



# motorola PMMN4148(A) Remote Speaker Microphone User Guide

[Home](#) » [Motorola](#) » motorola PMMN4148(A) Remote Speaker Microphone User Guide 

## Contents

- [1 motorola PMMN4148\(A\) Remote Speaker Microphone](#)
- [2 Safety and Legal](#)
- [3 Service and Warranty](#)
- [4 Contact Us](#)
- [5 Icon Conventions](#)
- [6 Style Conventions](#)
- [7 Product Overview](#)
- [8 Replacement Parts](#)
- [9 Operating Instructions](#)
- [10 Recommended Practices](#)
- [11 Documents / Resources](#)



**motorola PMMN4148(A) Remote Speaker Microphone**



### **PMMN4148 RM110 Remote Speaker Microphone with 3.5 mm Audio Jack (IP55) User Guide**

The PMMN4148 RM110 Remote Speaker Microphone is a device that allows users to communicate through a two-way radio system. It features a 3.5 mm audio jack for connecting a headset or earpiece, providing hands-free communication. The device is designed with an IP55 rating, making it resistant to dust and water.

**Safety and Legal Information** The safety and legal information for this product are as follows:

- **Intellectual Property and Regulatory Notices:** This section provides information about copyrights, trademarks, and license rights related to the product.
- **Open Source Content:** The product may contain Open Source software, and users should refer to the product installation media for full Open Source Legal Notices and Attribution content.
- **European Union (EU) and United Kingdom (UK) Waste of Electrical and Electronic Equipment (WEEE) Directive:** This directive provides guidelines for the proper disposal of electronic equipment.
- **RF Energy Exposure and Product Safety Guide for Portable Two-Way Radios:** This guide provides information on the acoustic safety and potential risks associated with radio usage. It advises users to stop listening through headsets or earpieces if experiencing any hearing issues and consult a doctor.
- **Service and Warranty:** Motorola Solutions offers warranty for the RSM. Users should refer to their Motorola Solutions dealer or point-of-purchase for detailed information.
- **Certification Markings:** The product is marked with appropriate certification markings to indicate compliance with relevant regulations.
- **Contact Address:** The contact addresses for Motorola Solutions in the European Union and United Kingdom are provided.

**Contact Us** If users need further assistance or have any questions, they can contact Motorola Solutions through their regional support. They can visit the [motorolasolutions.com](https://motorolasolutions.com) website and select the Support section.

**Icon Conventions** The documentation set uses graphic icons to provide visual clues. These icons are used throughout the documentation to represent specific actions or information.

**Style Conventions** The following style conventions are used in the documentation:

- **Bold:** Used for names of windows, buttons, and labels when they appear on the screen.
- **Monospacing font in bold:** Used for words to be typed exactly as shown in the text.
- **Monospacing font:** Used for general code snippets or examples.
- **CAPITAL LETTERS:** Used for emphasizing specific terms or instructions.
- *Italic:* Used for providing additional information or clarifications.

## Safety and Legal

This section provides the safety and legal information for this product.

### Intellectual Property and Regulatory Notices

#### Copyrights

The Motorola Solutions products described in this document may include copyrighted Motorola Solutions computer programs. Laws in the United States and other countries preserve for Motorola Solutions certain exclusive rights for copyrighted computer programs. Accordingly, any copyrighted Motorola Solutions computer programs contained in the Motorola Solutions products described in this document may not be copied or reproduced in any manner without the express written permission of Motorola Solutions

No part of this document may be reproduced, transmitted, stored in a retrieval system, or translated into any language or computer language, in any form or by any means, without the prior written permission of Motorola Solutions, Inc.

#### Trademarks

MOTOROLA, MOTO, MOTOROLA SOLUTIONS, and the Stylized M Logo are trademarks or registered trademarks of Motorola Trademark Holdings, LLC and are used under license. All other trademarks are the property of their respective owners.

#### License Rights

The purchase of Motorola Solutions products shall not be deemed to grant either directly or by implication, estoppel or otherwise, any license under the copyrights, patents or patent applications of Motorola Solutions, except for the normal non-exclusive, royalty-free license to use that arises by operation of law in the sale of a product.

#### Open Source Content

This product may contain Open Source software used under license. Refer to the product installation media for full Open Source Legal Notices and Attribution content.

European Union (EU) and United Kingdom (UK) Waste of Electrical and Electronic Equipment (WEEE) Directive

The European Union's WEEE directive and the UK's WEEE regulation require that products sold into EU countries and the UK must have the crossed-out wheelie bin label on the product (or the package in some cases). As defined by the WEEE directive, this crossed-out wheelie bin label means that customers and end-users in EU and UK countries should not dispose of electronic and electrical equipment or accessories in household waste. Customers or end-users in EU and UK countries should contact their local equipment supplier representative or service centre for information about the waste collection system in their country.

#### Disclaimer

Please note that certain features, facilities, and capabilities described in this document may not be applicable to or licensed for use on a specific system, or may be dependent upon the characteristics of specific mobile subscriber

## **RF Energy Exposure and Product Safety Guide for Portable Two-Way Radios**

### **CAUTION:**

Before using this accessory, read this guide which contains important operating instructions for safe usage and RF energy awareness and control for compliance with applicable standards and regulations. The Remote Speaker Microphone (RSM), when attached to the radio, is restricted to occupational use only to satisfy FCC/ICNIRP RF energy exposure requirements. Before using this product, read the RF energy awareness information and operating instructions in the Product Safety and RF Exposure booklet enclosed with your radio to ensure compliance with RF energy exposure limits.

### **Acoustic Safety**

Exposure to loud noises from any source for extended periods of time may temporarily or permanently affect your hearing. The louder the radio's volume, the less time is required before your hearing could be affected. Hearing damage from loud noise is sometimes undetectable at first and can have a cumulative effect. To protect your hearing:

- Use the lowest volume necessary to do your job.
- Turn up the volume only if you are in noisy surroundings.
- Turn down the volume before adding headset or earpiece.
- Limit the amount of time you use headsets or earpieces at high volume.
- When using the radio without a headset or earpiece, do not place the radio's speaker directly against your ear.
- If you experience hearing discomfort, ringing in your ears, or speeches that are muffled, you should stop listening to your radio through your headset or earpiece, and have your hearing checked by your doctor.

### **Service and Warranty**

Motorola Solutions offers warranty for your RSM. Refer to your Motorola Solutions dealer or point-of-purchase for detailed information.

**NOTE:** Warranty is void after customer replacement of any parts other than replacements parts listed.

### **Certification Markings**

#### **Contact Address**

European Union Contact  
Motorola Solutions,

- MN009681A01-AA
- Safety and Legal
- Czerwone Maki 82,
- 30-392 Krakow, Poland
- **UK Contact**
- Motorola Solutions UK Ltd.,
- Nova South, 160 Victoria Street,
- London, SW1E 5LB,
- United Kingdom

## Contact Us

The Centralized Managed Support Operations (CMSO) is the primary contact for technical support included in your organization's service agreement with Motorola Solutions. Service agreement customers should be sure to call the CMSO in all situations listed under Customer Responsibilities in their agreement, such as:

- To confirm troubleshooting results and analysis before taking action

Your organization received support phone numbers and other contact information appropriate for your geographic region and service agreement. Use that contact information for the most efficient response. However, if needed, you can also find general support contact information on the Motorola Solutions website, by following these steps:

1. Enter [motorolasolutions.com](https://motorolasolutions.com) in your browser.
2. Ensure that your organization's country or region is displayed on the page. Clicking or tapping the name of the region provides a way to change it.
3. Select "Support" on the [motorolasolutions.com](https://motorolasolutions.com) page

## Comments

Send questions and comments regarding user documentation to [documentation@motorolasolutions.com](mailto:documentation@motorolasolutions.com).

Provide the following information when reporting a documentation error:

- The document title and part number
- The page number or title of the section with the error
- A description of the error

Motorola Solutions offers various courses designed to assist in learning about the system. For information, go to <https://learning.motorolasolutions.com> to view the current course offerings and technology paths.

## Icon Conventions

The documentation set is designed to give the reader more visual clues. The following graphic icons are used throughout the documentation set.

**DANGER:** The signal word DANGER with the associated safety icon implies information that, if disregarded, will result in death or serious injury.

**WARNING:** The signal word WARNING with the associated safety icon implies information that, if disregarded, could result in death or serious injury, or serious product damage.

**CAUTION:** The signal word CAUTION with the associated safety icon implies information that, if disregarded, may result in minor or moderate injury, or serious product damage.

**CAUTION:** The signal word CAUTION may be used without the safety icon to state potential damage or injury that is not related to the product.

**IMPORTANT:** IMPORTANT statements contain information that is crucial to the discussion at hand, but is not CAUTION or WARNING. There is no warning level associated with the IMPORTANT statement.

**NOTE:** NOTICE contains information more important than the surrounding text, such as exceptions or preconditions. They also refer the reader elsewhere for additional information, remind the reader how to complete an action (when it is not part of the current procedure, for instance), or tell the reader where something is on the screen. There is no warning level associated with a notice.

## Style Conventions

The following style conventions are used:

## Convention/Description

- **Bold:** This typeface is used for names of, for instance, windows, buttons, and labels when these names appear on the screen (example: the Alarms Browser window). When it is clear that we are referring to, for instance, a button, the name is used alone (example: Click OK).
- **Monospacing font in bold:** This typeface is used for words to be typed in exactly as they are shown in the text (example: In the Address field, type `http://ucs01.ucs:9080/`).
- **Monospacing font:** This typeface is used for messages, prompts, and other text displayed on the computer screen (example: A new trap destination has been added).
- **Monospacing font in bold Italic>:** This typeface is used with angle brackets as placeholders for a specific member of the group that the words represent (example: `<router number>`).  
**NOTE:** In sequences to be typed in, the angle brackets are omitted to avoid confusion whether to include the angle brackets in the text to be typed.
- **CAPITAL LETTERS:** This typeface is used for keyboard keys (example: Press Y, and then press ENTER).
- **Italic:** This typeface is used for citations. A citation usually is the name of a document or a phrase from another document (example: Dimetra IP System Overview).
  - An → (arrow pointing right) is used for indicating the menu or tab structure in instructions on how to select a certain menu item (example: File→Save) or a certain sub-tab.

## Product Overview

This user manual describes the RM110 Remote Speaker Microphone, with 3.5 mm Audio Jack (IP55), PMMN4148.

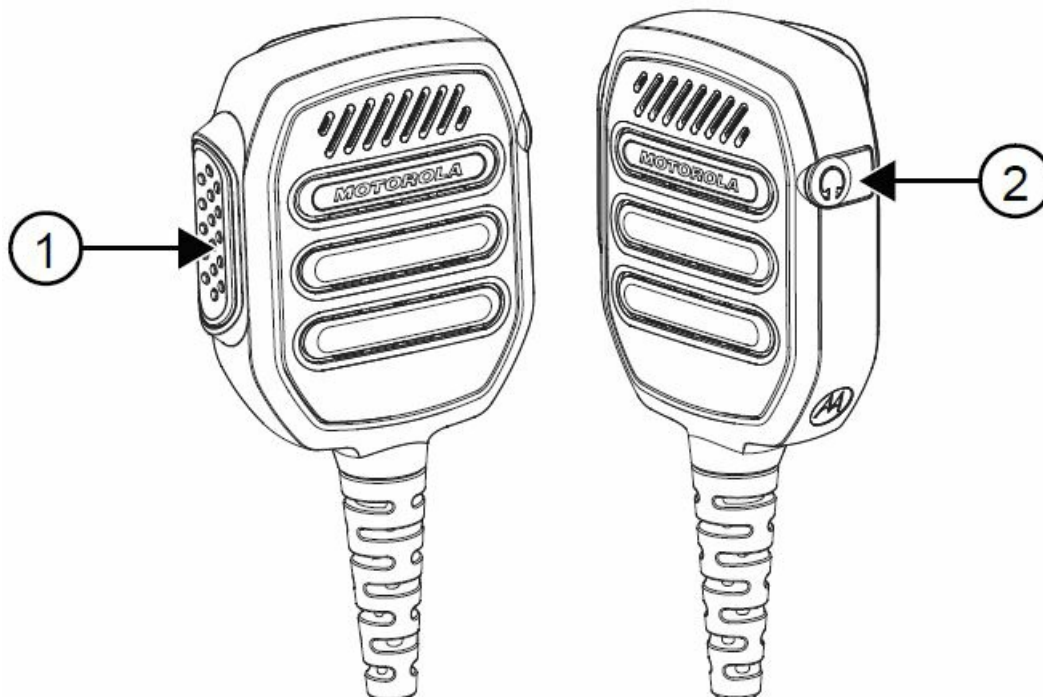

### Number/Description.

1. Push-to-Talk Button
2. Receive-only 3.5 mm Audio Jack (Non-threaded) covered by Dust Cover

Compatible Secondary Audio Accessories

No	Descriptions
PMLN8120	Rx only xL Clear Tube Earpiece, 3.5 mm Jack

Replacement Parts

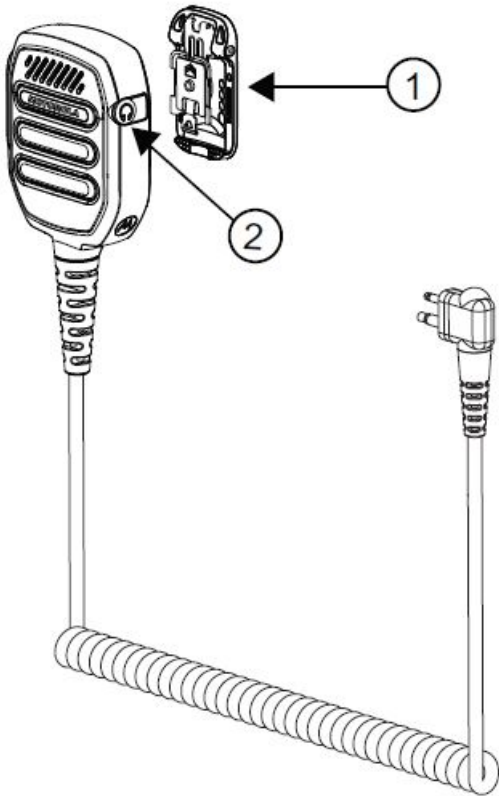
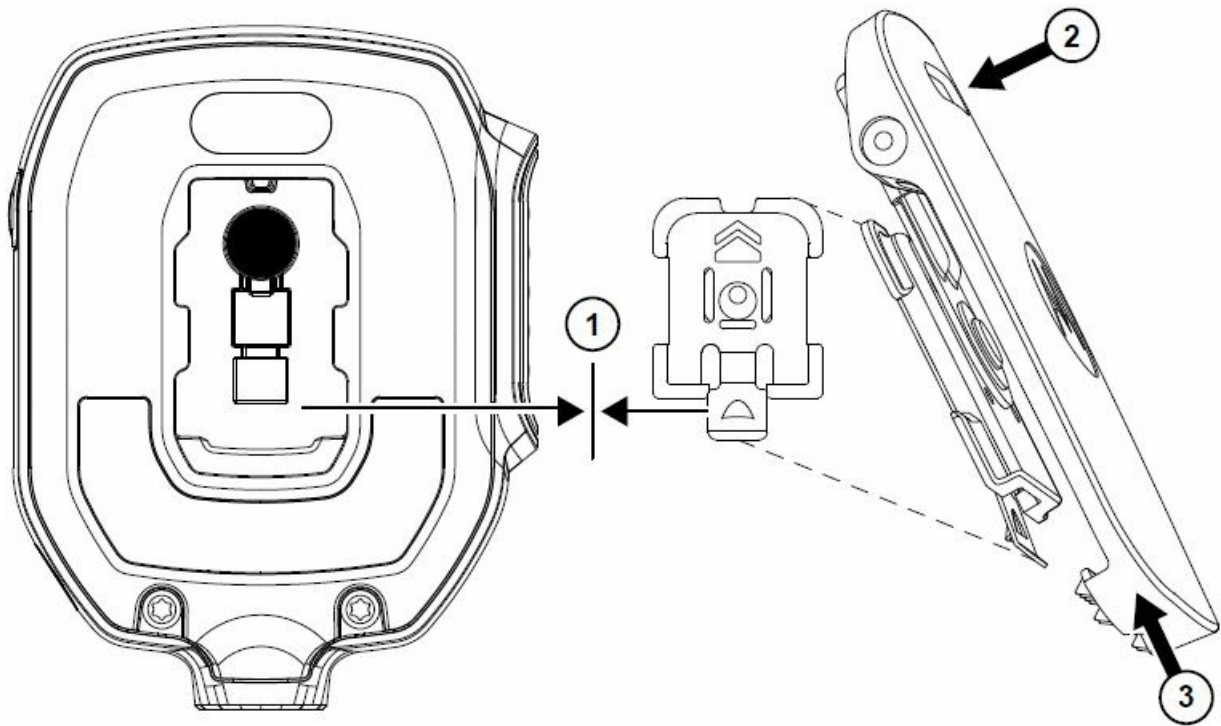

Table 1: Replacement Parts Callouts

No	Descriptions
1	Low Profile Swivel Clip (PMLN8121)
2	Dust Cover 10pcs/pack (PMLN8253)

Attaching Swivel Clip



**Procedure:**

1. Align the Bottom Release Latch to facing the downwards position.
2. Push down the top of the clip.
3. Simultaneously, slide the clip upward.

**Detaching Swivel Clip**

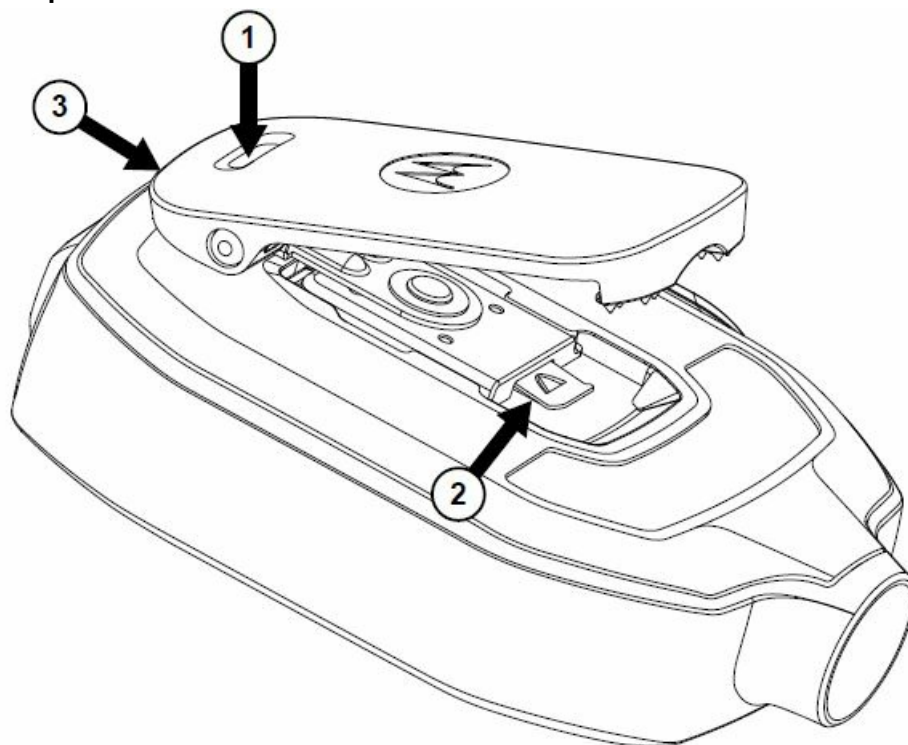

**Procedure:**

1. Push top of the clip to raise the clip to the highest position.



2. Lift up the bottom release latch.
3. Slide the clip to remove the clip.

### Removing the Dust Cover

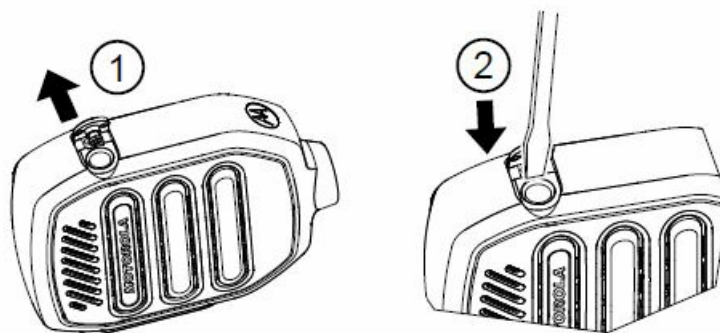

#### Procedure:

1. Lift up dust cover until it is fully open.
2. Insert small flat tip tool into recess and pry out the dust cover.

### Inserting the Dust Cover

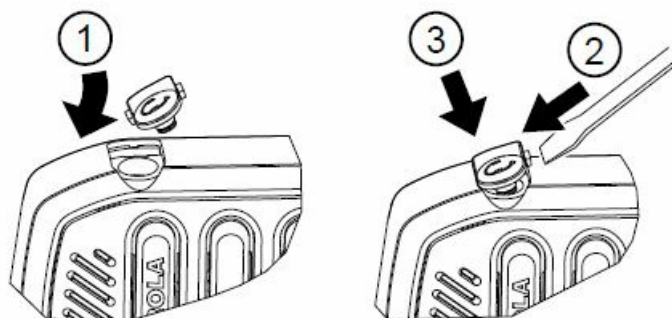

#### Procedure:

1. Slide the side tab of Dust Cover into the recess slot.
2. Push the opposite side with small tool.
3. Simultaneously push the Dust Cover into the RSM.

## Operating Instructions

This section provides guidelines on how to use your Remote Speaker Microphone.

### Attaching the RSM to the Radio

**Prerequisites:** Turn off your radio.

**NOTE:** To ensure proper operation, turn off the radio before connecting the RSM to the radio. Connecting the RSM to the radio disables the speaker of the radio, but does not disable the microphone and PTT of the radio.

#### Procedure:

Attach the Remote Speaker Microphone (RSM) connector to the side connector of the radio.

## Detaching the RSM from the Radio

**Prerequisites:** Turn off your radio.

**When and where to use:**

### Procedure:

1. Detach the Remote Speaker Microphone (RSM) connector from the radio side connector.
2. Keep the dust cover inserted in the audio jack of the RSM when a secondary accessory is not being used.

## Recommended Practices

This section provides information on the recommended practices for the Remote Speaker Microphone (RSM).

### Common Care

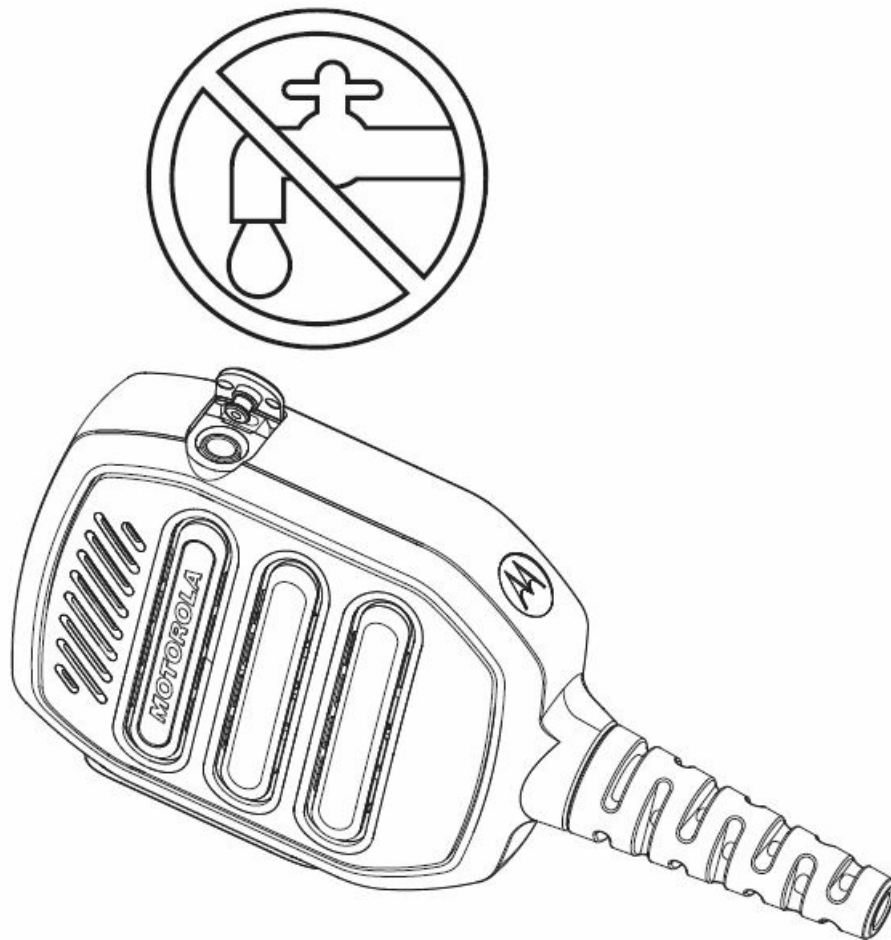

- Cover the audio jack with dust cover when it is not plugged with earpiece. Do not fill water into the audio jack.
- If water enters the audio jack, remove water by shaking the RSM.

## Transmitting and Receiving

**Figure 1:** Transmitting

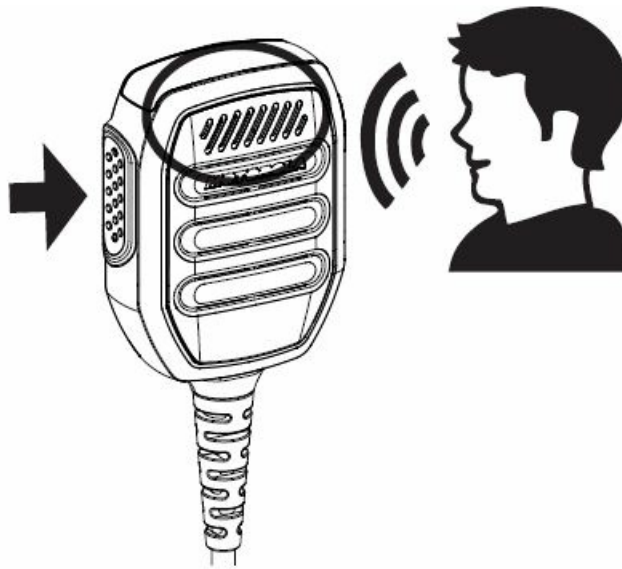

**Figure 2:** Receiving



### Recommended RSM Wearing Positions

**Figure 3:** Recommended Wearing Position



**NOTE:** For better performance, wear the RSM and the device on the same side.

### Cable Management

This section describes the recommended cable position.

**Figure 4:** Recommended

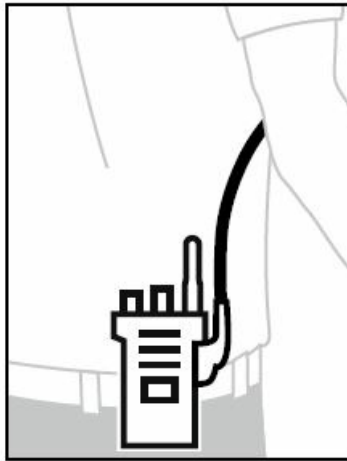

**Figure 5: Not Recommended**



To ensure optimum range and user experience, it is recommended to avoid crossing accessory cable with the radio antenna.

## American Communication Systems

- Discover the Power of Communications <sup>™</sup>
- <http://www.ameradio.com>.



## Documents / Resources

<p>American Communication Systems Discover the Power of Communications <a href="http://www.ameradio.com">http://www.ameradio.com</a></p> <p><b>PMMN4148 RM110</b> Remote Speaker Microphone with 3.5 mm Audio Jack (IP55) User Guide</p> <p>MARCH 2021</p>	<p><a href="#">motorola PMMN4148(A) Remote Speaker Microphone</a> [pdf] User Guide PMMN4148 A Remote Speaker Microphone, PMMN4148 A, Remote Speaker Microphone, Speaker Microphone</p>
--	--