



MOTOROLA CB400 Series Wi-Fi Call Buttons User Guide

[Home](#) » [Motorola](#) » MOTOROLA CB400 Series Wi-Fi Call Buttons User Guide 

MOTOROLA CB400 Series Wi-Fi Call Buttons



Contents

- 1 Quick Reference Guide
- 2 Safety and General Information
- 3 Compliance with RF Exposure Standards
- 4 and Operational Instructions for General Population and Uncontrolled Environment Use
- 5 Getting Started
- 6 Wi-Fi Call Buttons Overview
- 7 Connecting the Wi-Fi Call Button
- 8 Activating and Resetting the WiFi Call Button
- 9 Documents / Resources
 - 9.1 References
- 10 Related Posts

Quick Reference Guide

This Quick Reference Guide covers the basic operation of CB401, CB402, CB403C, and CB403W Wi-Fi Call Buttons.

For more operational details and information, refer to the MN009243A01 DH300, CB400 Series Installation Guide at [https:// learning.motorolasolutions.com](https://learning.motorolasolutions.com).

Notice to Users (FCC and Industry Canada)

This device complies with Part 15 of the FCC rules and Innovation, Science and Economic Development Canada's license-exempt RSS(s) per the following conditions:

- This device may not cause harmful interference.
- This device must accept any interference received, including interference that may cause undesired operation.
- Changes or modifications made to this device, not expressly approved by Motorola Solutions, could void the authority of the user to operate this equipment.

The CB400 Series Call buttons supports dual band Wi-Fi (2.4 GHz and 5 GHz).

Safety and General Information



Caution: Before using this radio, read this section which contains important operating instructions. For more information on product details, brochures, user manuals, and approved accessories, refer to <http://www.motorolasolutions.com>.

Compliance with RF Exposure Standards

National and international regulations require manufacturers to comply with the RF energy exposure limits for devices before they can be marketed. Your Motorola Solutions device is designed, manufactured, and tested to comply with all applicable national and international regulations for human exposure to radio frequency electromagnetic energy.

Observe a minimum safe distance of 20 cm from the device to the operator.

RF Energy Exposure Awareness and Control Information

and Operational Instructions for General Population and Uncontrolled Environment Use

For more information on what RF energy exposure is, refer to the following websites:

- <https://www.fcc.gov/>
 - <http://www.who.int/peh-emf/project/en/>
 - <http://www.ic.gc.ca/eic/site/smt-gst.nsf/eng/sf11467.html>
 - <http://www.ic.gc.ca/eic/site/smt-gst.nsf/eng/sf01904.html>
- For additional information, refer to https://www.motorolasolutions.com/en_us/about/company-overview/corporateresponsibility/governance-and-policies.html.

Getting Started

Types of Wi-Fi Call Buttons

Figure 1: CB401–Compact Glass Mount



Figure 2: CB403W–Wall Mount



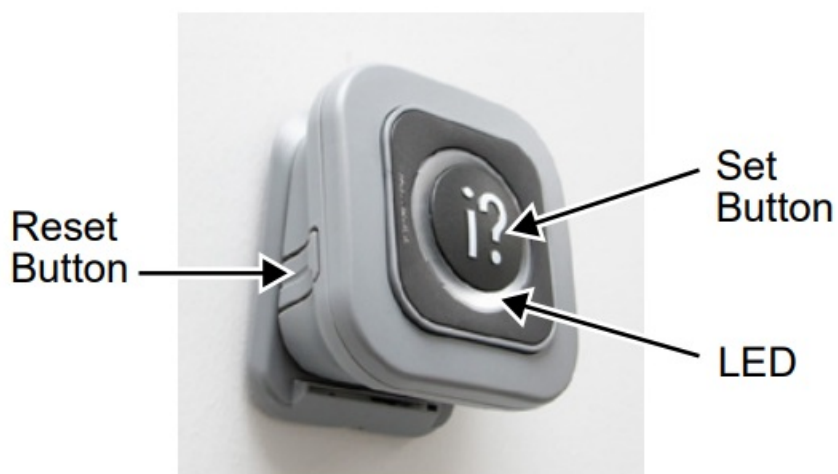
Figure 3: CB402–Blade Style

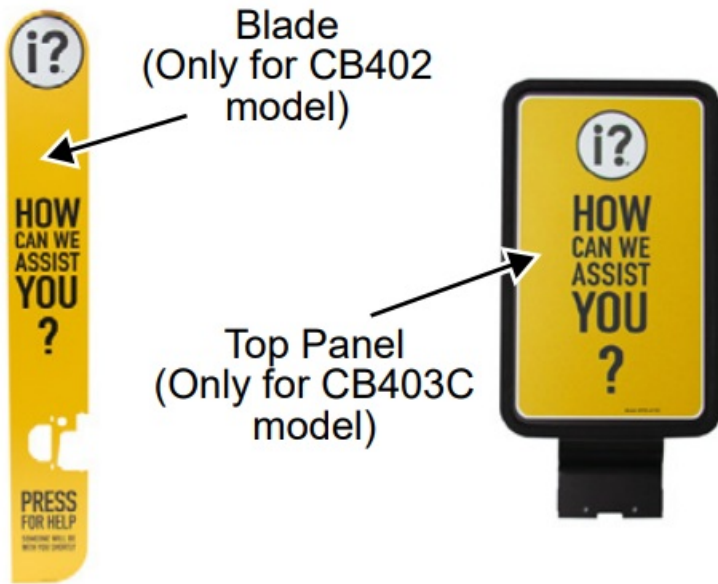


Figure 4: CB403C–Counter Top



Wi-Fi Call Buttons Overview



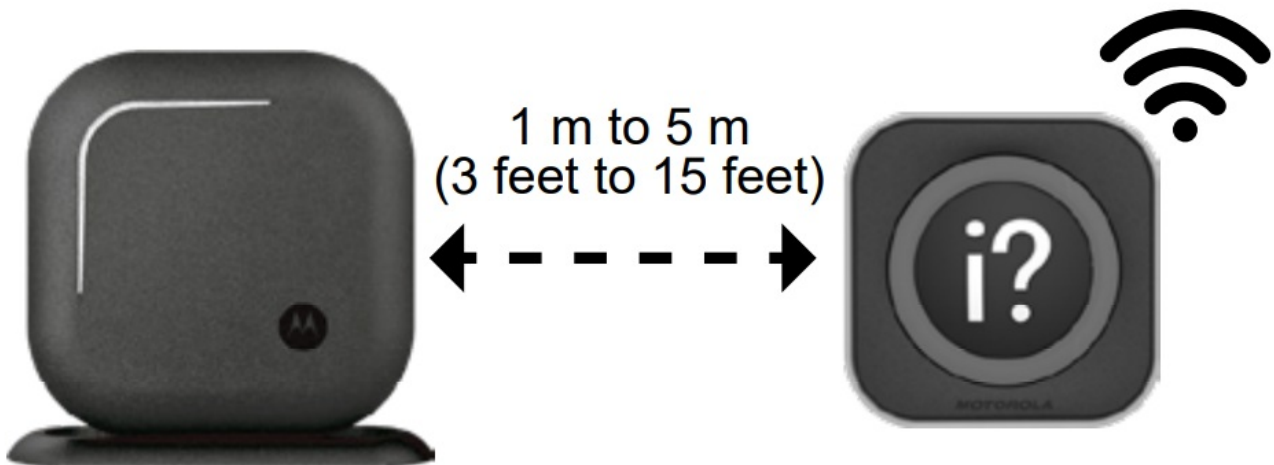


Note: There are four color options for blade panel and sign panel such as red, blue, yellow, and green

Connecting the Wi-Fi Call Button

Ensure that DH300 Digital Hub is connected and provisioned.

1. Place the call button at 1 to 5 meters (3 to 15 feet) distance from the DH300 hub.




2. Pull the battery tabs.



- The LED blinks yellow when the call button is establishing connection to the hub and when downloading the provisioning file.
- The LED blinks light green when connected and then turns off. The call button is ready to use within 45 seconds.

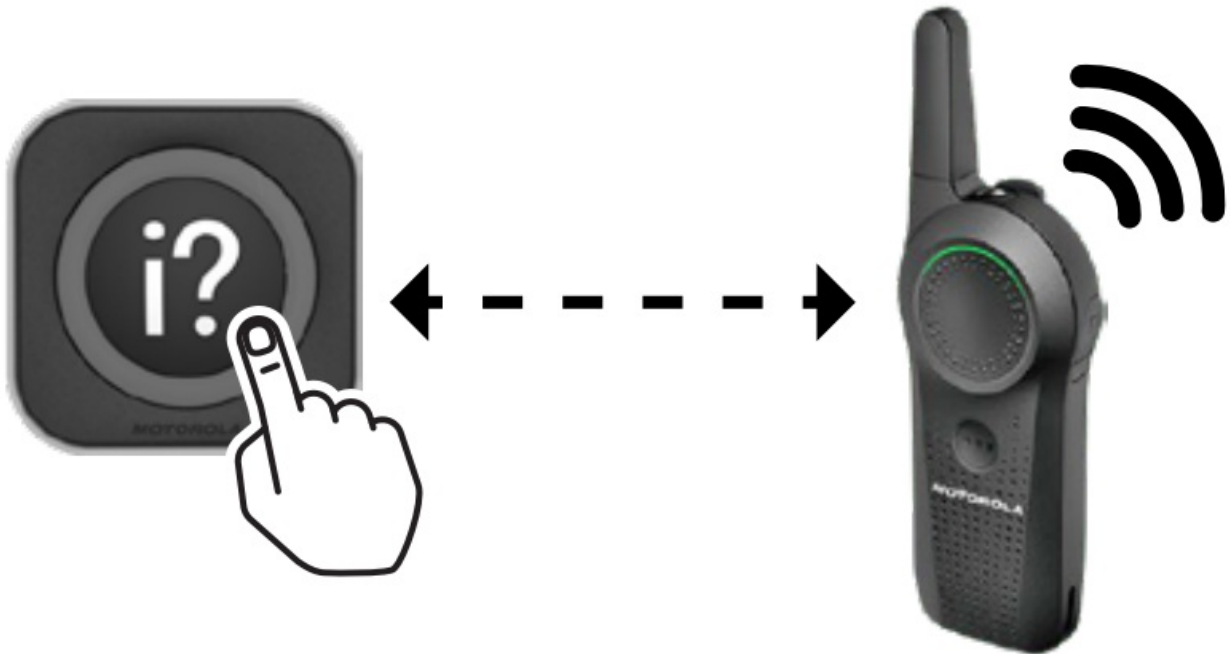
LED Indicators

LED Indicators	Status
Blinking Yellow	<ul style="list-style-type: none"> • Establishing internet connection. • Establishing hub connection.
Solid Blue	Firmware update from the Motorola Configuration Cloud.
Solid Purple	Updating the .wav audio file\ received from the hub.
Solid Green	Establishing connection between the hub and the call button.

LED Indicators	Status
Blinking White	The LED blinks when you press the call button. The LED color is interchangeable through the cloud setting.
LED Off	Idle mode.
 Note: The LED indicators are default colors configured in the cloud configuration.	

Activating and Resetting the WiFi Call Button

1. To activate the call button, press the Set button.



- The LED blinks blue.
- The radio announces that assistance is required.



Note: The LED indicators are default colors configured in the cloud configuration.

2. To reset the call button and acknowledge the call for assistance, press the Reset button.



- The LED blinks yellow.
- The radio announces that assistance is received.



Note: You can activate or reset the call button after the 10 seconds hangtime.

<https://learning.motorolasolutions.com/installation-guide/80396enus>



MOTOROLA, MOTO, MOTOROLA SOLUTIONS and the Stylized M logo are trademarks or registered trademarks of Motorola Trademark Holdings, LLC and are used under license. All other trademarks are the property of their respective owners. © 2023 Motorola Solutions, Inc. All rights reserved.

MN009240A01-AA



Printed in



MOTOROLA SOLUTIONS

Documents / Resources

	MOTOROLA CB400 Series Wi-Fi Call Buttons [pdf] User Guide CB400 Series Wi-Fi Call Buttons, CB400 Series, Wi-Fi Call Buttons, Call Buttons, Buttons
--	-----------------------------------------------------------------------------------------------------------------------------------------------------------------------

References

- [\(\\$V>Main - English\)](#)

-  [RSS-102 — Radio Frequency \(RF\) Exposure Compliance of Radiocommunication Apparatus \(All Frequency Bands\)](#)
-  [Radiofrequency Energy and Safety](#)
-  [Solving for Safer - Motorola Solutions Australia & NZ](#)
-  [Federal Communications Commission | The United States of America](#)
-  [Solving for Safer - Motorola Solutions EMEA](#)
-  [Governance and Compliance - Motorola Solutions](#)
- [User Manual](#)

[Manuals+](#), [Privacy Policy](#)

This website is an independent publication and is neither affiliated with nor endorsed by any of the trademark owners. The "Bluetooth®" word mark and logos are registered trademarks owned by Bluetooth SIG, Inc. The "Wi-Fi®" word mark and logos are registered trademarks owned by the Wi-Fi Alliance. Any use of these marks on this website does not imply any affiliation with or endorsement.