



MOTOROLA SOLUTIONS PMMN4135 Remote Speaker Microphone with DincX Noise Suppression User Guide

[Home](#) » [Motorola Solutions](#) » **MOTOROLA SOLUTIONS PMMN4135 Remote Speaker Microphone with DincX Noise Suppression User Guide** 

Contents

- [1 MOTOROLA SOLUTIONS PMMN4135 Remote Speaker Microphone with DincX Noise Suppression](#)
- [2 Safety and Legal](#)
- [3 Conformity Markings](#)
- [4 Icon Conventions](#)
- [5 Warranty](#)
- [6 Product Overview](#)
- [7 Speaker and Microphone](#)
- [8 Optional Accessories](#)
- [9 Replacing Coil Cord](#)
- [10 Chapter 2 Operating Instructions](#)
- [11 Chapter 3 Recommended Practices](#)
- [12 Using Your RSM](#)
- [13 Positioning Your RSM](#)
- [14 Chapter 4 Cleaning Procedure](#)
- [15 Documents / Resources](#)
 - [15.1 References](#)
- [16 Related Posts](#)





Specifications

- Product Name: XVP IMPRES Remote Speaker Microphone with DincX Noise Suppression
- Models Available: PMMN4135_, PMMN4136_, PMMN4141_, PMMN4142_ Languages: en-US, fr-CA, es-LA, pt-BR, uk-UA

Intellectual Property and Regulatory Notices

The product contains copyrighted material and trademarks of Motorola Trademark Holdings, LLC. Refer to the user manual for more information.

Open Source Content

This product may contain open-source software used under license. Please refer to the product installation media for full Open Source Legal Notices and Attribution content.

Warranty Information

Motorola Solutions offers a warranty for the Remote Speaker Microphone. Contact your dealer or point-of-purchase for detailed warranty information.

FAQ

Q: What should I do if I experience hearing discomfort while using the product?

A: If you experience any hearing discomfort, ringing in your ears, or muffled sounds, stop using the product and consult a doctor. Adjust the volume level as per safety guidelines provided in the manual.

Safety and Legal

This section provides the safety and legal information for this product.

Intellectual Property and Regulatory Notices

Copyrights

The Motorola Solutions products described in this document may include copyrighted Motorola Solutions computer programs. Laws in the United States and other countries preserve for Motorola Solutions certain exclusive rights for copyrighted computer programs. Accordingly, any copyrighted Motorola Solutions computer programs contained in the Motorola Solutions products described in this document may not be copied or reproduced in any manner without the express written permission of Motorola Solutions.

No part of this document may be reproduced, transmitted, stored in a retrieval system, or translated into any language or computer language, in any form or by any means, without the prior written permission of Motorola Solutions, Inc.

Trademarks

MOTOROLA, MOTO, MOTOROLA SOLUTIONS, and the Stylized M Logo are trademarks or registered trademarks of Motorola Trademark Holdings, LLC and are used under license. All other trademarks are the property of their respective owners.

License Rights

The purchase of Motorola Solutions products shall not be deemed to grant either directly or by implication, estoppel or otherwise, any license under the copyrights, patents or patent applications of Motorola Solutions, except for the normal nonexclusive, royalty-free license to use that arises by operation of law in the sale of a product.

Open Source Content

This product may contain Open Source software used under license. Refer to the product installation media for full Open Source Legal Notices and Attribution content.

European Union (EU) and United Kingdom (UK) Waste of Electrical and Electronic Equipment (WEEE) Directive



The European Union's WEEE directive and the UK's WEEE regulation require that products sold into EU countries and the UK must have the crossed-out wheeled bin label on the product (or the package in some cases). As defined by the WEEE directive, this crossed-out wheeled bin label means that customers and end users in EU and UK countries should not dispose of electronic and electrical equipment or accessories in household waste. Customers or end users in EU and UK countries should contact their local equipment supplier representative or service center for information about the waste collection system in their country.

Disclaimer

Please note that certain features, facilities, and capabilities described in this document may not be applicable to or licensed for use on a specific system, or may be dependent upon the characteristics of a specific mobile subscriber unit or configuration of certain parameters. Please refer to your Motorola Solutions contact for further information.

Conformity Markings



Contact Us

The Centralized Managed Support Operations (CMSO) is the primary contact for technical support included in your organization's service agreement with Motorola Solutions.

Service agreement customers should be sure to call the CMSO in all situations listed under Customer Responsibilities in their agreement, such as:

- To confirm troubleshooting results and analysis before taking action

Your organization received support phone numbers and other contact information appropriate for your geographic region and service agreement. Use that contact information for the most efficient response. However, if needed, you can also find general support contact information on the Motorola Solutions website, by following these steps:

1. Enter motorolasolutions.com in your browser.
2. Ensure that your organization's country or region is displayed on the page. Clicking or tapping the name of the region provides a way to change it.
3. Select "Support" on the motorolasolutions.com page.

Comments

Send questions and comments regarding user documentation to documentation@motorolasolutions.com

Provide the following information when reporting a documentation error:

- The document title and part number
- The page number or title of the section with the error
- A description of the error

Motorola Solutions offers various courses designed to assist in learning about the system. For information, go to <https://learning.motorolasolutions.com> to view the current course offerings and technology paths.

Icon Conventions

The documentation set is designed to give the reader more visual clues. The following graphic icons are used throughout the documentation set.

- **DANGER:** The signal word DANGER with the associated safety icon implies information that, if disregarded, will result in death or serious injury.
- **WARNING:** The signal word WARNING with the associated safety icon implies information that, if disregarded, could result in death or serious injury, or serious product damage.
- **CAUTION:** The signal word CAUTION with the associated safety icon implies information that, if disregarded, may result in minor or moderate injury, or serious product damage.
- **CAUTION:** The signal word CAUTION may be used without the safety icon to state potential damage or injury that is not related to the product.
- **IMPORTANT:** IMPORTANT statements contain information that is crucial to the discussion at hand, but is not a CAUTION or WARNING. There is no warning level associated with the IMPORTANT statement.
- **NOTE:** NOTICE contains information more important than the surrounding text, such as exceptions or preconditions. They also refer the reader elsewhere for additional information, remind the reader how to complete an action (when it is not part of the current procedure, for instance), or tell the reader where something is on the screen. There is no warning level associated with a notice.

Foreword

RF Energy Exposure and Product Safety Guide for Portable Two-Way Radios

CAUTION

Before using this product, read this guide which contains RF energy awareness information and operating instructions.

For information on intrinsic and/or nonincendive safety certification, refer to the Approval manual that ships with your radio.

Acoustic Safety

Exposure to loud noises from any source for extended periods of time may temporarily or permanently affect your hearing. The louder the radio volume, the less time is required before your hearing could be affected. Hearing damage from loud noise is sometimes undetectable at first and can have a cumulative effect. To protect your hearing:

- Use the lowest volume necessary to do your job.
- Turn up the volume only if you are in noisy surroundings.
- Turn down the volume before wearing the headset or earpiece.
- Limit the amount of time that you use headsets or earpieces at high volume.
- When using the radio without a headset or earpiece, do not place the radio speaker directly against your ear.
- If you experience hearing discomfort, ringing in your ears, or speeches that are muffled, you should stop listening to your radio through your headset or earpiece, and have your hearing checked by your doctor. To change the volume level, refer to Radio Product Safety Leaflet or Customer Programming Software (CPS) for Surveillance extra loud (xL) Kit Configurations.

Warranty

Motorola Solutions offers warranty for your RSM. Refer to your Motorola Solutions dealer or point-of-purchase for detailed information.

NOTE: Warranty is void after customer replacement of any parts other than replacement parts listed.

Chapter 1

Product Overview

Remote Speaker Microphone (RSM) Models

Table 1: RSM Models

Part Number	Description	Replacement Coil Cord	Compatible Radios
PMMN4135_	Channel Knob RSM	PMKN4260_	APX, APX NEXT
		PMKN4263_	APX N70
PMMN4136_	Without Channel Knob RSM	PMKN4260_	APX, APX NEXT
		PMKN4263_	APX N70
PMMN4141_	Channel Knob RSM	PMKN4260_	APX, APX NEXT
		PMKN4263_	APX N70
PMMN4142_	Without Channel Knob RSM	PMKN4260_	APX, APX NEXT
		PMKN4263_	APX N70

PTT and Programmable Button

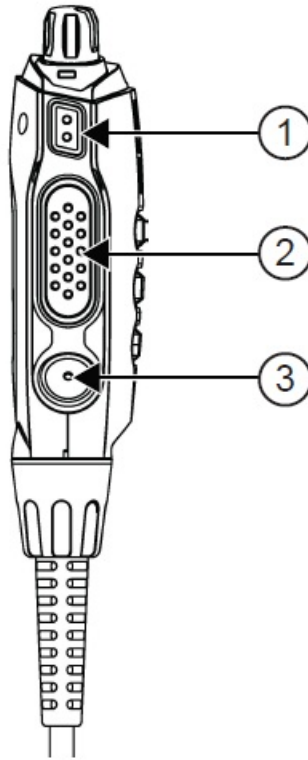

Number	Description
1	2-Dot
2	PTT
3	1-Dot

NOTE: 1-Dot, 2-Dot, and 3-Dot programmable buttons can be configured to other functions different from the same buttons on the radio. Refer to radio user manual for more information.

Speaker and Microphone

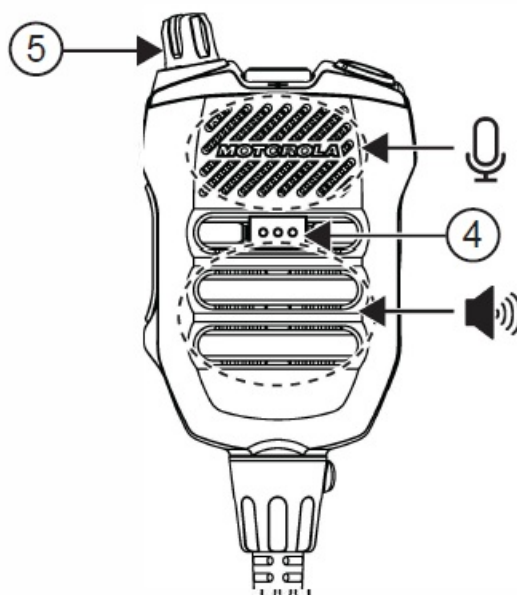

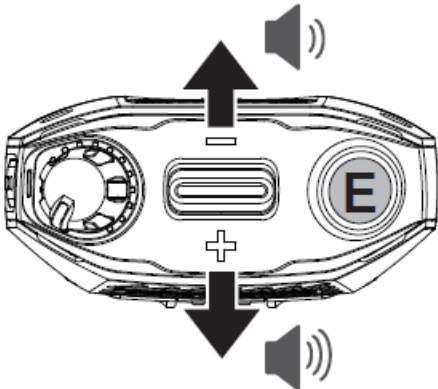

Number	Description
4	3-Dot
5	Channel Knob
	 NOTE: Only applicable to PMMN4135_ and PMMN4141_.

Increasing and Decreasing Volume



Replacement Parts

Table 2: Replacement Parts

Item	Part Number	Description
1	PMLN8312_	Low Profile Swivel Clip with D-Ring
2	PMLN8313_	Channel Knob
		 NOTE: Only applicable to PMMN4135_ and PMMN4141_.
3	PMKN4260_	Coil Cord
		 NOTE: Compatible with accessory side connector of APX and APX Next.
4	PMKN4263_	Coil Cord
		 NOTE: Compatible with accessory side connector of APX N70.

NOTE: Swapping the cable between PMKN4260_ and PMKN4263_ on the Remote Speaker Microphone (RSM) head is allowed but the rear housing label information does not change. Refer to the respective radio UL manual for compatible accessories.

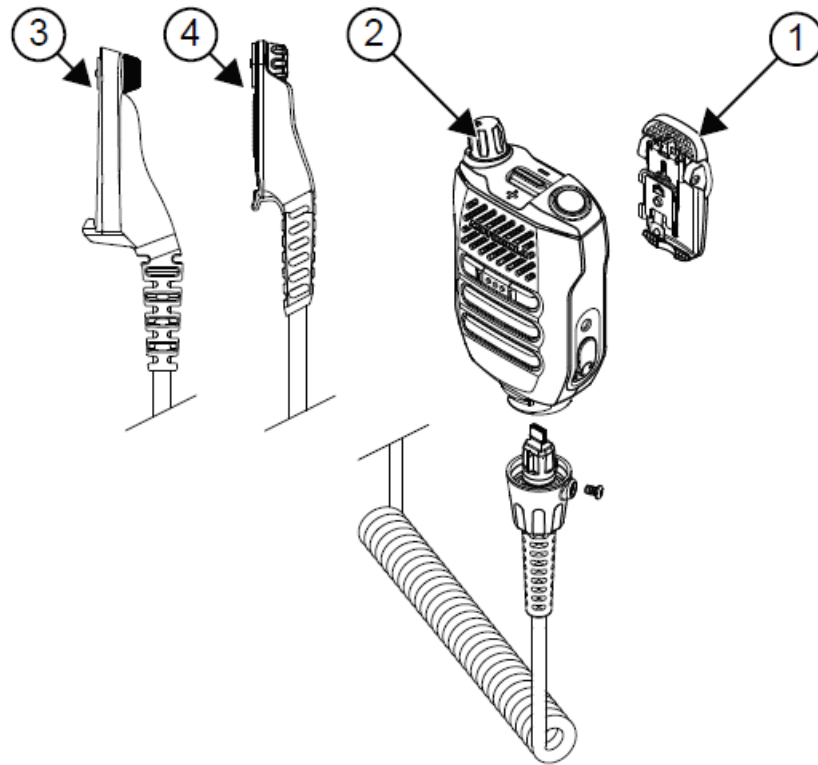

NOTE: To avoid functional problem, do not plug in incompatible cables.

Optional Accessories

Table 3: Optional Accessories

Part Number	Description
PMLN8120_	Receive-Only Loud Audio Earpiece with Translucent Tube, 3.5 mm Jack
PMLN8650_	N-ear 360 Flexo™ Dynamic Braided Fiber Cloth™ Single Ear Earpiece
PMLN8652_	Receive-Only Extra Loud Earpiece with Translucent Tube, 3.5 mm Jack

Replacing Coil Cord

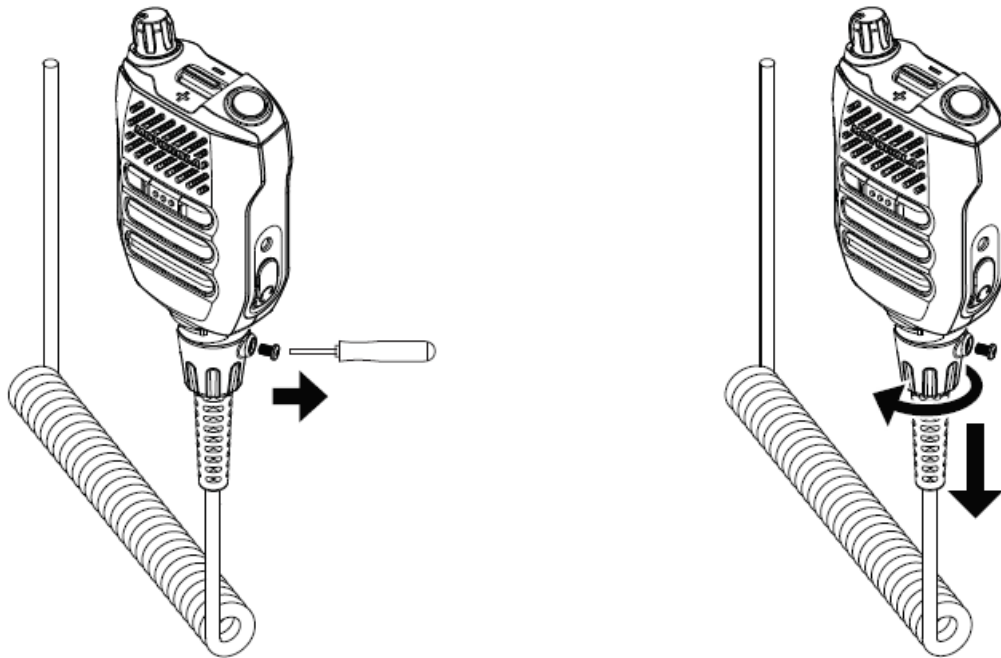

Chapter 2 Operating Instructions

This section provides guidelines on how to use your Remote Speaker Microphone.

Attaching the Remote Speaker Microphone (RSM) to the Radio

Prerequisites: Turn off your radio.

Procedure:

1. Attach the RSM connector to the side connector of the radio.
2. Secure the connection screw in a clockwise direction until tightened.

NOTE: To ensure proper operation, turn off the radio before connecting the RSM to the radio.

Connecting the RSM to the radio disables the speaker of the radio, but does not disable the microphone and PTT of the radio.

Attaching Swivel Belt Loop

Procedure:

1. Match and align the arrowhead icons and side wings.
2. Push down the top of the clip.
3. Simultaneously, push slide clip upward.

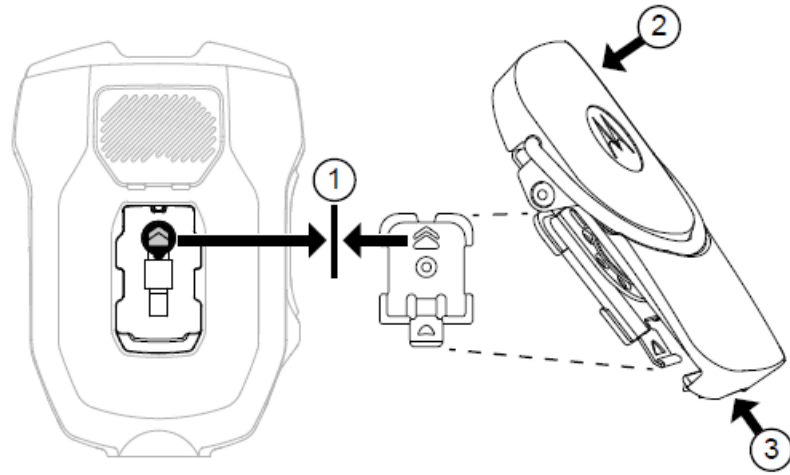

Detaching Swivel Belt Loop Procedure:

1. Push the top of the clip to raise the clip to the highest position.
2. Lift up the bottom release latch.
Recommended to use the small flat tip tool.
3. To remove the clip, slide the clip.

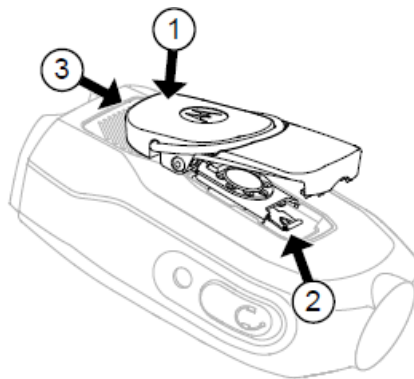

Earpiece Audio Jack

Figure 1: Inserting Audio Jack

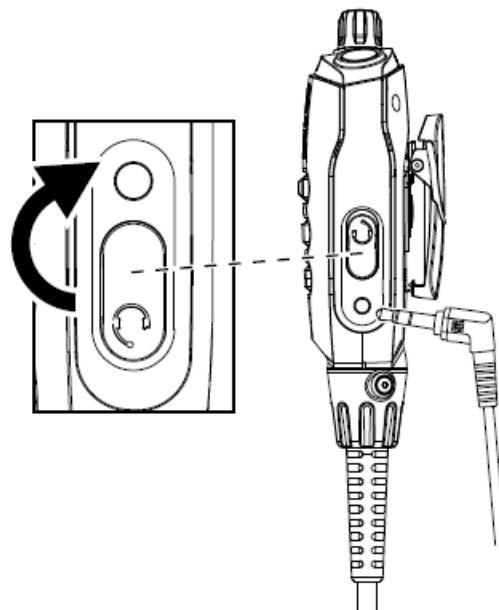

This section provides information on the recommended practices for the Remote Speaker Microphone (RSM).

Holding Your RSM

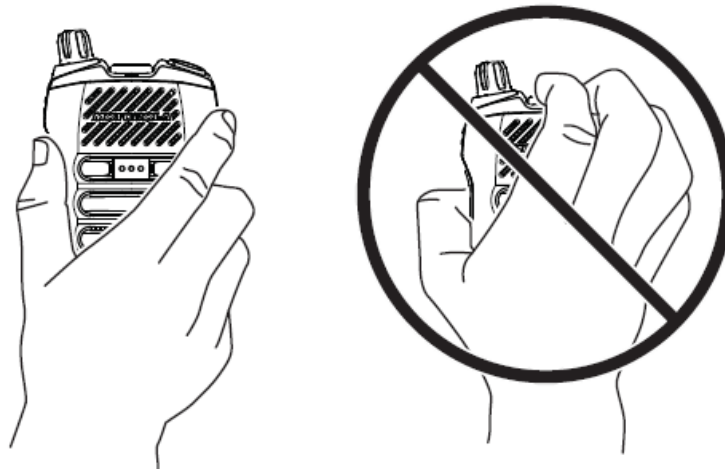

Using Your RSM

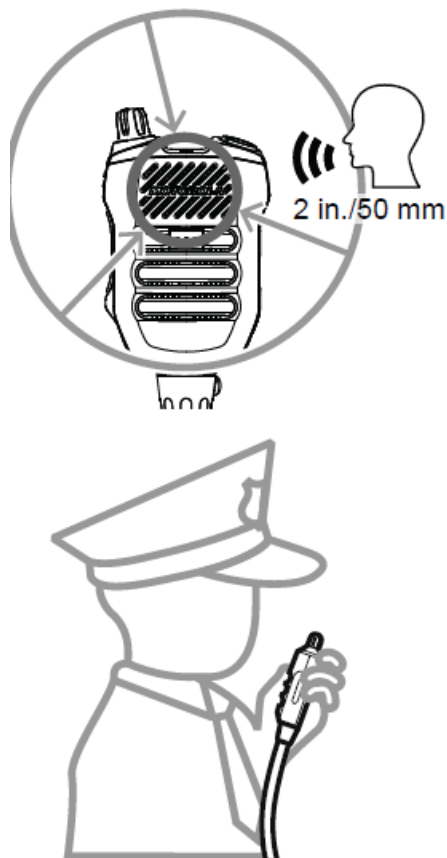

Positioning Your RSM

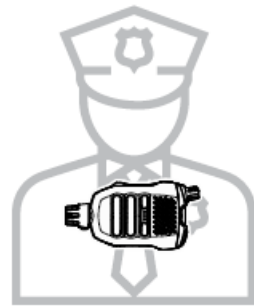
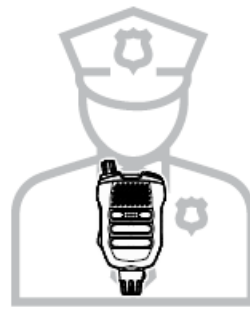

Proper Handling



Best Transmit Practices

- Hold the Remote Speaker Microphone (RSM) 1–2 inches from mouth.
- Speak in a loud, clear, and controlled voice
- Speak louder than the background noise
- When practical, shake the RSM to clear water before transmitting

NOTE: Refer to the radio user manual for more details.

Chapter 4 Cleaning Procedure

Do not use solvents to clean your Remote Speaker Microphone (RSM) as most chemicals may permanently damage the RSM housing and textures. Do not submerge the RSM in the detergent solution. To clean the external surfaces of your radio, perform the following procedure:

Procedure:

1. Vacuum the front surface of the RSM. Avoid completely covering the speaker grill and microphone openings all at once with the nozzle.
2. Mix one teaspoon of mild dish-washing detergent to one gallon of water (0.5 % solution) to clean the external surfaces of the RSM.
3. Apply the solution sparingly with a stiff, non-metallic, short bristled brush, making sure excess detergent does not get entrapped near the connectors, controls or crevices. Dry the RSM thoroughly with a soft, lint-free cloth.

RSM Firmware Upgrades Notice

- Radio checks the Remote Speaker Microphone (RSM) firmware version automatically after power up.
- Older RSM firmware is upgraded automatically through the radio.
- RSM firmware upgrade process takes less than 20 seconds to complete.
- During firmware update, all buttons except PTT and emergency button do not function.
- RSM firmware upgrade is aborted by the PTT Transmit (Tx) or incoming Receive (Rx) during the upgrade process. Turn your radio off and on again to re-initiate the RSM firmware upgrade.

Radio Firmware Requirement

XVP RSM is only compatible with the following radio firmware version and later:

- APX Radios: R24.00.00
- APX Next Radios: R03.20.00
- APX N70 Radios : R01.00.00

Documents / Resources

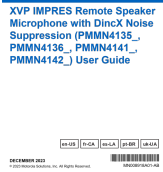
	<p>MOTOROLA SOLUTIONS PMMN4135 Remote Speaker Microphone with DincX Noise Suppression [pdf] User Guide</p> <p>PMMN4135 Remote Speaker Microphone with DincX Noise Suppression, PMMN4135, Remote Speaker Microphone with DincX Noise Suppression, Microphone with DincX Noise Suppression, DincX Noise Suppression, Noise Suppression, Suppression</p>
---	--

References

- [User Manual](#)

[Manuals+](#), [Privacy Policy](#)

This website is an independent publication and is neither affiliated with nor endorsed by any of the trademark owners. The "Bluetooth®" word mark and logos are registered trademarks owned by Bluetooth SIG, Inc. The "Wi-Fi®" word mark and logos are registered trademarks owned by the Wi-Fi Alliance. Any use of these marks on this website does not imply any affiliation with or endorsement.