



MOTOROLA SOLUTIONS MXM600 Mobile Radio User Guide

[Home](#) » [Motorola Solutions](#) » **MOTOROLA SOLUTIONS MXM600 Mobile Radio User Guide** 



MXM600 QUICK START GUIDE



Contents

- 1 Knowing Your Radio
- 2 Getting Started
- 3 Using the Radio
- 4 Indication
- 5 Documents / Resources
- 5.1 References

Knowing Your Radio

Control Head Overview



1. Large Rotary Control Knob
2. Emergency Button
3. GCAI MMP Dust Cover
4. Keypad with 15 Programmable Buttons
5. Status LED
6. Screws
7. Horizontal or Vertical Display
8. Power Button
9. Soft Key Buttons
10. Micro USB Port

Home Screen Overview

Veritcal Display



Horizontal Display

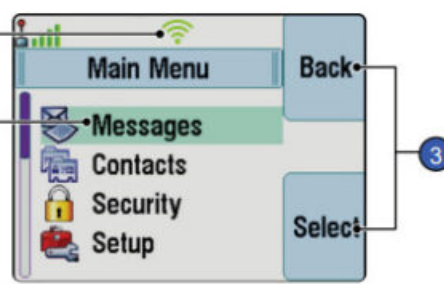

1. Status Icon Area
2. Display Area
3. Soft Key Area

Transceiver Overview

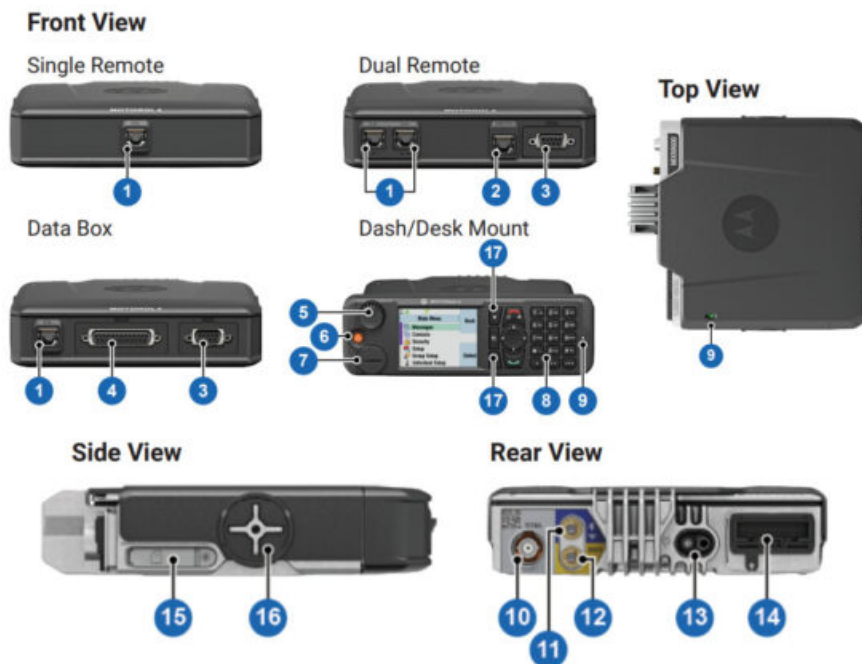

1. Ethernet RJ50 Connector (for Remote Control Head)
2. RJ50 connector for SIM Port and RJ45 Ethernet
3. 9-Pin SubD Connector (RS232)
4. 25-Pin SubD Connector
5. Large Rotary Control Knob
6. Emergency Button
7. GCAI MMP Dust Cover
8. Keypad with 15 Programmable Buttons
9. Status LED
10. TETRA Antenna Port

11. Bluetooth/Wi-Fi Antenna Port
12. GNSS Antenna Port
13. Power Connection
14. 26-Pin Accessory Connector
15. TETRA SIM Card Dust Cover
16. Trunnion Mounting Guide Point
17. Soft Key Buttons¹⁷

Getting Started

Looking After Your Radio

Never leave your Control Head in extreme temperatures (over +85° C), for example, behind a windscreen in direct sunlight.

The Dash/Desk Mount Control Head and Remote Ethernet Control Head is protected against dust and water sprays (compliant with the IP54 rating). The Telephone Style Control Head is protected and compliant with the IP55 rating. The IP67 Remote Ethernet Control Head is protected and compliant with the IP67 rating.

To clean your radio, use a moistened or antistatic cloth.

Attaching the Antenna

1. Connect the external Bluetooth/Wi-Fi antenna cable to the Bluetooth/Wi-Fi antenna port of the transceiver.
Tighten the cable connector head to the transceiver.
2. Connect the external GNSS antenna cable to the GNSS port of the transceiver. Tighten the cable connector head to the transceiver.
3. Connect the external TETRA cable to the TETRA LMR port of the transceiver. Turn the connector head of the cable to lock the cable to transceiver.

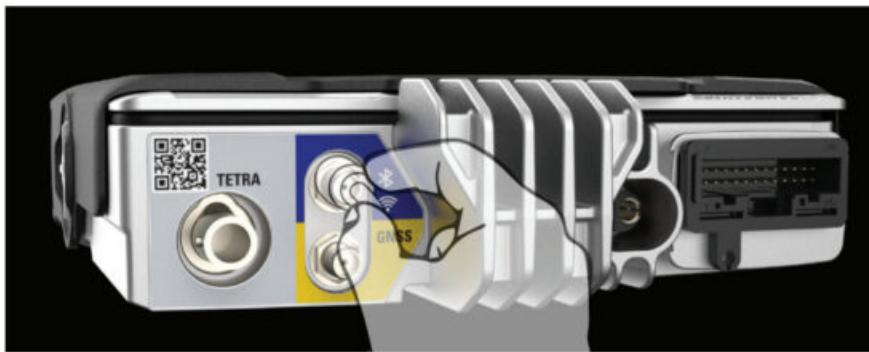

Inserting the TETRA SIM Card

1. Flip open the TETRA SIM card dust cover on the transceiver.
2. Insert the TETRA SIM card into the card slot. Ensure that the gold contact area is facing downward.
3. Close the TETRA SIM card dust cover. Ensure that the SIM card dust cover is closed completely.



Installing the Control Head

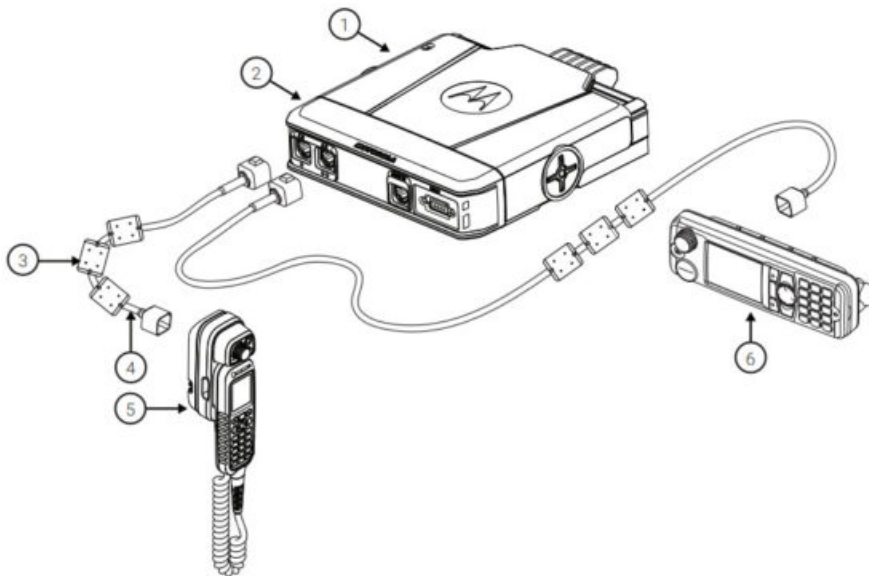

1. Transceiver
2. Dual Remote Expansion Head
3. Ferrite clamp
4. Remote Mount RJ50 Ethernet Cable
5. Telephone Style Control Head
6. Remote Ethernet Control Head

Using the Radio

Turning the Radio On

To turn on the radio, press and hold the Power button.

Turning the Radio Off

To turn off the radio, press and hold the Power button.

Entering Emergency Operation

Press and hold the Emergency button.

NOTE: If the terminal is turned off, press and hold the Emergency button to turn on the terminal in Emergency Operation (if configured by your Service Provider).

Rotary Knob Functions

The service provider can program the Rotary Knob to perform one of the following functions:

- Dual Control – The knob is used as a volume control and for scrolling through lists. Press the knob to switch between volume and list (default programming).
- List Control – The knob is used to scroll through lists or menu items. Volume can then only be adjusted through the menu or external accessory.

- Volume Control – The knob is used to adjust the volume. Press and hold the Rotary Knob to lock or unlock the volume setting.

Menu Key

Pressing the Menu button allows you to enter the following functions:

- Menu (when there is no ongoing activity): The menu allows you to control your terminal settings. Menus are organized in a hierarchy. The menu options provide access to the sub-menu.
- The context sensitive menu (when the context sensitive icon is on): This function allows you to view a list of items for the current menu.

Soft Keys

To select the options displayed on the screen, press the soft key.

Locking or Unlocking Keys

Press the Menu button, and then the * button.

Unlocking the Terminal

Enter the unlock code at the prompt.

NOTE: The default unlock code is "0000". Ask your service provider if the default code is changed when receiving your terminal.

Selecting Trunked or Direct Mode Operation

From the Home screen, press Options, and then select Trunked Mode or Direct Mode.

Selecting Gateway or Repeater Mode Operation

In Gateway Mode, your terminal connects DMO and TMO.

In Repeater Mode, your terminal extends the DMO range by enhancing the received information.

1. From the Home Screen, press the Options button.
2. Select either Gateway Mode or Repeater Mode.

Sending a New Message

1. Press the Menu button and select Messages > New Message.
2. Enter your message.
3. Select a contact to send your message.
4. Select Send or press the Send key.

Indication

Sending Status Messages

1. Select a group.
2. Press the Menu button and select Messages > Send Status.
3. Select a status and press the Send key or PTT button.

Making TMO or DMO Group Calls

1. Select TMO or DMO mode.
2. From the Home screen, select a group and press Select.

3. Press and hold the PTT button.
4. Release the PTT button to listen.

Making TMO or DMO Emergency Group Calls

1. Select a TMO or DMO mode.
2. Press and hold the emergency button.
3. Press and hold the PTT button.
4. Release the PTT button to listen.

NOTE: If you are using the Hot Mic feature, wait for the Emgcy Mic On message to appear on the display and talk without pressing the PTT button.

5. To exit Emergency Mode, press and hold the Exit soft key.

Making Simplex Private Calls

1. From the Home screen, dial a number.
2. Press and release the PTT button.
3. When the receipient answers, wait for their response to finish.
4. Press the end End key to terminate the call.

Making Duplex Private Call/Phone/PABX Calls

1. From the Home screen, press and release the Send key.
2. When the ringing sounds, the called party answers.
3. Press the End Key to terminate the call.

LED Status Indicator

Indication	Status
Solid green	<ul style="list-style-type: none"> • In use • Repeating call • Control head update, downgrade, or language change successful
Blinking green	<ul style="list-style-type: none"> • In service or idle • Switching modes from TMO to DM0
Solid red	<ul style="list-style-type: none"> • Out of service • Radio checks for software update (OTAP over Wi-Fi) failed • Failure or error detected during control head programming
Blinking red	<ul style="list-style-type: none"> • Connecting to a network • Switching modes from DM0 to TMO
Solid orange	<ul style="list-style-type: none"> • Radio is powering on • Transmit inhibit mode in service • Channel busy in DM0 • Radio interference in DM0
Blinking orange	<ul style="list-style-type: none"> • Incoming call • Programming control head
No indication	<ul style="list-style-type: none"> • Radio powered down
Red and orange interchanging	<ul style="list-style-type: none"> • Radio does not detect Certificate Enrollment

More Information on the Radio

Visit the Motorola Solutions web site or scan the QR code: <http://www.motorolasolutions.com/>



Learning Experience Portal User documentation available at: <https://learning.motorolasolutions.com/>

Open Source Software Legal Notices

Available in Integrated Terminal Management (iTM)



This document is copyright protected. Duplications for the purpose of the use of Motorola Solutions products are permitted to an appropriate extent. Duplications for other purposes, changes, additions or other processing of this document are not permitted.

Only this electronically-saved document is considered to be the original. Duplications are considered merely copies. Motorola Solutions, Inc., and its subsidiaries and affiliates do not vouch for the correctness of such kinds of copies.

MOTOROLA, MOTO, MOTOROLA SOLUTIONS and the Stylized M Logo are trademarks or registered trademarks of Motorola Trademark Holdings, LLC and are used under license.

The Bluetooth® word mark and logos are registered trademarks owned by the Bluetooth SIG, Inc. and are used

under license. All other trademarks are the property of their respective owners.
© 2024 Motorola Solutions, Inc. All rights reserved.



Printed in
MXM600 QUICK START GUIDE

MN009995A01-AA



Documents / Resources

	MOTOROLA SOLUTIONS MXM600 Mobile Radio [pdf] User Guide MN009995A01_AA, MXM600, MXM600 Mobile Radio, MXM600, Mobile Radio, Radio
---	---

References

- [Anatel — Agência Nacional de Telecomunicações](#)
- [User Manual](#)

[Manuals+](#), [Privacy Policy](#)

This website is an independent publication and is neither affiliated with nor endorsed by any of the trademark owners. The "Bluetooth®" word mark and logos are registered trademarks owned by Bluetooth SIG, Inc. The "Wi-Fi®" word mark and logos are registered trademarks owned by the Wi-Fi Alliance. Any use of these marks on this website does not imply any affiliation with or endorsement.