



MOTOROLA SOLUTIONS 1021 Vari Focal Dome Network Camera Installation Guide

[Home](#) » [Motorola Solutions](#) » [MOTOROLA SOLUTIONS 1021 Vari Focal Dome Network Camera Installation Guide](#) 



AVIGILON™



Contents

- [1 1021 Vari Focal Dome Network Camera](#)
- [2 Documents / Resources](#)
 - [2.1 References](#)

1021 Vari Focal Dome Network Camera

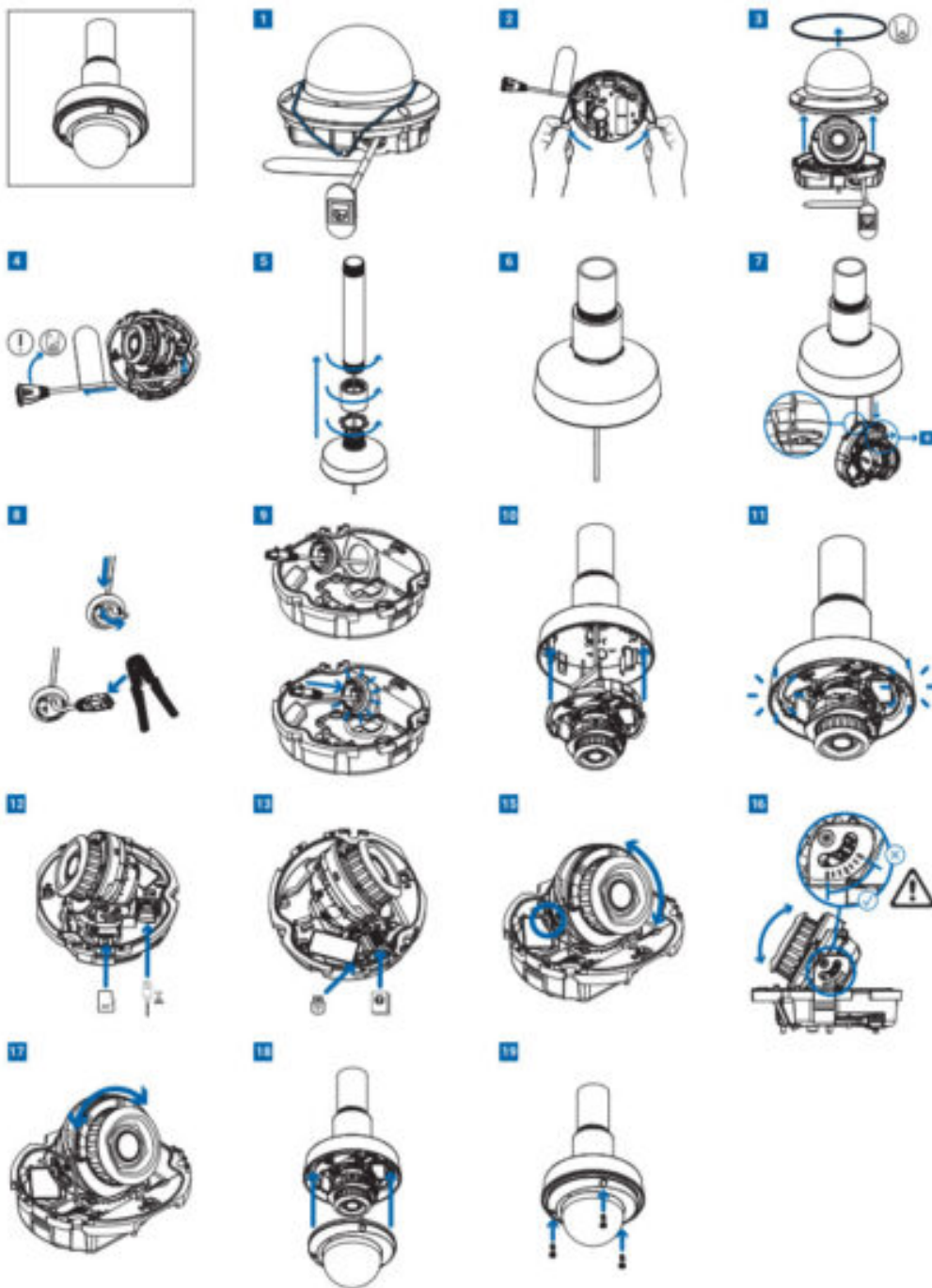



©2024 Avigilon Corporation. All rights reserved. AVIGILON and the AVIGILON logo are trademarks of Avigilon Corporation. MOTOROLA, MOTO, MOTOROLA SOLUTIONS, and the Stylized M Logo are trademarks or registered trademarks of Motorola Trademark Holdings, LLC and are used under license. Unless stated explicitly and in writing, no license is granted with respect to any copyright, industrial design, trademark, patent or other intellectual property rights of Avigilon Corporation or its licensors. Covered by one or more claims of the patents listed at patentlist.





<https://motr.la/pelco-psti-declaration?r=qr>

920-0433A – Rev 3

Documents / Resources

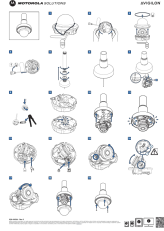
	<p>MOTOROLA SOLUTIONS 1021 Vari Focal Dome Network Camera [pdf] Installation Guide 1021, 1021, 1021 Vari Focal Dome Network Camera, 1021, Vari Focal Dome Network Camera, Dome Network Camera, Network Camera</p>
---	--

References

- [User Manual](#)

Manuals+, Privacy Policy

This website is an independent publication and is neither affiliated with nor endorsed by any of the trademark owners. The "Bluetooth®" word mark and logos are registered trademarks owned by Bluetooth SIG, Inc. The "Wi-Fi®" word mark and logos are registered trademarks owned by the Wi-Fi Alliance. Any use of these marks on this website does not imply any affiliation with or endorsement.