



motogadget mo.switch pro High Quality Handlebar Armature with 6 Illuminated Buttons Instruction Manual

[Home](#) » [motogadget](#) » motogadget mo.switch pro High Quality Handlebar Armature with 6 Illuminated Buttons Instruction Manual 

motogadget mo.switch pro High Quality Handlebar Armature with 6 Illuminated Buttons



Contents

- [1 Thank you!](#)
- [2 Review of Delivery](#)
- [3 Exclusion of Liability](#)
 - [3.1 Safety Instructions](#)
- [4 Setup](#)
- [5 Installation](#)
- [6 Mounting and Wiring](#)
- [7 Declaration of Conformity](#)
- [8 Documents / Resources](#)
- [9 Related Posts](#)

Thank you!

Thank you very much for purchasing a high quality motogadget product – Made in Germany.

Please read the following information and recommendations thoroughly and follow these instructions during installations and use of the product. No liability shall be assumed by motogadget for damage or defects resulting from negligence or failure to follow the operating and

Review of Delivery

All products from motogadget are thoroughly checked to ensure they are completely fault-free when dispatched. Please check the received goods immediately for possible transport damage. If you find any damage or other

deficiencies, please contact us immediately.

In this regard, we refer to our General Terms of Business and Delivery, which are published at www.motogadget.com. Should a return of the received delivery be agreed, please note that we only take back goods in their original packaging. The mo.switch and its accessories must be returned within the legal period of time and without any traces of use. We shall not assume any liability for returns which are insufficiently insured or packed.

Exclusion of Liability

THE DEVICE AND ITS ACCESSORIES MUST BE INSTALLED BY A CERTIFIED MOTORCYCLE TECHNICIAN AND IN AN AUTHORIZED SERVICE CENTER. MOTOGADGET ACCEPTS NO LIABILITY FOR DIRECT OR INDIRECT DAMAGE OR SUBSEQUENT DAMAGE OF ANY KIND RESULTING FROM THE USE, INSTALLATION OR CONNECTION OF THE DEVICE OR OTHER DELIVERED EQUIPMENT. THIS EXCLUSION OF LIABILITY PARTICULARLY INCLUDES DAMAGE TO PERSONS, MATERIAL LOSSES AND FINANCIAL DAMAGES. THE USE IN AREAS OF PUBLIC TRAFFIC ENSUES AT THE USER'S OWN RISK. THE USE OF THE DELIVERED DEVICE AND ITS ACCESSORIES FOR RACING OR OTHER COMPETITIONS AS WELL AS FOR ANY USE NOT CORRESPONDING TO THE RECOMMENDED APPLICATION ALL WARRANTY CLAIMS SHALL BE INVALID.

Safety Instructions

- THE VEHICLE BATTERY MUST BE COMPLETELY DISCONNECTED PRIOR TO ANY WORK ON THE VEHICLE'S ELECTRICAL SYSTEM. FIRST, DISCONNECT THE NEGATIVE TERMINAL AND THEN THE POSITIVE TERMINAL. FOR RECONNECTION PROCEED IN THE REVERSE ORDER
- USING THE MO.SWITCH WITH PLUS POLE CONNECTED TO VEHICLE FRAME (OLDER ENGLISH MOTORCYCLES) IS NOT POSSIBLE.
- INSTALLATION AND ELECTRICAL CONNECTION OF THE MO.UNIT MAY ONLY BE CARRIED OUT BY A CERTIFIED MOTORCYCLE TECHNICIAN.
- ALL CABLE DIAMETERS MUST BE DIMENSIONED ACCORDING TO THE CURRENT FLOW
- ALL ELECTRICAL CONNECTIONS IN THE WIRING LOOM AND AT THE CONNECTION TERMINALS HAVE TO BE CARRIED OUT PROFESSIONALLY. FAILURES AT CONNECTING JOINTS MAY CAUSE A CONTACT RESISTANCE AND LEAD TO HEAT GENERATION DURING HIGH CURRENT FLOW. THERE IS A RISK OF SERIOUS OR LETHAL INJURIES.

Setup

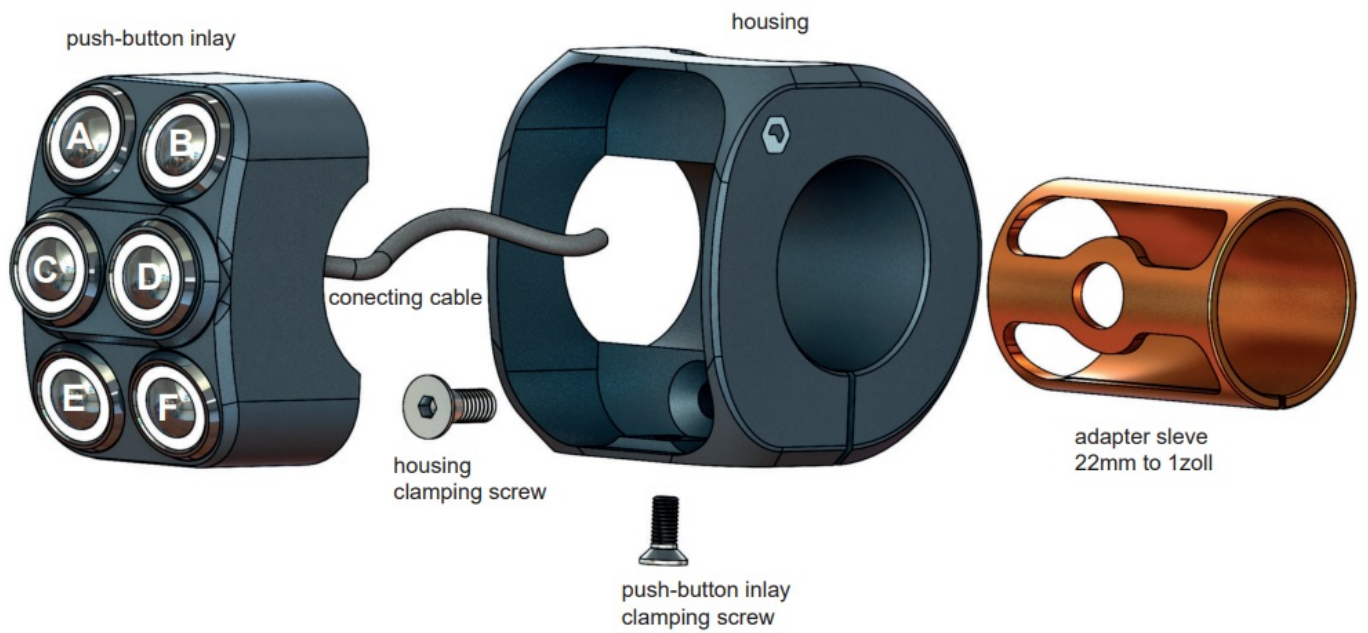

Installation

Mount all handlebar attachments and finalize their position.

Clamp mo.switch pro housing to handlebar.

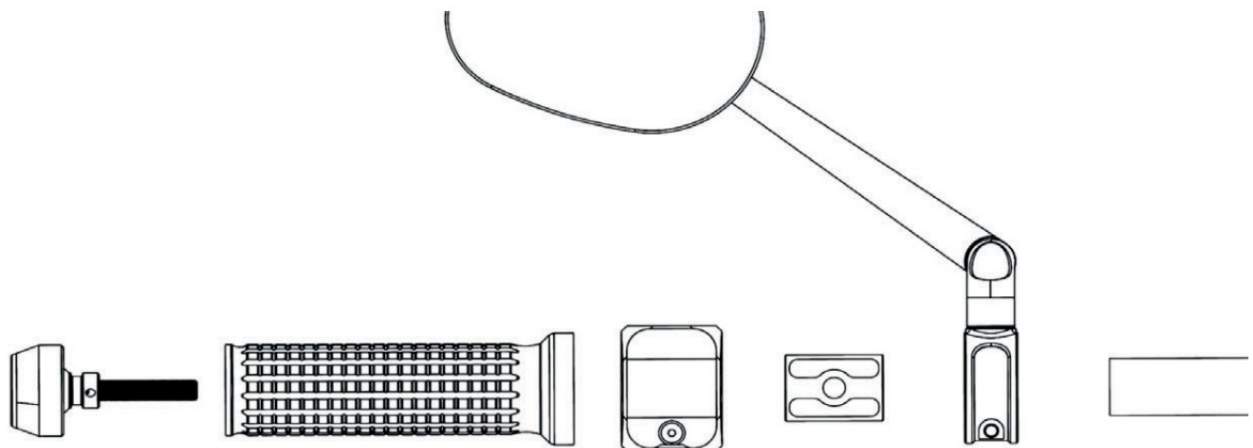

Drill 3 holes with 5mm diameter into the handlebar. Deburr the holes inside and outside carefully

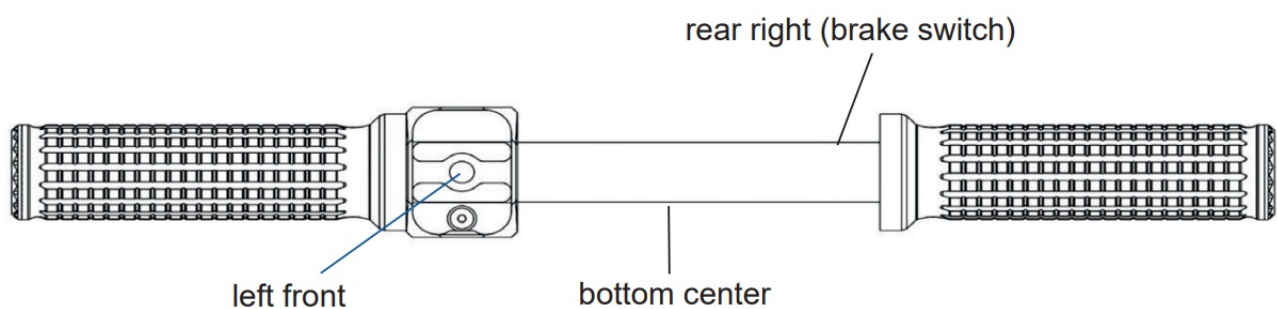

Mounting and Wiring

Guide the mo.switch connection cable through the handlebar hole at the clamping point and then through the second, central handlebar hole. Clamp the housing to the handlebar with the clamping screw. Carefully insert the push-button inlay into the housing and pull the cable piece by piece. Fasten the inserted push-button inlay to the housing with the supplied countersunk screw. Lay the connecting cable from the handlebars on the vehicle to the mo.unit without pulling or kinking.

The individual wires are connected as follows:

black – vehicle ground

red – terminal 15 (switched +12V), or AUX1 or AUX2 of the mo.unit

yellow – button **A**, switches to ground, connect to mo.unit input **LIGHT**

brown – button **B**, switches to ground, connect to mo.unit input **HORN**

white – button **C**, switches to ground, connect to mo.unit input **Turn L**

orange – button **D**, switches to ground, connect to mo.unit input **Turn R**

green – button **E**, switches to ground, connect to instrument input **Menu**

blue – button **F**, switches to ground, connect to mo.unit input **START**

Declaration of Conformity

Hereby, motogadget GmbH declares the product is in compliance to EU directives.

The full text of the EU Declaration of Conformity is available at the following internet address:

<https://manuals.motogadget.com/mo-switch-pro>



contact:

motogadget GmbH
Wollenberger Str. 4i/j
13053 Berlin – Germany

Tel. +49 (0)30-6900410-0



motogadget.com

info@motogadget.de

Copyright © 2023 motogadget GmbH, Berlin.
motogadget are registered trademarks of
motogadget GmbH, Berlin, Germany



Documents / Resources

 <small>Instruction Manual REV 04/2017 (21)</small> 	motogadget mo.switch pro High Quality Handlebar Armature with 6 Illuminated Buttons [pdf] Instruction Manual mo.switch pro, High Quality Handlebar Armature with 6 Illuminated Buttons, mo.switch pro High Quality Handlebar Armature with 6 Illuminated Buttons, mo.switch pro High Quality Handlebar Armature, High Quality Handlebar Armature, Handlebar Armature, Armature
--	---