



# motionics BlueAngle Wireless Rotor Runout Kit User Guide

[Home](#) » [motionics](#) » motionics BlueAngle Wireless Rotor Runout Kit User Guide 

## Contents

- [1 BlueAngle Wireless Rotor Runout Kit](#)
- [2 Description](#)
- [3 Included in the box](#)
- [4 Quick Start](#)
- [5 Documents / Resources](#)
  - [5.1 References](#)

## BlueAngle Wireless Rotor Runout Kit



## Important Notes

- Turn off BlueDial (1 and 6) and BlueAngle (9) after use. It will NOT turn off automatically.
- Do NOT open the device. Opening causes permanent damage and voids the warranty.
- BlueDial transmitter & digital indicator should be both on before pairing.

BlueDial operates on two separate batteries:

- 1) Rechargeable built-in Li-Po battery for the Bluetooth transmitter
- 2) Coin SR44 or LR44 battery for the digital dial

## Description



1. Dial On/Off – press to turn dial on/off
2. Origin Button – press to zero dial reading; this can also be done in the App
3. Unit Button – select reading in inch/mm
4. SPC Output – SPC data output port
5. Dial Battery – insert coin battery SR44 or LR44 for digital dial
6. BLE On/Off – press to turn Bluetooth transmitter on/off
7. Status LED



– Bluetooth transmitter is on



– BlueDial is in charge



– BlueDial is fully charged

8. Micro USB Port – connect to USB cable to charge BlueDial



9. On/Off Button – press to turn sensor on/off
10. Micro USB Port – connect to USB cable to charge BlueAngle
11. Status LED



– BlueAngle is on



– BlueAngle is in charge



– BlueAngle is fully charged

## Included in the box

- BlueDial 1X
- Bluetooth Angle Sensor BlueAngle 1X
- USB Charging Cable 1X
- USB Power Adapter 1X
- User Guide 1X

## Quick Start

1. Turn on both digital indicator and Bluetooth transmitter of BlueDial. Turn on BlueAngle. Pair gages in the App.

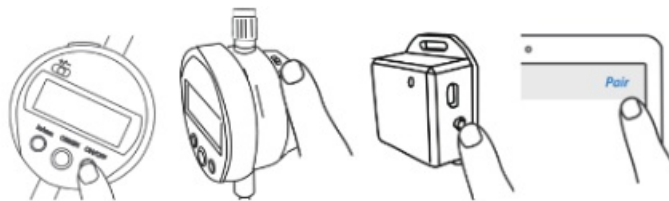

2. Attach BlueDial and BlueAngle to the testing shaft. Select the right angle on the Setting page. Enter the number of testing points.

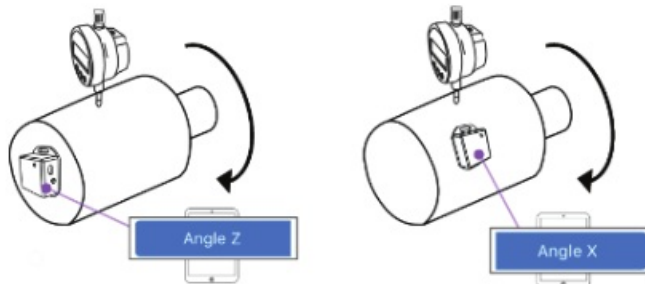

3. Start testing session. Rotate the shaft until all dash lines on the angle indicator become solid green lines.

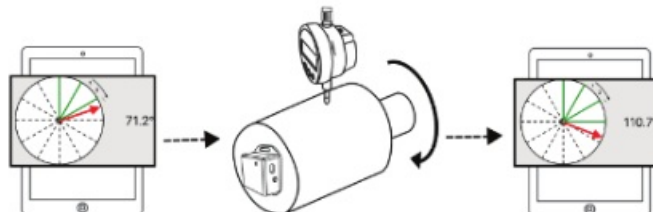

4. Move BlueDial to the next testing location, tap Add a plane button to start test for the next plane.

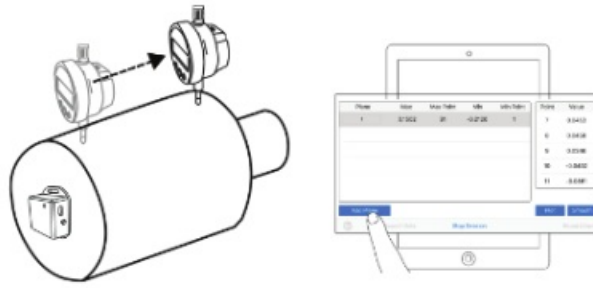

**LIVETEST**  
GET OUT OF THE LINE OF FIRE

[www.livetest.com.au](http://www.livetest.com.au)

02 4017 0198

[sales@livetest.com.au](mailto:sales@livetest.com.au)

115 Young St Carrington NSW 2294

## Documents / Resources



[motionics BlueAngle Wireless Rotor Runout Kit \[pdf\] User Guide](#)

BlueAngle Wireless Rotor Runout Kit, BlueAngle, Wireless Rotor Runout Kit, Rotor Runout Kit, Runout Kit, Kit

## References

- [User Manual](#)

[Manuals+](#), [Privacy Policy](#)

This website is an independent publication and is neither affiliated with nor endorsed by any of the trademark owners. The "Bluetooth®" word mark and logos are registered trademarks owned by Bluetooth SIG, Inc. The "Wi-Fi®" word mark and logos are registered trademarks owned by the Wi-Fi Alliance. Any use of these marks on this website does not imply any affiliation with or endorsement.