



MORWIN KY-2020D 2.0 Channel Bluetooth Sound Bar User Guide

[Home](#) » [MORWIN](#) » MORWIN KY-2020D 2.0 Channel Bluetooth Sound Bar User Guide

Contents [[hide](#)]

- [1 MORWIN KY-2020D 2.0 Channel Bluetooth Sound Bar](#)
- [2 Features and accessories](#)
- [3 Safety Instructions](#)
- [4 Installation](#)
- [5 Powering ON](#)
- [6 Indicator status](#)
- [7 Remote control key description](#)
- [8 Body button description](#)
- [9 HDMI sockets](#)
- [10 OPT sockets](#)
- [11 AUX sockets](#)
- [12 Bluetooth function](#)
- [13 Troubleshooting](#)
- [14 Technical data](#)
- [15 Cleaning and Maintenance](#)
- [16 Combination docking installation](#)
- [17 Documents / Resources](#)
- [18 Related Posts](#)



MORWIN KY-2020D 2.0 Channel Bluetooth Sound Bar



If there is an unsolvable problem with the equipment you purchased, . please contact our customer service

www.morwintech.com

support@morwintech.com

Features and accessories

Before getting started, ensure the package contains the following components:

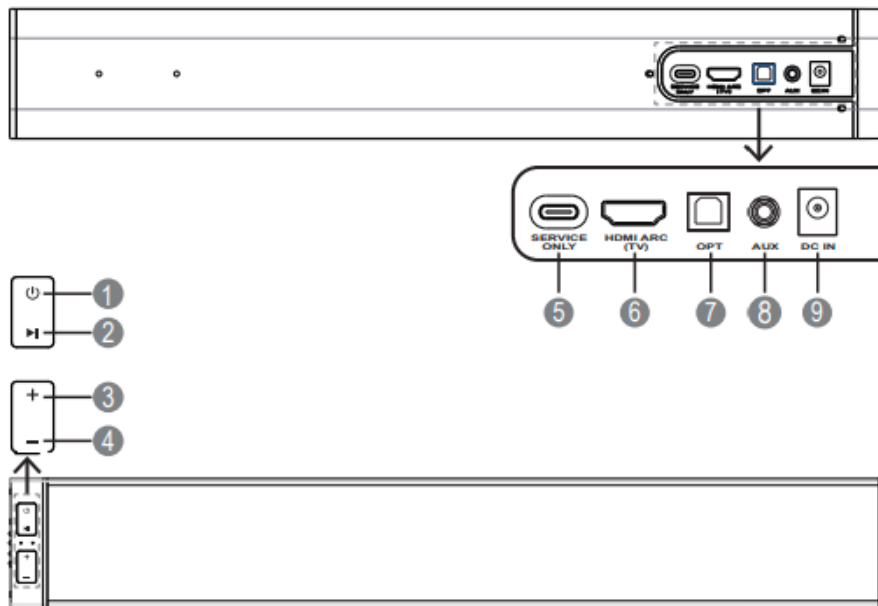

1. Power button
2. Play / Pause button
3. Volume + / Previous button
4. Volume – / Next button
5. SERVICE ONLY socket
6. HDMI ARC(TV) socket
7. OPT socket
8. AUX socket
9. DC IN socket

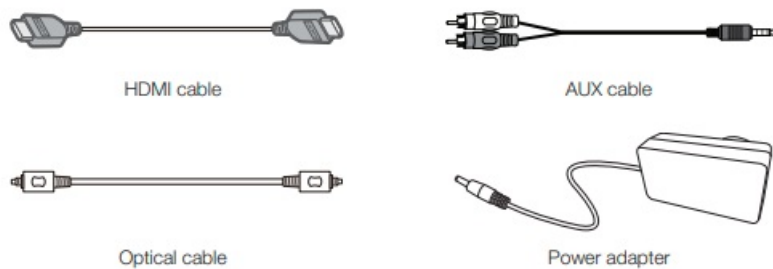
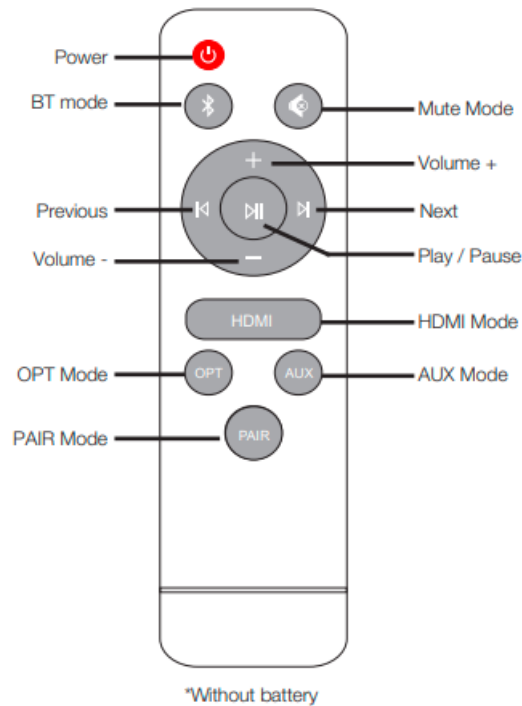

Safety Instructions

1. Follow all safety instructions!
2. Keep the user manual for further use.
3. Before connecting the appliance to the main power supply, check that the power supply voltage and current rating corresponds with the power supply details shown on the appliance rating label.
4. Never use an appliance that is damaged! Disconnect the appliance from the power supply contact your supplier if it is damaged.
5. **Danger of electric shock!** Never try to repair the appliance yourself. In the event of any malfunction, repairs are to be conducted by qualified personnel only.
6. **Warning!** The appliance should not be used near water. Do not operate the appliance with wet hands or while standing on a wet floor.
7. Do not open the appliance casing under any circumstances. Do not insert any foreign objects into the inside of the casing.
8. Never use accessories which are not recommended by the manufacturer. They could pose a safety risk to the user and might damage the appliance. You must therefore use original accessories only.
9. The appliance is only suitable for use at moderate degrees of latitude. Do not use in the tropics or in

particularly humid climates.

10. Keep the appliance away from any hot surfaces and open flames. Always operate the appliance on a level, stable, clean and dry surface. Protect the appliance against heat and cold, dust, direct sunlight, moisture, dripping and splashing water.
11. This appliance is not intended for use by persons (including children) with reduced physical, sensory, or mental capabilities, or by those who lack experience and knowledge, unless they have been given supervision and instruction concerning the use of the appliance by a person responsible for their safety.
12. Children should be supervised to ensure that they do not play with the appliance.
13. This appliance is classified as protection class II and must not be connected to a protective ground.
14. Regularly check the power plug and power cord for damage. If the supply cord is damaged, the adapter cannot be used and need to be replaced.
15. Avoid damage to the power cord. Do not crush, squeeze, bend, or scour on sharp edges. Keep the power cord away from hot surfaces and naked flames.
16. Lay the cables in such a way that nobody can inadvertently pull them or trip over them.
17. Do not pull the plug out of the socket by the power cord, and do not wrap the power cord around the appliance.
18. If an extension cord is used, its capacity needs to be suitable for the power consumed by the appliance.
19. Connect the power adapter to an easily reachable electrical outlet so that in case of an emergency the appliance can be unplugged immediately. Pull the power adapter out of the electrical outlet to completely switch off the appliance. Use the power adapter as the disconnection device.
20. Disconnect the power adapter from the electrical outlet when not in use and before cleaning.
21. Always switch the appliance off before disconnecting the power adapter.
22. Only use this product with the supplied power adapter.
23. Attention! In the event of a malfunction as a result of electrostatic discharge and momentary electrical surges, unplug the appliance and plug it in again.
24. Make sure that no electrical wires, water, gas or other lines are located around the installation location.
25. Ensure that there is sufficient ventilation. Keep a minimum distance of 4 inches (10 cm) between the appliance and other objects or walls.

Battery safety instructions

26. Do not expose batteries to extreme temperatures, like direct sunlight or fire.
27. Do not place the remote control on any heat source. Leaking battery acid may cause harm.
28. Always insert batteries correctly with regard to the polarities (+ and –) marked on the battery and the battery compartment.
29. **Caution!** Danger of explosion if batteries are incorrectly replaced.
30. Replace batteries only with the same or equivalent type.
31. If batteries should leak, remove them with a cloth from the battery compartment.
32. Dispose of batteries according to the regulations. If battery acid has leaked avoid contact to skin, eyes and mucous membranes. Rinse affected areas immediately after contact with the acid and wash with plenty of clean water. Visit a physician.
33. Do not allow children to replace batteries without adult supervision.
34. Batteries shall be stored in well-ventilated, dry and cool conditions.
35. Remove the batteries if you will not be using the appliance for an extended period of time.
36. **Danger of explosion!** The battery may not be disassembled, thrown into fire, or short-circuited.

Installation

Unpacking

- Remove all packaging.
- Check for the presence of all parts and for transport damage. In case of damage or incomplete delivery, please contact your dealer.

Please keep the packaging. The appliance can be stored in it, if not used for a longer period of time.

Intended use

The appliance serves as an audio output device and features wireless or wired connection.

Preparation

You can place the sound bar on a horizontal surface or mount it on a wall. When mounting it on a wall, pay attention to the following: The supplied wall mount brackets can be used to fix the sound bar to a wall. The wall mount brackets are designed for use on vertical walls constructed of solid concrete or bricks.

- When installing on a cinderblock wall, first verify that the blocks have a minimum of 1 inch (2.5 of actual concrete wall thickness to be used for the wall plugs.
- If you are uncertain about the construction of your wall, please consult a qualified contractor or installer for assistance.
- Ensure that the screws you use are strong enough to support the weight of the sound bar and long enough to sufficiently grip the wall.
- Additional tools (not included) are required for the installation.
- Do not overtighten screws.
- Use an electronic stud finder to check the wall type before drilling and mounting.
- During mounting, keep away children and pets.
- Make sure the sound bar is mounted in reach of a wall outlet.

Powering ON

The instructions below provide simple steps to help you power on your soundbar.

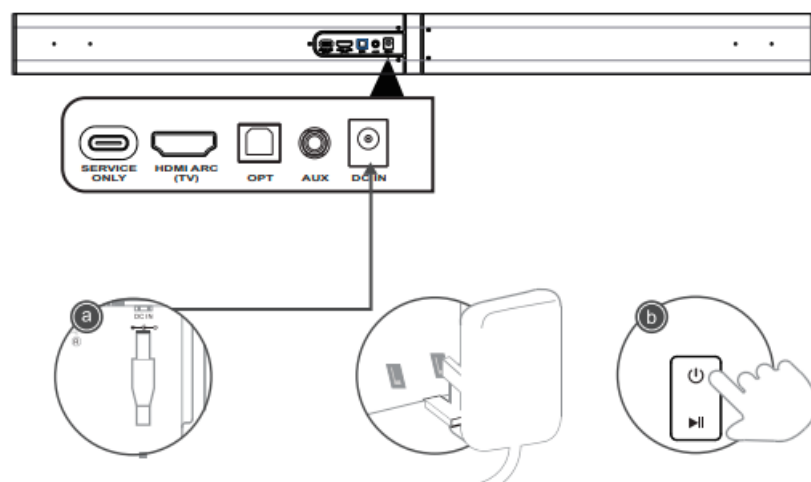

1. With the power supply connected, please insert the main adapter plug into the rear of the unit, then the LED will turn red.
2. long press power button 2 seconds to turn on, long press power button 2 seconds to turn off. Short press to switch modes. (BT-HDMI-AUX-OPT-BT)

Indicator status

Mode	Status
AUX Mode	White indicator light is always on
Bluetooth Mode	The blue light flashes 0.3S in the disconnected state The blue light is always on when the Bluetooth connection is
OPT Mode	Green indicator light is always on
HDMI Mode	Orange indicator light is always on

Remote control key description



Short press to switch on or off.



HDMI OPT AUX — Short press this key to switch to the corresponding mode.

PAIR

In Bluetooth mode, long press to enter the pairing state, short press to connect to the last connected device.

Short press to increase the volume step by step. Long press to continue the volume increase.



Short press to decrease the volume step by step Long press to decrease the volume continuously.



Short press previous song (in Bluetooth mode).



Short press next song (in Bluetooth mode).



In Bluetooth mode, short press to alternate playback and pause (keys are invalid in other modes).



In any mode, short press this button to mute the speaker, and press again to unmute.

Body button description



- ⏻ Short press to turn on, long press for 2 seconds to turn off. Short press to switch modes.(BT-HDMI-AUX-OPT-BT)
- ⏮ In Bluetooth mode, short press to play/pause songs in turn.
- ⏭ Short press to increase the volume step by step, long press the previous song
- ⏪ Short press to decrease the volume step by step, long press to switch to the next song

HDMI sockets

1. On the remote control, press to power on the soundbar, press the HDIM button until the Orange indicator light is on.
 2. Connect the device to the soundbar using the HDMI cable delivered by HDMI, as shown.
 3. When the device plays music, the soundbar will make the corresponding sound.
- This product only supports TVs with HDMI ARC output.

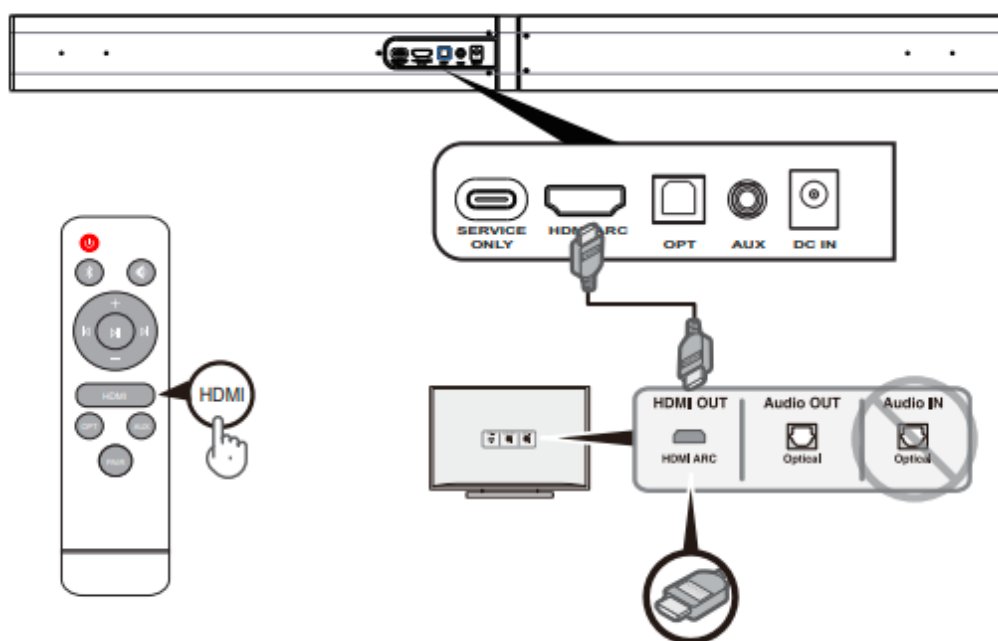

Why is the sound very small or why is the sound distorted? Please go over the following:

- Different devices output different sound effects: the sound of phone will be lower than television and it will be distorted if you connect with computer.
- Check to make sure the audio cables are correctly connected.

OPT sockets

If your TV has optical audio out, use the optical cable to connect the soundbar to your TV.

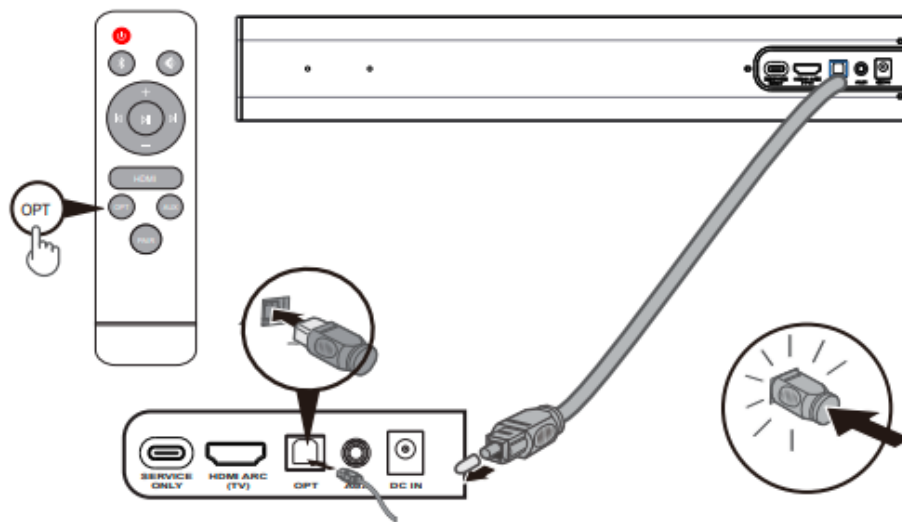

1. On the remote control, press to power on the soundbar, press the OPT button until the green indicator light is on.
2. Insert one end of the optical cable into your TV's Optical OUT connector.
3. Align the plug with the soundbar's OPTICAL IN connector and insert the plug carefully.
4. Firmly push the plug into the connector until you hear or feel a click.

CAUTION: Make sure you have removed the protective cap from both ends of the optical cable. Inserting the plug in the wrong orientation can damage the plug and the connector.

AUX sockets

1. On the remote control, press to power on the soundbar, press the AUX button until the white indicator light is on.
2. Connect the device to the soundbar using the line in cable delivered by RCA&3.5mm, as shown.
3. When the device plays music, the soundbar will make the corresponding sound.

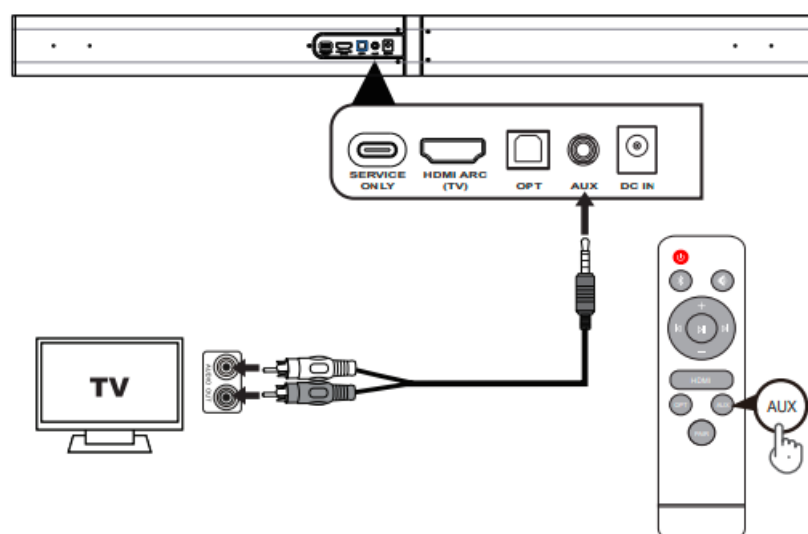

Why is the sound very small or why is the sound distorted? Please go over the following:

- Different devices output different sound effects: the sound of phone will be lower than television and it will be distorted if you connect with computer.
- Check to make sure the audio cables are correctly connected.

Bluetooth function

External Bluetooth devices can be connected to the appliance via Bluetooth connection.

1. Press the bluetooth button to enter the Bluetooth mode. The Bluetooth indicator lights up.
2. Activate the Bluetooth function of the external device and search for Bluetooth devices.
3. Select KY-2020 from the Bluetooth device list.
4. Follow the instructions shown on your device's screen.
5. When the Bluetooth connection is established, files from your connected Bluetooth device will be played through the sound bar.

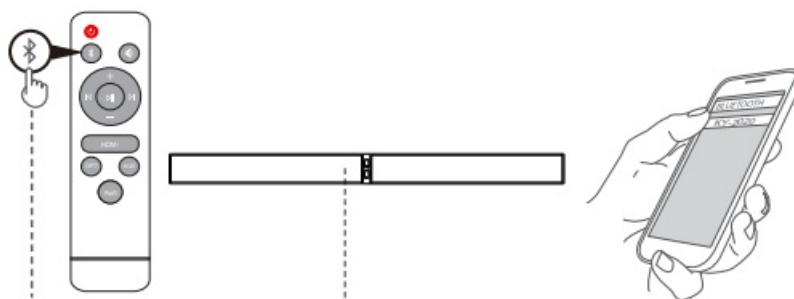

Disconnecting from the Bluetooth device:

- Press power button to enter HDMI, AUX or OPT mode.
- Press and hold the **pair** button for about 3 seconds. The current Bluetooth connection is disconnected and the sound bar starts searching for another Bluetooth device.

Notes:

- Bluetooth works best within a range of up to 30 feet (10 meters).
- The music streaming may be interrupted by obstacles between the Bluetooth device and sound bar, such as walls, metallic casing that covers the device, or other devices nearby that operate in the same frequency.
- If the connected device goes out of Bluetooth range, the appliance will reconnect automatically when the device comes back within range.

Troubleshooting

Problem	Solution
---------	----------

No power	<ul style="list-style-type: none"> – Check the power adapter is properly connected to an electrical outlet. – Check the DC plug is properly connected to the DC IN socket. – Unplug the power adapter for at least one minute and reconnect.
----------	---

No Sound	<ul style="list-style-type: none"> – Press the Power button on the sound bar or remote control to turn on the sound bar. The power indicator lights up green. – Press MUTE button on the remote control to restore sound. – Ensure that the source device has correct volume settings and is playing a track. – Ensure the correct source device is selected. – Plug the audio cable into a connector on your TV labeled Line OUT or Audio OUT, not Line IN or Audio IN. <p>Digital audio (SPDIF) connection:</p> <ul style="list-style-type: none"> – Plug the optical cable into a connector on your TV labeled Optical OUT or Digital OUT, not Optical IN or Digital IN. – Plug the RCA cable into a connector on your TV labeled Coaxial OUT or Digital OUT, not Coaxial IN or Digital IN. – Activate PCM(Pulse Code Modulation)in the audio settings menu of your source device(see your source device's user manual). <p>– Connect to the headphone socket of TV:</p> <ul style="list-style-type: none"> – Increase your TV's volume to maximum. – Turn on your TV speakers, Refer to your TV's user manual for more information.
----------	---

Poor audio quality	<ul style="list-style-type: none"> – Press the movie, music or news button on the remote control to select a suitable sound mode. – Set the volume of the sound bar to 75 percent of maximum Note: the maximum volume drop 3 levels is 75 percent . – Secure cable connections on the sound bar and TV (or other connected sources). – Try with different source devices. If the problem still exists, check the cable connections. – Ensure that the cables connected to the source devices are correctly plugged in and the plugs are fully inserted.
--------------------	--

Problem	Solution
---------	----------

Poor audio quality	<ul style="list-style-type: none"> – Reduce the volume of your source device. <p>Audio cable connection:</p> <ul style="list-style-type: none"> – Double clicking the boost button on the remote control to restore the volume. <p>Bluetooth connection:</p> <ul style="list-style-type: none"> – Bring the Bluetooth device closer to the sound bar and make sure that no obstacles are disturbing the connection.
--------------------	--

Remote control does not work	<ul style="list-style-type: none"> – Ensure that the batteries are correctly inserted; if necessary, replace the batteries. – Bring the remote control closer to the sound bar and make sure there are no obstacles in between. Ensure the remote control is within 16.5 feet (5 meters) of the system. – Aim the remote control directly at the infrared receiver of the system.
------------------------------	--

System doesn't react	<ul style="list-style-type: none"> – It is malfunction probably due to electrostatic discharge. – Unplug the power adapter for at least one minute and reconnect.
----------------------	---

	<ul style="list-style-type: none"> – Bring the Bluetooth device closer to the sound bar.
	<ul style="list-style-type: none"> – Switch off your device and/or sound bar, then back on, repeat the pairing process.
	<ul style="list-style-type: none"> – Make sure the sound bar is not connected another Bluetooth device.
	<ul style="list-style-type: none"> – Make sure that you have selected Sine Audio from the Bluetooth device list on your device.
Bluetooth device cannot be connected to the sound bar	<ul style="list-style-type: none"> – Ensure you are using the correct device. <p>If the device is still not connected, try the following:</p> <ul style="list-style-type: none"> – Remove the sound bar (Sine Audio) from the list of “paired devices” on your phone/tablet. – Turn the sound bar off and then on again. <p>Pair it again with your phone/tablet. It should now successfully establish the</p>
	pairing.
	Note: If none of the above solutions works, the Bluetooth device may be
	malfunctioning. Try another Bluetooth device. If not even the new device can be
	connected, the sound bar may be malfunctioning. In this case, please consult
	your dealer for repair.

Technical data

Power supply

- **Input:** 100 – 240 V~, 50/60 Hz
- **Output:** 15.0 V 2.0 A
- **Remote control:** 2 x 1.5 V AAA batteries (supplied NO)

Sound bar

- **Output power:** 25 W x 2 (50 W)
- **Speaker impedance:** 53mm / 7 Ω
- **Frequency response:** 90 Hz – 20 kHz
- **Signal to noise ratio:** 65 dB
- **Dimensions (W x H x D):** 800 x 60 x 60 mm

Bluetooth

- **Bluetooth version:** 5.0
- **Operating range:** 30 feet (10 meters)

Cleaning and Maintenance

Warning!

- Before cleaning, ensure to switch the appliance off and disconnect the power adapter from the electrical outlet.
- Do not use petrol, alcohol or other abrasive cleansers to clean the exterior.
- Clean the exterior with a lightly damp cloth.
- Do not allow liquids to spill into any openings.
- Use the original packaging if it is necessary to transport the appliance.

FCC Information

This device complies with Part 15 of the FCC Rules. Operation is subject to the following two conditions: (1) this device may not cause harmful interference, and (2) this device must accept any interference received, including interference that may cause undesired operation. the user's authority to operate the equipment.

Note: This equipment has been tested and found to comply with the limits for a Class B digital device, pursuant to Part 15 of the FCC Rules. These limits are designed to provide reasonable protection against harmful interference in a residential installation. This equipment generates, uses, and can radiate radio frequency energy and, if not installed and used in accordance with the instructions, may cause harmful interference to radio communications.

However, there is no guarantee that interference will not occur in a particular installation. If this equipment does cause harmful interference to radio or television reception, which can be determined by turning the equipment off and on, the user is encouraged to try to correct the interference by one or more of the following measures:

- Reorient or relocate the receiving antenna.

- Increase the separation between the equipment and receiver.
- Connect the equipment into an outlet on a circuit different from that to which the receiver is connected.
- Consult the dealer or an experienced radio/TV technician for help.

RF Exposure Information



This equipment complies with FCC radiation exposure limits set forth for an uncontrolled environment. This equipment should be installed and operated with minimum distance 20cm between the radiator and your body.

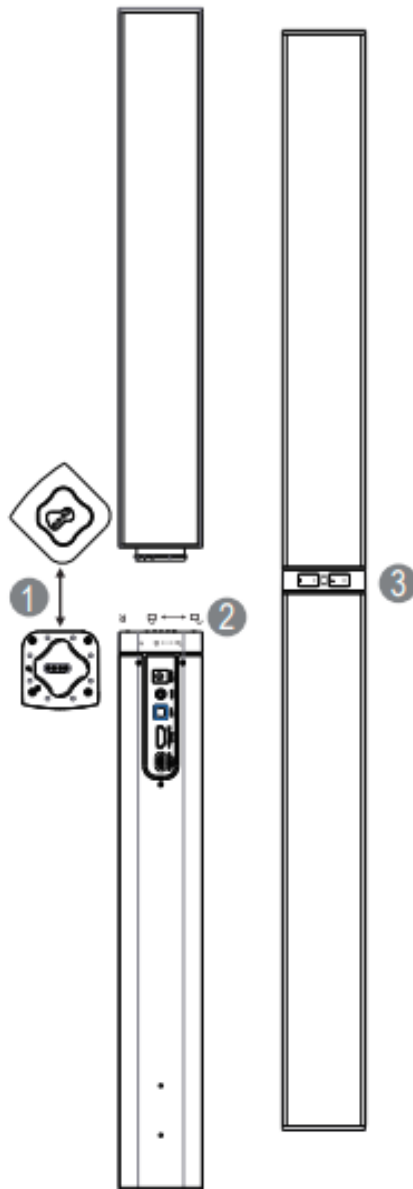

Combination docking installation



Combined installation method:

1. Align one section of the sound bar with the other section as shown in Figure 1,

2. Align the two sound bars and press    R lock and unlock

3.    R Press to lock the two sound bars to complete the combination.

Metal base installation 2

Metal base installation method:

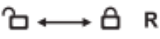
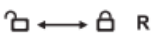
- Align the sound bar with the base as shown in Figure 1,
- Lock and unlock the sound bar and the base according to the  method
- Lock the sound bar and the base according to the  method and the installation is complete.

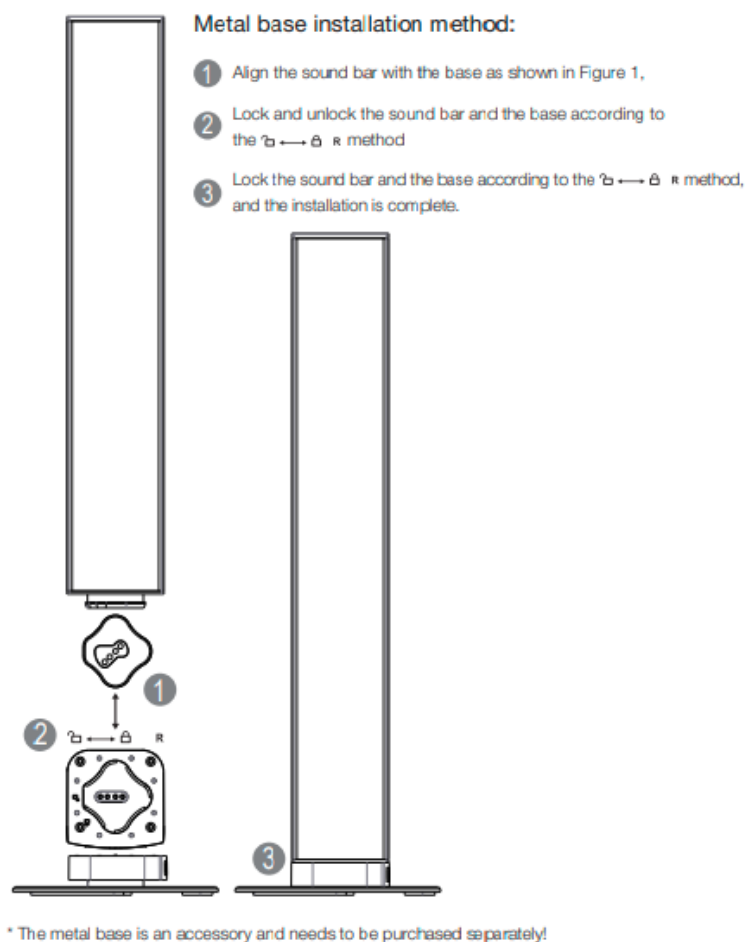

- The metal base is an accessory and needs to be purchased separately!

Metal base installation 3

Metal base installation method:

Connect the two sound bars with the base installed with the connecting wire of the base to complete the vertical assembly.

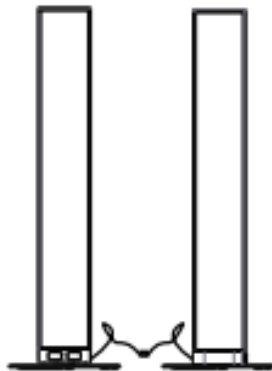

- The metal base is an accessory and needs to be purchased separately!

Wall mounting

- 1 Align the two (plastic wall parts) with the screw holes on the back of the sound bar,
- 2 Use a screwdriver to fix the screws (plastic wall mounts) on both sides of the sound bar,
- 3 Respectively align the 2 (metal wall hanging parts) at the (plastic wall parts) behind the fixed sound bar,
- 4 Use a screwdriver to fix the screws (metal wall hanging parts) on the wall respectively,
- 5 Align the fixed sound bar (plastic wall parts) to the wall of (metal wall hanging parts), The wall-mounted installation is complete.

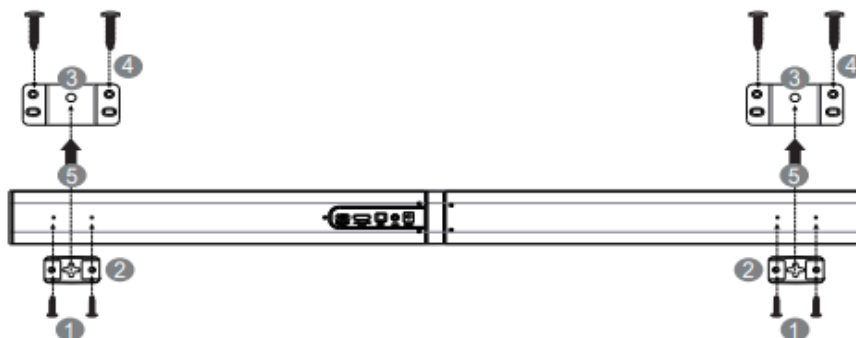

Note:

Wall-mounted accessories (plastic wall-mounted parts/metal wall-mounted parts/screws) are optional accessories and need to be purchased separately!

Documents / Resources

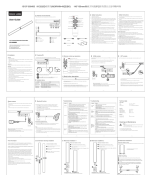

MORWIN KY-2020D 2.0 Channel Bluetooth Sound Bar [pdf] User Guide
KY-2020D, KY2020D, 2AB5T-KY-2020D, 2AB5TKY2020D, KY-2020D 2.0 Channel Bluetooth Sound Bar, KY-2020D, 2.0 Channel Bluetooth Sound Bar