



Morgan MVC-CHS198DB Cordless 3 in 1 Stick-Handheld Vacuum Cleaner User Manual

[Home](#) » [Morgan](#) » Morgan MVC-CHS198DB Cordless 3 in 1 Stick-Handheld Vacuum Cleaner User Manual

Morgan®

USER MANUAL

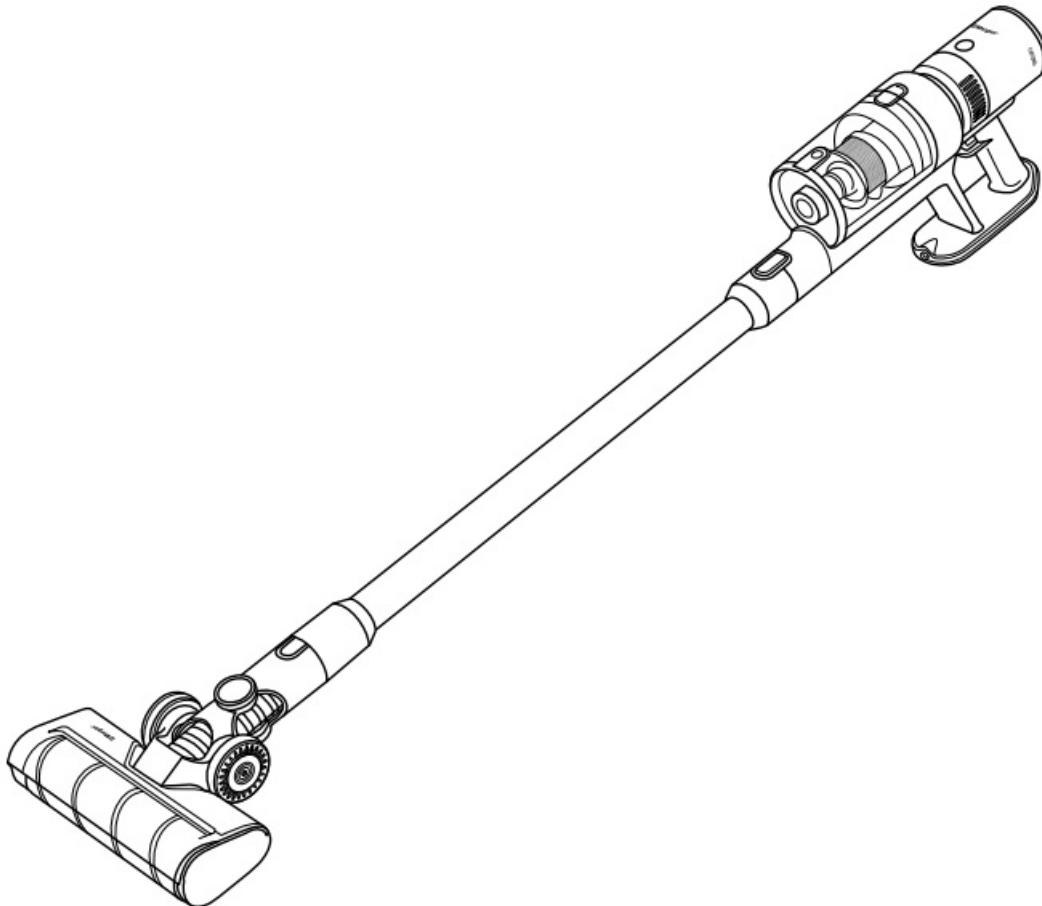

**Cordless 3 in 1
Stick/Handheld**

Vacuum Cleaner MVC-CHS198DB

Contents [[hide](#)]

- [1 MVC-CHS198DB Cordless 3 in 1 Stick-Handheld Vacuum Cleaner](#)
- [2 IMPORTANT SAFEGUARDS](#)
- [3 POWER SAFETY](#)
- [4 BATTERY SAFETY](#)
- [5 SERVICE](#)
- [6 PARTS IDENTIFICATION](#)
- [7 SPECIFICATIONS](#)
- [8 ASSEMBLY](#)
- [9 CARE & CLEANING](#)
- [10 TROUBLESHOOTING](#)
- [11 Documents / Resources](#)
 - [11.1 References](#)
- [12 Related Posts](#)

MVC-CHS198DB Cordless 3 in 1 Stick-Handheld Vacuum Cleaner

Thank you for purchasing a quality MORGAN appliance. We trust that you will have a pleasant experience with your new product. To guarantee safety and best efficiency, please read this manual carefully and keep a copy for future reference.

IMPORTANT SAFEGUARDS

PERSONAL SAFETY

When using electric appliances, basic safety precautions should always be adhered to, including the following:

- Read all instructions carefully and retain them for future reference.
- Ensure that the power cord and power plug are not damaged, and the housing is not cracked or deformed. Contact your authorized service agent if any other these are present.
- This appliance may be used by children aged 8 years and above and persons whose physical, perceptive or mental skills are impaired or who are inexperienced or not knowledgeable about the appliance as long as they are supervised or informed and made aware of the safe use of the appliance and the encountered dangers.
- Children should not play with the appliance. Cleaning and user maintenance should not be performed by children unless they are supervised by an adult.
- Always operate the appliance and power charger responsibly to reduce the risk of fire, electrical shock, or injury.
- Do not touch the appliance with wet hands when it is connected to the power supply.
- Keep the power cord away from hot surfaces and sharp edges.
- Protect the appliance from rain, humidity and heat sources.
- Do not obstruct the appliances' air vents and openings free of any objects including dust, lint, clothing, fingers (and all parts of the body);
- Unplug the appliance from the power supply before cleaning and maintenance.
- Do not immerse the appliance or its power cord in water for cleaning.
- Do not attempt to dismantle/modify/repair the appliance yourself.

- Only use original parts or accessories recommended by the manufacturer.
- Exercise caution when cleaning stairs.

POWER SAFETY

- Only use batteries and chargers supplied by the manufacturer.
- Never modify the charger in any way.
- The power charger has been designed for a specific voltage. Always check that the voltage is the same as indicated on the power supply rating label.
- A power charger that is suitable for one type of battery pack may create a risk of fire when used with another battery pack.
- Before using, inspect the power cord for signs of damage or ageing. A damaged or entangled power cord increases the risk of fire and electric shock:
- Never carry the charger by the power cord.
- Do not yank on the power cord to disconnect it from the power supply. Grasp the power plug and pull to disconnect it.
- Do not wrap the power cord around the charger when storing.
- Keep the power cord away from hot surfaces and sharp edges.
- The power cord cannot be replaced. If it is damaged, discard and replace it.
- Do not handle the power charger or the appliance with wet hands.
- Do not store or charge the appliance outdoors.
- The power charger must be removed from the power supply before removing the battery, cleaning or maintaining the appliance.

BATTERY SAFETY

- This appliance includes Li-ion batteries. Do not incinerate batteries or expose to high temperatures, as they may explode:
- Liquid ejected from the battery may cause irritation or burns. Seek professional help immediately in an emergency situation.
- Leaks from the battery cells can occur under extreme conditions. Do not touch any liquid that leaks from the battery. If the liquid that gets on skin, wash immediately with soap and water. If the liquid gets into the eyes, flush them immediately with clean water for at least 10 minutes and seek immediate medical attention. Wear gloves to handle the battery and dispose of immediately in accordance with local regulations.
- Striking the battery terminals may cause burns or fire.
- When the battery pack is not in use, keep it away from paper clips, coins, keys, nails, screws or other small metal objects that could make a connection from one terminal to another.
- When disposing of the appliance, remove the battery and dispose of the battery safely in accordance with local regulations.

SERVICE

- Before using the appliance and after any impact, inspect for signs of wear or damage and repair as necessary.
- Do not use the appliance if any part is damaged or defective.

- Repairs should be carried out by a service agent or a suitably qualified person in accordance with relevant safety regulations. Repairs by unqualified persons could be dangerous
- Never modify the appliance in any way as this may increase the risk of personal injury.
- Only use replacement parts or accessories provided or recommended by the manufacturer.

INTENDED USE

- This appliance has been designed for domestic dry vacuum cleaning only
- Do not vacuum flammable materials such as cigarette ash, or water or other liquids.
- Operate only as described in the instructions in this manual,
- Don't use on concrete, tarmac, or other rough surfaces. **WARNING**
- Do not use water, solvents, or polishes to clean the outside of the appliance.
- Wipe clean with a dry cloth.
- Never immerse the unit in water and do not clean in a dish washer.

PARTS IDENTIFICATION

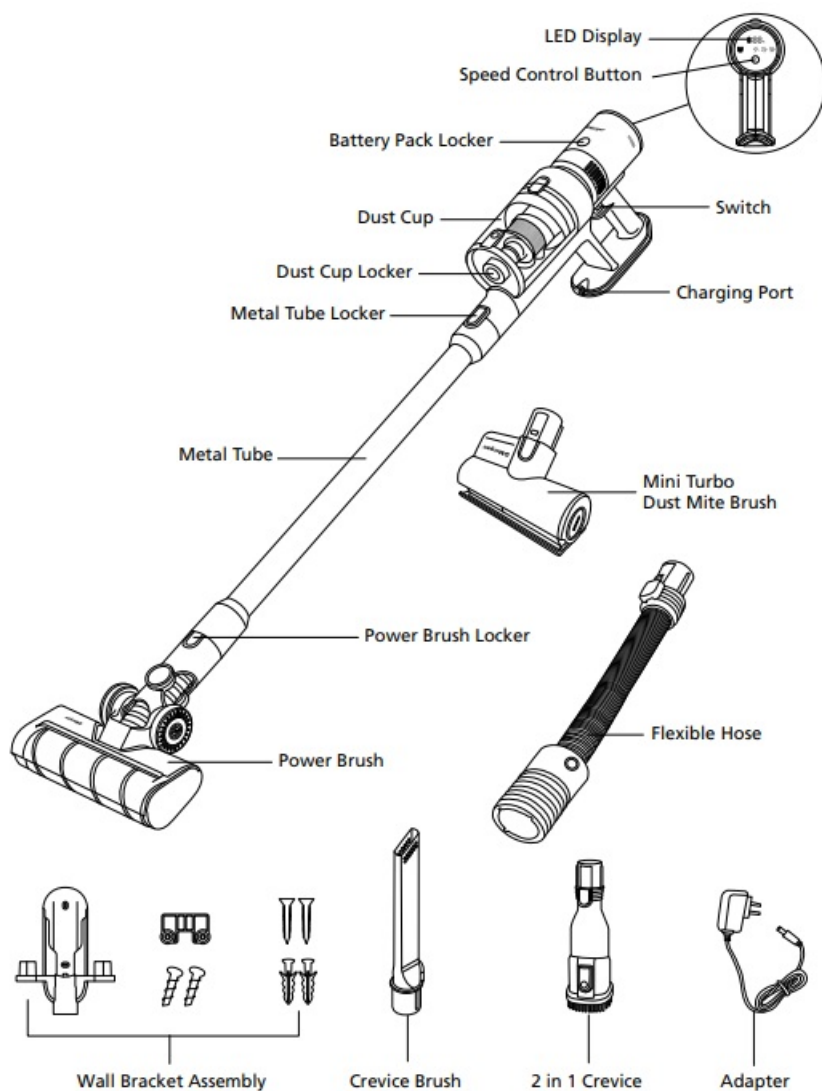

SPECIFICATIONS

MODEL	MVC-CHS198DB
ADAPTER INPUT VOLTAGE	100-240V-
INPUT FREQUENCY	50/60Hz
ADAPTER OUTPUT VOLTAGE	35V
MACHINE OPERATING POWER	450W
MAX. SUCTION	a120AW
DUST BOX CAPACITY	0.5L

ASSEMBLY

1. USING AS A STICK VACUUM CLEANER

Assemble the battery pack onto the main body until a click sound is heard. (Figure 1)

Attach the metal tube to the main body as below until a click sound is heard. (Figure 2)

Attach the brush to another tube head as shown. contents. (Figure 3)

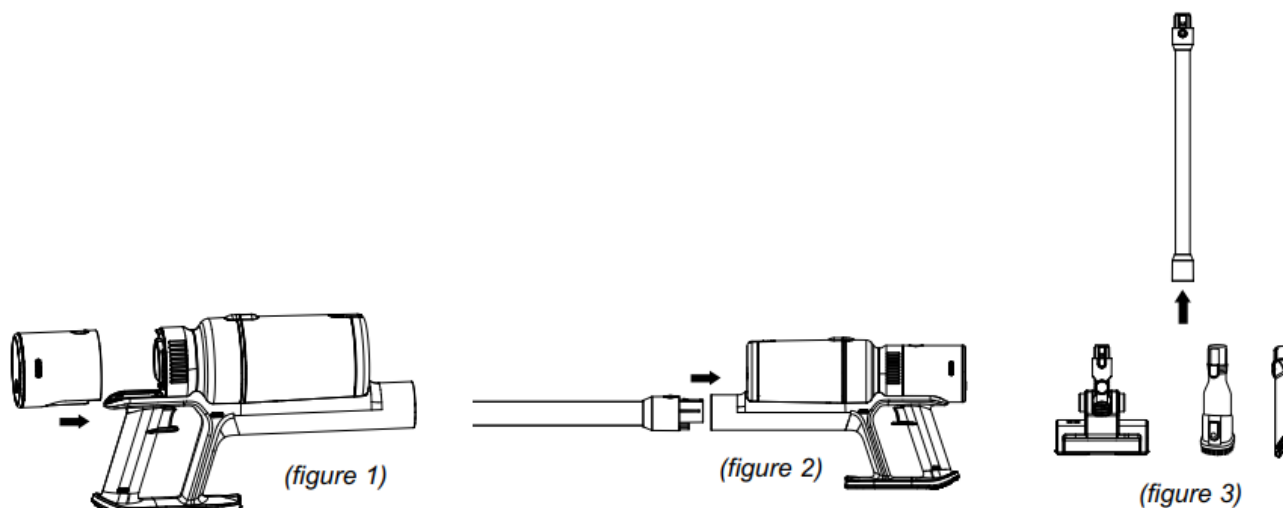

STORING & CHARGING

Secure the adapter onto the wall bracket as per the below instruction.

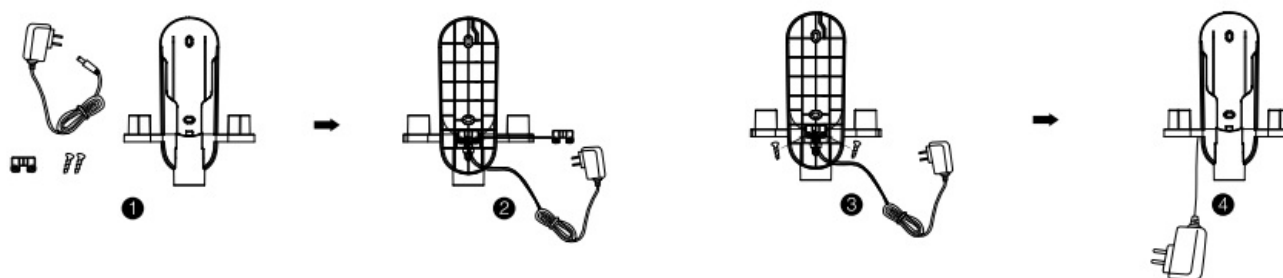

Attach the wall bracket onto the wall with expansion screws to hang the vacuum cleaner and to store accessories.

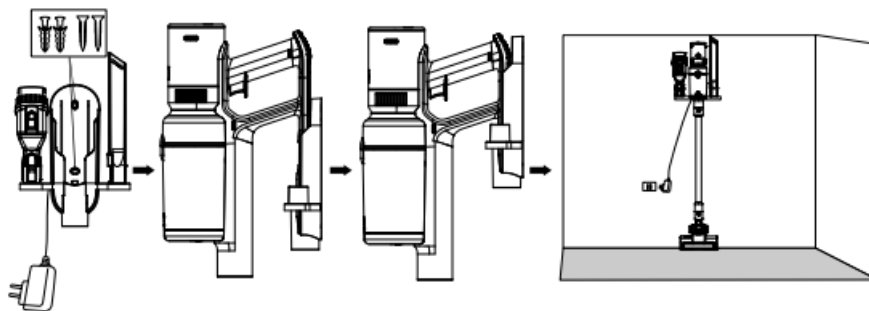

2. USING AS A HANDHELD VACUUM CLEANER

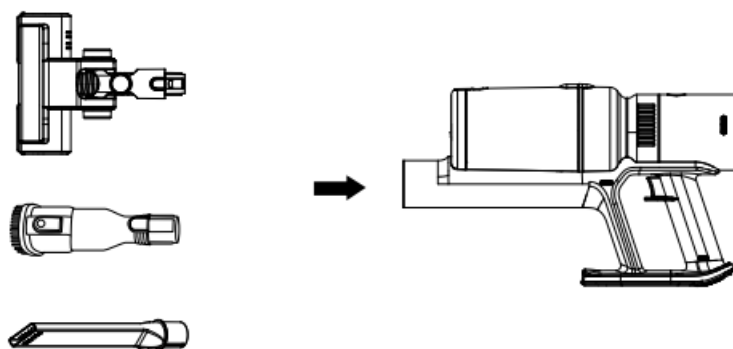

3. OPERATING INSTRUCTIONS

Press the power switch to operate.

Features 3-level speed system:

- 1st Light: Low speed when power switch button is pressed for the first time.
- 2nd Light: Medium speed when speed control button is pressed for the first time.
- 3rd Light: High speed when speed control button is pressed for the second time.
- Press the speed control button will revert to low speed.

Press the power switch button the second time will power off the appliance.

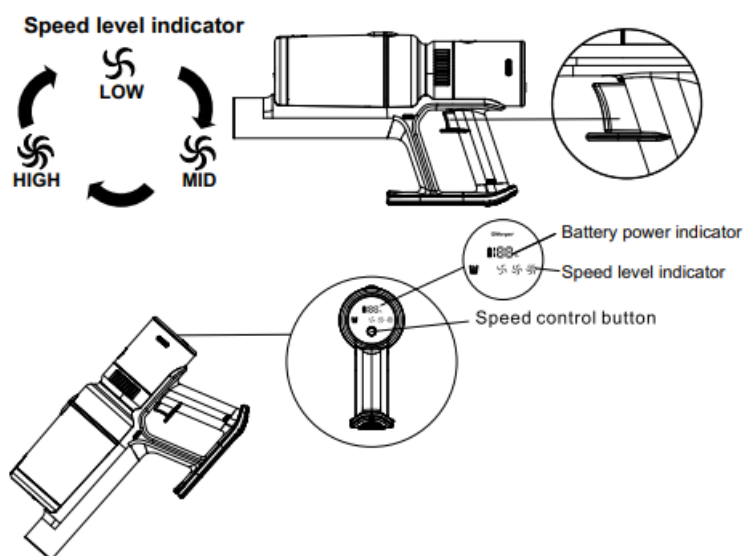

4. BATTERY CHARGING

When the last bar of the battery level indicator flashes green, it means power is insufficient and charging is required.

Connect the power charger to the power supply and charging port.

Charging is in progress when the four green indicator lights are continuously flashing.

Battery has been fully charged when the four indicator lights stay green.

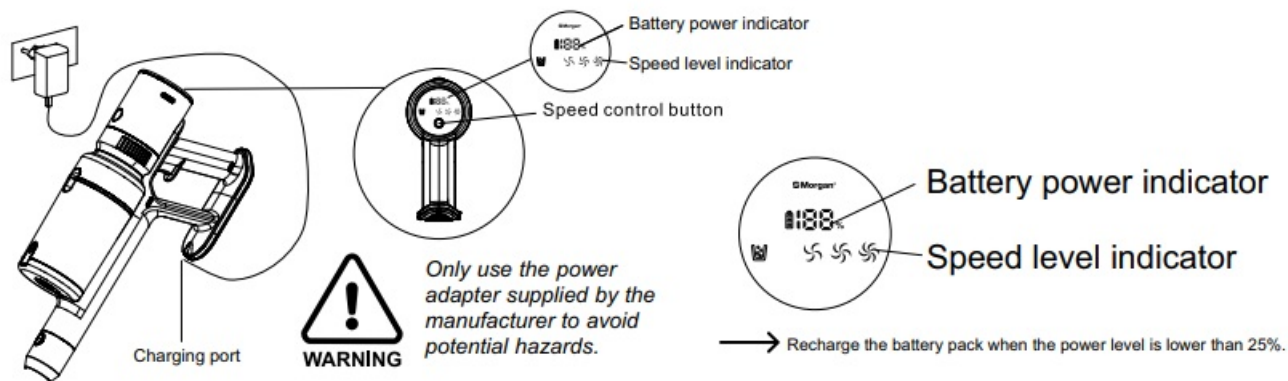

5. EMPTYING THE DUST CUP

Unlock the dust cup locker

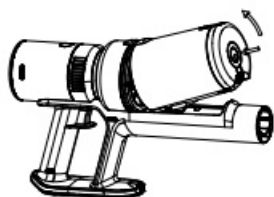

(1)

Empty the dust cup.



(2)

CARE & CLEANING

CLEANING & MAINTAINING THE FILTER

1. Press the release button to detach the dust cup from the main body.

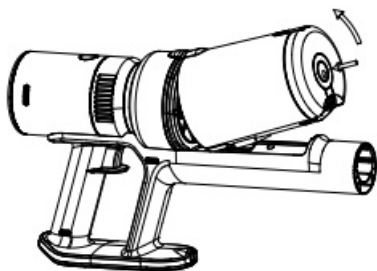

2. Remove the filter case from the dust cup.



3. Remove the sponge and MIF filter from the case.

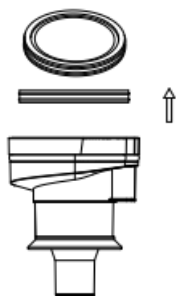

4. Wash the case, sponge and MIF filter.

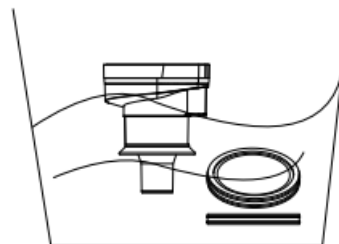

5. Dry the case, sponge and MIF filter.

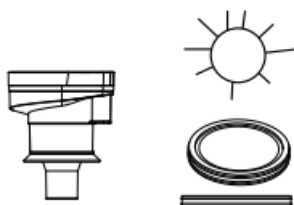

6. Assemble the sponge and MIF filter to the case.

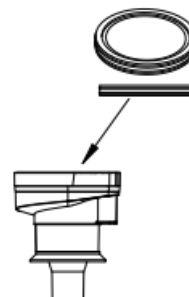

7. Assemble the filter case into the dust cup.

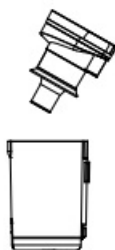

8. Attach the dust cup to the main body.

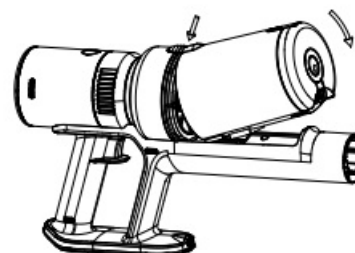

TROUBLESHOOTING

PROBLEM	SOLUTIONS
Suction is weak	<ul style="list-style-type: none"> •Empty the dust cup. •Clean the HEPA filter. •Ensure dust cup is inserted correctly.
Beier hush stops spinning & has strange sounds	<ul style="list-style-type: none"> •Check whether the bearing part of the brush is stuck with hair. •Ensure filter cup is installed correctly. •Detach the tube and operate it as a handheld vacuum. If not working, contact your authorized service agent.
Battery doesn't hold a charge	<ul style="list-style-type: none"> •Check whether power charger & charging base is connected correctly. •Ensure the battery pack is inserted onto the main body correctly. •If there is no charging indicator light during charging, contact your authorized service agent
NOTE: To ensure best performance, clean the roller brush regularly after every use.	



Market Expansion Services by

www.dksh.com.my

E-mail: electrical.appliance@dksh.com

www.morgan.my



facebook.com/morganappliances

Documents / Resources

	<p>Morgan MVC-CHS198DB Cordless 3 in 1 Stick-Handheld Vacuum Cleaner [pdf] User Manual</p> <p>MVC-CHS198DB, Cordless 3 in 1 Stick-Handheld Vacuum Cleaner, Handheld Vacuum Cleaner, Cordless 3 in 1 Stick Vacuum Cleaner, Vacuum Cleaner, Cleaner, MVC-CHS198DB Cleaner</p>
--	---

References

- [DKSH Holdings \(Malaysia\) Berhad Home page](#)
- [MORGAN Home Appliances - For A Quality Lifestyle](#)