



MOOSE KNUCKLES

## **Recovery Shackle Vehicle Size Reference**



# **Moose Knuckle Recovery Shackle Vehicle Size Reference User Guide**

[Home](#) » [Moose Knuckle](#) » **Moose Knuckle Recovery Shackle Vehicle Size Reference User Guide** 

### **Contents**

- [1 Moose Knuckle Recovery Shackle Vehicle Size Reference](#)
- [2 Product Information](#)
- [3 Product Usage Instructions](#)
- [4 FAQs](#)
- [5 SHACKLE SIZE REFERENCE](#)
- [6 Documents / Resources](#)
  - [6.1 References](#)
- [7 Related Posts](#)



MOOSE KNUCKLES

## **Moose Knuckle Recovery Shackle Vehicle Size Reference**



## Product Information

### Specifications

- Shackle Sizes Available: 1/2, 5/8, 3/4, 7/8
- Pin Diameter: The pin diameter is 1/8 inch larger than the shackle's stated size

### Product Usage Instructions

#### Choosing the Correct Size Shackle

When selecting the right shackle size, consider the following factors:

1. Determine the vehicle size, type, or weight.
2. Check the hole diameter on your bumper or hitch mounts.
3. Some tow points may be oversized to accommodate winch hooks and other recovery gear.
4. Adapter sleeves can be used to adapt the correct size shackle to larger holes.

### FAQs

#### Q: What is the pin diameter of each shackle?

A: The pin diameter of each shackle is 1/8 inch larger than the shackle's stated size. For example, a 3/4 size shackle has a 7/8 inch diameter pin.

## SHACKLE SIZE REFERENCE

Vehicle size, type, or weight is your first reference for choosing the correct size shackle. The next reference is the hole diameter on your bumper or hitch mounts. Keep in mind that some points are oversized to accommodate winch hooks and other recovery gear. Adapter sleeves are available to adapt the correct size shackle to larger holes.

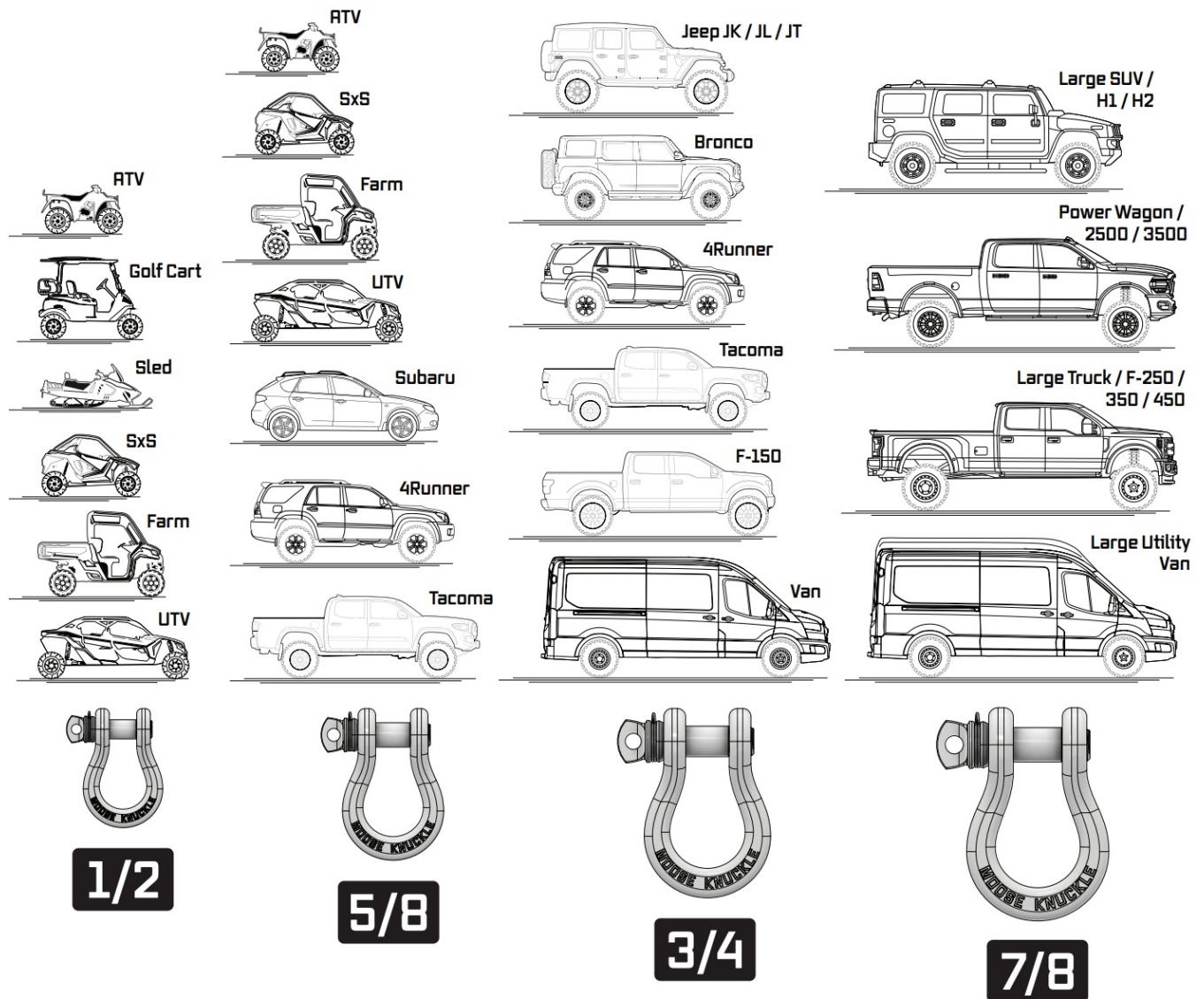

**PLEASE NOTE:** The pin diameter of each shackle is 1/8 inch larger than the shackle's stated size. The size labeled on the shackle is not the pin diameter. For example, a 3/4 size shackle has a 7/8 inch diameter pin.

## Documents / Resources

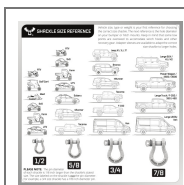

[Moose Knuckle Recovery Shackle Vehicle Size Reference](#) [pdf] User Guide  
Recovery Shackle Vehicle Size Reference, Recovery Shackle Vehicle Size Reference, Shackle Vehicle Size Reference, Vehicle Size Reference, Size Reference, Reference

## References

- [User Manual](#)

## **Manuals+. Privacy Policy**

This website is an independent publication and is neither affiliated with nor endorsed by any of the trademark owners. The "Bluetooth®" word mark and logos are registered trademarks owned by Bluetooth SIG, Inc. The "Wi-Fi®" word mark and logos are registered trademarks owned by the Wi-Fi Alliance. Any use of these marks on this website does not imply any affiliation with or endorsement.