

**Moooni HLP281BL 6 Lights Rectangular Chandelier**



# Moooni HLP281BL 6 Lights Rectangular Chandelier Instruction Manual

[Home](#) » [Moooni](#) » Moooni HLP281BL 6 Lights Rectangular Chandelier Instruction Manual 

## Contents

- [1 Moooni HLP281BL 6 Lights Rectangular Chandelier](#)
- [2 Specifications](#)
- [3 Product Usage Instructions](#)
- [4 Contact Information](#)
- [5 Installation Kit](#)
- [6 Safety Rules](#)
- [7 Installation Preparation](#)
- [8 Trouble Shooting](#)
- [9 Clean And Care](#)
- [10 Ordering Parts](#)
- [11 FAQ](#)
- [12 Documents / Resources](#)
  - [12.1 References](#)

m o o n i

**Moooni HLP281BL 6 Lights Rectangular Chandelier**



## Specifications

- **Model No.:** HLP281BL+BR-6A
- **Light Bulbs:** 6 E26 bulbs, up to 60W each
- **Dimmable:** Fully dimmable with compatible dimmable bulbs and switches (not included)

## Product Usage Instructions

### Tools You Need

- Ladder
- Pliers
- Wire Strippers
- Screwdrivers
- Power Drill (optional)
- Drill Bit (optional)

### Installation Step 1 (Assemble the Light)

1. Attach the canopy screw with nut, wire nut, and pair of gloves as needed.
2. Secure the canopy, lift ring, rod, lamp body, and bulbs as per the provided diagram.

### **Installation Step 2 (Hang and Wire)**

1. Pass the main wire through the rod and canopy, then fix the rods on the lamp body.
2. Install the lift ring on the rod and canopy.
3. Fix the bracket on the outlet box and connect the wires following the instructions.
4. Install the E26 bulbs.

### **Troubleshooting**

If you encounter any issues, refer to the troubleshooting section. Ensure proper connections and power supply before testing the fixture.

### **Clean And Care**

To clean, wipe the fixture with a soft cloth. Avoid using chemical cleaners that can damage the finish. Do not use abrasive materials for cleaning.

### **Contact Information**

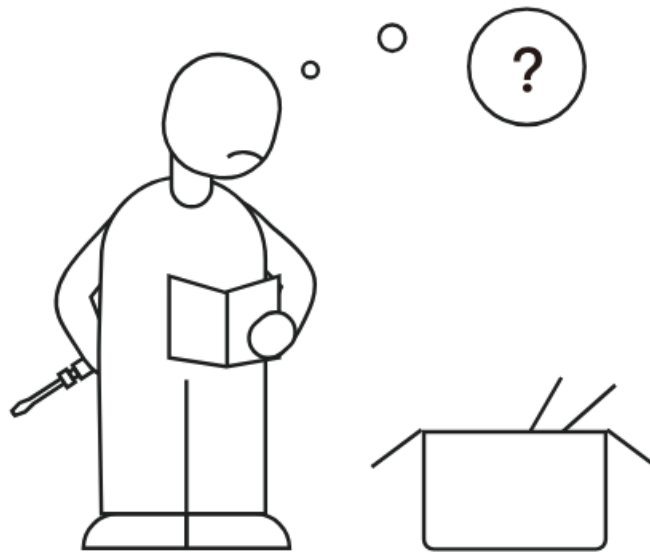

### **Please contact us with the following information**

1. Screenshot of your order page, including product picture, name, and order ID number.
2. Problem details with pictures / short video if possible.

Email: [homechandelier@qq.com](mailto:homechandelier@qq.com)

### **Installation Kit**

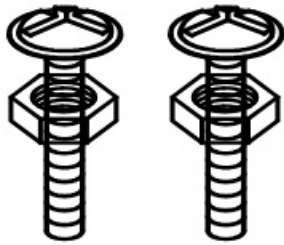

AA

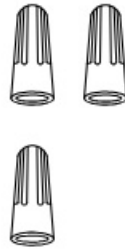

BB



CC



DD



EE

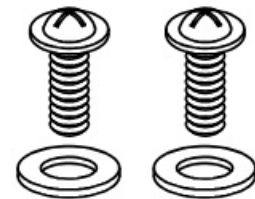

FF

Part	Description	Quantity
AA	Canopy Screw with Nut	2
BB	Wire nut	3
CC	Pair of Gloves	1
DD	Cap Nut	2
EE	Wood Screw (optional)	2
FF	Machine Screw & Washer for Outlet Box (spares)	2

**Note:**

Some extra hardware may be included. The quantity listed above is the number required for installation.

**Safety Rules**

**WARNING:** BE SURE THE ELECTRICITY TO THE WIRES YOU ARE WORKING ON IS SHUT OFF; EITHER THE FUSE IS REMOVED OR THE CIRCUIT BREAKER IS TURNED OFF. TURNING THE POWER OFF USING THE LIGHT SWITCH IS NOT SUFFICIENT TO PREVENT

**ELECTRICAL SHOCK.**

**NOTE:** The important safeguards and instructions appearing in this manual are not meant to cover all possible conditions or situations that may occur. It must be understood that common sense, caution, and care, are factors that cannot be built into any product. These factors must be supplied by the person(s) installing this unit.

**READ & SAVE THESE INSTRUCTIONS**

**CAUTION:** Before assembling the lighting fixture, please read the following chapters. If you feel you do not have enough electrical wiring experience, either refer to a do-it-yourself wiring handbook or have your lighting fixture

installed by a qualified, licensed electrician. Remove the fixture and the mounting packages from the box and make sure that no parts are missing by referencing the illustrations on the installation instructions. Be sure to read these installation instructions and review the diagrams thoroughly before installation.

### **LIGHT BULBS REQUIRED**

This lamp uses 6 E26 bulbs, compatible with bulbs up to 60W. Fully dimmable when used with dimmable bulbs and compatible dimming switches (not included).

## **Installation Preparation**

### **Tools You Need**



☒ Ladder

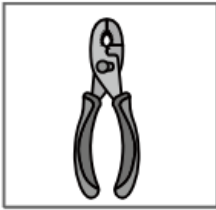

☒ Pliers



☒ Wire  
Strippers

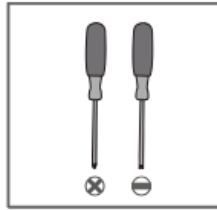

☒ Screwdrivers



☐ Power Drill  
(optional)



☐ Drill Bit  
(optional)

If mounting to a support structure, you will also need the optional tools.

### **Installation Step 1 (Assemble the Light)**

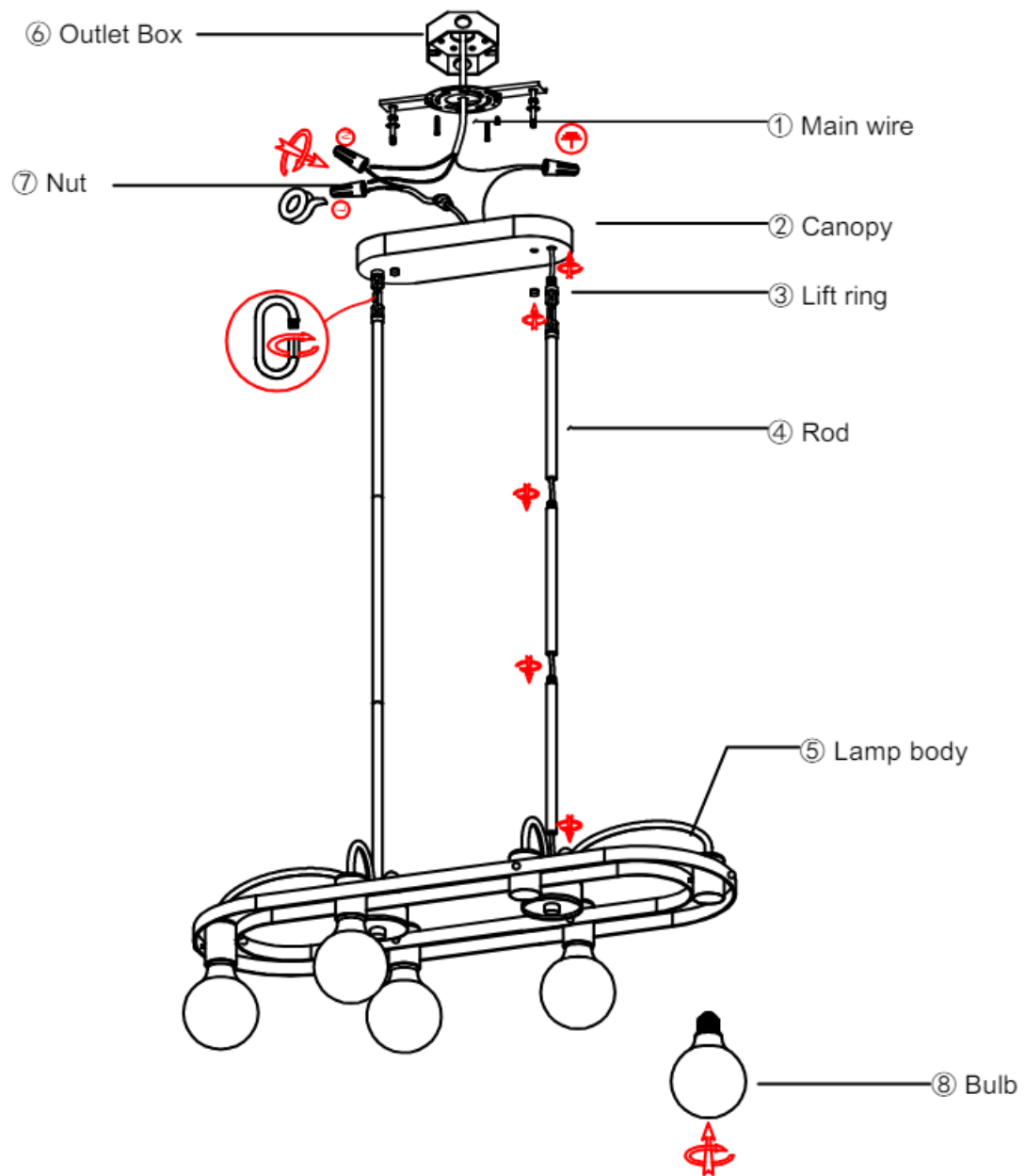

## Installation Step 2 (Hang and Wire)

1. Pass the main wire ① through the rod ④ and canopy ②, then fix the rods ④ on the lamp body ⑤.
2. Install the lift ring ③ on the rod ④ and canopy ②.
3. Fix the bracket on the outlet box ⑥ and connect the wires as shown on page 5.
4. Install the E26 bulbs ⑧.

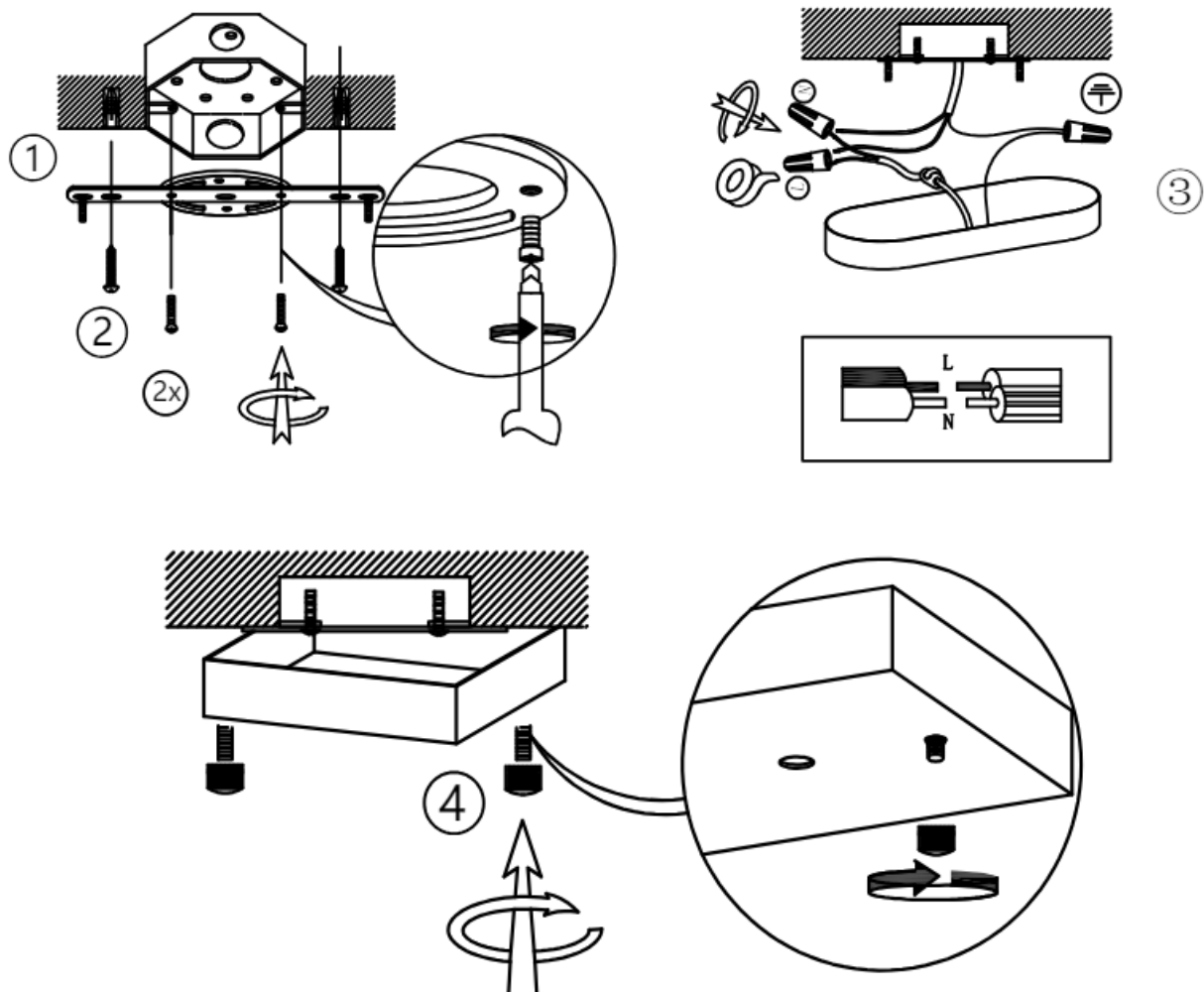

**Note:** Please test the fixture before installation to ensure it's working properly.

1. Turn off the power at the circuit box to avoid possible electric shock.
2. Attach the Mounting Plate to the junction box using mounting screws.
3. Connect fixture wires to house wires with a Wire nut, and wrap the connection with electrical tape.
4. Attach the canopy to the affixed mounting plate using a cap nut.

## Trouble Shooting

### Missing/Broken Parts

Make a list of the missing/broken parts according to the packing list, take photos for broken parts, then email us for free replacements.

### Bulbs Do Not Light Up

- Check your power and switch to make sure it's powered on.
- Check the bulb to make sure it's installed correctly.
- Change a new bulb.
- Check the wires to make sure they are connected correctly.

### Bulbs Flicker/Noisy Operation

- Check the bulb to make sure it's installed correctly.
- Change a new bulb.
- Make sure your bulb is dimmable if you use a dimmer switch.

### **Could Not Install/Assemble**

Take photos of the ceiling/fixture, and contact the seller for technical support.

### **Clean And Care**

To clean, wipe the fixture with a soft cloth. Spraying from chemical cleaners can discolour the finish of the fixture. Do not use scouring pads, powders, steel wool, or abrasive paper to clean this fixture.

### **Ordering Parts**

Keep this manual for future reference, and in case replacement parts are needed. Available parts can be ordered from the place of purchase. Use exact wording from diagrams when ordering parts.

### **SCANNER**





Scan for Installation Video

### **FAQ**

- **Q: What should I do if I receive extra hardware in the installation kit?**
  - A: Some extra hardware may be included for convenience. The listed quantities are the required ones for installation. You can keep the extras as spares.
- **Q: Can I use higher-wattage bulbs in this chandelier?**
  - A: It is recommended to use bulbs up to 60W as specified. Using higher wattage bulbs may affect the fixture's performance and safety.

### **Documents / Resources**



<div>Manual Book</div> <div>Chandelier</div> <div>Model No. HLP281BL-6L-6A</div> <div></div> <div></div>	<p><a href="#">Moooni HLP281BL 6 Lights Rectangular Chandelier</a> [pdf] Instruction Manual HLP281BL 6 Lights Rectangular Chandelier, HLP281BL, 6 Lights Rectangular Chandelier, Rectangular Chandelier, Chandelier</p>
--	---

References

- [User Manual](#)

Manuals+, Privacy Policy

This website is an independent publication and is neither affiliated with nor endorsed by any of the trademark owners. The "Bluetooth®" word mark and logos are registered trademarks owned by Bluetooth SIG, Inc. The "Wi-Fi®" word mark and logos are registered trademarks owned by the Wi-Fi Alliance. Any use of these marks on this website does not imply any affiliation with or endorsement.