

moonboon
designed for better sleep
**Essential
Bundle Cradle
with Motor**



moonboon Essential Bundle Cradle with Motor User Manual

[Home](#) » [moonboon](#) » moonboon Essential Bundle Cradle with Motor User Manual 

Contents

- 1 moonboon Essential Bundle Cradle with Motor
- 2 Product Specifications
- 3 Product Usage Instructions
- 4 IMPORTANT INFORMATION
- 5 WHAT IS INCLUDED
- 6 MOUNTING OPTIONS
- 7 ASSEMBLY INSTRUCTIONS
- 8 HEIGHT
- 9 PLACEMENT OF THE CHILD
- 10 QUESTIONS AND ANSWERS
- 11 CLEANING INSTRUCTIONS
- 12 SAFETY CHECKLIST
- 13 FAQ
- 14 Documents / Resources
 - 14.1 References

moonboon
designed for better sleep

moonboon Essential Bundle Cradle with Motor



Product Specifications

- **Brand:** Moonboon
- **Product:** Cradle
- **Weight Capacity:** 3-12 kg
- **Mounting Options:** Tripod Stand, Door Frame Clamp, Mounting Kit

Product Usage Instructions

Assembly and Installation

To ensure safe usage of the cradle, follow these steps:

1. Attach the spring to the cradle.
2. Install the cradle using one of the following options: Moonboon's tripod stand, door frame clamp, or the Mounting Kit.
3. Refer to the user manual for detailed assembly and installation instructions.

Important Safety Information

Follow these safety guidelines:

- Do not use the cradle without attaching the spring.
- Stop using the cradle once the child can sit by itself, lie on its knees, or crawl out.
- Avoid using third-party products not designed for this cradle to prevent choking hazards.
- Keep the cradle away from obstructions that may hinder its use.
- Avoid using around choking or strangulation hazards like wires, strings, or curtain cords.
- Use only one mattress in the cradle.

Cleaning Instructions

To clean the cradle:

1. Remove all bedding and accessories.
2. Wipe down the cradle with a damp cloth and mild soap.
3. Air dry thoroughly before reassembling.

Important: Read the user manual carefully and keep it for future use.

CONGRATULATIONS ON YOUR NEW CRADLE

- Moonboon's cradle has been designed for Moonboon's spring and motor system. Use the cradle with or without the motor.
- The standard cradle comes with a spring, which can be used when the baby weighs 3-12 kg.
- To ensure safe usage of the cradle, the spring needs to be attached, and the cradle needs to be installed with one of the following: Moonboon's tripod stand, a door frame clamp or the Mounting Kit.
- Follow the user manual carefully to ensure the cradle is assembled and installed correctly.
- Do not use systems or other brand products that have not been designed to work with the cradle.

IMPORTANT INFORMATION

WARNING

- Do not use this product without reading the user manual beforehand.

WARNING

- You must stop using this product once the child can sit by itself, lie on its knees, or can crawl out of the cradle.

WARNING

- Using third-party products not designed to work with this product may cause choking hazards.

WARNING

- Do not use this product near any other products that may obstruct its use.

WARNING

- Do not use this product around products that can cause choking hazards or strangulation, such as wires, strings, or curtain cords.

WARNING

- Do not use more than one mattress in this product.

WHAT IS INCLUDED

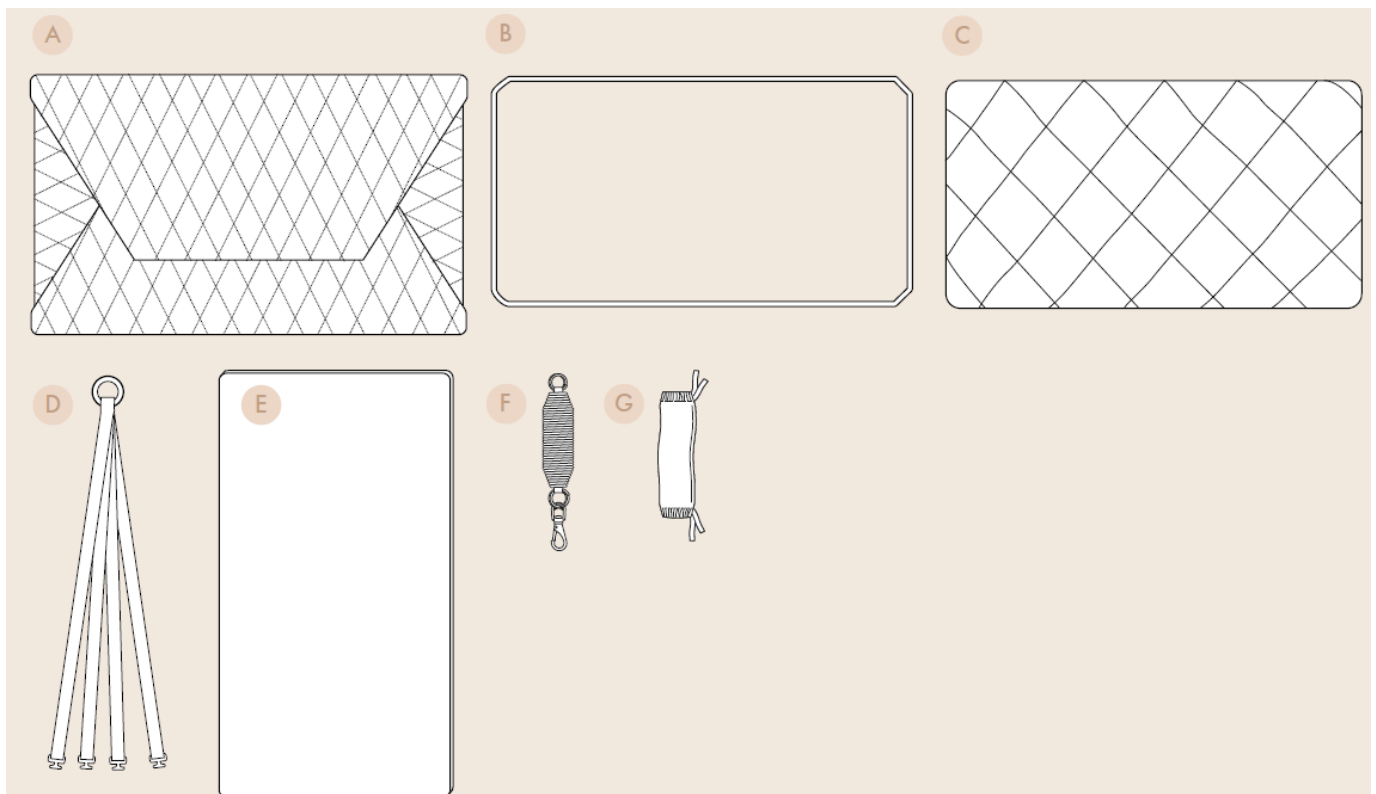

- **A.** 1x Quilted cradle cover
- **B.** 1x Steel frame
- **C.** 1x Foam mattress
- **D.** 1x Set of adjustable straps
- **E.** 1x Wooden baseboard of masonite with fabric cover

- **F.** 1x Spring
- **G.** 1x Spring cover

MOUNTING OPTIONS

The cradle can be installed with the Moonboon tripods stand, door frame clamp or with the Moonboon Mounting Kit. No matter how you choose to install the cradle, you should always place it somewhere that does not have a draft and at a safe distance from the nearest wall, furniture, or the like. See further instructions in the section about HEIGHT.

TRIPOD STAND

- You should only use the Moonboon tripod stand, developed to carry the cradle. Place the tripod stand on a solid floor that is not crooked.
- Read your user manual for the tripod stand carefully.

Please note

- We recommend you use the Mounting Kit from Moonboon, developed specifically for suspension from the ceiling. If you use other methods to suspend from the ceiling, such as a hook, it must be made from stainless steel without a coating.

DOOR FRAME CLAMP

It is possible to install the cradle with a door frame clamp to hang it in a doorway. We recommend you use Moonboon's door frame clamp, which can hold a load of 20 kg.

- The door frame on which you mount the door frame clamp should only be 25 cm wide as a maximum.
- The door frame clamp must be firmly attached to both sides of the wall.
- No wires must obstruct the door frame.

Read your user manual for the door frame clamp carefully.

Please note

- Never push the cradle back and forth or sideways, and do not use it as a swing.

MOUNTING KIT

- If you choose to install the cradle from a hook in the ceiling, we always recommend you use Moonboon's Mounting Kit, which includes a stainless steel ceiling hook and a hardwearing mounting strap in cotton and nylon.
- If you choose to use another hook, you must always ensure that the hook is strong enough to carry the weight of the cradle and the child.
- When you have found a nice place to install the cradle, you must check the ceiling material to ensure that you choose the correct raw plug and hook to prevent the mounting from falling.

Please note

- We recommend you use Moonboon's Mounting Kit, developed explicitly for suspension from the ceiling. If you use other methods to suspend from the ceiling, such as a hook, it must be made from stainless steel without a coating.
- The same applies if you choose to use a metal chain.

ASSEMBLY INSTRUCTIONS

ASSEMBLY, SPRING

1. First, you must prepare your chosen mounting method; tripod stand, a door frame clamp or the Mounting Kit. If you are installing a cradle bouncer, this needs to be installed first; consult the user manual for the cradle bouncer on how to do so.
2. Put the cover on the spring. Tie the cover with a bow at the top and bottom and manually stretch the spring to distribute the cover evenly.
 - Hang the spring using the snap hook provided in the package.
 - Note that the spring swivel snap hook must point down as shown in the illustration.

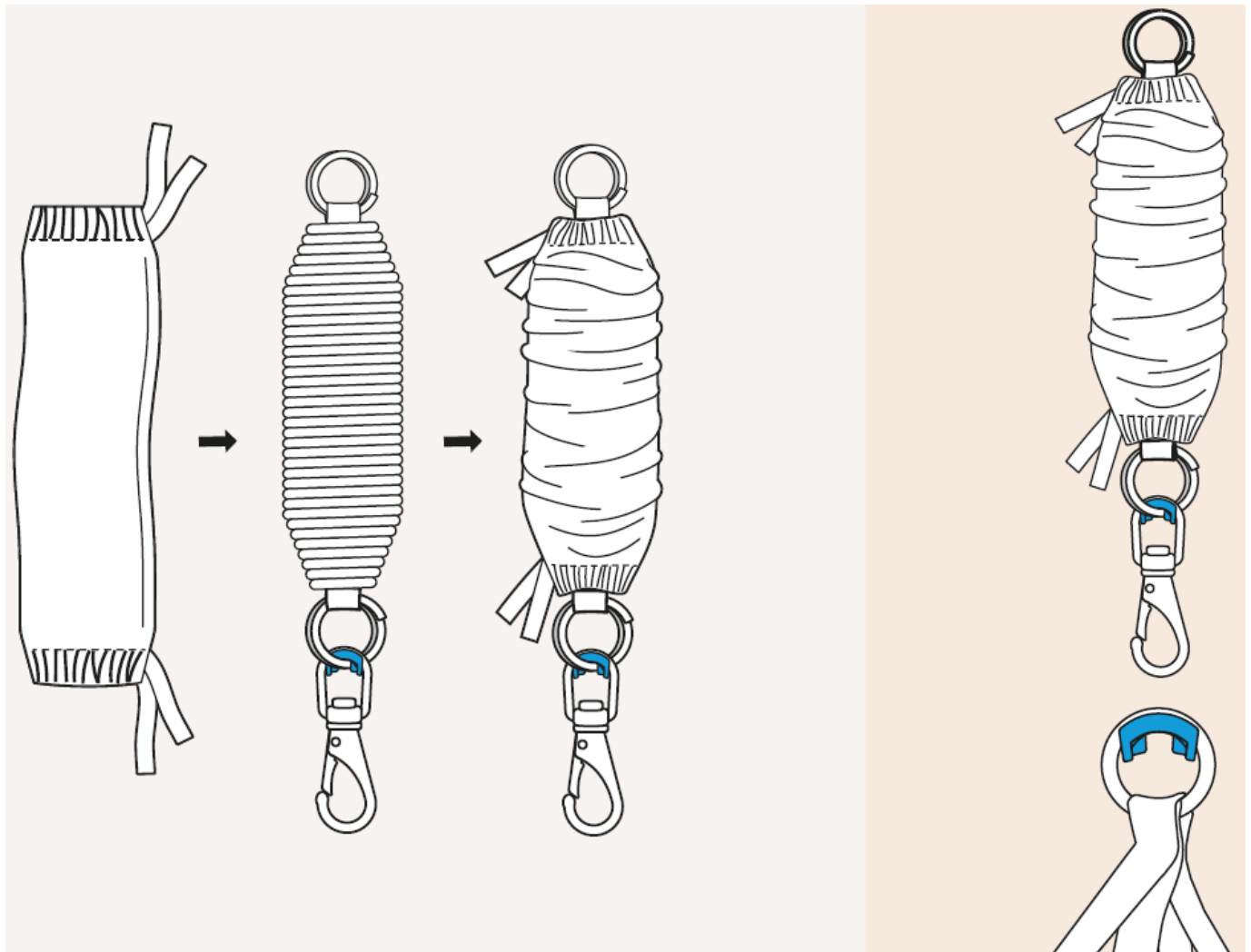

ASSEMBLY, CRADLE

1. Before you begin, ensure that you have every component.
2. Open the cover of the cradle by unzipping the zipper as wide as possible and opening the Velcro patch. Place the steel frame inside the cover and lift the steel frame to the top of the folded material, so that you can reach the steel frame through the four mounting holes in the cradle's cover.
3. Attach the adjustable straps to the steel frame. Pass each strap down through a mounting hole, around the steel frame, and back up through the mounting hole.
 - Ensure that the straps are passed in the same direction into the mounting holes and around the frame to achieve a consistent look all around. We recommend having the buckle on the outside of the strap so that the anchor for the buckle is on the inside.
 - Once the cradle straps are attached, zip the zipper and close the Velcro patch.

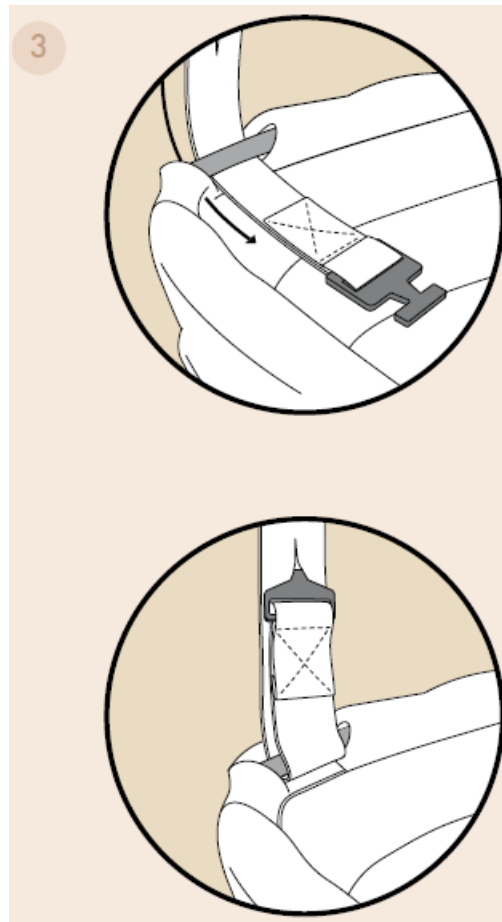

4. Now, attach the spring to the cradle strap's stainless steel metal ring. If you have chosen to use a cradle bouncer, attach the top of the spring to the motor. Otherwise, hang the spring directly in your chosen mounting method (tripod stand, door frame clamp, or ceiling mount).
 - Make sure that the Moonboon logo on the outside of the cradle cover faces forward. Adjust the cradle straps to be centered in the mounting holes and the cradle's four corners.
5. Place the wooden baseboard at the bottom of the cradle and make sure it is even. Then place the cradle's foam mattress on top of the wooden baseboard.
6. Adjust the cradle height by adjusting the length of the cradle straps. We recommend always using the bottom holes. The upper holes allow for adjustment of the cradle to always make it horizontal. You will need to try a few times to find the setting best suited for you.
 - If you are using a cradle bouncer, attach the motor wire to a cradle strap of your choosing.
7. The cradle is now ready for use. Please read the section about HEIGHT.

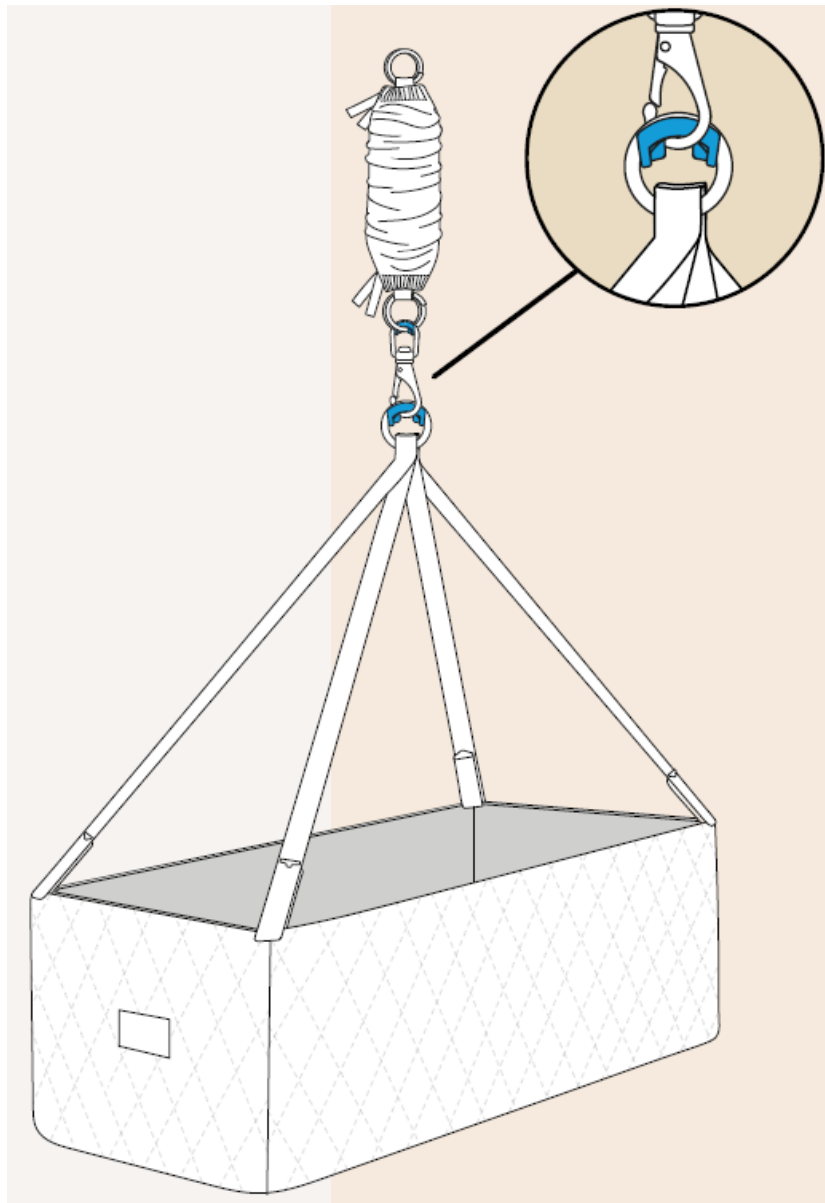

Please note

- Your spring comes with a plastic part already mounted it. Adjust the position of the plastic part so it rests between the metal of the spring and the swivel snap.

HEIGHT

The cradle must not touch the floor when it bounces. Before using the cradle, make sure to perform tests to ensure this.

TEST 1: WITHOUT A CHILD IN THE CRADLE

- Attach the cradle as instructed and pull the spring to stretch it as wide as possible. Pull on the spring until you can feel the safety strap (the nylon strap inside the Spring) stop any further extension.
- When the spring is fully extended, space must remain between the bottom of the cradle and the floor.

TEST 2: WITH A CHILD IN THE CRADLE

- Place the child in the cradle and perform the same test as before. You pull on the spring until you feel the safety strap holding it back from any further extension.
- Here, too, space must remain between the bottom of the cradle and the floor.

Please note

- Follow this instruction and test it regularly as your child grows and gains weight. This way, you ensure that the cradle never touches the floor.

PLACEMENT OF THE CHILD

- Place your child in the middle of the cradle.
- Your child should be placed with its feet facing the Moonboon-logo.
- If you feel like the cradle is uneven, with either end tipping slightly, you need to adjust the cradle straps by choosing another buttonhole.
- If you use the cradle once your child has learned to roll over by itself, your child needs to be under constant supervision to avoid any risks of falling out of the cradle.

QUESTIONS AND ANSWERS

WHY SHOULD I USE A CRADLE?

Some infants sleep very well, while others have periods where they find it difficult to rest or sleep. For periods like these, the cradle can be of great use to you. The bouncing of the cradle reminds the child of the time in the womb, and it is an extra form of comfort. It helps the little ones sleep better.

HOW MUCH AND HOW LONG MAY A BABY SLEEP IN THE CRADLE?

- Initially, your baby may sleep as much as necessary in the cradle.
- However, no two children are alike. If you have doubts about using the cradle too much, we recommend you consult your health professional for further guidance about your child's sleeping habits.

WHY DOES THE CRADLE COME WITH PLASTIC PARTS?

- In August 2021, the Danish Board of Health presented cases of children suffering from small metal particles in their eyes because of unfit metal hooks used for mounting sensory swings, cradles, and other similar products.
- With this in mind, Moonboon has developed a specific Mounting Kit to mount your cradle from concrete and wooden ceilings. Furthermore, Moonboon has developed plastic parts for the spring and motor to avoid metal on metal.

Further questions?

We want to make sure you get the most out of your Moonboon products, so if you have any questions about our care instructions, please do not hesitate to contact our customer service team, who would be happy to help at hello@moonboon.com

CLEANING INSTRUCTIONS

COVER FOR THE CRADLE

- Remove the adjustable straps, the steel frame, the wooden baseboard, and the foam mattress from the cradle cover before washing it. Wash the cover at 40°C in the washing machine.
- When you wash it, the cover may shrink a little. Make sure to stretch it back to its original shape and size while it is still wet. Iron the cover while it is still damp to eliminate wrinkles.
- Avoid chemical cleaning. Do not use bleach. Only dry on a rack and not in the tumble dryer.

FOAM MATTRESS

- The cover of the foam mattress can be washed at 40°C in the washing machine but cannot be tumble-dried. The mattress itself cannot be washed.

COVER FOR THE BASEBOARD

- Remove the cover from the baseboard to wash it. Wash the cover at 40°C in the washing machine.
- When you wash it, the cover may shrink a little. Make sure to stretch it back to its original shape and size while it is still wet. Iron the cover while it is still damp to eliminate any wrinkles.
- Avoid chemical cleaning. Do not use bleach. Only dry on a rack and not in the tumble dryer.

SAFETY CHECKLIST

Carefully read the safety checklist below. Once you have gone through the list and made sure everything is as described, you may start using the cradle. Enjoy!

- Double-check every assembled part carefully and pay special attention to loose components that may be caught on body parts or clothing, which can create choking hazards (this includes strings, buttons etc.)
- Toddlers should not be allowed to play next to this product unsupervised.
- Moonboon only recommends that you use original Moonboon accessories for the cradle.
- Pay attention to fire hazards that may arise from smoking cigarettes, open fires, or other sources of particular warm temperature (this includes electric, infrared and gas warming units) around the product.
- DO NOT USE this product if any parts are missing or if the product has been damaged in any way. Always contact Moonboon for new and original components. NEVER REPLACE original parts with third-party components.
- Only install and assemble the cradle using its original mounting parts. Always avoid any alternative parts for mounting.
- Check that the safety snap hook is locked and adequately fastened every time you use the cradle.
- Always use the accompanying plastic parts.
- Make sure the safety straps are secured correctly to the Spring. The strap goes through the spring and needs to be attached to the “eyes” on each end.
- Make sure the combined 4 buckles with anchors are correctly pulled through the selected buttonholes, and the cradle has been properly mounted every time you use the cradle.
- We always recommend that you stay close to the cradle when your child rests in it. You must ensure the cradle

does not touch the floor when it bounces. Read the section about HEIGHT.

- Moonboon discourages using the cradle as soon as the child can turn over or sit on their own. If you continue using the cradle after this point, your children need constant supervision when in the cradle. Moonboon disclaims any responsibility for using the cradle in these circumstances.
- Never use the cradle as a toy, swing or the like. The cradle must not be used as such when your child rests in it. Make sure everyone around you – particularly children – is aware of this when your child is in the cradle.
- If there are any visible wear and tears to the fabric or metal parts, you should avoid using the cradle before this is rectified.
- Do not swaddle or wrap a blanket around your baby while the baby is placed in the cradle.

Please note

- Make sure to check regularly that the cradle and the mounting meet all safety requirements.

FAQ

- **Q:** Can I use the cradle without the spring?
 - **A:** No, to ensure safe usage, always attach the spring as instructed.
- **Q:** What is included in the package?
 - **A:** The package includes a quilted cradle cover, steel frame, foam mattress, adjustable straps, wooden baseboard with fabric cover, spring, and spring cover.
- **Q:** How do I know if my chosen mounting location is suitable?
 - **A:** Ensure the location is free from drafts and at a safe distance from walls or furniture. Refer to height guidelines for further instructions.

Documents / Resources

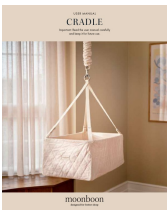
	<p>moonboon Essential Bundle Cradle with Motor [pdf] User Manual Essential Bundle Cradle with Motor, Bundle Cradle with Motor, Cradle with Motor, Motor</p>
---	---

References

- [User Manual](#)

Manuals+, Privacy Policy

This website is an independent publication and is neither affiliated with nor endorsed by any of the trademark owners. The "Bluetooth®" word mark and logos are registered trademarks owned by Bluetooth SIG, Inc. The "Wi-Fi®" word mark and logos are registered trademarks owned by the Wi-Fi Alliance. Any use of these marks on this website does not imply any affiliation with or endorsement.