

# MONSTERTECH VPC Control Panel Mount Instruction Manual

[Home](#) » [Monstertech](#) » MONSTERTECH VPC Control Panel Mount Instruction Manual 

**MONSTERTECH VPC Control Panel Mount**

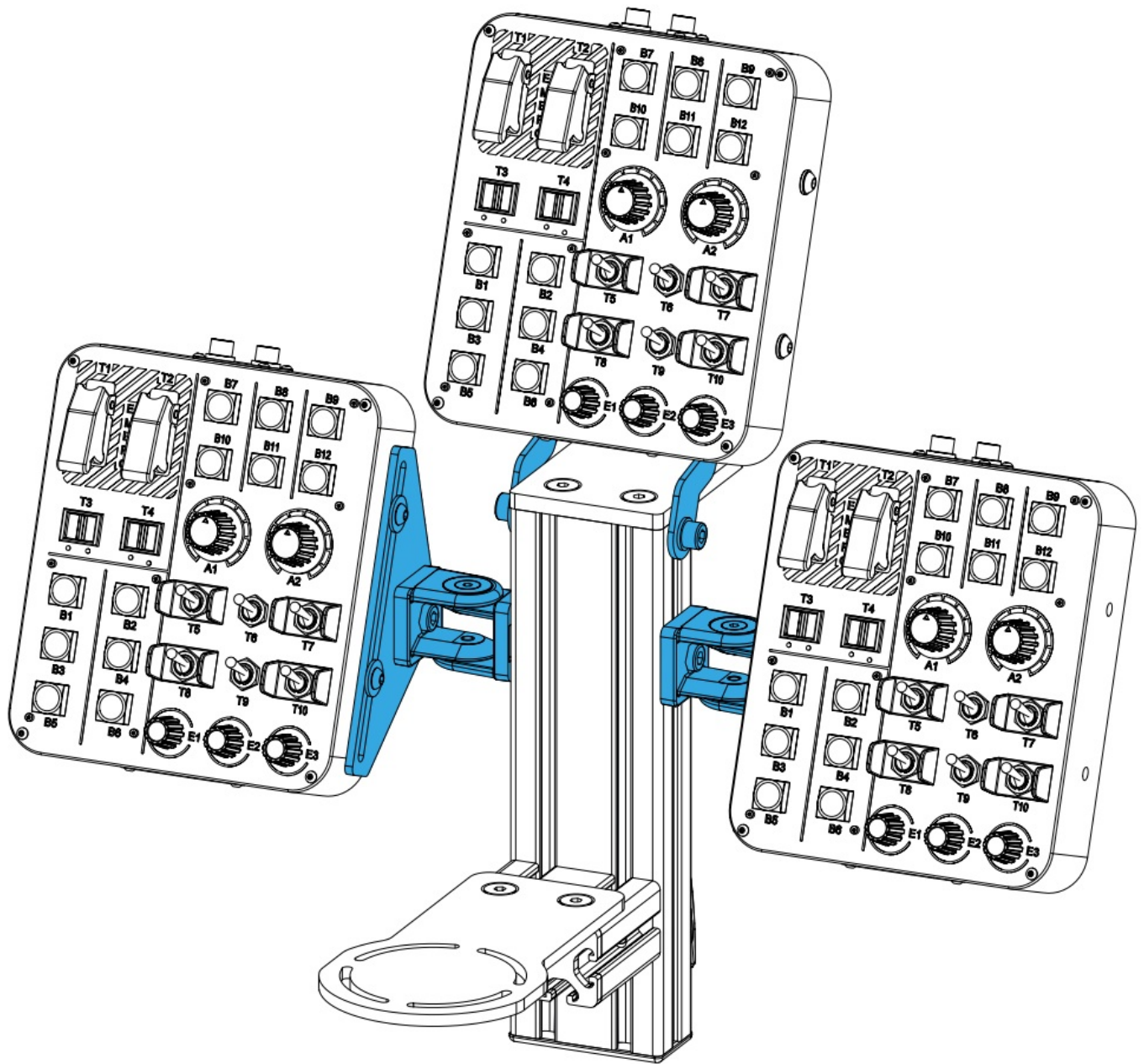

## Contents

### 1 GENERAL ASSEMBLY INFO AND HOW TO

#### 1.1 PROFILE NUT

#### 1.2 HEX KEY SET WITH BALL HEAD + EXTENSION OR SIMILAR REQUIRED

#### 1.3 UNIVERSAL CONNECTOR

#### 1.4 BOLT DIMENSIONS AND HOW TO MEASURE THEM [mm]

#### 1.5 PROFILE CAP ASSEMBLY

### 2 PARTS FOR CENTER MOUNT

### 3 PARTS FOR SIDE MOUNT

### 4 CENTER ASSEMBLY

### 5 ASSEMBLY FOR SIDE MOUNT

### 6 Documents / Resources

#### 6.1 References

### 7 Related Posts

## GENERAL ASSEMBLY INFO AND HOW TO

### PROFILE NUT

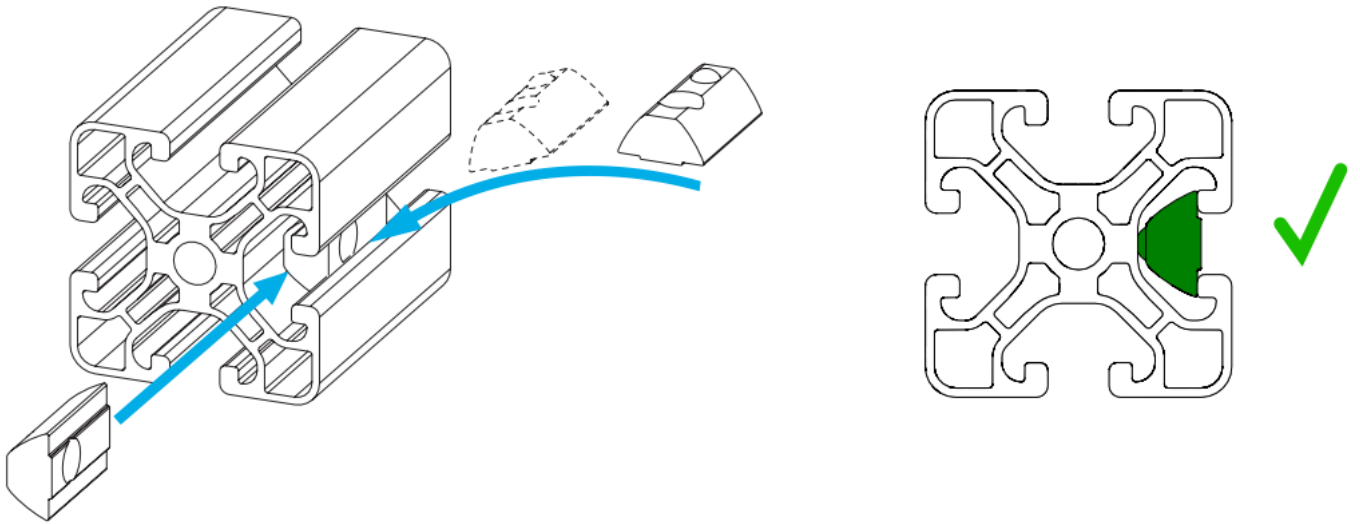

**HEX KEY SET WITH BALL HEAD + EXTENSION OR SIMILAR REQUIRED**

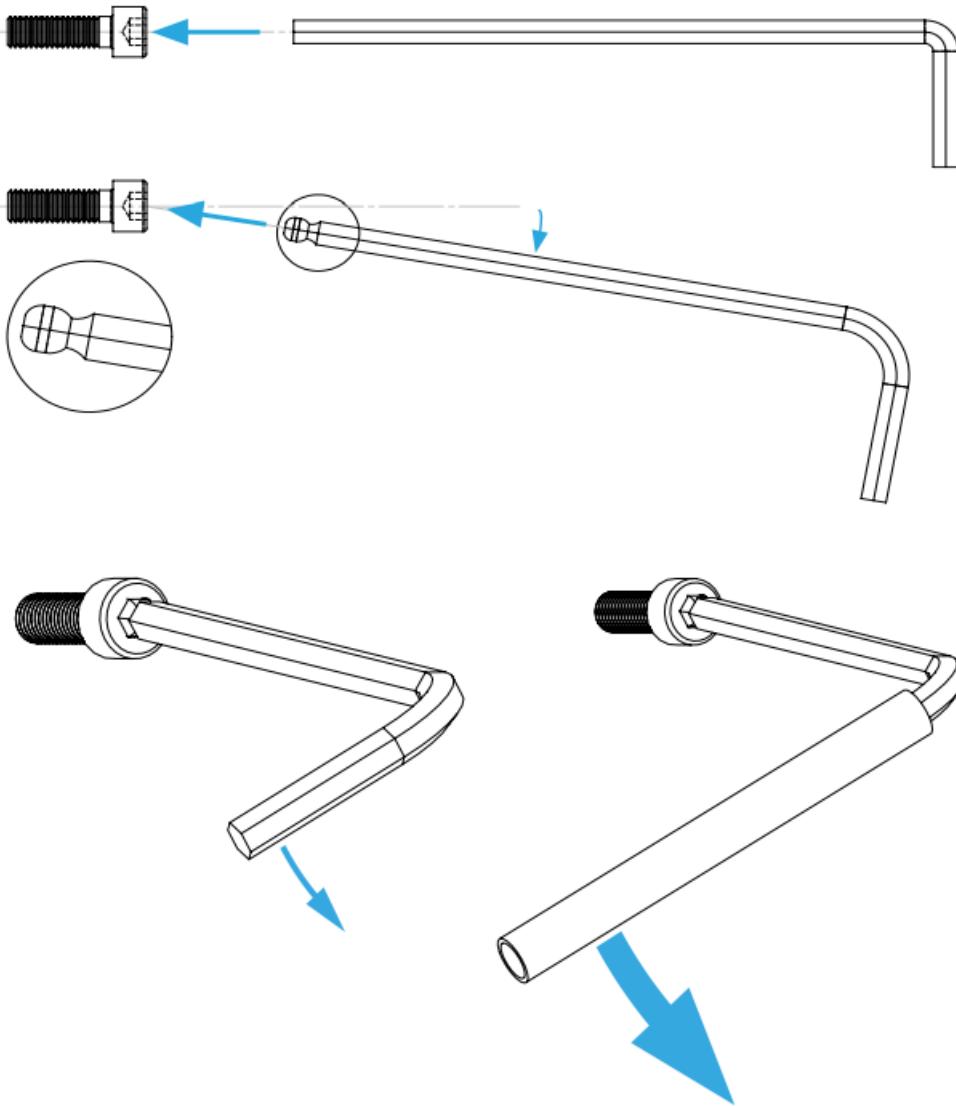

**UNIVERSAL CONNECTOR**

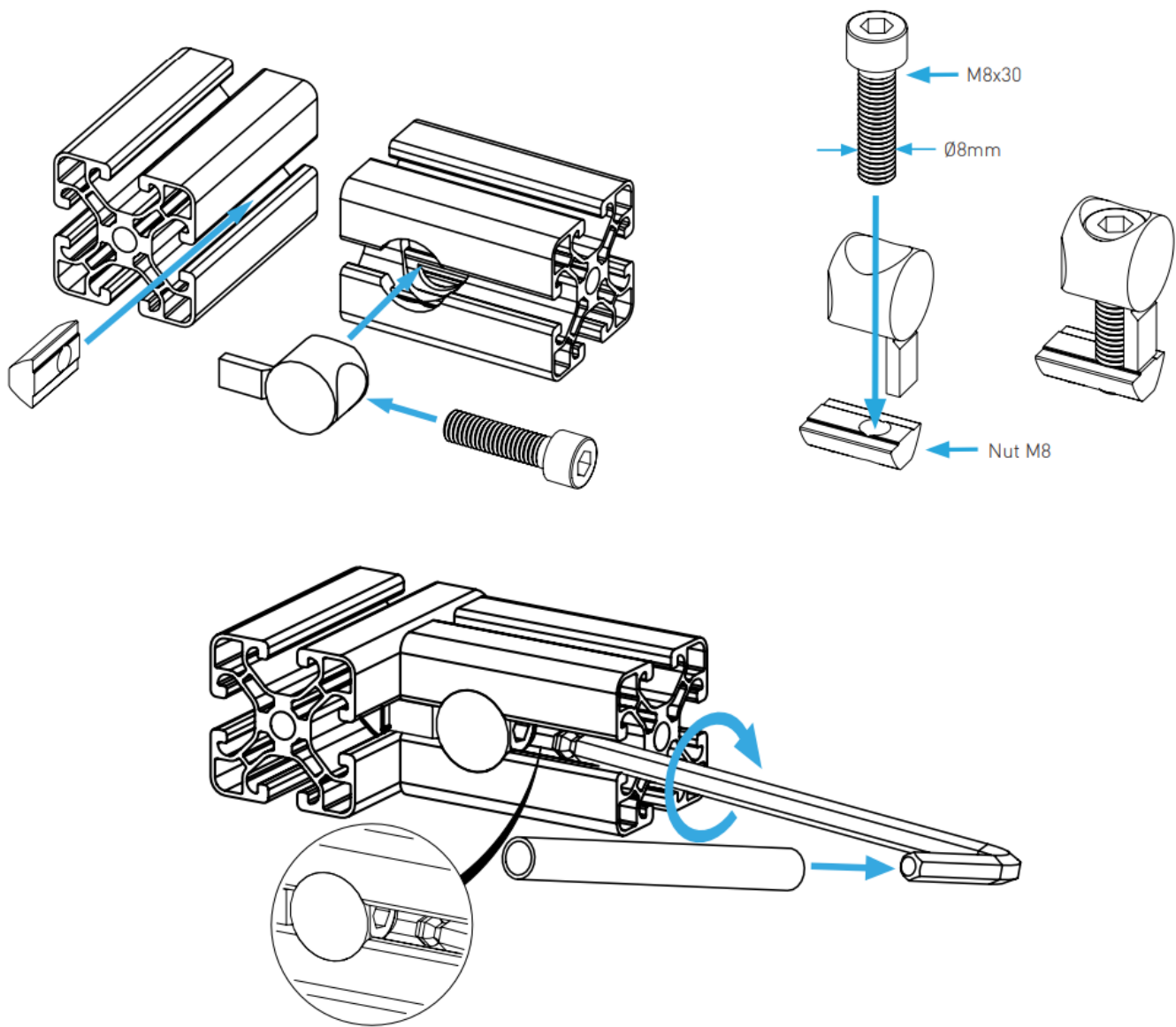

#### BOLT DIMENSIONS AND HOW TO MEASURE THEM [mm]

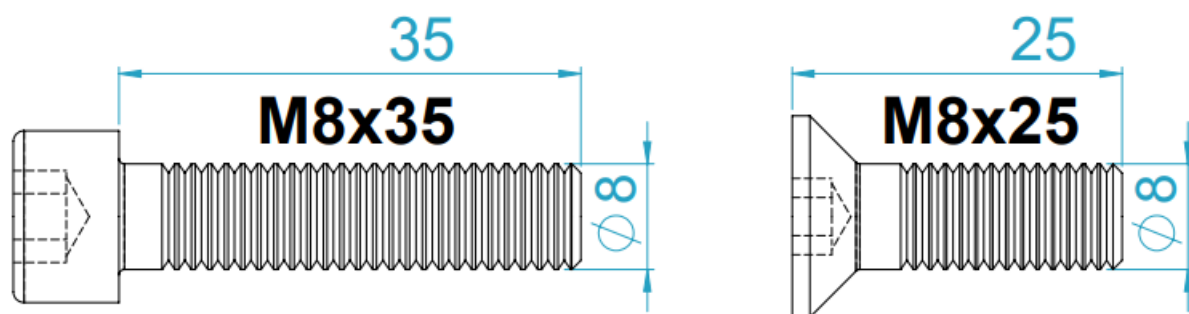

#### PROFILE CAP ASSEMBLY

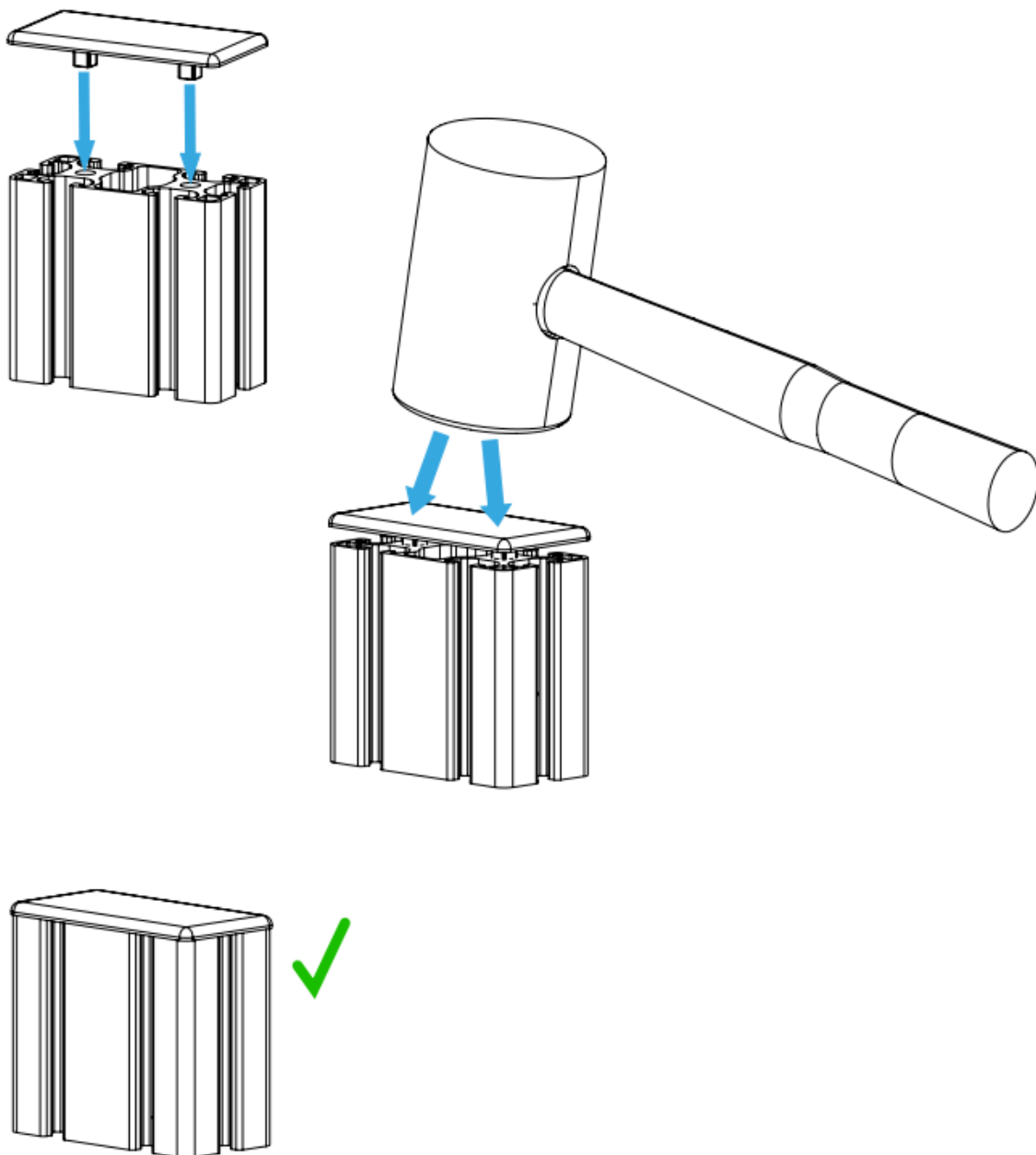

**PARTS FOR CENTER MOUNT**

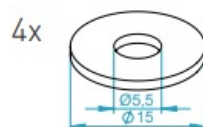
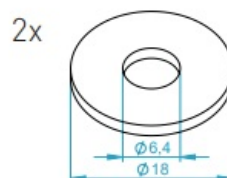
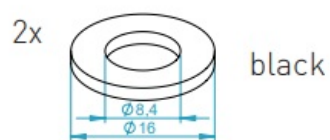
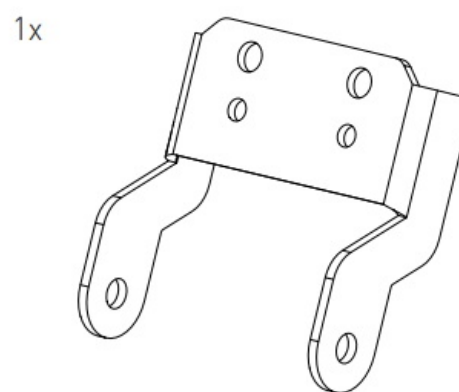
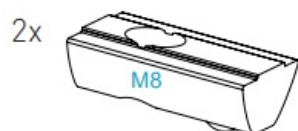
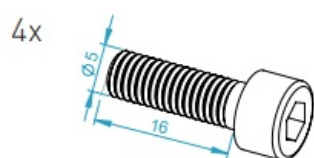
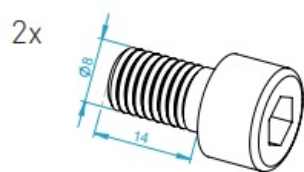
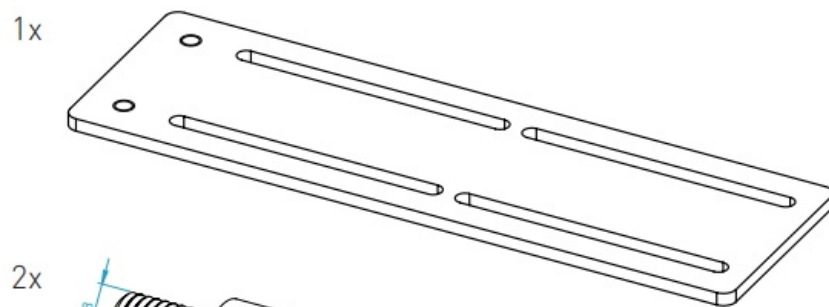

## PARTS FOR SIDE MOUNT

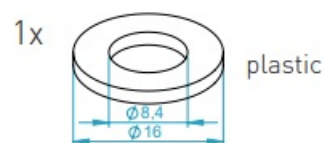
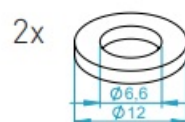
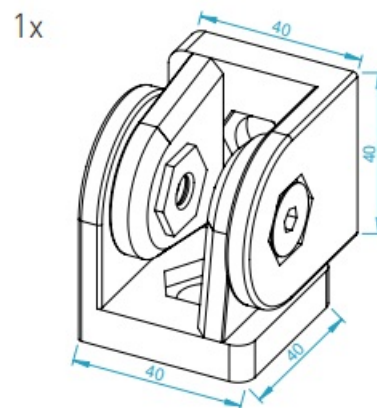
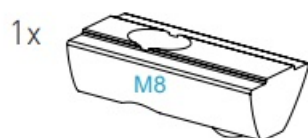
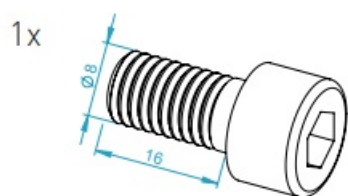
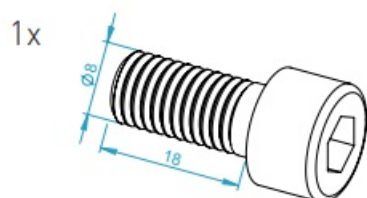
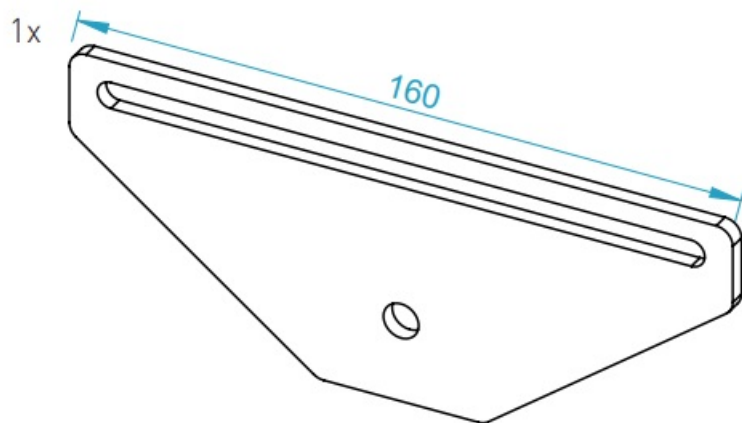

## CENTER ASSEMBLY

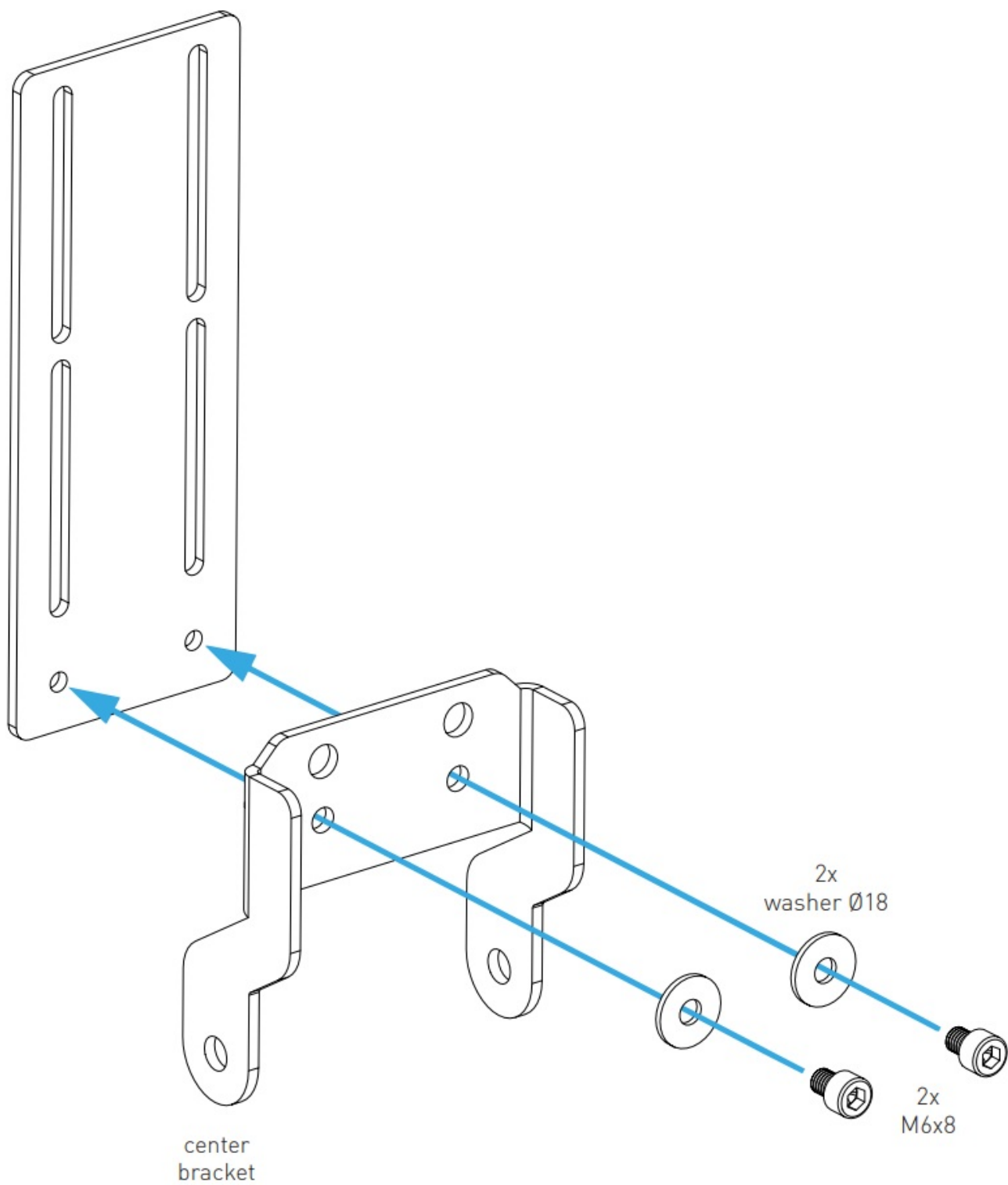



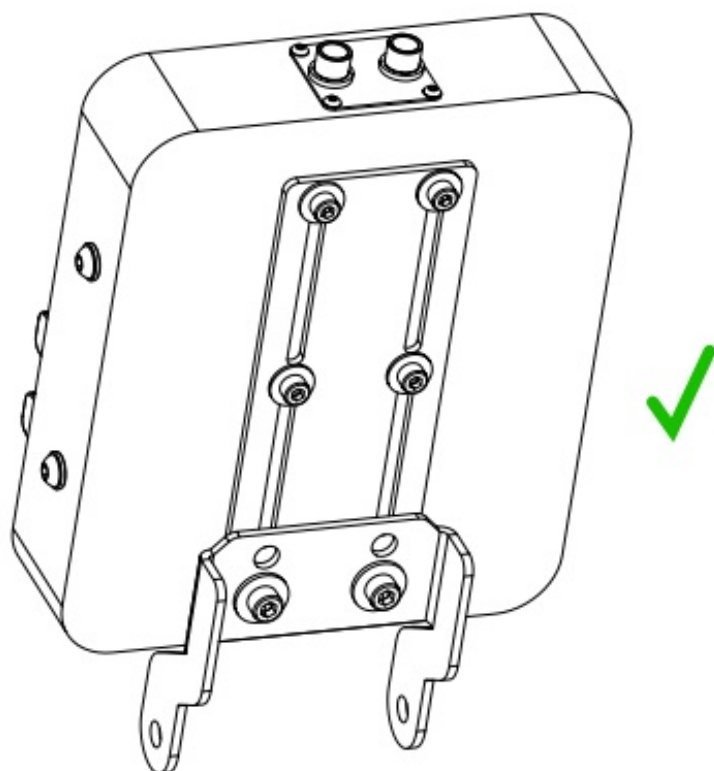
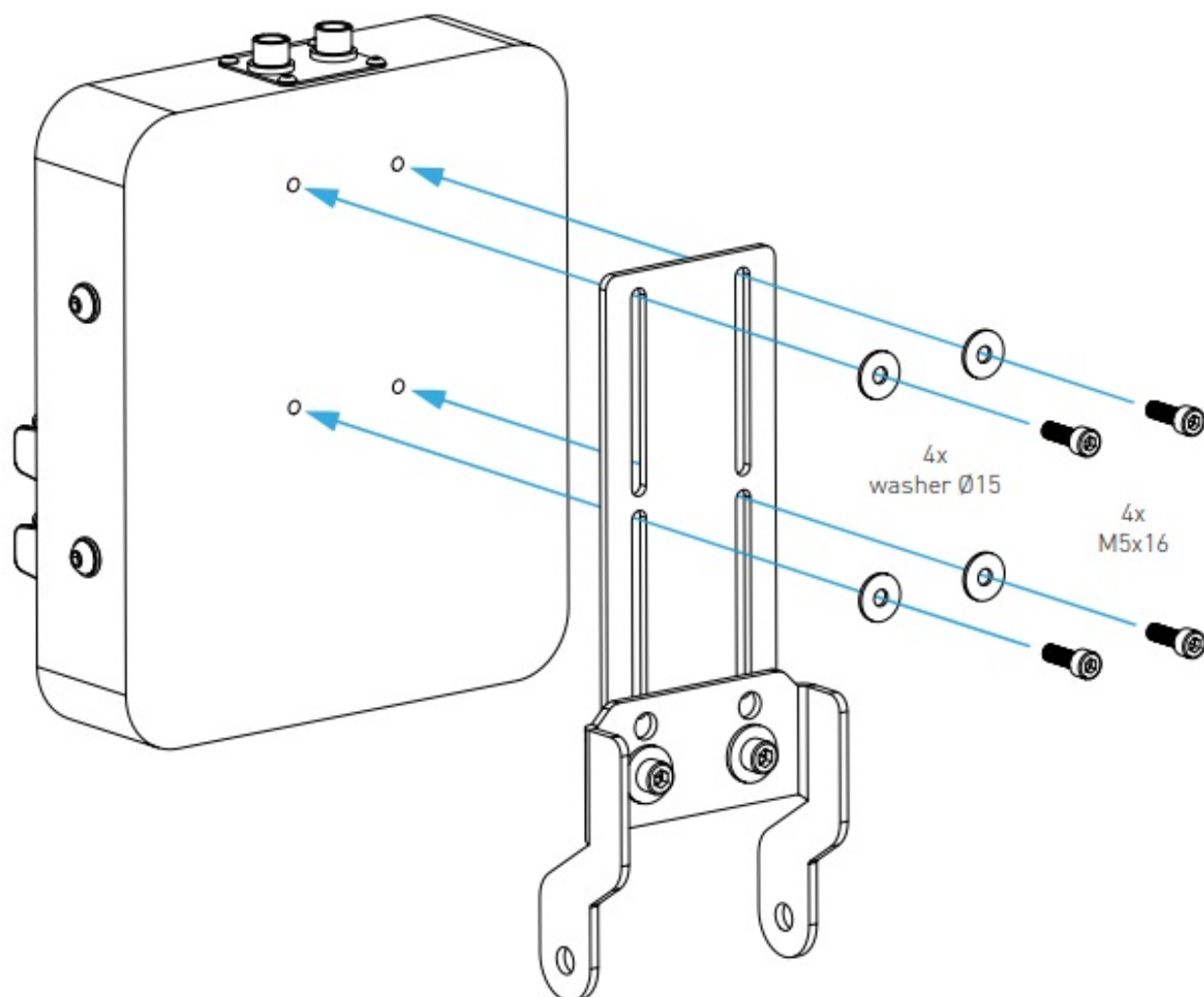

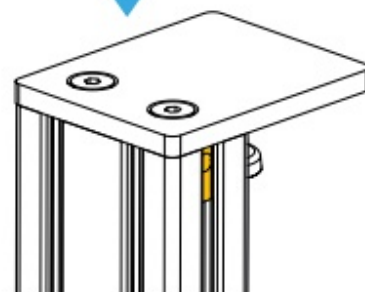
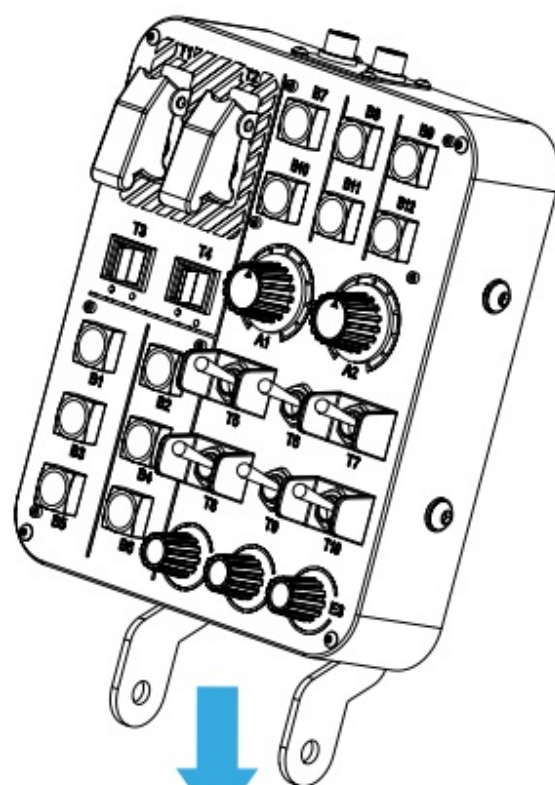
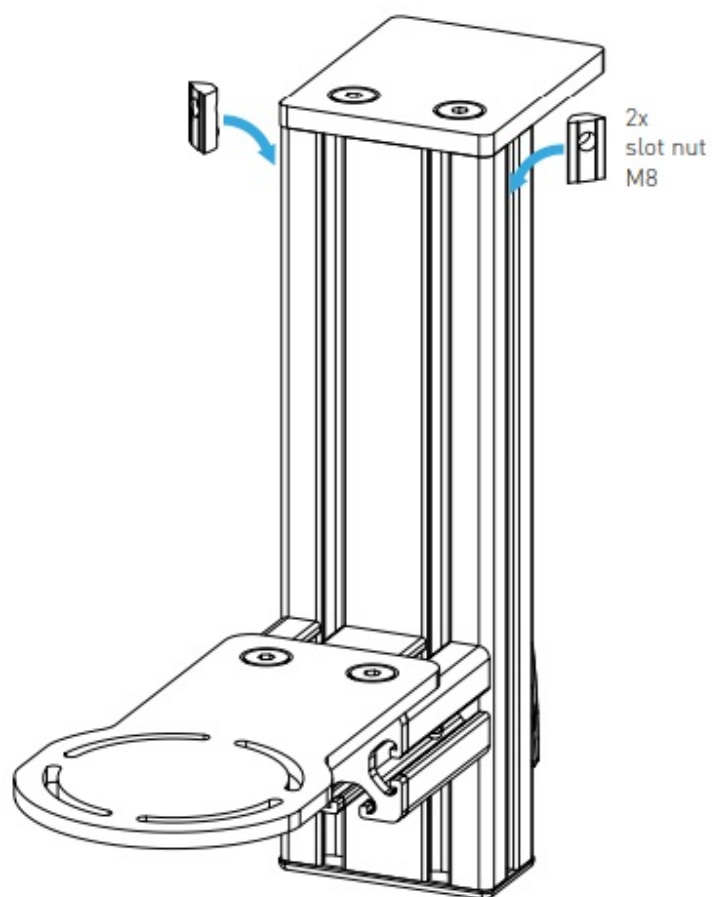

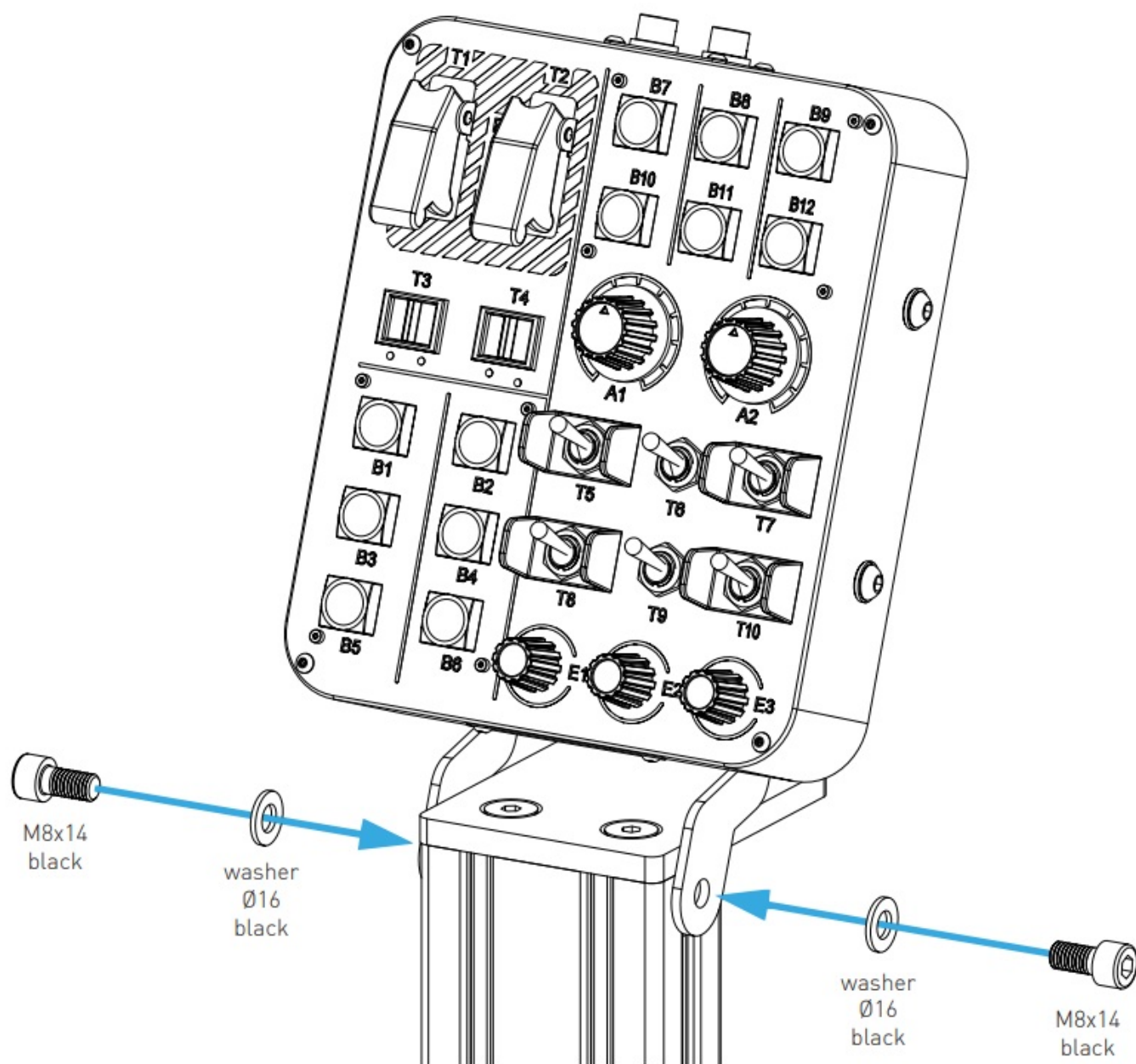

## ASSEMBLY FOR SIDE MOUNT

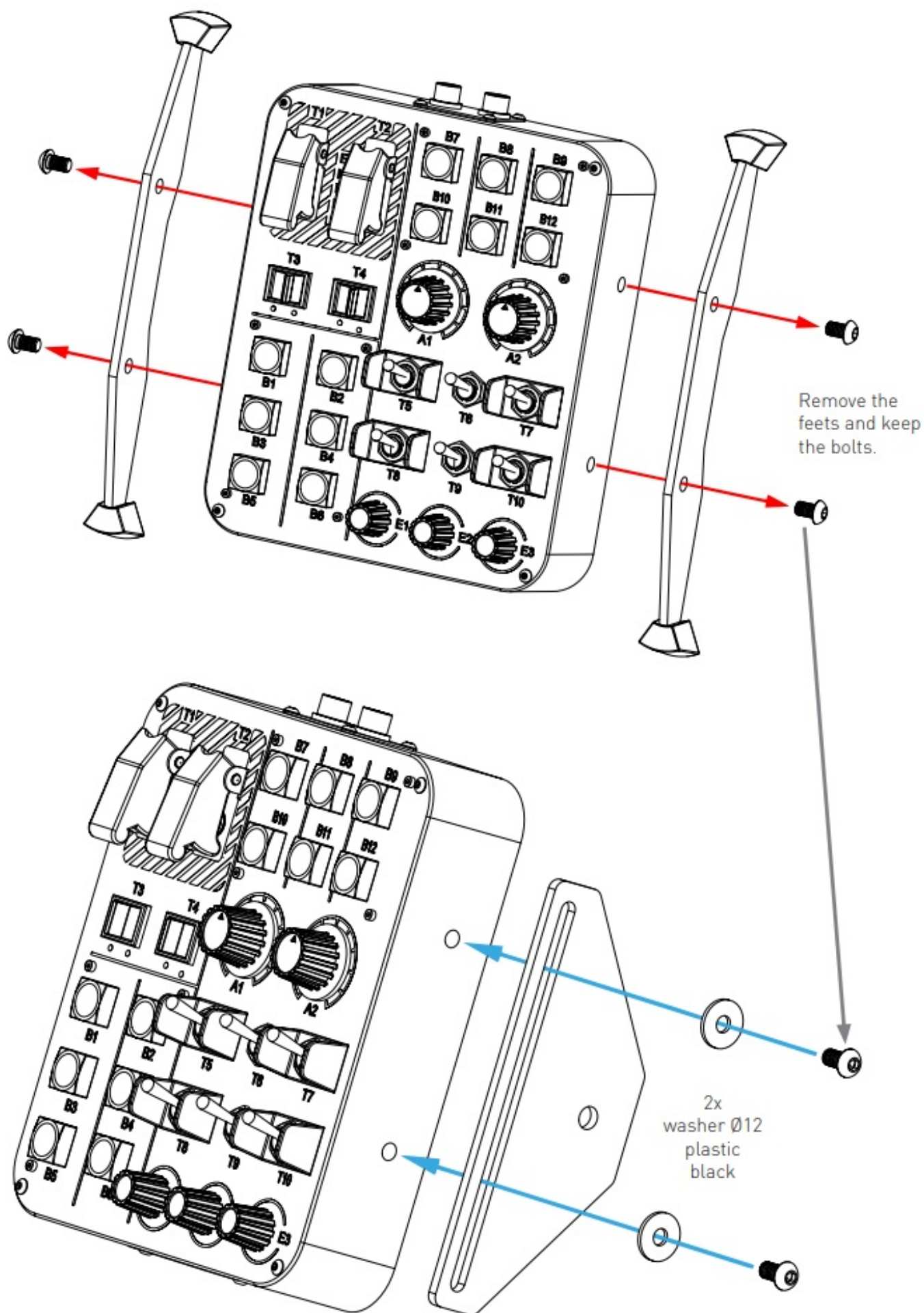

A locknut has to be rough-running on a bolt.

Therefore you need to use a wrench and a hex key to tighten it. Hold up the M8x18 bolt with the hex key while

tighten the locknut with the wrench (or reverse).

Its perfect tighten if you still can angle your mounted device but it is tight enough not to move unintentional.

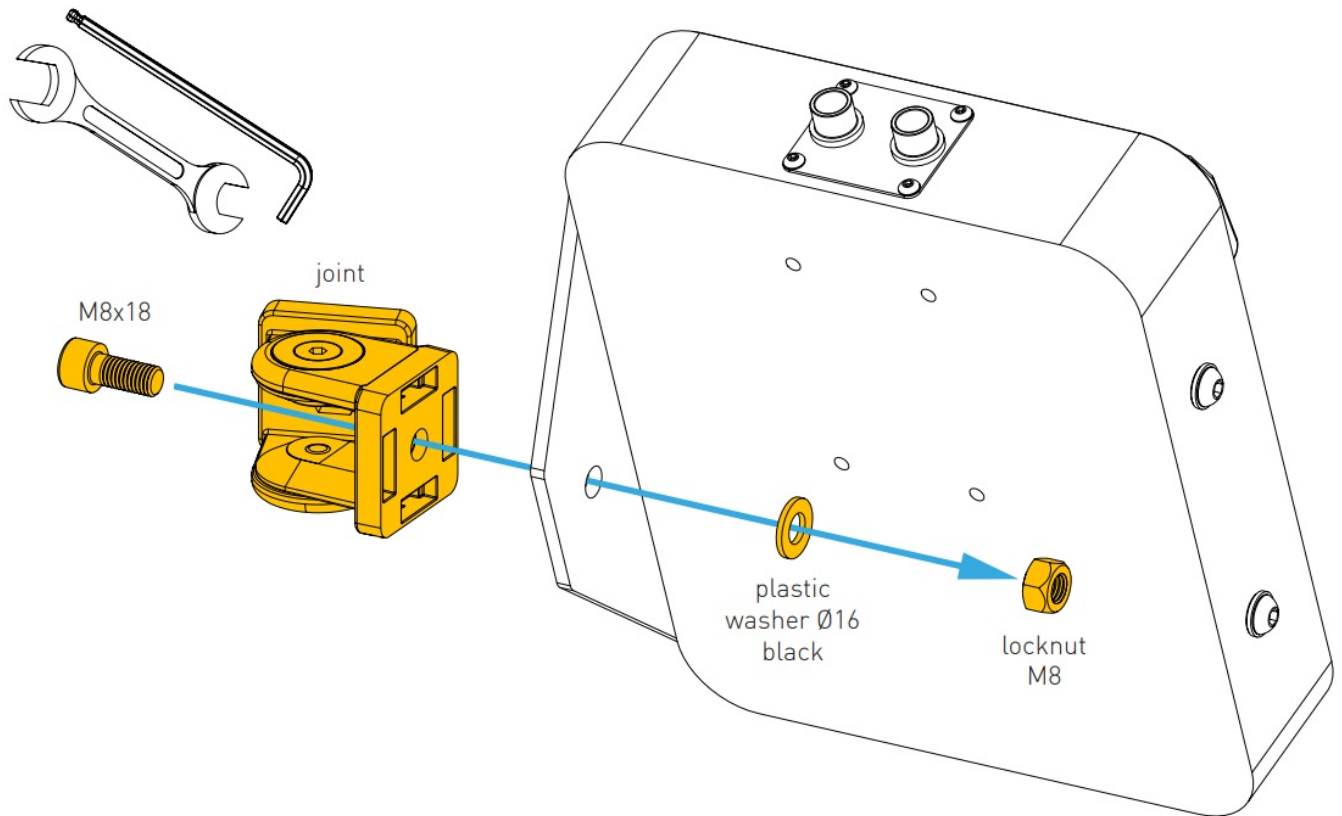



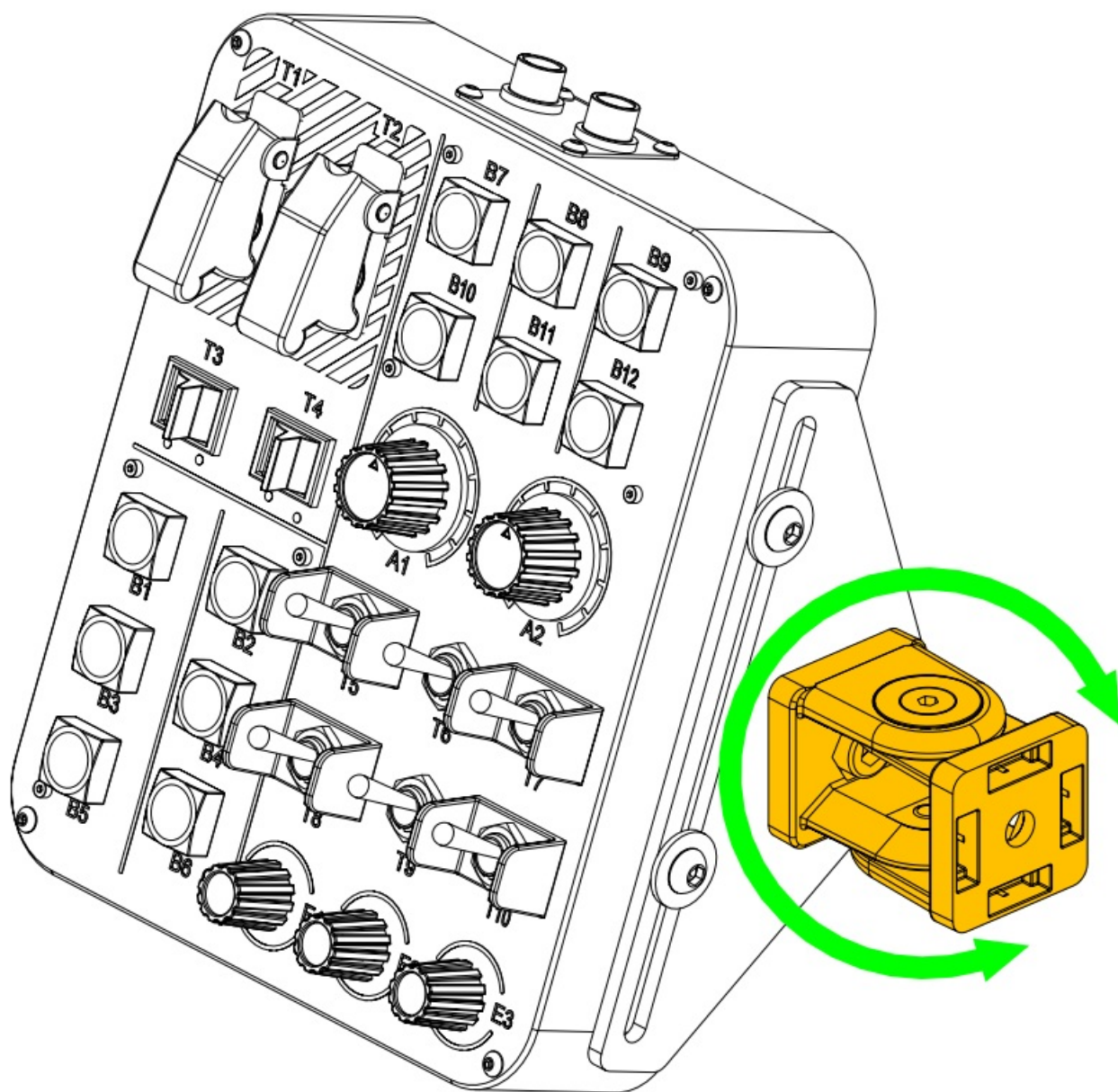

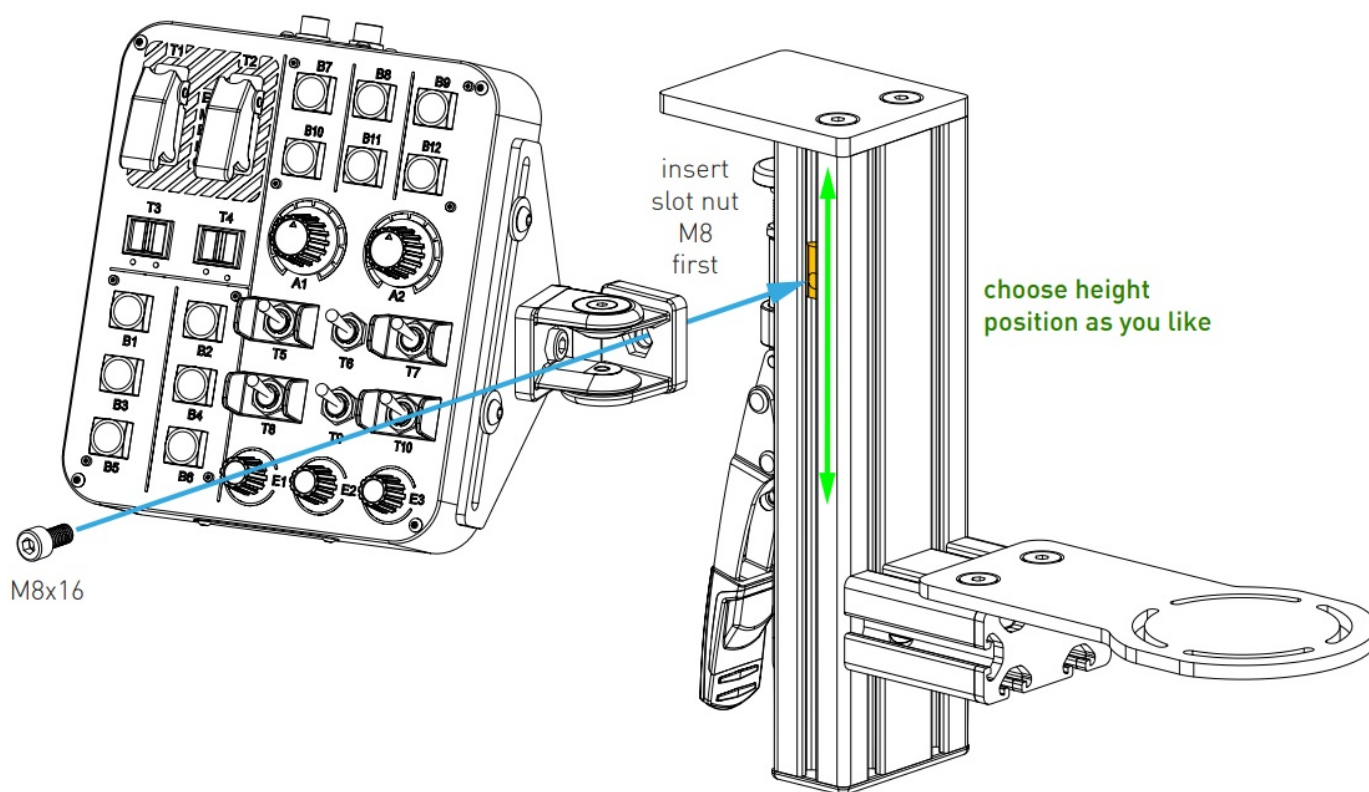
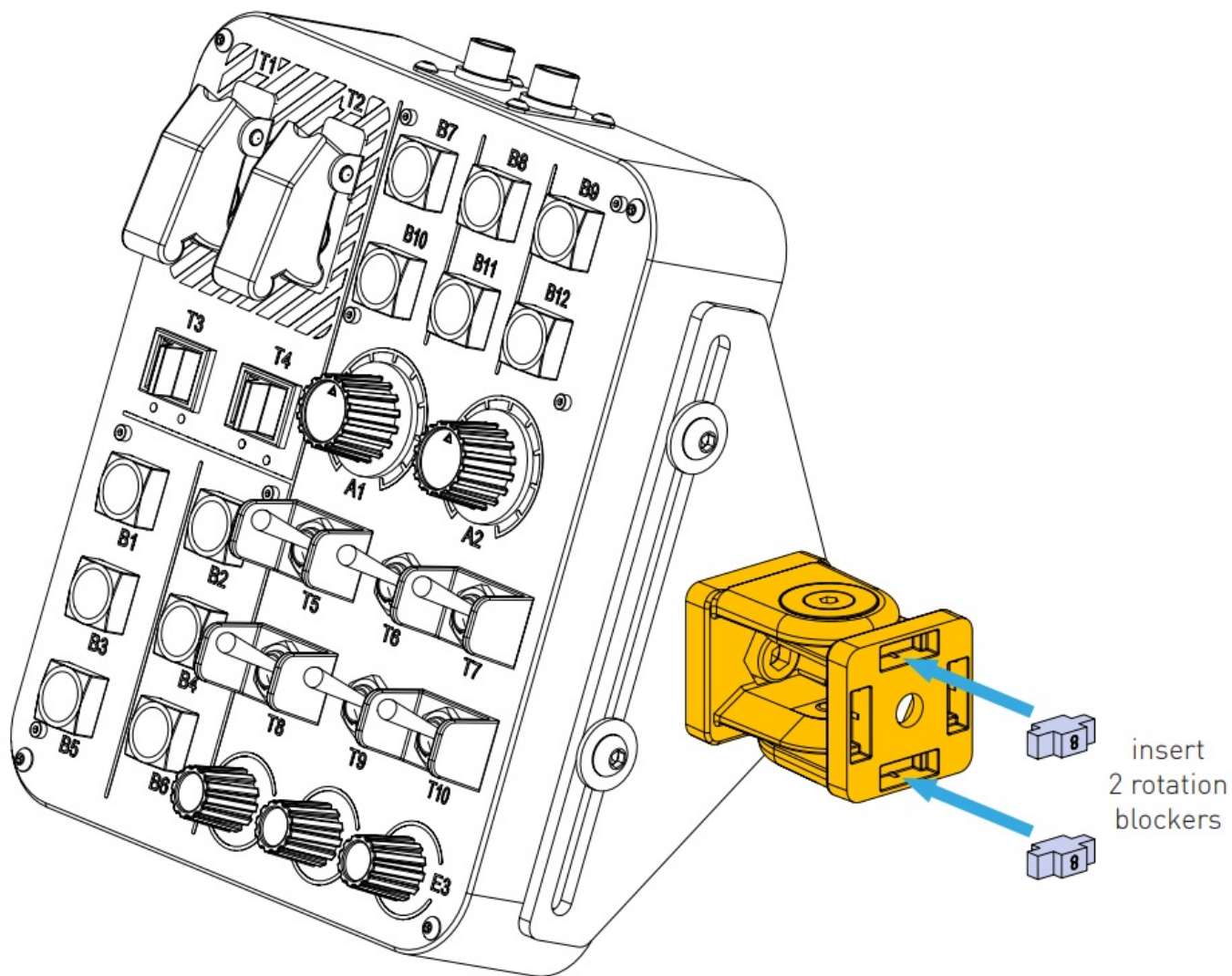

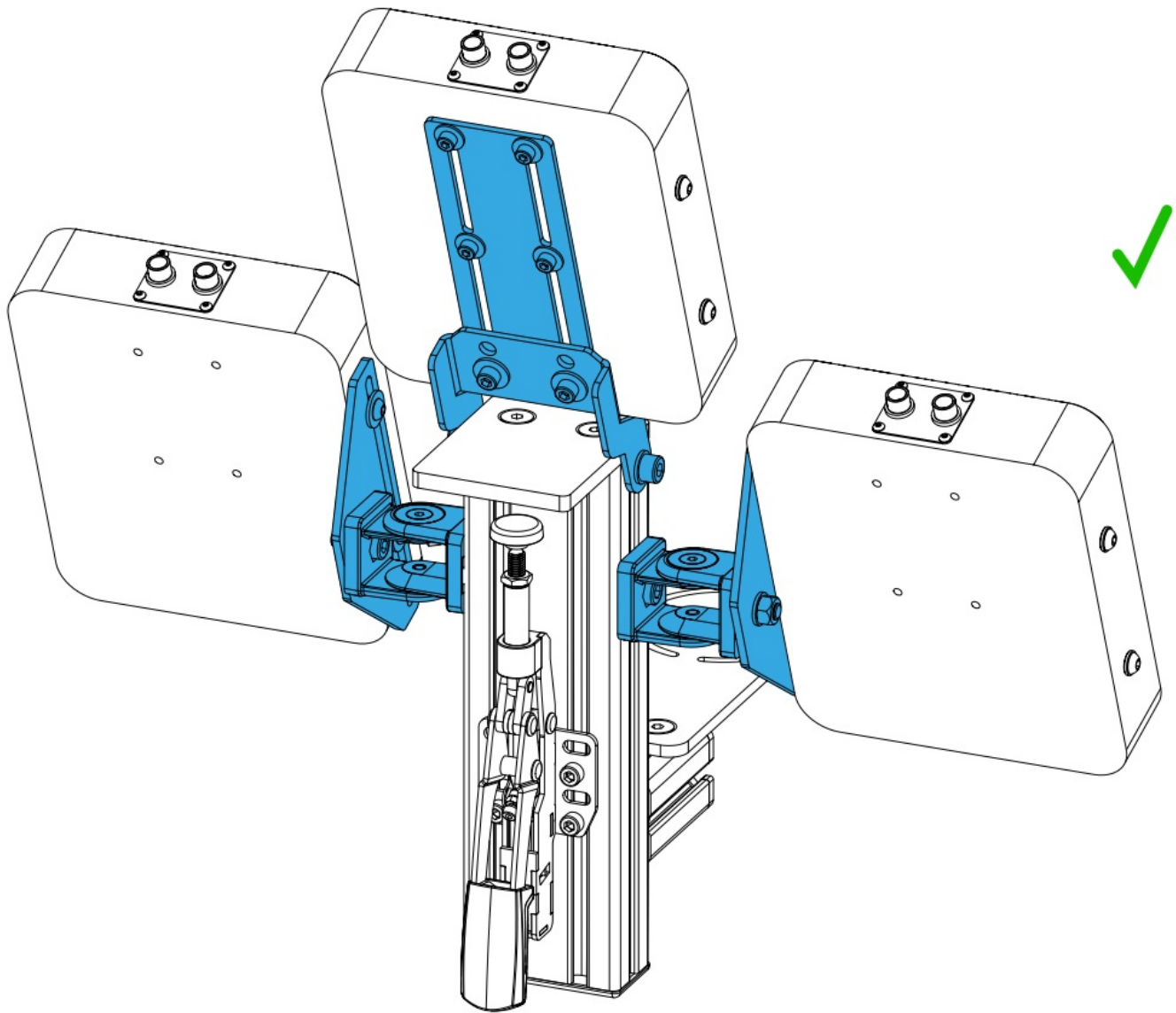

#### WARNING NOTICES

**CAUTION!** Do not clamp your fingers while attaching the table mount.

**CAUTION!** Check before usage if all screws are tightened.

**CAUTION!** Check before usage that the mounting plate is screwed on tight after making height adjustments.

**DANGER: Contains small parts not suitable for children under 3 years.**

**Only suitable for children over 12 years and adults.**

All MONSTERTECH products are hand assembled and quality checked.

The mount is designed for usage only with a computer controller (f.e. joystick or throttle).

We exclude liability if the product is used for purposes other than intended.

MONSTERTECH shall be liable for damage arising from causes other than the detriment to life, body and health only to the extent that such damage arises from willful misconduct, gross negligence or the culpable violation of a fundamental contractual obligation on the part of MONSTERTECH or a vicarious agent (e.g. the delivery service) of MONSTERTECH. Any further liability for damages shall be excluded.

If you have safety concerns or questions regarding assembly, contact us under [info@mtsim.com](mailto:info@mtsim.com) or visit [www.mtsim.com/en](http://www.mtsim.com/en)



---

## Documents / Resources

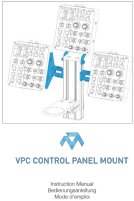
	<p><b><a href="#">MONSTERTECH VPC Control Panel Mount</a></b> [pdf] Instruction Manual VPC Control Panel Mount, VPC, Control Panel Mount, Panel Mount</p>
---	---

## References

- [↗ MTSIM – MONSTERTECH – Simulation Design – Offizielle Webseite](#)
- [↗ MTSIM – MONSTERTECH – Simulation Design – Official Website](#)
- [↗ MTSIM – MONSTERTECH – Simulation Design – Site officiel](#)
- [User Manual](#)