

Contents [[hide](#)]

- 1 MONSTERTECH Sim Stand Wheel
- 2 Product Usage Instructions
- 3 GENERAL ASSEMBLY INFO AND HOW TO PROFILE NUT
- 4 HEX KEY SET WITH BALL HEAD
- 5 UNIVERSAL CONNECTOR
- 6 ALTERNATIVE
- 7 BOLT DIMENSIONS
- 8 PROFILE CAP ASSEMBLY
- 9 PARTS
- 10 ASSEMBLY
- 11 Compatibility
- 12 SAFETY INSTRUCTION
- 13 Frequently Asked Questions
- 14 Documents / Resources
 - 14.1 References



MONSTERTECH Sim Stand Wheel



Product Specifications

- **Universal Connector:** M8x30
- **Profile Cap Assembly:** M6 and M8 screws
- **Wheel Dimensions:** Various sizes (refer to manual)
- **Compatibility:** Suitable for common flight and racing simulator accessories
- **Age Recommendation:** Suitable for children over 12 years and adults

Product Usage Instructions

General Assembly Information

Ensure you have a hex key set with a ball head or extension for assembly.

Assembly Steps

1. Prepare the universal connector by sliding in the very loose pre-assembled M8x30 connector, or use the alternative slot nut M8.
2. Use suitable screws for your wheel to attach it securely.
3. Assemble the wheel front using the provided M8x14 black screws and washers.
4. Check all screws are tightened before usage to avoid any mishaps.

Compatible Wheels

The product is compatible with wheels that meet the following dimensions: 167.5mm x

24.3mm x 17.4mm.

GENERAL ASSEMBLY INFO AND HOW TO PROFILE NUT

MONSTERTECH-Sim-Stand-Wheel-FIG-1

HEX KEY SET WITH BALL HEAD

EXTENSION OR SIMILAR REQUIRED

MONSTERTECH-Sim-Stand-Wheel-FIG-2

UNIVERSAL CONNECTOR

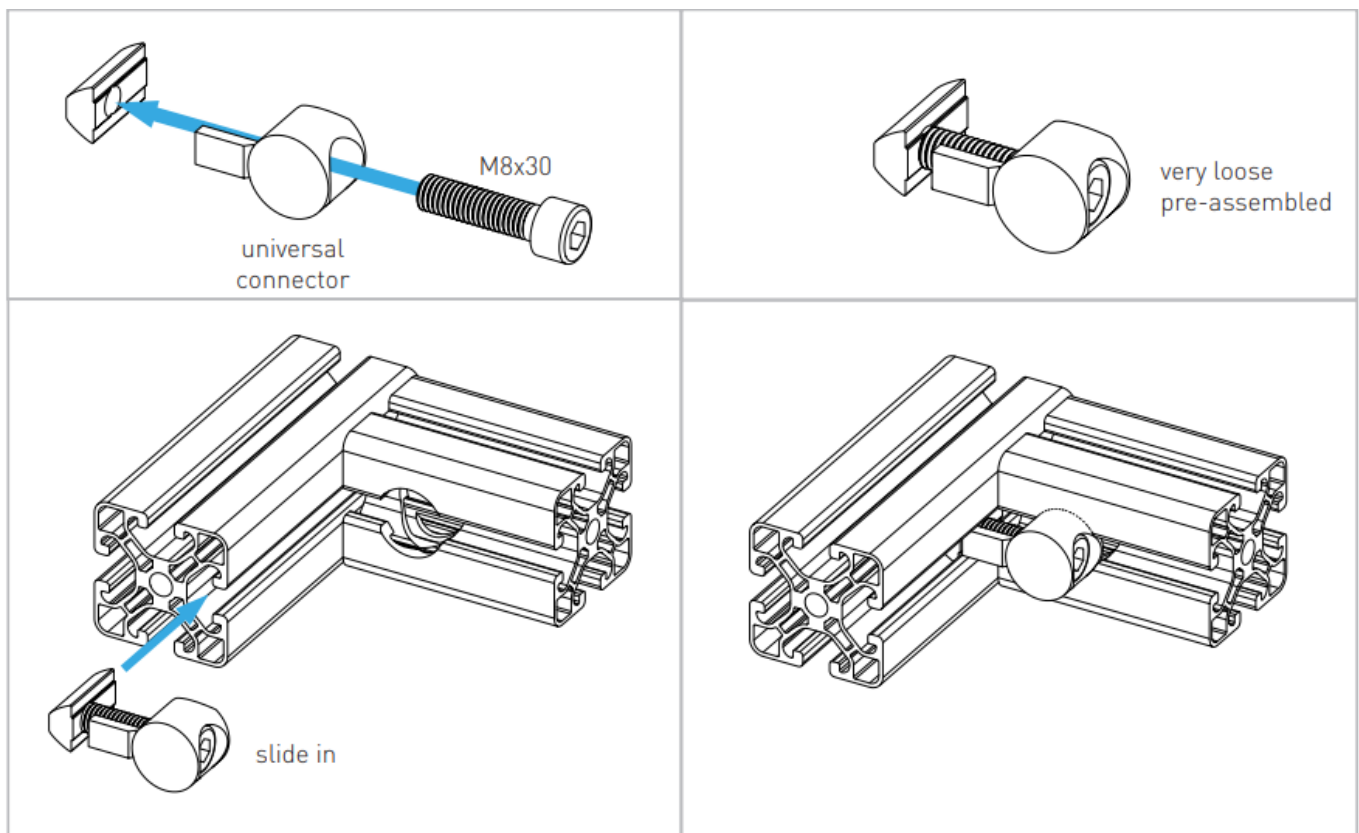

ALTERNATIVE

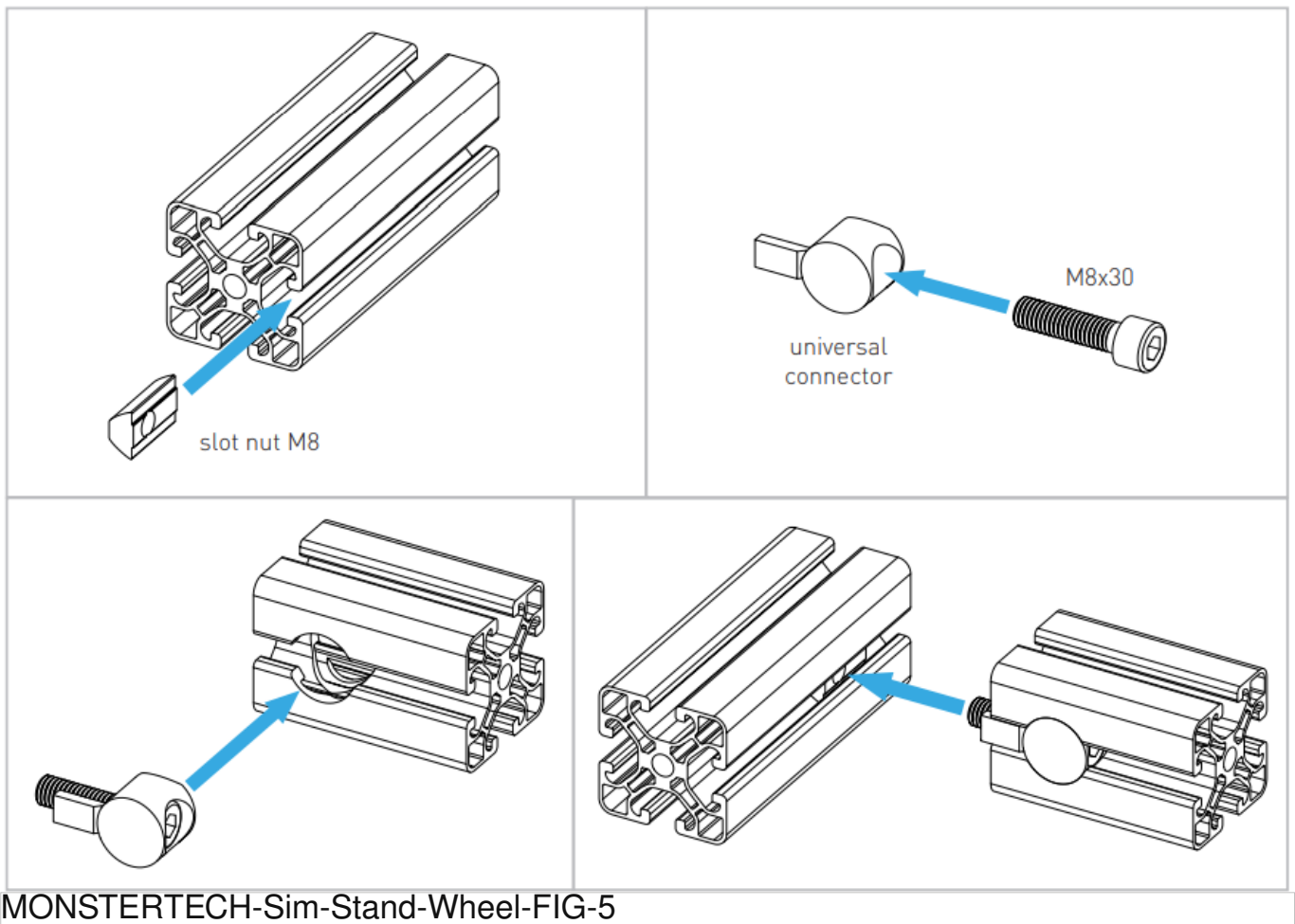

BOLT DIMENSIONS

BOLT DIMENSIONS AND HOW TO MEASURE THEM [mm]

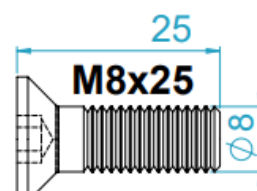
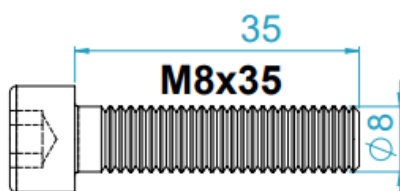

PROFILE CAP ASSEMBLY

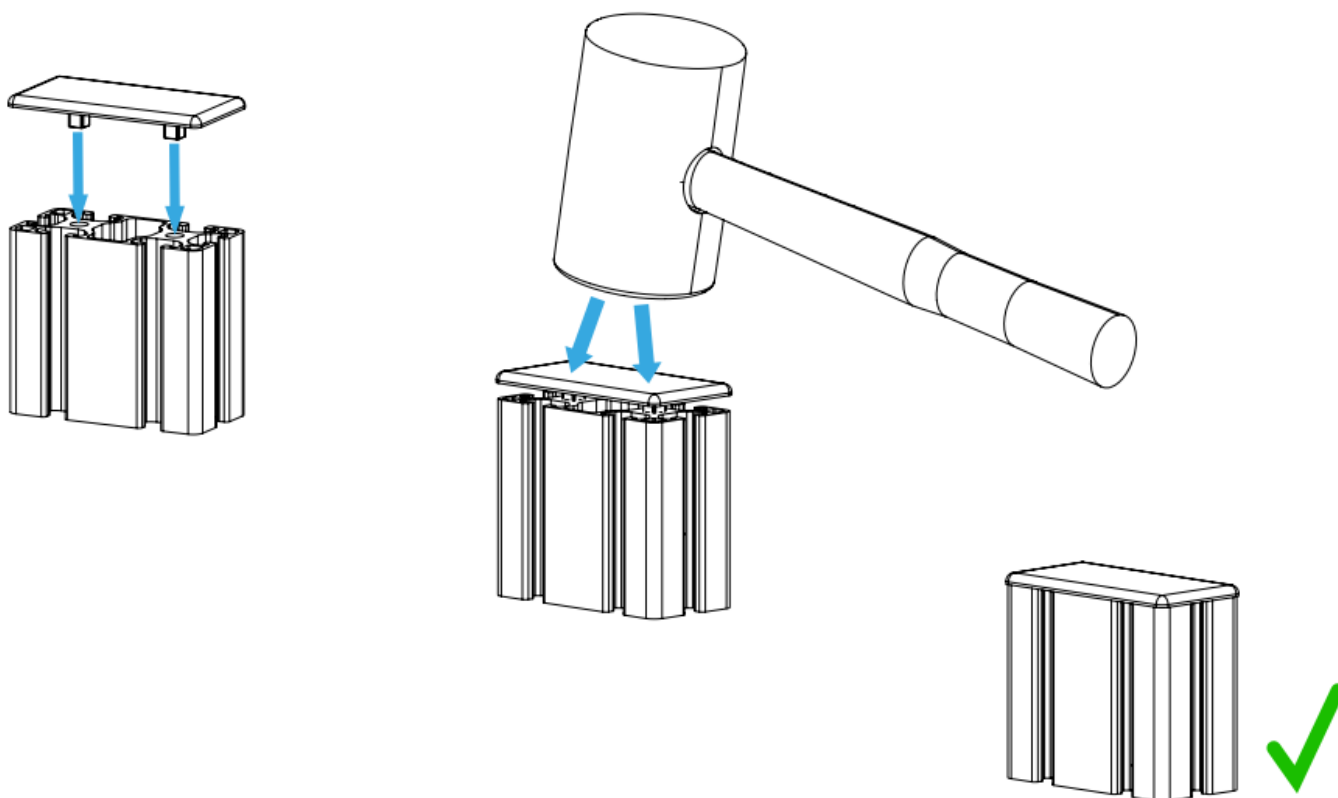

PARTS

WHEEL FLAT

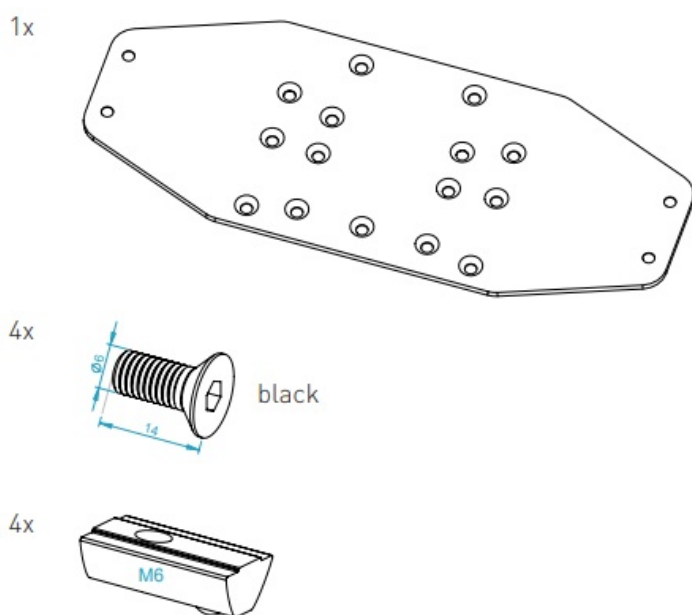

A selection of screws for mounting your wheel:

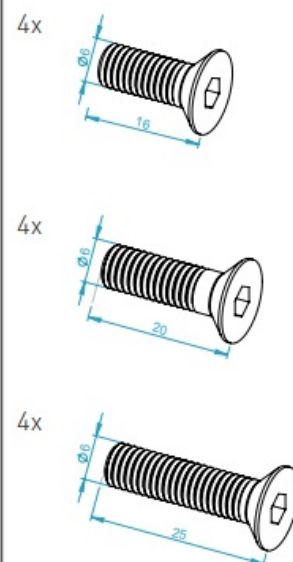

WHEEL FRONTAL

MONSTERTECH-Sim-Stand-Wheel-FIG-9

ASSEMBLY

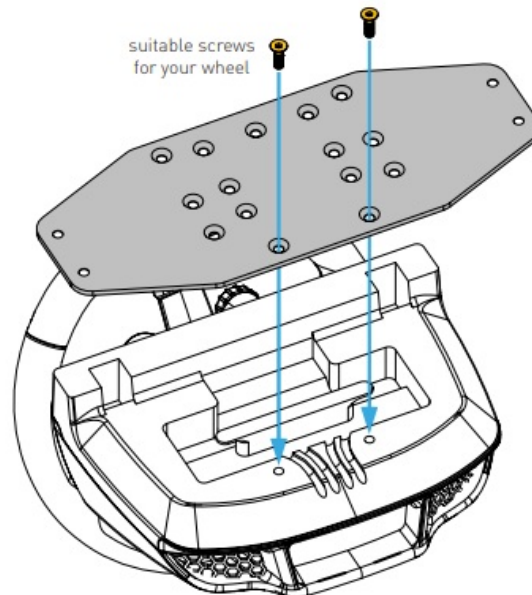
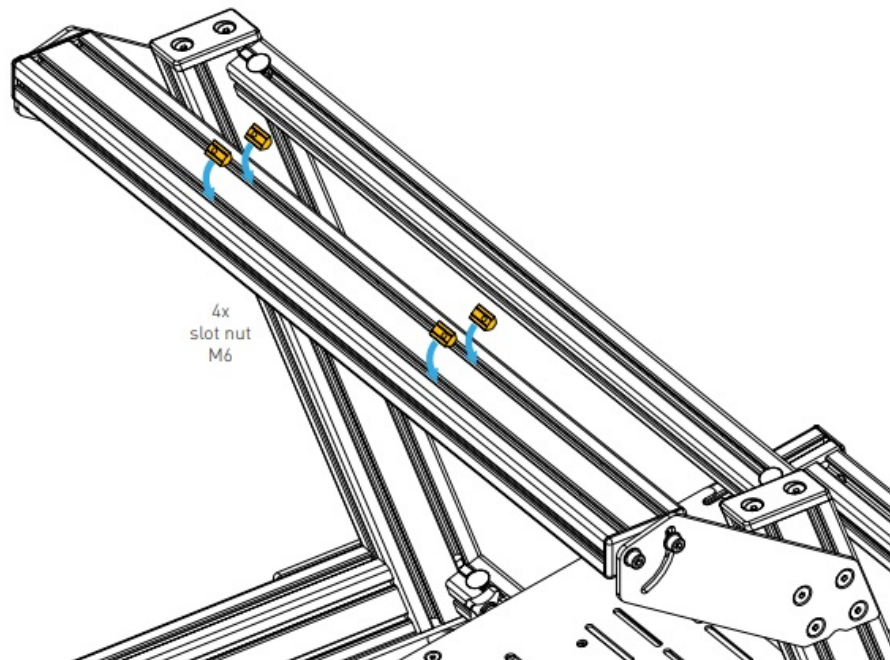

Compatibility

- **Fanatec Base**

- DDI / DD2 / CSL DD / DD PRO CSL Elite

- **CAMMUS LP8 Base**

- MOZA R9 / R16 / R21
- SIMCUBE Mount
- Simagic Alpha EVO Wheel Base

- **Trustmaster**

- TX Servo Base
- TS-XW Servo Base
- T-GT und T-GT 11 Racing Wheel

- T 248 / T 300 / T300RS / T500RS

- **Trustmaster**

- T818 Base (with mounting kit)

- **Logitech**

- G25/G27/G29/G920/G923
- PRO Racing Wheel

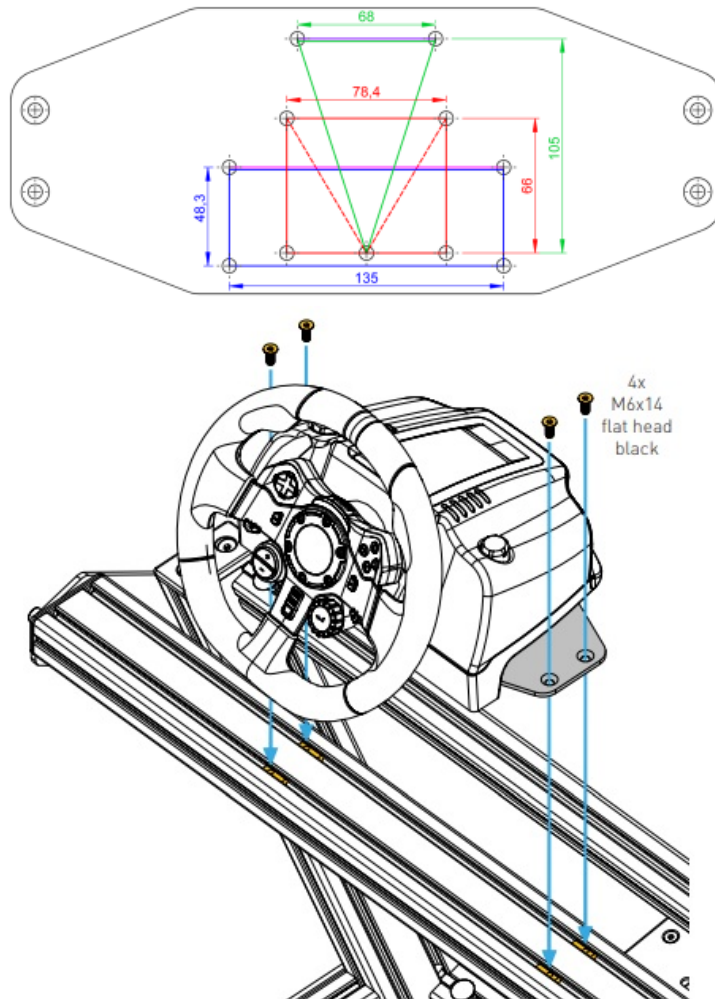

ASSEMBLY FOR FRONTAL WHEEL

MONSTERTECH-Sim-Stand-Wheel-FIG-13

Compatible Wheels:

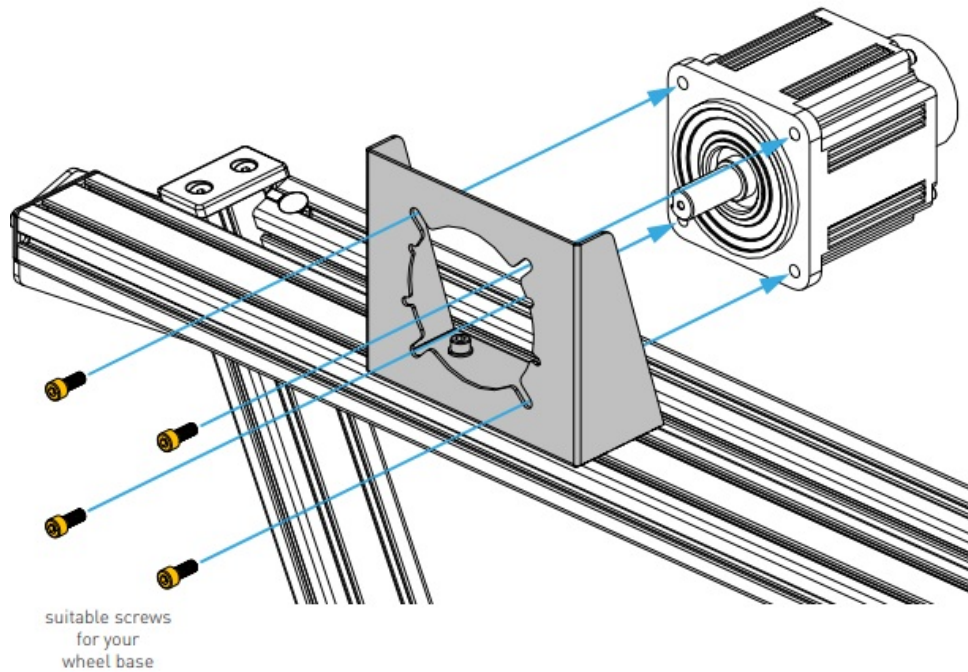

- SimXperience AccuForce Pro V2
- Lenze MCS Electro Motor
- MIGE 130ST Electro Motor
- SimuCube 2 Sport, Pro, Ultimate
- Simagic Alpha EVO Wheel Base
- Sensodrive SensoWheel SD-LC



SAFETY INSTRUCTION



WARNING NOTICES

-  **CAUTION!** Do not clamp your fingers while assembling the Sim Stand Wheel.
-  **CAUTION!** Check before usage if all screws are tightened.
-  **DANGER:** Contains small parts not suitable for children under 3 years.
- Only suitable for children over 12 years and adults.
- All MTSIM products are hand assembled and quality checked.
- The Sim Stand is only for the use of common flight and racing simulator accessories in conjunction with MTSIM mounts.
- We exclude liability if the product is used for purposes other than intended.
- MTSIM shall be liable for damage arising from causes other than the detriment to life, body, and health only to the extent that such damage arises from wilful misconduct, gross negligence or the culpable violation of a fundamental contractual obligation on the part of MTSIM or a vicarious agent (e.g., the delivery service) of MTSIM. Any further liability for damages shall be excluded.
- If you have safety concerns or questions regarding assembly, contact us under info@mtsim.com or visit www.mtsim.com/en/

Frequently Asked Questions

What is the recommended age for using the Sim Stand Wheel?

The Sim Stand Wheel is recommended for children over 12 years and adults.

Documents / Resources

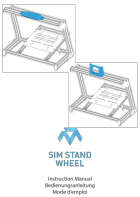
	<p>MONSTERTECH Sim Stand Wheel [pdf] Instruction Manual</p> <p>SimXperience AccuForce Pro V2, Lenze MCS Electro Motor, MIGE 130S T Electro Motor, SimuCube 2 Sport, Pro, Ultimate, Simagic Alpha EVO Wheel Base, Sensodrive SensoWheel SD-LC, Sim Stand Wheel, Stand Wheel, Wheel</p>
---	---

References

- [User Manual](#)

Monstertech

Lenze MCS Electro Motor, MIGE 130ST Electro Motor, Monstertech, Pro, Sensodrive SensoWheel SD-LC, Sim Stand Wheel, Simagic Alpha EVO Wheel Base, SimuCube 2 Sport, SimXperience AccuForce Pro V2, Stand Wheel, UltimatE, Wheel

Leave a comment

Your email address will not be published. Required fields are marked *

Comment *

Name

Email

Website

☐ Save my name, email, and website in this browser for the next time I comment.

Post Comment

Search:

e.g. whirlpool wrf535swhz

Search

[Manuals+](#) | [Upload](#) | [Deep Search](#) | [About Us](#) | [Privacy Policy](#) | [@manuals.plus](#) | [YouTube](#) | [LinkedIn](#) | [FaceBook](#)

This website is an independent publication and is neither affiliated with nor endorsed by any of the trademark owners. The "Bluetooth®" word mark and logos are registered trademarks owned by Bluetooth SIG, Inc. The "Wi-Fi®" word mark and logos are registered trademarks owned by the Wi-Fi Alliance. Any use of these marks on this website does not imply any affiliation with or endorsement.