



MONSTERTECH 00670001 VPC Control Panel Mount Instruction Manual

[Home](#) » [Monstertech](#) » MONSTERTECH 00670001 VPC Control Panel Mount Instruction Manual 



VPC CONTROL PANEL MOUNT Instruction Manual

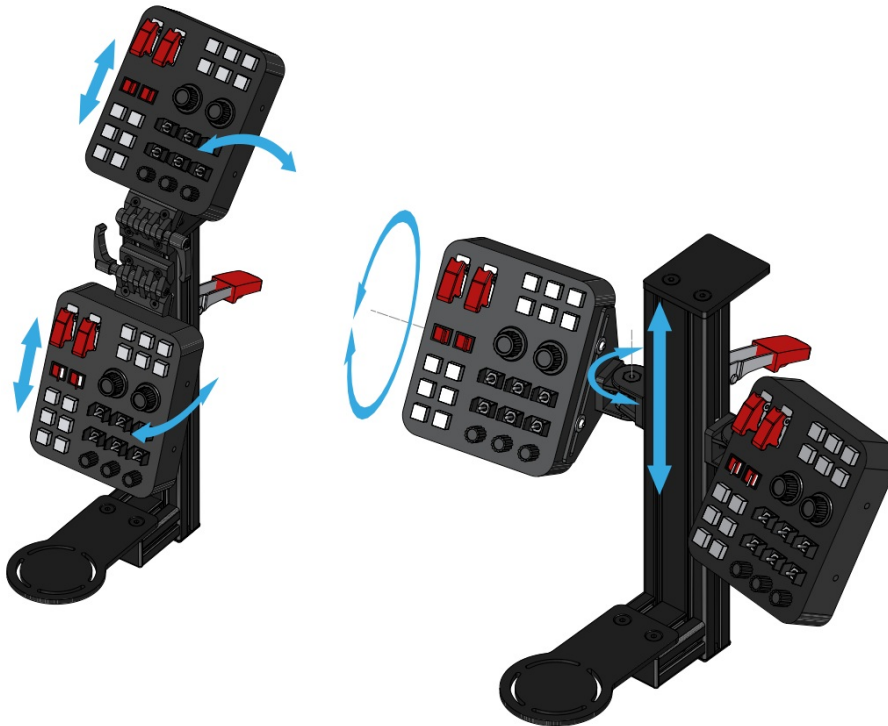

GENERAL ASSEMBLY INFO AND HOW TO

Contents

- [1 PROFILE NUT](#)
- [2 UNIVERSAL CONNECTOR](#)
- [3 PARTS FOR TOP / FRONT MOUNT](#)
- [4 CENTER ASSEMBLY](#)
- [5 Documents / Resources](#)
 - [5.1 References](#)
- [6 Related Posts](#)

PROFILE NUT

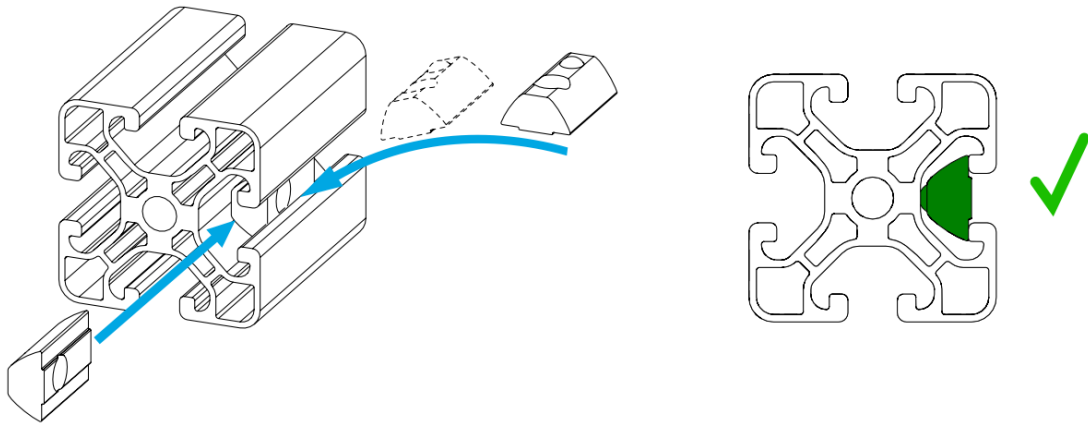

HEX KEY SET WITH BALL HEAD + EXTENSION OR SIMILAR REQUIRED

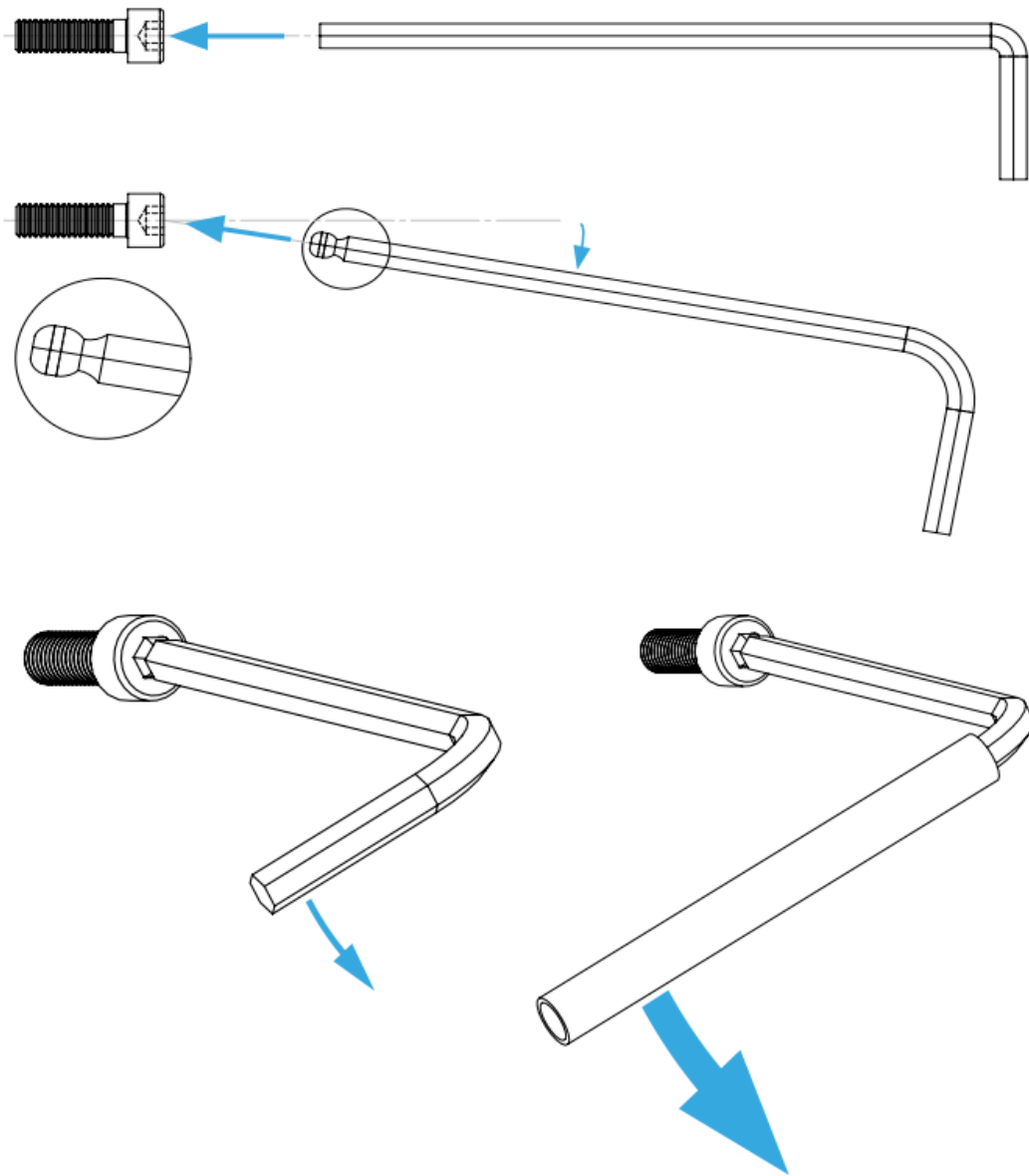

UNIVERSAL CONNECTOR

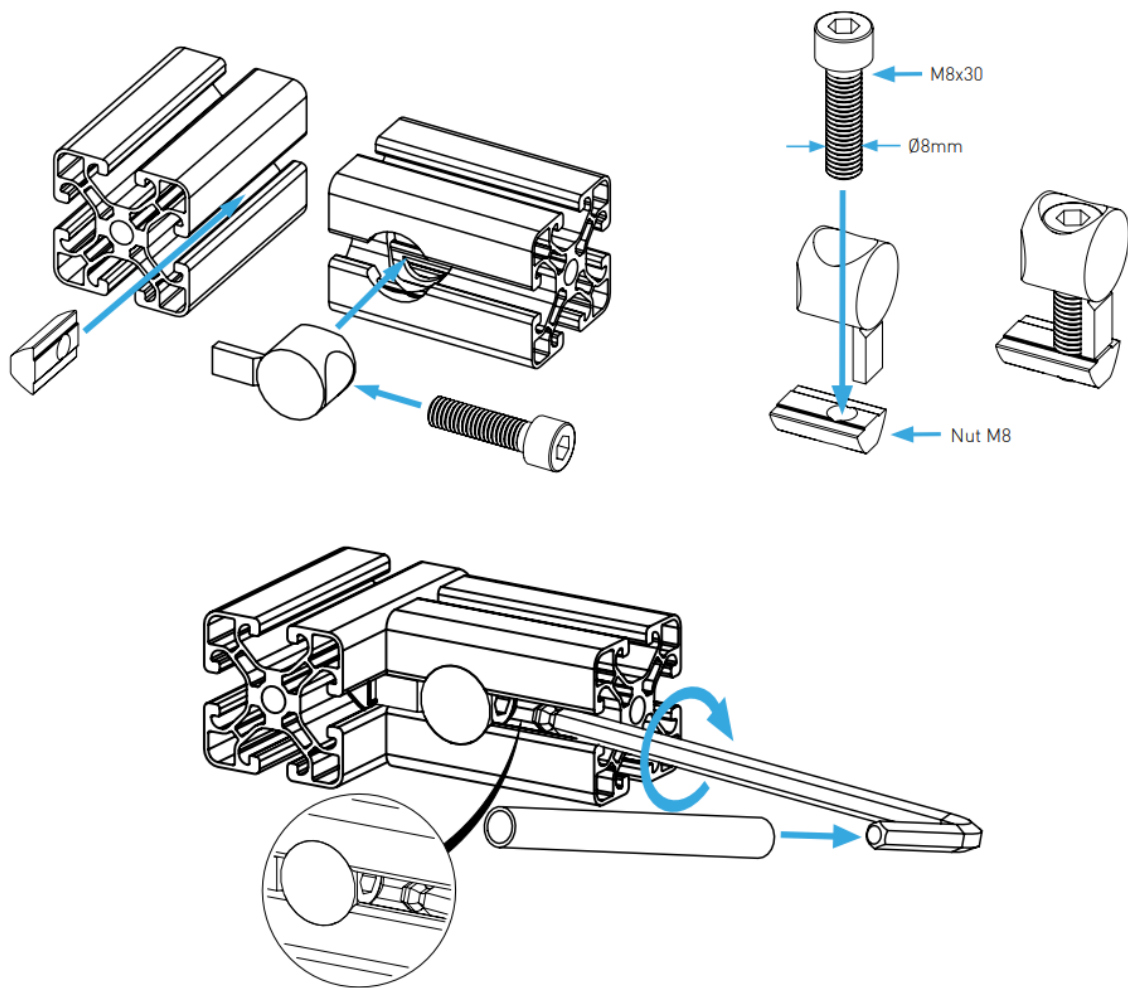

BOLT DIMENSIONS AND HOW TO MEASURE THEM [mm]

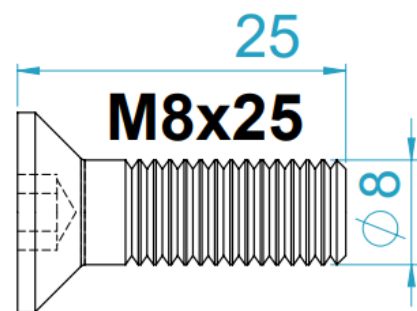
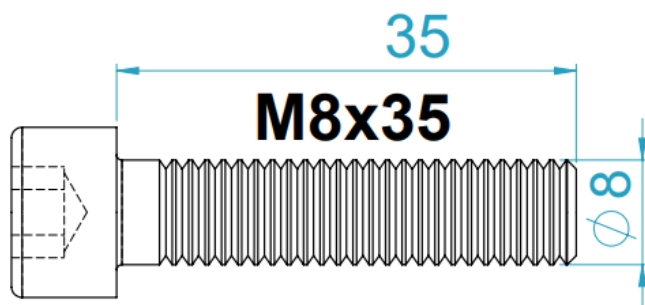

PROFILE CAP ASSEMBLY

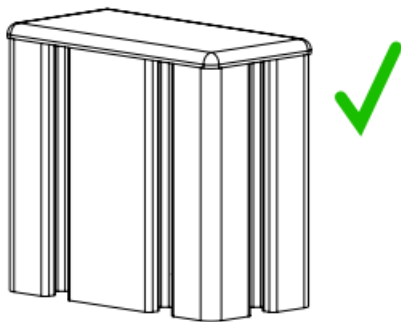
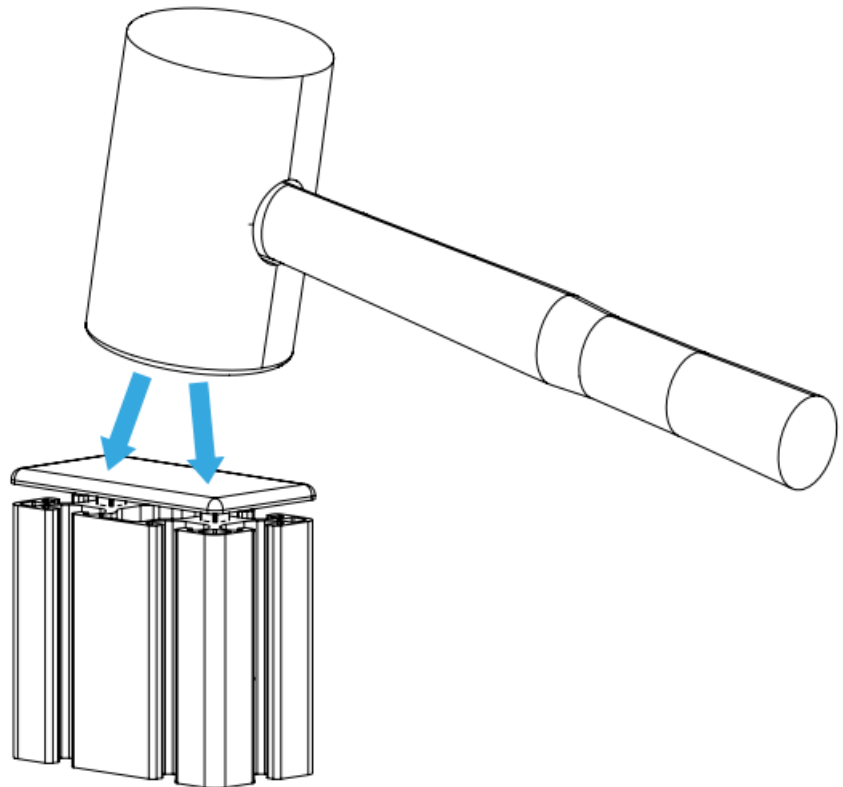
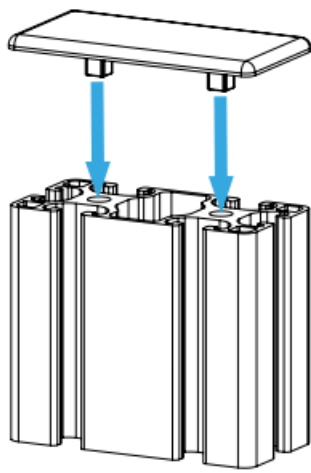

PARTS FOR TOP / FRONT MOUNT

[dimensions in mm /different scales]

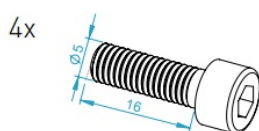
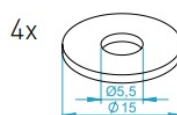
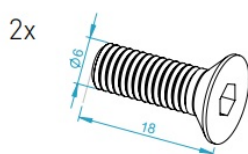
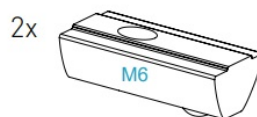
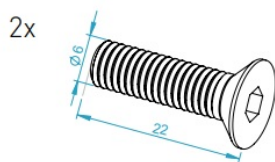
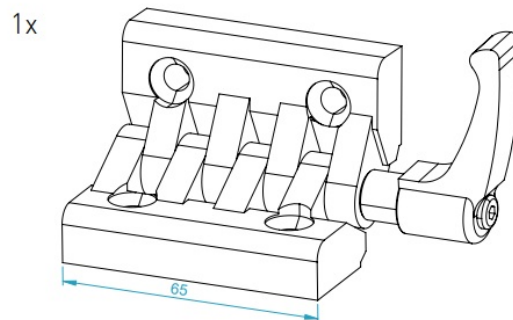
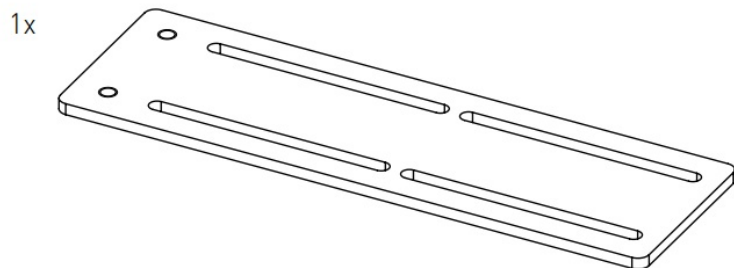

PARTS FOR SIDE MOUNT

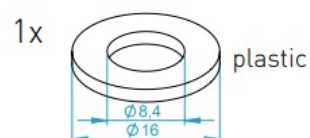
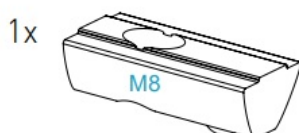
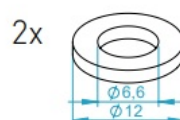
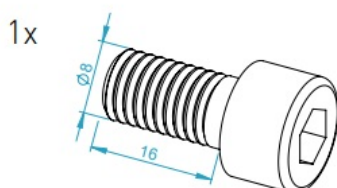
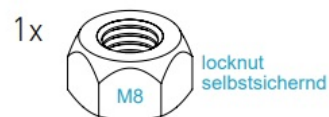
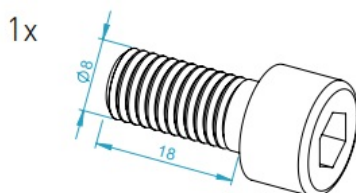
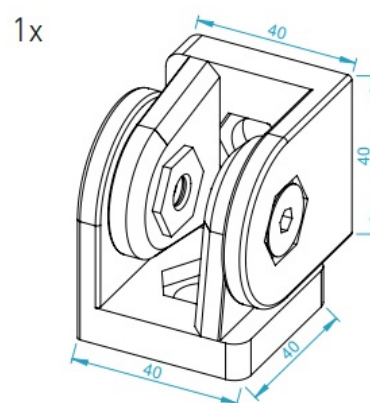
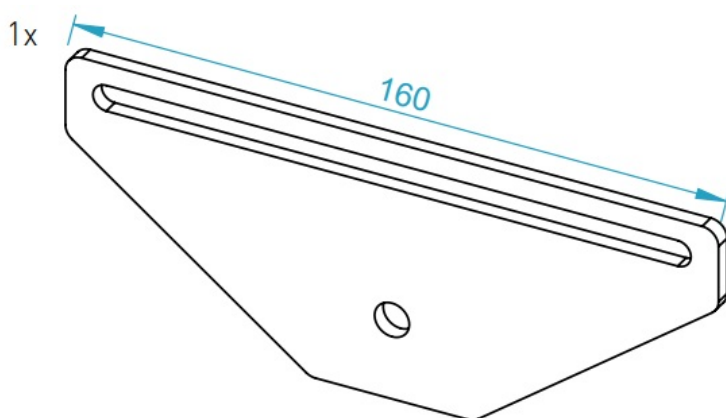

CENTER ASSEMBLY

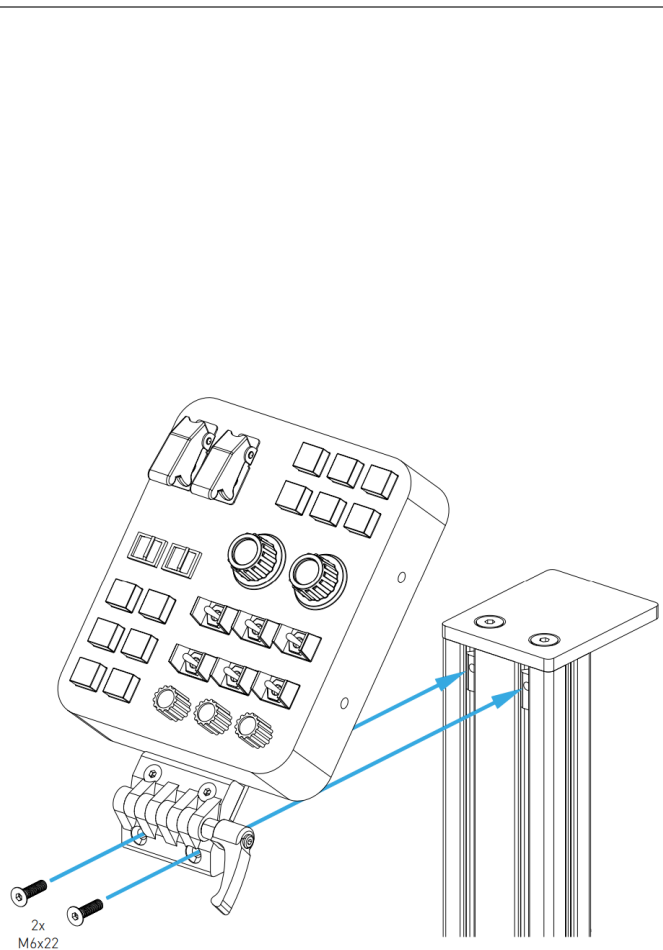
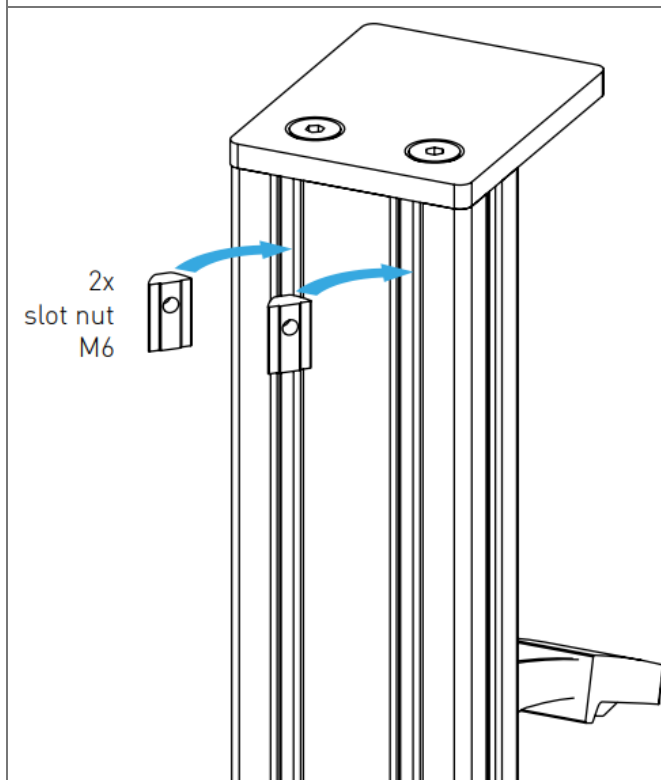
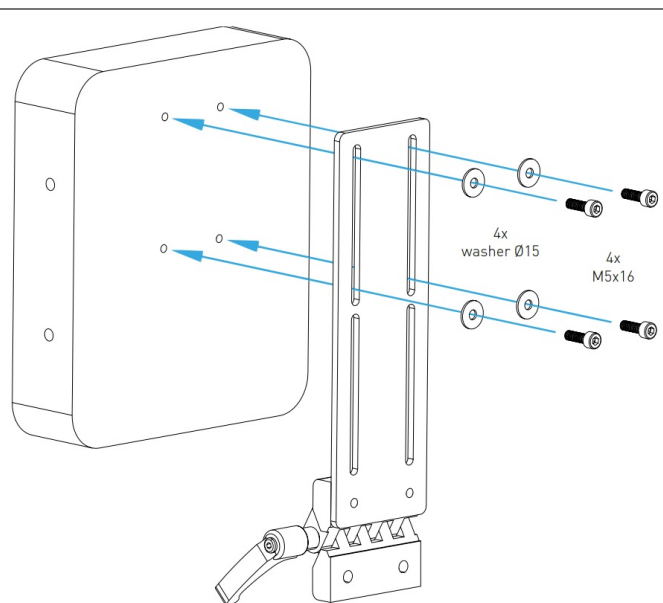
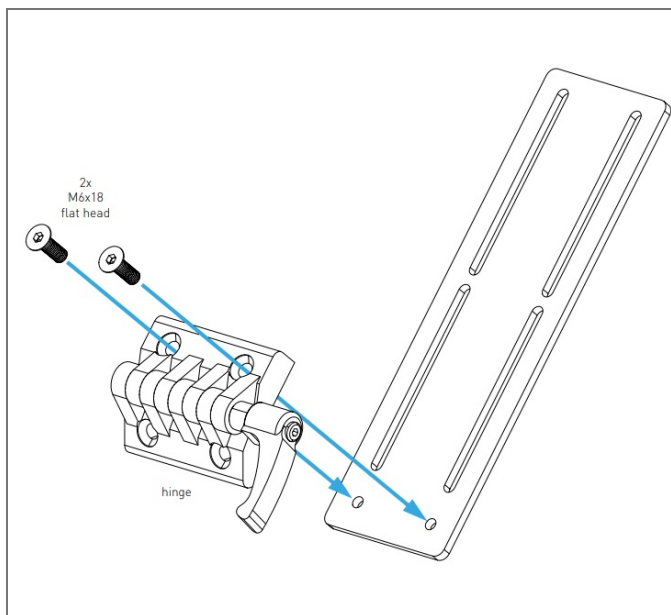

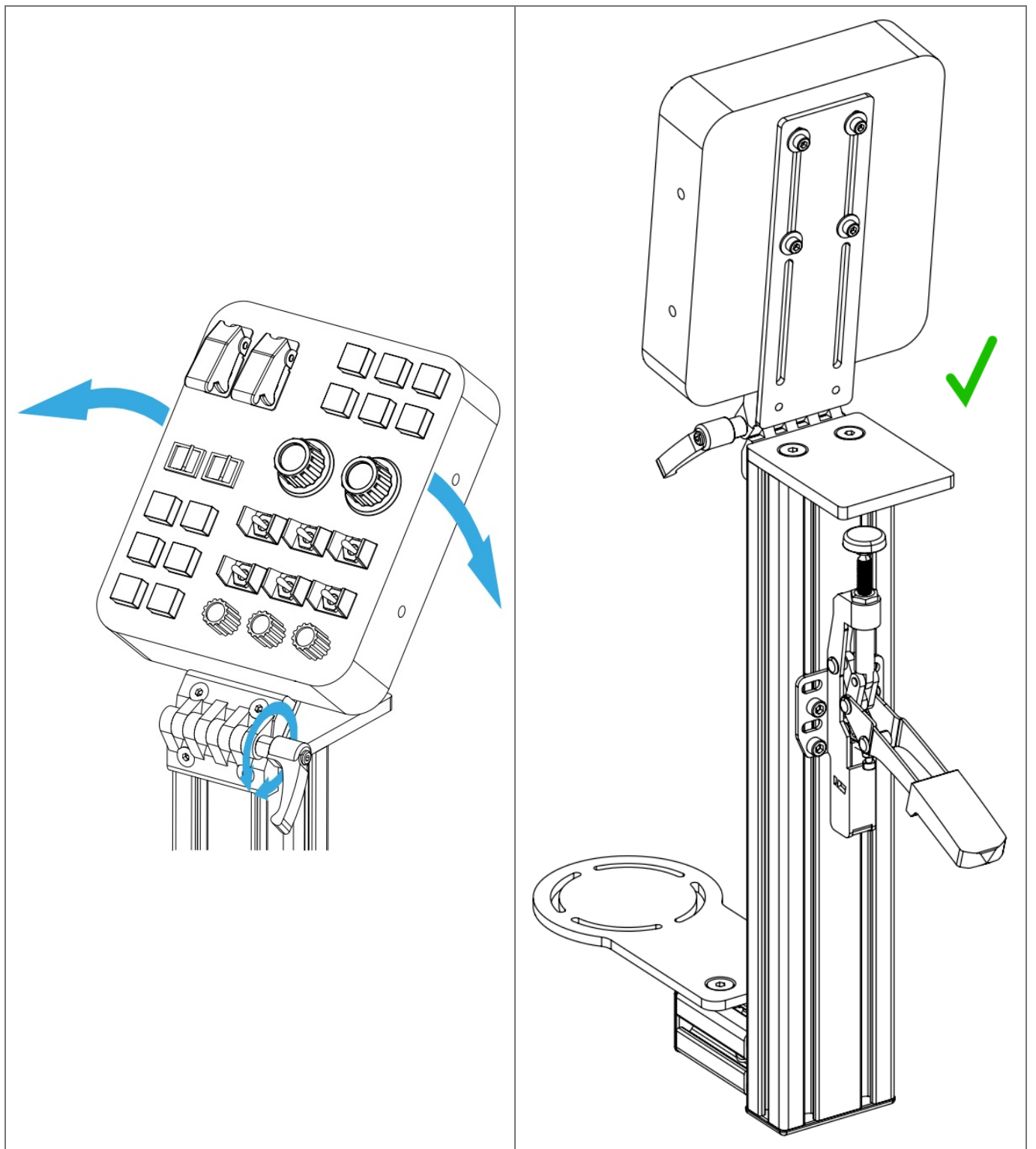

ALTERNATIVE ASSEMBLY ON FRONT

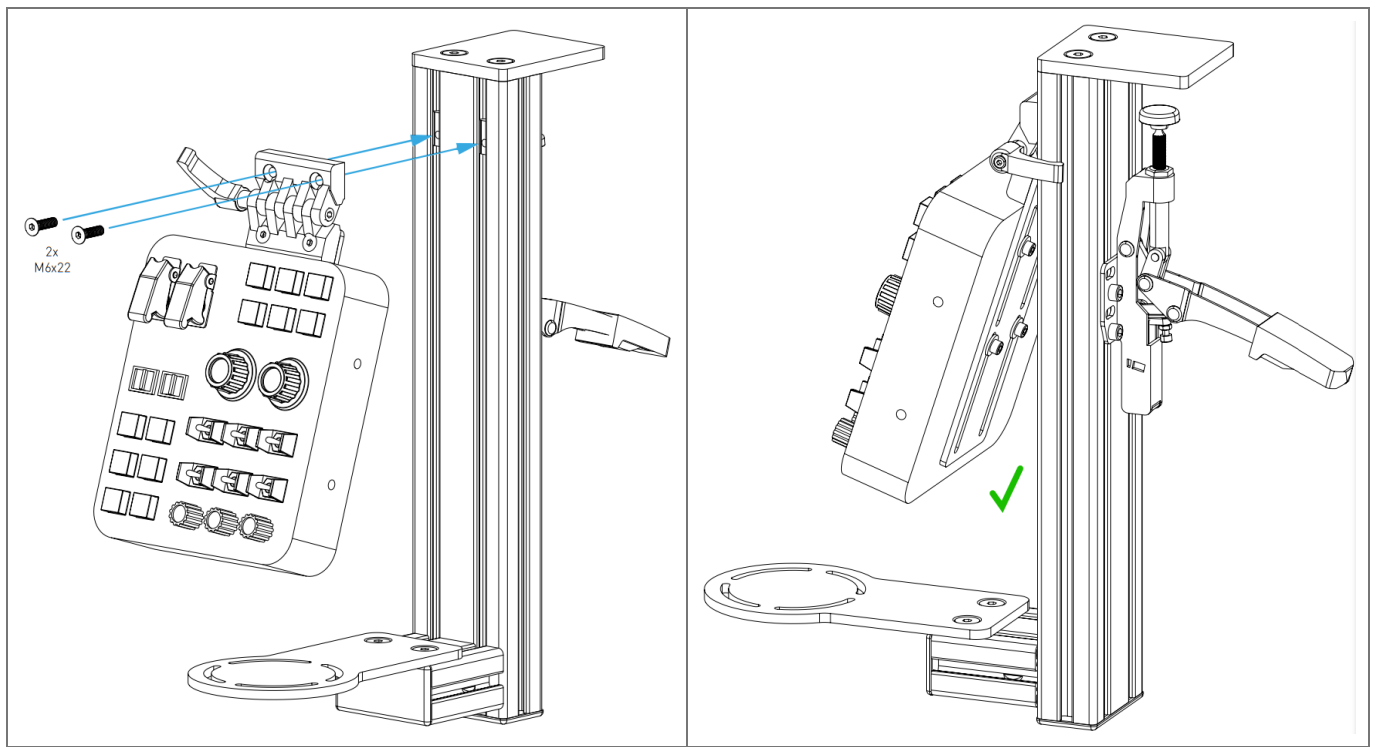

ASSEMBLY FOR SIDE MOUNT

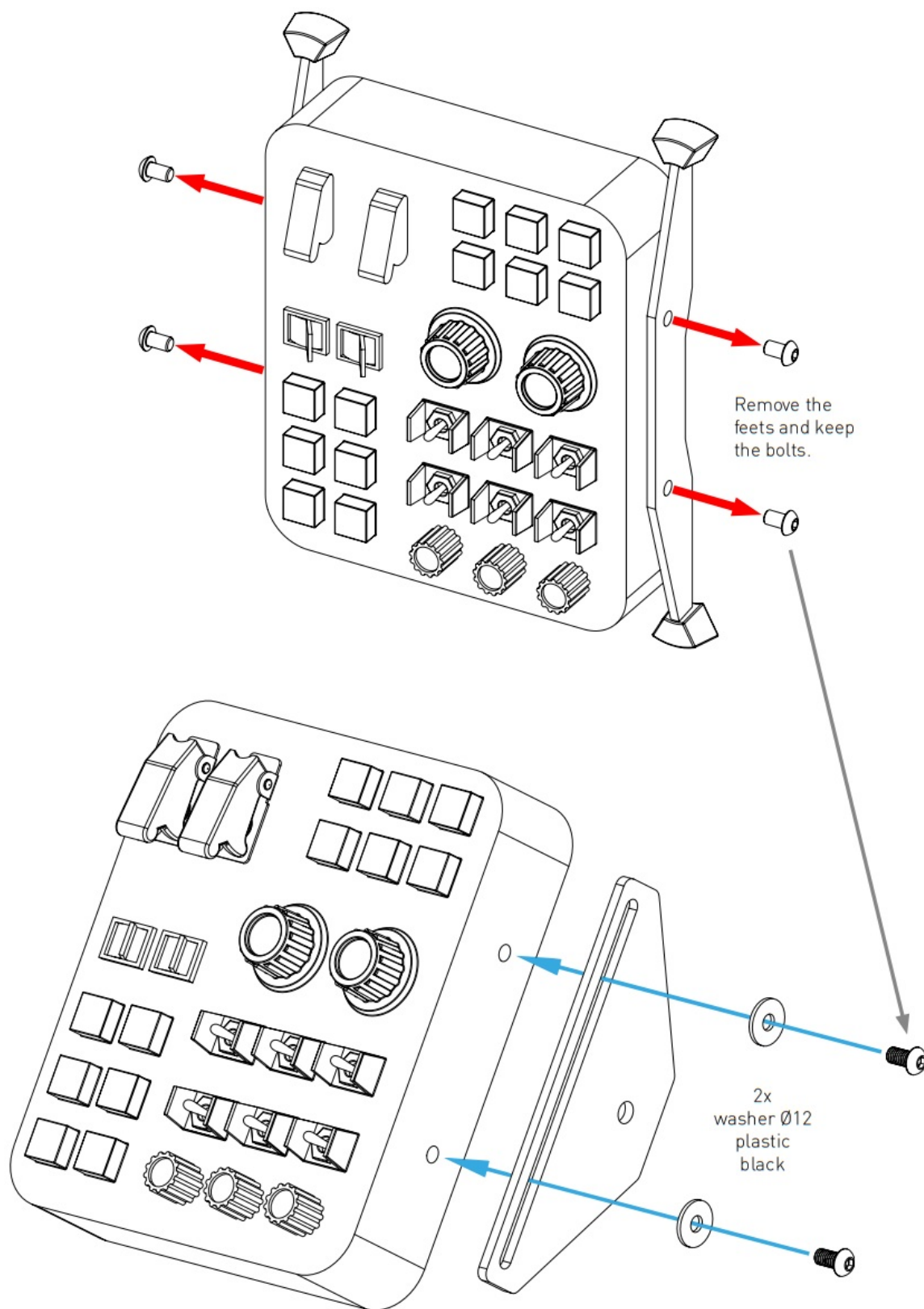

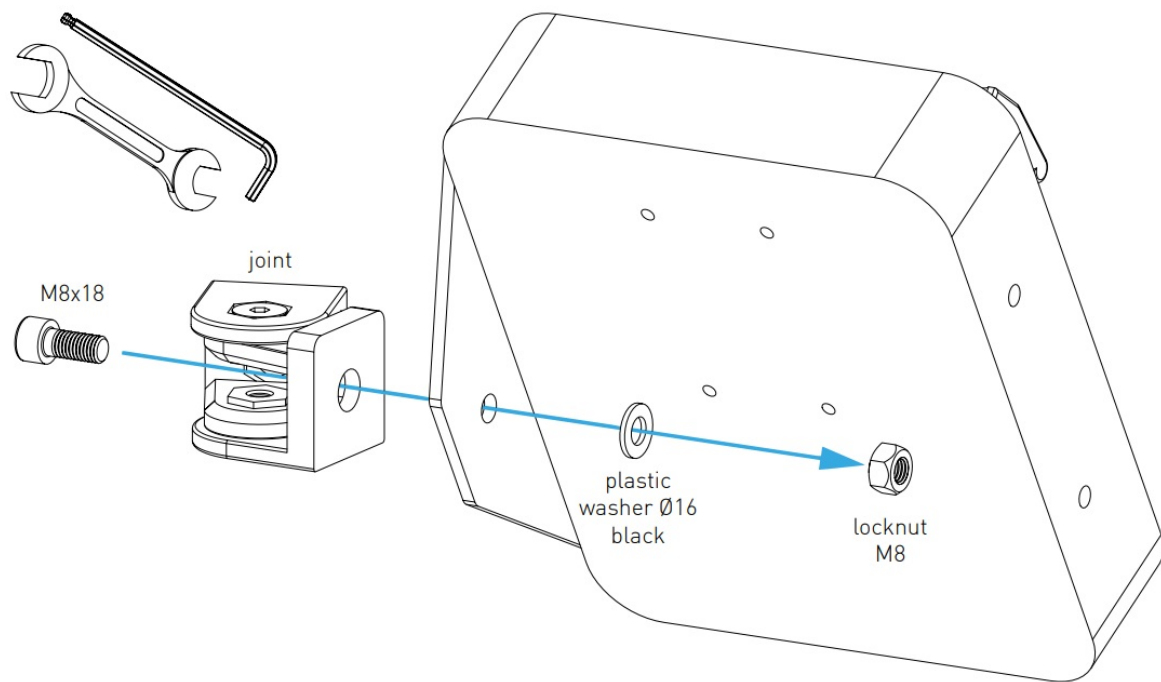

A locknut has to be rough-running on a bolt.

Therefore you need to use a wrench and a hex key to tighten it. Hold up the M8x18 bolt with the hex key while tightening the locknut with the wrench (or reverse).

It's perfect to tighten if you still can angle your mounted device but it is tight enough not to move unintentionally.

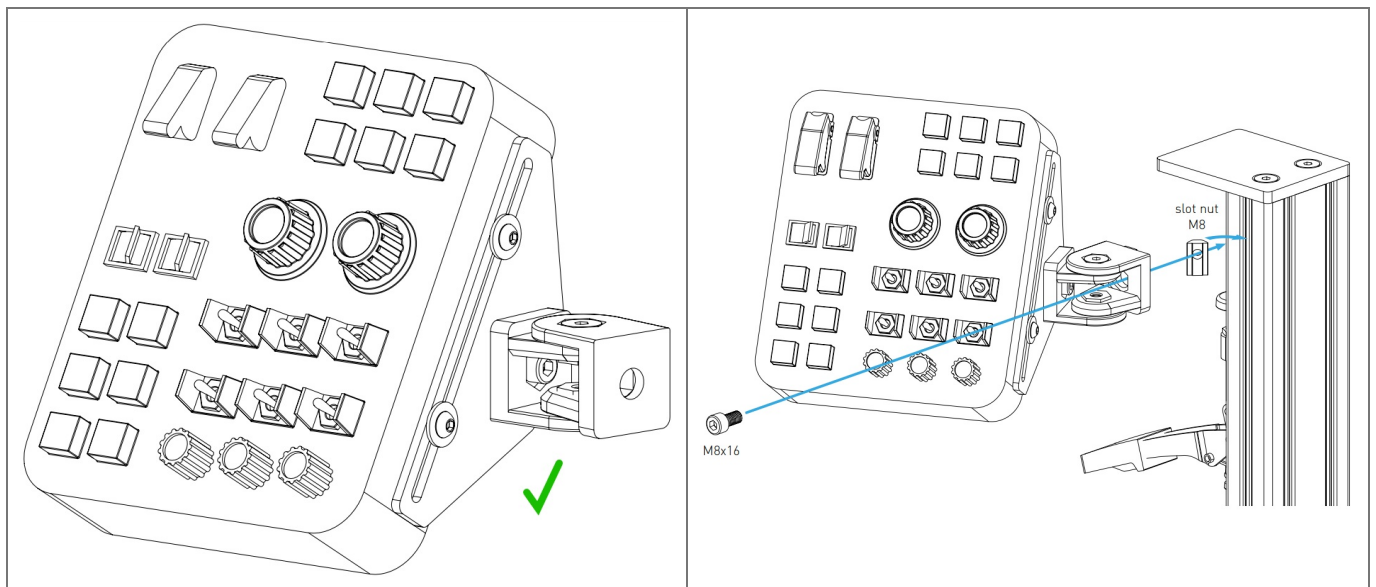

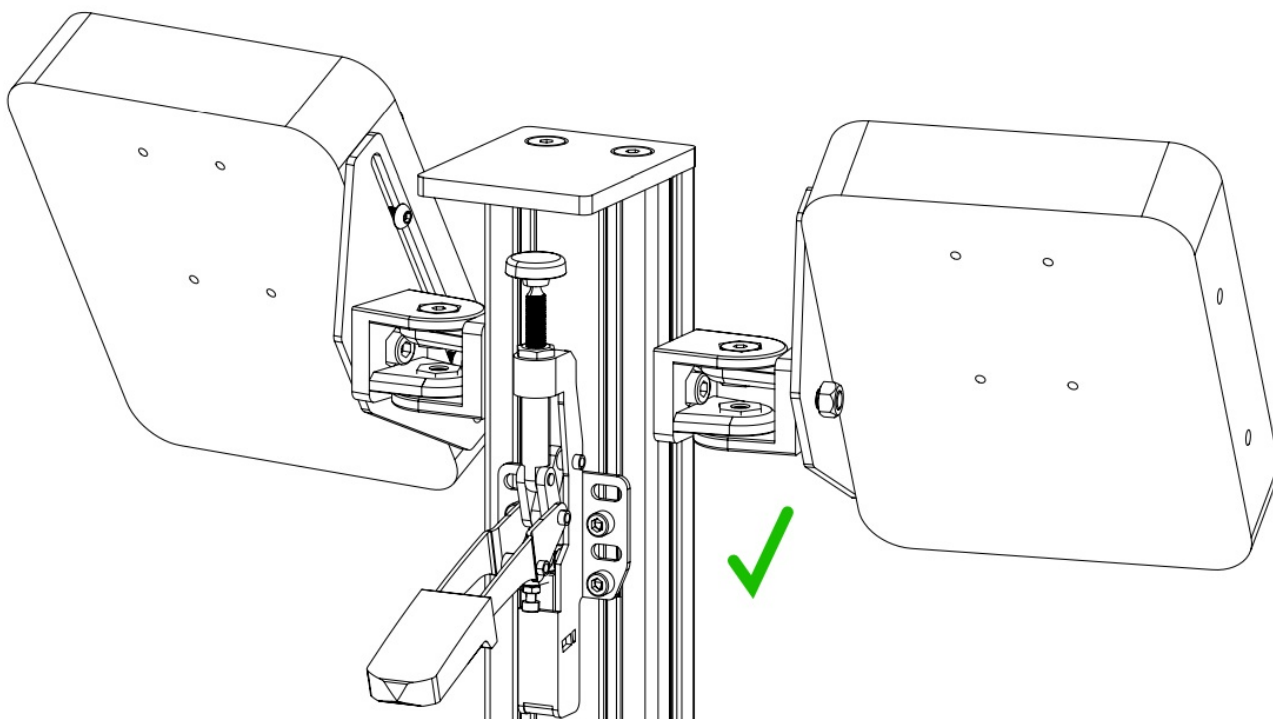

CAUTION! Do not clamp your fingers while attaching the table mount.

CAUTION! Check before usage if all screws are tightened.

CAUTION! Check before usage that the mounting plate is screwed on tight after making height adjustments.

DANGER: Contains small parts not suitable for children under 3 years.

Only suitable for children over 12 years and adults.

All MONSTERTECH products are hand assembled and quality checked.

The mount is designed for usage only with a computer controller (f.e. joystick or throttle).

We exclude liability if the product is used for purposes other than intended.

MONSTERTECH shall be liable for damage arising from causes other than the detriment to life, body and health only to the extent that such damage arises from wilful misconduct, gross negligence, or the culpable violation of a fundamental contractual obligation on the part of MONSTERTECH or a vicarious agent (e.g. the delivery service) of MONSTERTECH. Any further liability for damages shall be excluded.

If you have safety concerns or questions regarding assembly, contact us at info@mtsim.com or visit www.mtsim.com/en

Documents / Resources

 <p>VPC CONTROL PANEL MOUNT</p> <p>Instruction Manual Bedienungsanleitung Manuel d'instructions</p>	<p>MONSTERTECH 00670001 VPC Control Panel Mount [pdf] Instruction Manual 00670001, VPC Control Panel Mount, 00670001 VPC Control Panel Mount, Control Panel Mount, Panel Mount</p>
--	--

References

- [MTSIM – MONSTERTECH – Simulation Design – Offizielle Webseite](#)
- [MTSIM – MONSTERTECH – Simulation Design – Official Website](#)
- [MTSIM – MONSTERTECH – Simulation Design – Site officiel](#)