



# MONITOR AUDIO HYPHN Speaker System Owner's Manual

[Home](#) » [MONITOR AUDIO](#) » MONITOR AUDIO HYPHN Speaker System Owner's Manual 

## Contents

- [1 MONITOR AUDIO HYPHN Speaker System](#)
- [2 ASSEMBLING](#)
- [3 channel system](#)
- [4 Specifications](#)
- [5 Welcome to Hyphn](#)
- [6 Documents / Resources](#)
  - [6.1 References](#)
- [7 Related Posts](#)



**MONITOR AUDIO HYPHN Speaker System**



**WARNING:** DO NOT attempt to lift the loudspeaker alone. We strongly recommend at least four people to unpack and maneuver them.

It is strongly recommended to place each loudspeaker relatively close to the optimum listening position when unpacking to minimize the amount they have to be moved. The handles on the sides of the cartons can be used to lift the cartons off the transit pallet and into position. Spike cups with Magic Sliders attached to them are available to ease the loudspeakers into position.

## **ASSEMBLING**

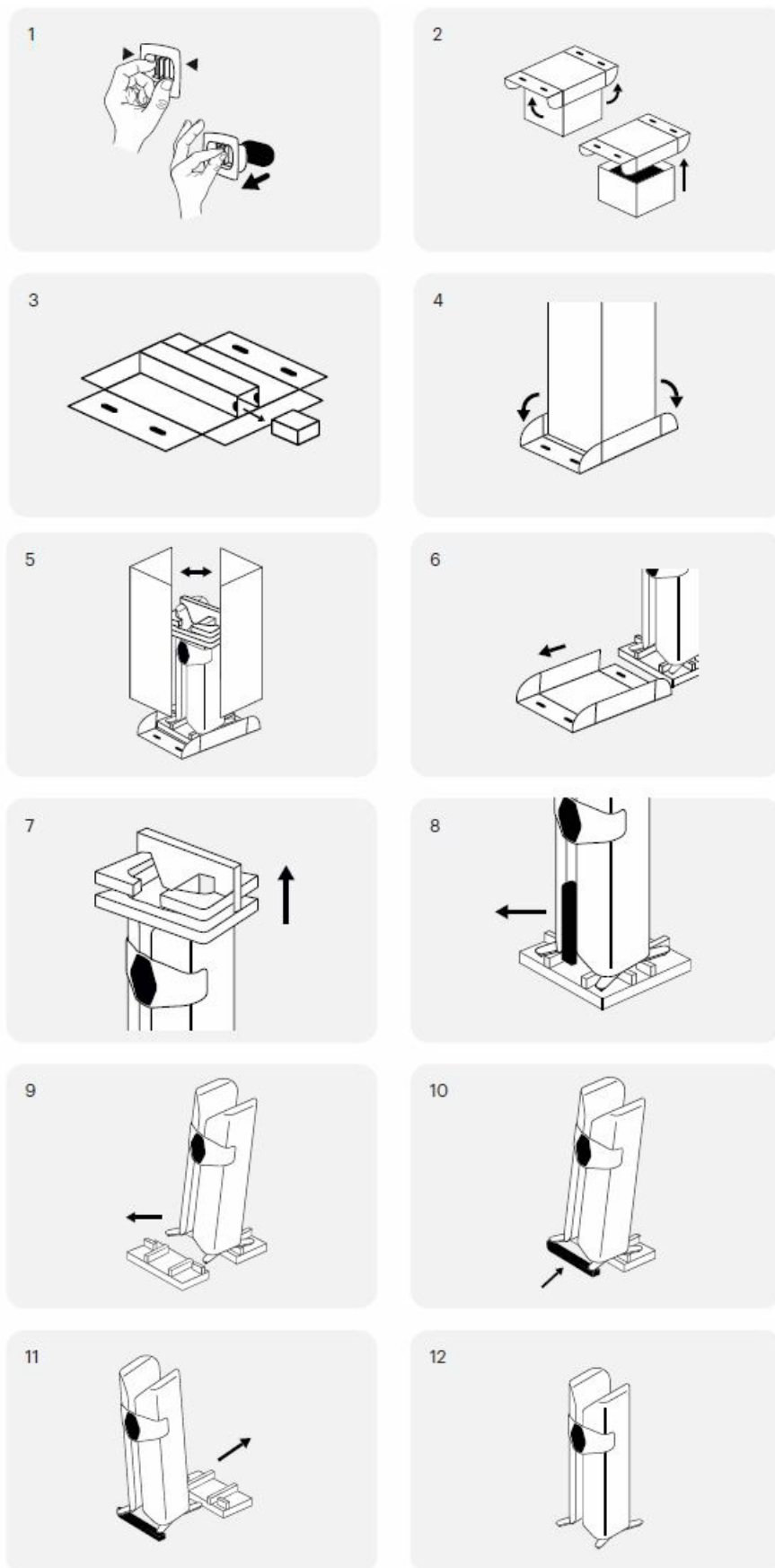

## channel system

With the speaker sitting on the Magic Sliders, it is possible to “slide” the speaker into position with massively reduced resistance other than the weight of the speaker.

When arranging a 2-channel system, the listening position and the loudspeakers should form an equilateral triangle. Ideally, the loudspeakers should be positioned approximately 1.8 – 3m (6 – 10 feet) apart and a minimum of 91cm (3 feet) from the side walls. The ideal distance from the rear wall is 91cm (36 inches).

**NOTE:** These are recommended distances for optimal performance.

Actual results will vary depending on room size, construction, and personal tastes.

Experimentation is strongly advised when setting up the loudspeakers, as the environment and personal preference will differ with every installation. Listen to a few familiar songs, making sure you are happy with the speaker position before removing the Magic Sliders. To enhance stereo imaging, try 'toeing' the loudspeakers in the listening area. Sounds that are recorded equally to each channel should sound as though they are coming from the space between the speakers. Use the diagram opposite for the suggested positioning of the speakers.

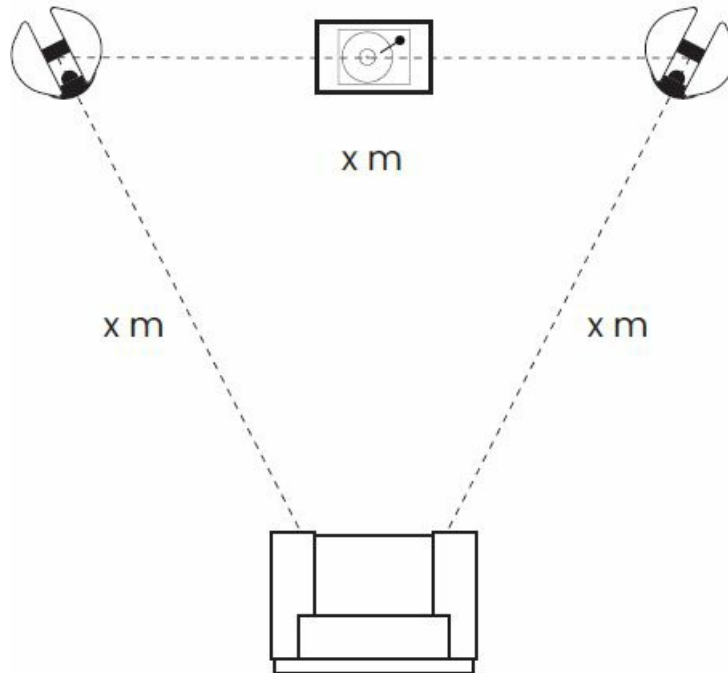

#### Use on carpeted floors

The outriggers are supplied and assembled with spikes, and fitted to the cabinet for use on carpeted floors. All that is required is to position the loudspeaker in its listening position, and check it is level and stable. Please ensure there are no hidden wires under the carpet that could be damaged by the spikes.

#### Use on wooden or hard floors

If the loudspeaker is being installed on a wooden or hard floor, use the supplied foot cups underneath the spike to protect the floor. Position the loudspeaker in its listening position and check it is level and stable.

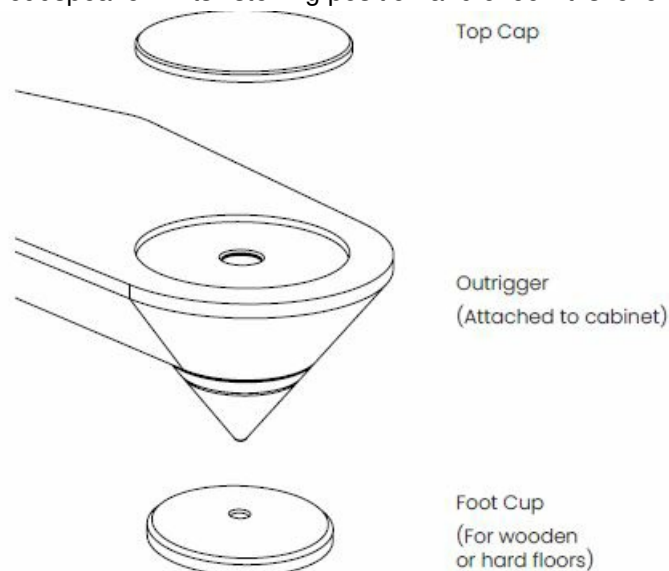

#### Leveling the speaker

You can check that the loudspeaker is level on all sides by using a spirit level (not supplied). If it's slightly uneven, remove the top cap (held in place magnetically) and unscrew the foot at the lowest point using the supplied Hex key as illustrated below and check again. Continue this process until the cabinet is fully level, then replace the top cap.

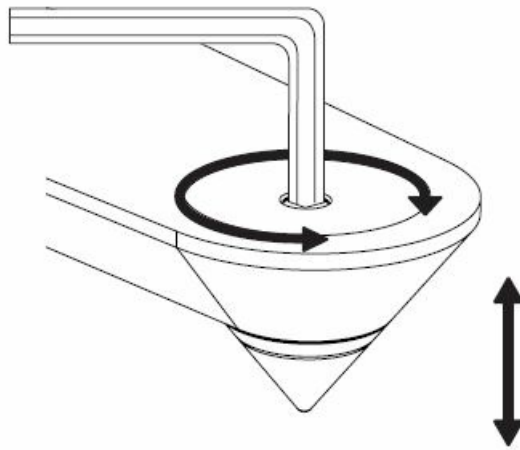

### Bi-wiring

Bi-wiring is accomplished by connecting separate pairs of loudspeaker cables to the terminals on the loudspeaker from a single pair of connections on the amplifier. In the case of Hyphn, the bottom terminals connect to the bass driver(s) and the top terminals connect to the mid and tweeter.

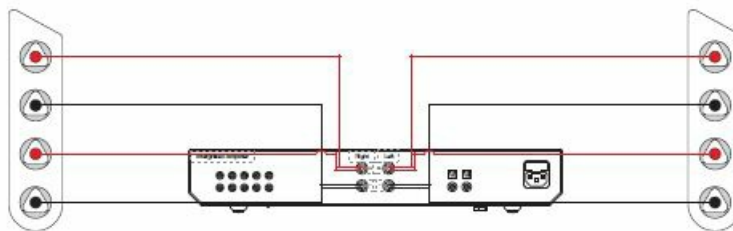

### Bi-amping

Bi-amping is the same as bi-wiring, except you are introducing a second amplifier into the equation. In order to bi-amp, you must connect a set of loudspeaker cables to the top terminals on the loudspeaker from one amplifier and another set of loudspeaker cables to the bottom terminals from the second amplifier.

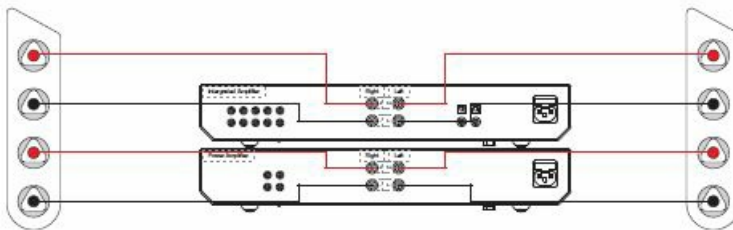

### Running-in your loudspeakers

Run your loudspeakers in by playing music at low-mid listening levels for approximately 50-70 hours of playtime. You may find the sound will continue to improve, even after the 70-hour mark. This can be done naturally over time: like a fine wine, the performance will improve with age.

### upkeep of cabinets

The finish of the cabinet can be maintained by regular dusting using a soft or microfibre cloth. The drive units should only be cleaned with a damp cloth if more than normal dusting is required. Be careful not to damage the driver units whilst cleaning. Never use solvents or aggressive cleaning/polishing agents on your Hyphn loudspeakers. When in doubt, test the cleaning product on an inconspicuous area on the cabinet, and let it sit for several days before committing to its use on visible portions of the cabinet.

### Warranty

In the unlikely event that there is a defect with this product, it is covered by the Monitor Audio manufacturer's warranty, provided that the product was supplied by an authorized Monitor Audio retail specialist. For the period of cover please refer to the product page on our website at [monitoraudio.com](https://www.monitoraudio.com).

### Specifications

Model	Hyphn
Sensitivity (2.83 Vrms @ 1 m)	86 dB
Recommended Amplifier Power (RMS into 4 Ohm, Music Signal)	200 – 1,600 W
Continuous Power Handling (RMS into Nominal Impedance, Pink Noise with 6 dB Crest Factor)	800 W
Nominal Impedance	4 Ohm
Minimum Impedance (20 Hz to 20 kHz)	3.5 Ohm @ 2.2 kHz
Drive Unit Complement	4 x 8" (203 mm) RDT III Bass Driver 6 x 2" (50 mm) RDT III Midrange Driver 1 x MPD III Transducer
Frequency Response (In-room, -6 dB)	18 Hz – 60 kHz
Maximum Peak SPL (single speaker @1 m Z-Weighted)	129 dB
System Format	3-Way
Bass Alignment	Bass Reflex
Port Tuning Frequency	25 Hz

Crossover Frequencies	350 Hz, 3.7 kHz
External Dimensions (Inc. plinth) (H x W x D)	1392 x 502 x 520 mm (54 13/16 x 19 3/4 x 20 1/2")
Weight (Inc. Outrigger Feet)	106.9 kg (235 lbs 10.7 oz)

## Welcome to Hyphn

Thank you for purchasing our Hyphn speaker system, you're now ready to start your journey to breathtaking sound. Hyphen is a peerless, definitive, uncompromising demonstration of the Monitor Audio Group's current design, engineering, and manufacturing capabilities and its future ambitions. It is unlike anything Monitor Audio, or anyone else, has ever created: the most creatively ambitious, technically advanced, and powerful loudspeaker in the company's history. In this product manual, you'll find information about setting up your system and how to maintain your speakers for a lifetime of enjoyment. If you need any further assistance, please contact our technical team at [monitoraudio.com/hyphn-support](https://monitoraudio.com/hyphn-support)

## Register your Hyphn speakers

to ensure the best possible product and customer support Register your speakers using the QR code or visit [monitoraudio.com/registration](https://monitoraudio.com/registration).



- Monitor Audio Ltd.
- 24 Brook Road
- Rayleigh, Essex
- SS6 7XJ
- England
- **Tel:** +44 (0)1268 740580
- **Email:** [info@monitoraudio.group](mailto:info@monitoraudio.group).
- [monitoraudio.com](https://monitoraudio.com).
- ©Monitor Audio Ltd. | V1-2023 – Hyphn

## Documents / Resources



[MONITOR AUDIO HYPHN Speaker System](#) [pdf] Owner's Manual  
HYPHN Speaker System, HYPHN, Speaker System

## References

- [🔗 Monitor Audio | Hi-Fi, Cinema & Architectural Speakers](#)
- [🔗 Support | Help | Monitor Audio](#)
- [🔗 Product Registration | Monitor Audio](#)