



MoMi LIMURU 2 In 1 Combi Stroller User Manual

[Home](#) » [MOMI](#) » MoMi LIMURU 2 In 1 Combi Stroller User Manual 

Contents

- [1 MoMi LIMURU 2 In 1 Combi Stroller](#)
- [2 PRECAUTIONS](#)
- [3 PRODUCT COMPONENTS](#)
- [4 ASSEMBLING AND USE](#)
- [5 USE OF THE BRAKE](#)
- [6 INSTRUCTIONS FOR USE](#)
- [7 CLEANING AND MAINTENANCE](#)
- [8 Documents / Resources](#)
 - [8.1 References](#)



MoMi LIMURU 2 In 1 Combi Stroller



Dear Customer,

- Thank you very much for purchasing the MoMi 2in1 LIMURU stroller. We hope that the purchased product meets your expectations.
- In the interest of children's safety, please read the operating instructions carefully and follow its recommendations to use the product safely.
- The person performing the assembly must be an adult who will use all the components of the product according to the instructions for use and their intended use to prevent injuries to the child.

PRECAUTIONS

IMPORTANT:

- Remember to remove and throw away all the packaging elements that were attached to the product, so that they do not remain within the reach of a child (e.g. cardboard elements, plastic films, etc.).
- This could cause a risk of harm, e.g. choking on the child, and suffocation for the child.
- We recommend that you keep this manual for future reference, to read, if necessary, what to do in the event of an emergency or for proper maintenance.

PLEASE NOTE:

- Drawings and photos are for reference only. The actual appearance of the product may differ from the visualization in the manual.

WARRANTY:

- The manufacturer provides a 2-year warranty on the product and a 6-month warranty on the accessories.

WARRANTY EXCLUSIONS AND LIMITATIONS:

- We are responsible for the quality of our products. Our warranty does not include damages caused by improper use of the product or mechanical damages.

TAKE CARE OF THE ENVIRONMENT:

- When you stop using the product, please dispose of it at an appropriate facility following local laws.

IMPORTANT! PLEASE READ CAREFULLY AND KEEP FOR FUTURE REFERENCE SAFETY NOTES AND PRECAUTIONS.

WARNINGS!:

- Never leave your child unattended.
- Make sure all locking devices are turned on before use.
- Do not let a child play with this product.
- To avoid injuries, make sure your child is in safe distance when it unfolds or folds this product.
- Do not let a child play with or in the vicinity of this product.
- The brakes should be locked when putting in and taking out your baby.
- Use the most recline position for the new born babies.
- This product is not suitable for running or skating.
- Check that the seat mounting devices are properly engaged before use.
- The product is intended for children from 0 to 36 months of age, up to a weight of 15 kg.
- The product is intended for the transport of one child at a time.
- Maximum load on the basket under the stroller up to 2 kg.
- The brakes should be locked when putting in and taking out your baby.
- Each additional load suspended on the handles of the stroller makes it lose its stability.
- Only use parts and accessories that have been supplied or recommended by the manufacturer.
- Do not place the product near an open flame or other heat sources.
- Do not leave the stroller on slopes, even with the brake applied.
- Regularly check the technical condition of the stroller.
- Do not use the stroller on uneven surfaces, near fire or other hazardous places.
- Do not use the stroller on stairs. Fold the stroller before going down or up stairs.
- Additional luggage put in the stroller may lead to the loss of its stability.
- Do not use the product if you are in any doubt about the correct operation of the wheelchair or its safety.
- The stroller is compatible with car seats that have a universal fastening system.
- For car seats used in conjunction with a chassis, this vehicle does not replace a cot or a bed. Should your child need to sleep, then it should be placed in a suitable pram body, cot or bed.
- When using the stroller in combination with a car seat, refer to the instructions of the car seat manufacturer.

PRODUCT COMPONENTS

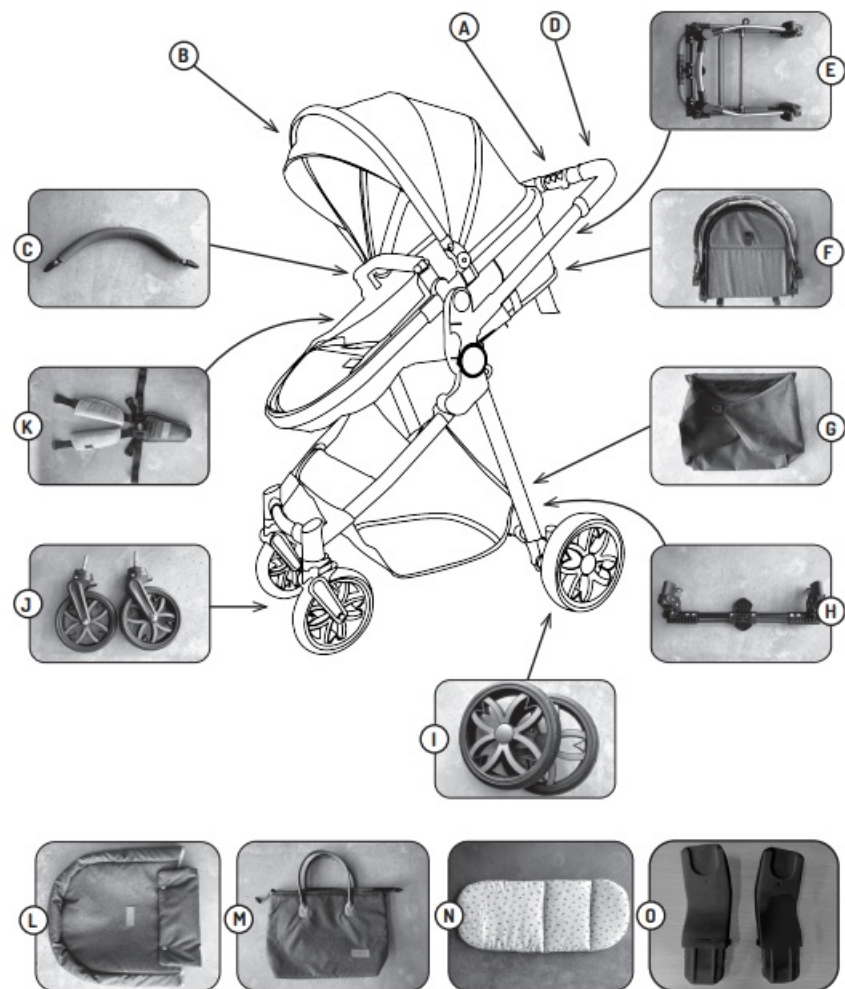

- A. Folding button
- B. Canopy with extension part
- C. Bumper
- D. Push handle
- E. Frame
- F. Gondola / Seat
- G. Textile basket
- H. Rear wheel brake
- I. Rear wheels
- J. Front wheels
- K. Seat belts

ACCESSORIES FOR THE STROLLER:

- L. Sleeping bag
- M. Bag
- N. Mattress
- O. Car seat adapters

ASSEMBLING AND USE

1. Before assembling, make sure that nothing is missing
2. Place the frame on a flat surface and unlock the frame lock button (as shown in pictures 1-2).
3. Grab the handle and pull it upwards to unfold the frame (as shown in pictures 3-4).
4. To install the rear axle with brake, the frame should be positioned as shown in picture 4 and the plastic holes at both ends of the brake (as shown in picture 5) into the metal tube of the frame until you hear a click (as shown at picture 6)
5. Install the rear wheels by inserting them into the holes on the rear axle until you hear a click, then you are sure that the wheels are properly and securely assembled (as shown in pictures 7-8).
6. To install the front wheels, insert them into the holes in the front of the frame until you hear a click, you can be sure that the wheels are properly and securely assembled (as shown in pictures 9-10)
7. To remove the front wheels, press the quick-release button (as shown in picture. 9b)
8. To remove the rear wheels, press the lock button and pull the wheels out of the holes (as shown in picture 7b)
9. To embed the carrycot, put it on the stroller frame as shown in picture 11
10. Place the carrycot on a flat surface. Press the footrest adjustment buttons (as shown at picture 11) to unfold the carrycot. Before installing the carrycot on the stroller frame, attach the Velcro fasteners to the metal rod on the bottom of the carrycot and leave it unfolded. When mounting the gondola on the trolley frame, attach it to the designated holes on both sides of the stroller frame until a characteristic click
11. The stroller is ready for use as a deep gondola.

STROLLER:

12. If you want to use the stroller as a pushchair, install the bumper by inserting its ends into the plastic tubes in the centre of the carrycot (as shown at pictures 12-13) until you hear a click
13. Adjust the seat by pressing the large, round buttons on the sides of the carrycot (as shown in picture 14)
14. To adjust the footrest, fasten the buckles at the ends of the footrest adjustment straps on the bottom right and left of the carrycot. The footrest will lift (as shown in pictures 15-16).
15. Repeat with the next pair of clamps in the opposite direction
16. Unfasten the Velcro fasteners on the metal bar on the underside of the carrycot. Slide the metal bar towards the footrest, thus creating the seat of the pushchair.
17. Adjust the backrest to the child's needs by loosening or tightening the buckle on the backrest of the stroller (as shown in pictures 17-18). To do this, press the button on the belt buckle and pull it up or down.

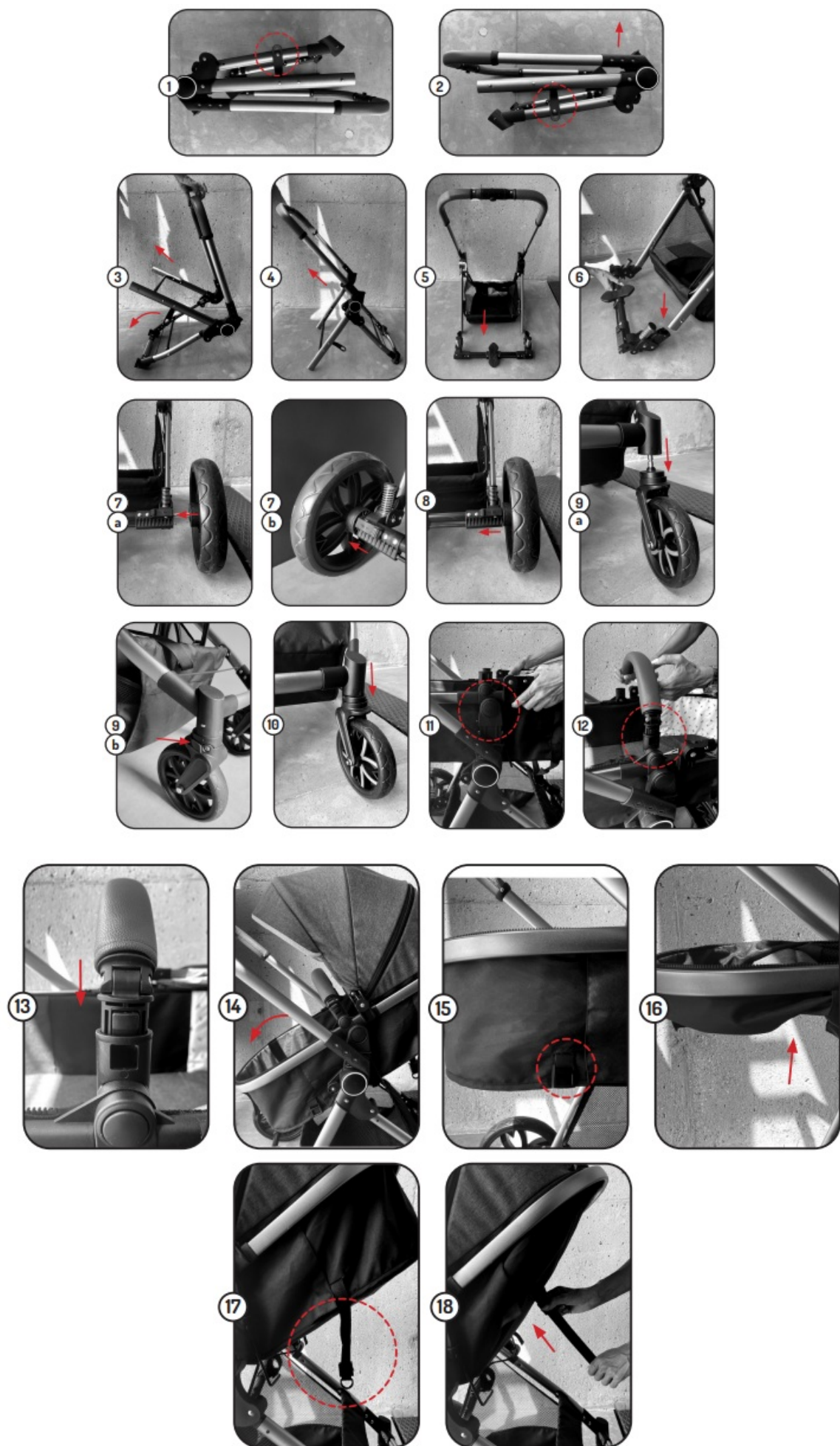

USE OF THE BRAKE

- This stroller is equipped with a foot parking brake on the rear axle.
- Press the brake pedal downwards (as shown in picture 19a) so that the brake is activated.
- Unlocking takes place after lifting the pedal (as shown in picture 19b).

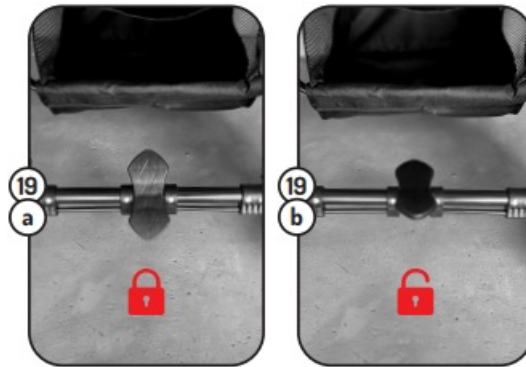

ADJUSTMENT OF CUSHIONING:

- This stroller has a two-stage shock absorption adjustment (as shown in pictures 20-21).
- The adjusting levers are located on the underside of the brake rear axle just below the springs (as shown in picture 21).
- When driving on uneven surfaces, pull the lever firmly towards the rear axle until it locks.
- In this position, the shock absorbers will smooth out any unevenness.
- When riding on a flat surface, firmly pull the button in the opposite direction until it locks and the spring visibly tightens.
- In this position, the shock absorbers will provide greater stability.

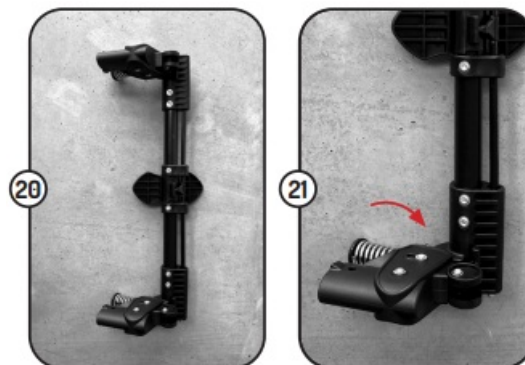

INSTRUCTIONS FOR USE

INSTRUCTIONS FOR USE OF THE SEAT BELTS:

- The product is equipped with 5-point seat belts. To fasten the safety belts place both shoulder strap buckles in the crotch strap buckle. Press down and make sure that they are properly fastened (as shown in picture 22).
- To unfasten the seat belts, press the button on the crotch strap buckle (as shown in picture 23).
- The straps can be adjusted (as shown in picture 22) to fit your child properly, but be careful so that the baby is not too tightly compressed and can breathe freely. When fastening a seat belt, pay attention that the child's hands are not near the buckle.
- Fasten all belts with a buckle and cover with a mattress.
- Always use a clasp system.
- **Straps Removal (for cleaning):** Remove the shoulder straps, lap straps and crotch straps from the holes by

pushing the plastic hooks inwards. Assembly is the reverse way. After assembly, make sure that the plastic hooks securely block the straps.

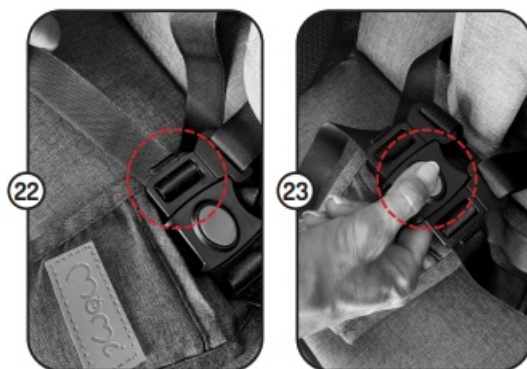

ASSEMBLY AND ADJUSTMENT OF THE CANOPY:

- To install the canopy, zip it around the inside of the carrycot.
- Tighten the clasps of the visor on the frame so that the pins go into the holes.
- The canopy has the option of increasing the coverage area of the gondola and the seat.
- To do this, open the lock on the outside of the roof (as shown in pictures 24-25).



ASSEMBLY OF THE LEG COVER:

- Attach the foot cover using the zipper on the inside of the seat. Close the zipper and close the Velcro cover on the safety bar.

ADJUSTING THE HEIGHT OF THE SEAT BELTS:

- The straps of the safety belts have a 3-step height adjustment to better adapt them to the child's needs.
- To change the height, unclip the buckle by sliding it from the bottom of the backrest with one hand and pulling it out on the other side.
- Select the height at which you want to mount the belts, and then pass the buckle through the hole in the fabric and pull it through the backrest until it locks on its back.

ATTENTION!

- Check that the seat belt is properly locked on the back of the seatback.

DISASSEMBLING THE STROLLER:

- Remove the seat/carrycot from the frame. Press the lock button in the centre of the pushchair handle, turn the plastic handle towards the hood and pull the handle downwards (as shown at pictures 26-28).

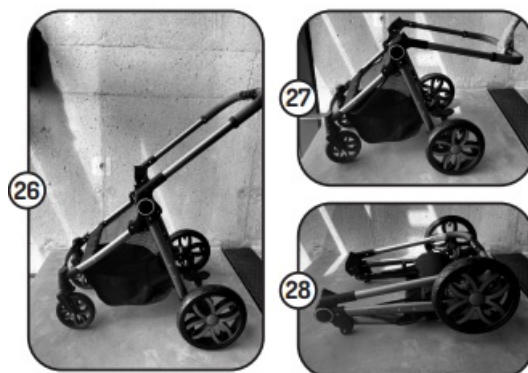

ATTENTION!

- Do not disassemble the stroller without the carrycot/seat removed.

CLEANING AND MAINTENANCE

- Periodically check the technical condition of the trolley for damage or missing parts.
- Stop using the wheelchair if any part is missing or damaged.
- The product should be cleaned with a damp cloth with a mild soap solution.
- If the product frame has been exposed to a salt solution, clean the product as soon as possible with a damp cloth with a soap solution.
- If the cart is wet, leave it unfolded until it is dry to prevent mould growth.
- Never leave the stroller in a humid or hot environment.
- Thank you for reading the manual. Please keep it for future reference.

www.momi.store.

Documents / Resources

 <p>LIMURU</p> <ul style="list-style-type: none"> • STROLLER • SEAT • CARRYCOT • TRANSFORMER • LATCH SYSTEM • ADJUSTABLE • REMOVABLE • FOLDABLE • COMPACT • EASY TO USE 	<p>MoMi LIMURU 2 In 1 Combi Stroller [pdf] User Manual</p> <p>LIMURU 2 In 1 Combi Stroller, LIMURU, 2 In 1 Combi Stroller, Combi Stroller, Stroller</p>
---	--

References

- [User Manual](#)

[Manuals+](#), [Privacy Policy](#)