



# MOMAN H2 Pro Headset Helmet Intercom User Manual

[Home](#) » [MOMAN](#) » Moman H2 Pro Headset Helmet Intercom User Manual 

## MOMAN H2 Pro Headset Helmet Intercom User Manual



### Contents

- [1 INSTALLTION INSTRUCTION](#)
- [2 Package List](#)
- [3 Product Introduction](#)
- [4 Operation](#)
- [5 Music Sharing](#)
- [6 Installation](#)
- [7 Notes](#)
- [8 Music Sharing](#)
- [9 Installation](#)
- [10 Installation](#)
- [11 Documents / Resources](#)
  - [11.1 References](#)
- [12 Related Posts](#)

## INSTALLTION INSTRUCTION

### Caring For Your MOMAN Product

- Please keep the product in a dry, clean, dust-free environment.
- Keep corrosive chemicals, liquids and heat source away from the product to prevent mechanics damage.
- Use only a soft and dry cloth for cleaning the product.
- Malfunction may be caused by dropping, impact of external force.
- Do not attempt to disassemble the product. Doing so voids warranty.
- Please have the product checked or repaired by authorized technicians if any malfunctions happened.
- Failure to follow all the instructions may result in mechanics damage.
- Warranty does not apply to human errors.

### Package List

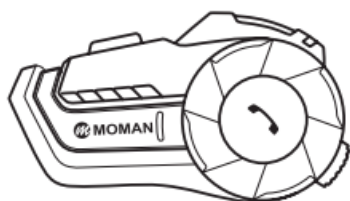

Intercom x2  
( x1 for 1-Rider Kit )



Velcro Clip x2  
( x1 for 1-Rider Kit )

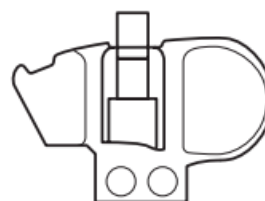

Back Clip x2  
( x1 for 1-Rider Kit )



hook and Loop Fasteners x2  
( x1 for 1-Rider Kit )

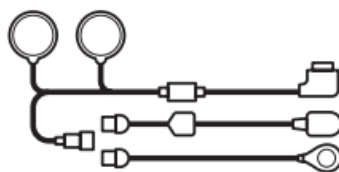

Replaceable Hard Mic  
and Soft Mic Speakers x2



Manual x1

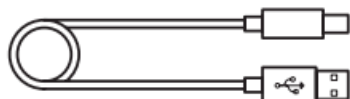

USB Cable x2  
( x1 for 1-Rider Kit )



Screw Driver x2  
( x1 for 1-Rider Kit )



Headphone Velcro x8  
( x4 for 1-Rider Kit )

### Product Introduction

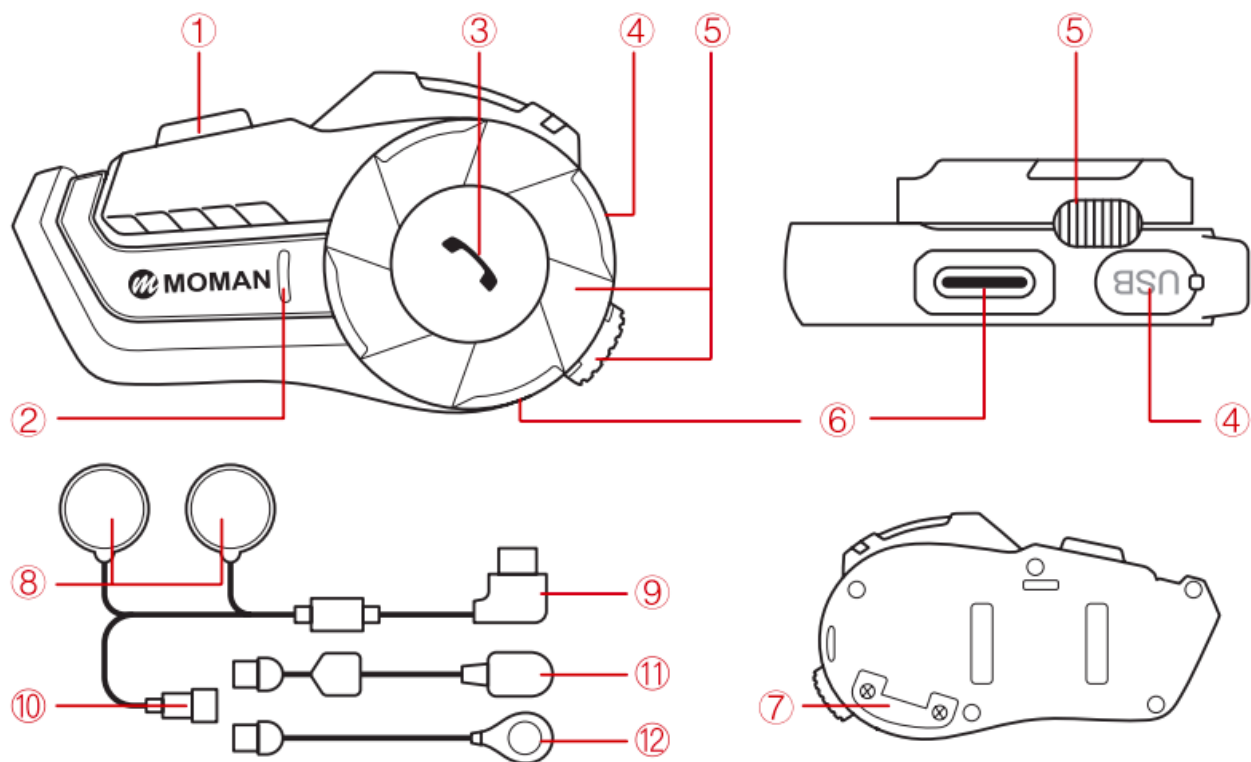

1. On/Off Key
2. Knob
3. Headset Interface
4. Headset Plug
5. Indicator Light
6. Function Key
7. Buckle Flap
8. Charging Interface
9. Speaker
10. Butterfly sticker
11. Replaceable hard mic
12. Replaceable soft mic

#### Important Notice:

Before installing the headsets, follow the Quick Manual instructions to connect your phone and audition the sound and volume. If there is a large difference in sound effect and volume after installing it on the helmet, please adjust the position of the speaker in the helmet.

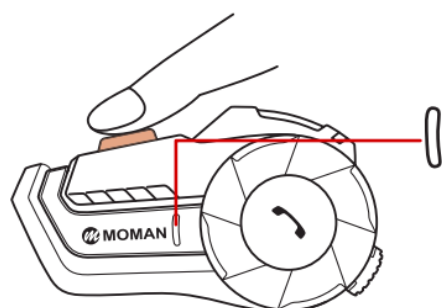

**ON:** The BLUE light flashes twice, the RED and BLUE lights flash alternatively.

↓ Voice prompt



**OFF:** The RED light flashes once.

#### Operation

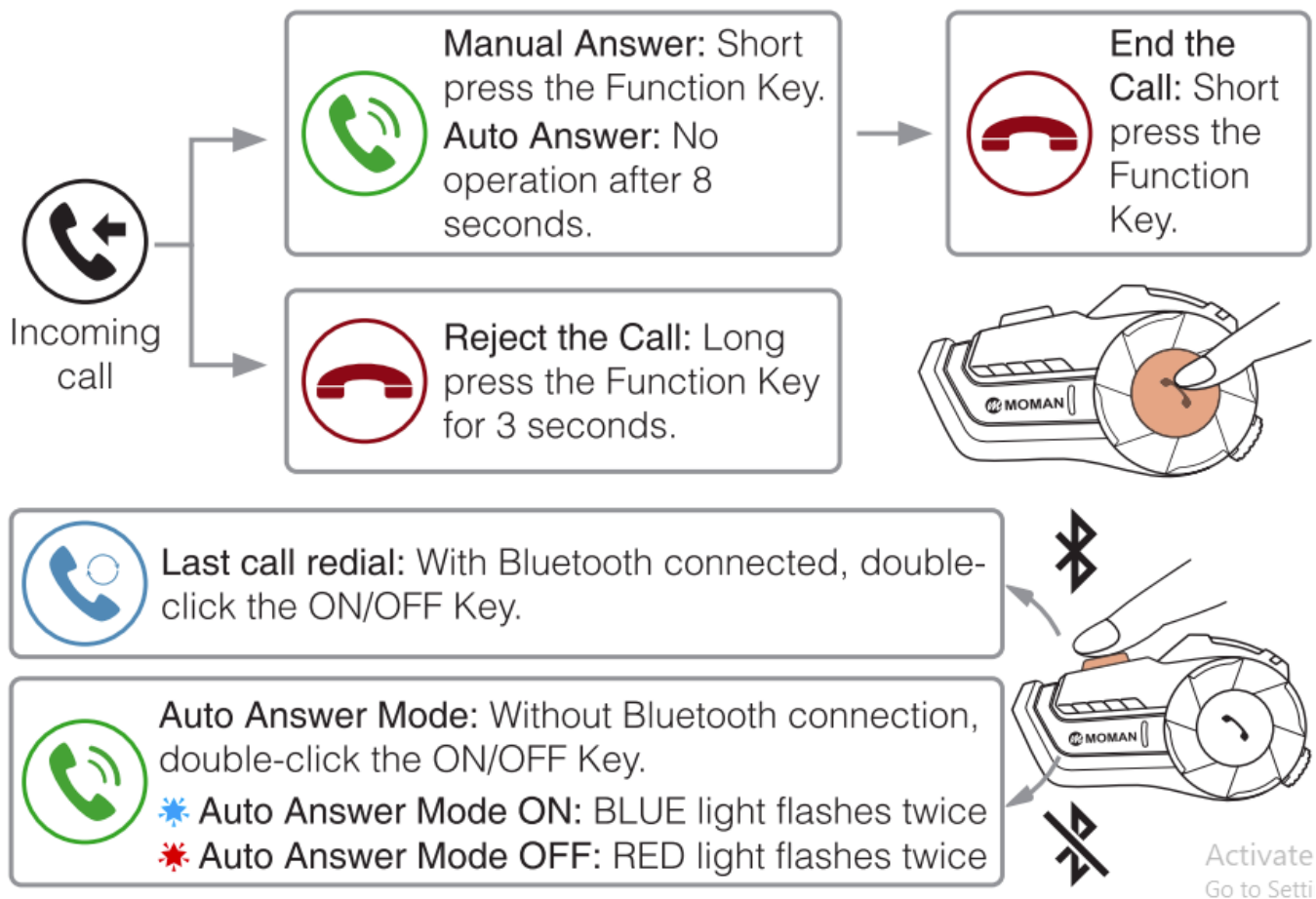

## Power On/Off

**ON:** Press the ON/OFF key for 2 seconds.

**OFF:** Long Press the ON/OFF key for 4 seconds.

**Reset:** Under Power on mode, long Press the ON/OFF Key for 8 seconds.

## Phone Control

### Music Control

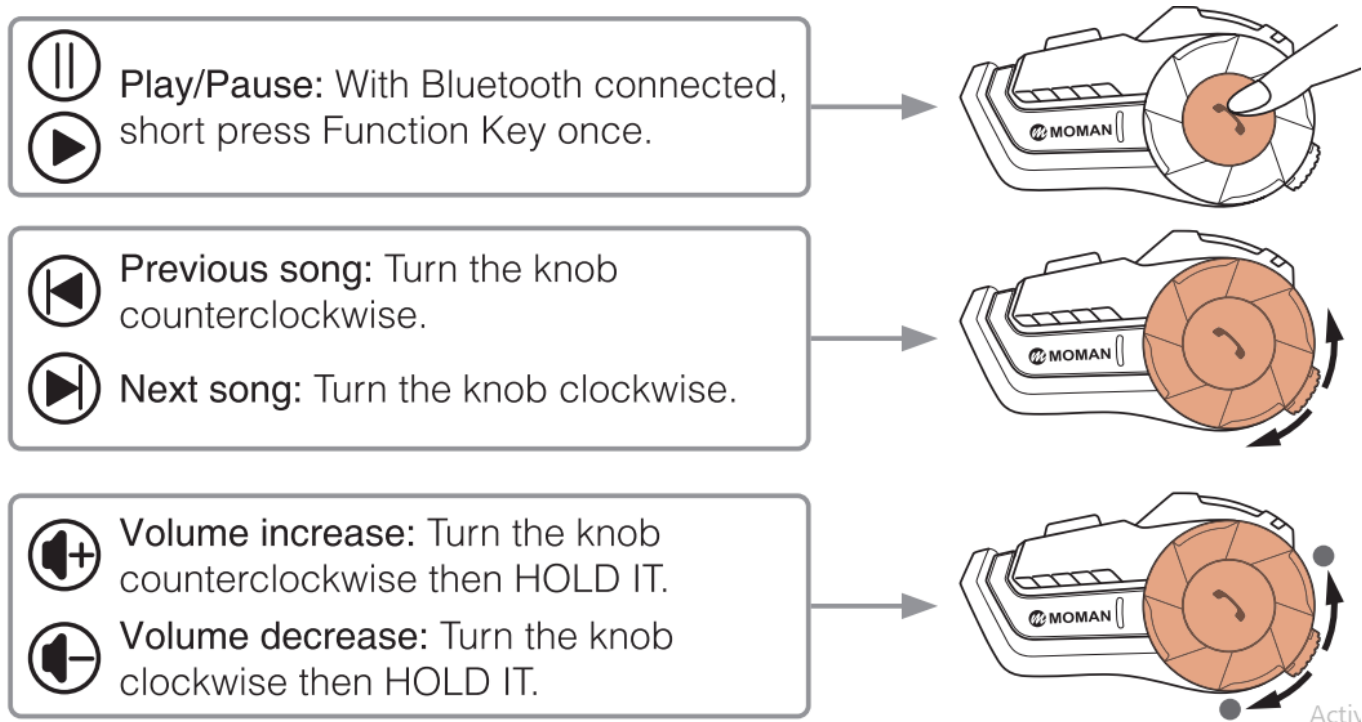

There is voice alarm for too high and too low volume.

### **FM Radio**

**ON:** Under Standby mode, double-click the Function Key twice.

**OFF:** Double-click the function key twice.

3 Select channels: Quickly rotate and release the knob to select and adjust

### **Notes:**

If the signal is weak indoor, you could try to turn on the FM radio near window or in the open area

When FM radio is turned on and there is a phone calling, the machine will cut off FM radio automatically and connect to the mobile phone. It gets back to the FM radio when the call ends.

### **Language Switch**

Power on, press the ON/OFF key and rotate the knob at the same time. (English Japanese → Italian)

Voice Assistant

### **Pairing and Disconnection**

#### ***With Mobile Phone:***

After switching on press the On/Off Key and Function Key simultaneously for 4 seconds, BLUE light flashes twice, then RED and BLUE light flash alternatively, Pairing Turn on the bluetooth function search "MOMAN H2 PRO to connect.

Voice prompt "Bluetooth connected

MOMAN H2 PRO Connected

After switching on, press the On/Off Key and Function Key simultaneously for 4 seconds. BLUE light flashes twice, then RED and BLUE light flash alternatively

2 Press the ON/OFF key of 1 intercom, the blue indicator light flashes

After switching on, press the On/Off Key and Function Key simultaneously for 4 seconds. BLUE light flashes twice, then RED and BLUE light flash alternatively

2 Press the ON/OFF key of 1 intercom, the blue indicator light flashes

### **Music Sharing**

**ON:**

**OFF:** Press the Function Key of Intercom A for 2 seconds 9. Multi-Mode Switch Between Intercom and Music/FM Radio

. Method 1: Install with Back Clip

1 Use the screwdriver to loosen the screws of the back clip so that it can open to a proper extent.

Open the helmet liner, insert the clip into the right position on the left side of the helmet and tighten the screw

Slide the intercom into the back clip slot to make sure it locks firmly

Open the helmet liner (ear position), clean the EPS surface of the helmet, and stick a piece of horn Velcro on the left and right sides of the helmet.

5 Stick the speaker on the fixed Velcro surface and the speaker with short line should be installed close to the machine. Fix the microphone and arrange the helmet lining and cable

Insert the headset into the jack of the intercom and tie up the headset cable.

. **Method 1: Install with Back Clip**

1. Use the screwdriver to loosen the screws of the back clip so that it can open to a proper extent.
2. Open the helmet liner, insert the clip into the right position on the left side of the helmet and tighten the screw
3. Slide the intercom into the back clip slot to make sure it locks firmly
4. Open the helmet liner (ear position), clean the EPS surface of the helmet, and stick a piece of horn Velcro on the left and right sides of the helmet.
5. Stick the speaker on the fixed Velcro surface and the speaker with short line should be installed close to the machine. Fix the microphone and arrange the helmet lining and cable
6. Insert the headset into the jack of the intercom and tie up the headset cable.

**Method 2:** Install with Velcro Clip Separate the hook and loop fasteners. First stick the hook onto the Velcro clip; choose the right installation position on the helmet and stick the loop to the position. Install the intercom onto the Velcro clip The installation of speakers can refer to the description above.

## Installation

1. Before using the Bluetooth intercom, please use the attached charging cable to charge the intercom. The small type-C interface on the charging line is connected to the USB charging interface of the Bluetooth intercom, and the large USB connector on the charging cable is connected to the following charging interface for power supply:
  - A. N 1.the 2. st Se USB interface of computer;
  - B. A mobile power supply with DC 5V output;
  - C. A USB power adapter with DC 5V output.
2. When charging, the red LED is always on, and when fully charged, the red light goes out slowly. It takes up to 2.5 hours to fully charge the unit.

## Notes

1. If you do not use intercom for up to one month or more, please charge the intercom once every two months in order to protect the lithium battery;
2. The storage temperature of this product is -20°C to 50 °C, and do not store in the environment with too high or low temperature, otherwise, the service life of the product will be affected;
3. Do not expose this product to fire to avoid explosion;
4. Only two screws on the back of intercom can be opened. Do not open other screws to the intercom to avoid short circuit of main board or battery damage.

### 5. Language Switch

Power on, press the ON/OFF key and rotate the knob (Japanese Italian) at the same time. (English OMOWAN HOMAN Voice Assistant)

### 6. Pairing and Disconnection

#### **With Mobile Phone:**

After switching on, press the On/Off Key and Function Key simultaneously for 4 seconds, BLUE light flashes twice, then RED and BLUE light flash alternatively.

② **Pairing:** Turn on the bluetooth function search "MOMAN H2 PRO" to connect.

## Two Intercoms Pairing

1. After switching on press the On/Off Key and Function Key simultaneously for 4 seconds, BLUE light flashes

twice, then RED and BLUE light flash alternatively.

2. Press the ON/OFF key of 1 intercom, the blue indicator light flashes quickly.

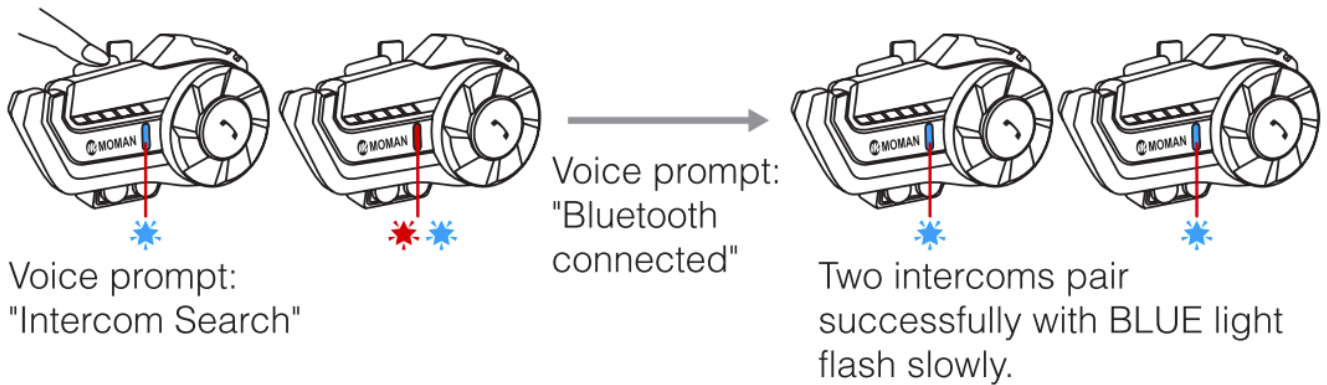

#### Notes:

1. Automatic connection: Once the intercoms pair successfully, there is no need to pair repeatedly.
2. After switching on, short press the On/Off Key under Standby mode to repair.

#### Reconnect&Disconnect

1. **Reconnect:** Short press the ON/OFF Key Voice prompt: "Di".

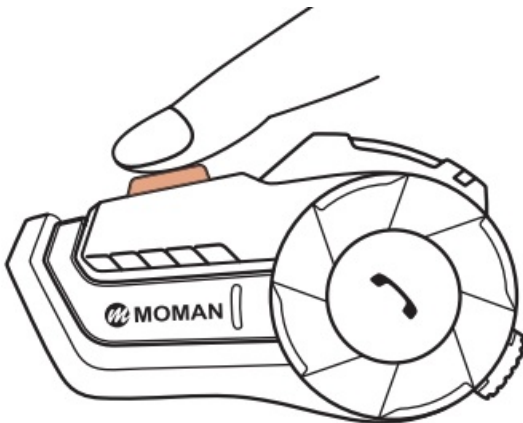

2. **Disconnect:** Short press the ON/OFF Key Voice prompt: "Di".

#### Notes:

Within five minutes of disconnection, connects automatically:

More than five minutes, short press the On/Off Key to search.

#### Music Sharing

##### ON

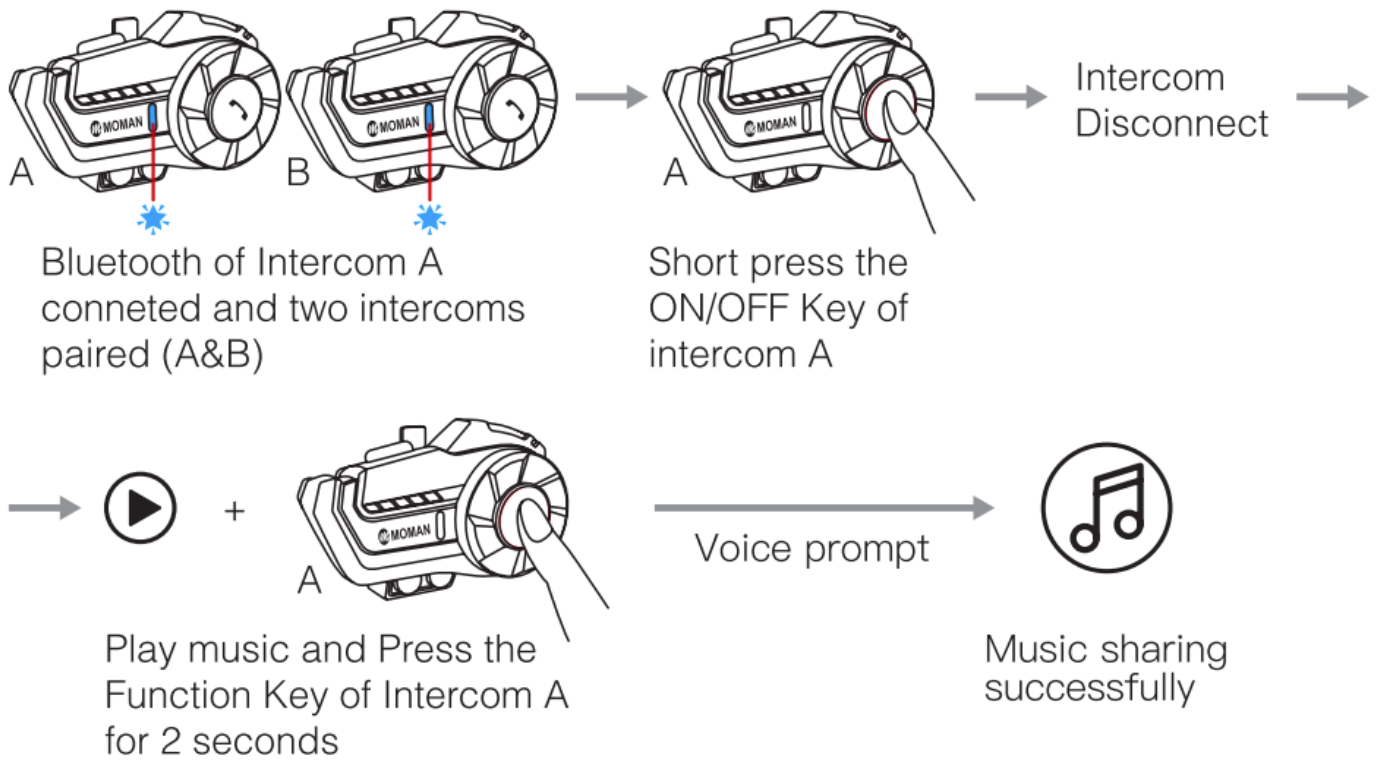

**OFF:** Press the Function Key of Intercom A for 2 seconds

### Multi-Mode Switch

Between Intercom and Musci/FM Radio:

### Moman (UK) Limited

**Between Intercom and Mobile Phone:**

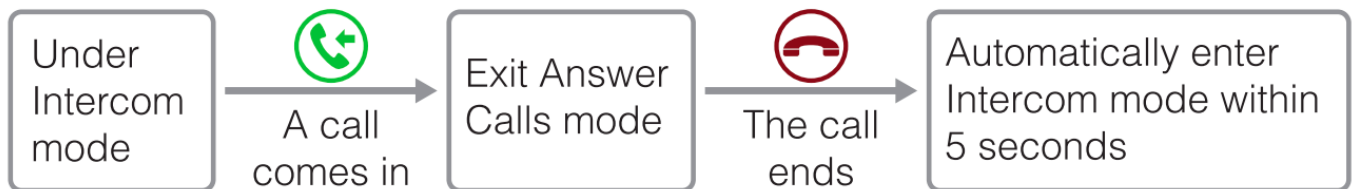

### 10. Function Priority Level

1. Mobile Phone Level
2. Intercom Level
3. Music/FM Radio

### Installation

#### Method 1: Install with Back Clip

1. Use the screwdriver to loosen the screws of the back clip so that it can open to a proper extent.



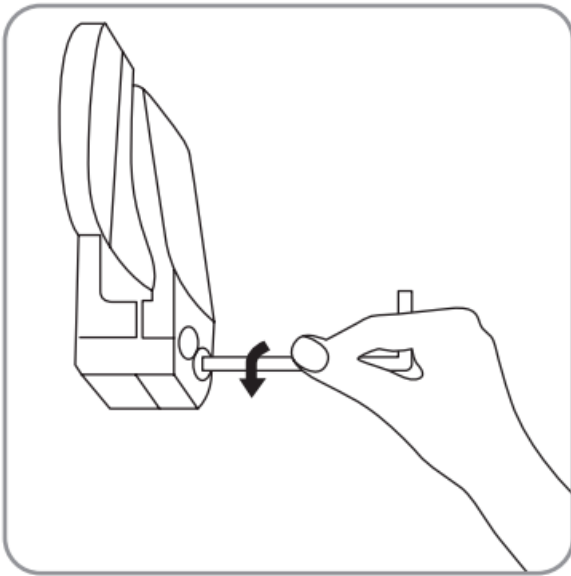

2. Open the helmet liner, insert the clip into the right position on the left side of the helmet and tighten the screw.

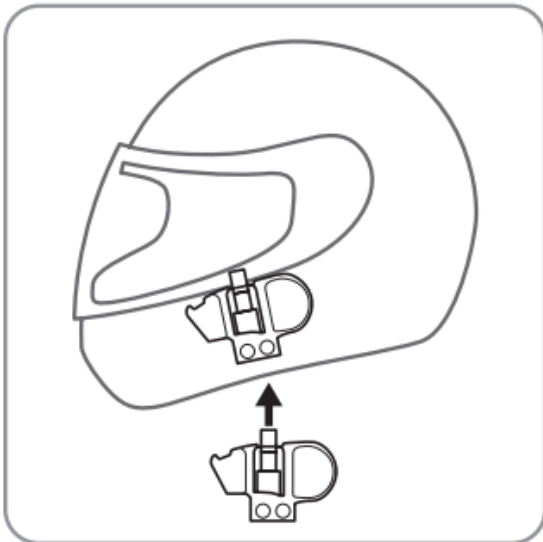

3. Slide the intercom into the back clip slot to make sure it locks firmly.

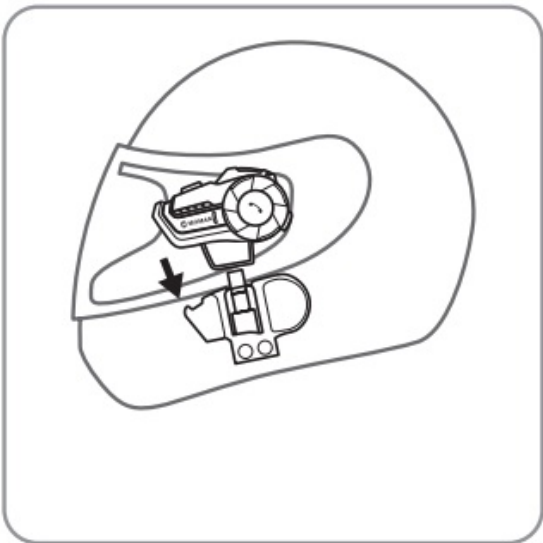

4. Open the helmet liner (ear position), clean the EPS surface of the helmet, and stick a piece of horn Velcro on the left and right sides of the helmet.

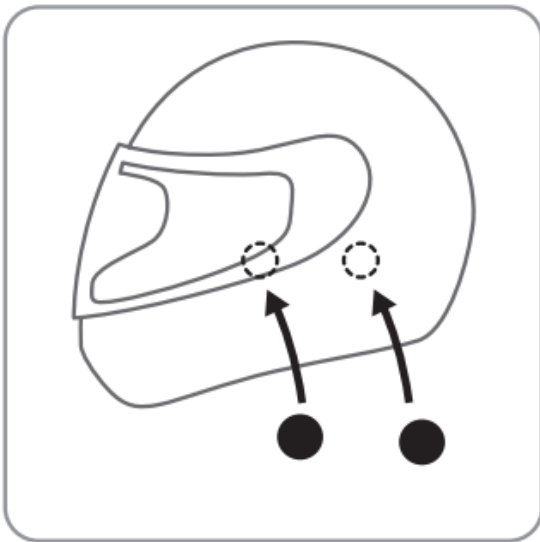

5. Stick the speaker on the fixed Velcro surface and the speaker with short line should be installed close to the machine. Fix the microphone and arrange the helmet lining and cable.

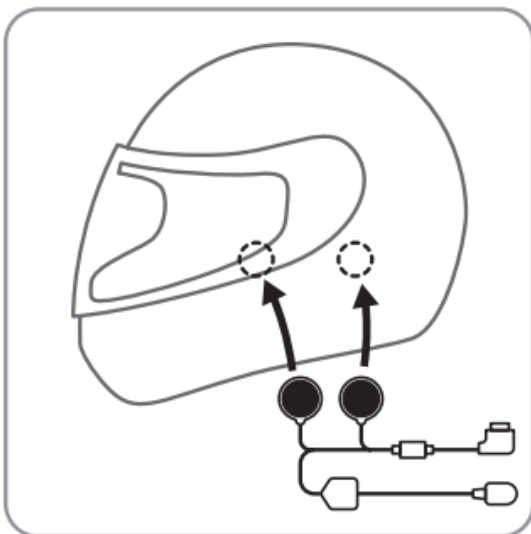

6. Insert the headset into the jack of the intercom and tie up the headset cable.

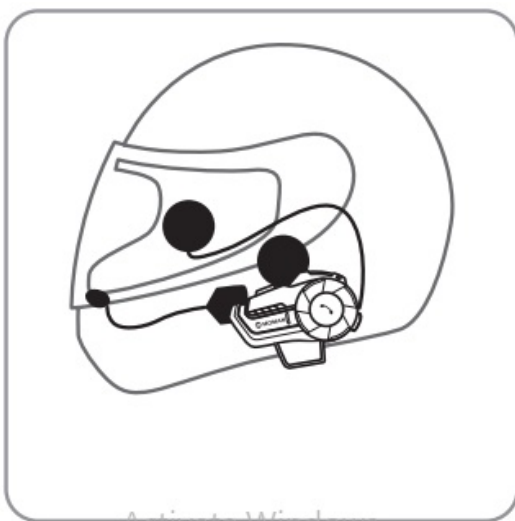

### Method 2: Install with Velcro Clip

Separate the hook and loop fasteners. First stick the hook onto the Velcro clip; choose the right installation position on the helmet and stick the loop to the position. Install the intercom onto the Velcro clip. The installation of speakers can refer to the description above.

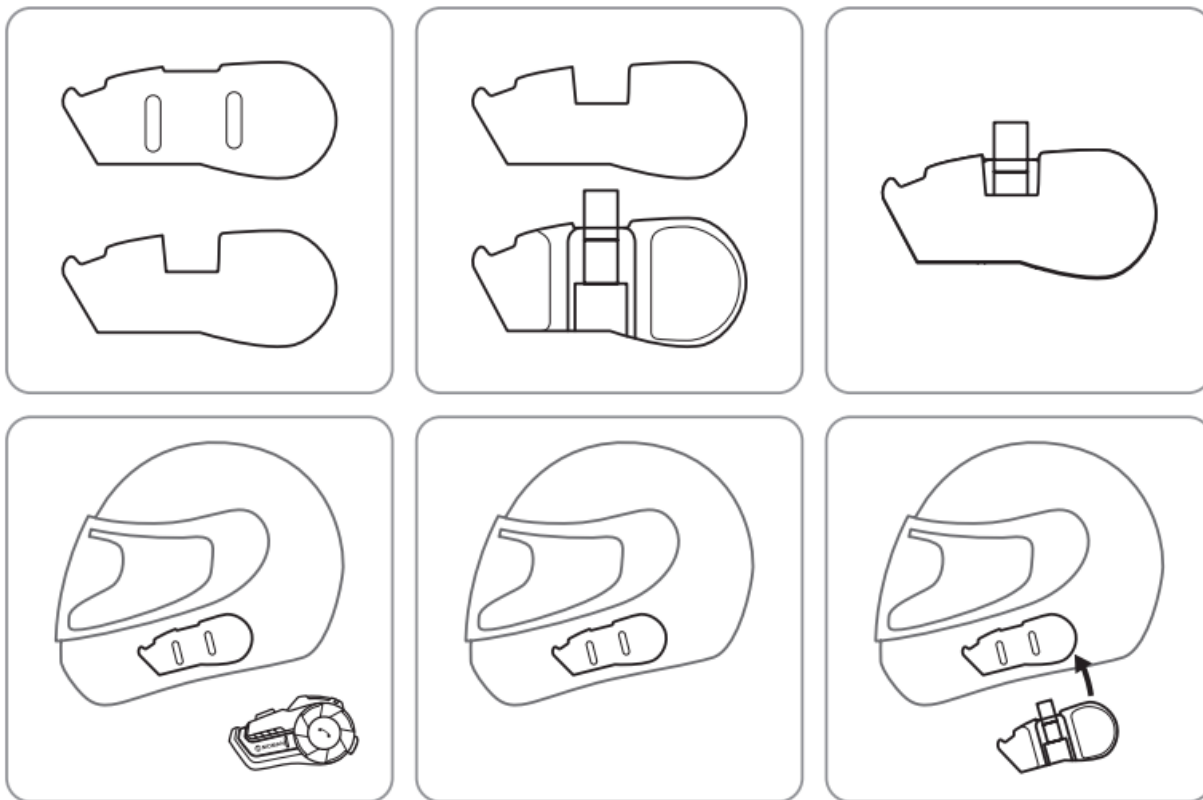

### How to Remove the Intercom from Helmet

First unplug the headset, then press the fixed buckle in the middle of the back clip with one finger (push towards the side of the helmet), so that the back clip hook is detached from the intercom, and push the intercom upwards to let it slide out of the back clip smoothly to complete the disassembly.

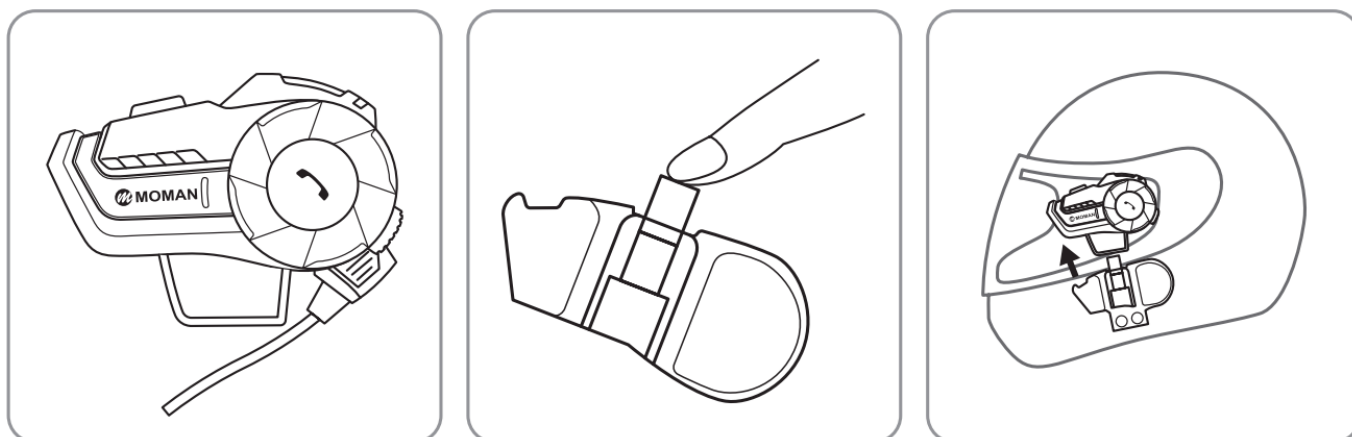

### How to Fix the Headset Plug (If necessary)

Unscrew the screws on the back of intercom with screwdriver, open the buckle flap, plug in the headset plug and tighten the screws. If you need to plug out the headset, please open the buckle flap by unscrewing the screws.

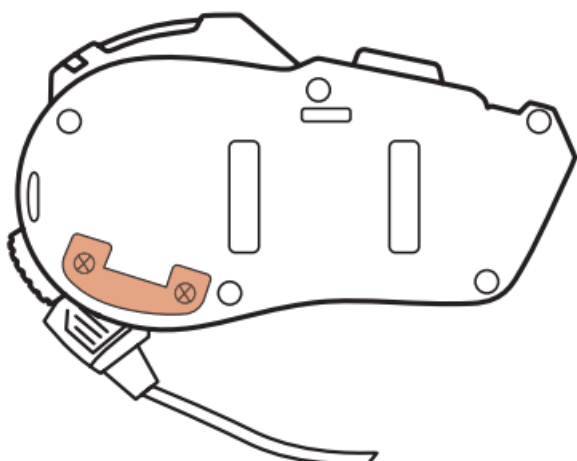

## Installation

1. Before using the Bluetooth intercom, please use the attached charging cable to charge the intercom. The small type-C Interface on the charging line is connected to the USB charging interface of the Bluetooth intercom, and the large USB connector on the charging cable is connected to the following charging interface for power supply:
  - A. USB Interface of computer;
  - B. A mobile power supply with DC 5V output;
  - C. A USB power adapter with DC 5V output
2. When charging, the red LED is always on, and when fully charged, the red light goes out slowly. It takes up to 2.5 hours to fully charge the unit.

## Notes

1. If you do not use intercom for up to one month or more, please charge the Intercom once every two months in order to protect the lithium battery;
2. The storage temperature of this product is -20 °C to 50°C, and do not store in the environment with too high or low temperature, otherwise, the service life of the product will be affected,
3. Do not expose this product to fire to avoid explosion,
4. Only two screws on the back of intercom can be opened. Do not open other screws to the intercom to avoid short circuit of main board or battery damage.



Unit 25 Basepoint Business Centre, Aviation Park, West Christchurch, United Kingdom BH23 6NX



[www.momanx.com](http://www.momanx.com)



MomanGlobal



<https://moman.co/youtube>



## Documents / Resources

	<a href="#">MOMAN H2 Pro Headset Helmet Intercom</a> [pdf] User Manual H2 Pro Headset Helmet Intercom, H2 Pro, Headset Helmet Intercom, Helmet Intercom, Intercom
--	--

## References

- [User Manual](#)

[Manuals+](#), [Privacy Policy](#)

This website is an independent publication and is neither affiliated with nor endorsed by any of the trademark owners. The "Bluetooth®" word mark and logos are registered trademarks owned by Bluetooth SIG, Inc. The "Wi-Fi®" word mark and logos are registered trademarks owned by the Wi-Fi Alliance. Any use of these marks on this website does not imply any affiliation with or endorsement.