



Moleskine SWSAB33BK01 Smart Writing Set User Guide

[Home](#) » [MOLESKINE](#) » Moleskine SWSAB33BK01 Smart Writing Set User Guide 

Moleskine SWSAB33BK01 Smart Writing Set User Guide



Contents

- [1 Introduction: about the Smart Writing Set](#)
- [2 Getting to know your Smart Writing Set](#)
- [3 Moleskine Notes App](#)
- [4 Pen](#)
- [5 Our portfolio: Moleskine Smart Notebooks](#)
- [6 Our portfolio: Smart Planners](#)
- [7 Troubleshooting](#)
- [8 Documents / Resources](#)
 - [8.1 References](#)
- [9 Related Posts](#)

Introduction: about the Smart Writing Set

At Moleskine we believe in the timeless power of handwriting as an essential expression of human civilization, a powerful act to unleash human genius and foster the development and sharing of literacy and knowledge. Handwriting is both universal and deeply personal. It's a thoughtful way to express your true self and connect to others in a very intimate yet universally accessible way.

Put pen to paper and unleash your unique voice.

We also believe in the infinite potential for continuity and connection between analogue and digital tools. This bridging of page and screen is essential to fulfil our users' needs.

Moleskine Smart is an ecosystem of smart tools and services designed to simplify the creative and productive process, allowing an idea to evolve naturally on paper before being edited and shared digitally

You can visit our website using the following link: <https://www.moleskine.com/home>

+This guide is the first step in familiarizing yourself with your Smart Writing Set. It will help you to answer some of the questions you may have and facilitate your experience.

If you have a specific question, please check our FAQs.

Getting to know your Smart Writing Set

How does the Smart Writing Set work?



The Smart Writing Set is designed to amplify the note-taking process by combining the power of technology with

the instinctive feel of exploring ideas on paper. It features a Smart Pen, connected via Bluetooth to the Moleskine Notes App, and a special Smart Notebook featuring Ncoded technology: a hidden grid embedded within the pages which enables words and drawings to be transformed into digital documents.

Discover the Smart Writing System:

<https://www.moleskine.com/en-us/shop/moleskine-smart/smart-writing-system/>

What is included in the Smart Writing set?

The Smart Writing Set comes with a Smart Pen, an Ncoded Smart Notebook, a magnetic charger, and a spare black ink refill.



The Smart Writing Set is available on [moleskine.com](https://www.moleskine.com), Moleskine stores and retailers. You can purchase Smart Planners and Smart Notebooks individually from Moleskine stores, retailers or via our website. More Moleskine Smart Notebooks featuring Ncoded paper will be introduced in the future.

You can download the Moleskine Notes App on Apple store OR Google play. Please find more information about the app below.

Warranty and support system

Please find the warranty here:

https://www.moleskine.com/on/demandware.static/-/Library-Sites-MoleskineSharedLibrary/default/dwbe893d20/pdf/2WARRSMPEN04_Warranty_8no_10%20lang.pdf

At Moleskine, we want to make sure you get the most from your Smart Writing Set. You can reach us using the Support section on our website. The FAQ section can be accessed here: <https://www.moleskine.com/it-it/faq>

If you have any inquiries regarding your purchase, the return process or defects, please contact us via: <https://www.moleskine.com/contact-us>

For technical questions not solved by reading our FAQs, please do not hesitate to contact us: notesapp@moleskine.com

Smart Pen serial number

The serial number is on the sticker on your Smart Pen. The serial number is useful to identify your product in case a problem occurs.

Smart Notebooks

All Moleskine Smart Notebooks are compatible with the Smart Pen and with the new versions of the Notes App. Check our website to browse our available portfolio of Ncoded Smart Notebooks and Smart Planners. You can also check your nearest Moleskine store or retailer.

For more details, see below.

Moleskine Notes App

The Moleskine Notes App

The Smart Writing Set app is called MOLESKINE NOTES. You need the app to connect the Smart Pen and sync your notes to your device

Compatibility: IOS (App Store) and Android (only Google Play).



The Notes App is the third element of the Smart Writing Set. By buying the set and downloading the Notes App, you will be able to digitize every pen stroke made on the pages of your Smart Notebook. Please download the Notes App to begin the experience – making sure you have enough storage space on your device.

Apple Store



Google Play



Compatibility

The Notes App is compatible with several mobile phones, Android tablets and iPads. You can download the Notes App using the following links: Apple Store OR Google Play

Make sure that you have Bluetooth support and the latest operating system on your device. If not, please update your device software.

Moleskine Notes app is not available on Windows

The new Notes App is currently not available on Windows OS.

How to move from the previous Notes App

The previous version of Moleskine Notes is still working but can't be downloaded nor is it updated anymore. If you have stored any data in the previous version of the app, you should keep it and proceed with the migration process before deleting it from your device.

Before starting with the new Notes App, if you have digital notebooks synced on the previous app version, please back-up your notes on Google Drive. Local migration is available to all users and it is the default setting

See below for more information about syncing.

Guide to the previous version of the Moleskine Notes app:

https://www.moleskine.com/on/demandware.static/-/Sites-masterCatalog_Moleskine/default/dwb033a449/pdf/SmartPen3_UserGuideA4_web.pdf

Main Notes App features:

Moleskine Notes helps you turn inspiration on paper into ideas on screen. You can:

- Digitize handwriting and sketches from your Smart Notebook
- Modify notes and drawings with powerful editing tools
- Transcribe your handwritten notes into digital font
- Export your drawings in vector formats
- Plan your work or personal events using a Smart Diary/Planner
- Search within all your notes and events
- Share notes and sketches with others or upload to cloud storage

Simply start writing in your Smart Notebook with your Smart Pen to create an instant digital copy of each notebook page in the Notes App

Exporting your drawings

The Notes App allows you to export digital pages as Images (JPEG/PNG), PDF, Vector file (SVG), Text, Word and PowerPoint.

How to start

After unboxing, charge your Smart Pen using the magnetic charger provided, keep your Smart Notebook at your fingertips and download the Notes App. Then, simply follow the instructions on screen.

Bluetooth and pairing

Open the app and step into the world of Moleskine Notes!

Once you have downloaded the Notes App, follow the steps on screen in order to pair your Smart Pen to the app via Bluetooth.

After making sure that your Smart Pen is charged (it takes 2 hours to fully charge), open the Notes App and click on "Add your Moleskine Smart Pen". If you don't have your Smart Pen with you or if it's not charged, you can still explore the app by clicking on "Proceed without Smart Pen". See screenshot below.

Please make sure your Bluetooth is on and that you "allow" your device to pair with new devices. Make sure you have the space to pair a new device.

Press the on/off button on the pen once: the LED will turn on (blue LED light) and the Smart Pen will automatically connect to the Notes App.

If you have a Pen+ or Pen+ Ellipse smart pen, please press the button for 3 seconds to connect to your device.



Screenshots of the Moleskine Notes App to help you set up your new Smart Pen.

Once the Smart Pen is recognized by the Notes App, you can tap on the pen icon to proceed. The next steps allow for personalization: you can give your Smart Pen a name and add a passcode.

If your Smart Pen is already connected, tapping on the icon will open the Smart Pen settings menu with options such as calibration and stats regarding the battery and memory.

Sync

The Smart Writing Set allows you to sync your notes at any time, even if the Notes App is not opened on your device.

If the Notes App is not running, make sure your Moleskine Smart Pen is turned on when taking notes. The light on your Smart Pen should be blue while connecting to your device and then green when it is ready to be used.

Your work is automatically saved when the Smart Pen is paired to the Notes App. If you are writing with the Smart Pen switched on but when the Notes App is not running, your notes will be saved to your device as soon as you activate the Notes App. Make sure that your smart device and operating system are compatible.

Ensure that the Moleskine Smart Pen firmware and Notes App software are updated to the latest versions. To check which version you're currently using, please go to the Support section in the Notes App.

Firmware

You can update your firmware in the Notes App by tapping the Smart Pen Settings icon (top right corner) > Firmware > Update

Make sure you have activated the Smart Pen connection icon in the top right corner (the icon glows when activated) when syncing your notes.

Migration from the previous version of the Notes App to the current version

If you are using the previous version of the Notes App, we kindly advise you to switch to the latest version, available on Google Play and on AppStore. The new Notes App will be updated with further releases and will keep on being your best option to view, store and edit your notes.

The previous version of the Notes App is no longer available. Please, do not delete the previous version from your device before downloading and switching to the new one. Follow these instructions to back up and move your digital contents from the previous version of the app to the new one:

- Open Moleskine Notes Legacy
- Open left side menu
- Tap “Settings” option
- Tap “Authentication center” menu item
- Turn on “Google Drive” toggle
- Sign into Google Account
- Go back to the “Settings” menu
- Tap “Backup & Restore”
- Turn on “Google Drive” toggle here as well
- Go back to side menu
- You should see an additional “Backup & Restore” item
- Follow the instructions to complete backup

Then, reopen the new Moleskine Notes

- Select “With Google Drive” as method
- Continue Migration (if you can’t find it open side menu > Settings > Migration)
- Connect to Google
- Transfer Notebooks

Local Migration

Follow these steps:

- Open Moleskine Notes Legacy
- Open left side menu
- Tap the orange “Export Notebook” button

Then reopen the new Moleskine Notes

- Select “Locally on this Device” as method
- Transfer Notebooks

Create a free account

In the Accounts area, you can create a Notes App account for free.

By creating an account, you can access your notes from any mobile device and back-up your notebooks.

To view your digitized notes on multiple devices, the Notes App needs to be downloaded on each device and the user login must match your account.

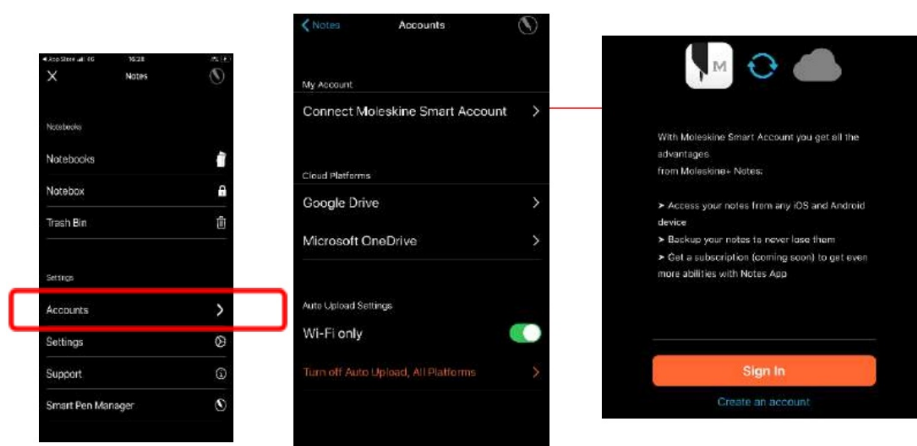

We advise creating an account to be able to view your digital notebooks from multiple compatible devices. Your data will be stored in your personal account.

Transcribe and modify text

The Notes App allows you to transcribe your notes from the pages of your Smart Notebook – turning your handwriting into digital font on screen. The third round icon in the central part of the screen is for transcription. You will be able to see the transcribed format (font) of your notes on screen. You can add and edit sentences using your device keyboard.

Writing and drawing tools on the Moleskine Notes App

Within the Notes App you can draw on and edit your notes by following these easy steps:

Click on the central round icon to draw and edit your notes. You can highlight or insert simple drawings interacting with the screen of your device.

Edit allows you to select text and change the thickness and colour of your strokes. In order to change the thickness, select the pen icon at the bottom of the screen (the first).

The second pen icon is the highlighter. You can change the color of your pen and highlighter with the options provided in the color palette. Select the pen or the highlighter, then change the color.

Sketching on paper

The Smart Writing Set not only transcribes text, but also digitizes your drawing and sketches. An exact digital version of your creation appears in the Notes App in real time. You can also store and share the time-lapse of your drawing process. Please check below for more information.

Writing replay and time-laps

Handwriting is automatically recorded from start to finish. If you want to watch back the process from the first pen stroke to the last, press “play” in the top left corner of the screen (see image below).



You can choose the speed of the video in the options provided on the banner, as well as the time-lapse and real-time options. You can export the final product and share it with options provided, or directly save the file on your device.

Email set up and sharing

Tapping the envelope on the page of your Smart Notebook allows you to share the page, with various sharing options available. With just a few clicks, you can share each page to an email address already setup on your device

Check your device settings in order to set up a default email account for email sending.

You can share work by tapping the envelope icon in your Smart Notebook or Planner with your Smart Pen and following the steps on your device

Voice and video recording

The Moleskine Notes App and Smart Pen allow you to make voice recordings. Below each page you can find the “voice record” icon. Press to start recording.



Search and tags

The new Notes App allows you to search for Smart Notebooks and specific words: tap on the “Search” field and start typing the word you want to find. You can search your notebooks, transcribed pages, tags, dates, comments and attachments (this feature is coming soon) as well as other properties

Tags can be added to each page and to individual Smart Notebooks. Each tag can have a color (type or select to choose) and/or a name. Names and colors facilitate the searching and grouping process on your work online

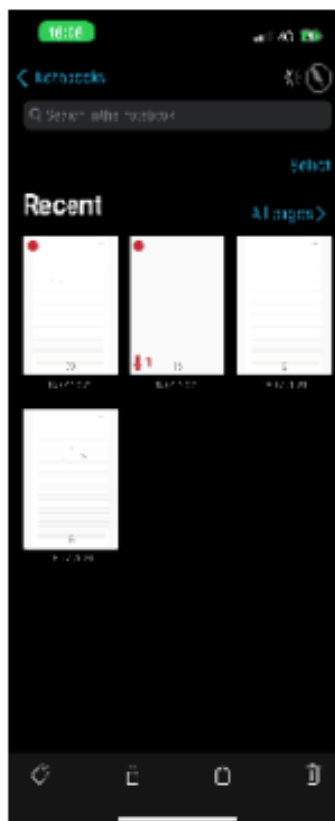
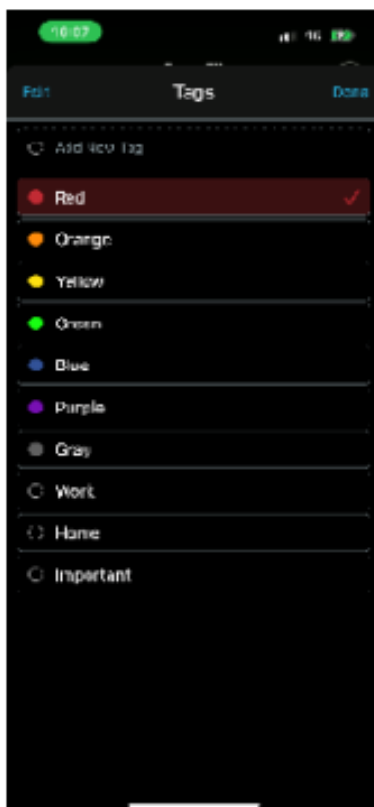

Languages

The default language of the Notes App is English, but there are 30 languages available. You can choose just one

additional language alongside English.

Pen

There are 3 models of Smart Pen available :

The Moleskine Pen+ (no longer for sale), the Pen+ Ellipse, and the newest Smart Pen.

Moleskine Smart Pen



Moleskine Pen+ Ellipse



Smart Pen features compared

Pen+ Ellips	Smart Pen
Metallic finish	Soft finish
Metallic finish	Rounded shape
Weight: 22g without pen caP	Weight: 15.8g without pen cap
Length: 16 cm (with pen cap)	Length: 14.6 cm (with pen cap)
Pressure sensitivity: 1024 levels	Pressure sensitivity: 4096 levels
Battery 5H (of continuous usage)	Eco mode available. Battery – Eco mode ON 11H – Eco mode OFF 8H
Charging cable (plastic covered)	Charging cable (textile covered)
USB charging cable	Magnetic charging cabl

Battery charge and battery life



The Smart Pen (new version) can only be charged using the specific cable provided with it in the Smart Writing Set (POGO magnetic connector → USB). The USB port can be connected to any smartphone charger/pc USB power port)

The Moleskine Smart Pen takes about 2 hours to fully charge. The fully charged Moleskine Smart Pen will provide from 8 to 11 hours of non-stop writing (depending if eco-mode is switched on).

The Pen+ Ellipse provides a continuous usage of 5 hours.

Power on/off

Auto on: Auto-on is a setting that means that the Smart Pen switches on automatically when it touches the page and you start writing. Auto-on is activated by default after the Smart Pen is first paired with the Notes App, but can be disabled on the Smart Pen info and Settings page (icon in the top right corner or in the left menu > Pen Manager > Smart Pen)

Automatic power-off is set by default with the Smart Pen's 20-minute battery-save mode.

The battery may be low when first purchased and we strongly recommend charging before use. It takes 2 hours to fully charge the Smart Pen. Check the "Battery charge and battery life" section for more information about the battery.

To use the reset feature, press the Smart Pen power button for about 10 seconds.

Formatting your Smart Pen

When you wish to cancel all the data stored in the Smart Pen, you can format it by keeping the power button pressed for 10-15 seconds.

To delete the data currently stored in the Smart Pen memory, pair the Smart Pen and insert the wrong passcode 10 times.

Setting a passcode

The passcode will allow you to keep your data protected. Should anyone else use your pen, they could format it and use it but they won't be able to access your notes. You can set it during the initial set up, as suggested, or decide to skip it. If you wish to add it later on, pressing on the pen icon on the upper corner right, you can insert the Password (4 digits). If you enter the wrong password 10 times, the data stored in the internal memory of the pen will be erased.

LED colors of the new Smart Pen

Blue: Smart Pen is pairing but not yet synced with your device.

Green: Smart Pen is connected to the app and ready to use with any Moleskine Smart Notebook or Smart Planner.

Yellow: Smart Pen is running out of memory. Please connect it to the Moleskine Notes App to transfer your Smart Pen data.

For more information, please check the section below

If you are asked to check your Smart Pen's optical sensor, please refer to chapter 7.3 to solve the problem.

Calibration

The Smart Pen Calibration function allows you to regulate the width and sharpness of your handwriting on screen depending on the amount of pressure you typically apply when writing on the page. Move the slider in the Pen Calibration graph so that your handwriting appears thicker or thinner based on your unique writing style.

If you have already registered your Smart Pen, you can explore this function by clicking on the pen icon on the top right of the app page, then going to the calibration section

Calibration setting view within the Notes App

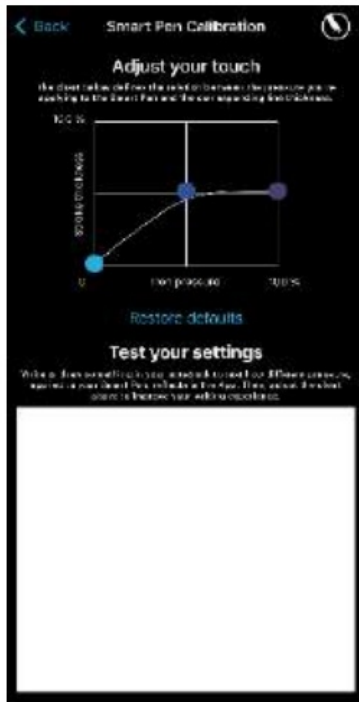

Lead change

You can order a new lead (ink and cable) at your nearest Moleskine retail store, on moleskine.com or at a Moleskine retailer.

Ink refill

The Moleskine Smart Pen uses a standard D1 mini refill that is widely available in various formats and colors.

The Smart Writing Set comes with 2 Ink refills, one already in the Smart Pen and a spare. We can provide a recommended refill list to guarantee the best performance of the Moleskine Smart Pen: Ncoded technology uses carbon ink, so all pen strokes need to be carbon-free in order not to affect recognition precision.

Recommended Smart Pen refills:

ZEBRA – 4C TYPE MITSUBISHI – SE TYPE
KAWECO
PARKER
PILOT
STAEDTLER
SAILORPEN
ROTRING
CARAN D'ACHE

KYOCERA
SHACHIHATA
VISCANTI
YARD-O-LED

Our portfolio: Moleskine Smart Notebooks

This new way of writing puts together the Smart Pen and Ncoded Smart Notebooks to digitize your handwritten ideas. Ncode is a technology that uses invisible patterns of dots or lines within the pages of our beloved notebooks. With the help of the Smart Pen, your notes and sketches are instantly recreated on your device. Ncode paper helps the Smart Pen digitize every line and word you add to the page. Ncode is also designed to allow you to identify an exact location in a specific Smart Notebook.

Our current Smart portfolio features Smart Notebooks (hard cover black, ruled, large and XL) and Smart Cahiers (pocket, large ruled and XL Plain). More Moleskine Smart Notebooks will be available soon.

Discover all available Smart Notebooks here:

<https://www.moleskine.com/en-us/shop/moleskine-smart/smart-writing-system/smart-notebooks/>

Discover the Smart Writing System here:

<https://www.moleskine.com/en-us/shop/moleskine-smart/smart-writing-system/>

Compatibility Smart Pen versions/Smart Notebooks

All you need is a Moleskine Smart Notebook featuring the Ncoded technology: a hidden grid embedded within the paper enables the Moleskine Smart Pen to recognize both individual pages and where you are on each page. Both our previous Smart Pens are compatible with our current Smart Notebooks. See the following link to buy the Smart Writing system.

More Moleskine Smart Notebooks featuring Ncoded paper will be introduced in the future.

Using more than one notebook

The Moleskine Smart Pen can recognize where you are in each Smart Notebook thanks to a hidden grid embedded within each page. Notebooks that use this technology are coded according to type. You will find all your notebooks listed in the Notes App, however, if you wish to use two notebooks of the same type, the app will recognise them as one. Please block the one you will not be using. Please refer to the Notebook Lock and Unlock feature in the Main Menu to be able to keep both within the Notes App, but always keep just one active.

By pressing the lock icon (second one on the lower bar), you will be able to block the Smart Notebook



Virtual notebooks

Please remember that with the new Notes App, it is no longer possible to create a “virtual notebook” by matching pages from different physical Smart Notebooks.

Our portfolio: Smart Planners

Getting started with Smart Planners

Our current Smart portfolio features the Smart Planner (hard cover, black, weekly 12-month) and the Smart Planner Pro (hard cover, black, weekly, 12-month).

Smart Planner Pro



Discover our Smart Planners here:

<https://www.moleskine.com/en-us/shop/moleskine-smart/smart-writing-system/smart-planner/>

Discover the Smart Writing System here:

<https://www.moleskine.com/en-us/shop/moleskine-smart/smart-writing-system/>

The Smart Planner gives you a new way of planning.

The first time you write in your Smart Planner, you'll be invited to connect it to a digital calendar on your device. Setting up this connection will allow the Notes App to create events on the device calendar that mirror the ones you write on paper.

In order to connect your planner to your device, please follow these steps:

Connect your Smart Pen to your device (see the steps above)

Once you start writing in your Smart Planner, the Smart Pen will recognise the page and type of notebook.

Within the Notes App you can see all your Smart Notebooks and Smart Planners on the main page (Notebooks page) and block the ones you are not using.

The Smart Planner has different page layouts: Monthly, Weekly Vertical and Weekly Horizontal (PRO). Depending on the page layout, some information about your events is automatically recognized, then you can add additional information like start time and duration as specified in this guide.

Migrating from a previous version of the Moleskine Notes App

In the former Notes App, digital calendars were updated via the “Authentication Center”, while in the current Notes App they synchronize directly with the digital calendars connected to your device.

Type of Smart Planner

The Weekly Planner features the days of the week listed vertically on the left page opposite an extra page for notes.

The Weekly Pro Planner features the days of the week in columns, with lines for time slots.

The Monthly Planner, integrated as a special view in the Smart Planner and in the Smart Planner Pro.

Discover our Smart Planners here:

<https://www.moleskine.com/en-us/shop/moleskine-smart/smart-writing-system/smart-planner/>

Smart Planner compatibility

A digitized version of your Smart Planner will be available on whichever device has your Moleskine Notes App and which is linked to your Smart Pen. Please check above for app and device compatibility information.

Once your events are synced with your digital calendar, they will be available on all the devices you have synced to your calendar account.

Modify events and duration

You can edit or cancel events within your preferred digital calendar.

(If you strike through an event in your Smart Planner, it will appear struck through in the digital version of your Smart Planner within the Moleskine Notes App. However, the event will not then be deleted from your preferred digital calendar). You can also edit the duration of single events you have already created.

Appointment sync with the application off

Appointments are synced only when the Smart Pen is connected to the Moleskine Notes App via Bluetooth.

If you write an event off-line (you write in Smart Diary/Planner PRO with your Smart Pen turned on, but without connecting to the Notes App) the event/s in question will be synced to your calendar the moment you connect your Smart Pen to the Moleskine Notes App.

Sync Smart Planner with online calendars if you missed the initial set up Open the notebook within the Notes App and a list of the pages is shown

- Tap on the “tag” button, the first at the bottom of the screen

Tap on “Calendar to sync with” and select the calendar (Grant permissions to Calendar)

- Switch on the “Auto-sync calendar” toggle

Once this is done you should be able to see the transcription in the transcription view and see the detail of the even

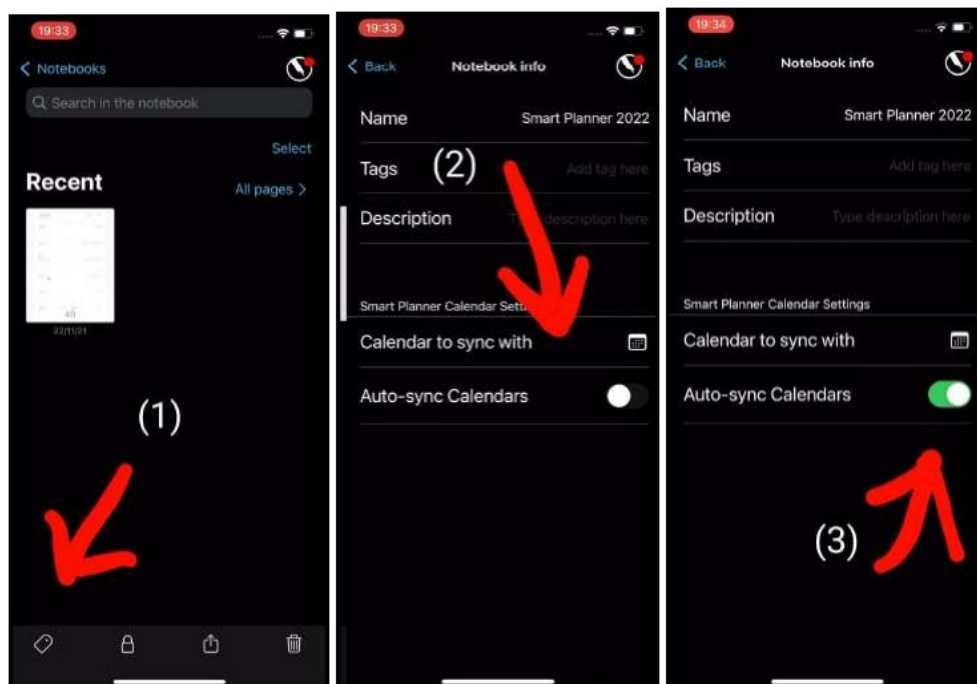

Writing event slots

The Smart Planner currently supports the following time format: 12 hour AM/PM notation.

The 24-hour clock is not currently recognized.

The Smart Planner supports the following formats for indicating time span:

All of these examples will create a 2-hour event from 1PM to 3PM

If you only specify an event start time in the Smart Planner, a 1-hour event is automatically created in your digital calendar

Create an all-day event slot

To create an all-day event, simply write the event name without specifying a time.

Time formats such as AM and PM are NOT recognized while creating an all-day event.

Overnight events

You can write events that last up to 23 hours and 59 minutes from any time on one day to the next. Simply record the event and timing on the start date.

For example: 09PM – 01AM Gala dinner

Event slots

The minimum time slot is 1 hour. You can write on the first or second line or both; in any case an hour-long event beginning on the hour will be recognized.

Event slots Monthly Planner

With the Monthly Planner, which is integrated into both the Smart Planner and the Smart Planner PRO, you will be able to create a single all-day event for each day.

Monthly Smart Planner with all-day events displayed



Troubleshooting

Smart Pen does not turn on

Automatic power-off is set by default with the 20-minute battery save mode feature.

The battery may be low. Please charge before use with a 5.0 V power rating charger. Press the turn on button once in order to connect your Smart Pen.

If you are still having problems after making sure your Smart Pen is correctly charged, please contact us at: notesapp@moleskine.com

Bluetooth issues

Please check again after rebooting both your Smart Pen and device. If the connection is still not working, even when you try with a different smart device, then the Smart Pen may need a professional inspection. Please check the sections above for Compatibility and Pairing help.

When you alternate between Moleskine Notes and other devices or apps, we recommend that you disconnect the pen from the service you were using or close the app before switching to the other service.

Please try to add the pen again from the Pen Manager section in the Notes App.

If you have downloaded the Notes App on several devices, please make sure that only the Bluetooth of the device you are using is activated.

Handwriting not recognised

The easier your handwriting is to read, the more accurate the transcription process will be. The best way to hold the Smart Pen is with the tip facing the page, writing horizontally. If you encounter any issues:

Check that the LED on the Smart Pen is green.

Please remove the plastic protection located on the tip of the Smart Pen before writing.

Gently remove any foreign substances from the glass under the pen tip with a cotton swab.

Ensure that your Bluetooth connection is working.

Retry data transfer.

Adjust stroke and pressure in the Settings menu. For more detailed information, refer to the “Calibration” section above.

Notes missing

Please check if the Smart Pen sensor is clean, if the product is exposed to direct sunlight, if the Smart Pen is being held the right way, or if the light is of

Usage Angle

Hold the pen in order to avoid pressure on the wrist and maintain a natural writing angle

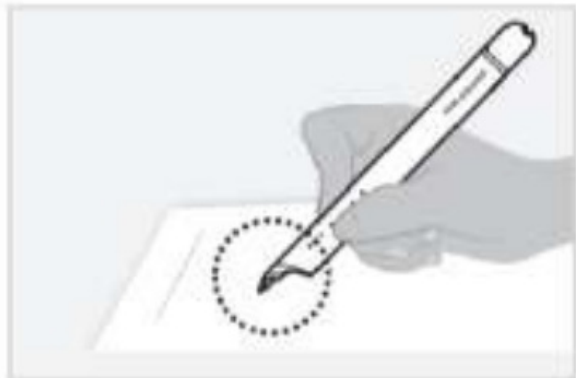

Allowable Recognition Angle

Pen's acceptable recognition angle is $20^{\circ} \pm 40^{\circ}$ (90° vertical standard).

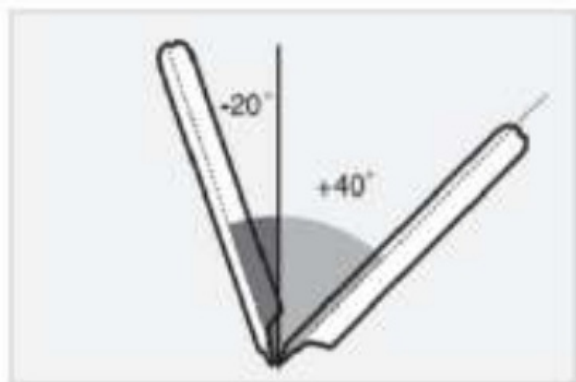

If you use the Smart Pen with the sensor not facing the paper, then there is an increased chance of product malfunction and omitted pen strokes. If the problem persists even after the taper is removed, then the glass sensor beneath the tip may have been scratched. In this case, there will be a charge for repairs.

Within the Notes App, please check that each stroke of the Smart Pen is mirrored on screen. Do not close the app while the sync pop up is open.

Check the percentage of transferred data in the settings and be sure that it is 100%.









Sometimes the data is there but there are delays with the sync. Please tap on the upper right corner featuring the pen icon for an update or go back to the front cover of your notebook for an update

More questions?

Please contact support using notesapp@moleskine.com

	<p>Moleskine SWSAB33BK01 Smart Writing Set [pdf] User Guide</p> <p>SWSAB33BK01 Smart Writing Set, SWSAB33BK01, Smart Writing Set, Writing Set, Set</p>
---	--

References

-  [Contact us | Moleskine](#)
-  [Smart Writing System: Notebook, Planner and Pen | Moleskine](#)
-  [Smart Notebook | Moleskine](#)
-  [Smart Planners | Moleskine](#)
-  [Moleskine® sito ufficiale - Agende, taccuini, quaderni | Moleskine](#)
-  [Sites-Moleskine_EU-Site | Moleskine](#)
-  [Moleskine Smart | Moleskine](#)
-  [Smart Writing System | Moleskine](#)
-  [Sites-Moleskine_EU-Site | Moleskine](#)
- [User Manual](#)