



Mokot 288 LED Solar Sensor Light User Manual

[Home](#) » [Mokot](#) » Mokot 288 LED Solar Sensor Light User Manual 

Contents

- 1 [Mokot 288 LED Solar Sensor Light](#)
- 2 [INSTALLATION](#)
- 3 [OPERATION GUIDE](#)
- 4 [WARM TIPS AND Modes](#)
- 5 [Documents / Resources](#)
 - 5.1 [References](#)
- 6 [Related Posts](#)

Mokot

Mokot 288 LED Solar Sensor Light



INSTALLATION

Press the button on the back and select the desired mode.

Then choose a place that can get enough sunshine to install this wall light. The longer it gets sunshine, the longer the lights can last.

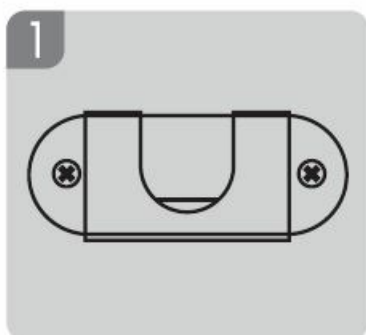

Waterproof button switch

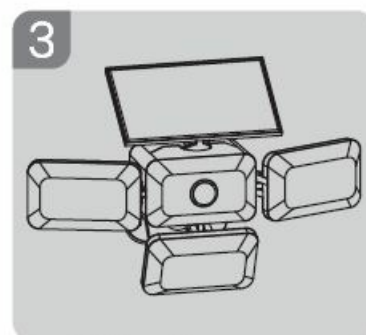
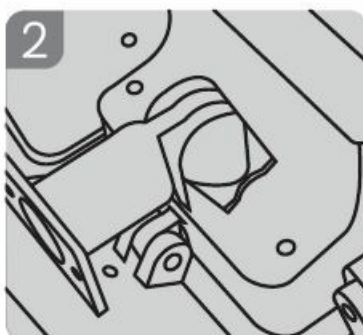
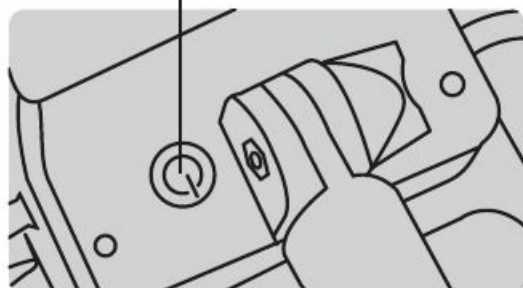

nut fixation

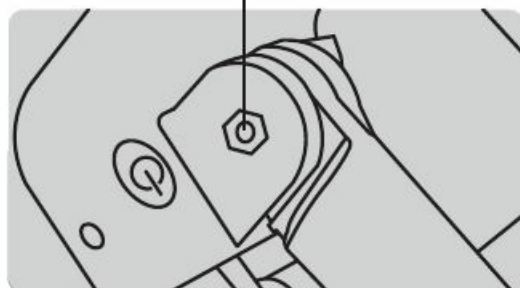

1. **FIX THE BASE(pic 1):** Punch two holes on the wall with a drill bit, Insert the attached expansion pillar-hinge into holes, drill the screws through the base into the wall.
2. **CHOOSE THE ANGLE, INSTALL THE LIGHT(pic 2):** install the adjustable pivot arm part to the back, attach the pivot arm to the base, adjust the desired angle, then tighten it through the knob screw

OPERATION GUIDE

The default mode of the product is OFF mode. Press the back button or use the remote control to adjust modes using the light.

4 Lighting Modes

- **Press once to enter into MODE 1**
 - Automatically detect the changes in the brightness of the external environment. When the brightness is low enough, it will automatically switch from energy-saving mode to lighting mode without motion detection (Auto on at night Auto off at sunrise).
- **Press twice to enter into MODE 2**
 - In dark the light will automatically turn on the Low Light lighting. When the sensor detects people coming it will enter Strong Light lighting, and after the person leaves for 20s will back to Low Light lighting.
- **Press three times to enter into MODE 3**
 - When detect people are coming, it will auto turn ON with Strong Light. After the person leaves for 20s will auto turn OFF the light.
- **Press four times to enter into MODE 4**
 - In dark the light will automatically turn on the the light which would flashes continuously.
- **OFF**
 - Based on Mode 4, press the power button again, the LED Solar Sensor Wall light power off.

WARM TIPS AND Modes

WARM TIPS

1. It is recommended to turn off the light and charge it under direct sunlight for 1-2 days before the first use. Make sure the product has enough power.
2. During the installation, please make sure the LED Solar Sensor Wall light is installed under direct sunlight where there is no shade or eave to shelter the solar panel. Otherwise, the lighting time will be shorter.
3. That whether the LED Solar Sensor Wall light can produce the best lighting effect or not depends on sunlight intensity, geographical location, weather conditions, seasons, and other conditions.

Two Ways to Change Modes

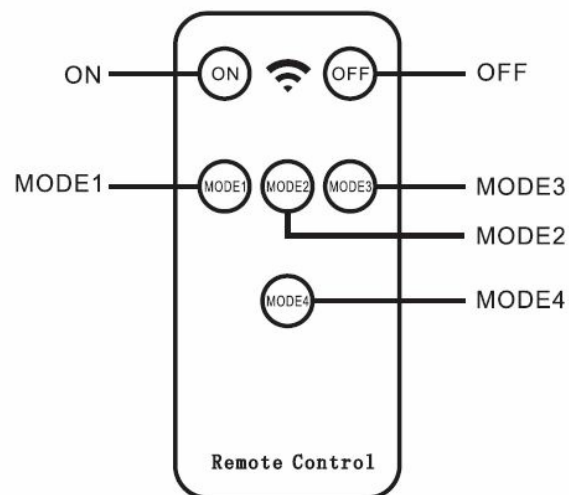
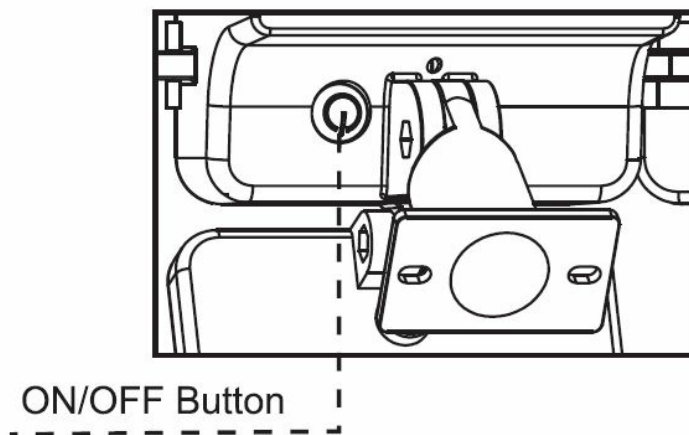

1. Click the black button on the back of light panel, each press the black button will change one mode. Mode set in cycle(Mode1-Mode2-Mode3-Mode4-off).
2. Change mode with Remote control. But you must active the lights by click the button on the back of lights.



Documents / Resources

	<p>Mokot 288 LED Solar Sensor Light [pdf] User Manual 288 LED Solar Sensor Light, 288, LED Solar Sensor Light, Solar Sensor Light, Sensor Light, Light</p>
---	---

References

- [User Manual](#)