



# Moes ZSS-S01-TH Temperature Humidity Sensor Instruction Manual

[Home](#) » [MOES](#) » Moes ZSS-S01-TH Temperature Humidity Sensor Instruction Manual 

## Contents

- [1 Moes ZSS-S01-TH Temperature Humidity Sensor](#)
- [2 Product Introduction](#)
- [3 Packing List](#)
- [4 Technical Parameters](#)
- [5 Installation Instructions](#)
- [6 Preparation for Use](#)
- [7 Add device](#)
- [8 SERVICE](#)
- [9 WARRANTY CARD](#)
- [10 Documents / Resources](#)
  - [10.1 References](#)
- [11 Related Posts](#)



**Moes ZSS-S01-TH Temperature Humidity Sensor**



## Instruction Manual

Temperature & Humidity Sensor Zigbee 3.0

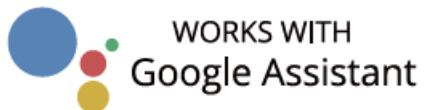

## Product Introduction

Temperature and humidity sensor is a sensor that detects the temperature and humidity of the surrounding environment and can sense subtle temperature and humidity changes and report them to the mobile phone APP, and users can view the current and historical temperature and humidity data on the mobile phone. It can be moved and placed at will or installed by sticking. Can be linked through the gateway to control other smart products, such as linkage with smart air-conditioning, smart humidifier, smart fresh air system and other equipments.

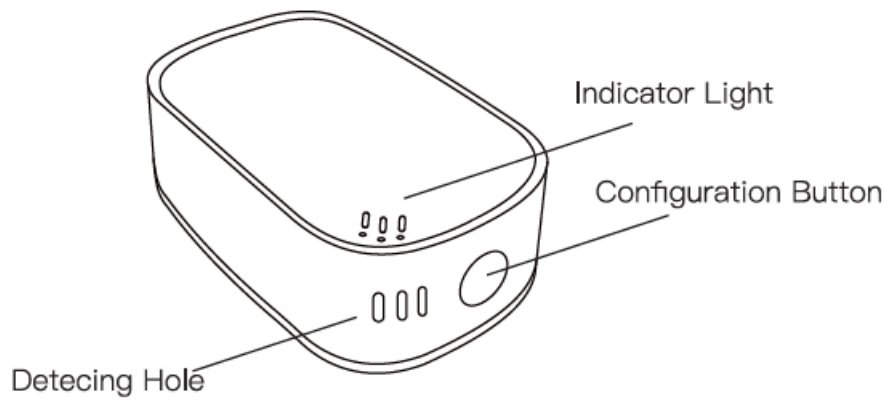

\*This product needs to be used with Zigbee gateway or multi-mode gateway.

## Packing List

- Temperature & Humidity Sensor \*1
- Battery \*1
- Product user manual \*1
- Double-sided sticker \*1

## Technical Parameters

Model	ZSS-S01 TH
Product Name	Temperature & Humidity Sensor
Wireless Connection	Zigbee
support Low Battery Alarm	Yes
Operating Temperature	-10°C – +50°C
Battery Specifications	CR2032 (replaceable)
Temperature Measurement Range	-10°C – +50°C
Humidity Measurement Range	0%-99%RH
Product Size	40*26*13mm

## Installation Instructions

1. **Method 1:** No need to paste, simply place it in the desired position.

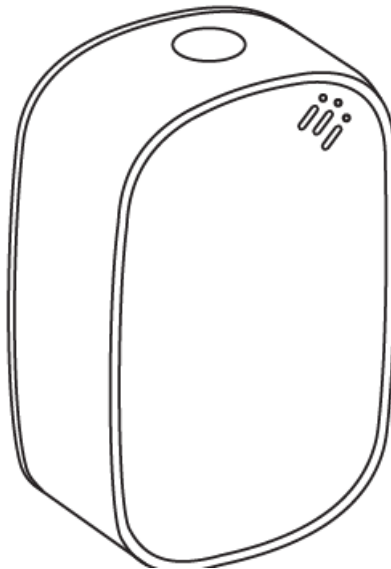

2. **Method 2:** Tear off the adhesive and stick it in the desired position.

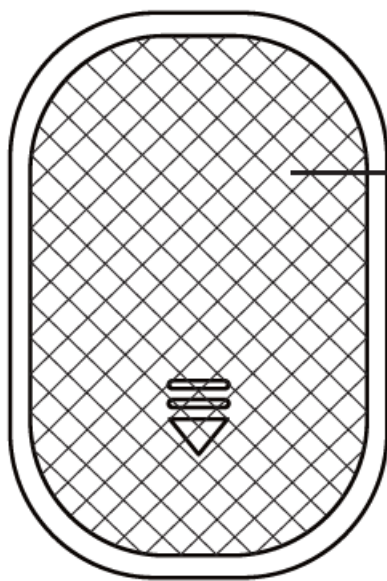

Adhesive tape

- The bonding surface must be kept clean and dry.
- To ensure stable wireless communication, please avoid installing on metal surfaces.

## Preparation for Use

1. Download MOES App on App store or scan the QR code



- MOES App is upgraded as much more compatibility than Tuya Smart/Smart Life App, functional well for scene controlled by Siri, widget and scene recommendations as the fully new customized service.
- **(Note;** Tuya Smart/Smart Life App still works, but MOES App is highly recommended)

## 2. Registration or Log in

1. Download "MOES" Application.
2. Enter the Register/Login interface, tap "Register to create an account by entering your phone number to get verification code and "Set password. Choose "Log in" if you already have a MOES account.

## Add device

1. Slide the rear cover towards the direction of the arrow, remove the rear cover, then remove the insulation sheet and finally reinstall the rear cover.

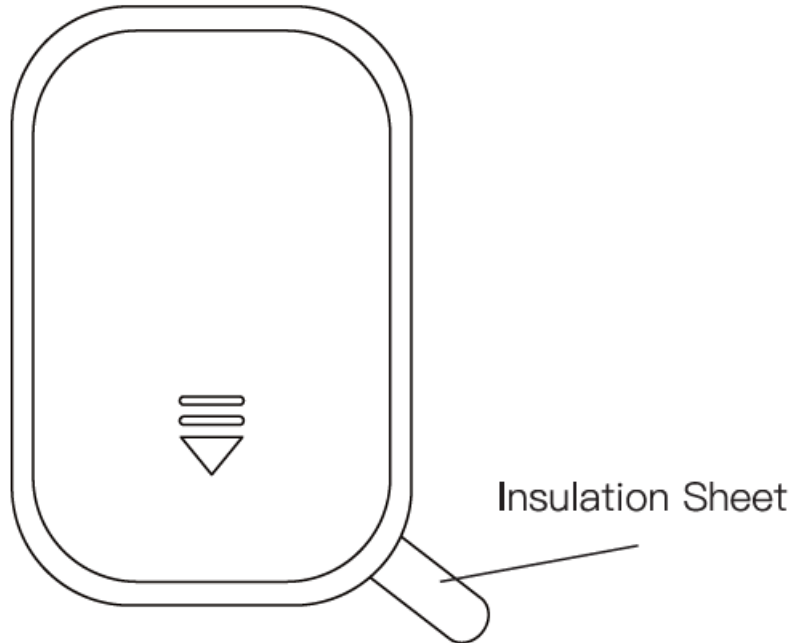

1. Remove insulation sheet to power on the sensor.
2. Open the MOES APP, make sure the ZigBee gateway/multi mode gateway is connected to the APP, enter the gateway and click "Add New Device".

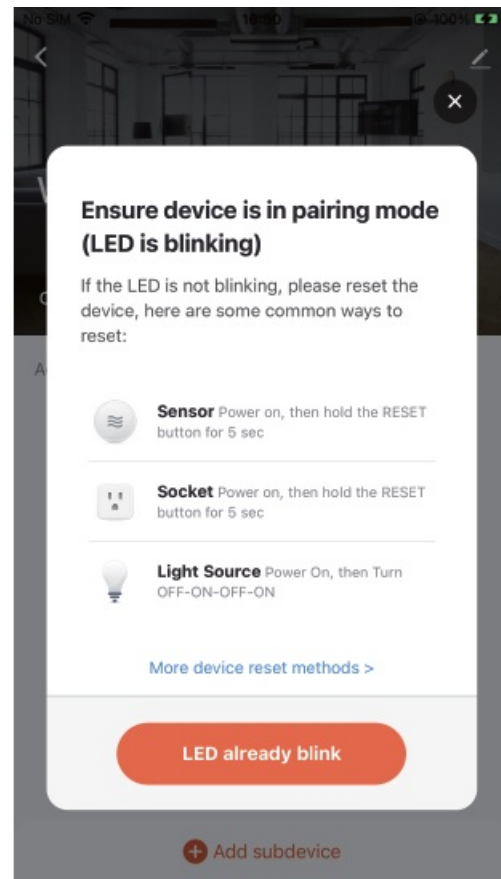
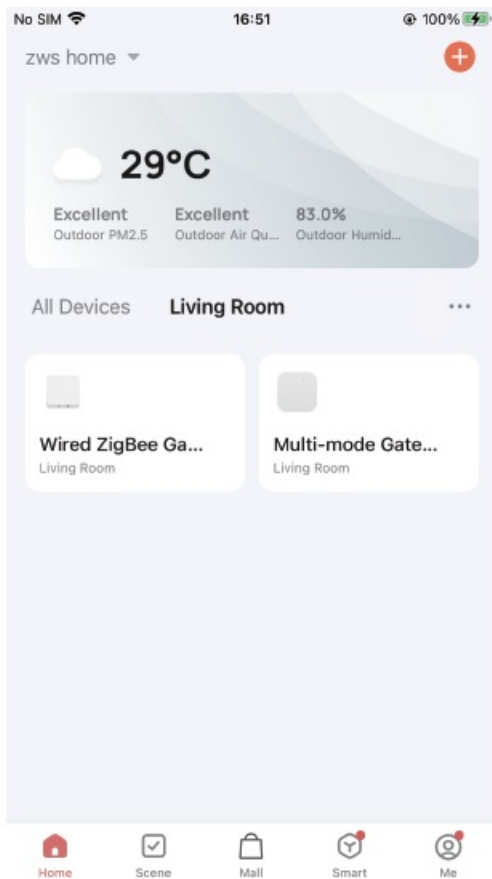

### 3. Enter configuration mode

1. press and hold the “button” for more than 6 seconds until the white indicator light flashes quickly, and the temperature and humidity sensor enters pairing mode. (Note: When configuring the network, keep the device as close to the gateway as possible.)
2. If the network configuration fails, repeat the above operation, please press and hold the device button again until the white light flashes quickly.

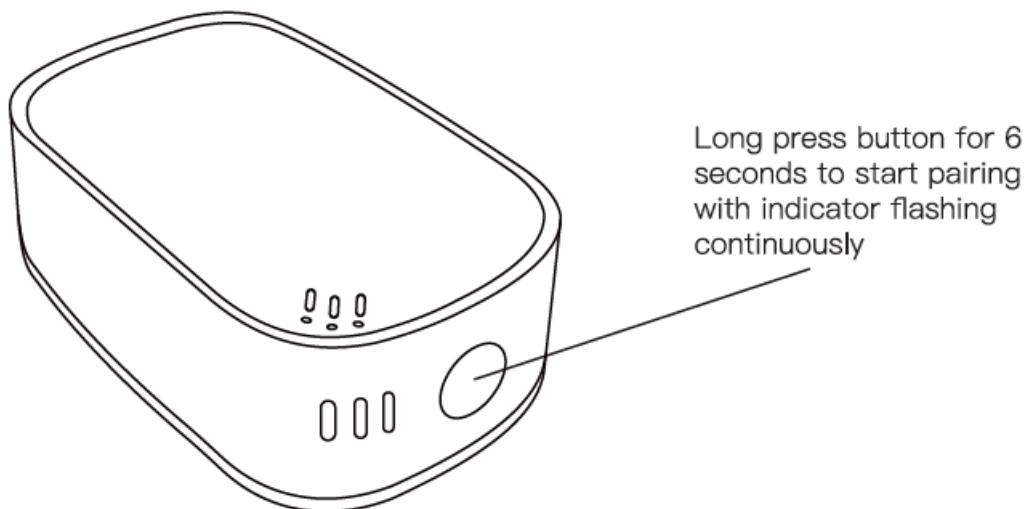

4. Wait for 10-120 seconds. After adding the device successfully, you can edit the device name.

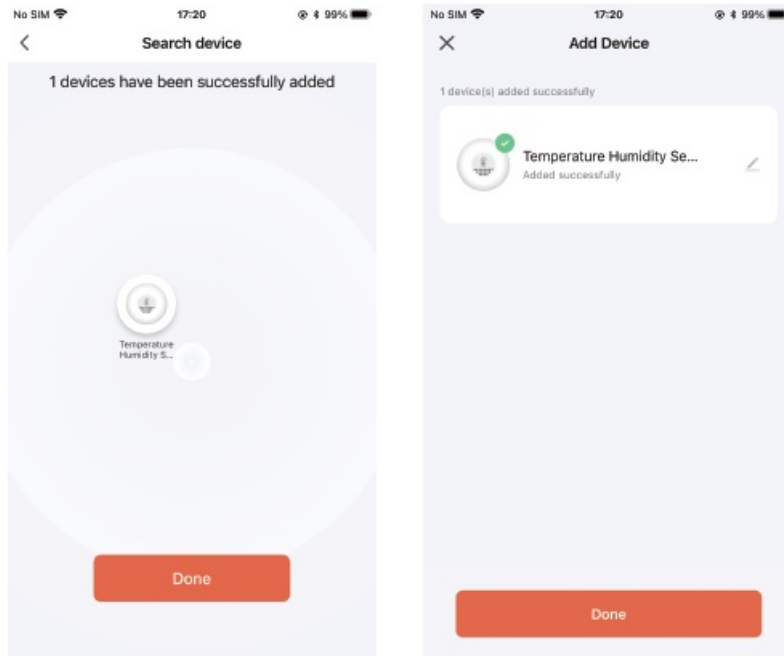

5. Now you can set "smart scene linkage" according to your needs and enjoy your smart home life.

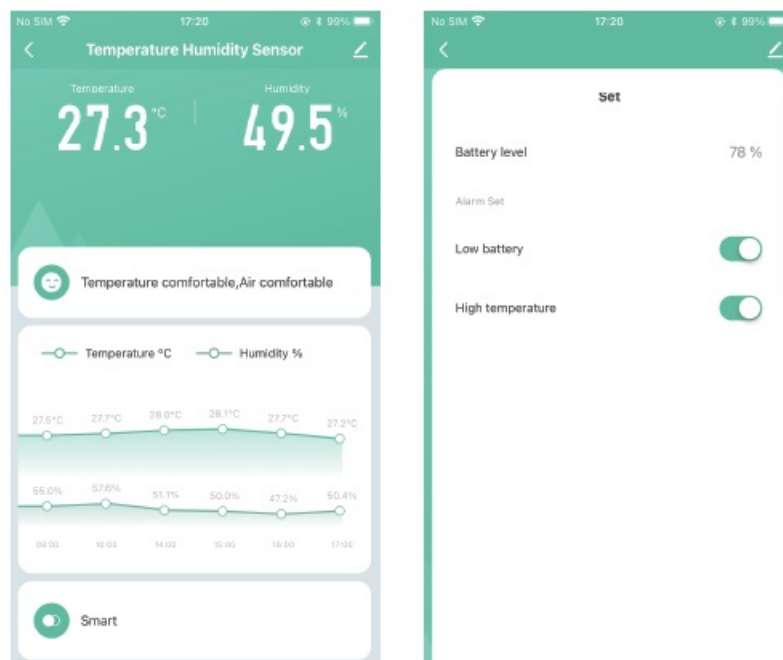

#### Restriction of elements or element identification tables

	Toxic and hazardous substances or elements					
Part Name	Lead (Pb)	Mercury (Hg)	Chromium (Cd)	Hexavalent motto (Cr(VI))	Doa diphenyl (PBB)	Dioxydiphenylether phenyl ether (PBDE)
LED	○	○	○	○	○	○
Circuit Board	X	○	○	○	○	○
Housings and other components	X	○	○	○	○	○

This form has been prepared in accordance with the provisions of SJ/T 11364.

- O :Indicates that the content of the toxic and hazardous substances in all homogeneous materials of the component is below the limits specified in the GB/T26572 standard limit requirements below.
- X :Indicates that the content of the toxic and hazardous substance in at least one homogeneous material of the component exceeds the limit requirements specified in GB/T26572 standard.

## SERVICE

- Thank you for your trust and support to our products, we will provide you with a two-year worry-free after-sales service (freight is not included), please do not alter this warranty service card, to safeguard your legitimate rights and interests. If you need service or have any questions, please consult the distributor or contact us.
- Product quality problems occur within 24 months from the date of receipt, please prepare the product and the packaging, applying for after-sales maintenance in the site or store where you purchase; If the product is damaged due to personal reasons, a certain amount of maintenance fee shall be charged for repair.

### We have the right to refuse to provide warranty service if;

1. Products with damaged appearance, missing LOGO or beyond the service term
2. Products that are disassembled, injured, privately repaired, modified or have missing parts
3. The circuit is burned or the data cable or power interface is damaged
4. Products damaged by foreign matter intrusion (including but not limited to various forms of fluid, sand, dust, soot, etc.)

## RECYCLING INFORMATION

All products marked with the symbol for separate collection of waste electrical and electronic equipment (WEEE Directive 2012/ 19 / EU) must be disposed of separately from unsorted municipal waste. To protect your health and the environment, this equipment points for electrical and electronic equipment must designated be by disposed the of at government designated or local collection authorities. )t Correct disposal and recycling will help prevent potential negative consequences for the environment and human health. To find out where – these collection points are and how they work, contact the installer or your local authority.



## WARRANTY CARD

### Product Information

- Product Name, \_\_\_\_\_
- Product Type \_\_\_\_\_
- Purchase Date \_\_\_\_\_
- Warranty Period, \_\_\_\_\_
- Dealer Information \_\_\_\_\_
- Customer's Name, \_\_\_\_\_
- Customer Phone \_\_\_\_\_



- Customer Address \_\_\_\_\_ \_

## Maintenance Records

Failure date	Cause Of Issue	Fault Content	Principal

- Thank you for your support and purchase at we Moes, we are always here for your complete satisfaction, just feel free to share your great shopping experience with us.
- If you have any other need, please do not hesitate to contact us first, -we will try to meet your demand.

## FOLLOW US



@moes\_smart



MOES.Official



@moes\_smart



www.moes.net



@moessmart



@moes\_smart

[www.moes.net](http://www.moes.net)



**AMZLAB GmbH**

auberihof23,45326Essen



**EVATOST CONSULTING LTD**

- **Address:** Suite 11, First Floor, Moy Road Business Centre, Taffs Well, Cardiff, Wales, CF15 7QR
- **Tel: +442921680945**
- **Email:** [contact@evatmaster.com](mailto:contact@evatmaster.com)



**WENZHOU NOVA NEW ENERGY CO.,LTD**

- **Address:** Power Science and Technology Innovation Center,
- NO.238, Wei 11 Road, Yueging Economic Development Zone, Yueging, Zhejiang, China
- **Tel: +86-577-57186815**
- **Email:** [service@moeshouse.com](mailto:service@moeshouse.com)
- **Made In China**

---

## Documents / Resources

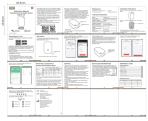

[Moes ZSS-S01-TH Temperature Humidity Sensor](#) [pdf] Instruction Manual  
ZSS-S01-TH Temperature Humidity Sensor, ZSS-S01-TH, Temperature Humidity Sensor, Humidity Sensor, Sensor

## References

- [User Manual](#)