



## Moes zigbee Smart Button User Manual

[Home](#) » [MOES](#) » Moes zigbee Smart Button User Manual 



Smart Button

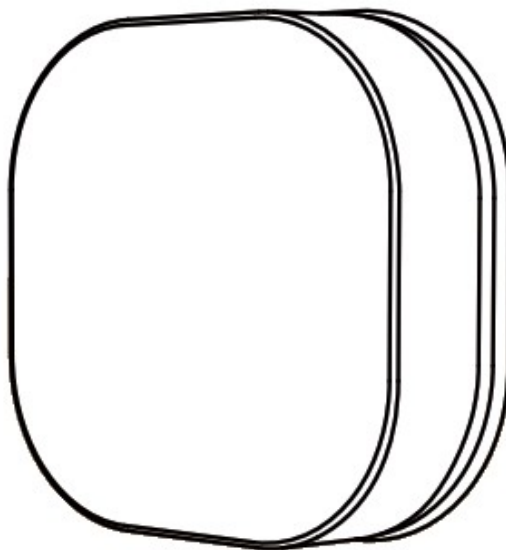

**zigbee**

## Contents

- [1 Dimention](#)
- [2 Specification](#)
- [3 Install the Battery](#)
- [4 Connect to Network](#)
- [5 Reset/Pairing](#)
- [6 SERVICE](#)
- [7 RECYCLING INFORMATION](#)
- [8 WARRANTY CARD](#)
- [9 Documents / Resources](#)
- [10 Related Posts](#)

## Dimention

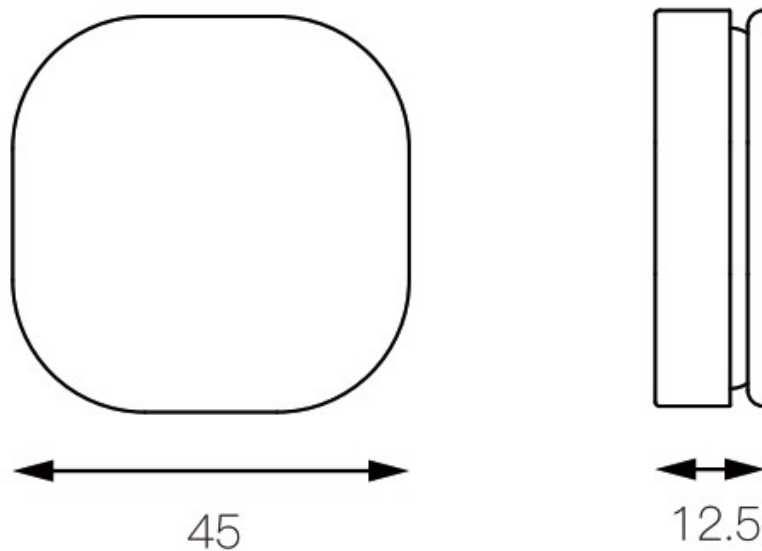

## Specification

Power supply:	Battery CR2032 3V DC
Communication:	Zigbee 3.0
Control distance:	25M open area
Ingress Protection:	1: IP55
Dimensions:	45 X 45 X 12.5mm
Operating temperature:	—10 °C~45 °C
Working Humidity:	<90%RH
Life of battery:	1 years (General use)

## Install the Battery

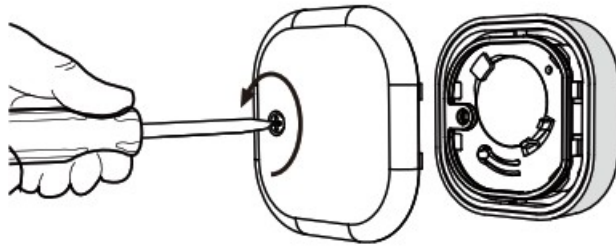

1. Remove the screw

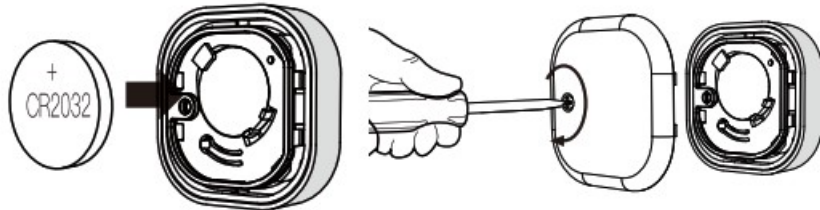

2. Install the CR2032 battery

3. Install the cover

## Connect to Network

Scan the QR code to download APP



<https://smartapp.tuya.com/smartlife>

**Note:** Required Gateway for network pairing

## Reset/Pairing

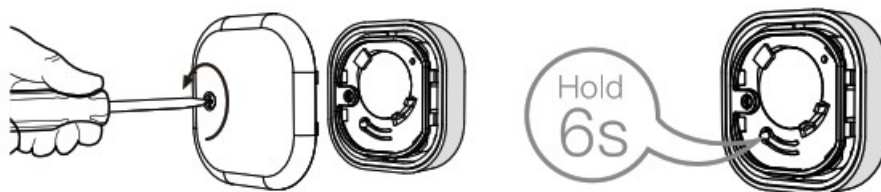

1. Remove the screw

2. Hold“RESET”to 6s

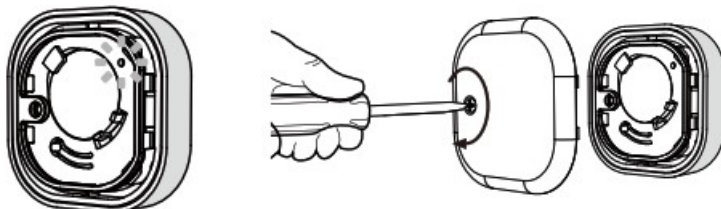

3. LED will start flashing

4. Install the cover

## 5.1 Add Device

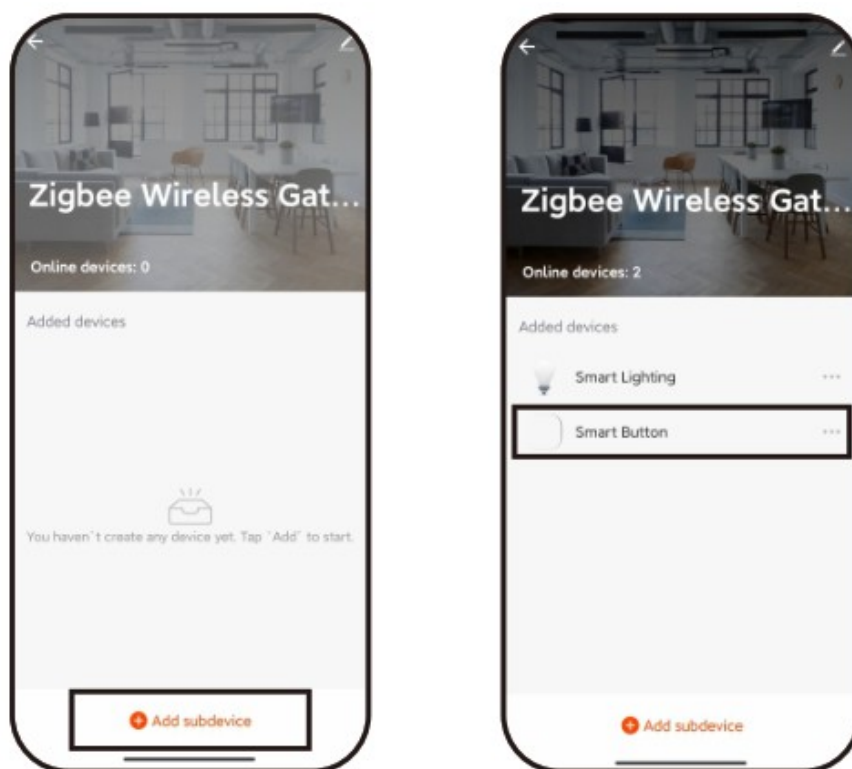

## 5.2 Remote mode

**Note:** Default operate mode

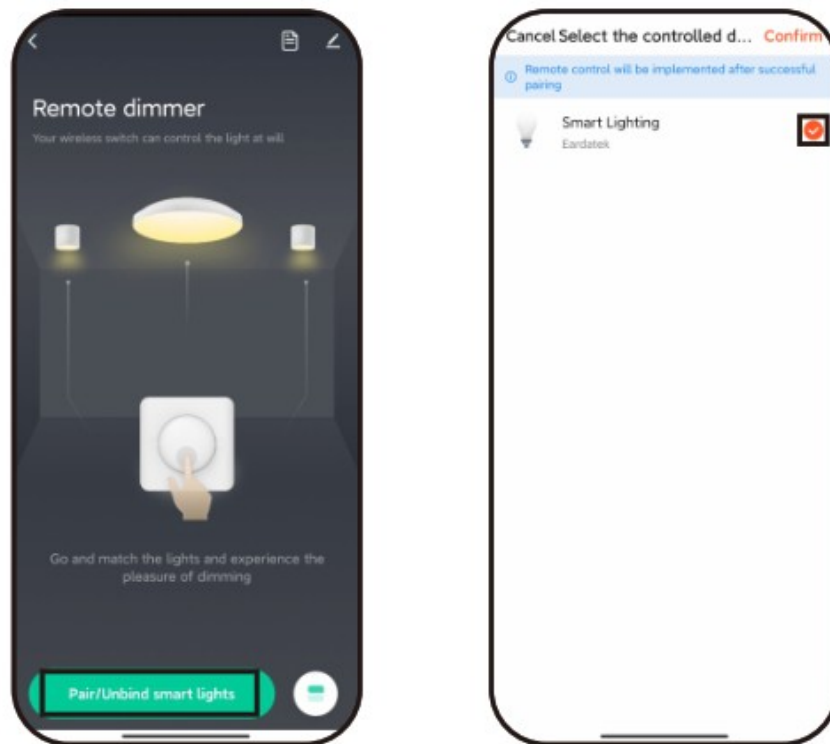

### 5.3 Remote mode





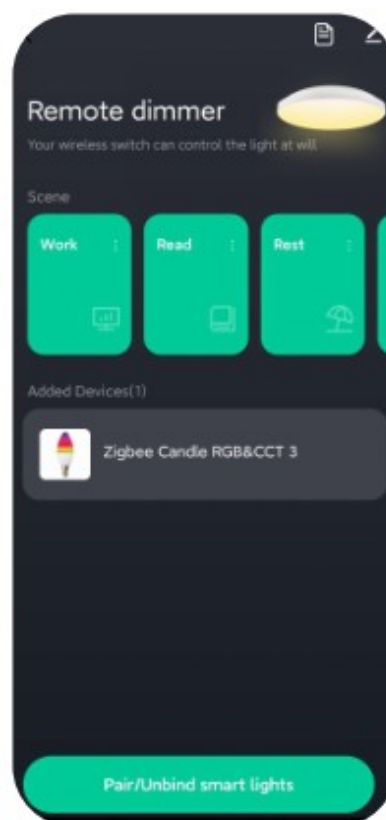

First time to add smart light MUST press the button to activate memory



### 5.4 Remote mode

B. Control description under remote mode

	Single Press On		Single Press Change preset light mode when light up
	Dual Press Off		Long Press >3s Dimming

**Note:** The operates may different depending on the smart lights

**5.5 Mode swap**

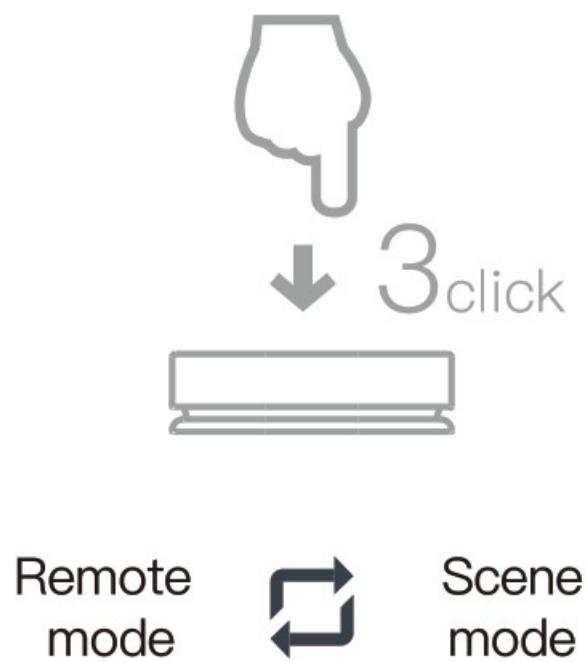

**5.6 Scene mode**

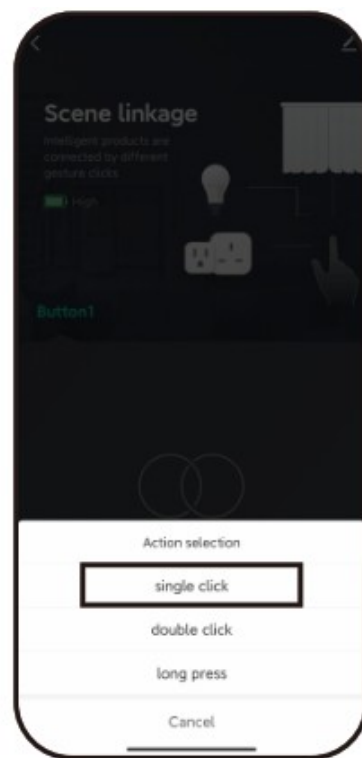
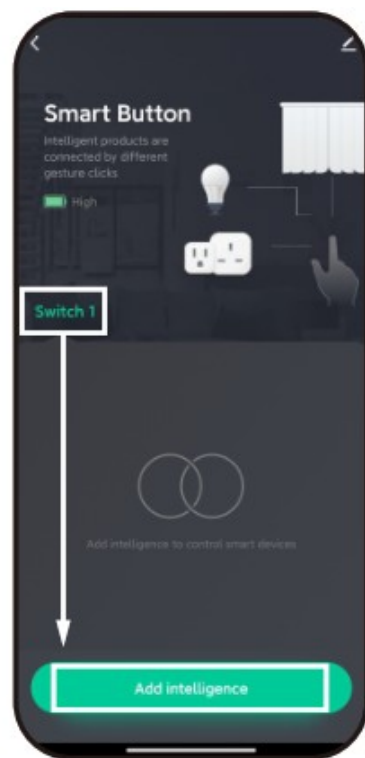

## 5.7 Scene mode

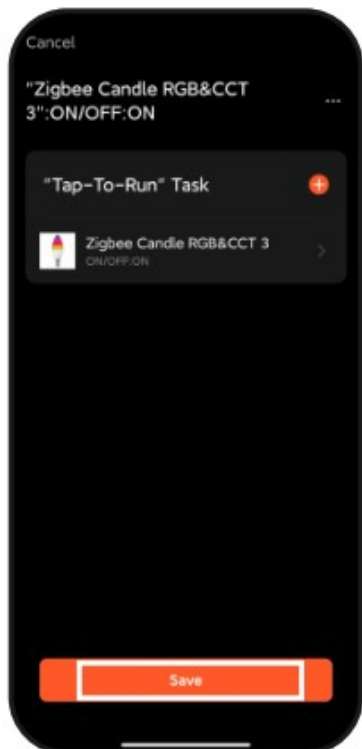

## 5.8 Scene mode

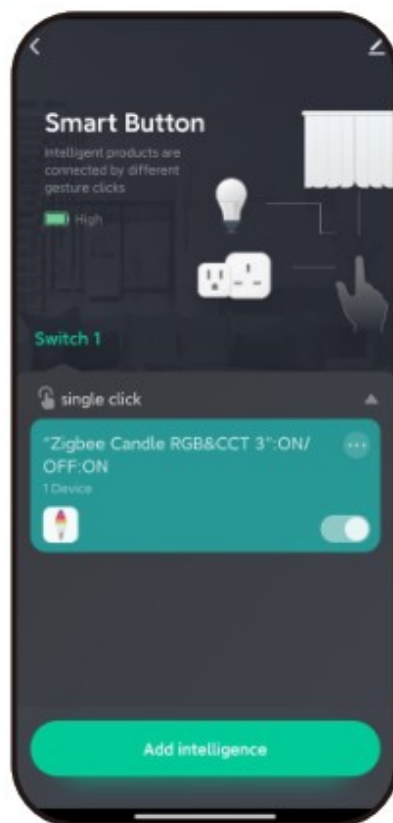

## SERVICE

1. During the free warranty period, if the product breaks down during normal use, we will offer free maintenance for the product.
2. Natural disasters/man-made equipment failures, disassembly and repair without the permission of our company, no warranty card, products beyond the free warranty period, etc., are not within the scope of free warranty
3. Any commitment (oral or written) made by the third party (including the dealer/service provider) to the user beyond the warranty scope shall be executed by the third party
4. Please keep this warranty card to ensure your rights
5. Our company may update or change the products without notice. Please refer to the official website for the updates.

## RECYCLING INFORMATION



All products marked with the symbol for separate collection of waste electrical and electronic equipment (WEEE Directive 2012/19 / EU) must be disposed of separately from unsorted municipal waste. To protect your health and the environment, this equipment must be disposed of at designated collection points for electrical and electronic equipment designated by the government or local authorities.

Correct disposal and recycling will help prevent potential negative consequences for the environment and human health. To find out where these collection points are and how they work, contact the installer or your local authority.

## WARRANTY CARD

### Product Information

Product Name \_\_\_\_\_

Product Type \_\_\_\_\_



Purchase Date \_\_\_\_\_  
 Warranty Period \_\_\_\_\_  
 Dealer Information \_\_\_\_\_  
 Customer's Name \_\_\_\_\_  
 Customer Phone \_\_\_\_\_  
 Customer Address \_\_\_\_\_

### Maintenance Records





Failure date	Cause Of Issue	Fault Content	Principal

Thank you for your support and purchase at we Moes, we are always here for your complete satisfaction, just feel free to share your great shopping experience with us.



If you have any other need, please do not hesitate to contact us first, we will try to meet your demand.

### FOLLOW US

	@moessmart		MOES. Official
	@moes_smart cd		@moes_smart
	@moes_smart		<a href="http://www.moeshouse.com">www.moeshouse.com</a>



### WENZHOU NOVA NEW ENERGY CO.,LTD

Address: Power Science and Technology  
 Innovation Center, NO.238, Wei 11 Road,  
 Yueqing Economic Development Zone,  
 Yueqing, Zhejiang, China  
 Tel:+86—577-571 86815  
 Email:[service@moeshouse.com](mailto:service@moeshouse.com)



### AMZLAB GmbH

Laubenhof 23, 45326 Essen

Made In China

**Note:** UI interface or functions may change according to firmware version or application scenarios, the actual APP interface shall prevail.

BB14

Documents / Resources

	<p><a href="#">Moes zigbee Smart Button</a> [pdf] User Manual</p> <p>ZT-SY-SR-MS, BB14-220309 C, zigbee Smart Button, zigbee Button, zigbee, Smart Button, Button</p>
---	---

[Manuals+](#).