

MOes

**WM-104B-M Mini  
Smart Switch Module**



# MOes WM-104B-M Mini Smart Switch Module Instruction Manual

[Home](#) » [MOES](#) » MOes WM-104B-M Mini Smart Switch Module Instruction Manual 

## Contents

- 1 MOes WM-104B-M Mini Smart Switch Module
- 2 Product Usage Instructions
- 3 Introduction
- 4 TECHNICAL SPECIFICATIONS
- 5 WIRING DIAGRAM
- 6 FAQ
- 7 Download the MOES APP
- 8 Smart Device Linked Voice Speaker
- 9 SERVICE
- 10 CONTACT
- 11 Documents / Resources
  - 11.1 References

MOes

**MOes WM-104B-M Mini Smart Switch Module**



## Product Usage Instructions

1. For the switch module: Press the reset button on the module for a long time until the beep sounds continuously and quickly for pairing and reset mode.
2. For the rocker light switch: press the switch button 20 times (ON/OFF cycle for 10 times) until the beep sounds continuously and rapidly for pairing and reset mode.
3. Add another smart switch to the same MOES App.
4. If your switch requires a neutral wire, only L and N are required for wiring. If it doesn't require a neutral wire, follow the wiring instructions.
5. You can control lights simultaneously with multiple switches in the MOES App.
6. Launch the Google Home App and ensure the Google Home speaker is installed.
7. Open the Google Home app, click on the plus sign, then click on Set up device.
8. Search for MOES, enable MOES smart skills, log in to your account, and wait for devices to be discovered.
9. Your MOES application is now paired with Google Home, and you can control smart devices.

Please scan the QR code to view the German manual, get the installation video and function introduction



## Introduction

- Global international operation Whenever & Wherever You are an all-in-one Mobile App

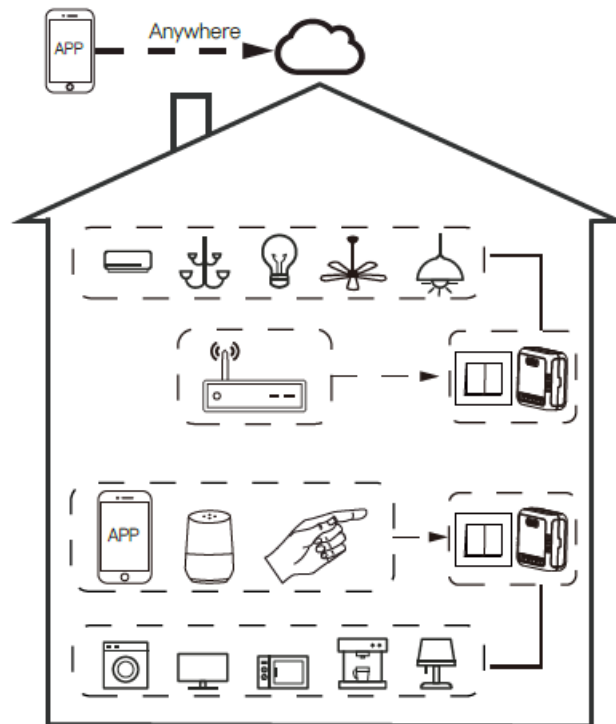
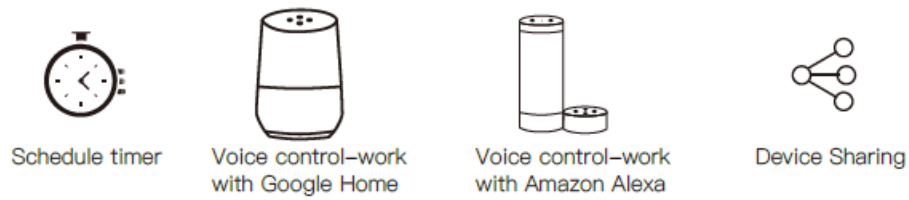

- In house local operation

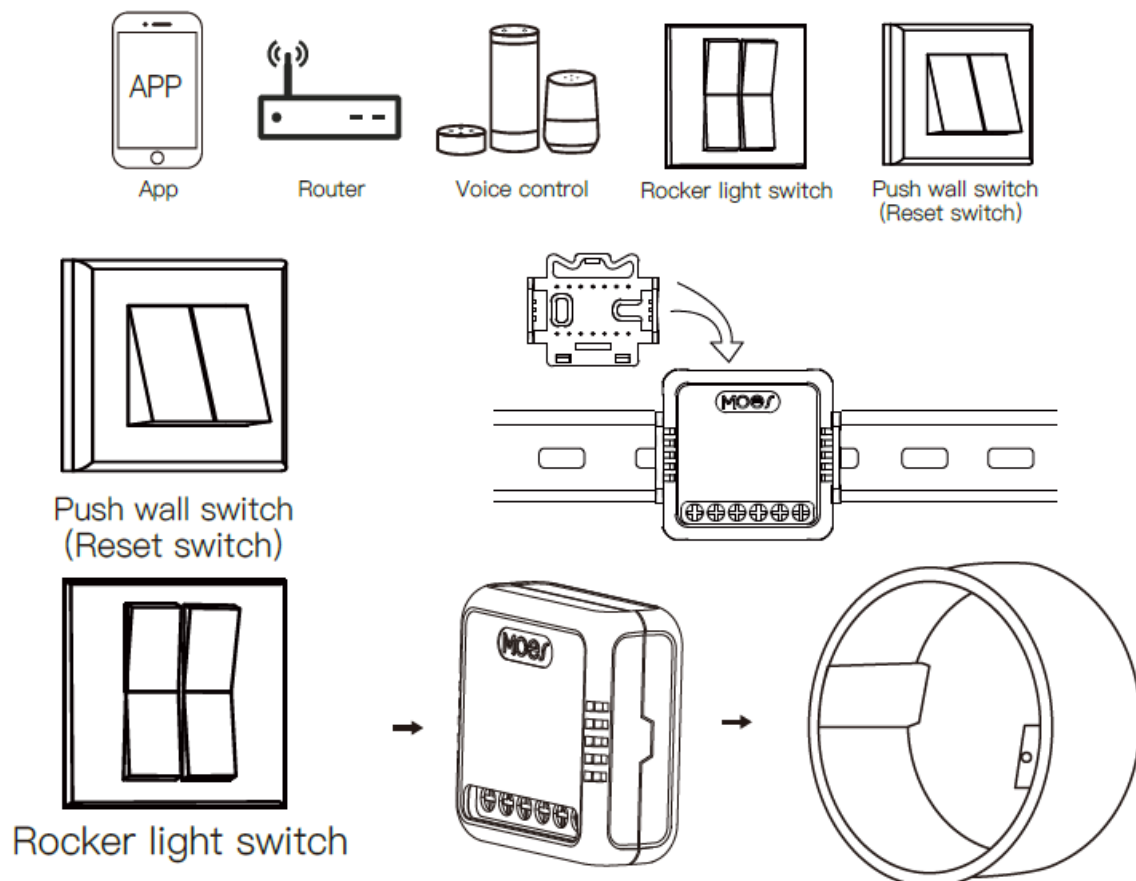

## Step 1

- Turn off the circuit breaker and use the electrical tester to test the power.
- Ensure the circuit breaker is off before wiring.



## Attention

Please disconnect the power supply before installing or removing the device to avoid irreversible damage to the device from the electric current or some unpredictable problems such as lamp flashing.

## Step 2

- Remove the old switch

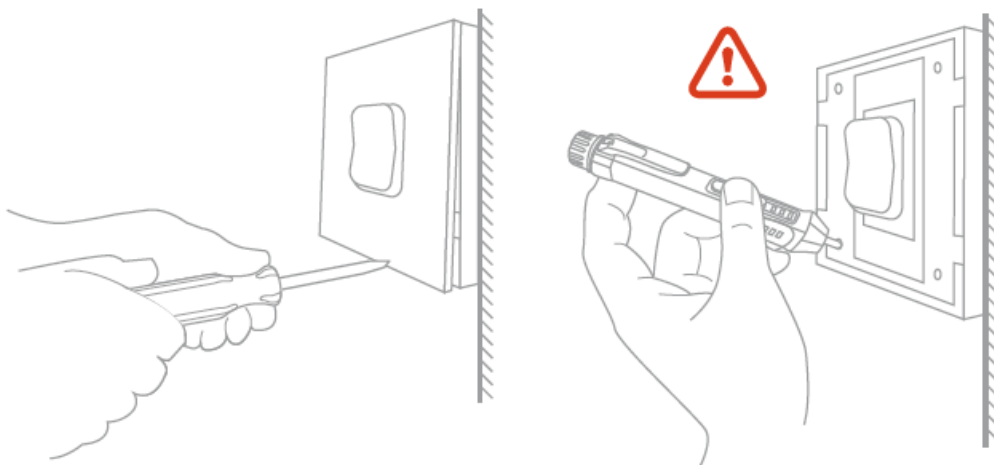

## Step 3

- Remove the switch and pull it away from the wall.
- Identify Line/Load Wire (Note: The color of your wire may be different from the color shown in the manual.)

## Verify power is off

- We recommend you remove the faceplate from the old switch and use an electrical tester to test all wires connected to the switch to ensure there is no voltage in the circuit.
- You may need to turn off more than one circuit breaker.

## Warnings

1. Installation must be carried out by a qualified electrician under local regulations.

2. Keep the device out of the reach of children.
3. Keep the device away from water, damp, or hot environments.
4. Install the device away from strong signal sources such as microwave ovens that may cause signal interruption resulting in abnormal operation of the device.
5. Obstruction by concrete walls or metallic materials may reduce the effective operation range of the device and should be avoided.
6. Do NOT attempt to disassemble, repair, or modify the device.

### 1Gang Smart Switch Module

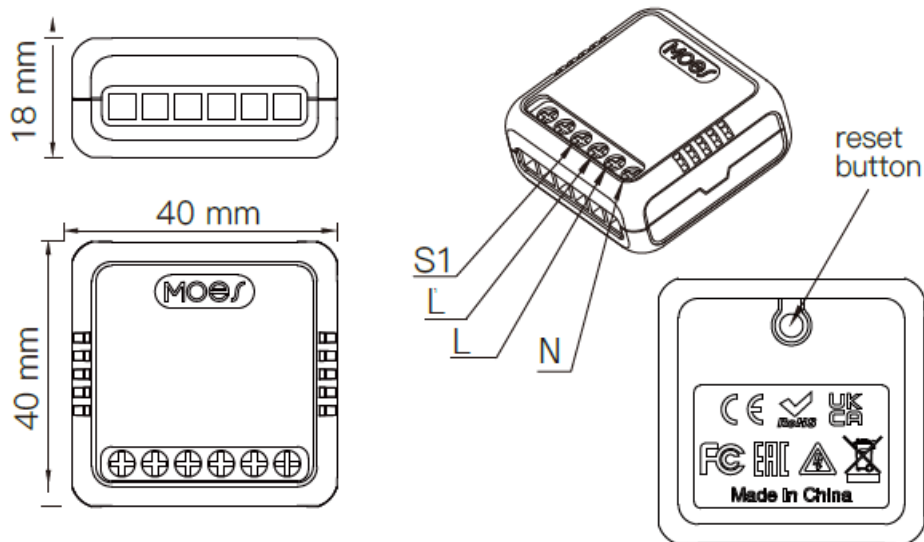

### TECHNICAL SPECIFICATIONS

- Model: WM-104-M
- Product Type: Smart Switch Module
- Voltage: 90-250V AC 50/60Hz
- Current: 10A/Gang; Total 10A
- Wireless Protocol: Wi-Fi BLE
- Operation Temp: -10°C ~ 65°C
- Case Temp: Tc: +80°C (Max.)
- Operation Range: ≤70 m
- Dims (WxDxH): 40x40x18 mm
- IP Rating: IP20

### WIRING DIAGRAM

#### 1Gang Smart Switch Module

1. With one 1 Gang switch

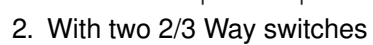

## Wiring Instructions and Diagrams

1. Turn off the power supply before carrying out any electrical installation work.
2. Connect wires according to the wiring diagram.
3. Insert the module into the junction box.
4. Connect the power supply and follow switch module configuration instructions.

**Notes:** Put your smartphone close to the switch module when you're configuring, and make sure you have min. 50% Wi-Fi signal.

## FAQ

Q1: What should I do if I can't configure the switch module?

a. Please check whether the device is powered on. b. Make sure your mobile and switch module are under the same 2.4 GHz WiFi network. c. Whether it's in good internet conditions. d. Make sure the password entered in the App is correct. e. Make sure the wiring is correct.

Q2: What device can be connected to this WiFi switch module?

Most of your household electrical appliances can be such as lamps laundry machines coffee makers etc.

Q3: What happens if the WiFi goes off?

You can still control the device connected to the switch module with your traditional switch and once WiFi is active again the device connected to the module will connect automatically to your WiFi network.

Q4: What should I do if I change the WiFi network or change the password?

You have to re-connect our WiFi switch module to the new WiFi network according to the App User Manual.

## Download the MOES APP

Download the MOES App on the App Store or scan the QR code



MOES App is upgraded as much more compatibility than the Tuya Smart/Smart Life App, functional well for scenes controlled by Siri, widgets, and scene recommendations as the fully new customized service.  
(Note: Tuya Smart/Smart Life App still works, but the MOES App is highly recommended)

### Registration or Log-in

- Download “MOES” Application.
- Enter the Register/Login interface; tap “Register” to create an account by entering your phone number to get a verification code and “Set password”. Choose “Log in” if you already have a MOES account.



- Wi-Fi link method:(two pairing methods)

### Method One

Scan the QR code to configure the network guide.

1. Make sure your MOES APP has successfully connected to Wi-Fi





### Method two

Pair and clear up the WiFi code with Bluetooth and WiFi connected meantime.

1. Make sure your phone is connected to Wi-Fi and Bluetooth.

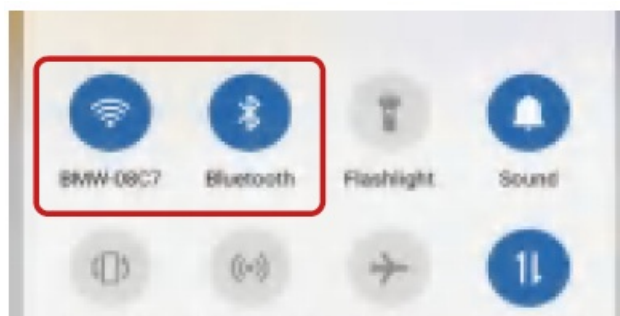

2. Open MOES/Tuya App and Click "+", then the prompt page will automatically show on the screen. Click "add".

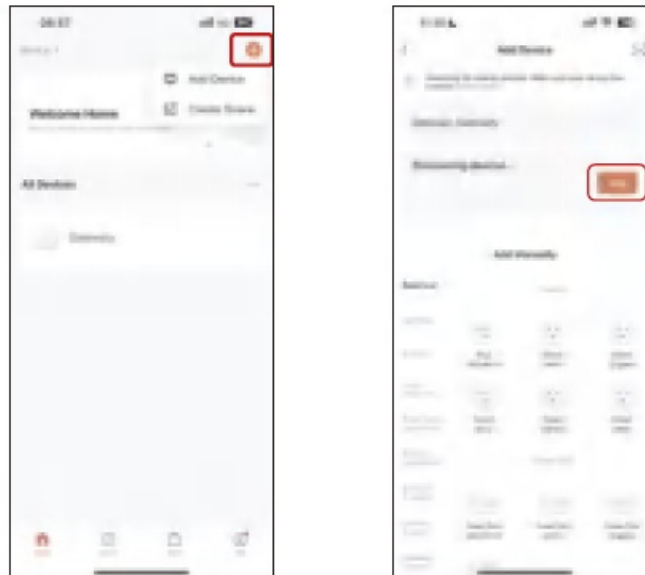

3. Enter your Wi-Fi Password and click “Next”, waiting to complete the connection.

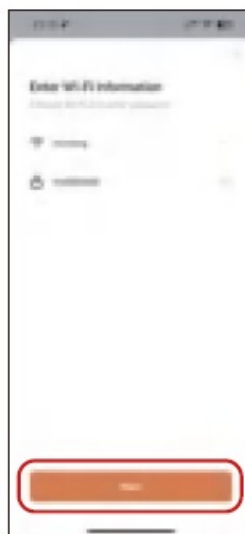

4. Select the device you want to add and click “+”. Add the device successfully, you can edit the name of the device to enter the device page by clicking “Done”

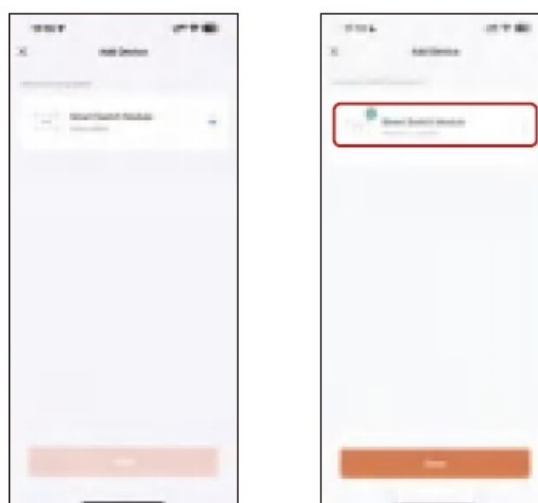

5. Click“Done”to enter the device page to enjoy your smart life with home automation.

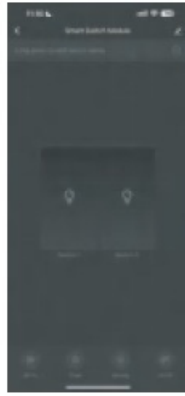

## How to reset /pair Wi-Fi code

### For switch module:

- Press the reset button on the module for a long time until the beep sounds continuously and quickly for pairing and reset mode.

### For the rocker light switch:

- press the switch button for 20 times (ON/OFF cycle 10 times) until the beep sounds continuously and rapidly as Di-Di-Di... for pairing and reset mode.

### For reset switch:

- press the switch button 10 times until the beep sounds continuously and rapidly as Di-Di-Di... for pairing and reset mode.

## How to achieve multicontrol association (only for N+L wire)

**Note:** Please confirm you have successfully finished the link method above for adding this switch to your MOES App before the association.

1. Add another smart switch to the same MOES App. (If there is a smart switch having been added before to the app, just go to the next step.)

**Note:** If your switch requires a neutral wire, then there is no need to wire the newly added switch to the light, only L and N are required for wiring. Then you can control 1 light with multiple switches in the MOES App.

If your switch doesn't require a neutral wire, you need to follow the wiring instructions to connect the L and light. At this point, you can control the lights simultaneously with multiple switches.

2. Then you will see two devices in the app and click the main switch (as one gang switch as below) by entering into the next operation.

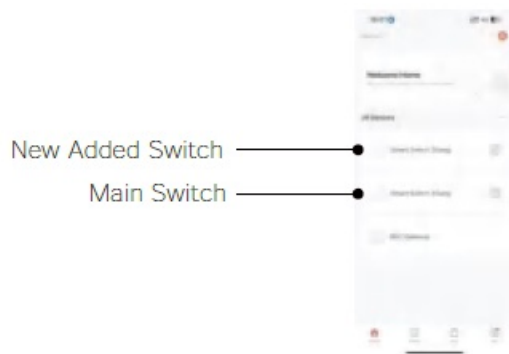

3. Click  in the upper right corner and choose “Multi-Control Association, and then click “+” in the right corner.

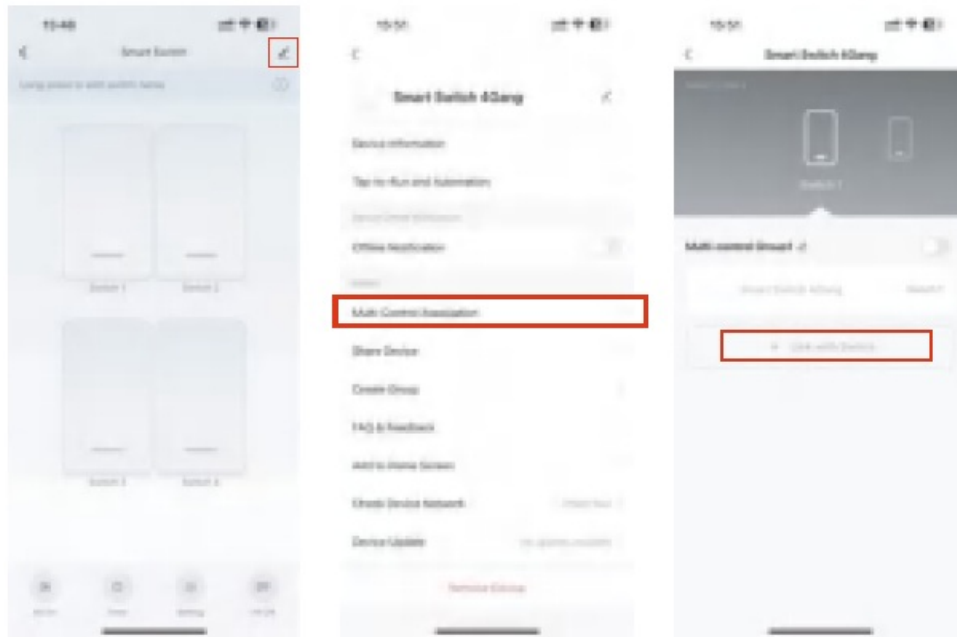

4. Choose the switch that you want to associate with and then choose the switch button that you want to control the same light. Then go back to the previous page, and you will see two items in on the page, one is your main switch, and the other is the one you associate just now.

**Note:** Please confirm the associated switch is enabled.

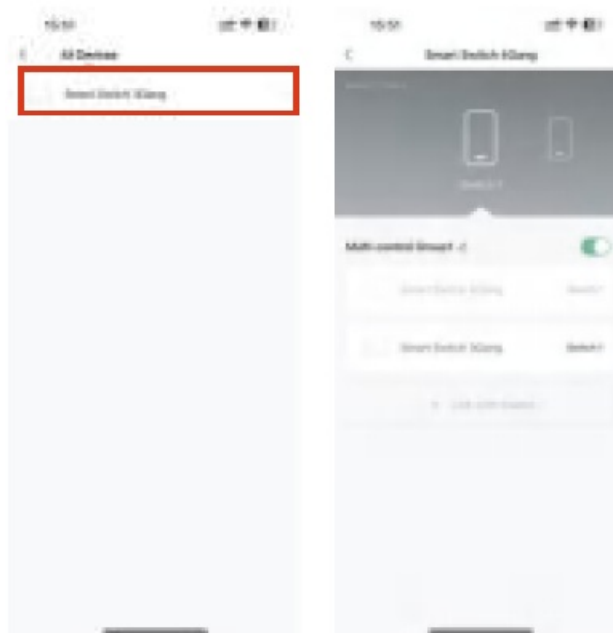

5. Now you can control your light with two switches. Do not associate another button in the same switch for multi-control.
6. If you want to add another third or more smart switches to control your light, just repeat the steps above. And

you will see the result as below when you associate another new switch.

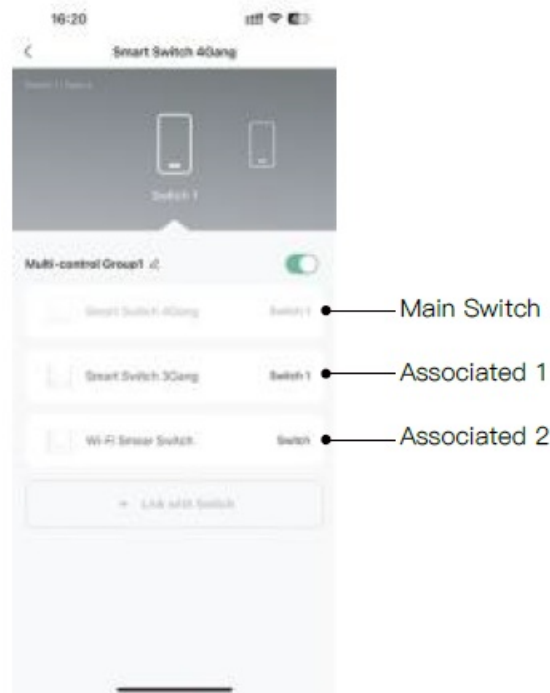



## Smart Device Linked Voice Speaker

### Complete product networking configuration in the App

- Complete the device's networking configuration according to the prompts in the App. Note: In the App, change the name of the device to an easily identifiable name such as Alexa; names are usually in English, such as “bed light”.

### How to connect Smart Device to Amazon Alexa

1. Launch the MOES App, sign into your account, and make sure Smart Device is on the device list.
2. Minimize MOES App, then launch the Alexa App sign in to your Alexa account, and make sure you have at least one Alexa smart speaker-controlled device installed like Echo Dot, etc.
3. In the Bottom right corner of the Home page, press  the button to show the APP Menu. Then select  in the menu.
4. Click on the search button in the upper right corner, enter “ MOES ” in the search box, and then search.

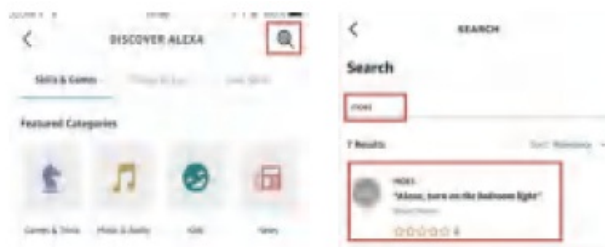

5. Enable MOES Smart Skill then sign in to your Moes account to complete your account setup.

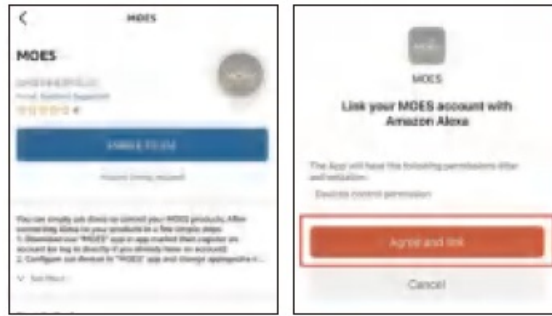

6. After successfully logging into your account, you need to give Alexa 20 seconds to search for devices.

Once the device is successfully discovered, your MOES application is now paired with Alexa. Clicking “” will display all available devices in your APP, and now you can control smart devices through Alexa.

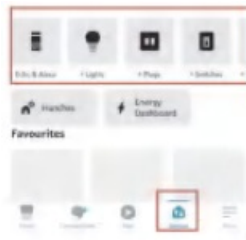

## How to connect Smart Device to Google Home

1. Launch the Google Home App and make sure the Google Home speaker is installed. If not, please follow Google Home speaker installation instructions to complete the installation.
2. Open the Google Home app and click on the plus sign in the top left corner to enter the “add and manage” page, then click on “Set up device”.

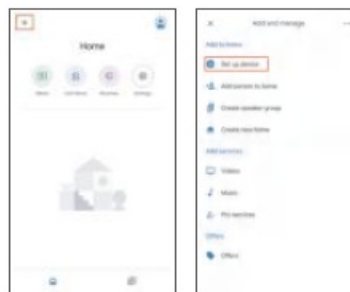

3. Enter “MOES” in the search box and then search for it. Enable MOES smart skills, and then log in to your Moes account to complete the account setup.

After successfully logging into your account, you need to wait 20 seconds to search for devices. Once the device is successfully discovered, it means that your MOES application has been paired with Google Home, and all available smart devices are displayed on the homepage upon returning. Now you can use Google Home to control your smart devices.

## SERVICE

Thank you for your trust and support of our products, we will provide you with a two-year worry-free after-sales service (freight is not included), please do not alter this warranty service card, to safeguard your legitimate rights and interests. If you need service or have any questions, please consult the distributor or contact us. Product quality problems occur within 24 months from the date of receipt, please prepare the product and the packaging, applying for after-sales maintenance in the site or store where you purchase; If the product is damaged due to personal reasons, a certain amount of maintenance fee shall be charged for repair. We have the right to refuse to provide warranty service if:

1. Products with damaged appearance, missing LOGO or beyond the service term
2. Products that are disassembled, injured, privately repaired, modified or have missing parts
3. The circuit is burned or the data cable or power interface is damaged
4. Products damaged by foreign matter intrusion (including but not limited to various forms of fluid, sand, dust, soot, etc.)

## RECYCLING INFORMATION

- All products marked with the symbol for separate collection of waste electrical and electronic equipment (WEEE Directive 2012/19 / EU) must be disposed of separately from unsorted municipal waste.
- To protect your health and the environment, this equipment must be disposed of at designated collection points for electrical and electronic equipment designated by the government or local authorities.
- Correct disposal and recycling will help prevent potential negative consequences for the environment and human health. To find out where these collection points are and how they work, contact the installer or your local authority.



## WARRANTY CARD

### Product Information

Product Name\_\_\_\_\_

Product Type\_\_\_\_\_

Purchase Date\_\_\_\_\_

Warranty Period\_\_\_\_\_

Dealer Information\_\_\_\_\_

Customer's Name\_\_\_\_\_

Customer Phone\_\_\_\_\_

Customer Address\_\_\_\_\_

### Maintenance Records







Failure date	Cause Of Issue	Fault Content	Principal

- Thank you for your support and purchase at We Moes, we are always here for your complete satisfaction, just feel free to share your great shopping experience with us.



- If you have any other needs, please do not hesitate to contact us first, and we will try to meet your demand.

## FOLOW US

-  @moessmart
-  @moes\_smart
-  @moes\_smart
-  [MOES.Official](https://www.youtube.com/MOES.Official)
-  @moes\_smart
-  [www.moes.net](http://www.moes.net)

## CONTACT

### EVATOST CONSULTING LTD

- Address: Suite 11, First Floor, Moy Road
- Business Centre, Taffs Well, Cardiff, Wales,
- CF15 7QR
- Tel: +44-292-1680945
- Email: [contact@evatmaster.com](mailto:contact@evatmaster.com)

### AMZLAB GmbH

- Laubenhof 23, 45326 Essen



- Made In China

## Manufacturer

- WENZHOU NOVA NEW ENERGY CO., LTD
- Address: Power Science and Technology
- Innovation Center, NO.238, Wei 11 Road,
- Yueqing Economic Development Zone,
- Yueqing, Zhejiang, China
- Tel: +86-577-57186815
- After-sale Service: [service@moeshouse.com](mailto:service@moeshouse.com)

## Documents / Resources

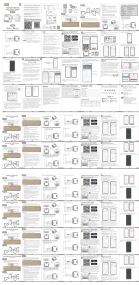
	<p><a href="#">MOes WM-104B-M Mini Smart Switch Module</a> [pdf] Instruction Manual WM-104-M, WM-104B-M, WM-104B-M Mini Smart Switch Module, WM-104B-M, Mini Smart Switch Module, Switch Module</p>
--	---

## References

-  [MOES Smart: Create Your Smart Life With Smart Home Devices](#)
- [User Manual](#)

[Manuals+](#), [Privacy Policy](#)

This website is an independent publication and is neither affiliated with nor endorsed by any of the trademark owners. The "Bluetooth®" word mark and logos are registered trademarks owned by Bluetooth SIG, Inc. The "Wi-Fi®" word mark and logos are registered trademarks owned by the Wi-Fi Alliance. Any use of these marks on this website does not imply any affiliation with or endorsement.