



Moes WM-103-MS-DD10 WiFi Smart Temperature Humidity Sensor Dual Relay Instruction Manual

[Home](#) » [MOES](#) » Moes WM-103-MS-DD10 WiFi Smart Temperature Humidity Sensor Dual Relay Instruction Manual 



Instruction Manual
Temperature and Humidity
Smart Switch Module
WiFi



WM-103-MS-DD10



<https://drive.google.com/drive/folders/1pIDmgqxp9iq-2SS1rfqppn94say2q-Tk?usp=sharing>

Thank you for purchasing your smart home product.

Ready to get started?

Download the MOES app to manage your smart home products straight from your phone or tablet.
Easily connect to your home Wi-Fi and control multiple devices with the touch of your fingertips.

Contents

- 1 Product description
- 2 Safety information
- 3 Specifications
- 4 Wiring diagram
- 5 How to Download moes App
- 6 Control function instructions
- 7 RECYCLING INFORMATION
- 8 Documents / Resources
 - 8.1 References

Product description

MS-103 is an easy-to-use, safe and reliable dual relay output temperature and humidity controller. It can be used as overtemperature protection and automatic temperature & humidity control system for various electric appliances such as equipment for home-brew, pet breeding, incubation, seedling heat mats, terrestrial heat control, constant temperature cycle of heating pump, culture fermentation, accelerating germination, electric radiator, electric oven, automatic watering, humidification and dehumidification as humidity control system.

Safety information

1. Do not disassemble, reassemble, modify or attempt to repair this product by yourself. This work should be performed by authorized professionals.
2. Product batteries should be recycled and must be recycled or disposed of separately from household waste. Dispose of batteries according to local environmental regulations.

Specifications

Model: MS-103
Input Voltage: 90-250V AC, 50/60Hz
Max. Current: 15A/Gang; Total 15A
Temperature Measurement Range: -40~80 °C / -40~176 ° F
Humidity Measurement Range: 0~99%
Wireless Protocol: Wi-Fi 2.4GHz 802.11 b/g/n
Type of Temperature and Humidity Probe: 3.3-5.5VDC
Temperature and Humidity Accuracy: $\pm 3\%H \pm 0.5^{\circ}C$
Probe Length: Max. 30 meters available
Frequency Band: 2.412~2.484GHz
Maximum Radio Transmit Power: $< +16dBm$

Package list

Smart Switch module *1
User Manual *1

Note:

Before installing Smart Life App, please check your home network setting as following:

1. Check your home routers or related: please use 2.4G Wi-Fi network.
Recommend set your 2.4G network and 5G network different names.
2. Your phone is connected with your home 2.4G Wi-Fi network.

3. To stay strong Wi-Fi connection, please keep smart device close to router.
4. Whether connected devices have reached the maximum number of router connections, If so, remove the device from the filter list and make sure that router is not prohibiting device from connection.
5. Please use English and numbers to name your Wi-Fi router. Otherwise the Smart Device may not recognize it when you try to add it into MOES.

Wiring diagram

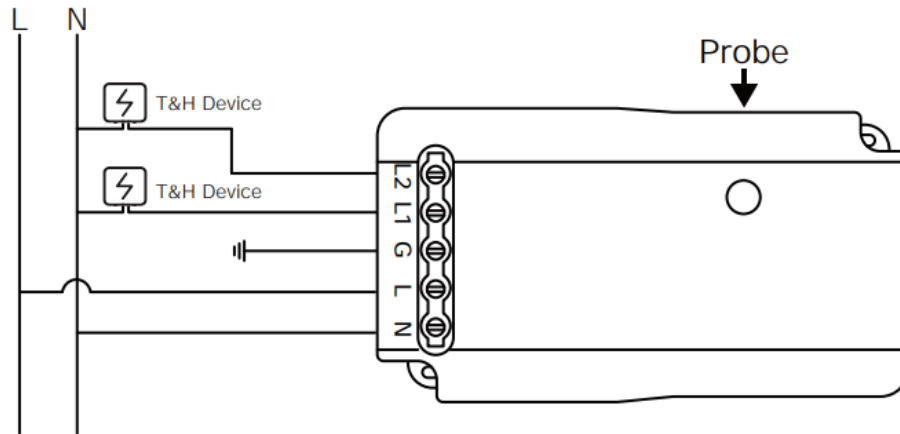

How to Download moes App

1. Download MOES App on App store or scan the QR code



<https://a.smart321.com/moeswz>

MOES APP is upgraded as much more compatibility than Tuya Smart/ Smart Life APP, functional well for scene controlled by Siri, widget and scene recommendations as the fully new customized service.

(Note: Tuya Smart/ Smart Life APP still works, but MOES APP is highly recommended)

2.Registration or Log in

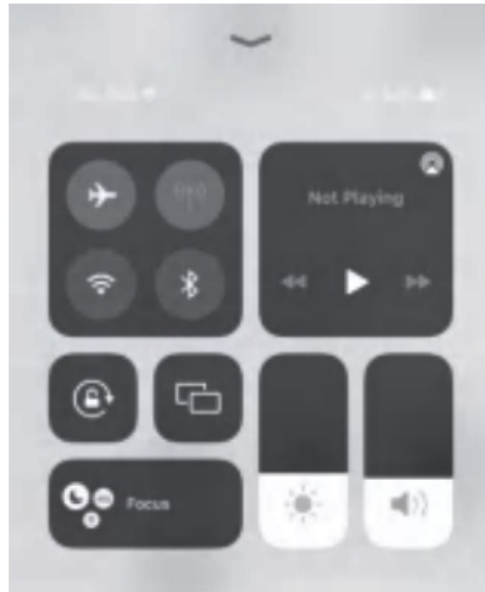

2. Long press the reset button on the module until indicator flashes for reset.

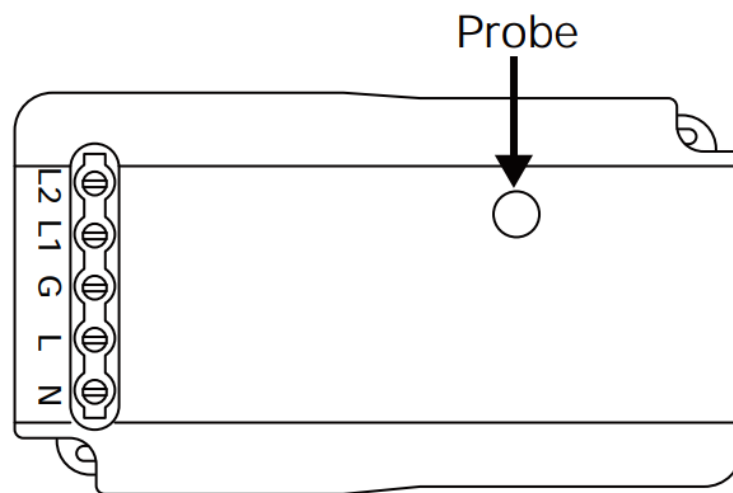

3. Open MOES App and Click "+", then the prompt page will automatically show on the screen. Click "Add".

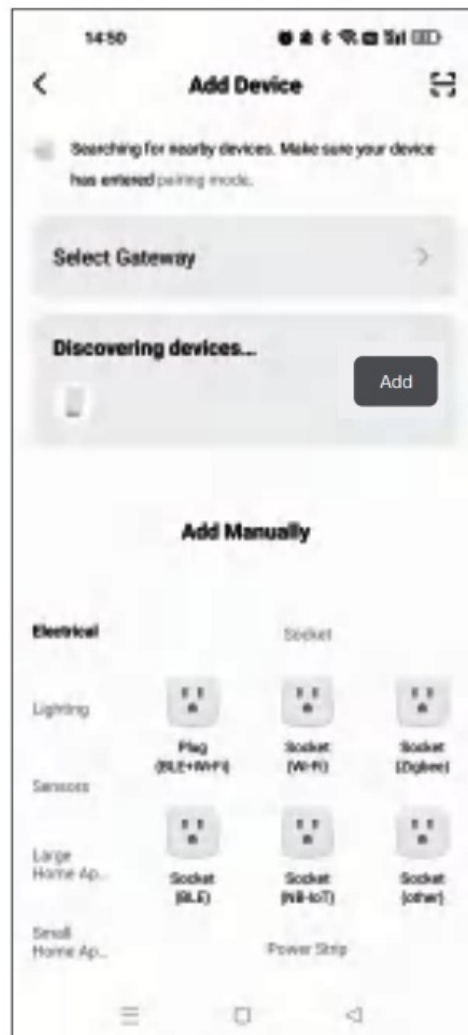

4. Enter Wi-Fi Password and click “Next”,waiting for the connection completed.

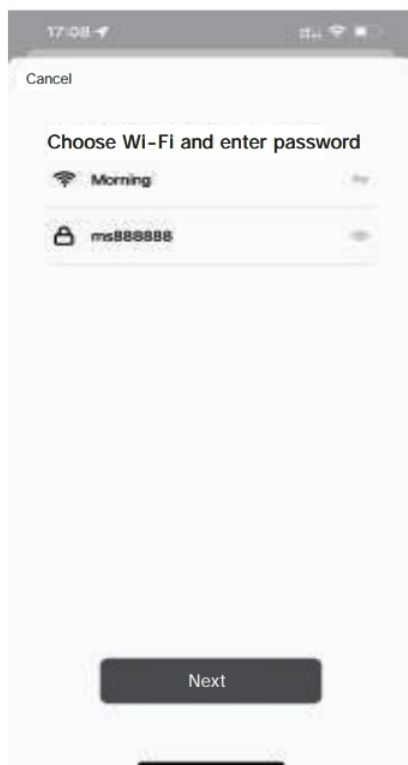

5. Add the device successfully, you can edit the name of the device to enter the device page by click “Next”

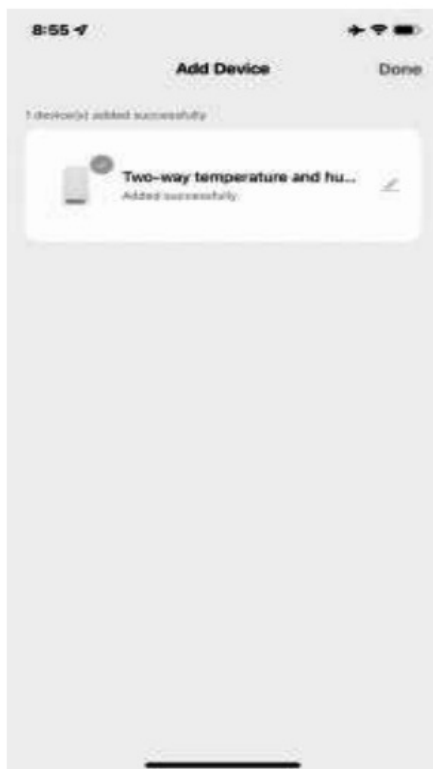

If you cannot add your Smart Device , please check:

1) Whether the Smart Device is powered on. 2) Whether the phone is connected with 2.4GHz Wi-Fi network. 3) Please check routers or related: if your router is dual-band, please select 2.4GHz Wi-Fi network to connect your phone and Smart Plug. 4) Setting up Wi-Fi router: setting encryption method as WPA2-PSK and authorization type as AES, or set both as auto. Wireless mode cannot be 11n only. 5) Please use English and numbers to name your Wi-Fi router. Otherwise our Smart Plug may not recognize it when you try to add it into Smart Life. 6) To stay strong Wi-Fi connection, please keep smart device close to router. 7) Whether connected devices have reached the maximum number of router's connections. If so, please turn off some devices connected to the router and try again. 8) The manual (automatic) mode can be switched only when the temperature and humidity probe is on. 9) The temperature & humidity probe and dual relay output will when the main switch is turned off; And only the temperature and humidity probe will be ON when the main switch is ON.

Control function instructions

1. Heating Mode

When the measured temperature < Low Temperature Value the controller will enter the heating state, the switch module is on, HEATING output works.

When the measured temperature \geq High Temperature Value, the switch module is off and the HEATING output turns off

2. Cooling Mode

when the measured temperature > High Temperature Value, the controller will enter the cooling state, the switch module is on, COOLING output works;

when measured temperature \leq Low Temperature Setting Value, the switch module is off and the COOLING output turns off.

3. Humidifying Mode

When the measured humidity < Low Humidity Value the controller will enter the humidifying state, the switch module is on, HUMIDIFYING output works.

When the measured humidity ≥ High Humidity Value, the switch module is off and the HUMIDIFYING output turns off.

4. Dehumidifying Mode

When the measured humidity > High Humidity Value the controller will enter the dehumidifying state, the switch module is on, DEHUMIDIFYING output works.

When the measured humidity ≤ Low Humidity Value, the switch module is off and the DEHUMIDIFYING output turns off.

Contact us

For any inquiries comments concerning to our products, please do not hesitate to send us email, and we will respond to you as soon as possible.

We appreciate your support!

Control your home with your voice

Devices are compatible with Amazon Alexa and Google Home supported functionalities. Please see our step-by-step guide on: <https://www.moestech.com/blogs/news/smartdevice-linked-voice-speaker>

Declaration of conformity

Hereby, WENZHOU NOVA NEW ENERGY CO., LTD declares that the radio equipment type WM-103 is in compliance with Directive 2014/53/EU, 2014/35/EU, 2014/30/EU, 2011/65/EU. The full text of the EU declaration of conformity is available at the following internet address <https://www.moestech.com/blogs/news/wm-103>

SERVICE

Thank you for your trust and support to our products, we will provide you with a two-year worry-free after-sales service (freight is not included), please do not alter this warranty service card, to safeguard your legitimate rights and interests. If you need service or have any questions, please consult the distributor or contact us. Product quality problems occur within 24 months from the date of receipt, please prepare the product and the packaging, applying for after-sales maintenance in the site or store where you purchase; If the product is damaged due to personal reasons, a certain amount of maintenance fee shall be charged for repair.

We have the right to refuse to provide warranty service if:

1. Products with damaged appearance, missing LOGO or beyond the service term
2. Products that are disassembled, injured, privately repaired, modified or have missing parts
3. The circuit is burned or the data cable or power interface is damaged
4. Products damaged by foreign matter intrusion (including but not limited to various forms of fluid, sand, dust, soot, etc.)

RECYCLING INFORMATION



All products marked with the symbol for separate collection of waste electrical and electronic equipment (WEEE Directive 2012/19 / EU) must be disposed of separately from unsorted municipal waste. To protect your health and the environment, this equipment must be disposed of at designated collection points for electrical and electronic equipment designated by the government or local authorities. Correct disposal and recycling will help prevent potential negative consequences for the environment and human health. To find out where these collection points are and how they work, contact the installer or your local authority.



WARRANTY CARD

Product Information

Product Name _____
 Product Type _____
 Purchase Date _____
 Warranty Period _____
 Dealer Information _____
 Customer's Name _____
 Customer Phone _____
 Customer Address _____

Maintenance Records

Failure date	Cause Of Issue	Fault Content	Principal

Thank you for your support and purchase at we Moes, we are always here for your complete satisfaction, just feel free to share your great shopping experience with us.



If you have any other need, please do not hesitate to contact us first, we will try to meet your demand.

FOLLOW US

@moessmart

@moes_smart

MOES.Official

@moes_smart

@moes_smart

www.moes.net

E-CrossStu-GmbH

Mainzer Landstr. 69 ,60329 Frankfurt am Main

Email: crossstu@web.de

Tel: +4969332967674

Made In China

EVATOST CONSULTING LTD

Address: Suite 11, First Floor, Moy Road Business

Centre, Taffs Well, Cardiff, Wales, CF15 7QR

Tel: +44-292-1680945

Email: contact@evatmaster.com

Manufacturer:

WENZHOU NOVA NEW ENERGY CO.,LTD

Address: Power Science and Technology Innovation

Center, NO.238, Wei 11 Road, Yueqing Economic

Development Zone, Yueqing, Zhejiang, China

Tel: +86-577-57186815

After-sale Service: service@moeshouse.com

Documents / Resources

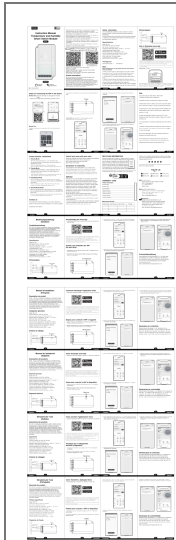

[Moes WM-103-MS-DD10 WiFi Smart Temperature Humidity Sensor Dual Relay](#) [pdf] Instruction Manual

WM-103-MS-DD10, WM-103-MS-DD10 WiFi Smart Temperature Humidity Sensor Dual Relay, WiFi Smart Temperature Humidity Sensor Dual Relay, Smart Temperature Humidity Sensor Dual Relay, Humidity Sensor Dual Relay, Sensor Dual Relay, Dual Relay, Relay

References

- [M MOES Smart: Create Your Smart Life With Smart Home Devices](#)
- [User Manual](#)

[Manuals+](#), [Privacy Policy](#)

This website is an independent publication and is neither affiliated with nor endorsed by any of the trademark owners. The "Bluetooth®" word mark and logos are registered trademarks owned by Bluetooth SIG, Inc. The "Wi-Fi®" word mark and logos are registered trademarks owned by the Wi-Fi Alliance. Any use of these marks on this website does not imply any affiliation with or endorsement.