

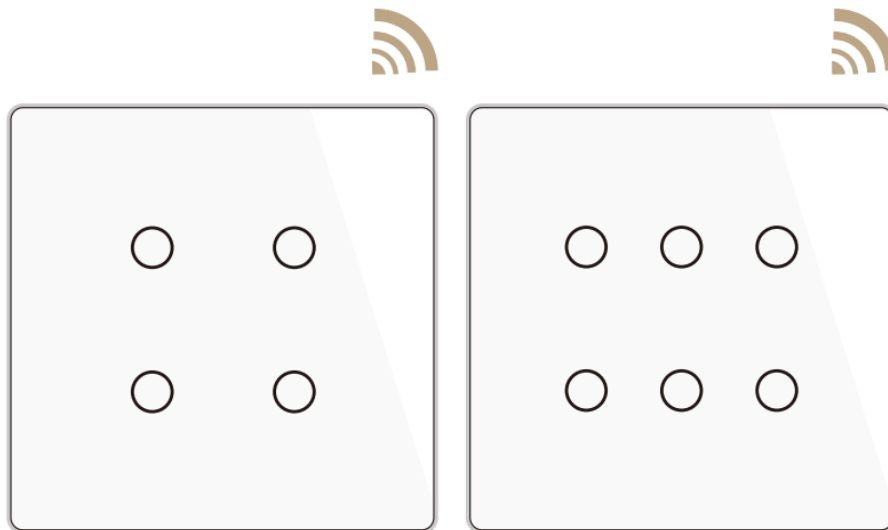

MOES WiFi 4 and 6 Button Smart Switch Instruction Manual

[Home](#) » [MOES](#) » MOES WiFi 4 and 6 Button Smart Switch Instruction Manual 

MOES WiFi 4 and 6 Button Smart Switch



Contents

- [1 Product Description](#)
- [2 Safety Information](#)
- [3 Installation](#)
- [4 Add Devices](#)
- [5 Enter Smart Life Skill in Alexa APP](#)
- [6 SERVICE](#)
- [7 RECYCLING INFORMATION](#)
- [8 WARRANTY CARD](#)
- [9 FOLLOW US](#)
- [10 Documents / Resources](#)
 - [10.1 References](#)
- [11 Related Posts](#)

Product Description

The smart touch wall switch is designed with WiFi, which meets the demand of most families. Its scratch resistance glass panel is suitable for different styles of decoration at its best value. A new smart feature like association of multiple smart controls is added to Smart Life App, along with for controlling by app. It works with Alexa Google Home, guaranteeing the user an experience of controlling their lights through multiple control modes, providing their intelligent life with much more comfort and pleasure.

Safety Information

Electric Shock Hazard: Electricity can cause personal injury and property damage if handled incorrectly. If you are unsure about any part of these instructions, please seek professional assistance from a qualified electrician.

Technical Parameters:

Model: WRS-BR4 / WRS-BR6

Voltage: 100-250V AC, 50/60Hz

Max. Current: 10A/Gang; Total 10A

Max. charging power: 2200W

Wireless Protocol: Wi-Fi 2.4GHz+RF433MHz

Work temperature: 0°C~40°C

support system: Android / iOS

Warnings: Turn off the power at the circuit breaker and test that power is off before wiring.

Installation

Note:

- Install the switch with the electricity turned off.
- Do not install in wet environment.
- Neutral wire is required. Confirm that the wall box contains a wire (usually white). If the wall box does not contain the wire, try another location in your home or contact an expert.
- The wire colors indicated in this manual are the usual colors and can be changed in some houses.
- Make sure the wire conductors are securely attached to each wire. Check if the Wi-Fi signal is stable and normally working before wiring.
- Please follow the instructions and install correctly.

Step 1

- Turn off the circuit breaker and use the electrical tester to test the power.
- Ensure the circuit breaker is off before wiring.





Attention: Please disconnect the power supply before installing or removing the device for avoiding irreversible damage on the device from the electric current or some unpredictable problems such as lamp flashing.

Step 2

Remove the old switch

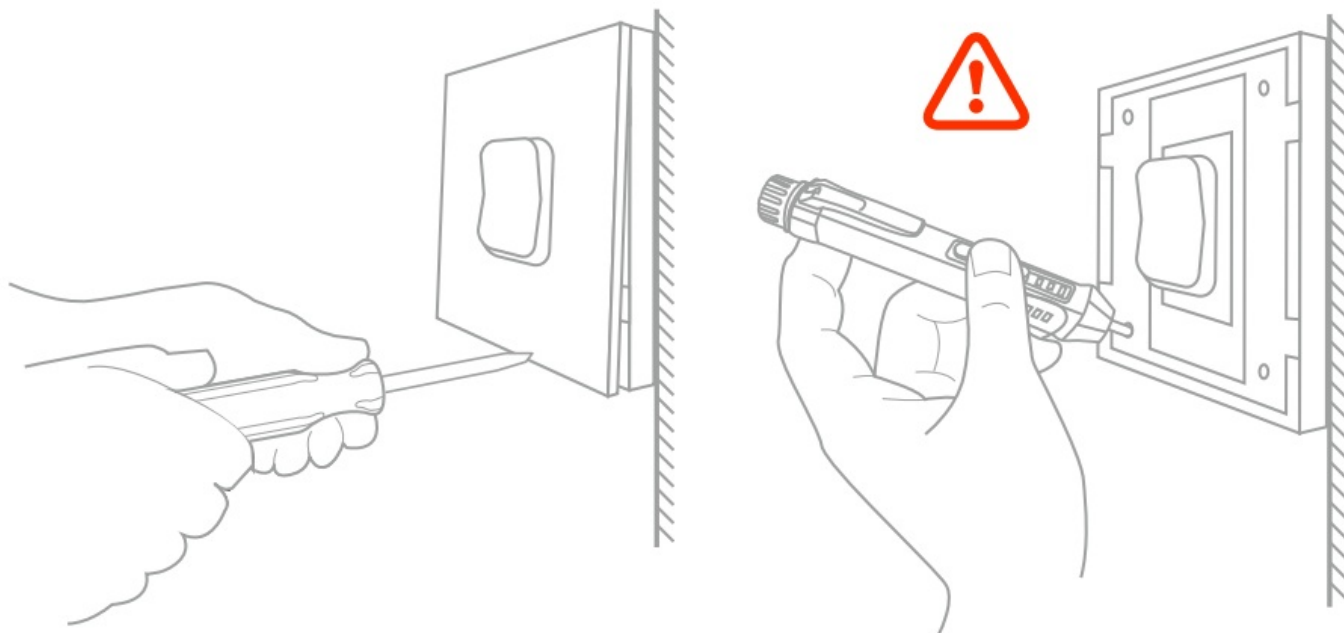

Step 3

Remove the switch and pull it away from the wall. Identify Line/Load **Wire**(Note: The color of your wire may be different from the color shown on the manual.)



Verify power is off

- We recommend you remove the faceplate from the old switch and use an electrical tester to test all wire connected to the switch to ensure there is no voltage in the circuit.
- You may need to turn off more than one circuit breaker

Step 4

- Take pictures of the wiring

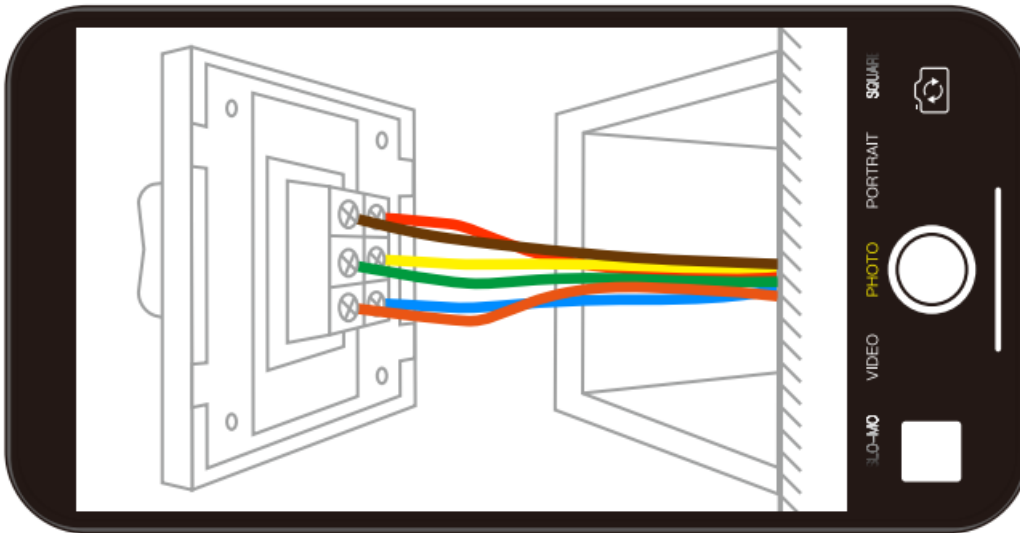

- Follow the wiring diagram to connect the switch wires to the wires in the wall box with the wire conductors.

Step 5

- Remove the panel with screwdriver
(Please don't install with electricity power on)

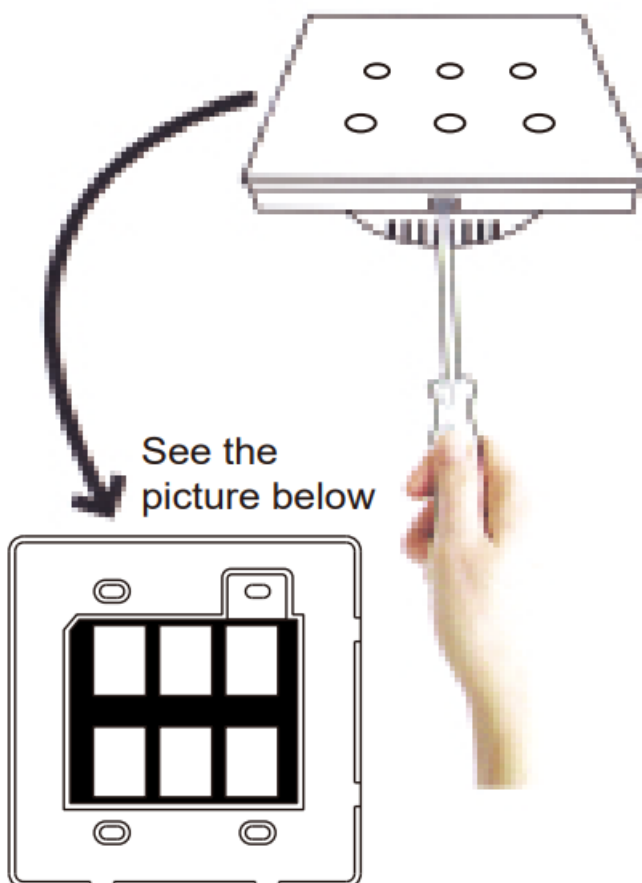

Step 6

- **Prepare to install wiring**
 - A. Live wire connects “ L ” terminal
 - B. Neutral wire connects “ N ” terminal

C. Lamp wire connects “ L1,L2,L3,L4,L5,L6 ” terminal

1. Gang connects “L1” terminal
2. Gang connects “L1,L2” terminal
3. Gang connects “L1,L2,L3” terminal
4. Gang connects “L1,L2,L3,L4” terminal
5. Gang connects “L1,L2,L3,L4,L5” terminal
6. Gang connects “L1,L2,L3,L4,L5,L6” terminal

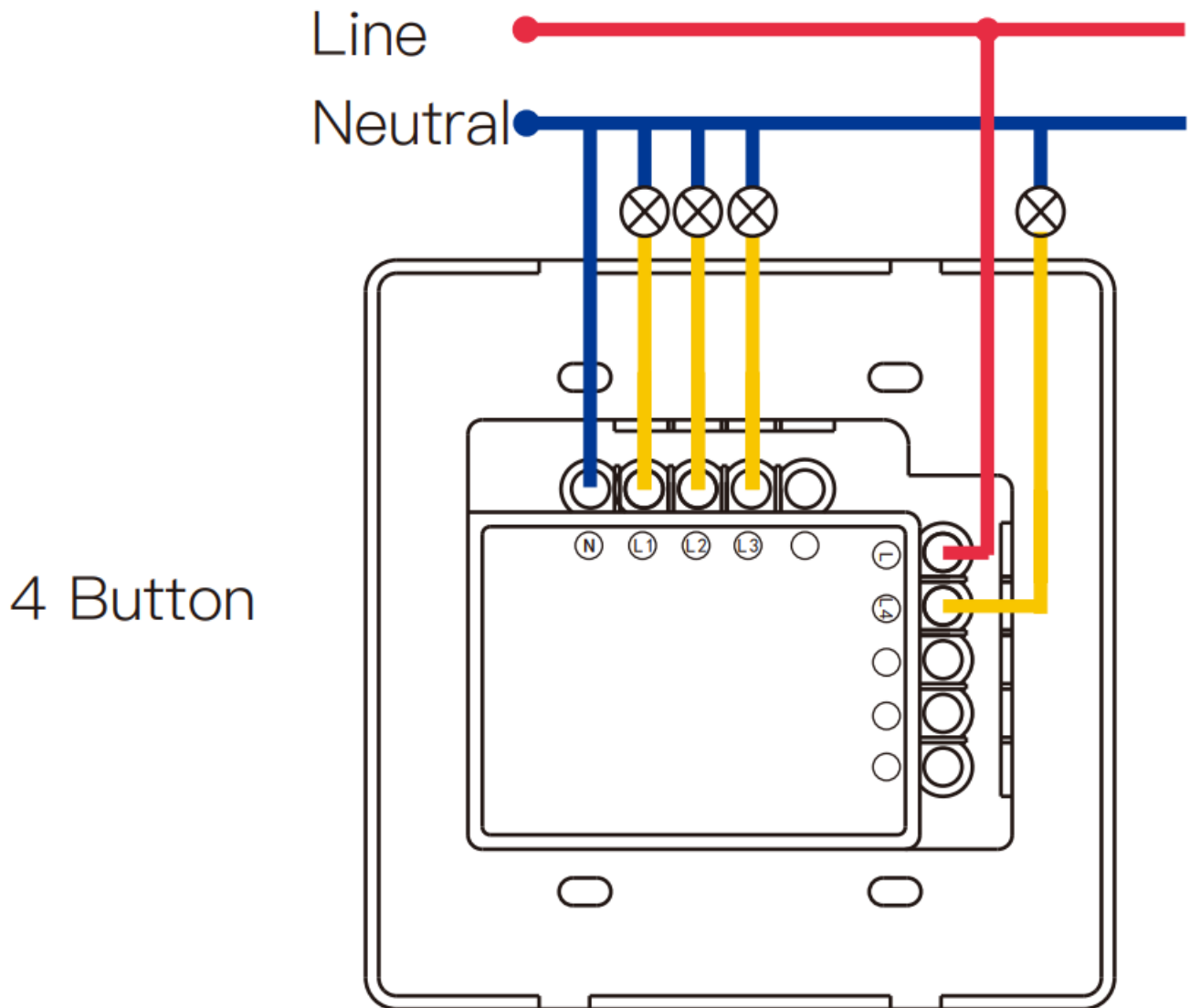

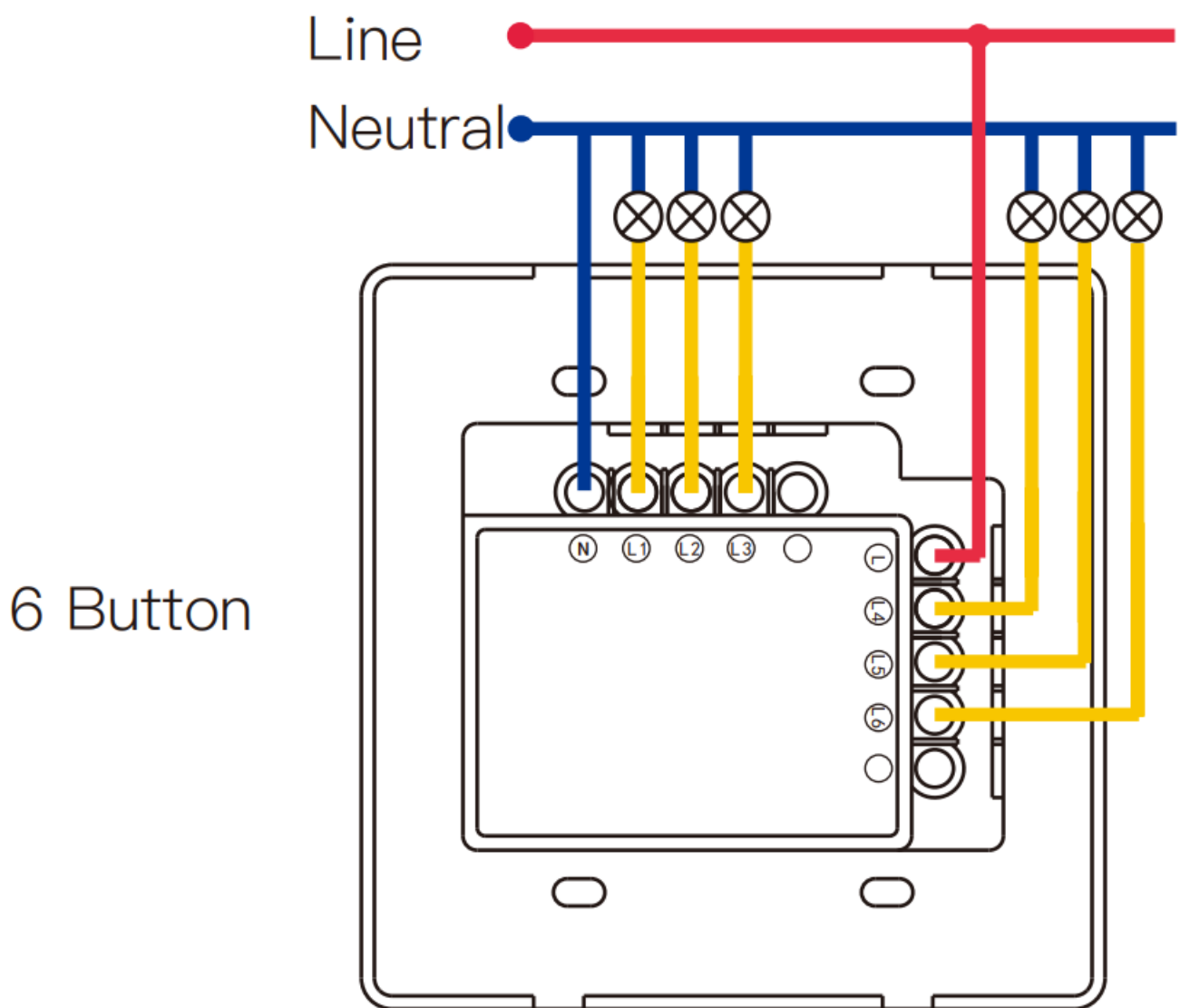

Step 7

- Put the switch into switch box in the wall
- Mount the two side screws
- Install the glass panel (install from up above)
- Finish installation

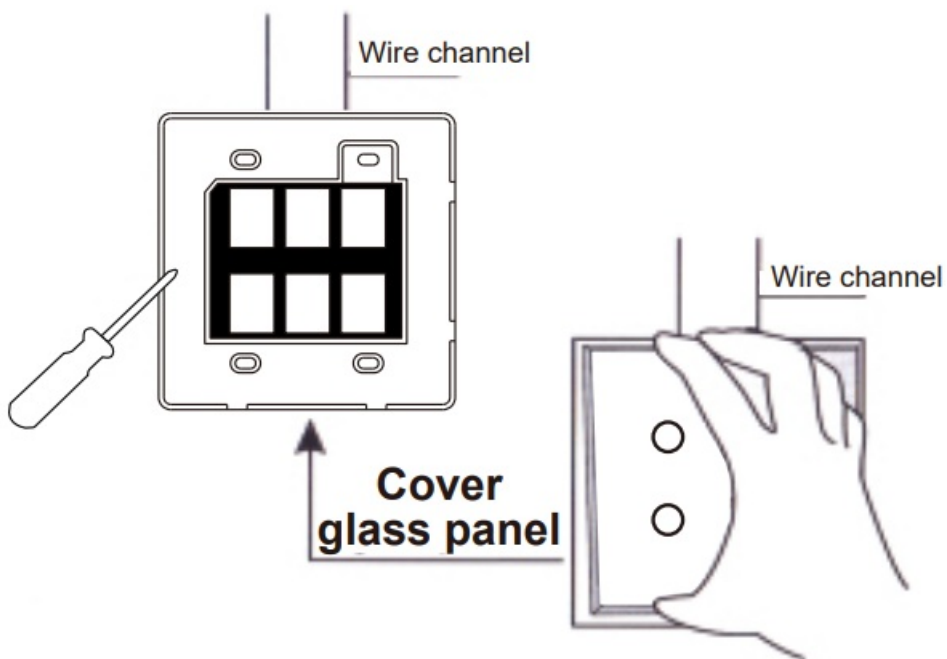

Add Devices

1. Download Smart Life App





Please scan the QR code or download Smart Life on App store.

2. Registration or Log in

- Download "Smart Life" Application
- Enter the Register/Login interface; tap "Register" to create an account by entering your phone number to get verification code and "Set password". Choose "Log in" if you already have a Smart Life account.

3. Configure the APP to the switch

Preparation: Ensure the switch has been connected with electricity; ensure your phone has been connected to Wi-Fi and is able to connect to the Internet.

Note: The switch only supports 2.4G network. If you have connected 5G network, please disconnect 5G network firstly and connect 2.4G network.

Wi-Fi link method: Pair and clear up the WiFi code(New Updated)

1. Confirm the indicator is flashing, if not, press and hold the button for 6s until the indicator flashes.
2. Make sure your phone is connected to Wi-Fi and Bluetooth.

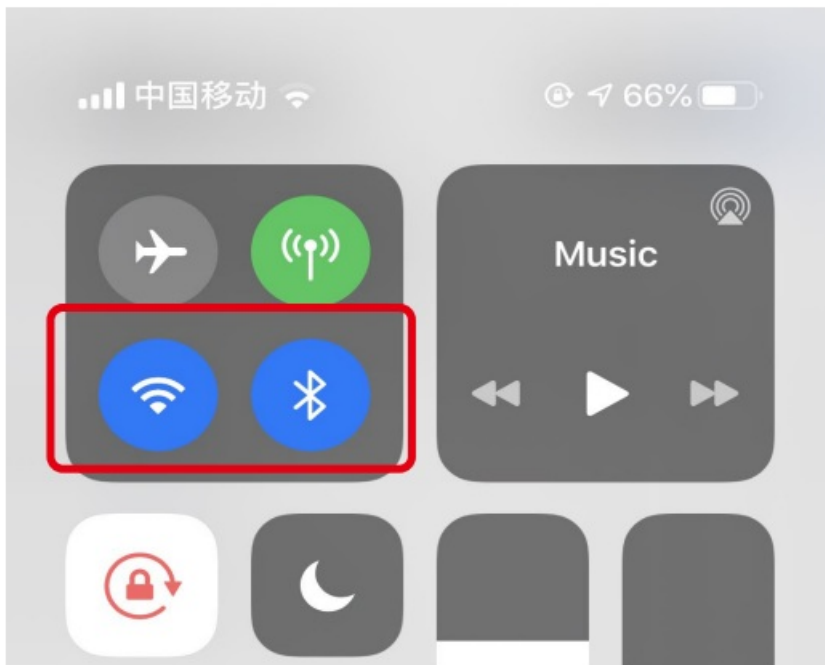

3. Open Smart Life/Tuya App and Click "+", then the prompt page will automatically show on the screen. Click "Go to add".

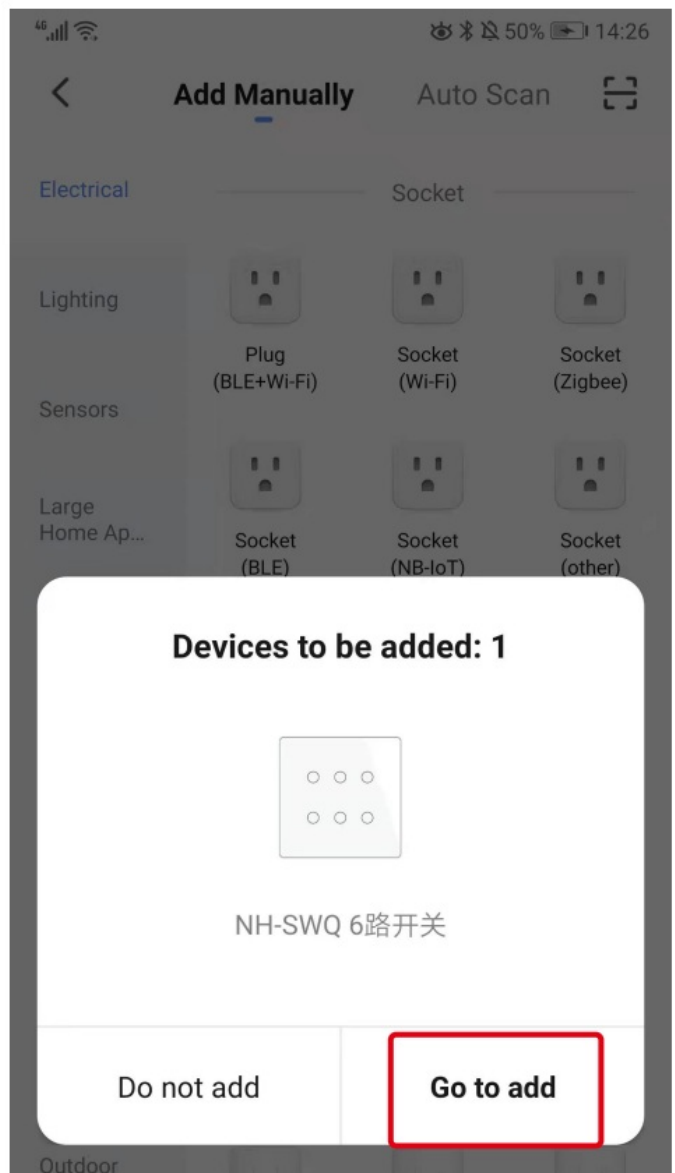
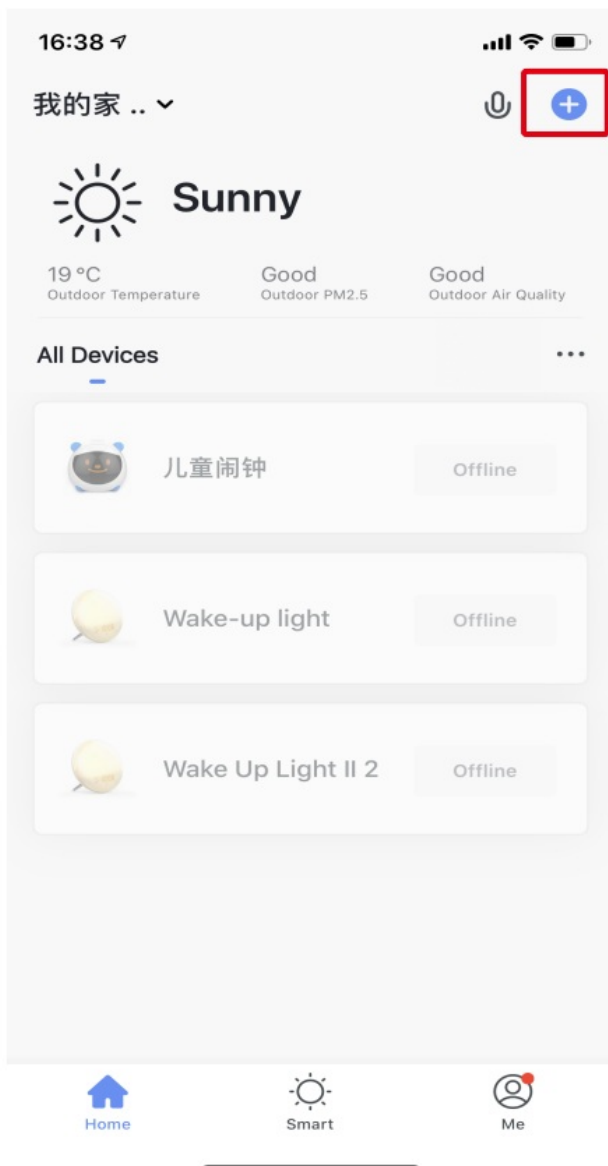

4. Select the device you want to add and click "Add"

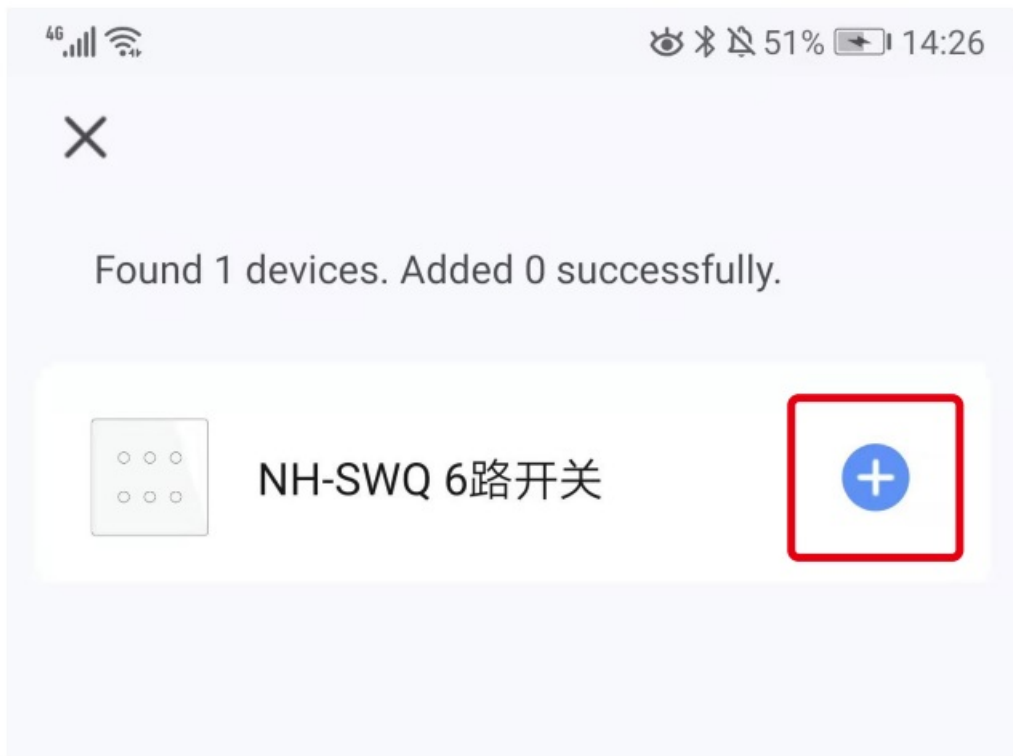

5. Enter Wi-Fi Password and click “Confirm”,waiting for completing the connection.

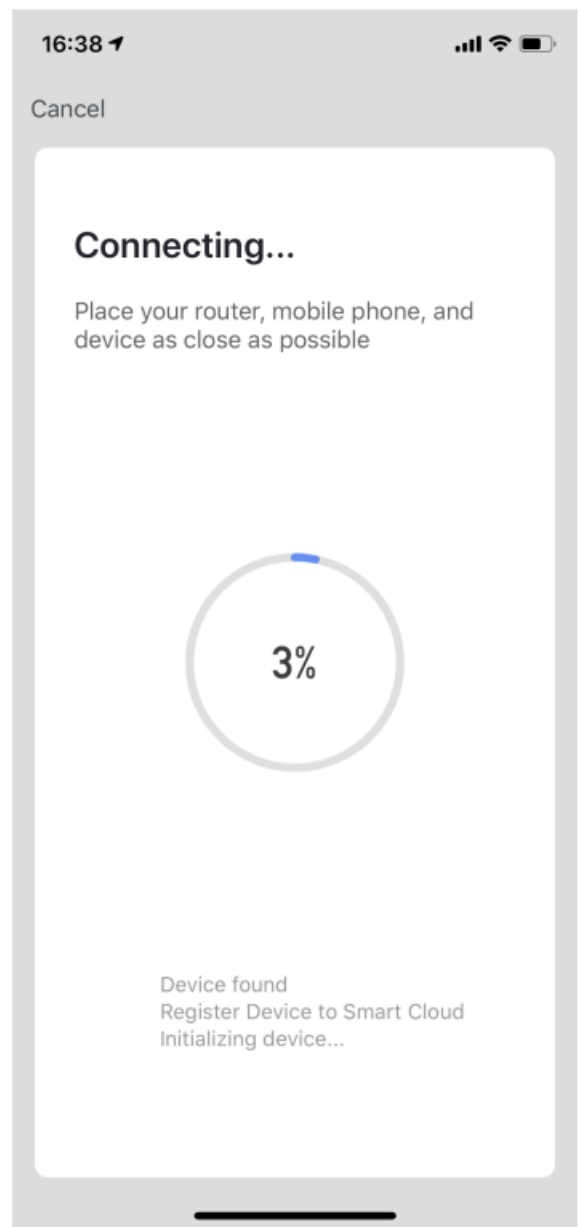
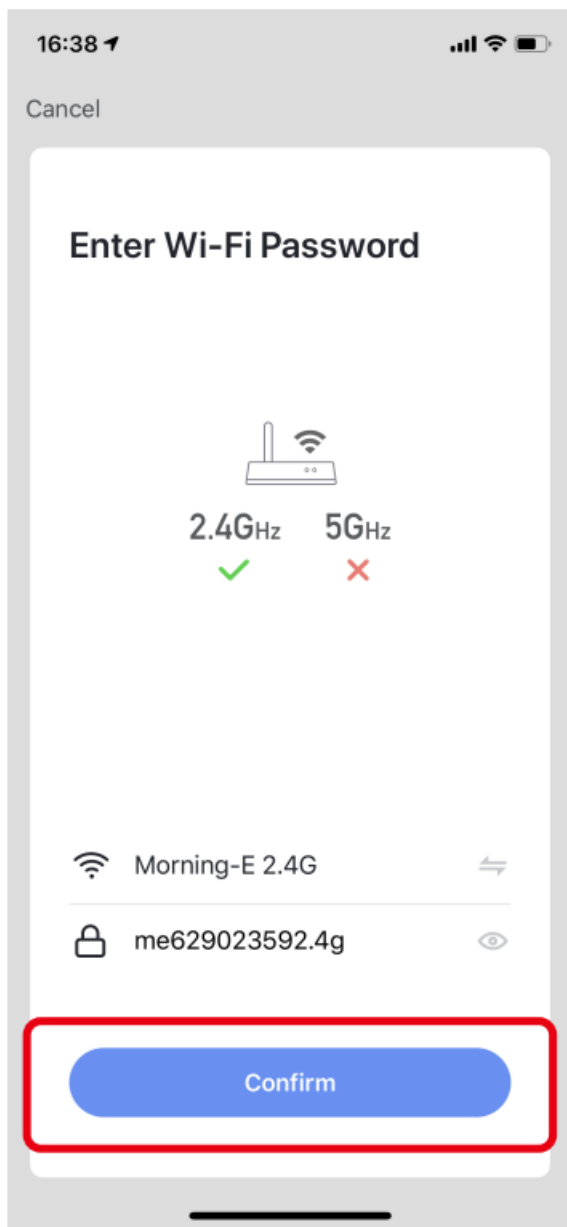

6. Add the device successfully, you can edit the name of the device to enter the device page by click "Done"

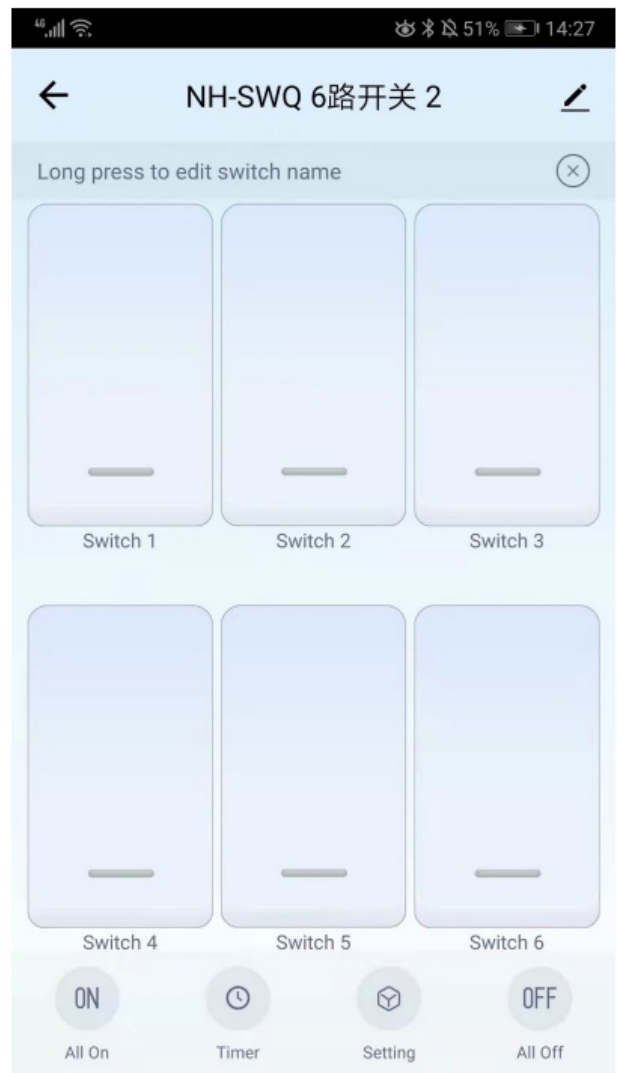
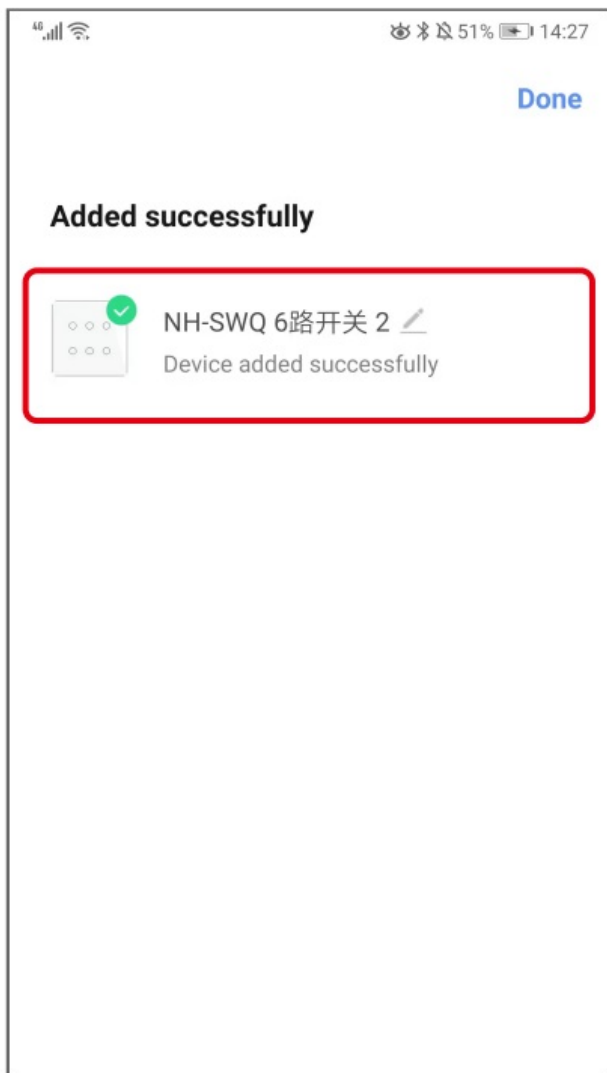

How to reset/re-pair Wi-Fi code

Press the switch button for about 6 seconds, then release until you hear Di-Di-Di(3 times), and the blue indicator on the switch will flash fast after 3 seconds. Reset/re-pair is successful.

Remote radio frequency (RF)link method: Pair and clear up the RF code

How to pair the RF code

1. (can be turned on and off): Press the switch button for 6 times and long press on the 6th time until you hear the beep as Di-Di-Di for 3 times. Then the matching of RF code is successful. The key of the remote controller can control the switching of the state of the switch on and off corresponding to the position of the switch.
2. (Open only): Press the switch button for 6 times and long press on the 6th time until you hear the beep as Di for 1 time. Then the matching of RF code is successful.
The key of the remote controller can control the switching of the state of the switch on and off corresponding to the position of the switch.
3. (Close only): Press the switch button for 6 times and long press on the 6th time until you hear the beep as Di-Di for 2 times. Then the matching of RF code is successful. The key of the remote controller can control the switching of the state of the switch on and off corresponding to the position of the switch.

How to clear up the RF code

Press the switch button for 6 times and long press on the 6th time until you hear the beep as Di-Di-Di-Di for 4 times, and then release the button. The RF code is now cleared up.

How to achieve multi-control association

Note: Please confirm you have successfully finished the WiFi link method above for adding this switch to your Smart Life App before the association.

1. WiFi add another smart switch to the same Smart Life/Tuya App.(If there is a smart switch having been added before to the app,just go to next step.)Note:There is no need to wire the new added switch to the light,only L and N are required for wiring.
2. Then you will see two devices in the app and click the main switch(as One gang switch as below) by entering into the next operation.

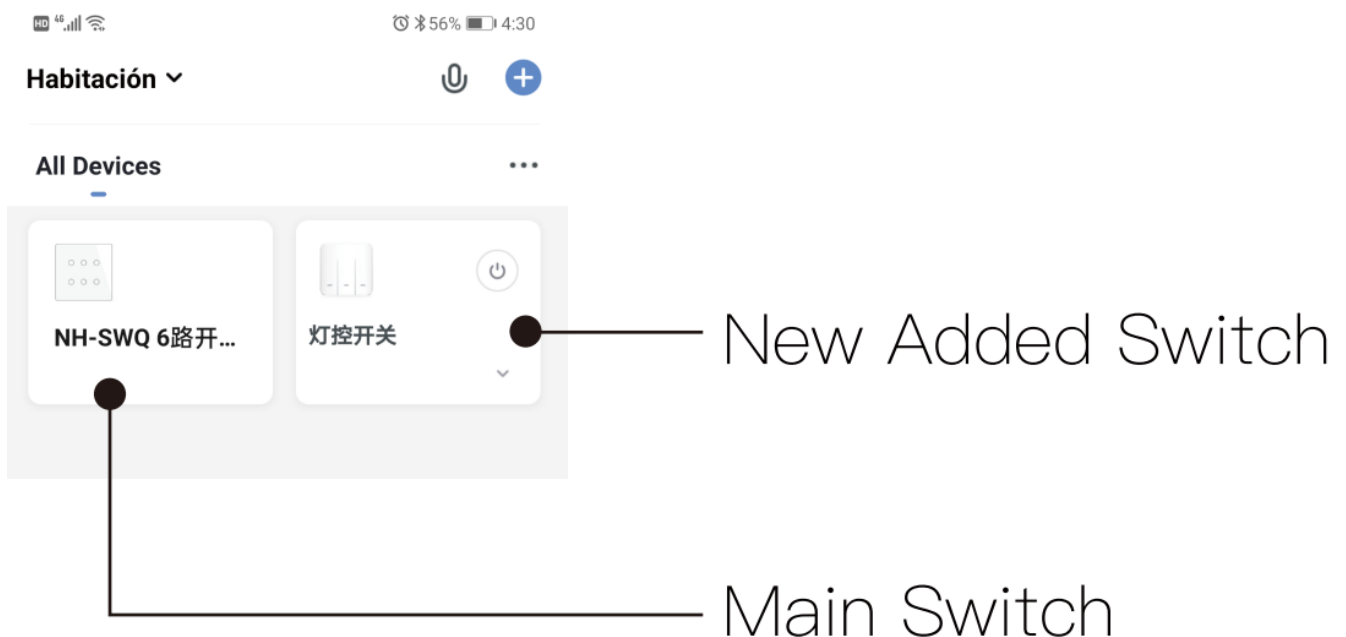

3. Click  in the upper right corner and choose“ Multi Control Association, and then click “+” in the right corner

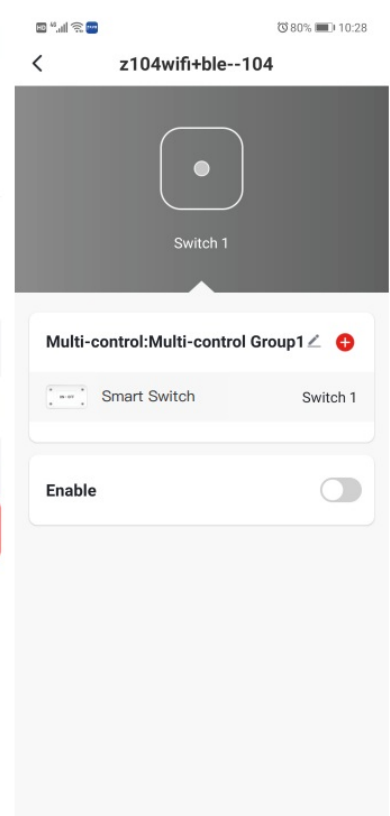
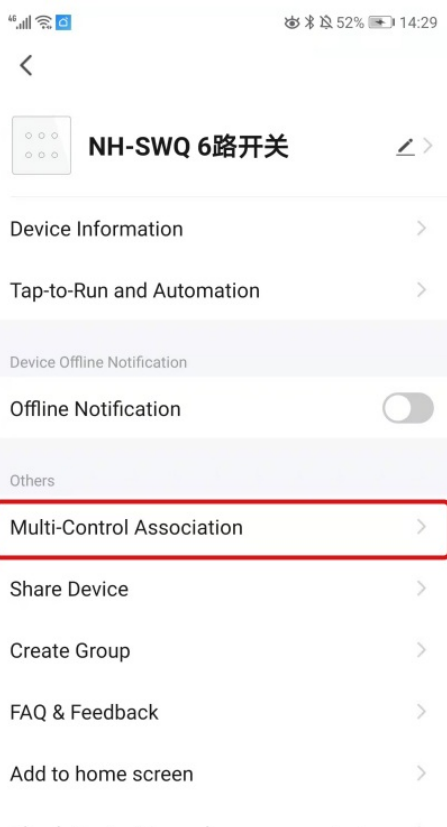
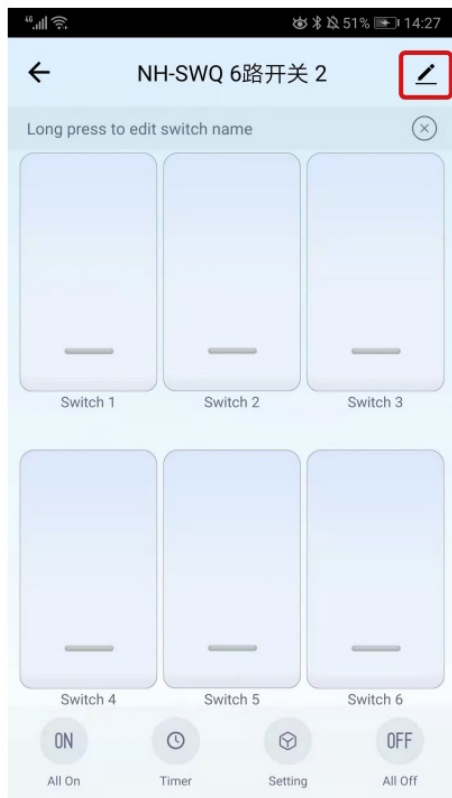

4. Choose the switch that you want to associate to and then choose the switch button that you want to control the same light.
5. Then go back to previous page,you will see two items in the page,one is your main switch,the other is the one you associate just now.

Note: Please confirm the associated switch is enabled.

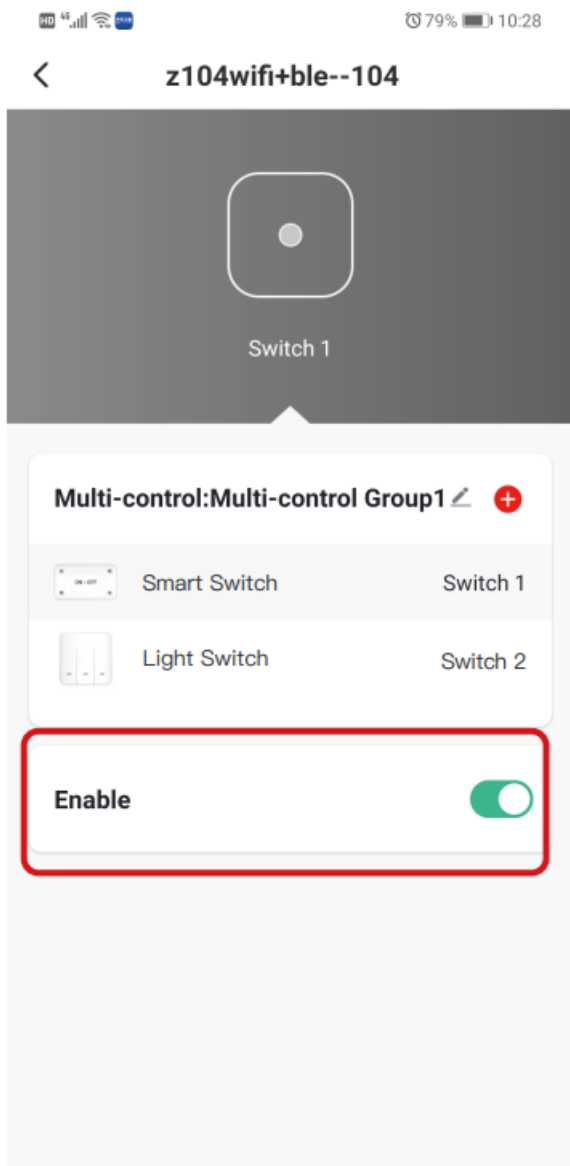

6. Now you are able to control your light with two switches. Do not associate another button in the same switch for multi-control.
7. If you want to add another third or more smart switches to control your light, just repeat the steps above. And you will see the result as below when you associate another new switch.

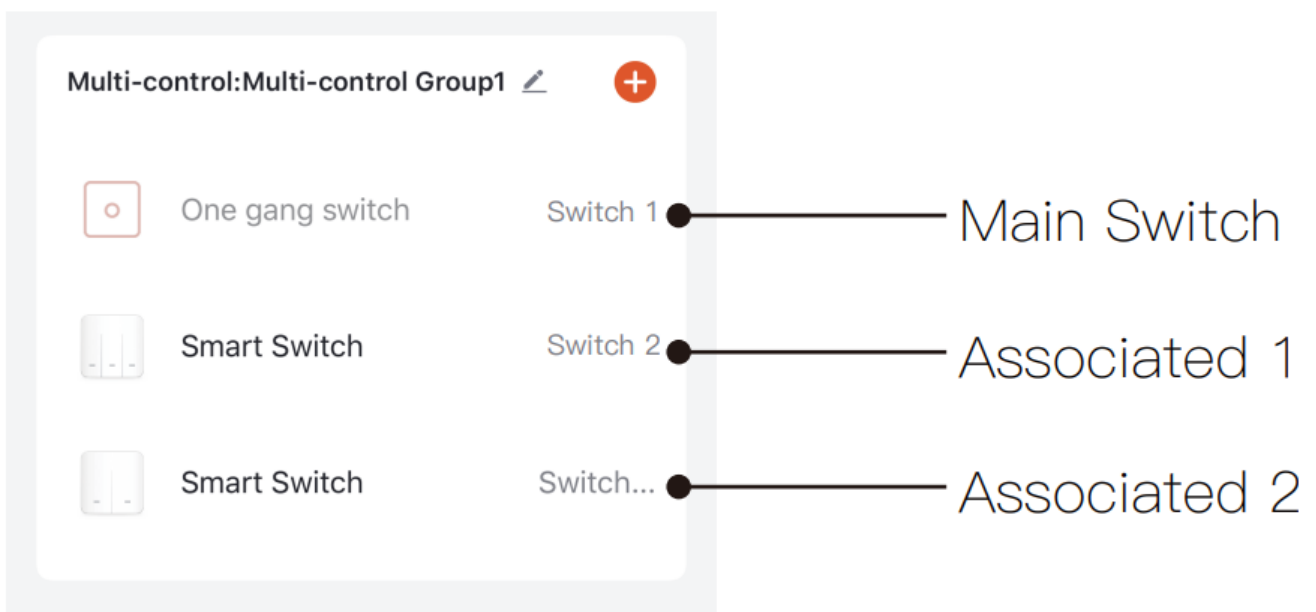

Enter Smart Life Skill in Alexa APP

Complete product networking configuration in the App

Complete the device's networking configuration according to the prompts in the App.

Note: In the App, change the name of the device to an easily identifiable name such as Alexa; names are usually in English, such as "bed light".

Configure the Amazon Echo device

(If you have already configured Amazon Echo, you can skip this step. The following instructions are based on the iOS client.)

Make sure your Amazon Echo device is powered on and connected to a Wi-Fi network.

Open the Alexa App on your phone. After successful login, tap on the menu in the upper left corner of the Home page, select "Settings" and tap "Set Up A New Device" to set up the Amazon Echo.

Choose your Amazon Echo device type and language for connecting. Press and hold the small dot on the device until the light turns yellow. Then tap "Continue" to connect to the hotspot.

After connecting to the Amazon Echo hotspot, return to the page. At this point, the connection is successful.

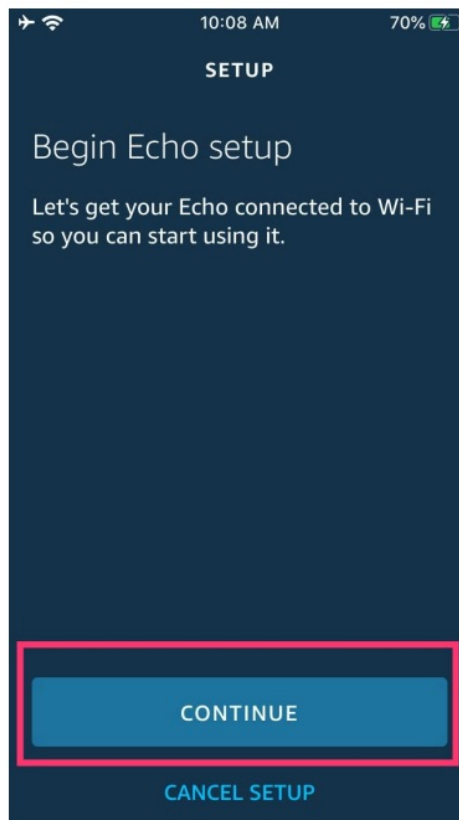
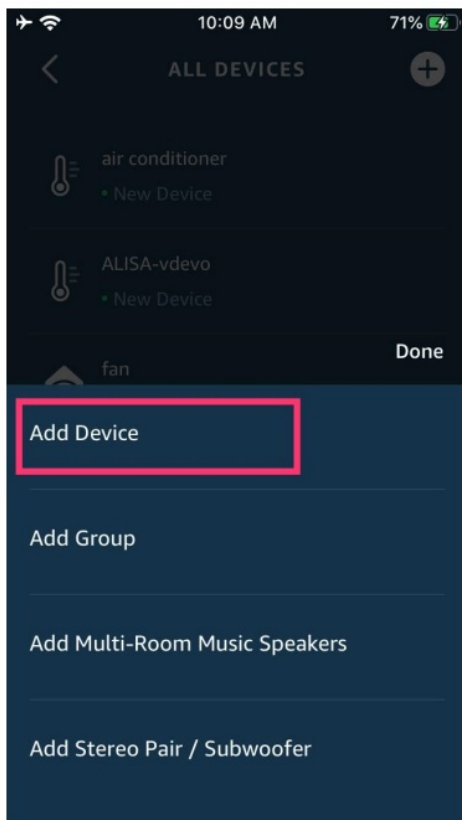



Tap “Continue” to proceed to the next step. Choose a Wi-Fi network to connect to. Amazon Echo will take a few minutes to try to connect to the network.
After the network connection is successful, tap “Continue”. An introduction video will appear. After the video ends, tap “Continue” to jump to the Alexa Home page. You have now completed the Amazon Echo’s configuration process.

Key step — Link Skill

- Tap on “Skills” in the Alexa App menu.

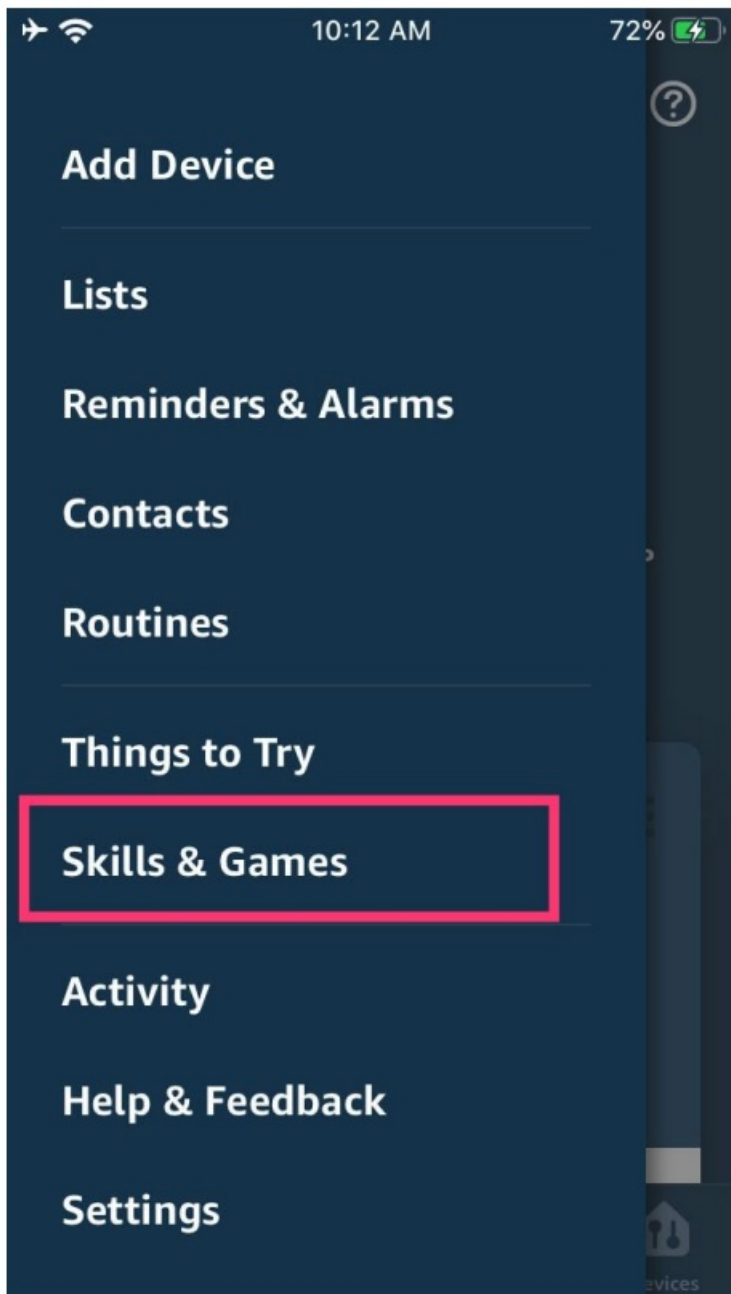

- Then search for “App Name”. Tap “Enable” to enable the Skill.
- Enter the App account and password, then tap “Link Now” to link your App account to enable the Skill. Now you can start your smart home journey.

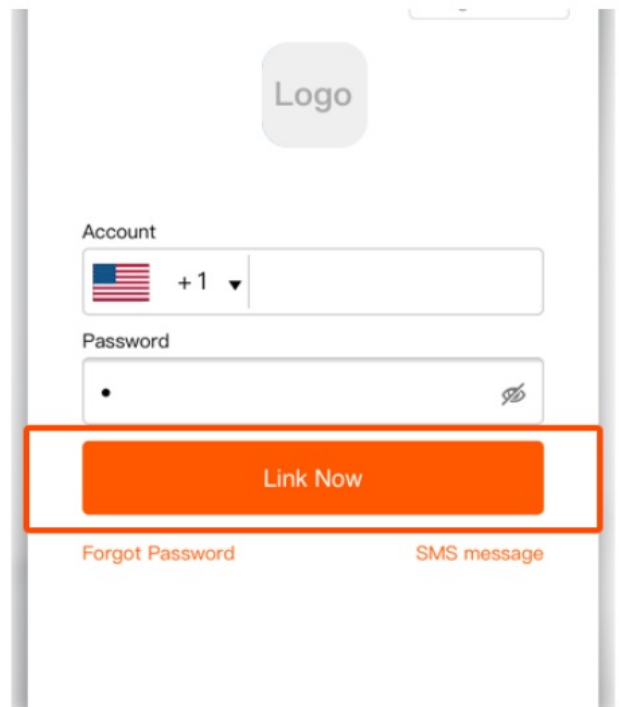
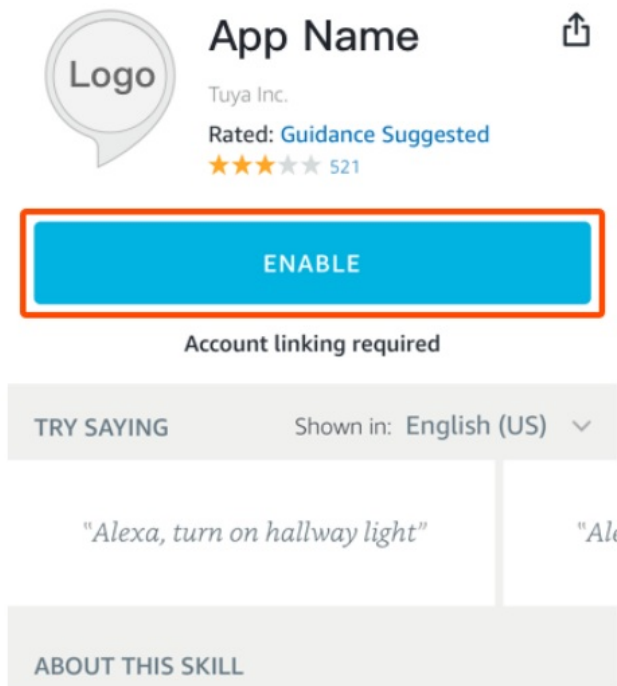

Common commands

Control the device via voice commands, now you can control your smart device with Echo. You can control your device (such as your bedroom light) with the following commands:

- Alexa, turn on/off bedroom light. (Turn on/off the light)
- Alexa, set bedroom light to 50 percent. (Set the light to any brightness)
- Alexa, brighten/dim bedroom light. (Increase/weaken the brightness of the light)
- Alexa, set bedroom light to green. (Adjust the color of the light)

SERVICE

1. During the free warranty period, if the product breaks down during normal use, we will offer free maintenance for the product.
2. Natural disasters/man-made equipment failures, disassembly and repair without the permission of our company, no warranty card, products beyond the free warranty period, etc., are not within the scope of free warranty
3. Any commitment (oral or written) made by the third party (including the dealer/service provider) to the user beyond the warranty scope shall be executed by the third party
4. Please keep this warranty card to ensure your rights
5. Our company may update or change the products without notice. Please refer to the official website for the updates.

RECYCLING INFORMATION



■ All products marked with the symbol for separate collection of waste electrical and electronic equipment (WEEE Directive 2012/19 / EU) must be disposed of separately from unsorted municipal waste. To protect your health and the environment, this equipment must be disposed of at designated collection points for electrical and electronic equipment designated by the government or local authorities. Correct disposal and recycling will help prevent potential negative consequences for the environment and human health. To find out where these collection points are and how they work, contact the installer or your local authority.

WARRANTY CARD

Product Information

Product Name _____
Product Type _____
Purchase date _____
Warranty Period _____
Dealer Information _____
Customer's Name _____
Customer Phone _____
Customer Address _____

Maintenance Records

Failure date	Cause Of Issue	Fault Content	Principal

Thank you for your support and purchase at we Moes,we are always here for your complete satisfaction,just feel free to share your great shopping experience with us.



If you have any other need,please do not hesitate to contact us first,we will try to meet your demand.

FOLLOW US



@moessmart



@moes_smart



@moes_smart



moes



@moes_smart



WENZHOU NOVA NEW ENERGY CO.,LTD

Address: Power Science and Technology Innovation Center, NO.238, Wei 11 Road, Yueqing Economic Development Zone, Yueqing, Zhejiang, China

Tel:+86-577-57186815

Email: service@moeshouse.com



AMZLAB GmbH

Laubenhof 23, 45326 Essen

Made In China

Documents / Resources



[MOES WiFi 4 and 6 Button Smart Switch](#) [pdf] Instruction Manual

WiFi 4 and 6 Button Smart Switch, WiFi 4 Button Smart Switch, WiFi 6 Button Smart Switch, Button Smart Switch, Smart Switch, Bluetooth Switch, Switch

References

-  [MOES Smart WiFi ZigBee Smart 2/3 Way Switch Socket Thermostat Sensor](#)