

MOES MS-108ZR Smart Curtain Switch Module Instruction Manual

[Home](#) » [MOES](#) » MOES MS-108ZR Smart Curtain Switch Module Instruction Manual 

MOES MS-108ZR Smart Curtain Switch Module Instruction Manual

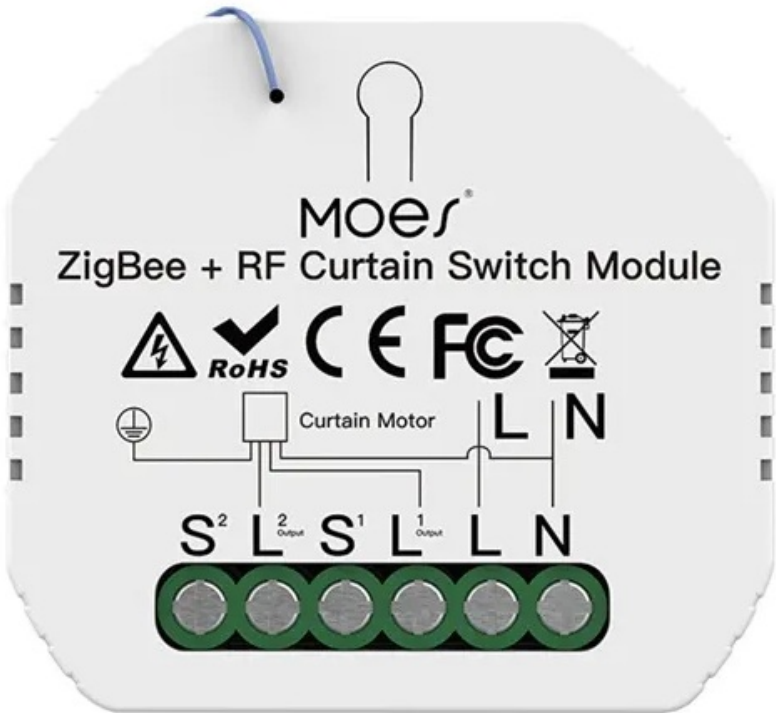

- Bitte scannen Sie den QR-Code, um das deutsche
- Veuillez scanner le code QR pour obtenir le manuel en français, la vidéo d'installation et l'introduction des fonctions
- Отсканируйте QR-код, чтобы получить руководство на русском языке, видео по установке и описание



Global international operation Whenever & Wherever You are, All-in-one Mobile App.

1. Schedule timer



2. Voice control-work with Google Home

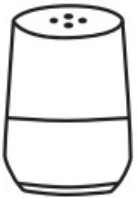

3. Voice control-work with Amazon Alexa

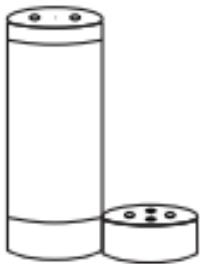

4. Device Sharing

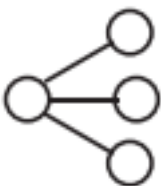

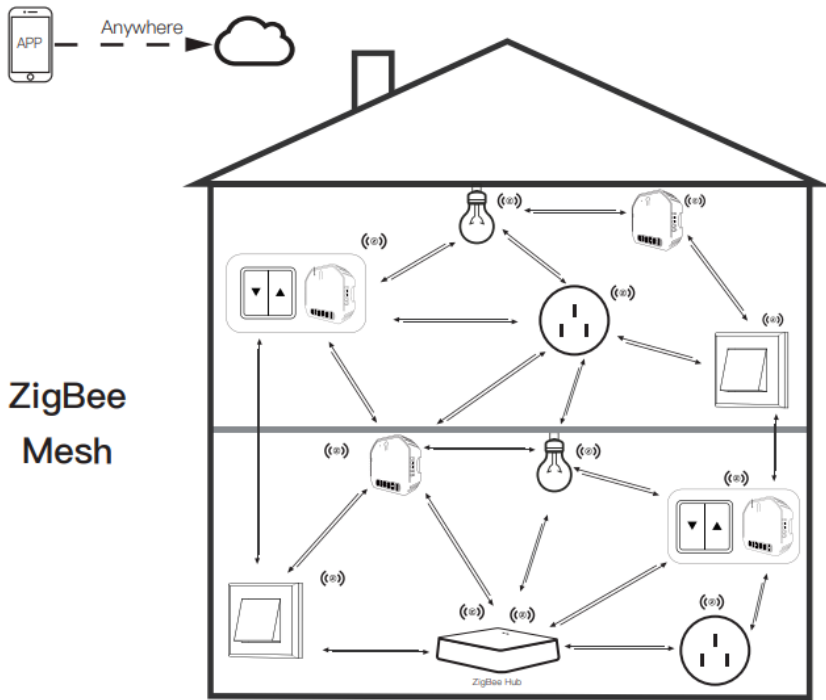

Inhouse local operation

1. App

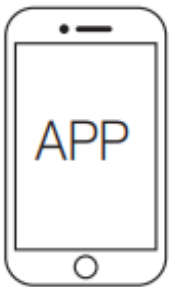

2. Route

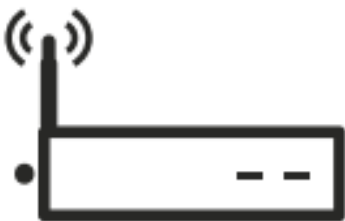

3. Voice control



4. Reset Curtain Switch

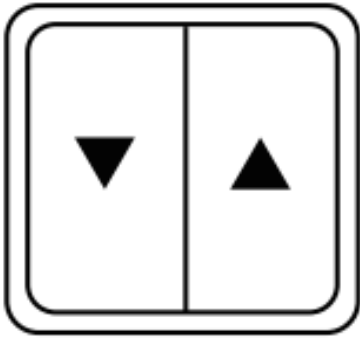

5. Rocker Curtain switch

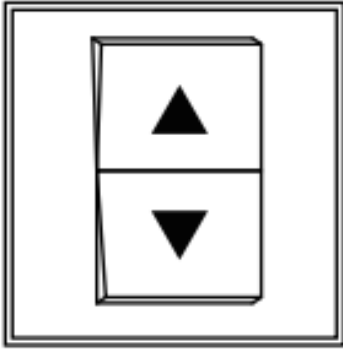

Note: Press the traditional curtain switch once after switch to up/down (any button on the switch) to stop the curtains (connect your switch to the curtain module first).

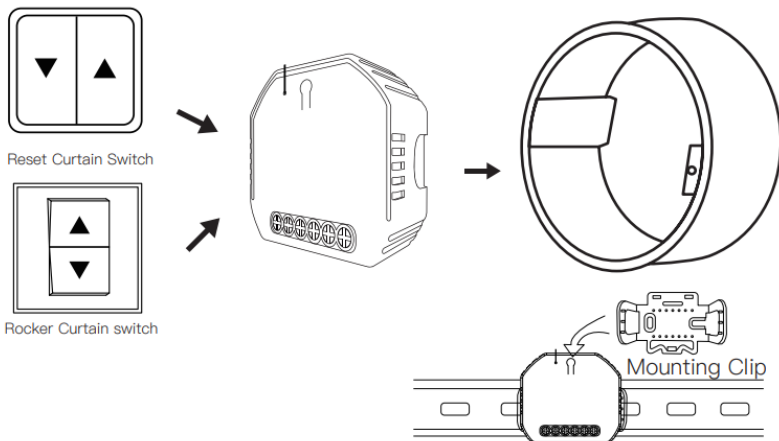

- Turn off the circuit breaker and use the electrical tester to test the power.
- Ensure the circuit breaker is off before wiring.



Attention

Please disconnect the power supply before installing or removing the device for avoiding irreversible damage on the device from the electric current or some unpredictable problems such as lamp flashing

Remove the old switch

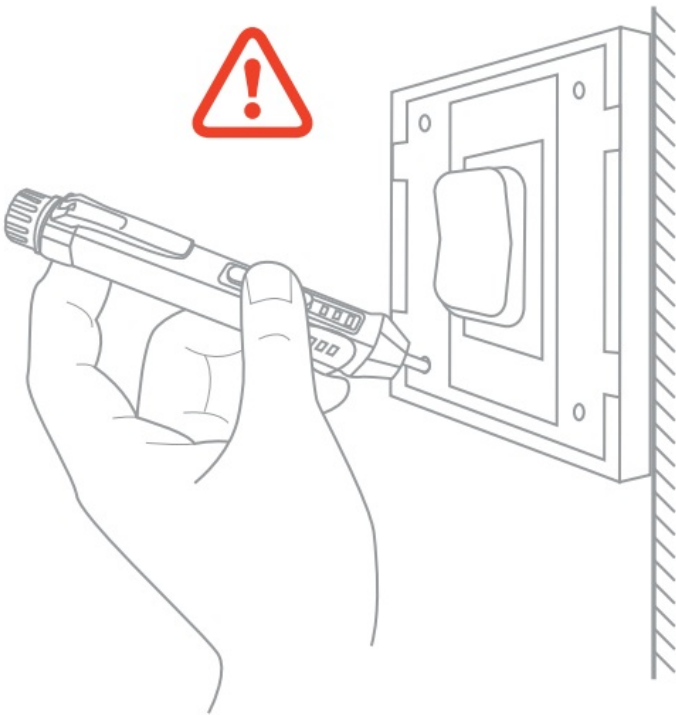
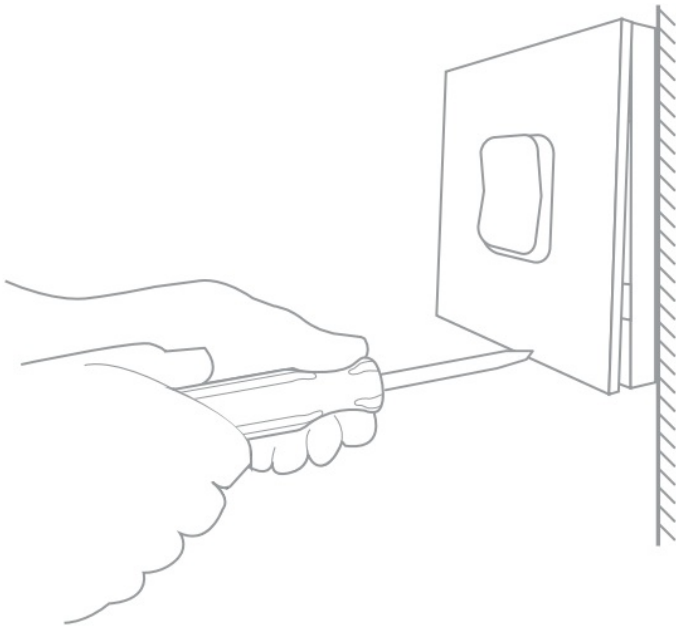

Remove the switch and pull it away from the wall. Identify Line/Load Wire (Note: The color of your wire may be different from the color shown on the manual.)



Verify power is off

- We recommend you remove the faceplate from the old switch and use an electrical tester to test all wires connected to the switch to ensure there is no voltage in the circuit.
- You may need to turn off more than one circuit breaker

Contents

- [1 INSTALLATION](#)
- [2 TECHNICAL SPECIFICATIONS](#)
- [3 WIRING DIAGRAM](#)
- [4 FAQ](#)
- [5 MANUAL OVERRIDE](#)
- [6 Enter Smart Life Skill in Alexa APP](#)
- [7 RF Link Method](#)
- [8 Reset Method](#)
- [9 SERVICE](#)
- [10 RECYCLING INFORMATION](#)
- [11 WARRANTY CARD](#)
- [12 Maintenance Records](#)
- [13 Documents / Resources](#)
 - [13.1 References](#)
- [14 Related Posts](#)

INSTALLATION



Warnings

1. Installation must be carried out by a qualified electrician in accordance with local regulations.
2. Keep the device out of the reach of children.
3. Keep the device away from water , damp or hot environment.
4. Install the device away from strong signal sources such as microwave oven that may cause signal interruption resulted in abnormal operation of the device.
5. Obstruction by concrete wall or metallic materials may reduce the effective operation range of the device and should be avoided.
6. Do NOT attempt to disassemble, repair or modify the device

TECHNICAL SPECIFICATIONS

| | |
|-------------------|--------------------------|
| Product Type | ZigBee+RF Curtain Module |
| V oltag e | 90-250V AC 50/60Hz |
| Current | 2A |
| Max. Power | 500W(250V) |
| Wireless Protocol | ZigBee 3.0 |
| Operation Temp. | -10°C – +40°C |
| Case Temp. | Tc: +80°C (Max.) |
| Operation Range | ≤ 200 m |
| Dims (WxDxH) | 52x47x18 mm |
| IP Rating | IP20 |

EMC Standard (EMC)

EN 300 328 V2.1.1 (2016-11),
EN 301489-1 V2.1.1 (2017-02),
EN 301489-17 V3.1.1 (2017-02),
EN 62311: 2008, EN 55015:2013
+A1:2015, EN 61547:2009

Safety Standard (LVD)

IEC 60669-2-1:2002/AMD1:2008/
AMD2:2015, IEC 60669-1:1998/
AMD1:1999/AMD2:2006,
EN 60669-2-1:2004+A1: 2009+ A2:2010,
EN 60669-1:2018

RoHS Standard (RoHS)

2011/65/EU, (EU) 2015/683

WIRING DIAGRAM

1. With curtain switch

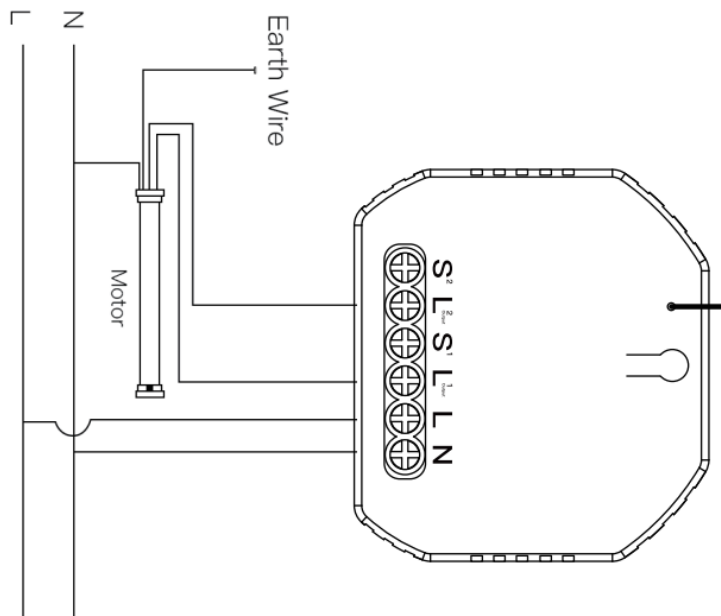

2. Without switch

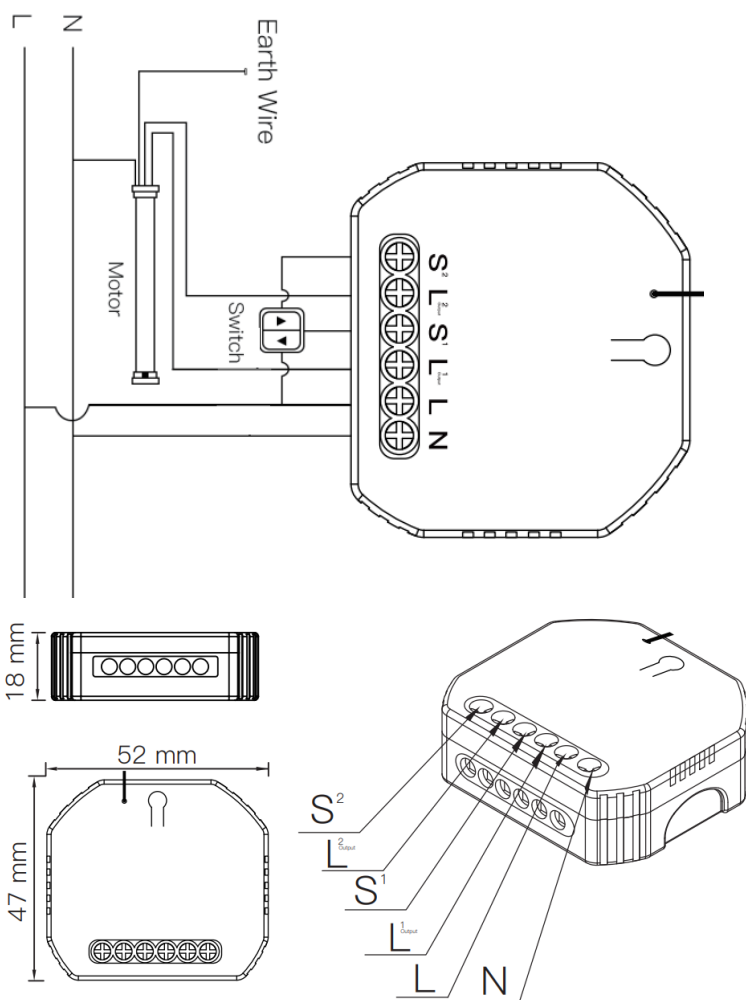

Wiring Instructions and Diagrams

1. Turn off the power supply before carrying out any electrical installation work.
2. Connect wires according to the wiring diagram.
3. Insert the module into the junction box.
4. Connect the power supply and follow curtain switch module configuration instructions.

Notes: Put your smartphone close to the curtain switch module when you're configuring, and make sure you have min. 50% Wi-Fi signal.

FAQ

Q1: Does this work with Google Home?

A: Yes, it does. And it's also compatible with Alexa.

Q2: Do I need to buy a hub to work with the curtain module?

A: Yes, there is need for you to buy a Tuya ZigBee hub.

Q3: Can I control the module with my own remote controller?

A: This curtain switch module (MS-108ZR) is RF433 built in and it can only work with RF433 remote control switch with encoding 1527.

Q4: Shall I buy a smart curtain switch to work with this module?

A: No, you can just connect the module to your traditional curtain switch to realize intelligence.

Q5: What should I do if I can't configure the curtain module?

A: a: Please check whether device is powered on. b: Make sure your mobile and curtain module are under the same 2.4GHz wifi network. c: Whether it's in good internet conditions. d: Make sure the password entered in App is correct. e: Make sure the wiring is correct.

Q6: Which products can I control with the device?

A: Curtains, shutter, blind....

Q7: What happens if the wifi goes off?

A: You can still control the device connected to the curtain module with your traditional curtain switch and once wifi is active again the device connected to the curtain module will connect automatically to your wifi network.

Q8: What should I do if I change the wifi network or change the password?

A: You can connect the module to the wifi network according to the App User Manual.

MANUAL OVERRIDE

The curtain switch module terminal reserves the access of manual override function for the end-user to switch on/off.

- Switch on/off for permanent on/off function.

Notes:

1. Both the adjustment on App and switch can be reset, the last adjustment remains in memory.
2. The App control is synchronized with the manual switch.

APP USER MANUAL



1. Scan the QR code to download Smart Life App, or Scan the QR code to configure the network guide. Method 1
Method 2 you can also search keyword “Smart Life” at App Store or Googleplay to download App.



2. Log in or register your account with your mobile number or e-mail address. Type in the verification code sent to your mobile or mail box, then set your login password. Click “Create Family” to enter into the App.
Scan the QR code to configure the network guide.



(1)

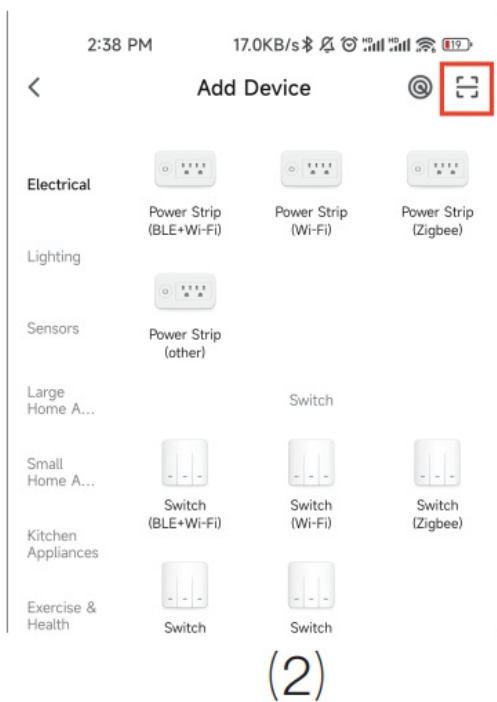

Scan the QR code



Please connect the device according to the configuration process.

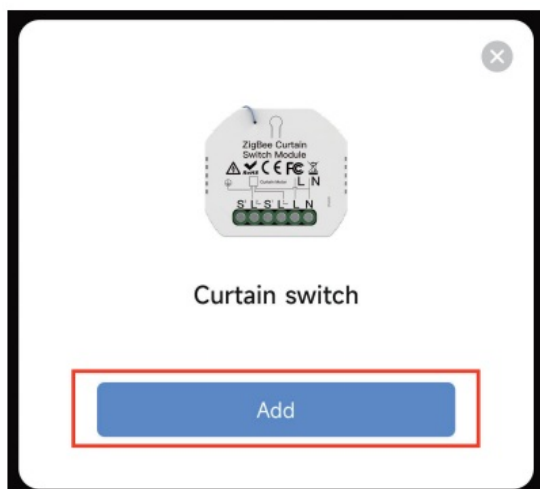

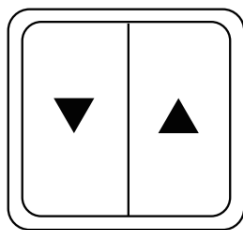
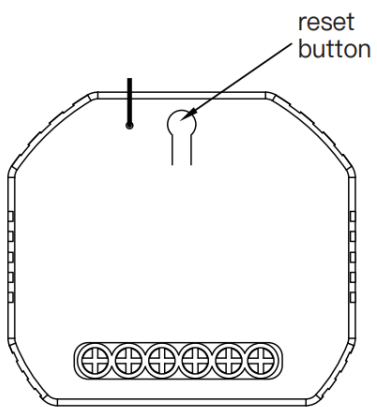

Reset Curtain Switch

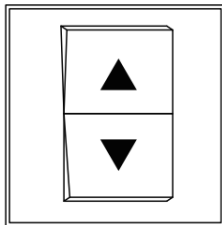

Rocker Curtain switch

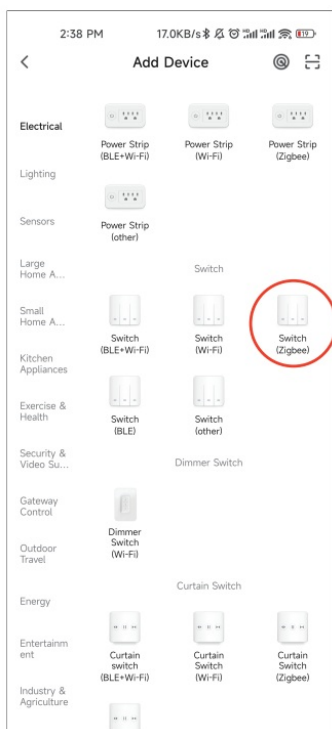

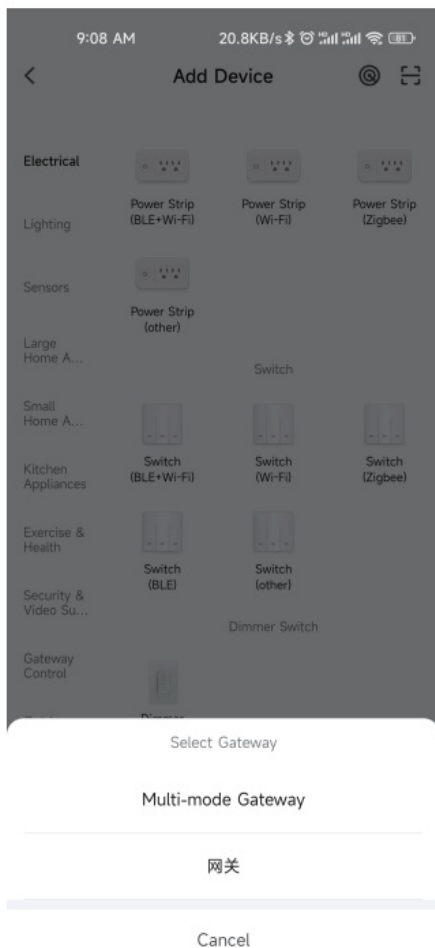

3. Open the App, select “+” on top right, choose “Switch (Zigbee)” to add device. And select the right Gateway to confirm the connection.

Note: Make sure you have successfully connected one Zigbee gateway hub.

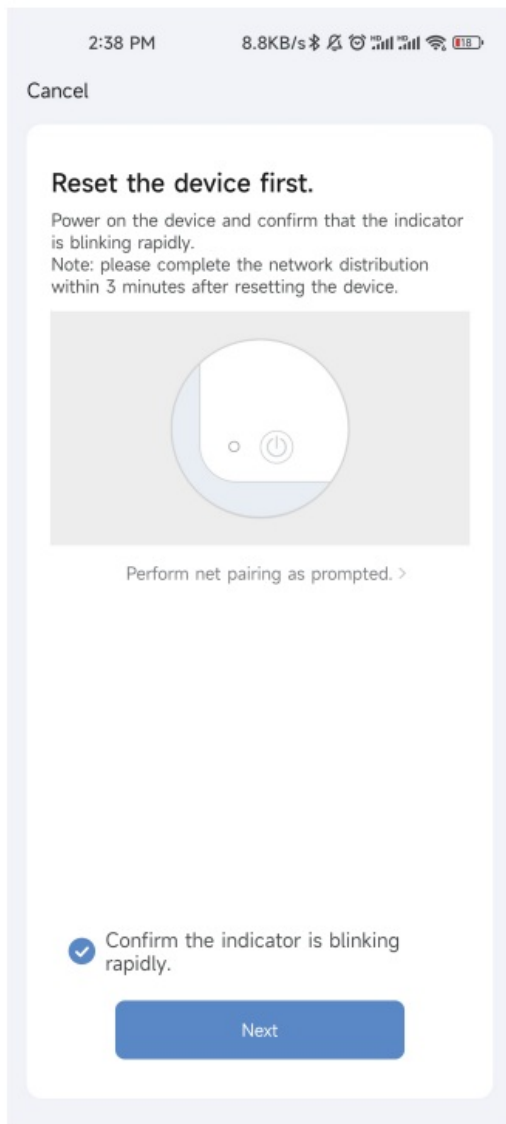

4. Make sure your smart phone and ZigBee switch module are under the same WiFi network at 2.4 GHz connection. Confirm when the beep sounds continuously rapidly (twice a second).

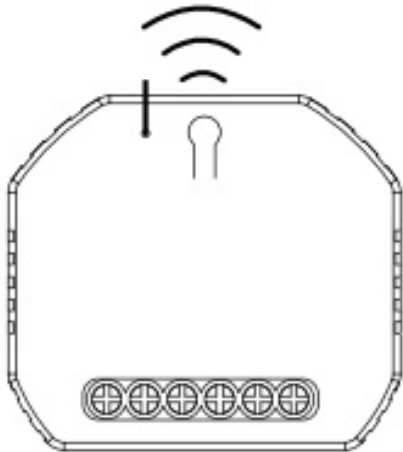
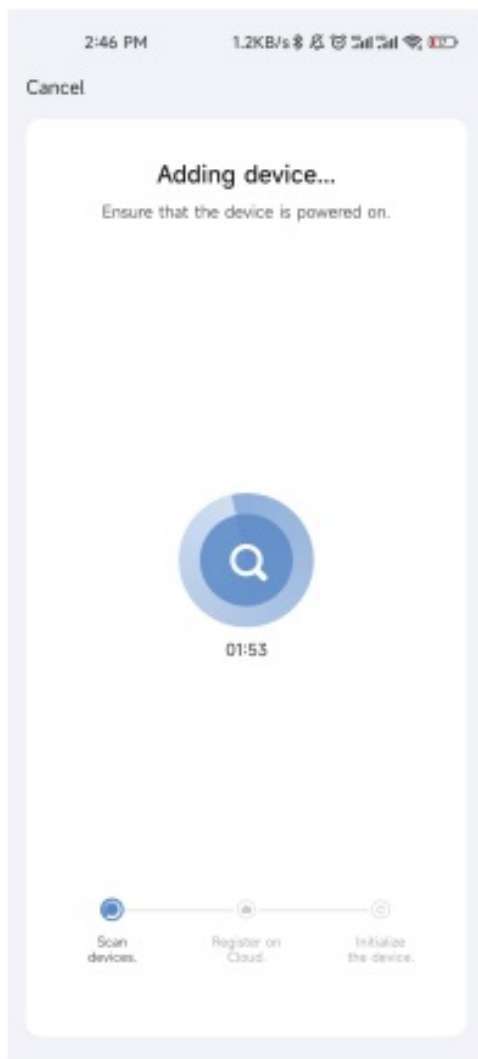

5. The connecting will take about 10-120 seconds to complete depending on your network condition

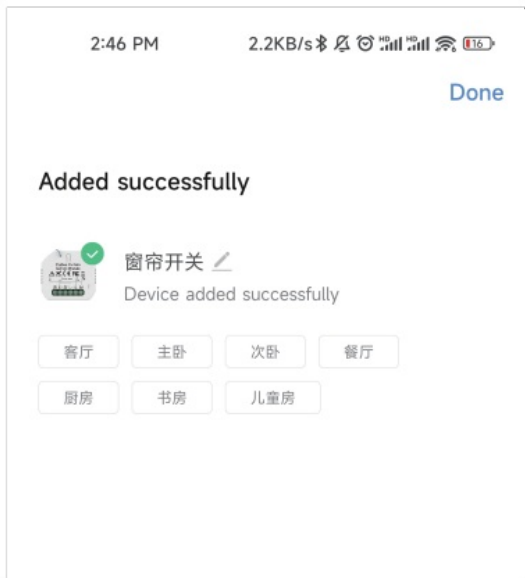

6. When pairing is done, the Zigbee switch will be shown on the App.

Enter Smart Life Skill in Alexa APP

1. Complete product networking configuration in the App

Complete the device's networking configuration according to the prompts in the App.

Note: In the App, change the name of the device to an easily identifiable name such as Alexa; names are usually in English, such as "bed light"

2. figure the Amazon Echo device

(If you have already configured Amazon Echo, you can skip this step. The following instructions are based on the iOS client.)

- Make sure your Amazon Echo device is powered on and connected to a Wi-Fi network.
- Open the Alexa App on your phone. After successful login, tap on the menu in the upper left corner of the Home page, select "Settings" and tap "Set Up A New Device" to set up the Amazon Echo.
- Choose your Amazon Echo device type and language for connecting. Press and hold the small dot on the device until the light turns yellow. Then tap "Continue" to connect to the hotspot.
- After connecting to the Amazon Echo hotspot, return to the page. At this point, the connection is successful.

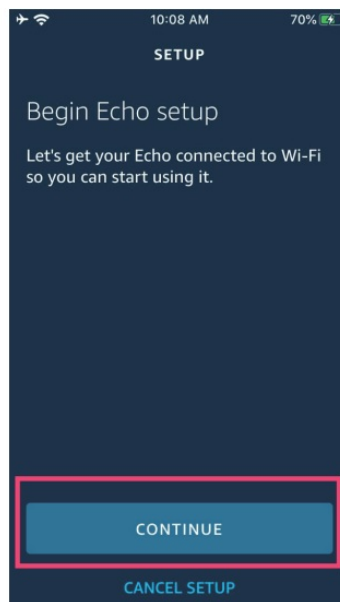
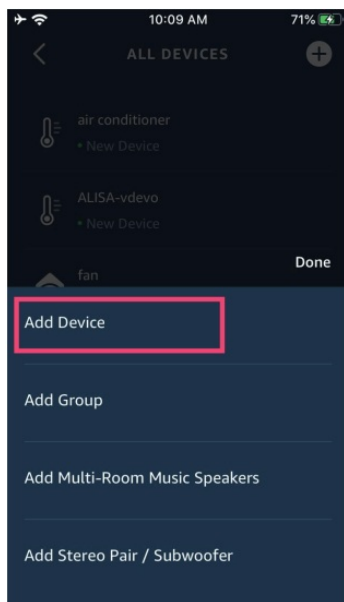

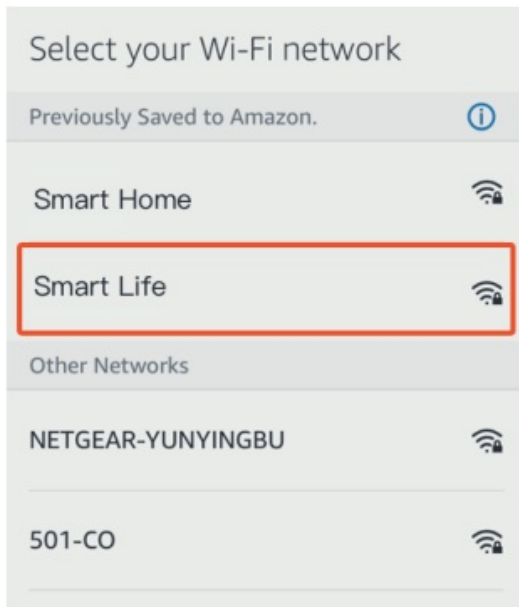

Tap “Continue” to proceed to the next step. Choose a Wi-Fi network to connect to. Amazon Echo will take a few minutes to try to connect to the network.

- After the network connection is successful, tap “Continue”. An introduction video will appear. After the video ends, tap “Continue” to jump to the Alexa Home page. You have now completed the Amazon Echo’s configuration process.

3. Key step —— Link Skill

- Tap on “Skill” in the Alexa App menu

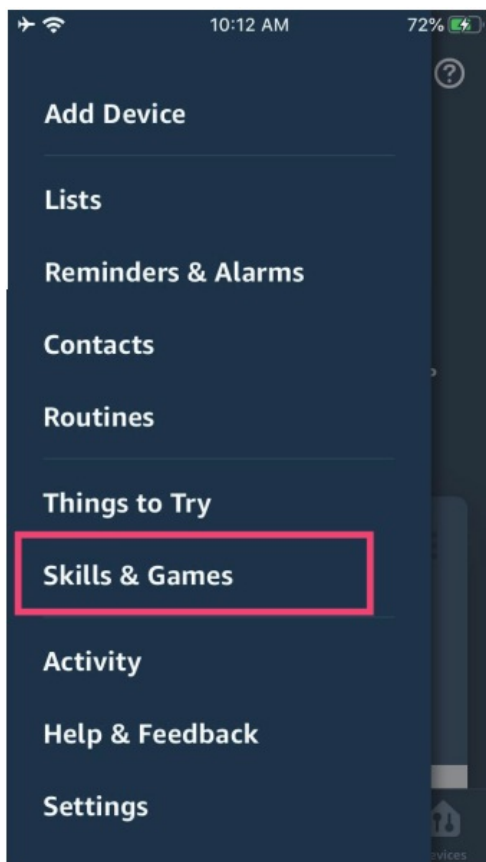

- Then search for “App Name”. Tap “Enable” to enable the Skill.
 - Enter the App account and password, then tap “Link Now” to link your App account to enable the Skill.
- Now you can start your smart home journey

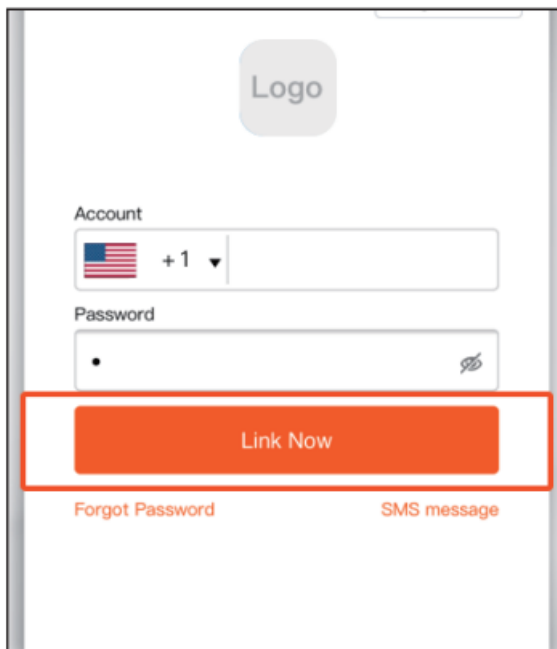
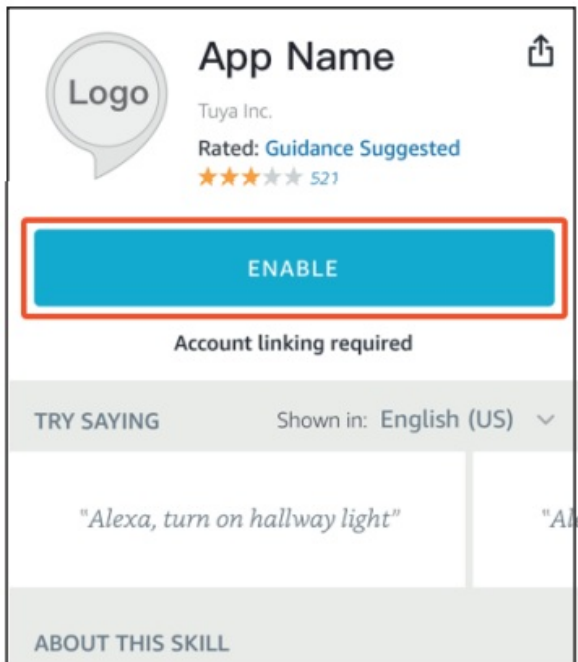

4. Common commands

Control the device via voice commands, now you can control your smart device with Echo. You can control your device (such as your bedroom light) with the following commands:

Alexa, turn on/off bedroom light. (Turn on/off the light)

Alexa, set bedroom light to 50 percent. (Set the light to any brightness)

Alexa, brighten/dim bedroom light. (Increase/weaken the brightness of the light)

Alexa, set bedroom light to green. (Adjust the color of the light)

RF Link Method

1. Press the reset button for 5 times and wait for 2 seconds until the red indicator flashes fast to pair with the open button.
2. Press the reset button for 6 times and wait for 2 seconds until the red indicator flashes fast to pair with the close button.
3. Press the reset button for 7 times and wait for 2 seconds until the red indicator flashes fast to pair with the stop

button.

Reset Method

1. Press the reset button for more than 7 seconds to start to reset of Wi-Fi method.
2. Press the reset button for 10 times for clearing mode of RF.

SERVICE

1. During the free warranty period, if the product breaks down during normal use, we will offer free maintenance for the product.
2. Natural disasters/man-made equipment failures, disassembly and repair without the permission of our company, no warranty card, products beyond the free warranty period, etc., are not within the scope of free warranty
3. Any commitment (oral or written) made by the third party (including the dealer/service provider) to the user beyond the warranty scope shall be executed by the third party
4. Please keep this warranty card to ensure your rights
5. Our company may update or change the products without notice. Please refer to the official website for the updates

RECYCLING INFORMATION

All products marked with the symbol for separate collection of waste electrical and electronic equipment (WEEE Directive 2012/19 / EU) must be disposed of separately from unsorted municipal waste. To protect your health and the environment, this equipment must be disposed of at designated collection points for electrical and electronic



 equipment designated by the government or local authorities.

Correct disposal and recycling will help prevent potential negative consequences for the environment and human health. To find out where these collection points are and how they work, contact the installer or your local authority

WARRANTY CARD

Product Information

Product Name _____
Product Type _____
Purchase Date _____
Warranty Period _____
Dealer Information _____
Customer's Name _____
Customer Phone _____
Customer Address _____

Maintenance Records

| Failure date | Cause Of Issue | Fault Content | Principal |
|--------------|----------------|---------------|-----------|
| | | | |
| | | | |
| | | | |
| | | | |

Thank you for your support and purchase at we Moes, we are always here for your complete satisfaction, just feel free to share your great shopping experience with us.

If you have any other need, please do not hesitate to contact us first, we will try to meet your demand.



@moessmart



@moes_smart



@moes_smart



MOES.Official



@moes_smart



www.moeshouse.com



WENZHOU NOVA NEW ENERGY CO.,LTD

Address: Power Science and Technology

Innovation Center, NO.238, Wei 11 Road,

Yueqing Economic Development Zone,

Yueqing, Zhejiang, China

Tel:+86-577-57186815

Email:service@moeshouse.com

AMZLAB GmbH

Laubenhof 23, 45326 Essen

Made In China

Documents / Resources



[MOES MS-108ZR Smart Curtain Switch Module](#) [pdf] Instruction Manual

MS-108ZR Smart Curtain Switch Module, MS-108ZR, Smart Curtain Switch Module, Curtain Switch Module, Switch Module

References

-  [MOES Smart WiFi ZigBee Smart 2/3 Way Switch Socket Thermostat Sensor](#)