



Moes MS-108 Smart Curtain Switch Module Instruction Manual

[Home](#) » [MOES](#) » Moes MS-108 Smart Curtain Switch Module Instruction Manual 

Moes MS-108 Smart Curtain Switch Module Instruction Manual



Contents

1 INSTRUCTION

2 Inhouse local operation

3 INSTALLATION

4 TECHNICAL SPECIFICATIONS

5 WIRING DIAGRAM

6 FAQ

7 Q1:Does this work with Google Home?

8 Q2:Do I need to buy a hub to work with the curtain module

9 Q3:Can I control the module with my own remote controller?

10 Q4:Shall I buy a smart curtain switch to work with this module?

11 Q5:What should I do if I can't configure the curtain module?

12 Q6:Which products can I control with the device?

13 Q7:What happens if the wifi goes off?

14 Q8:What should I do if I change the wifi network or change the password?

14.1 MANUAL OVERRIDE

14.2 Preparation for use

14.3 RF Link Method (only for MS-108WR)

14.3.1 Enter Smart Life Skill in Alexa APP

14.4 SERVICE

14.5 RECYCLING INFORMATION

14.6 WARRANTY CARD

14.7 Documents / Resources

14.7.1 References

INSTRUCTION

Global international operation Whenever & Wherever You are,All-in-one Mobile App

- Schedule timer



- Voice control-work with Google Home

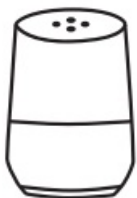

- Voice control-work with Amazon Alexa

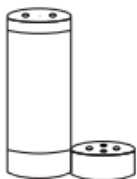

- Device Sharing



Inhouse local operation

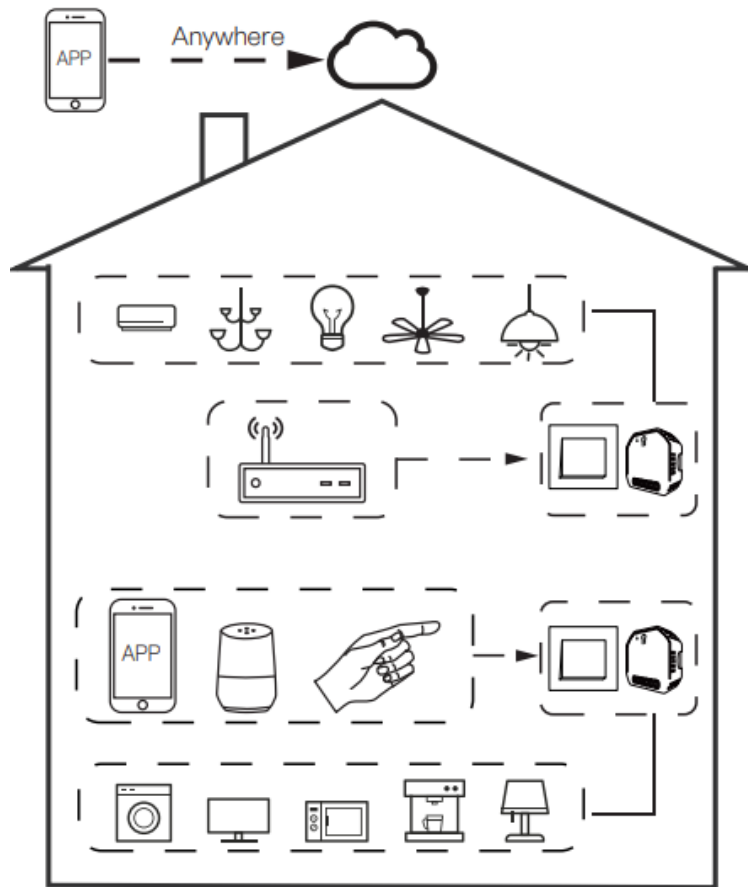

- App

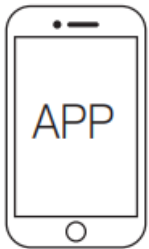

- Router



- Voice control



- Reset Curtain Switch

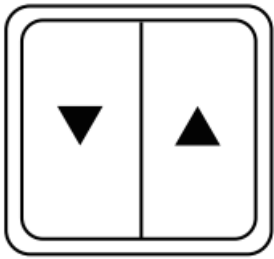

Note: Press the traditional curtain switch once after switch to up/down (on the same button) to stop the curtains (connect your switch to the curtain module first).

Reset Curtain Switch

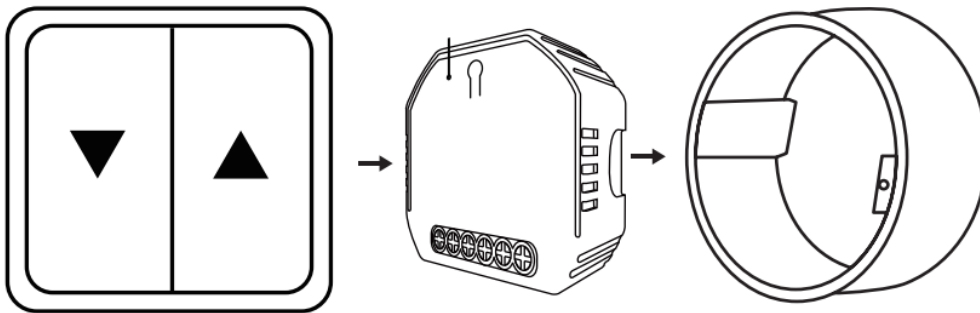

Reset Curtain Switch

Step 1

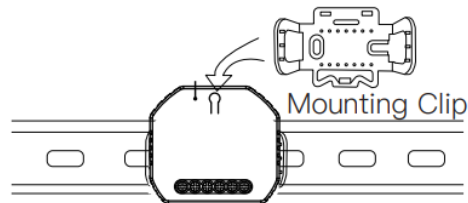

- Turn off the circuit breaker and use the electrical tester to test the power.
- Ensure the circuit breaker is off before wiring



⚠ Attention:

Please disconnect the power supply before installing or removing the device for avoiding irreversible damage on the device from the electric current or some unpredictable problems such as lamp flashing.

Step 2

- Remove the old switch

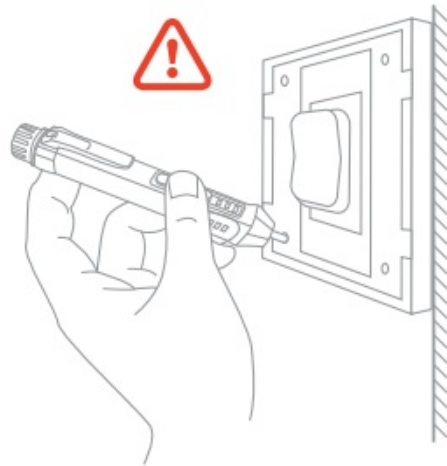
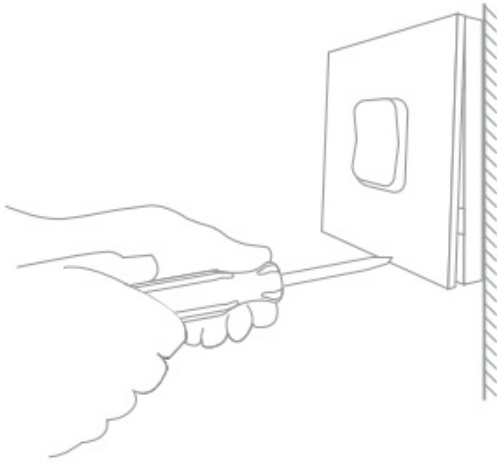

Step 3

- Remove the switch and pull it away from the wall .Identify Line/Load Wire(**Note:** The color of your wire may be different from the color shown on the manual.)



Verify power is off

- We recommend you remove the faceplate from the old switch and use an electrical tester to test all wires connected to the switch to ensure there is no voltage in the circuit.
- You may need to turn off more than one circuit breaker.

INSTALLATION



Warnings

1. Installation must be carried out by a qualified electrician in accordance with local regulations.
2. Keep the device out of the reach of children.
3. Keep the device away from water , damp or hot environment.
4. Install the device away from strong signal sources such as microwave oven that may cause signal interruption resulted in abnormal operation of the device.

5. Obstruction by concrete wall or metallic materials may reduce the effective operation range of the device and should be avoided.
6. Do NOT attempt to disassemble, repair or modify the device.

TECHNICAL SPECIFICATIONS

Product Type	Smart Curtain Switch Module
Voltage	90-250V AC 50/60Hz
Current	2A
Max. Power	500W(250V
Wireless Protocol	Wi-Fi 2.4GHz IEEE 802.11 b/g/n
Operation Temp.	-10°C – +40°C
Case Temp.	Tc: +80°C (Max.)
Operation Range	≤ 200 m
Dims (WxDxH)	52x47x18 mm
IP Rating	IP20

EMC Standard (EMC)

EN 300 328 V2.1.1 (2016-11),
 EN 301489-1 V2.1.1 (2017-02),
 EN 301489-17 V3.1.1 (2017-02),
 EN 62311: 2008, EN 55015:2013
 +A1:2015, EN 61547:2009

Safety Standard (LVD)

IEC 60669-2-1:2002/AMD1:2008/
 AMD2:2015, IEC 60669-1:1998/
 AMD1:1999/AMD2:2006,
 EN 60669-2-1:2004+A1: 2009+ A2:2010,
 EN 60669-1:2018

RoHS Standard (RoHS)

2011/65/EU, (EU) 2015/683

WIRING DIAGRAM

1. With curtain switch

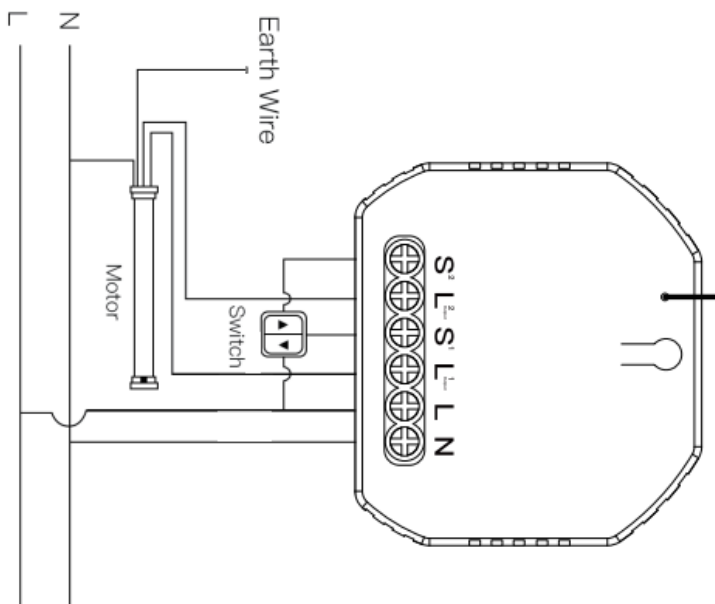

2. Without switch

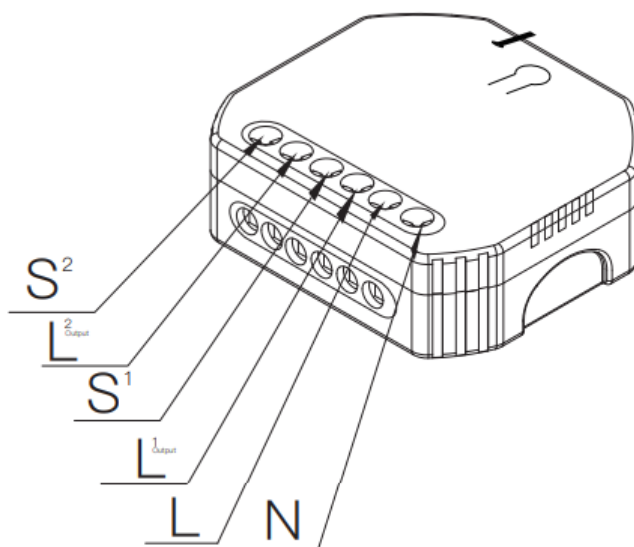
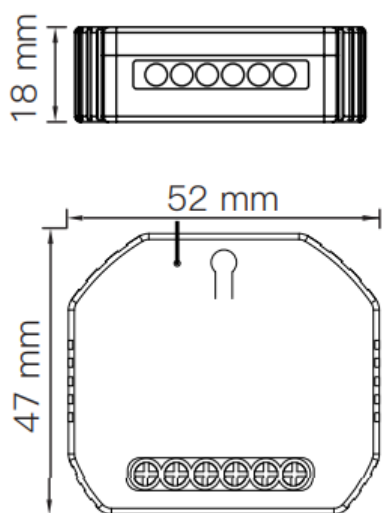
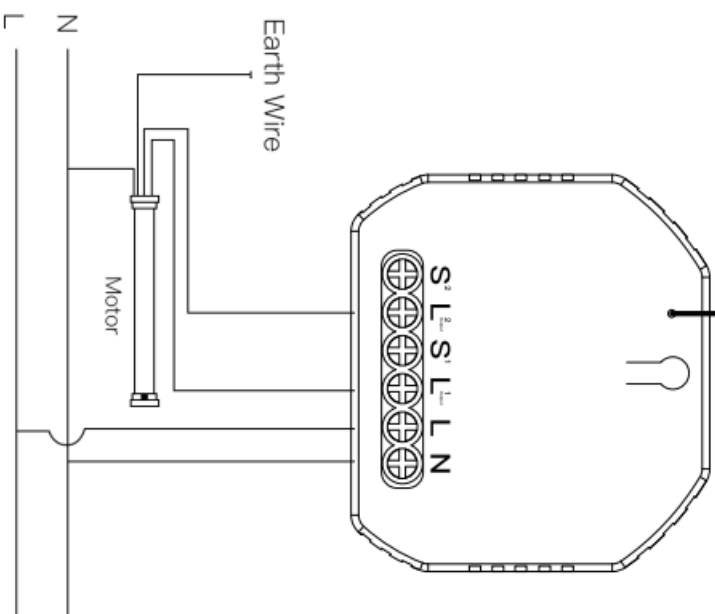

1. Turn off the power supply before carrying out any electrical installation work.
2. Connect wires according to the wiring diagram.
3. Insert the module into the junction box.
4. Connect the power supply and follow curtain switch module configuration instructions.

Notes

Put your smartphone close to the curtain switch module when you're configuring, and make sure you have min. 50% Wi-Fi signal.

FAQ

Q1:Does this work with Google Home?

A: Yes,it does.And it's also compatible with Alexa

Q2:Do I need to buy a hub to work with the curtain module

A: No,there is no need for you to buy a hub and no hub required for the module.

Q3:Can I control the module with my own remote controller?

A:This curtain switch module(MS-108WR) is RF433 built in and it can only work with RF433 remote control switch with encoding 1527

Q4:Shall I buy a smart curtain switch to work with this module?

A:No,you can just connect the module to your traditional curtain switch to realize intelligence.

Q5:What should I do if I can't configure the curtain module?

A: a:Please check whether device is powered on. b:Make sure your mobile and curtain module are under the same 2.4GHz wifi network. c:Whether it's in good internet conditions. d:Make sure the password entered in App is correct. e:Make sure the wiring is correct.

Q6:Which products can I control with the device?

A:Curtains,shutter,blind.

Q7:What happens if the wifi goes off?

A:You can still control the device connected to the curtain module with your traditional curtain switch and once wifi is active again the device connected to the curtain module will connect automatically to your wifi network.

—
Q8:What should I do if I change the wifi network or change the password?

A:You can connect the module to the wifi network according to the App User Manual.

MANUAL OVERRIDE

The curtain switch module terminal reserves the access of manual override function for the end-user to switch on/off.

- Switch on/off for permanent on/off function.

Notes

1. Both the adjustment on App and switch can be reset , the last adjustment remains in memory.
2. The App control is synchronized with the manual switch.

Preparation for use



Please scan the QR code or download Smart Life on App store.

1. Scan the QR code to download Smart Life App, or you can also search keyword “Smart Life” at AppStore or Googleplay to download App.
2. Log in to the App or create a new account.



Enter the Register/Login interface; tap “Register” to create an account by entering your phone number to get verification code and “Set password”. Choose “Log in” if you already have a Smart Life account.

Steps for connecting the APP to the device

Method One:

1. Make sure your phone is connected to Wi-Fi and Bluetooth.

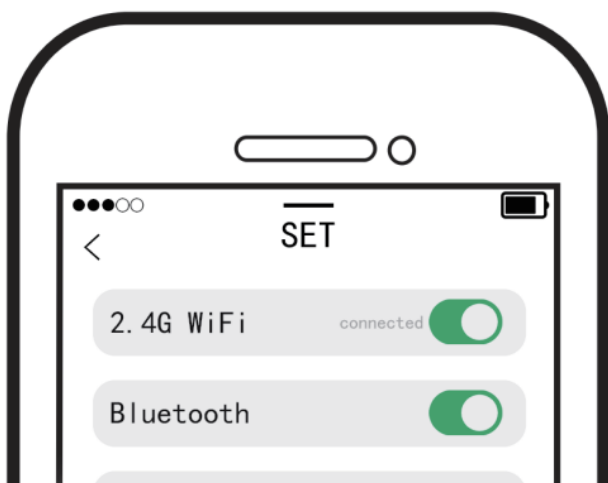

2. Scan the QR code to configure the network guide.

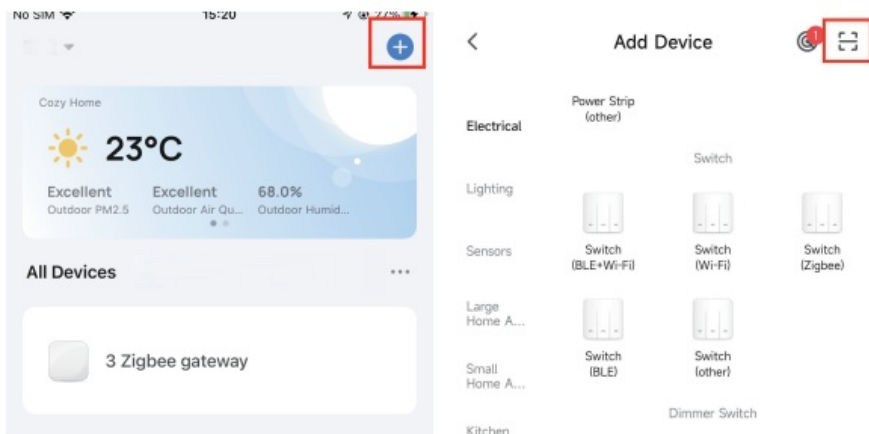

Scan this QR code



Add

Method Two:

1. Make sure your phone is connected to Wi-Fi and Bluetooth.

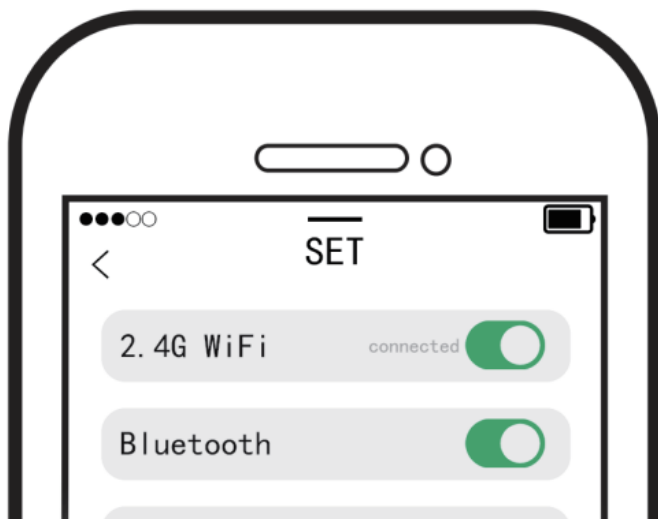

2. **Reset:** Press the reset button for more than 7 seconds until the beep sounds continuously rapidly as Di-Di-Di...

for entering into Wi-Fi pairing mode.

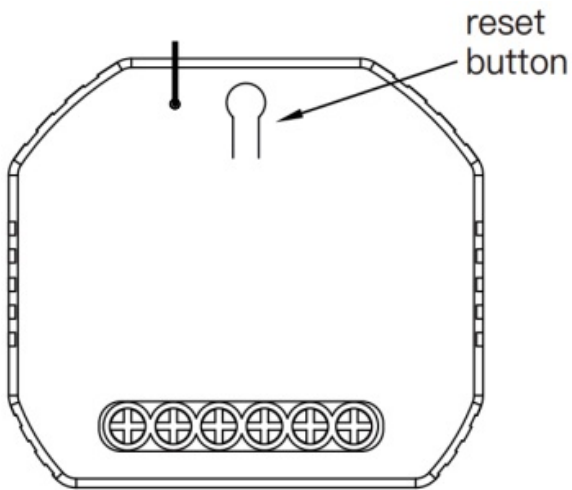

3. Open Smart Life/Tuya App, then the prompt page will automatically show on the screen. Click “Add”, Select the device you want to add and click “+”.

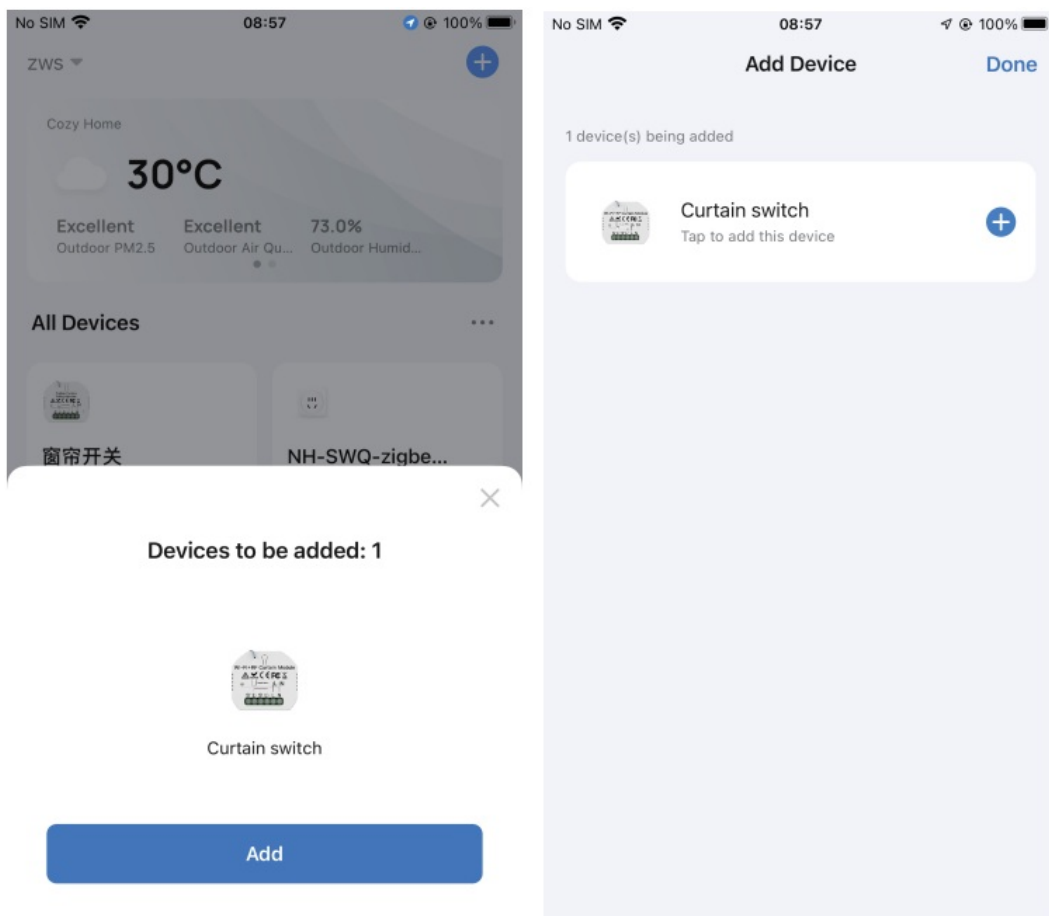

4. Enter Wi-Fi Password and click “Next”, waiting for completing the connection. Add the device successfully, you can edit the name of the device to enter the device page by click “Done” .

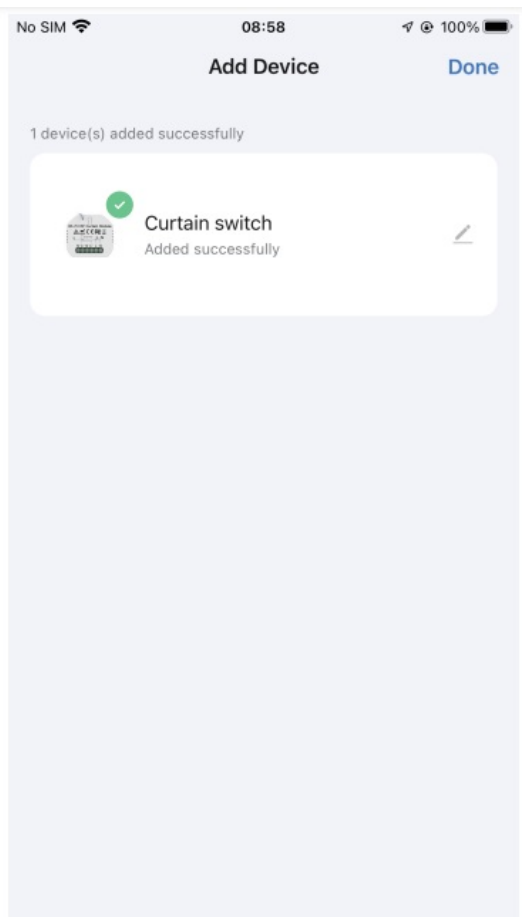
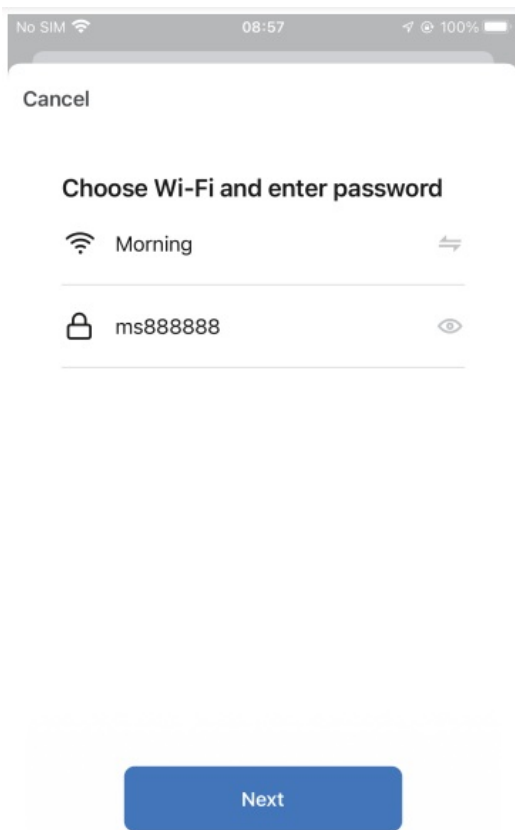

5. enjoy your smart life with home automation

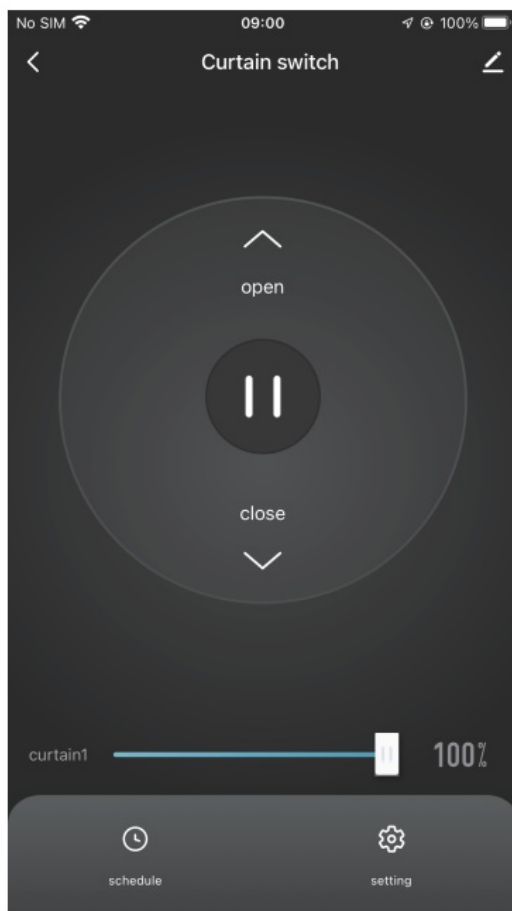
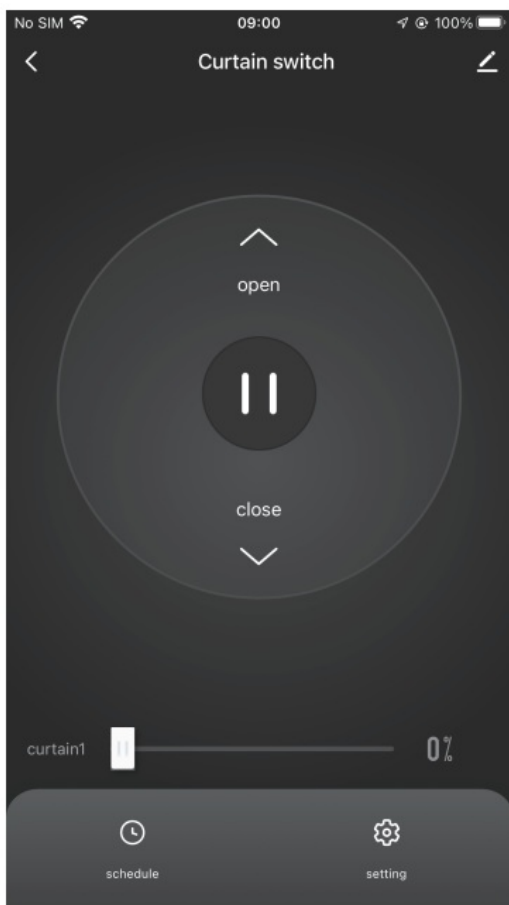

RF Link Method (only for MS-108WR)

1. Press the reset button for 5 times and wait for 2 seconds until the red indicator flashes fast to pair with the open button.
2. Press the reset button for 6 times and wait for 2 seconds until the red indicator flashes fast to pair with the close button.
3. Press the reset button for 7 times and wait for 2 seconds until the red indicator flashes fast to pair with the stop button.

Reset Method

1. Press the reset button for more than 7 seconds to start to reset of Wi-Fi method.
2. Press the reset button for 10 times for clearing mode of RF.

Enter Smart Life Skill in Alexa APP

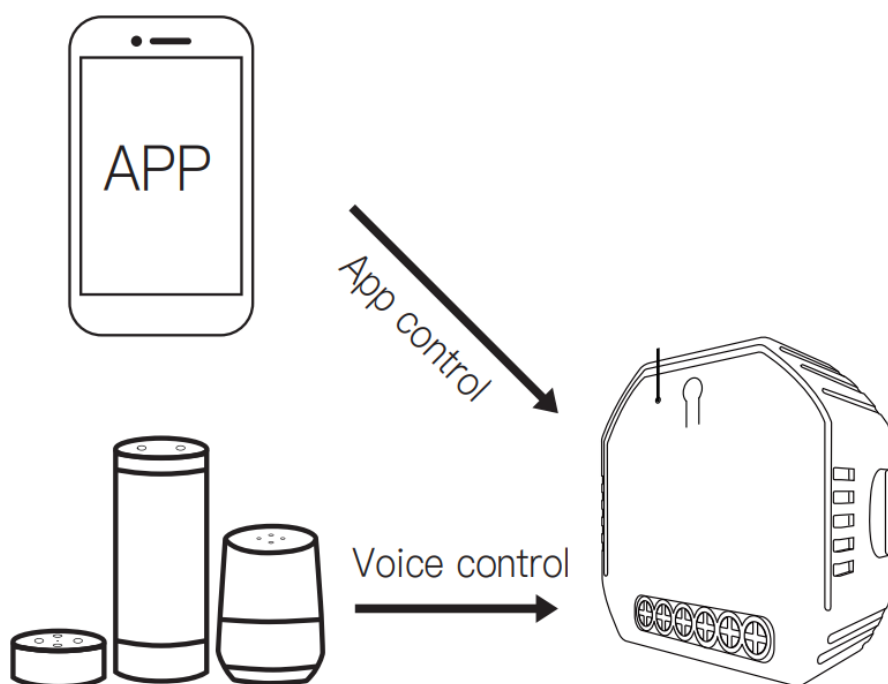

Enjoy your smart life of home automation for intelligent control by using our All-in-one mobile App wherever you are in the world or simply by voice control when you are sitting at home comfortably.

1. Complete product networking configuration in the App

Complete the device's networking configuration according to the prompts in the App. Note: In the App, change the name of the device to an easily identifiable name such as Alexa; names are usually in English, such as "bed light".

2. Configure the Amazon Echo device

Note: If you have already configured Amazon Echo, you can skip this step. The following instructions are based on the iOS client.

1. Make sure your Amazon Echo device is powered on and connected to a Wi-Fi network.
2. Open the Alexa APP on your phone and log in
3. tap on the menu in the upper left corner of the Home page, select "Settings" and tap "Set Up A New Device" to set up the Amazon Echo.
4. Choose your Amazon Echo device type and language for connecting.

5. Press and hold the small dot on the device until the light turns yellow.
6. Click "Continue" to connect to the hotspot, connect to the Amazon Echo hotspot, and return to the APP page.
7. Click "Continue" to find and connect to your home Wi-Fi network.
8. Amazon Echo will take a few minutes to try to connect to the network.
9. After the network connection is successful, tap "Continue". An introduction video will appear. After the video ends tap "Continue" to jump to the Alexa Home page.
10. You have now completed the Amazon Echo's configuration process.

3. Key step —— Link Skill

1. Tap on "Skills" in the Alexa App menu.
2. Then search for "App Name". Tap "Enable" to enable the Skill.
3. Enter the App account and password, then tap "Link Now" to link your App account to enable the Skill.

Now you can start your smart home journey.

4. Common commands

Control the device via voice commands, now you can control your smart device with Echo. You can control your device (such as your bedroom light) with the following commands:

- Alexa, open the "
- "Alexa, close the "
- "Alexa, pause "
- "Alexa, resume "
- "Alexa, set the to thirty percent
- Alexa, increase by ten percent."
- Alexa, decrease by twenty percent.

SERVICE

1. During the free warranty period, if the product breaks down during normal use, we will offer free maintenance for the product.
2. Natural disasters/man-made equipment failures, disassembly and repair without the permission of our company, no warranty card, products beyond the free warranty period, etc., are not within the scope of free warranty
3. Any commitment (oral or written) made by the third party (including the dealer/service provider) to the user beyond the warranty scope shall be executed by the third party
4. Please keep this warranty card to ensure your rights
5. Our company may update or change the products without notice. Please refer to the official website for the updates.

RECYCLING INFORMATION



All products marked with the symbol for separate collection of waste electrical and electronic equipment (WEEE Directive 2012/19 / EU) must be disposed of separately from unsorted municipal waste. To protect your health and the environment, this equipment must be disposed of at designated collection points for electrical and electronic equipment designated by the government or local authorities. Correct disposal and recycling will help prevent potential negative consequences for the environment and human health. To find out where these collection points are and how they work, contact the installer or your local authority.

WARRANTY CARD

Product Information

Product Name: _____

Product Type: _____

Purchase Date: _____

Warranty Period: _____

Dealer Information: _____

Customer's Name: _____



Customer Phone: _____

Customer Address: _____

Maintenance Records

Failure date	Cause Of Issue	Fault Content	Principal

Documents / Resources

	Moes MS-108 Smart Curtain Switch Module [pdf] Instruction Manual MS-108, Wi-Fi, MS-108WR, Wi-Fi RF433, MS-108 Smart Curtain Switch Module, MS-108, Smart Curtain Switch Module, Curtain Switch Module, Switch Module, Module
	MOES MS-108 Smart Curtain Switch Module [pdf] Instruction Manual MS-108, MS-108WR, MS-108 Smart Curtain Switch Module, Smart Curtain Switch Module, Curtain Switch Module, Switch Module

References

- 
[MOES Smart: Create Your Smart Life With Smart Home Devices](#)