



Moes BT-B-EU1-MS Scene Switch User Manual

[Home](#) » [MOES](#) » Moes BT-B-EU1-MS Scene Switch User Manual 

*Moes BT-B-EU1-MS Scene Switch
User Manual*

Scene Switch

User Manual

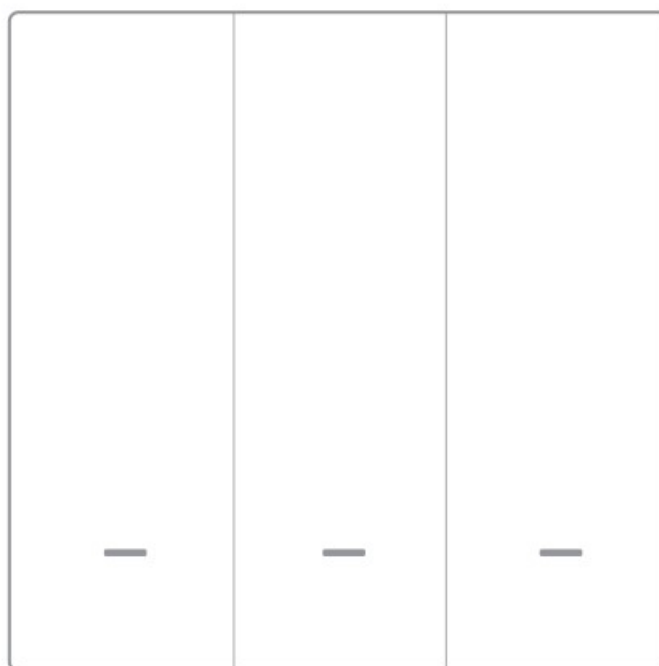

Contents

- 1 Product Introduction
- 2 Scene Switch with Your Smart Home
- 3 Specification
- 4 Installation
- 5 Fix it as Where as You Want
- 6 Connection and Operation
- 7 APP Operation
- 8 SERVICE
- 9 RECYCLING INFORMATION
- 10 WARRANTY CARD
- 11 Documents / Resources
 - 11.1 References

Product Introduction



- This Scene Switch is powered by battery, which is developed under ZigBee/BLE communication. After connecting with ZigBee/BLE gateway and adding into Smart life App, it allows you to quickly “set the scene” for a particular room or living scene, like Reading, Movie, and so on.
- Scene Switch is a time and energy-saving item alternative to the traditional hard-wired switch, with push button design. It can be stick on the wall or put it on everywhere you like.

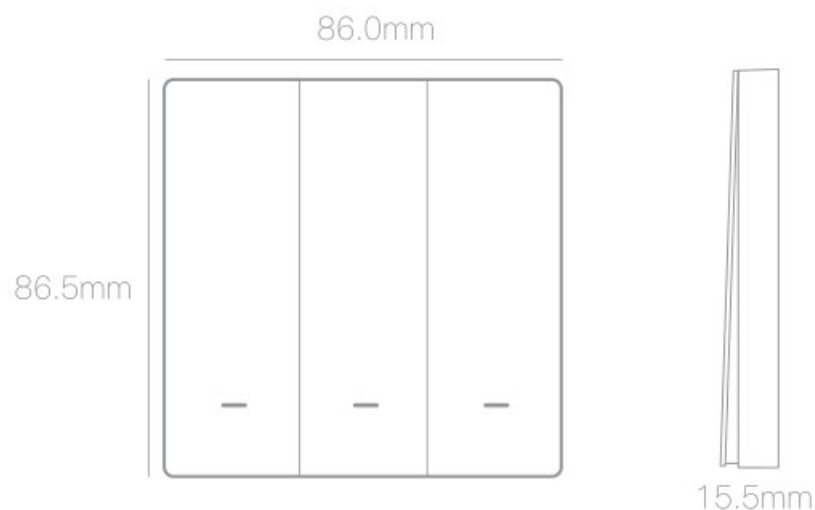

Scene Switch with Your Smart Home

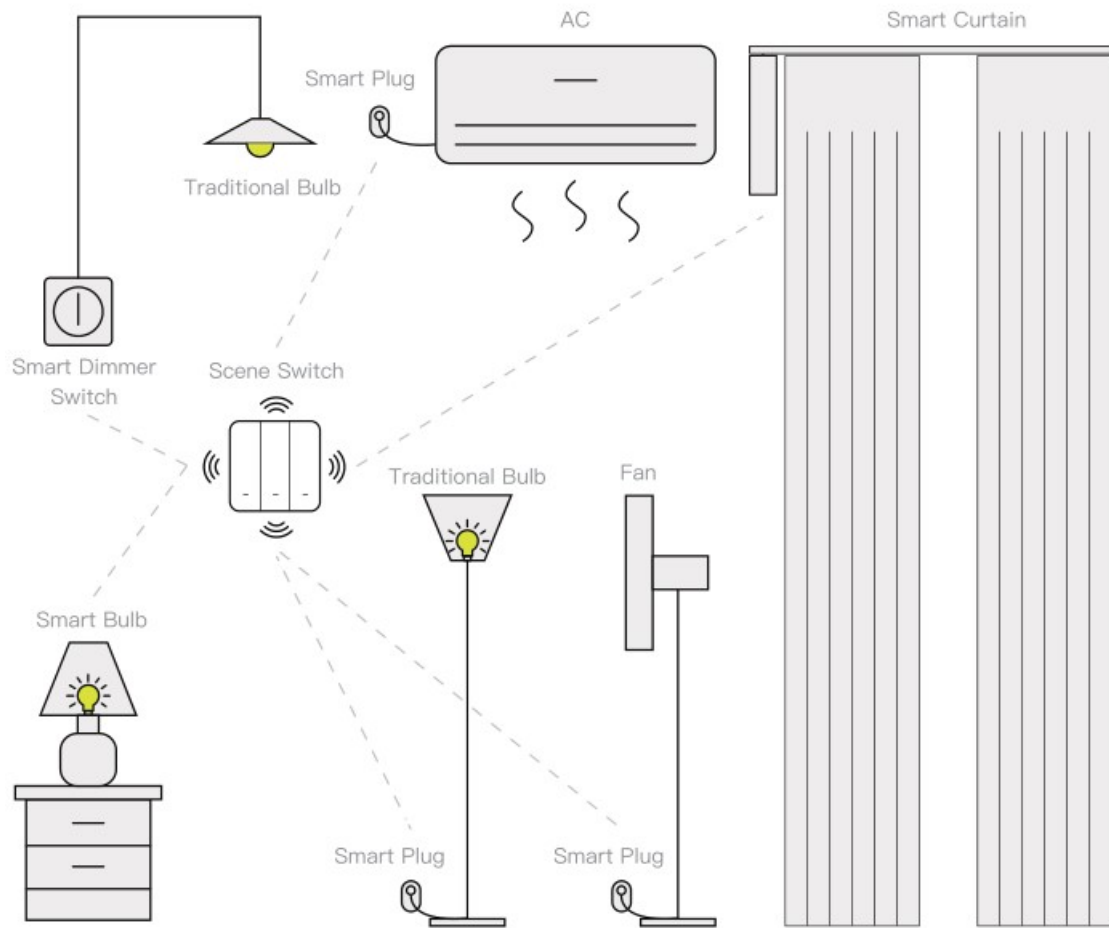

Specification

Input Power:	CR 2032 button battery
Communication:	ZigBee 3.0 /BLE
Dimension:	86*86.5*15.5mm
Standby current:	10uA
Working Temperature:	-10°C~45°C
Working Humidity:	<90%RH
Button lifecycle:	500K

Installation

Open the cover then put the button battery in the battery slot. Press the button on the switch, the indicator will turn on, it means that the switch works correctly.

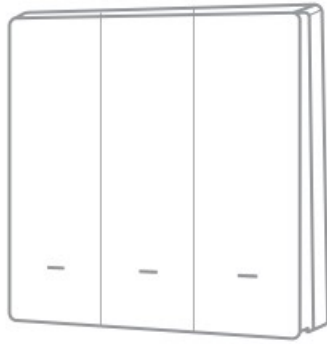

- ① Pry open switch backplane

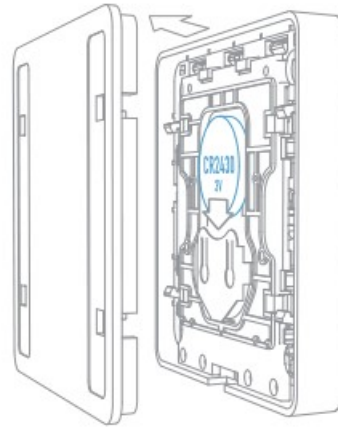

- ② Open the cover then put the button battery in the battery slot.

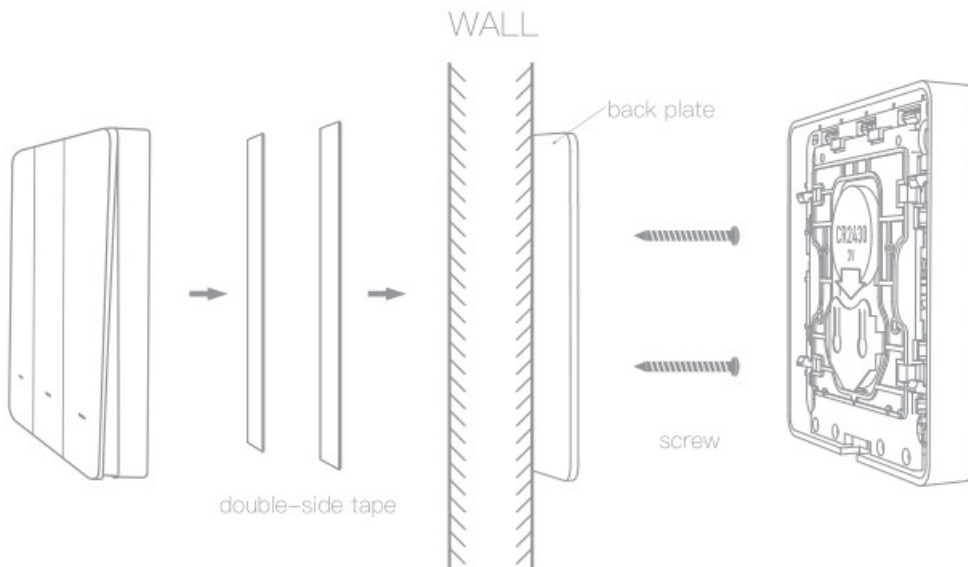

Method 1:

Clean the walls with a cloth, then blow dry them. Use double-sided tape on the back of the scene switch and then stick it on the wall.

Method 2:

First remove the bottom plate of the scene switch, fix it on the wall with screws, and then cover the panel.

Fix it as Where as You Want

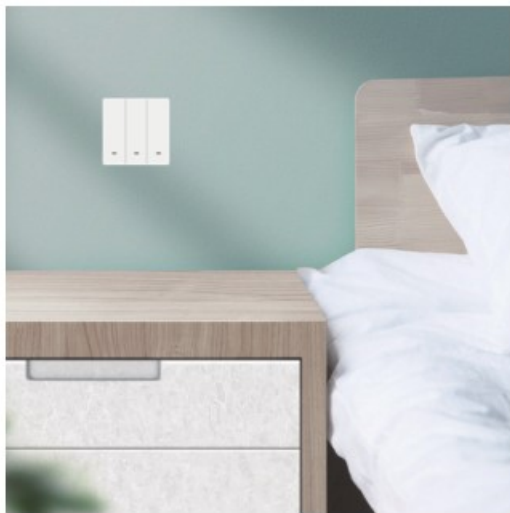

Bedroom

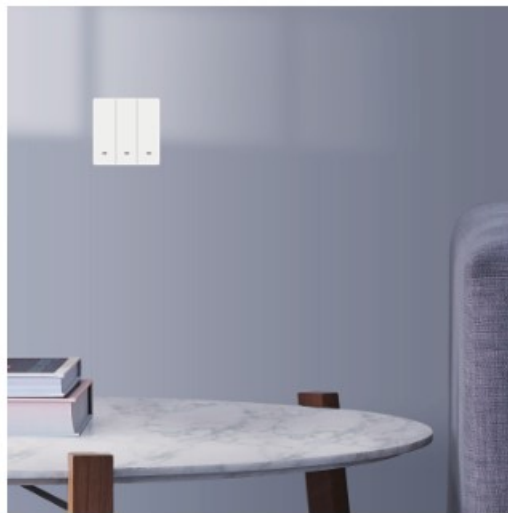

Living Room



Kitchen



Bathroom

Connection and Operation

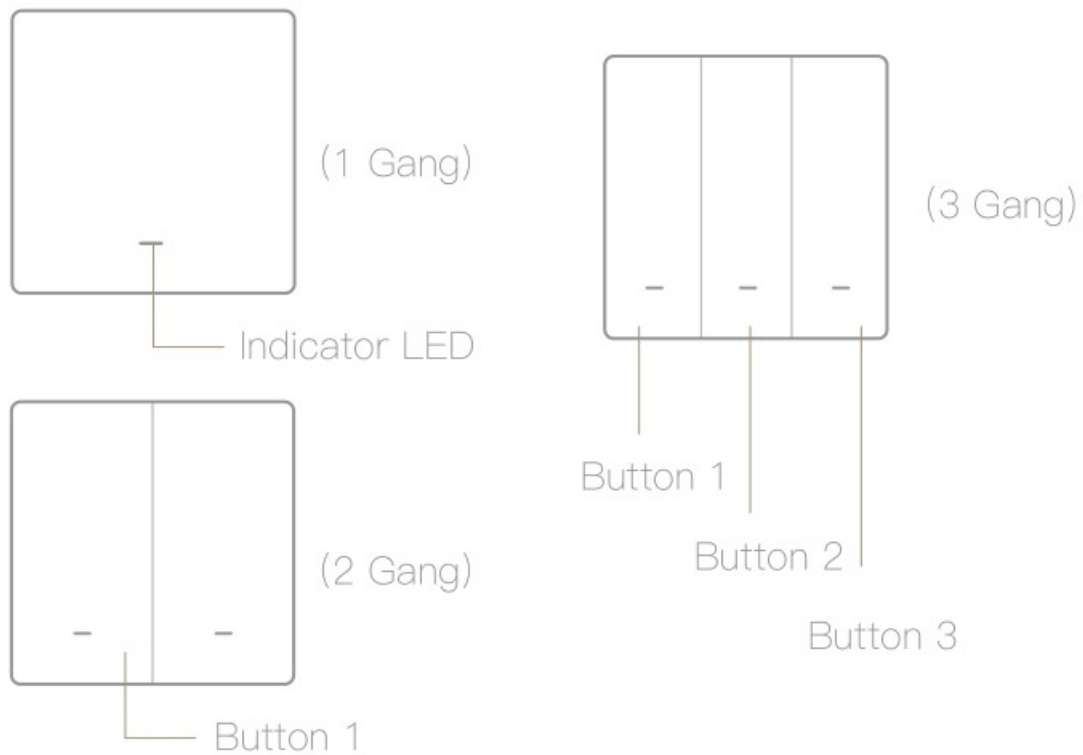

Indicator LED

Long press the button, the indicator will turn on.

The indicator flash quickly, it means that the switch under process of network connecting.

Scene Switch Operate: Each one button can be adapted upto three different scenarios through the APP.

(Single Click) : Activate the 1st scene

(Double Click) : Activate the 2nd scene

Long Hold 5s: Activate the 3rd scene

Press and Hold button 1 for 10s get into pair mode, LEDs will quick flash

APP Operation

1.Search the App in the store or scan the QR code on the package/ manual to download and install the App.



Please scan the QR code or download Smart Life on App store.

2. Register and login

If you download for the first time, please click the “register” button to register your account. If you have an account, click the “login” button.

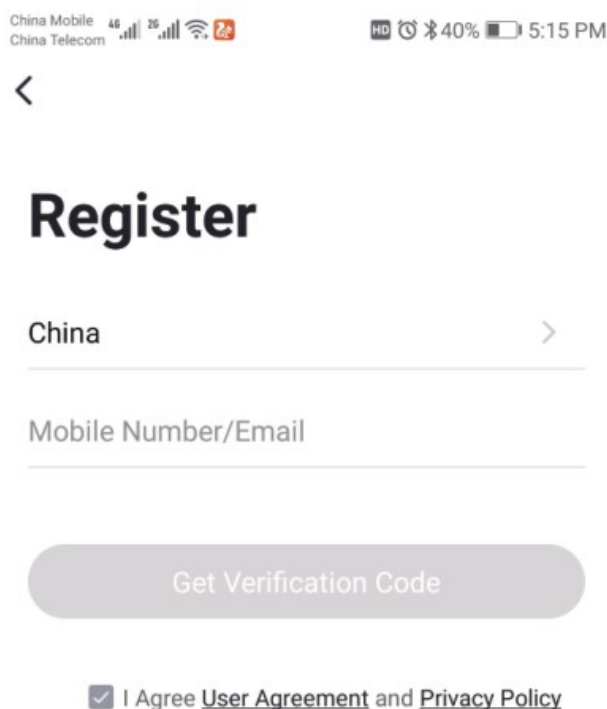

China Mobile 4G 2G China Telecom 40% 5:15 PM

<

Register

China >

Mobile Number/Email

Get Verification Code

☒ I Agree [User Agreement](#) and [Privacy Policy](#)

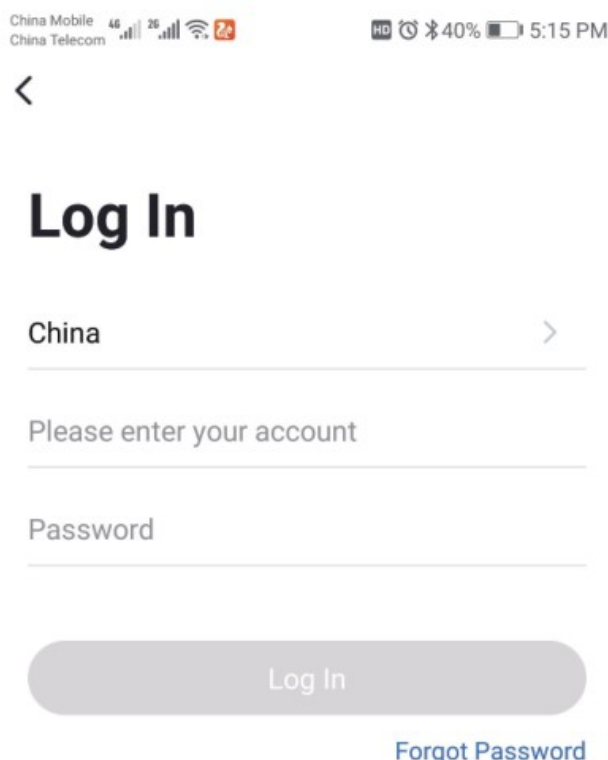

China Mobile 4G 2G China Telecom 40% 5:15 PM

<

Log In

China >

Please enter your account

Password

Log In

[Forgot Password](#)



Login means that you agree with [User Agreement](#) and [Privacy Policy](#)

3. Add devices

Note: Intelligent gateway needs to be added before adding devices. Connect the device to the power supply, press and hold the first button to put the device into the network configuration mode, and ensure that the mobile phone is connected to the same network. Open the app, on the “smart gateway” page, click “add subdevice”, and click “LED already blink”.

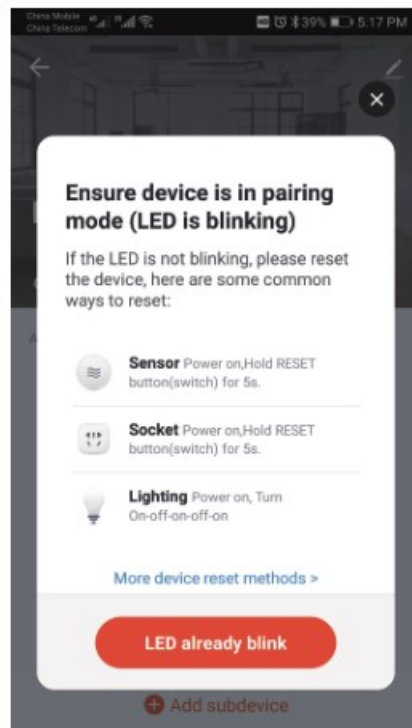
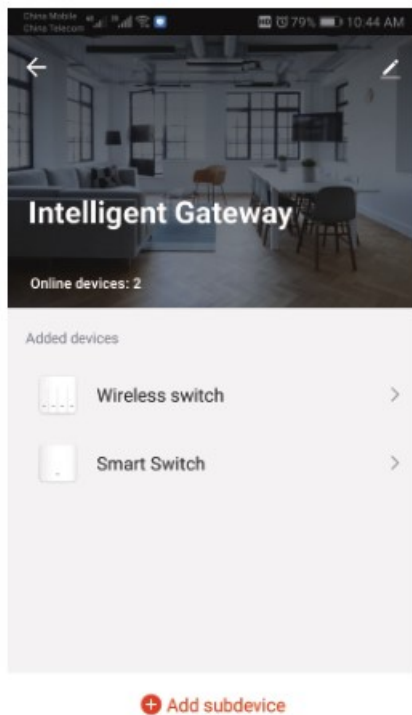

Wait for device networking to succeed, Click “DONE” to add the device successfully.

*NOTE: If you fail to add the device, please move the gateway closer to the product and reconnect the network after powering on.

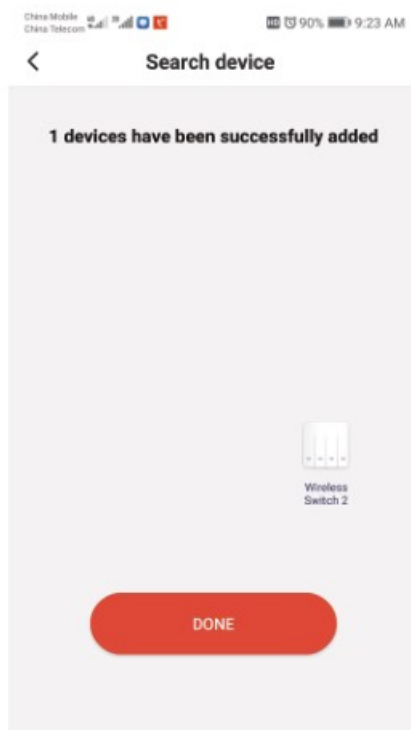
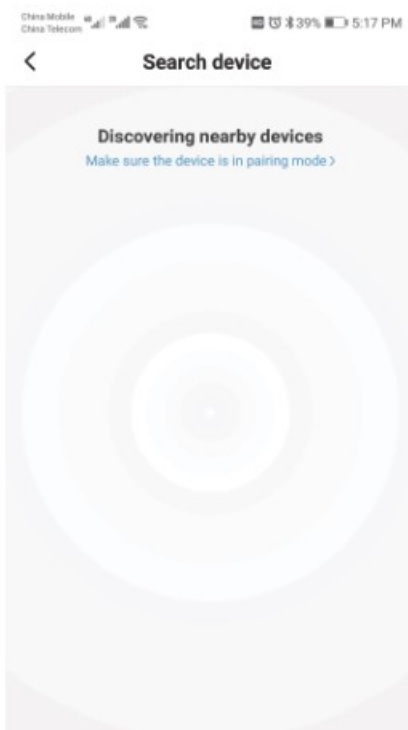

After connecting the network successfully, you will see the Intelligent Gateway page, choose the WIRELESS SWITCH 2 to enter the controlling page, then choose “Add intelligence” enter to the setting mode.

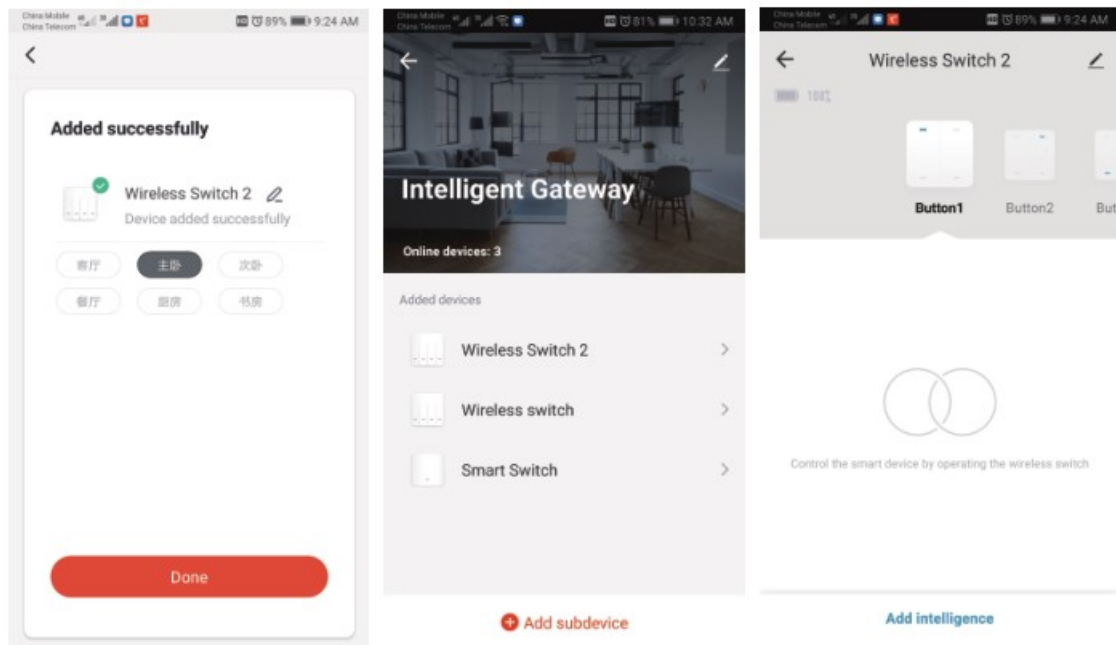

Choose “Add condition” to choose the controlling condition, such as “Single click”, the choose “Add task” choose the controlling action.

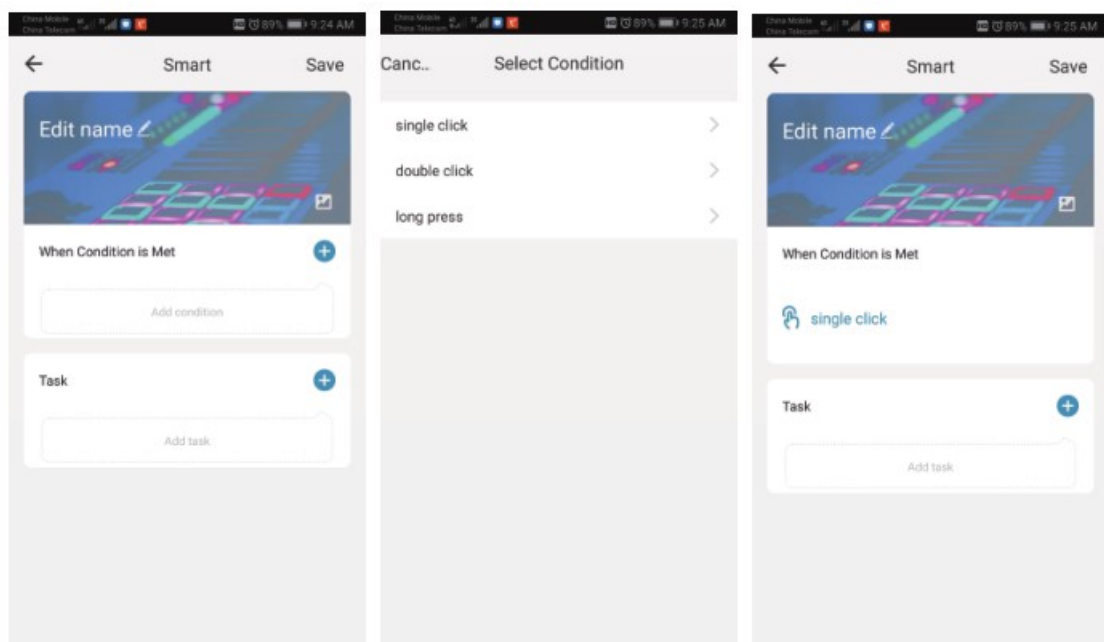

Such as choose the On/Off status of the switch.

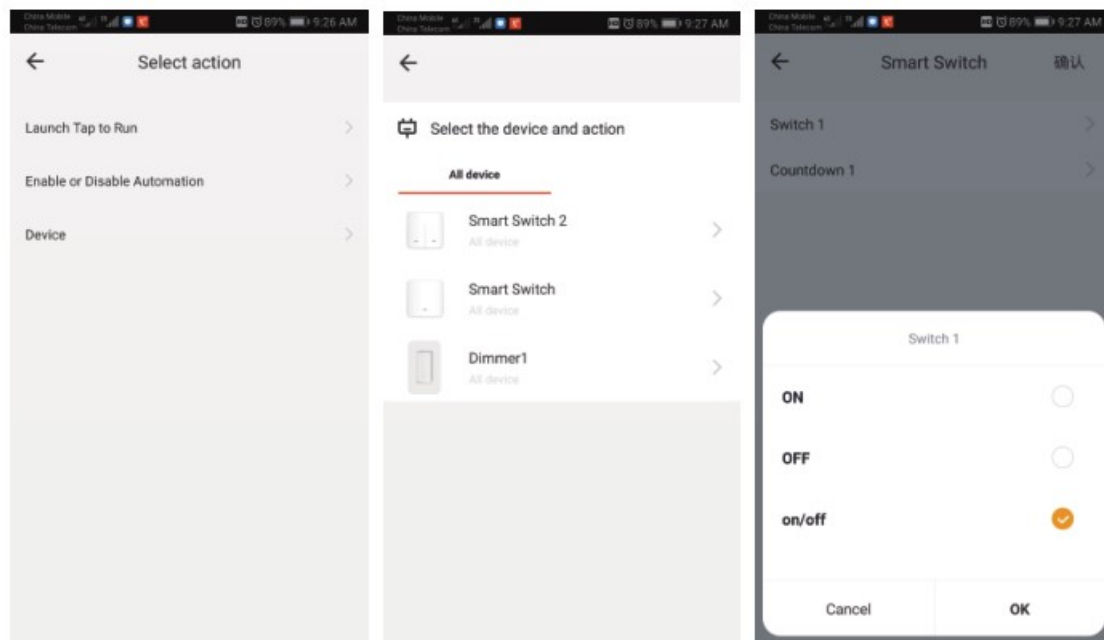

Save your collocation, the you could use the scene switch to control the light.

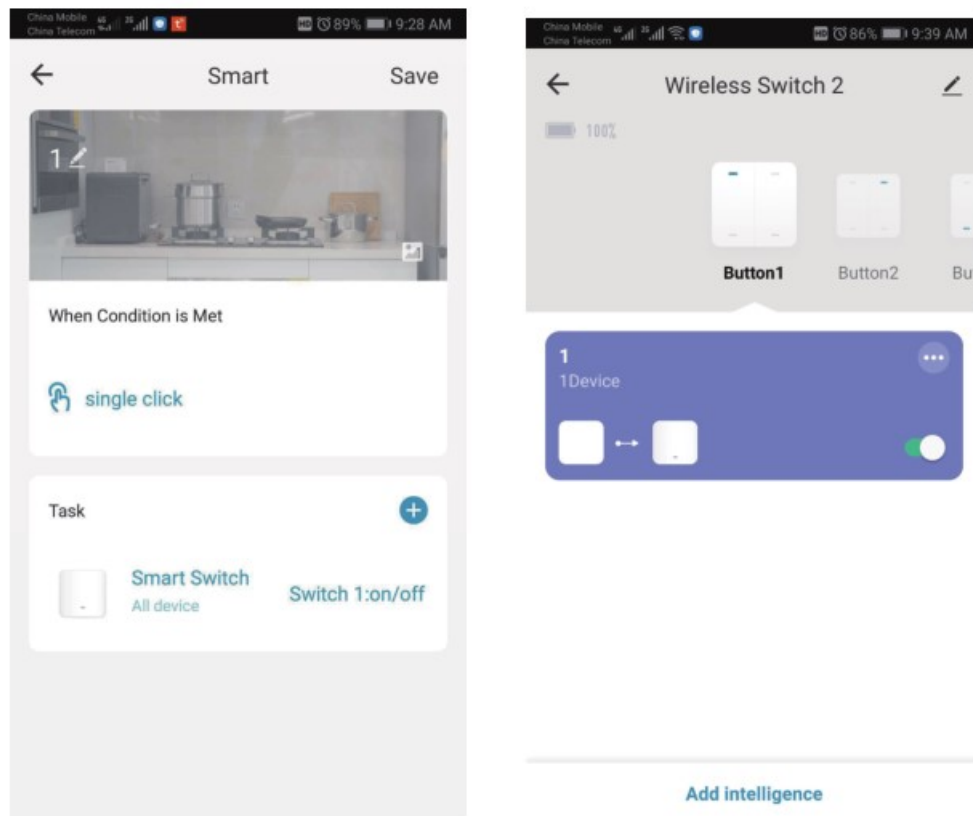

SERVICE

1. During the free warranty period, if the product breaks down during normal use, we will offer free maintenance for the product.
2. Natural disasters/man-made equipment failures, disassembly and repair without the permission of our company, no warranty card, products beyond the free warranty period, etc., are not within the scope of free warranty
3. Any commitment (oral or written) made by the third party (including the dealer/service provider) to the user

beyond the warranty scope shall be executed by the third party

4. Please keep this warranty card to ensure your rights 5. Our company may update or change the products without notice.

Please refer to the official website for the updates.

RECYCLING INFORMATION

All products marked with the symbol for separate collection of waste electrical and electronic equipment (WEEE Directive 2012/19 / EU) must be disposed of separately from unsorted municipal waste. To protect your health and the environment, this equipment must be disposed of at designated collection points for electrical and electronic equipment designated by the government or local authorities.



Correct disposal and recycling will help prevent potential negative consequences for the environment and human health. To find out where these collection points are and how they work, contact the installer or your local authority.



WARRANTY CARD

Product Information

Product Name _____

Product Type _____

Purchase Date _____

Warranty Period _____

Dealer Information _____

Customer's Name _____

Customer Phone _____

Customer Address _____

Maintenance Records

Failure date	Cause Of Issue	Fault Content	Principal

Thank you for your support and purchase at we Moes, we are always here for your complete satisfaction, just feel free to share your great shopping experience with us.



If you have any other need, please do not hesitate to contact us first, we will try to meet your demand.

FOLLOW US



@moessmart



MOES.Official



@moes_smart



@moes_smart



@moes_smart



www.moeshouse.com

www.moeshouse.com



WENZHOU NOVA NEW ENERGY CO.,LTD

Address: Power Science and Technology

Innovation Center, NO.238, Wei 11 Road,

Yueqing Economic Development Zone,

Yueqing, Zhejiang, China

Tel:+86-577-57186815

Email: service@moeshouse.com



AMZLAB GmbH

Laubenhof 23, 45326 Essen

Made In China

Documents / Resources



[Moes BT-B-EU1-MS Scene Switch](#) [pdf] User Manual

BT-B-EU1-MS, BB14-220214, BT-B-EU1-MS Scene Switch, BT-B-EU1-MS, Scene Switch, Switch

References

-  [MOES: Smart WiFi ZigBee, Smart Switch Socket, Thermostat Sensor](#)