

# moebel DERRY Table Lamp Instruction Manual

## Contents

- [1 moebel DERRY Table Lamp](#)
- [2 Product Specifications](#)
- [3 Product Usage Instructions](#)
- [4 Frequently Asked Questions](#)
- [5 Mounting](#)
- [6 Documents / Resources](#)
  - [6.1 References](#)
- [7 Related Posts](#)

# moebel

## moebel DERRY Table Lamp

### Product Specifications

- **Brand:** DERRY
- **Model:** PL
- **Language Options for Mounting Instructions:** GB, D, F, I, E, DK, S, LT, SRB

### Product Usage Instructions

#### Mounting Instructions:

Follow the appropriate language option provided in the user manual for mounting instructions.

#### Light Source Replacement:

The light source used in this luminaire should only be replaced by the manufacturer or its service representative, or a similarly qualified person. Ensure to follow all safety precautions and guidelines provided in the user manual during the replacement process.

### Frequently Asked Questions

- **Q: Who should replace the light source in this luminaire?**
  - **A:** The light source should only be replaced by the manufacturer or its service representative, or a

similarly qualified person.

- **Q: Can I replace the light source myself?**

- **A:** It is recommended to have the light source replaced by a qualified person to ensure proper installation and safety.

## Mounting

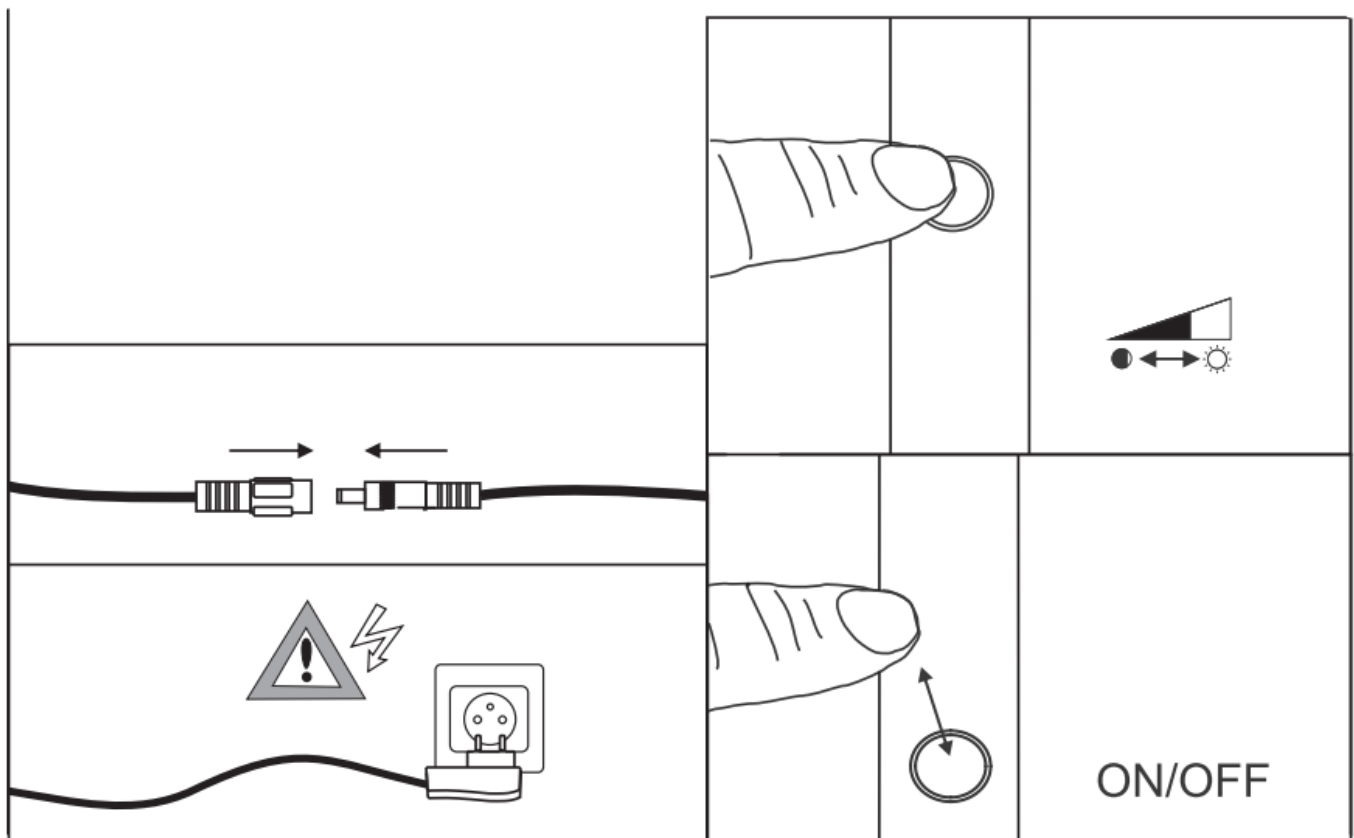
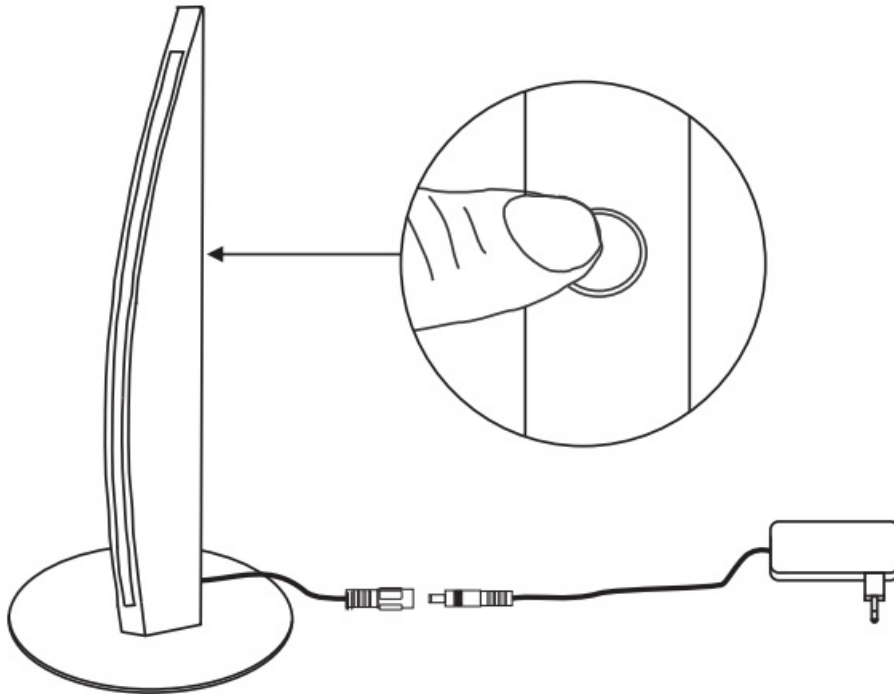

This product includes a light of the energy efficiency class F.

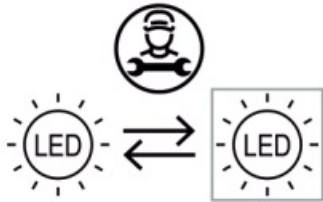

The light source used in this luminaire should only be replaced by the manufacturer or its service representative, or a similarly qualified person.

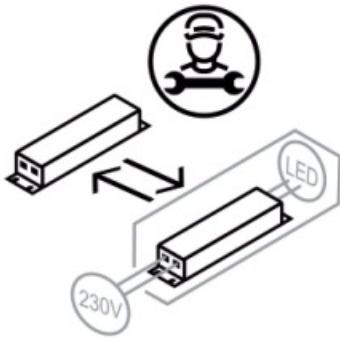

The separate control gear should be replaced by a qualified person.

## Documents / Resources

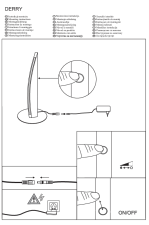
	<a href="#">moebel DERRY Table Lamp</a> [pdf] Instruction Manual 381756, 204392, DERRY Table Lamp, DERRY, Table Lamp, Lamp
--	---

## References

- [User Manual](#)

### Manuals+, Privacy Policy

This website is an independent publication and is neither affiliated with nor endorsed by any of the trademark owners. The "Bluetooth®" word mark and logos are registered trademarks owned by Bluetooth SIG, Inc. The "Wi-Fi®" word mark and logos are registered trademarks owned by the Wi-Fi Alliance. Any use of these marks on this website does not imply any affiliation with or endorsement.