



Contents [[hide](#)]

- [1 Mocreo LS1 Temperature Sensors](#)
- [2 Product Usage Instructions](#)
- [3 Introduction](#)
- [4 How the System Works](#)
- [5 What's in the Box](#)
- [6 Product Parameter](#)
- [7 Specifications](#)
- [8 Setup](#)
- [9 Precautions and Disclaimer](#)
- [10 FCC Statement](#)
- [11 Warranty](#)
- [12 Customer Service](#)
- [13 FAQ](#)
- [14 Documents / Resources](#)
 - [14.1 References](#)



Mocreo LS1 Temperature Sensors



Product Usage Instructions

- Download the MOCREO Smart App from the Google Play Store or the App Store.
- Open the app and follow the on-screen instructions to set up your account.
- Scan the QR code provided in the manual to download the app or search for “MOCREO” in your app store.
- Open the MOCREO Smart App.
- Follow the app’s instructions to add a new device.
- Select “LS1 Sensor” from the list of available devices.
- Complete the pairing process as guided by the app.
- Once the sensor is successfully added, you can monitor temperature data through the MOCREO Smart App.
- The app will display real-time temperature readings and historical data for your reference.

Introduction

- The LS1 wireless temperature sensor provides a comprehensive solution for

temperature monitoring needs.

- LS1: The sensor provides professional temperature measurement with a built-in high-precision sensor.
- Its IP67 waterproof rating and low power consumption make it ideal for long-term use in humid environments, such as refrigerators and freezers.
- The system is widely used for temperature monitoring in homes, laboratories, and storage facilities.

How the System Works

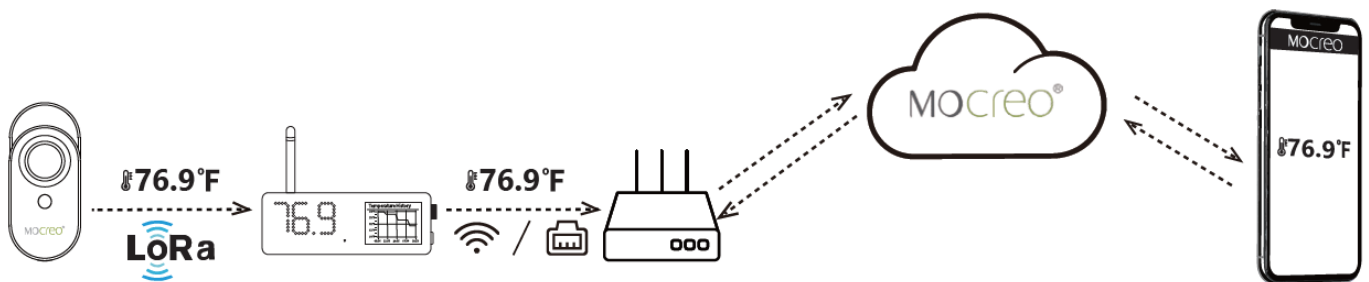

The H5-LS1D set enables remote monitoring through a two-step process:

1. The LS1 sensor collects temperature data and sends it to the H5-Pro gateway via LoRa technology, which supports long-range communication and strong wall penetration.
2. The H5-Pro gateway uploads the data to the MOCREO Cloud using local Wi-Fi or Ethernet.

This setup allows users to access monitoring data anytime through the MOCREO Smart App.

What's in the Box

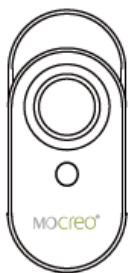

LS1 Sensor ×2



Velcro ×2



User Manual ×1

Product Parameter

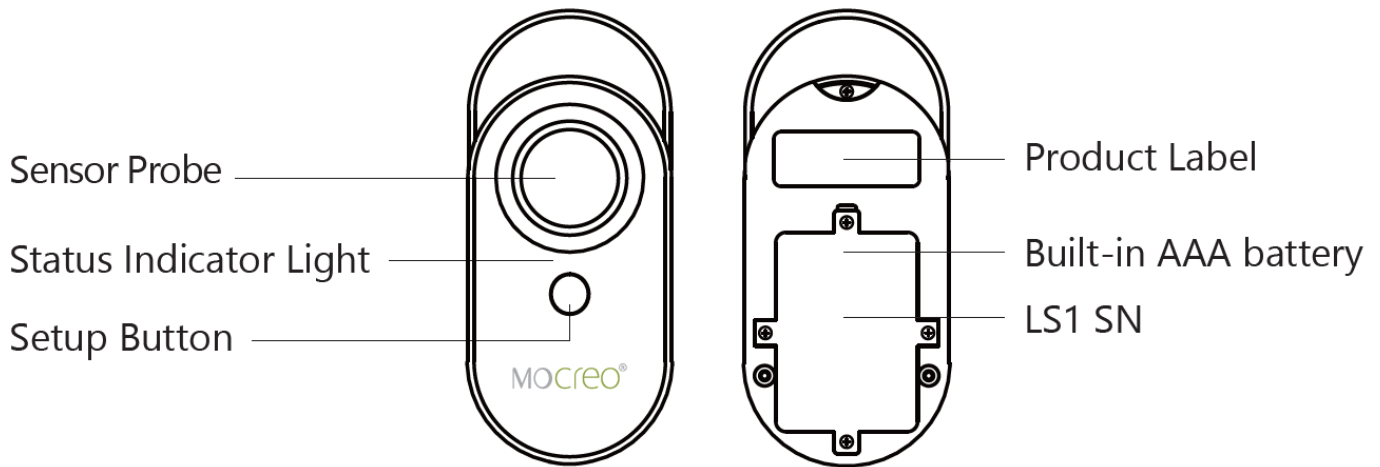

Specifications

- Model: LS1
- Wireless Connection: LoRa
- Communication Range: 500 m (clear line of sight)
- Dimensions: 106 mm*56.4 mm*21 mm
- Weight (Including probe): 96g
- Battery: 3*AAA battery (Unable to charge)
- Probe Measuring Range: -0.4 ~ 131°F (-18°~ 55°C)
- Temperature Accuracy: $\pm 0.9^{\circ}\text{F}$ ($\pm 0.5^{\circ}\text{C}$)

Setup

Download MOCREO Smart App

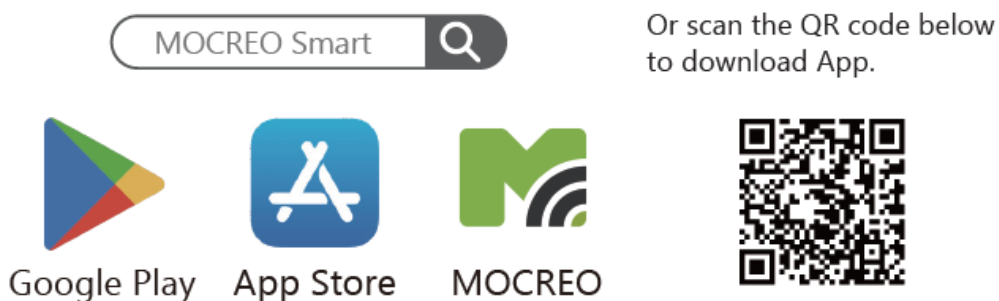

Add Device

1. Add LS1 Sensor

Open the MOCREO Smart App, follow the instructions provided by the app, and

complete the LS1 Sensor addition process.

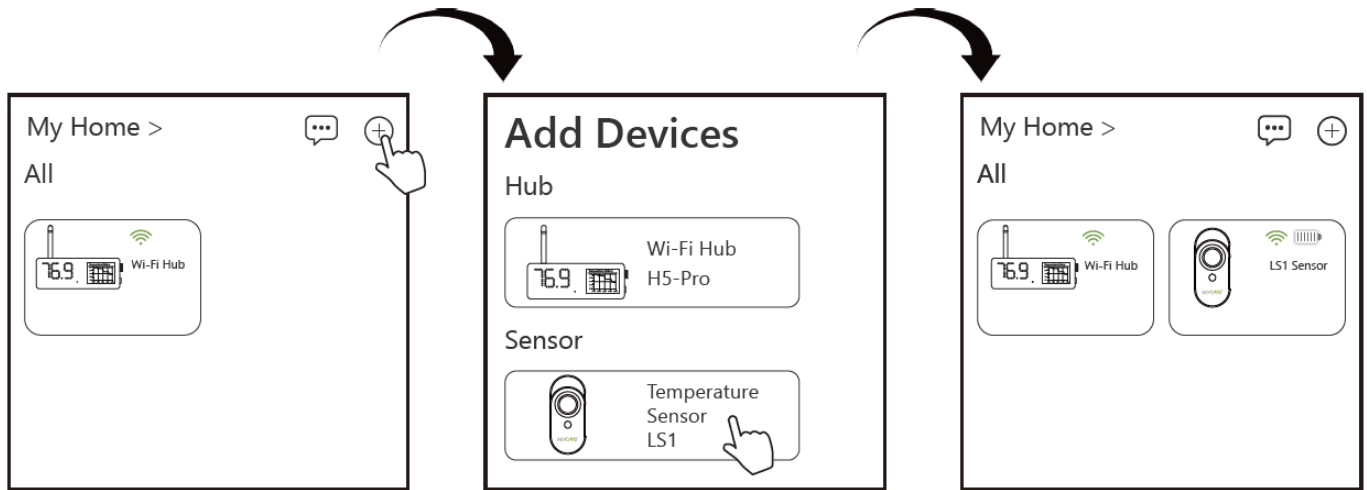

Precautions and Disclaimer

Precautions for Use

To ensure the normal use of the product, please pay attention to the following situations:

- It is recommended to install the H5-Pro in a high place.
- Do not expose the Sensor to a High-temperature environment.
- Do not place the Device near flammable materials.
- Do not put heavy objects on the Device or use it as a support.
- Children should not use the Device without adult supervision.

Disclaimer

- The contents about how to use the product and the App guidance are only for reference; please refer to the actual situation for specific applications.
- If there is something different from the instructions during using the product, please contact MOCREO Support for updates.
- This product is for detecting and monitoring only. MOCREO is not responsible for any property damage or other consequences of the use of this product.

FCC Statement

FCC ID (Sensor): 2BFZL-LS1

This device complies with part 15 of the FCC Rules. Operation is subject to the following two conditions:

1. This device may not cause harmful interference.
2. This device must accept any interference received, including interference that may cause undesired operation.

Warning: Changes or modifications not expressly approved by the party responsible for compliance could void the user's authority to operate the equipment.

Note: This equipment has been tested and found to comply with the limits for a Class B digital device, according to part 15 of the FCC Rules.

These limits are designed to provide reasonable protection against harmful interference in a residential installation. This equipment generates uses and can radiate radio frequency energy and, if not installed and used under the instructions, may cause harmful interference to radio communications.

However, there is no guarantee that interference will not occur in a particular installation. If this equipment does cause harmful interference to radio or television reception, which can be determined by turning the equipment off and on, the user is encouraged to try to correct the interference by one or more of the following measures:

- Increase the separation between the equipment and the receiver.
- Connect the equipment to an outlet on a circuit different from that to which the receiver is connected.
- Consult the dealer or an experienced radio/TV technician for help.

Warranty

- MOCREO products enjoy a 12-month limited warranty (starting from the date when the customer receives the product), which applies only to hardware components of the device that are not subject to accident, misuse, neglect, fire, or other external causes, alterations, or repairs.

Customer Service

- <https://doc.mocreo.com/>
- +1 [530-988-8608](tel:530-988-8608)
- help@mocreo.com



User Guide Manual

Search [MOCREO] on YouTube to watch the setup video tutorials.

FAQ

- **What is the communication range of the LS1 sensor?**
 - The LS1 sensor utilizes LoRa technology for long-range communication, allowing it to transmit data over significant distances with strong wall penetration capabilities.
- **How do I access monitoring data remotely?**
 - The H5-Pro gateway uploads temperature data to the MOCREO Cloud using local Wi-Fi or Ethernet connections. Users can then access this data anytime through the MOCREO Smart App on their mobile devices.
- **What is the warranty coverage for MOCREO products?**
 - MOCREO products come with a 12-month limited warranty that covers hardware components not subject to accident, misuse, neglect, fire, alterations, or unauthorized repairs. For warranty claims, contact MOCREO Support with your purchase details.

Documents / Resources

	<p>Mocreco LS1 Temperature Sensors [pdf] User Manual</p> <p>LS1, 2BFZL-LS1, 2BFZLLS1, LS1 Temperature Sensors, LS1, Temperature Sensors, Sensors</p>
-------------------------------------------------------------------------------------	----------------------------------------------------------------------------------------------------------------------------------------------------------------------

References

- [User Manual](#)

Leave a comment

Your email address will not be published. Required fields are marked *

Comment *

Name

Email

Website

☐ Save my name, email, and website in this browser for the next time I comment.

Post Comment

Search:

e.g. whirlpool wrf535swhz

Search

[Manuals+](#) | [Upload](#) | [Deep Search](#) | [Privacy Policy](#) | [@manuals.plus](#) | [YouTube](#)

This website is an independent publication and is neither affiliated with nor endorsed by any of the trademark owners. The "Bluetooth®" word mark and logos are registered trademarks owned by Bluetooth SIG, Inc. The "Wi-Fi®" word mark and logos are registered trademarks owned by the Wi-Fi Alliance. Any use of these marks on this website does not imply any affiliation with or endorsement.