



Contents [[hide](#)]

- [1 Mobile Pixels MP Pixcase Portable Entertainment System](#)
- [2 Preface](#)
- [3 Packing List](#)
- [4 Product Specifications](#)
- [5 Product Usage Instructions](#)
- [6 Button Instructions](#)
- [7 Touch Function Instructions](#)
- [8 Built-in Battery Instructions](#)
- [9 Screen Mirroring](#)
- [10 Remote Control User Manual](#)
- [11 Gaming Controller User Manual](#)
- [12 FCC Statement](#)
- [13 Documents / Resources](#)
 - [13.1 References](#)

Mobile Pixels

Mobile Pixels MP Pixcase Portable Entertainment System



Preface

Thank you for choosing the Pixcase!

Please read this manual carefully to understand how to use this machine and the precautions before you turn on the machine.

Warnings

- Use only the original supplied AC power cord.
- Slits and openings in the machine are used for ventilation and heat dissipation; do not block or cover these slits and openings.
- Do not use or store the machine in dusty, humid, or hot environments.
- When the machine malfunctions, do not disassemble and repair the machine by yourself, you need to contact the original manufacturer or dealer to solve the problem.
- Avoid stepping on the power AC cable to avoid wire damage that may cause electric leakage and other dangers.
- If the wire of the power AC cable is damaged, please do not continue to use it, otherwise it may be dangerous.
- Unplug the power cord and turn off the battery button during thunderstorms or when the unit is not in use for a long period of time.
- When using, please do not put the machine on the edge of the table or the place

where children can easily reach, to avoid the machine falling or hurting children.

- Please do not squeeze the display during transportation and do not touch the display with sharp or hard objects to avoid damage to the display.
- Please use a dry soft cloth or a soft cloth slightly dipped in a flexible cleaning agent to clean the machine.
- Do not use any kind of solvents, such as alcohol or gasoline, as this may damage the surface finish.
- Children must be made aware of the dangers of climbing on this product, which can cause serious injury if dropped or tipped over.
- Do not place the product in an unstable or tilted position.
- Always ensure timely organization of the cables connected to the product to avoid tripping, pulling, or snagging.

Packing List

After opening the packaging, please confirm the packaging content below.

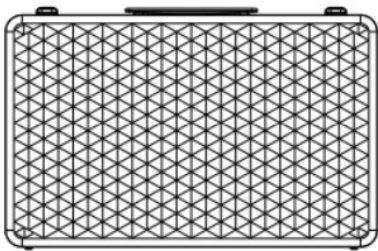

Monitor x1



Power Cable x1

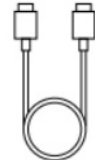

Type-C Cable x1



User Guide x1



Bluetooth Remote Control x1



Gaming Controller x1

Product Specifications

| | | |
|----------------|---------------------------|--|
| System | CPU | RK3588S2 octa-core |
| | RAM | 16GB |
| | ROM | 128GB |
| | Operating System | Android 13 |
| Specifications | Panel | 27-inch LCD |
| | Resolution | 1920*1080 |
| | Touch Points | 10-Point Capacitive Touch |
| | Aspect Ratio | 16:9 |
| Interfaces | Wi-Fi | 802.11b/g/n/a/ac/ax (Wi-Fi 6) BT 5.3 |
| | DP IN | DP IN function,Compatible with PD fast charge output, support 5V/2A,9V/2A,12V/2A,15V/2A output |
| | AC Power Input | 100-240V~,50/60Hz,3.3A Max. |
| | Rocker Switch | The switch that controls the device's battery power supply |
| | Type-c | (Output) Display+Data Transmission |
| | USB | USB Host*1 |
| | HDMI IN | 1920*1080@60HZ |
| Others | Key | Power/Volume+/Volume- |
| | Gravity Sensor | Supports 90° Rotation |
| | Hall Switch | Closing the top cover to hibernate, opening the top cover to automatically power on/wake up the screen (the whole machine power switch is turned on state) |
| | Horn | 4Ω/10w/4 |
| | Microphone | Standard built-in 4 microphones, supporting noise reduction and echo cancellation |
| | Built-in Battery Capacity | 14.6V / 6800mAh |
| | Storage Temperature | -20 C---60 C |
| | Operation Temperature | 0 C---40 C |

Product Usage Instructions

1. Place the product on a flat surface with the front side facing up.
2. Turn on the battery switch located on the left side of the product. (After turning off the battery switch, the product can only be used by connecting the power cable)
3. If power supply is needed, you can use the owner cable to connect. The power port is cated on the back of the product.

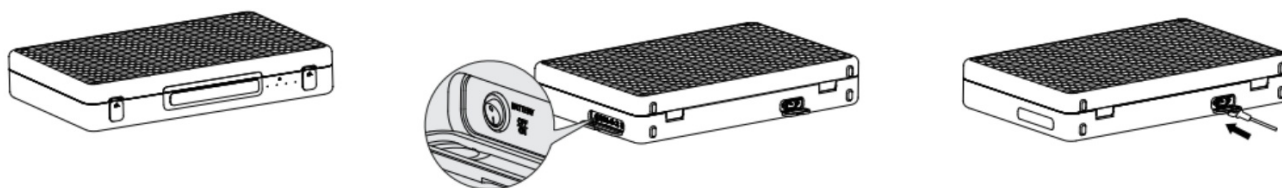

4. Unlock the front lock latch of the product and open the top cover.
5. Please lift the display screen upwards, with the display facing forward.

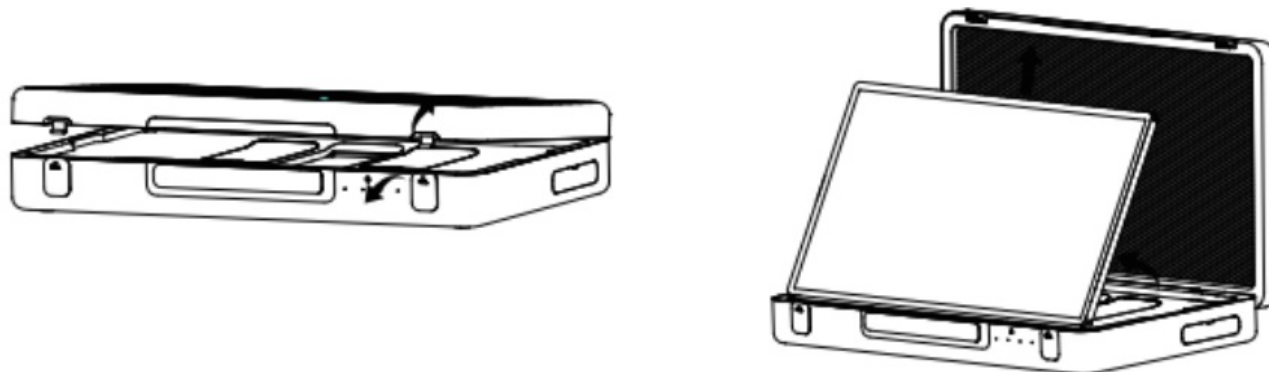

6. To rotate the screen, please pull the screen ipwards and rotate clockwise (anti-clockwise rotation is not supported).

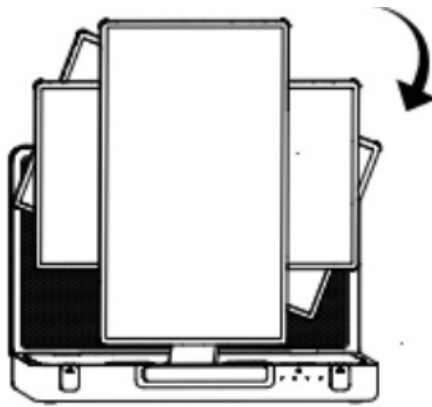

7. Box internal storage box, storage power cord, remote control and other accessories.
8. Power on by short-pressing the power button. For the first boot, please follow the on-screen setup wizard.

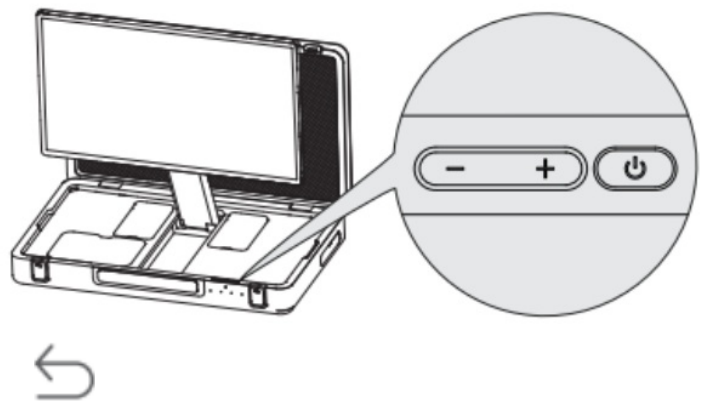
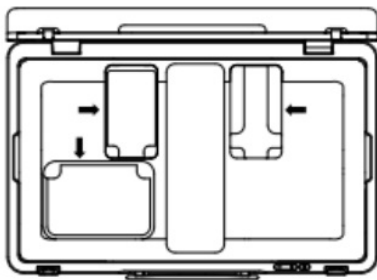

Button Instructions

Please use the induced standard AC power cable.



| Button | Functions |
|--------|---|
| | When pressing the " O " direction: The entire device is in the power-off state. When pressing the " I " direction: The entire device is in the power-on state. |
| | When in the power-off state: Press and hold for 2-3 seconds to power on. When in the power-on state: 1.Press and hold for 2-3 seconds to enter shutdown confirmation [Power off/Restart]. 2.Short press to enter the sleep screen state, and short press again to exit the sleep state. |
| | Adjustment system volume increase |
| | Adjustment system volume reduction |

* When the power cable plug supplies power to the box, try to move the product in a small range to avoid the danger of power leakage caused by vigorously ripping off or tearing the power cord.

Port Connection Instructions

Rich interfaces to support a variety of peripheral connections.

- **HOMI IN:** For connecting an external HD video signal input
- **USB :** Can be used with a USB storage device, or for a mouse and keyboard receiver.
- **DP IN :** Multi-function interface 1. Supports PD fast charging protocol, adaptive four-stage voltage $5V \approx 2A; 9V \approx 2A; 12V \approx 2A; 15V \approx 2A$ output, maximum 30W. 2. Supports DP screen mirroring, you can output your cell phone/Nintendo Switch game console to the device via TYPE-C cable.
- **Type-C :** Connect the TYPE-C docking station to connect a USB flash drive, mouse and more.

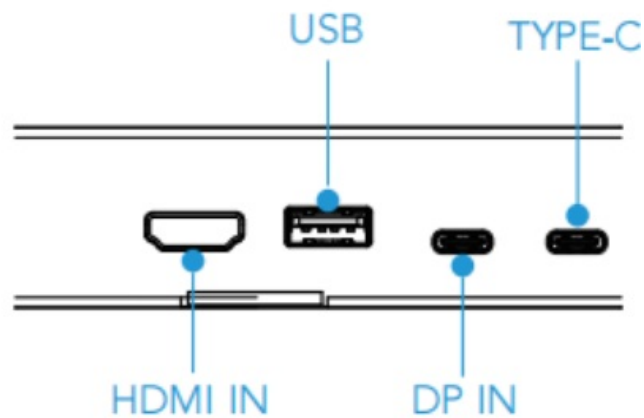

Touch Function Instructions

Adopting IPS full HD ten point capacitive touch LCD display screen. To keep the screen clean, please make sure it is clean.

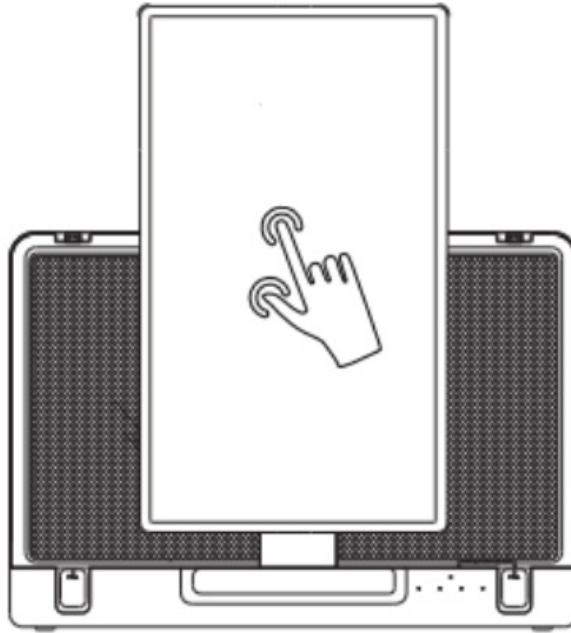

Built-in Battery Instructions

This product contains a built-in power supply board and a rechargeable battery, allowing it to be used for a period of time without connecting to other power sources. When the battery is depleted, connect the power AC cable to charge the device. Upon connecting the power AC cable, the power indicator light will turn green.



Notice:

As the product ages, there will be a proportional decline in battery life, which is a normal occurrence.

To extend battery lifespan, it is recommended to recharge the battery after a certain period of use. After the battery is fully charged, unplug the AC power cable to avoid keeping the battery continuously at a full charge. Avoid charging the battery in extreme conditions. If not in use for an extended period, please turn off the battery switch to preserve battery life.

*The standard usage time mentioned in the manual is based on our company's laboratory test data, and the actual time may vary due to different usage conditions.

Screen Mirroring

- Android: The phone and the device are on the same network -> Open the quick settings menu on the phone -> Click on "Screen Mirroring" -> Select the name of the device to be mirrored -> The device displays the phone screen, mirroring successful.
- iPhone: The phone and the device are on the same network -> Enter the shortcut menu on your iPhone -> Tap "Screen Mirroring" -> Select the name of the mirroring device -> The device displays the iPhone screen, mirroring successful.
- Windows: The computer and the device are on the same network -> On Windows, go to Settings – System -> Display – Multiple displays -> Click "Connect to a wireless display" -> Select the name of the mirroring device -> The device displays the screen, mirroring successful.
- Mac: The computer and the device are on the same network -> On Mac, go to System Preferences -> Displays -> Add Display -> Select the name of the mirroring device -> The device displays the screen, mirroring successful.
- Audio and video push: The casting device and the device are on the same network -> The casting device enters the video app -> Select the video -> Click the "Casting icon" in the top right corner of the video -> Select the name of the casting device -> The device displays the video, casting successful.

Download Application Software

Overseas: The device accesses "Google Play Store" -> Log in to the Google account -> Select the downloaded app -> Installation successful.

In **China:** The device accesses "App treasure" -> Select the downloaded app -> Installation successful.

Remote Control User Manual



1. Click  in the upper-right corner of the main page to enter the Setting.
2. Click on [Connected Devices] to establish a Bluetooth connection.

3. Click on [+Pair with new device].

4. Simultaneously long-press the "↶" back button and "▶⏸" Play/Pause buttons on the remote control. Release the buttons when the indicator light on the remote control is continuously flashing.

5. A new connected device "Remote Controller" will appear below [Available Devices]. Select the "Remote Controller" device for pairing.

6. When prompted to confirm the pairing on the screen, click "Pair" to successfully set up the remote control.

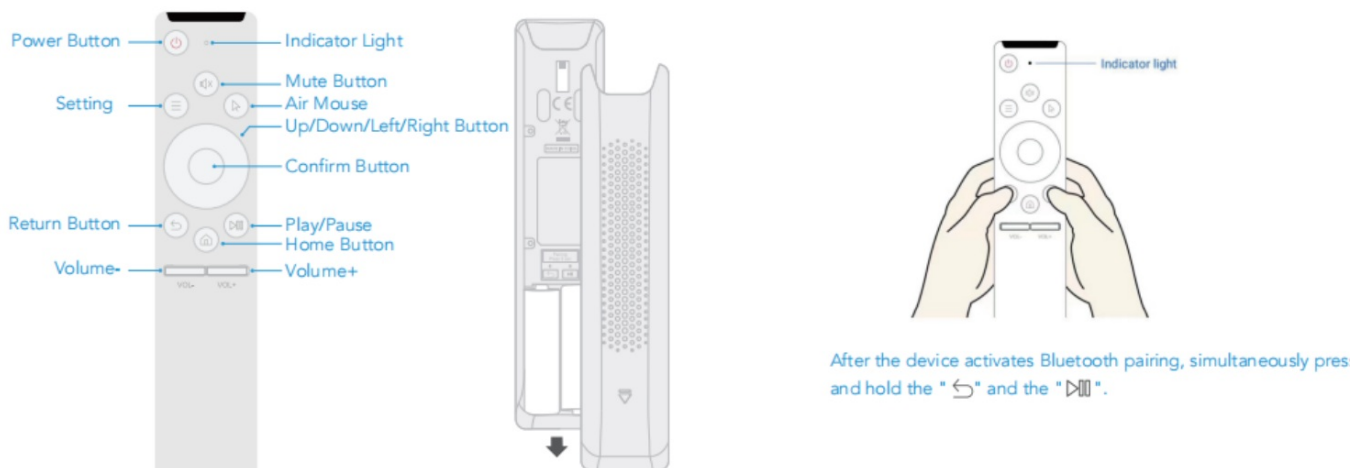

The remote control is only intended for auxiliary use and may not support all applications.

Gaming Controller User Manual

Pair the controller

1. On the MP Pixcase, long-press the Bluetooth icon in the dropdown menu to access the connected devices section or go to the settings menu and select "Connected Devices".
2. Choose "Pair new device"
3. On the controller, switch from OFF to ON, then press and hold the C pairing button for 5 seconds to enter pairing mode; the LED will blink quickly.
4. The "Xbox Wireless Controller" will appear on the list of available devices.
5. Select the controller to pair. Once pairing is complete, the LED will stay on.

Reconnect the controller

The control User will enter sleep mode after 15 minutes of inactivity. To awaken the

device and reestablish the connection, please press the Mode button. The controller retains its previous mode even after being powered off, so pressing the Mode button will reconnect it to the last used setting. If a connection is not established within 15 seconds, the controller will automatically revert to sleep mode.

Turbo and Clear

Turbo Mode: Hold the T button and press the button you want to assign (A/B/X/Y/L1/L2/R1/R2). **Clear:** To remove Turbo Mode, hold the T button and press the button that is currently assigned.

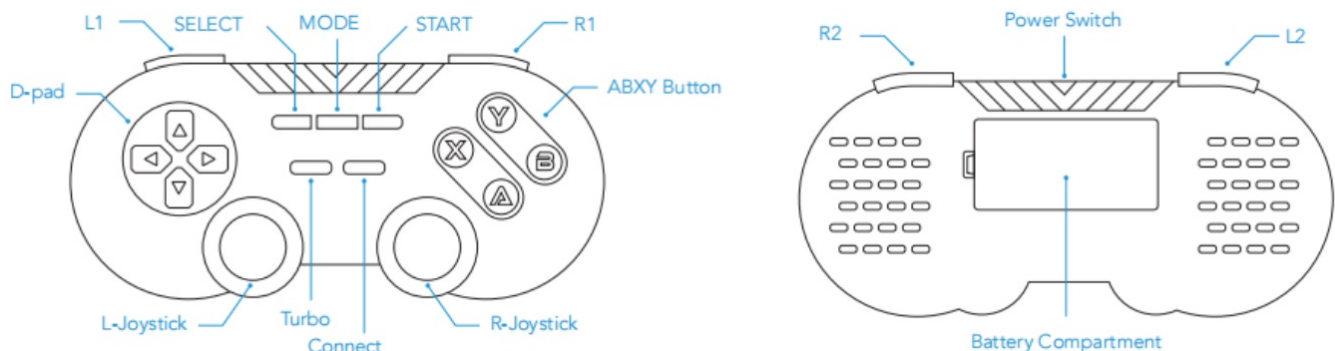

The gaming controller is only intended for auxiliary use and may not support all applications .

FCC Statement

This device complies with Part 15 of the FCC Rules. Operation is subject to the following two conditions

1. This device may not cause harmful interference
2. This device must accept any interference received, including interference that may cause undesired operation.

Warning: Changes or modifications not expressly approved by the party responsible for compliance could void the use's authority to operate the equipment

NOTE: This equipment has been tested and found to comply with the limits for a Class B digital device ,pursuant to Part 15 of the FCC Rules. These limits are de signed to provide reasonable protection against harmful interference in a residential installation. This equipment generates uses and can radiate radio frequency energy if not installed

and used in accordance with the instructions, may cause harmful interference to radio communications. However, there is no guarantee that interference will not occur in a particular installation. If this equipment does cause harmful interference to radio or television reception which can be determined by turning the equipment off and on, the user is encouraged to try to correct the interference by one or more of the following measures:

- Reorient or relocate the receiving antenna
- Increase the separation between the equipment and receiver.
- Connect the equipment into an outlet on a circuit different from that to which the receiver is connected
- Consult the dealer or an experienced radio/TV technician for help.

RF warning statement:

The device has been evaluated to meet general RF exposure requirement. The device should be installed and operated ,with minimum distance 20cm between the radiator & your body.



This device complies with parts of the FCC rules. Operation is subject to the following two conditions:

This device will not cause harmful interference;



This device must accept any interference received, including interference that may cause undesired operation This product complies with the essential requirements of European safety regulations and has passed the product safety conformity assessment procedure. It also has a manufacturer's declaration of conformity to ensure that every product delivered to the customer is safe.

Android is a trademark of Google LLC

Documents / Resources

| | |
|---|---|
|  | Mobile Pixels MP Pixcase Portable Entertainment System [pdf] User Guide e MP Pixcase Portable Entertainment System, Portable Entertainment System, Entertainment System |
|---|---|

References

- [User Manual](#)

Mobile

Pixels

Entertainment System, Mobile Pixels, MP Pixcase Portable Entertainment System, Portable Entertainment System

Leave a comment

Your email address will not be published. Required fields are marked *

Comment *

Name

Email

Website

☐ Save my name, email, and website in this browser for the next time I comment.

Post Comment

Search:

e.g. whirlpool wrf535swhz

Search

[Manuals+](#) | [Upload](#) | [Deep Search](#) | [Privacy Policy](#) | [@manuals.plus](#) | [YouTube](#)

This website is an independent publication and is neither affiliated with nor endorsed by any of the trademark owners. The "Bluetooth®" word mark and logos are registered trademarks owned by Bluetooth SIG, Inc. The "Wi-Fi®" word mark and logos are registered trademarks owned by the Wi-Fi Alliance. Any use of these marks on this website does not imply any affiliation with or endorsement.