



# MOBICOOL MCG15 Cool Boxes User Manual

[Home](#) » [MOBICOOL](#) » MOBICOOL MCG15 Cool Boxes User Manual 

## Contents

- [1 MOBICOOL MCG15 Cool Boxes User Manual](#)
- [2 WARNING!](#)
- [3 Health hazard](#)
- [4 ANOTICE! Damage hazard](#)
- [5 Intended use](#)
- [6 Operation](#)
- [7 Disposal](#)
- [8 Read More About This Manual & Download PDF:](#)
- [9 Documents / Resources](#)
  - [9.1 References](#)
- [10 Related Posts](#)

## MOBICOOL MCG15 Cool Boxes User Manual



2021 Dometic Group. The visual appearance of the contents of this manual is protected by copyright and design law. The underlying technical design and the products contained herein may be protected by design, patent or be patent pending. The trademarks mentioned in this manual belong to Dometic Sweden AB. All rights are reserved.

**⚠ DANGER**

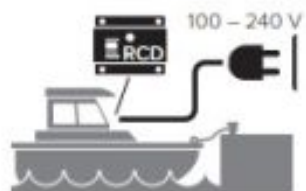
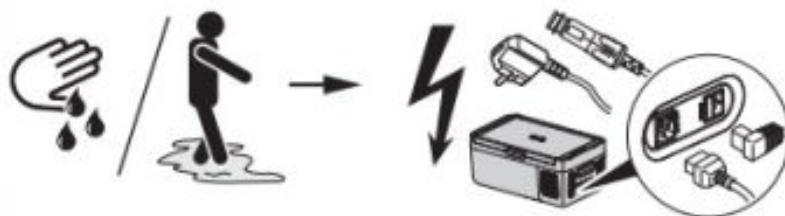

**⚠ WARNING**

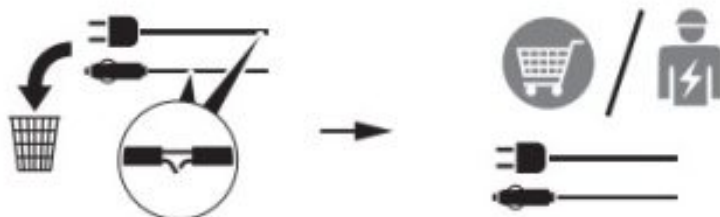

**⚠ CAUTION**

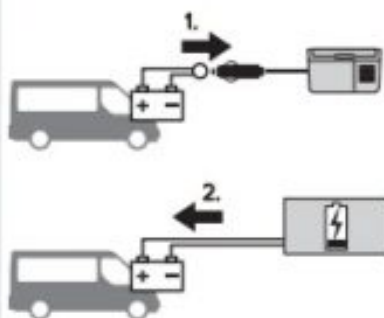
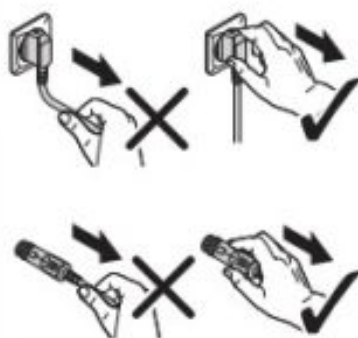

**CAUTION**

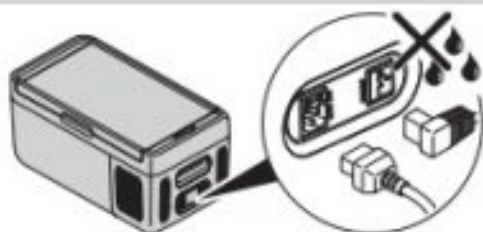

**NOTICE**

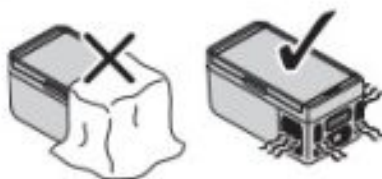
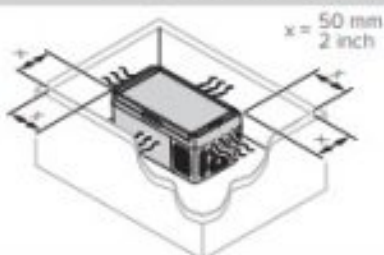

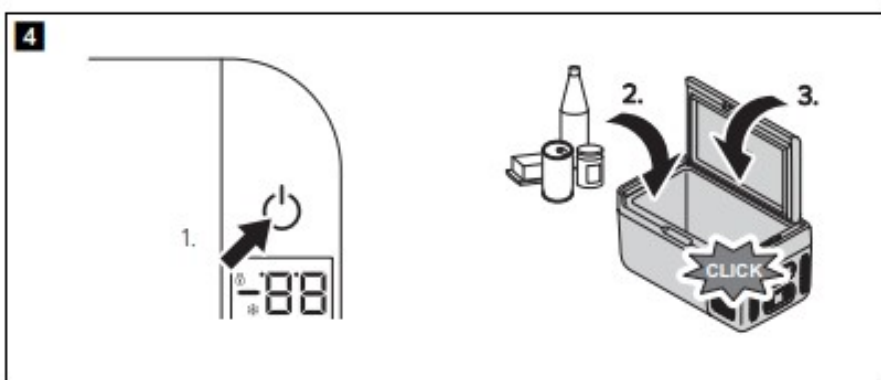
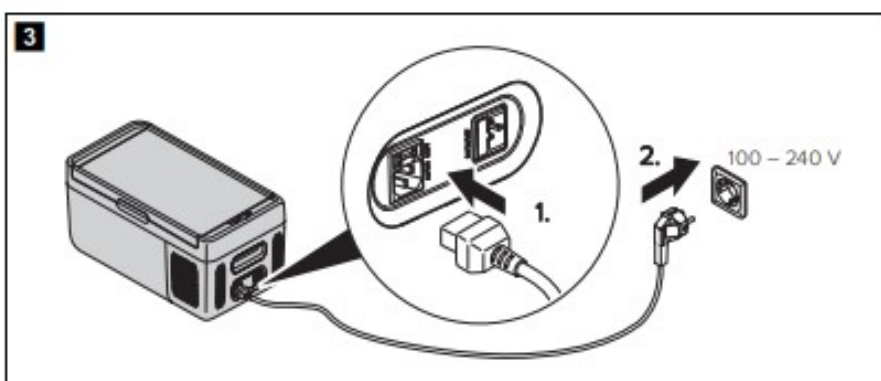
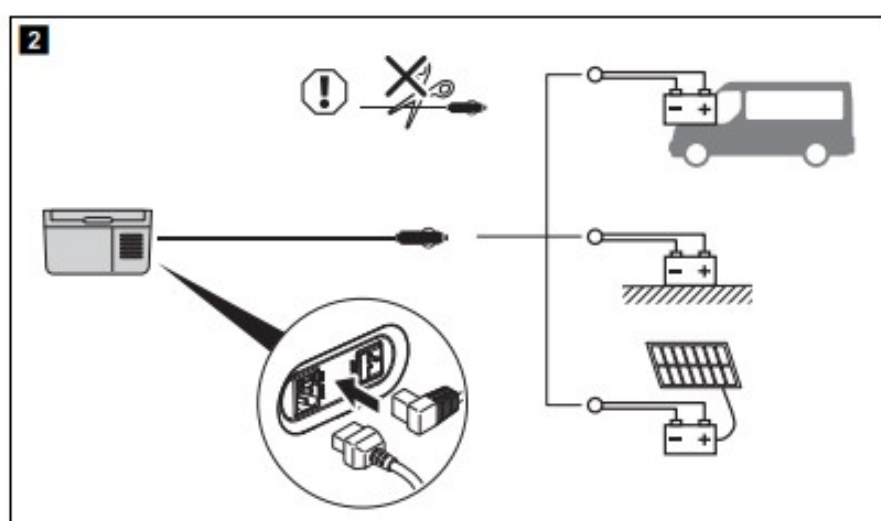
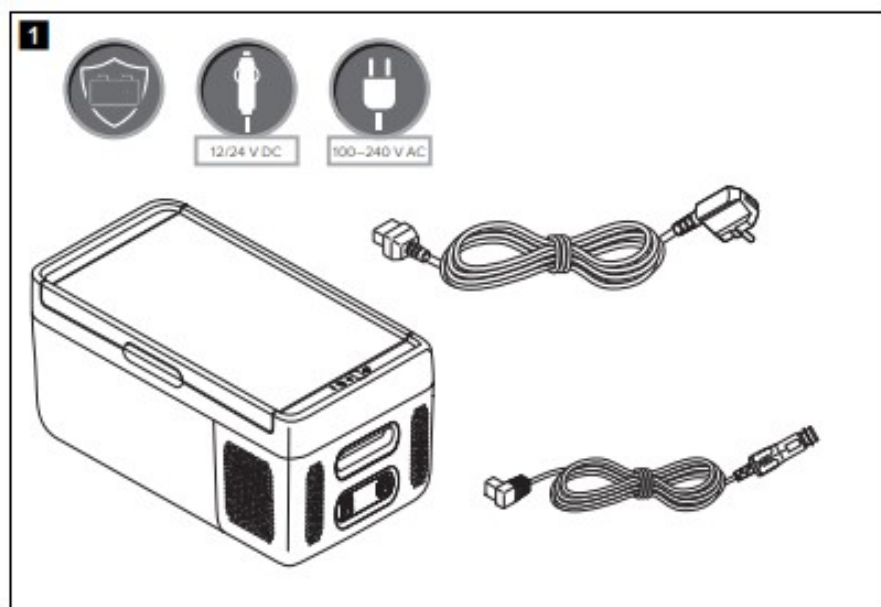

5

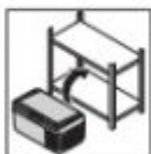

12/24 V  
100 – 240 V  
2.

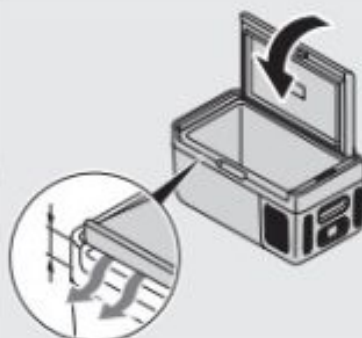
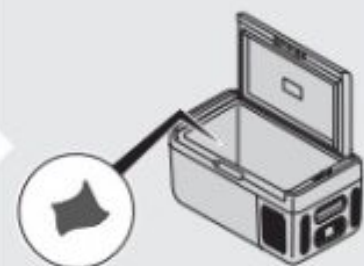
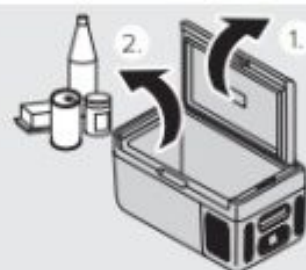

6

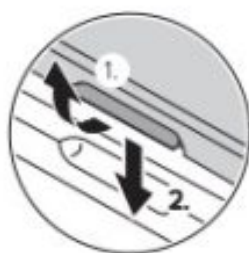

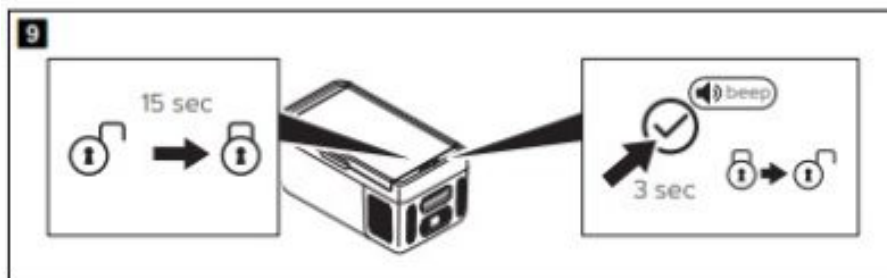
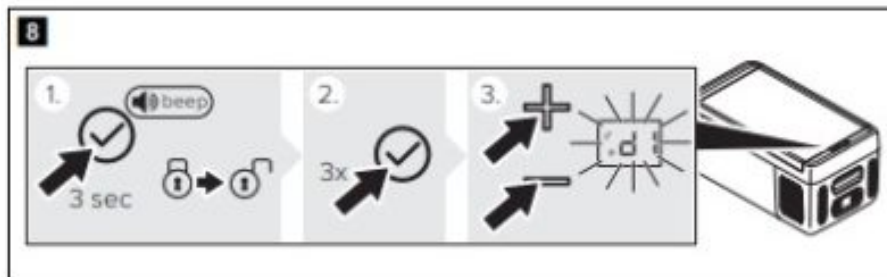
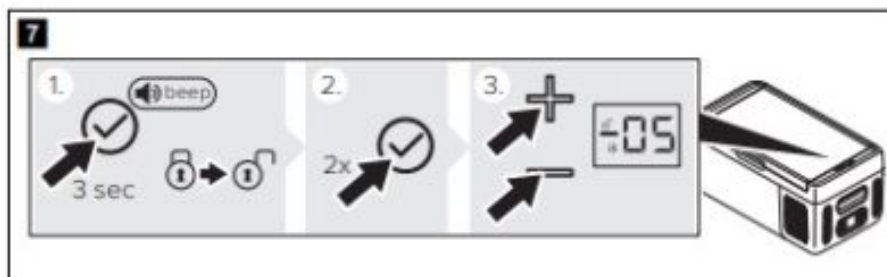

**10**

	OFF	10.1 V
	ON	11.4 V
	OFF	21.5 V
	ON	23.0 V

Please read these instructions carefully and follow all instructions, guidelines, and warnings included in this product manual in order to ensure that you install, use, and maintain the product properly at all times. These instructions **MUST** stay with this product. By using the product, you hereby confirm that you have read all instructions, guidelines, and warnings carefully and that you understand and agree to abide by the terms and conditions as set forth herein. You agree to use this product only for the intended purpose and application and in accordance with the instructions, guidelines, and warnings as set forth in this product manual as well as in accordance with all applicable laws and regulations. A failure to read and follow the instructions and warnings set forth herein may result in an injury to yourself and others, damage to your product or damage to other property in the vicinity. This product manual, including the instructions, guidelines, and warnings, and related documentation, may be subject to changes and updates. For up-to-date product information, please visit [dometic.com](http://dometic.com).



Find the full operating manual online on  
[documents.dometic.com/ ?object\\_id=71795](http://documents.dometic.com/?object_id=71795)

## WARNING!

Also observe the safety instructions on page 3 to page 4. Safety instructions  
**!WARNING!** Failure to obey these warnings could result in death or serious injury.

## Electrocution hazard

- Do not operate the cooling device if it is visibly damaged.
- If this cooling device's power cable is damaged, it must be replaced by the manufacturer, a service agent or a similarly qualified person in order to prevent safety hazards.
- This cooling device may only be repaired by qualified personnel. Improper repairs can lead to considerable hazards.

## Health hazard

- This device can be used by children aged from 8 years and above and persons with reduced physical, sensory or mental capabilities or lack of experience and knowledge if they have been given supervision or instruction concerning use of the device in a safe way and understand the hazards involved.
- Children shall not play with the device.
- Cleaning and user maintenance shall not be made by children without supervision.
- Children aged from 3 to 8 years are allowed to load and unload cooling devices.

### Explosion hazard

- Do not store any explosive substances such as spray cans with a flammable propellant in the cooling device.

### Fire hazard

- When positioning the device, ensure the supply cord is not trapped or damaged.
- Do not locate multiple portable socket-outlets or portable power supplies at the rear of the device.
- Keep the ventilation openings on the device housing or in installations free of obstructions.
- Do not use any mechanical objects or other means to speed up the defrosting process, unless they have been recommended by the manufacturer for this purpose.
- Do not damage the refrigerant circuit.



**!CAUTION!** Failure to obey these cautions could result in minor or moderate injury. Health hazard

- Please check if the cooling capacity of the device is suitable for storing the food or medicine you wish to cool.
- Food may only be stored in its original packaging or in suitable containers.
- Opening the lid for long periods can cause significant increase of the temperature in the compartments of the device.
- Clean regularly surfaces that can come in contact with food and accessible drainage systems.
- If the device is left empty for long periods:
  - Switch off the device.
  - Defrost the device.
  - Clean and dry the device.
  - Leave the lid open to prevent mould developing within the device.





## **ANOTICE! Damage hazard**

- Only carry the cooling device upright.
- Check that the voltage specification on the type plate corresponds to that of the energy supply.
- The insulation of the cooling device contains flammable cyclopentane and requires special disposal procedures.

Deliver the cooling device at the end of its life-cycle to an appropriate recycling center.

- Do not use electrical devices inside the cooling device unless they are recommended by the manufacturer for the purpose.
- Hazard from excessively low temperature  
Ensure that only those objects are placed in the cooling device that are intended to be cooled at the selected temperature.
- The cooling device shall not be exposed to rain.

## **Intended use**

The cooling box is suitable for cooling food.

The cooling box is also suitable for use on vehicles.

The cooling box is designed to be operated from a DC power supply socket of a vehicle or from an AC power supply.

The cooling box is suitable for camping use.

The cooling box is not suitable for:

- storage of corrosive, caustic or solvent-containing substances
- freezing of food

This cooling box is not intended to be used as a built-in appliance.

This cooling box is only suitable for the intended purpose and application in accordance with these instructions.

This manual provides information that is necessary for proper installation and/or operation of the cooling box.

Poor installation and/or improper operating or maintenance will result in unsatisfactory performance and a possible failure.

The manufacturer accepts no liability for any injury or damage to the product resulting from:

- Incorrect assembly or connection, including excess voltage
- Incorrect maintenance or use of spare parts other than original spare parts provided by the manufacturer
- Alterations to the product without express permission from the manufacturer
- Use for purposes other than those described in this manual

Dometic reserves the right to change product appearance and product specifications.

## **Operation**

Scope of delivery: fig.1 Proceed as shown:

- Connecting to a battery: fig.2

- Connecting to an AC power supply: fig.3
- Switching on the cooler: fig.4
- Switching off and storing the cooler: fig.5
- Latching the cooler lid: fig.6
- Setting the temperature: fig.7
- Setting the brightness: fig.8
- Unlocking the buttons: fig.9
- Using the battery monitor: fig.0



## Disposal

► Place the packaging material in the appropriate recycling waste bins, wherever possible.



M If you wish to finally dispose of the product, ask your local recycling center or specialist dealer for details about how to do this in accordance with the applicable disposal regulations.

## Read More About This Manual & Download PDF:

## Documents / Resources

	<p><a href="#">MOBICOOL MCG15 Cool Boxes</a> [pdf] User Manual MCG15 Cool Boxes, MCG15, Cool Boxes</p>
---	--

## References

-  [Dometic Outdoor USA - Compact solutions for Outdoor living | Dometic.com](#)
-  [United States | MOBICOOL](#)
-  [Contact us | MOBICOOL](#)
-  [Contact us | MOBICOOL](#)