

 **MMViCTY**
MY-V82 Multi
Function Transparent
Customized
Keyboard



MMViCTY MY-V82 Multi Function Transparent Customized Keyboard User Guide

[Home](#) » [MMViCTY](#) » MMViCTY MY-V82 Multi Function Transparent Customized Keyboard User Guide 

Contents

- [1 MMViCTY MY-V82 Multi Function Transparent Customized Keyboard](#)
- [2 Specifications](#)
- [3 Product Usage Instructions](#)
- [4 Basic parameters](#)
- [5 Product Overview](#)
- [6 Multimedia keys and function keys](#)
- [7 Connection method](#)
- [8 Wired connection](#)
- [9 List of Items](#)
- [10 Fcc](#)
- [11 Frequently Asked Questions](#)
- [12 Documents / Resources](#)
 - [12.1 References](#)
- [13 Related Posts](#)



MMViCTY MY-V82 Multi Function Transparent Customized Keyboard



Specifications

- Product: Multi-function transparent customized keyboard
- Execution standard: GB/T 14081-2010
- Interface: Type-C
- Connectivity: Bluetooth/wired/2.4G
- Sleep mechanism: Yes
- Battery Indicator: Yes
- Switch light color options
- Multi-media keys and function keys

Product Usage Instructions

Basic Parameters

The keyboard features knob Caps/WIN lock/charging/indicator light, a Type-C interface, and a three-stage switch for Bluetooth/wired/2.4G connectivity with a 2.4G receiver storage area.

Sleep Mechanism:

In wireless mode, the keyboard goes into deep sleep mode after 30 minutes of standby time. In wired mode, the keyboard does not sleep. The keyboard backlight turns off after 3 minutes of standby time in wireless mode.

Battery Indicator:

When the battery voltage is below 3.3V in wireless mode, the low voltage indicator light flashes. The charging indicator light remains constant during charging and turns off when fully charged. Normal operation can be restored after wired charging.

Switch Light Color:

Use different key combinations to change the light color, slow down or speed up the lighting, and adjust the brightness of the light.

Connection Methods:

1. **2.4G Connection:** Insert the dedicated receiver, turn the three-stage switch to the 2.4G mark for normal use.
2. **Bluetooth Connectivity:** Pair with Bluetooth-enabled devices.
3. **Wired Connection:** Connect via Type-C interface and switch to the USB icon for normal operation.

List of Items:

- One keyboard
- One TYPE-C charging cable
- 2.4G receiver
- One set of tools
- One copy of the manual warranty card

OPERATING GUIDE

- **Execution standard:** GB/T 14081-2010
- **Note:** The product images are for reference only and may differ from the actual product. Please refer to the actual object. We apologize for any inconvenience caused!

Basic parameters

- Product model: Forester MY-V 82
- Battery parameters: 3.7V 3000mAh
- Input: 5V 1A
- Driver: Support (go to the official download or consult the customer service of the purchasing platform to request)
- Connection modes: wired connection, Bluetooth connection (3.0+5.0), 2.4G connection
- Wireless version: 2.4G, BLE5.0+BT3.0
- Wireless connection distance: 10 meters (in unobstructed open environments)
- Charging port: Type-C (USB-C). Supported systems: Windows, macOS, iOS, Android
- Product size: Height: 40mm, Length: 330mm, Width: 142mm
- Product weight: 82.3g

Product Overview

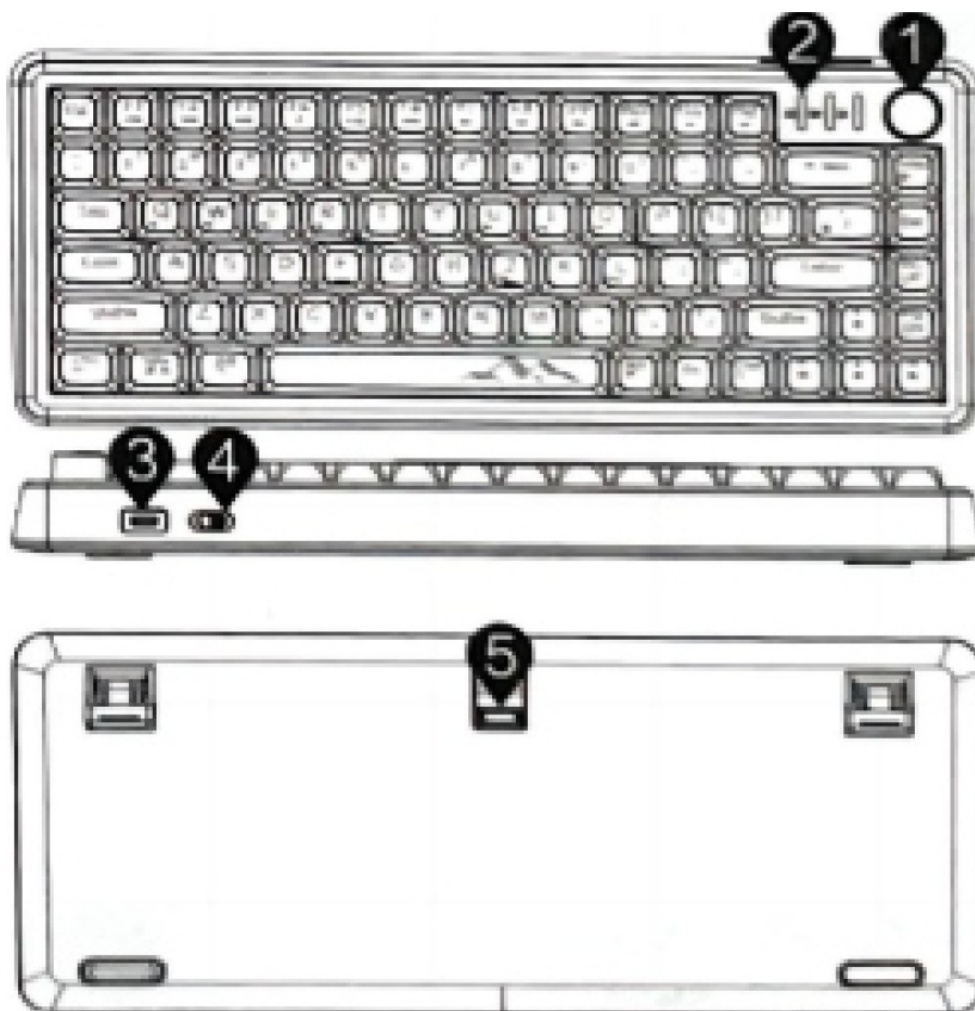

1. knob
2. Caps/WIN lock/charging/ indicator light
3. Type-C interface
4. Three-stage switch Bluetooth/wired/2.4G
5. 2.4G receiver storage area

Sleep mechanism

- The key is invalid, and the keyboard is awakened. The second key value is validity. Light up; In wired mode, the keyboard does not sleep 30 minutes of standby time to enter deep sleep mode; Release the button for 3 minutes in wireless mode for the first time to enter standby mode. The keyboard backlight will turn off. Press any key.

BatteryIndicator

- In wireless mode, when the battery voltage is below 3.3V, the low voltage indicator light flashes. In charging state The charging indicator light remains constant and turns off when fully charged. After plugging in the wired charging, normal operation can be restored.

Lighting settings

- FN+|Switch lighting effects Classic music rhythm (driver), light and shadow mode (driver); Dynamic breathing,

spectral cycling, customization (driver), music rhythm electronic music (driver), one stone, two birds, peak turning, colorful crisscrossing, flying snow in the sky, shooting stars, constant brightness, towering mountains, sine waves, surging colorful springs, stepping on snow without leaving a trace, blooming flowers, drifting with the flow, rippling green waves, twinkling stars, endless streams, following closely like a shadow.

- Switch light color FN+HOME
- Colorful, red, orange, yellow, green, green, blue, purple, white;
- FN+-Slow down the light speed; FN+→Speed up the lighting;
- FN+ increasesthe brightnessof the light; FN+↓Decreased brightness of the light

Multimedia keys and function keys

Automatic detection and switching system after connection

MAC	Function
F1	Screen brightness-
F2	Screen brightness+
F3	Array running program
F4	Search
F5	Siri
F6	Screenshot

MAC	Function
F7	Previous song
F8	Play/Pause
F9	Next song
F10	Mute
F11	Volume-
F12	Volume+

WIN	Function
FN+F1	My computer
FN+F2	Mailbox
FN+F3	Homepage
FN+F4	Search
FN+F5	Refresh
FN+F6	Music
FN+F7	Previous song
FN+F8	Play/Pause
FN+F9	Next song
FN+F10	Mute

WIN	Function
FN+F11	Volume-
FN+F12	Volume+
FN+WIN	Lock WIN and APP keys
FN+ESC	Restore factory settings
FN+U	Prtsc
FN+I	ScrIk
FN+0	Pause
FN+J	Ins
FN+L	End

- Turning the knob to the right increases the volume, while turning it to the left decreases the volume, Press the knob to turn the keyboard light on/off.

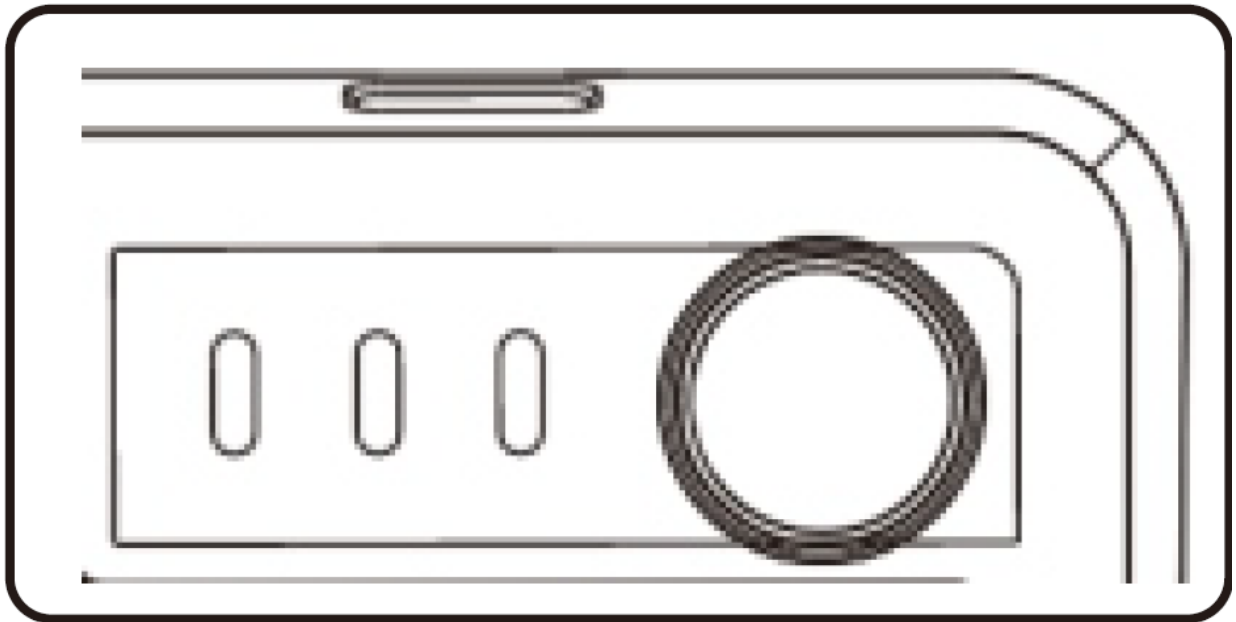

Connection method

2.4G connection

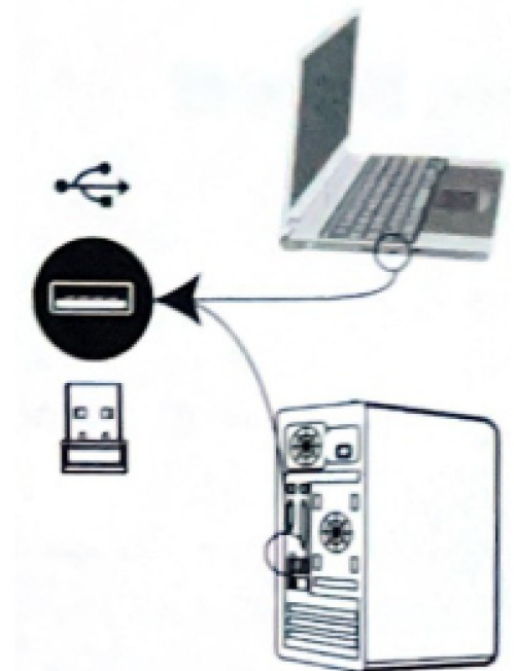
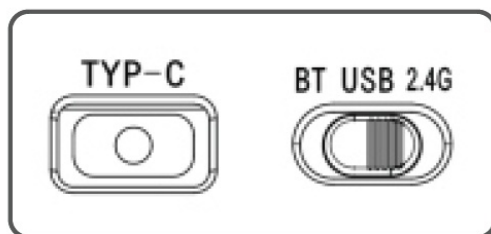

- 2.4G mode: Insert a dedicated receiver that has been paired with the code, turn the three-stage switch to the 2.4G mark, and use the keyboard normally

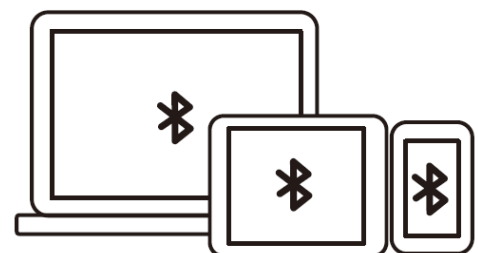
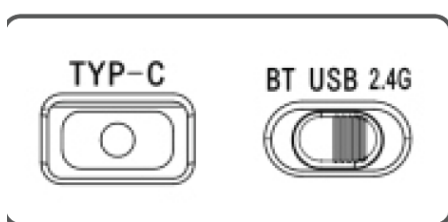

Bluetooth name:

- Bluetooth mode: Turn the three-stage switch to Bluetooth mode. There are three Bluetooth channels in total:
- Short press FN+O: Bluetooth 1 FN+W: Bluetooth 2 FN+E: Bluetooth 3. Open the device that needs to be paired for Bluetooth pairing, and once paired successfully, the keyboard can be used normally. When connecting multiple
- Bluetooth devices simultaneously, short press the corresponding Bluetooth key to switch between Bluetooth devices. Long press FN+O: search for Bluetooth 1 FN+W: search for Bluetooth 2 FN+E: search for Bluetooth 3.

Wired connection

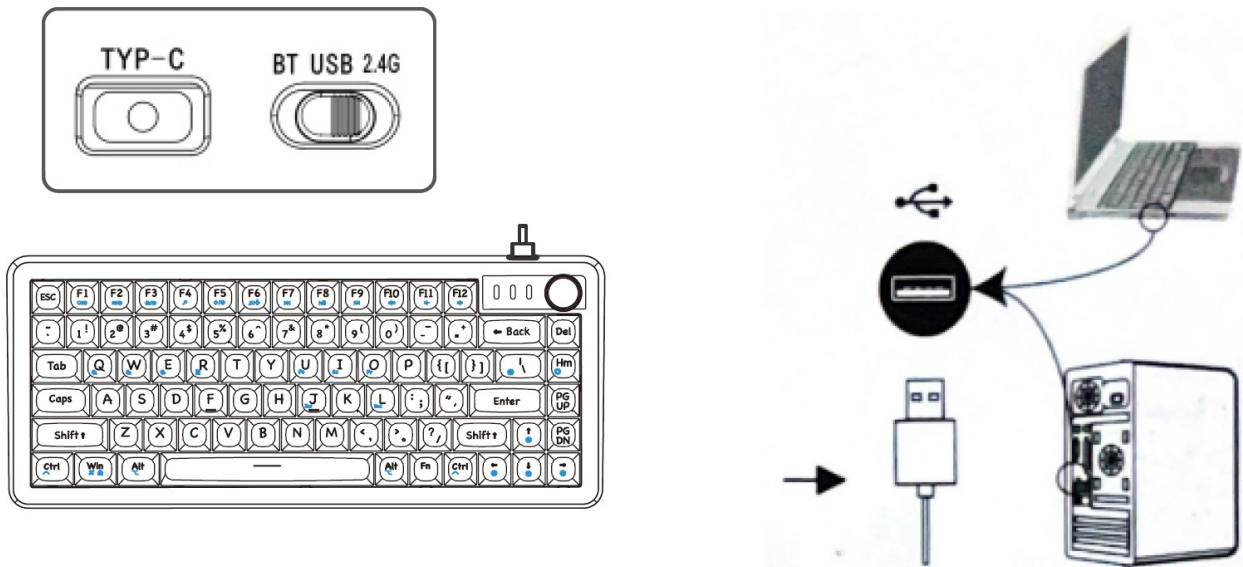

- **Wired mode:** First, insert the connecting cable into the TYPE-C interface, then connect the other end to the computer. Turn the three-stage switch to the USB icon, and the keyboard can be used normally

List of Items

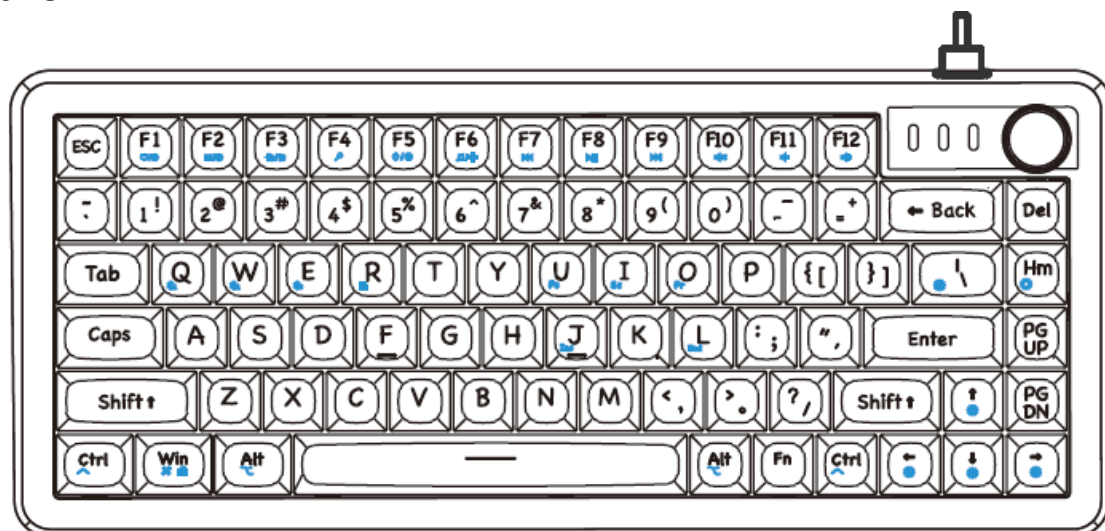

TYPE-C charging cable

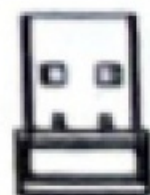

2.4G receiver

1. One keyboard
2. One TYPE-C charging cable
3. 2.4G receiver
4. One set of tools
5. One copy of the manual warranty card

Fcc

FCC Warning:

This equipment has been tested and found to comply with the limits for a Class B digital device, under part 15 of the FCC Rules. These limits are designed to provide reasonable protection against harmful interference in a residential installation. This equipment generates, uses, and can radiate radio frequency energy and, if not installed and used according to the instructions, may cause harmful interference to radio communications. However, there is no guarantee that interference will not occur in a particular installation. If this equipment does cause harmful interference to radio or television reception, which can be determined by turning the equipment off and on, the user is encouraged to try to correct the interference by one or more of the following measures:

- Reorient or relocate the receiving antenna.
- Increase the separation between the equipment and receiver.
- Connect the equipment into an outlet on a circuit different from that to which the receiver is connected.
- Consult the dealer or an experienced radio/TV technician for help.

Caution: Any changes or modifications to this device not explicitly approved by the manufacturer could void your authority to operate this equipment.

This device complies with part 15 of the FCC Rules. Operation is subject to the following two conditions:

1. This device may not cause harmful interference, and
2. This device must accept any interference received, including interference that may cause undesired operation.

This equipment complies with FCC radiation exposure limits set forth for an uncontrolled environment. This equipment should be installed and operated with minimum distance 0cm between the radiator and your body.

Frequently Asked Questions

- **Q: How do I change the color of the keyboard lights?**
 - **A:** Press FN+HOME to cycle through various colors. Use other key combinations to control the brightness and speed of lighting.
- **Q: What should I do if the keyboard does not respond in wireless mode?**
 - **A:** Ensure the battery voltage is above 3.3V. If not, charge the keyboard. If the issue persists, contact customer support.
- **Q: How do I connect the keyboard to my computer via Bluetooth?**
 - **A:** Put the keyboard in Bluetooth mode, search for available devices on your computer, and select the keyboard to pair.

Documents / Resources

