



Mintion Upgraded 3D Printer Camera User Manual

[Home](#) » [Mintion](#) » Mintion Upgraded 3D Printer Camera User Manual 



Contents

- 1 Upgraded 3D Printer Camera
- 2 PACKING LIST
- 3 CAMERA INTRODUCTION
- 4 INSTALLATION BRACKET
- 5 ADD THE CAMERA
- 6 FIRST USE
- 7 WEB PAGE
- 8 CUSTOMER SUPPORT
- 9 FCC WARNING STATEMENT
- 10 SPECIFICATION
- 11 Documents / Resources
 - 11.1 References

Upgraded 3D Printer Camera



**Beagle V2
3D Printer Camera
Quick Guide Manual**



Manual-Download

<https://www.mintion.net/pages/manual-download>

 https://mintion-6288.myshopify.com/pages/beagle-v2-camera-firmware	 https://mintion-6288.myshopify.com/pages/beagleprint-app-download
Beagle V2 Firmware Download Beagle V2 camera supports online upgrade	Beagleprint App Download



The lens has been adjusted, DO NOT knob t befor the WiFi connection.

PACKING LIST



Beagle V2



Gimbal x1
Tripod x1



Micro SD
Card x1
(Insert in camera)



Quick Guide
Manual x1



Power
Plug x1



USB-Type-C
Cable 1.5M x2
(For power)

CAMERA INTRODUCTION

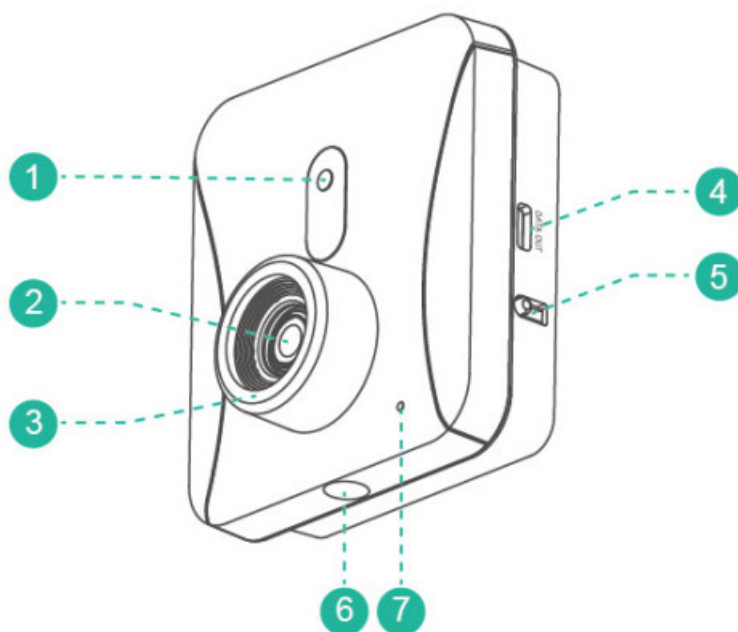

- 1. routsensor
- 2. Lens

3. Focus Ring
4. Data Port (With Cover)
5. ResetButton
6. Tripod Mount (size 1/47-20)
7. Vicrophone

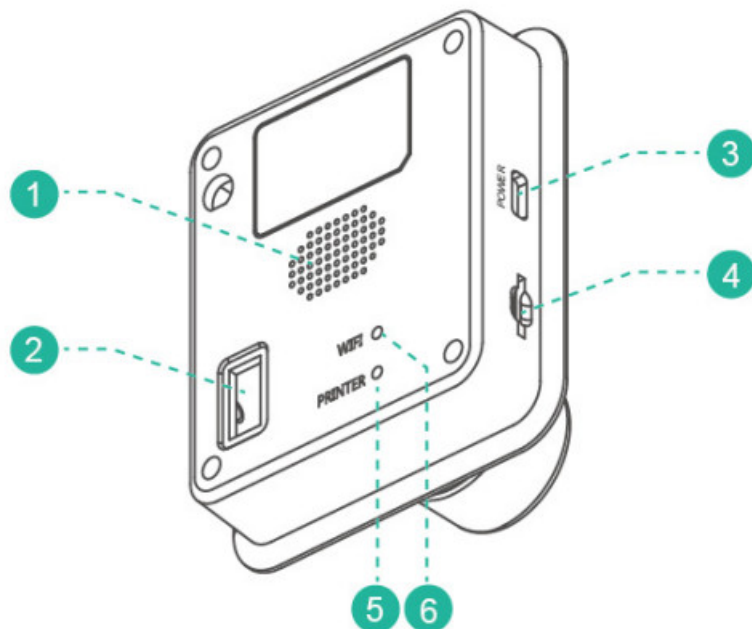

1. speaker
2. usb socket
3. Power socket
4. micro s Card
5. Printer indicator

 Solid Red: Printer Connected
 Flashing Red: Printer Disconnected

6. Wifi indicator

 Solid Green: WiFi Connected
 Flashing Green: WiFi Disconnected

INSTALLATION BRACKET

Assemble the gimbal and tripod

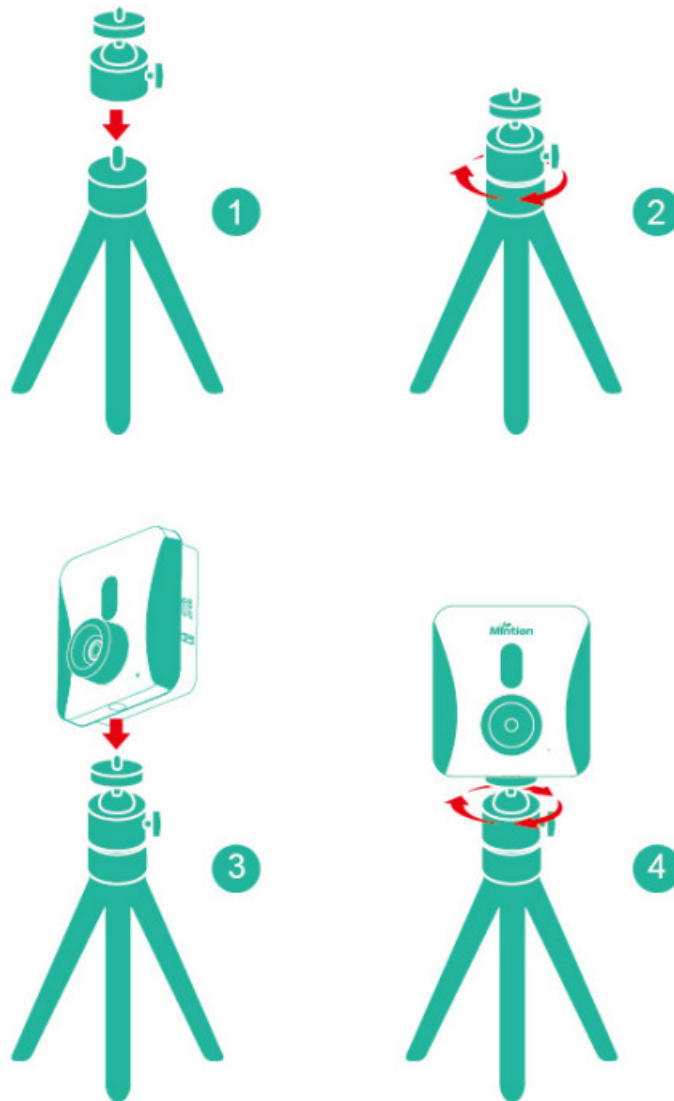

ADD THE CAMERA

Download Beagleprint, Register an account and log in.



<https://mintion-6288.myshopify.com/pages/beagleprint-app-download>

Power up the Camera until you hear the voice prompt “Camera is ready for Wi-Fi configuration”, (expected within 1 minute).

Click + to add the camera and select the “QR Scan Configuration” for WiFi connection.

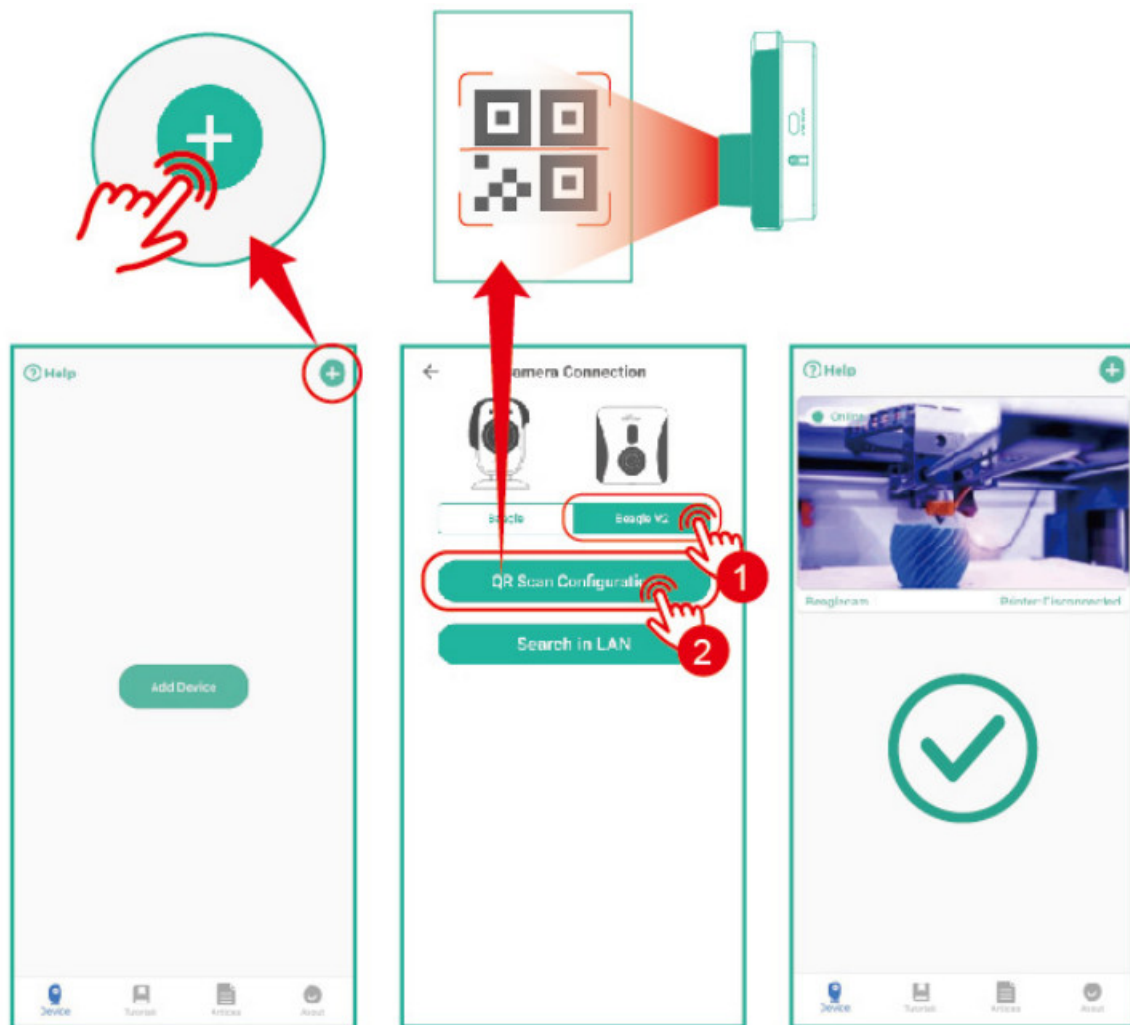

FIRST USE

Click on the device on the device page to enter the device control page and set the printer model

*Click on the corresponding space to perform the operation.

Use a USB cable to connect the.

Camera to the printer USB port "After the printer s started (when the printer screen is operable, th printer is considered to have completed the startup).

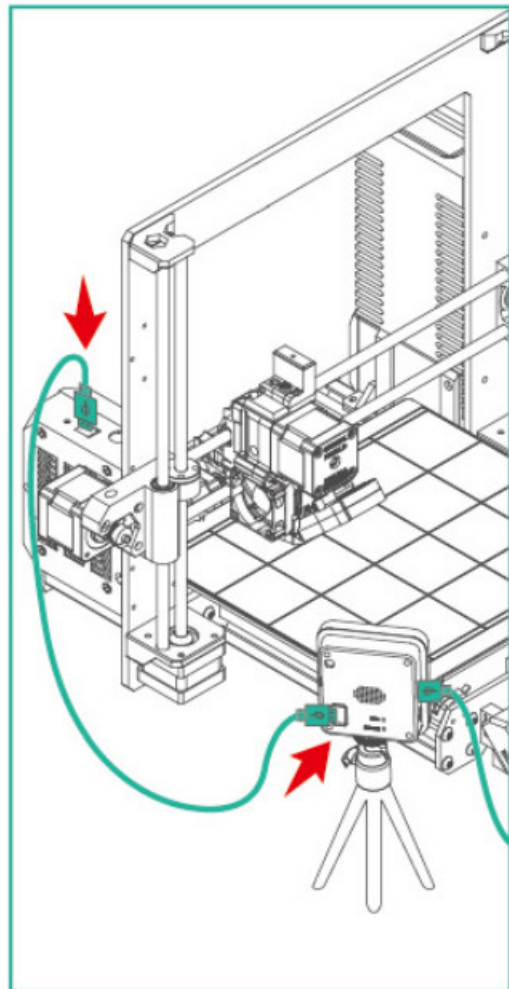
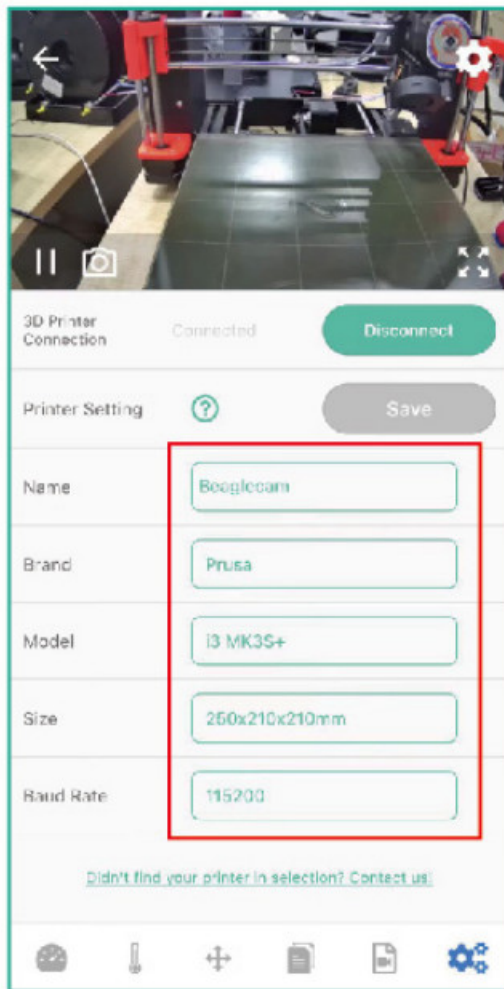

Connect the Camera by clicking the “connect” button to connect the printer.

*After successful connection, the button will change to “Disconnect”. Also, Print off only indicates that there is no current printing process

Click “+”, upload the G-code file, and click “{print icon}” to start printing.

*If your printer is an automatic bed leveling printer, please insert M420 \$1 below G28 in the Star Goodo section of your slicing software to enable automatic bed leveling compensation

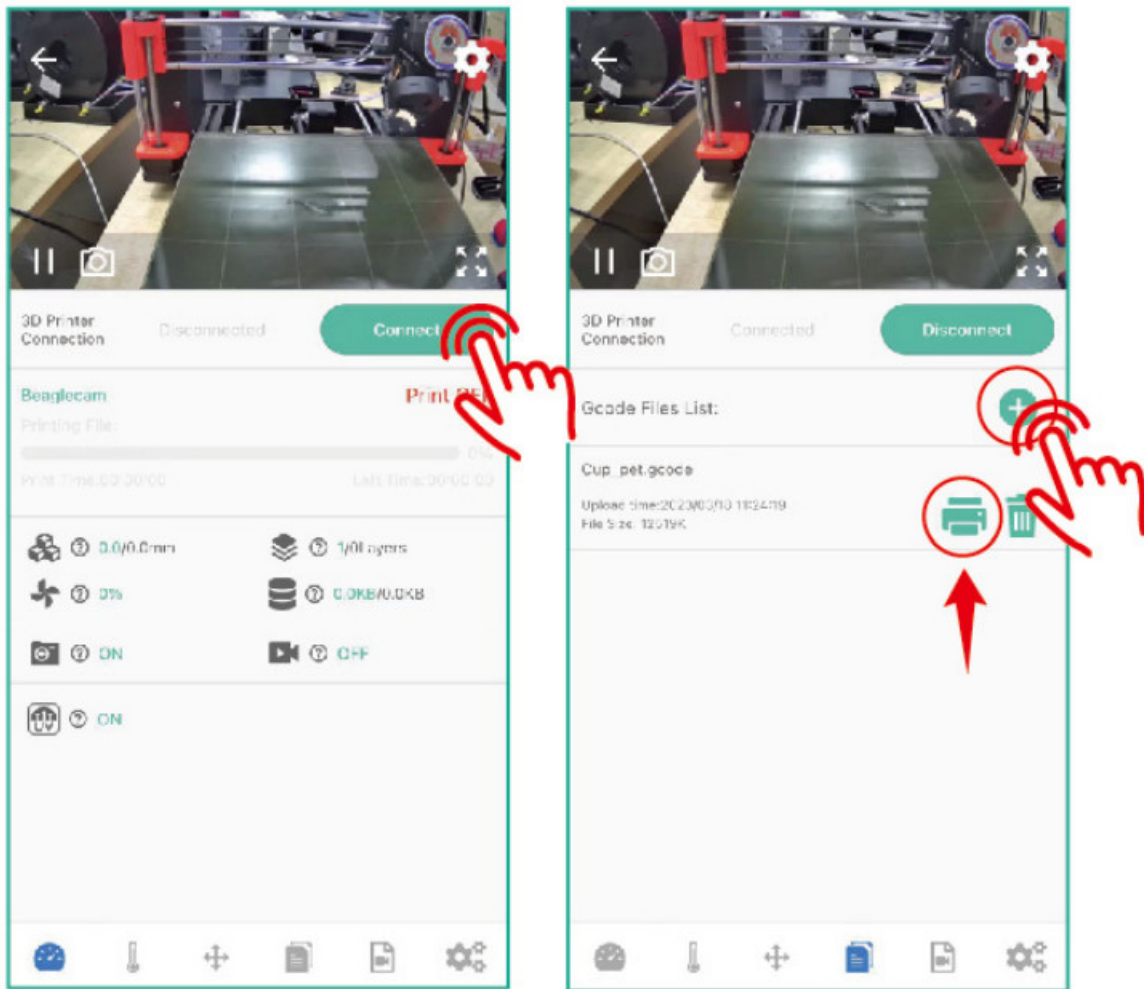

On the dashboard page or device page, you can monitor the progress of the printer's printing task and pause or stop the printing operation.

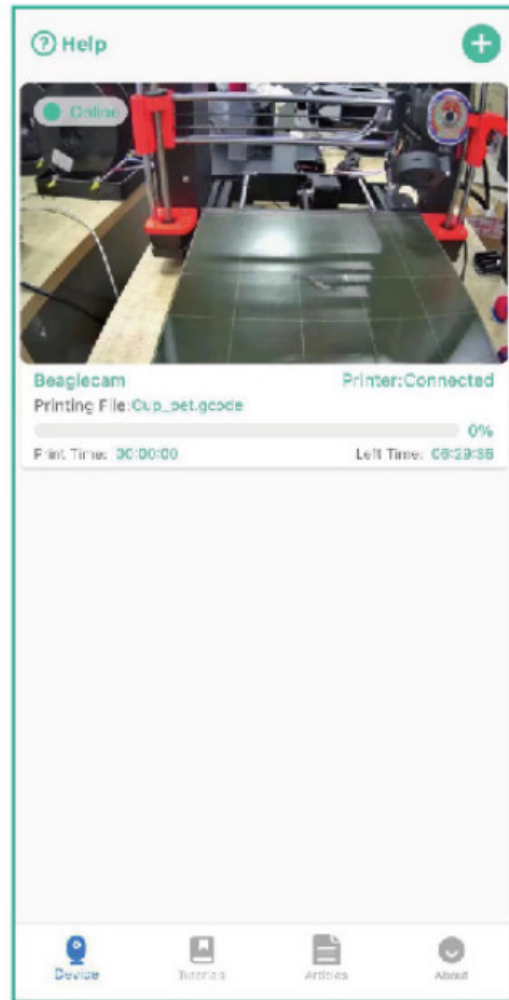
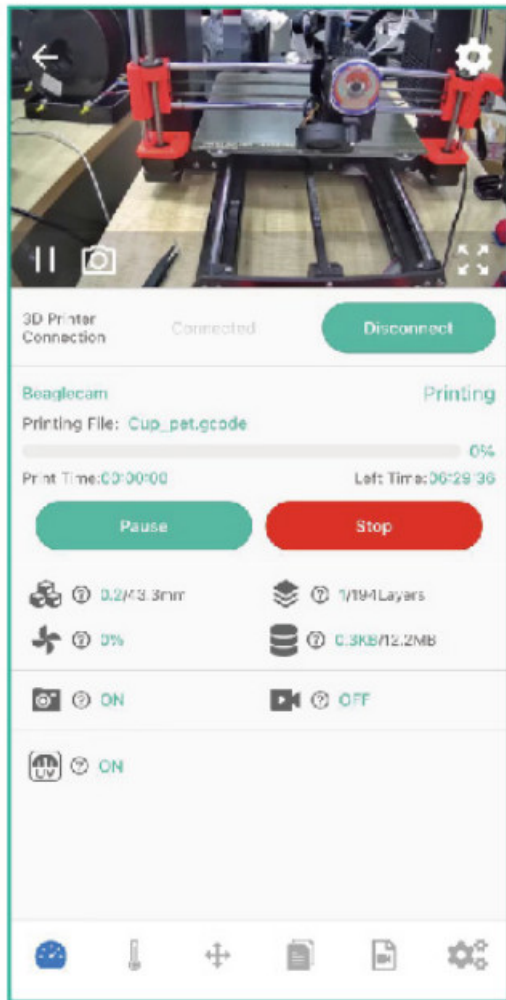

WEB PAGE

In the Beagleprint app, click on Settings, find the IP address in the Camera information page, and use a browser to enter it to access the login page.

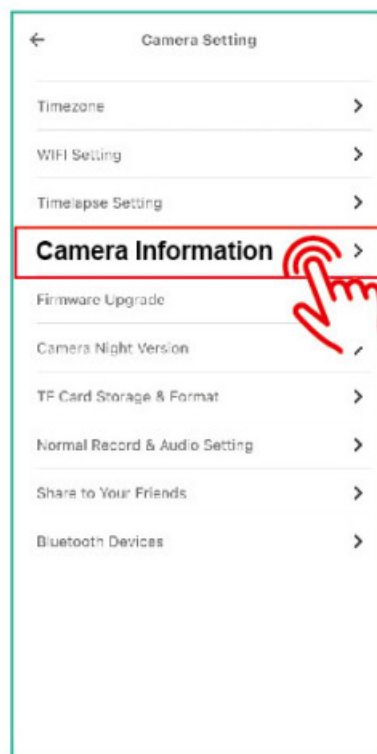
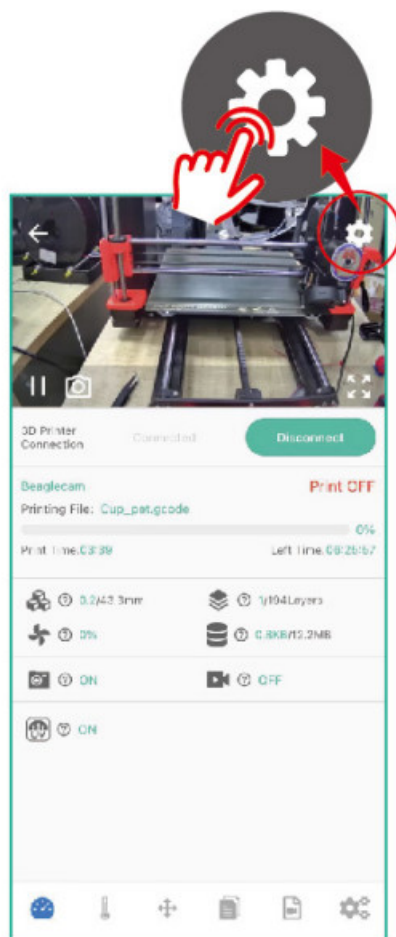

Camera Information	
Camera ID	MKFC-139123-KVXWVY
Camera Model	Beagle
Current Firmware	1.1.9
User Online	1
Mac Address	84:6D:C2:8C:D8:7A
IP Address	192.168.0.15
Subnet Mask	255.255.255.0
Gateway	192.168.0.1
DNS1	192.168.0.1
DNS2	192.168.0.1

Restart Camera

Reset Camera (Saved WiFi)

Reset Camera (No WiFi)

Find the IP address

Enter IP address, Enter the password (default password is "admin") and click the confirm button to log in.

Please sign in

Account: admin

Password: admin

☒ Remember Me

Login

The default account and password of camera is "admin".

"The Camera is connected to the same network (same subnet) as the Computer/tablet/phone using the browser. Once logged in successfully, you can connect to the printer via the *Connect* button in the upper left corner. If it says "Disconnect", it means the camera has been connected to the printer."

Unconnected

Print time: 10:06:10
Print time: 10:06:10

Printed Pause Cancel

Dashboard

Time-lapse Videos

2D Preview

3D Preview

Circle Reading

Setting

3D Model

Temperature Curve

Printable Files List

Upload

File List

Curved_gcode

Upload 2023/05/10 11:24:19 Size 12.20KB

Printer icon with hand cursor

Then, on the Dashboard page, find "Printable Files List", click "Upload", select the G-code file to be uploaded, and click the printer icon to start printing.

"If your printer is an automatic bed leveling printer, please insert M420 S1 below G283 in the Star Geode section"

of your slicing software to enable automatic bed leveling compensation.

On the Dashboard page, find the Status & Control" page, where Yyou can monitor the printing progress, such as the number of layers and height, and pause or cancel printing as needed

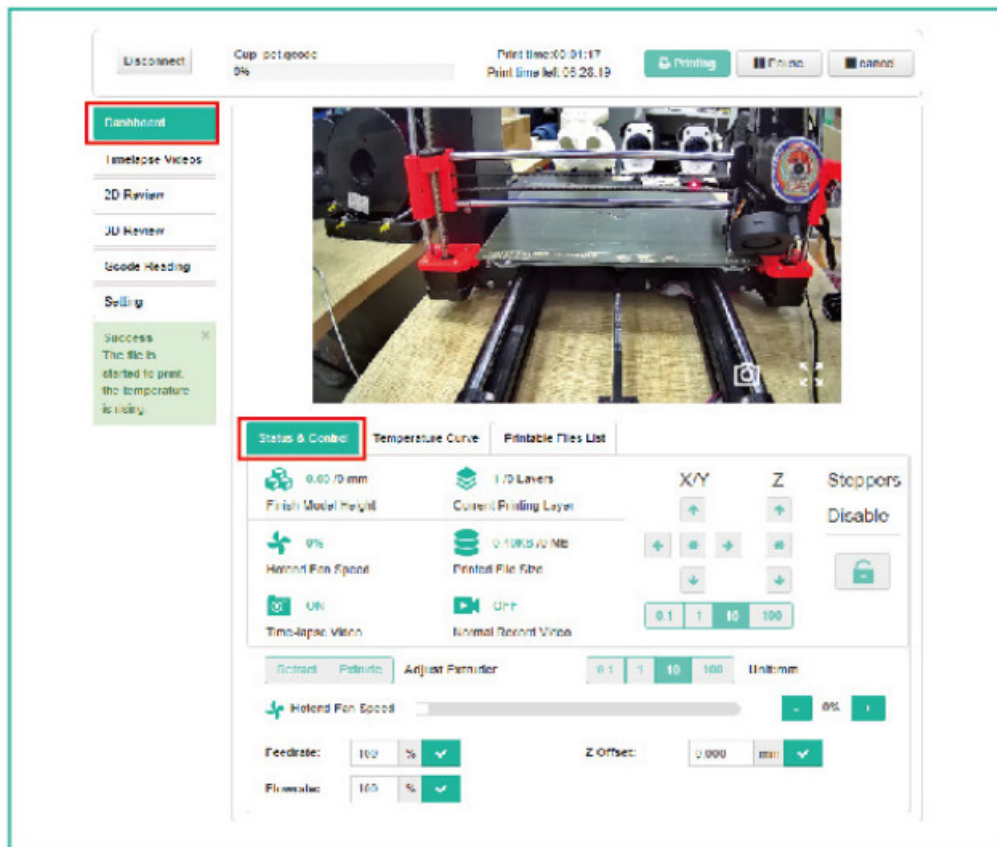

CUSTOMER SUPPORT



<https://mintion-6288.myshopify.com/blogs/guidelines>

Please visit the Mintion official website for more machine usage and maintenance tutorials:



<https://www.facebook.com/groups/mintion>

Join our Facebook group to communicate with us, our users, fans, and other members through Facebook.

FB Group: Mintion Official Group

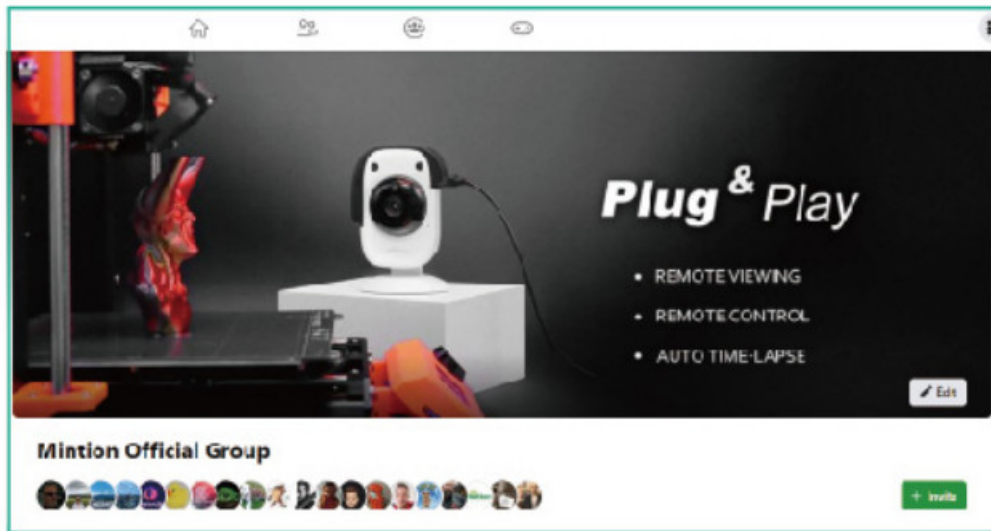

If you need human assistance, you can email: support@mintion.net and we will contact you within 24 hours

ATTENTION

Please DO NOT cut off the power of the Beagle V2 camera when it's connecting to the 3d printer on printing; DO NOT disconnect the camera from the printer when it is connected to the printer and transmit gcode files through the camera for printing. Otherwise, it will cause printing failure and damage the camera's firmware. In this case, the camera cannot work typically; this problem is the user problem, not a quality problem. Hence, please ensure that you cannot disconnect the camera from the power supply and the USB cable connected to the printer when the camera is working, and the 3d printer is printing.

The Beagle camera only supports one printer connection for control, allowing four users to simultaneously log in and access the camera (including mobile phone and computer users). Therefore, please make sure to securely access the device to prevent bad guys from accessing the camera or printer and the environment to cause damage.

At the same time, we recommend that you do not let the 3d printer perform the 3d printing work completely unattended. Please come to the printer and watch the real printing progress of the printer regularly to prevent further deterioration of the situation when an abnormal condition occurs.

This camera shortens the distance between the user and the printer. The user is obliged to ensure the reasonableness and legality of the use of the product and avoid infringement of third-party rights, including but not limited to publicity rights, intellectual property rights, data rights, or privacy rights. At the same time, since the customers' use and storage of this camera are beyond our control, we are not responsible for possible personal injury or property loss.

This manual is for reference only. In any case, we have the right to modify and improve it without notifying users. If you want to know the latest instruction manual, you can go to the official website for more information.

FCC WARNING STATEMENT

Changes or modifications not expressly approved by the party responsible for compliance could void the user's authority to operate the equipment. This equipment has been tested and found to comply with the limits for a Class B digital device, pursuant to Part 15 of the FCC Rules. These limits are designed to provide reasonable protection against harmful interference in a residential installation.

This equipment generates uses and can radiate radio frequency energy and, if not installed and used in accordance with the instructions, may cause harmful interference to radio communications. However, there is no guarantee that interference will not occur

in a particular installation. If this equipment does cause harmful interference to radio or television reception, which can be determined by turning the equipment off and on, the user is encouraged to try to correct the interference by one or more of the following

measures: dealer or an experienced radio/TV technician for help.

- Reorient or relocate the receiving antenna.

- Increase the separation between the equipment and receiver.
- Connect the equipment into an outlet on a circuit different from that to which the receiver is connected.
- Consult the dealer or an experienced radio/TV technician for help.

FCC RADIATION EXPOSURE STATEMENT

The antennas used for this transmitter must be installed to provide a separation distance of at least 20 cm from all persons and must not be co – located for operating in conjunction with any other antenna or transmitter.

SPECIFICATION

Model	Beagle V2
Video Compression	H.264/MJPEG
Video Resolution	1080P
Night Version	Yes
Frame Rate	Upto 25fps
Auto Time-lapse Video	Yes
WiFi Connectivity	Supports 2.4GHz/5GHz
Compatibility	Marlin 3D Printers
Connect to Printer	USB Cable
Files Storage	Micro SD Card
Power Source	Plug-in
Lens Adjustable	Manual Knob
1/4" Screw for Tripod	Yes



www.mintion.net

SHENZHEN MINTION TECHNOLOGY CO., LTD

Distribution: sales@mintion.net

Support: support@mintion.net

Facebook Group: Mintion Official Group



Documents / Resources

	Mintion Upgraded 3D Printer Camera [pdf] User Manual Upgraded 3D Printer Camera, Upgraded 3D, Printer Camera, Camera
---	---

References

- [User Manual](#)