



# Mintion Beagle 3D Printer Camera User Manual

[Home](#) » [Mintion](#) » Mintion Beagle 3D Printer Camera User Manual 

## Contents

- [1 Mintion Beagle 3D Printer Camera](#)
- [2 PACKING LIST](#)
- [3 SPECIFICATION](#)
- [4 CAMERA INTRODUCTION](#)
- [5 CONNECTION](#)
- [6 APP DOWNLOAD & REGISTRATION](#)
- [7 USE THE APP](#)
- [8 ATTENTION](#)
- [9 FCC WARNING STATEMENT](#)
- [10 FAQ](#)
- [11 GUIDELINES OF BEAGLE CAMERA](#)
- [12 Documents / Resources](#)
- [13 Related Posts](#)



**Mintion Beagle 3D Printer Camera**



Distribution: [sales@mintion.net](mailto:sales@mintion.net)

Support: [support@mintion.net](mailto:support@mintion.net)

FB Group: Mintion Official Group (Beagleprint)



**PACKING LIST**



Beagle camera



Power  
Plug x1



Type C Cable  
1.5M x1  
(For power)



USB-Micro-B  
Cable 1M x1  
(Connect to printer)



Micro SD  
Card x1  
(Insert in camera)



Reset  
Needle x1



Quick Guide  
Manual x1

## SPECIFICATION

Part Number	Beagle
Night Version	Yes
Frame Rate	Up to 25fps
Upload Printable File	Yes, Only geode files
Compatibility of 3D Printers	Marlin firmware
Videos/Printable Files Storage	Micro SD Card
Connect to Printer	USS Cable
Video Compress	H.264/MJPEG
Camera Resolution	Upto 1080P
Auto Time-lapse Video	Yes
Temperature Moni tor	Yes, for Hot End & Hot Bed
WiFi Connectivity	Supports 2.4 GHz 802.11gin
Power Source	Plug-in
Weight	130g

## CAMERA INTRODUCTION

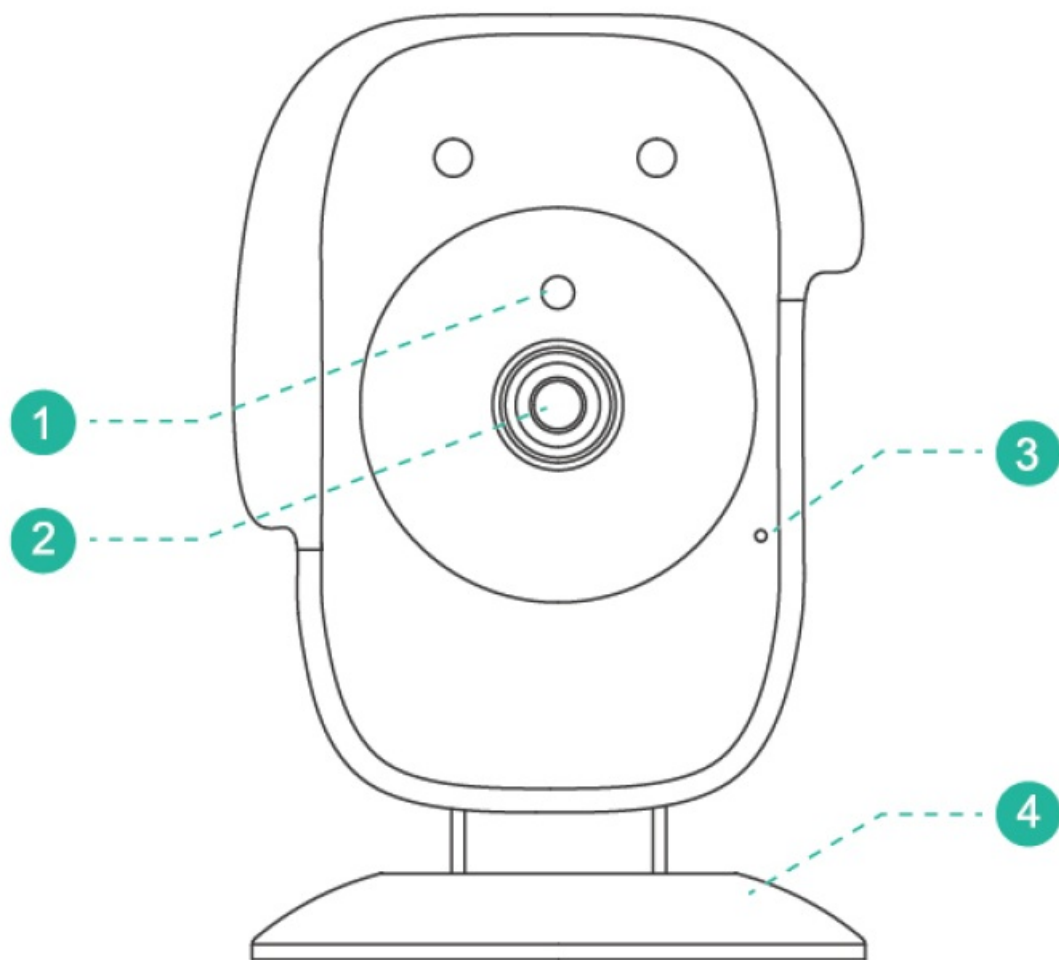

- 1. IR-Cut Sensor
- 2. Lens
- 3. Microphone
- 4. Camera Base

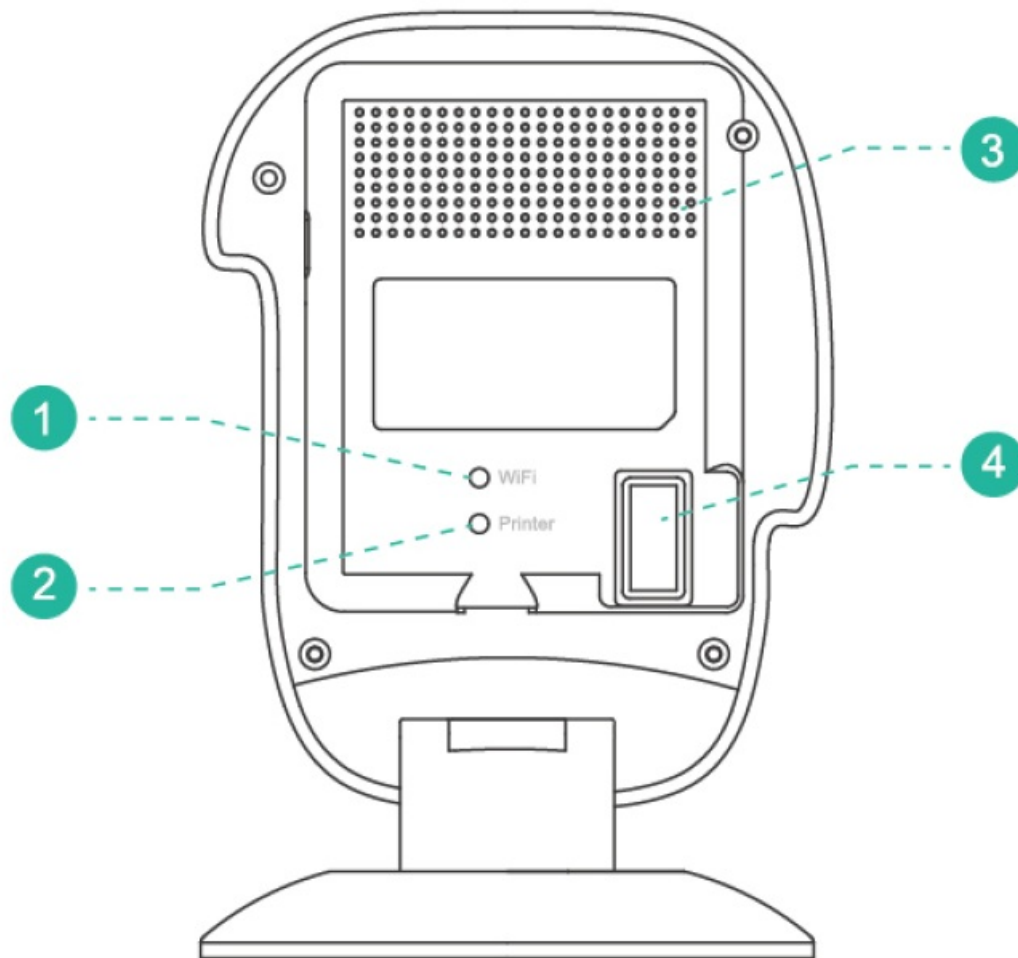

1. WiFi Indicator
  - Solid Green:**  
WiFi connected
  - Flashing Green:**  
WiFi disconnected
2. Printer Indicator
  - Solid Red:**  
Printer connected
  - Flashing Red:**  
Printer disconnected
3. Speaker
4. USS Socket

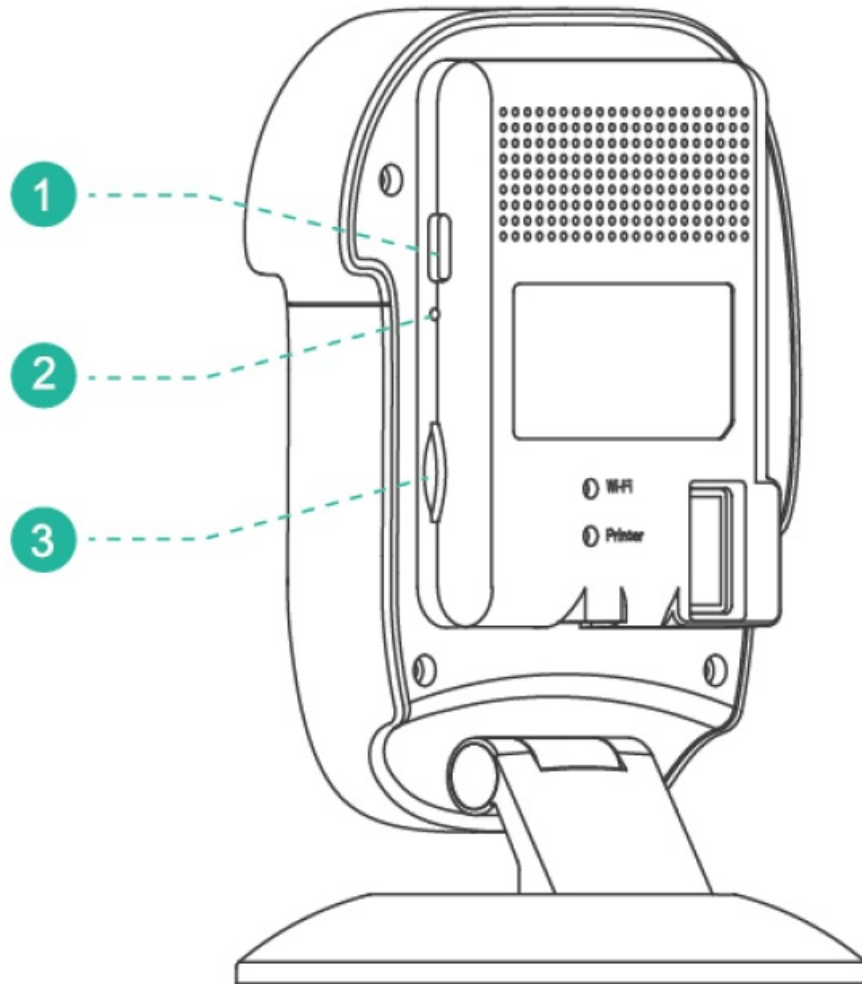

1. Type-C Socket (Power)
2. Plug and hold for 5 seconds, and you will hear the voice of “Successfully resetting the camera”, then the camera will be reset and restart.
3. Micro SD Slot

## CONNECTION

### Connecting Cables

Plug the power cable into the camera and the power adaptor, then into a power outlet, plug the USB-Micro-B Cable into the camera and the 3d printer, as shown in the figure below.

(The camera will take 1-2 minutes when power-up, don't cut off the power during this period.)

### Power outlet

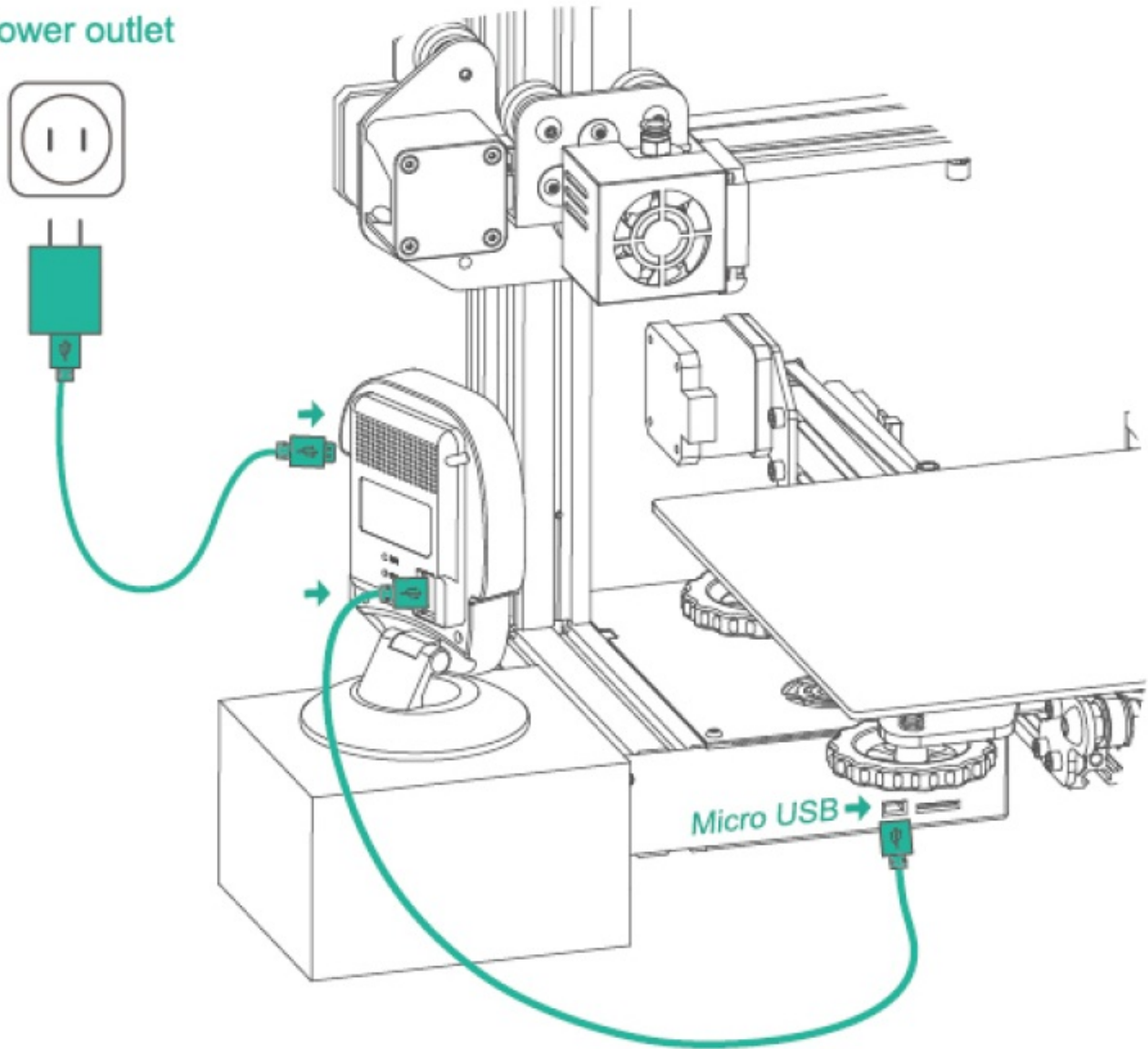

### Connect to Printer

Plug the USB-Micro USB cable into the camera and the printer, as shown in the figure above.

### Put on Camera

You could put the camera onto the box on the printer's front side, as shown below.

\*You need to use a USB 2.0 Hi-Speed cable if your printer is with Hi-Speed 2.0 slot.  
(Please make sure your cable has the function of transferring data)

### APP DOWNLOAD & REGISTRATION

Please scan the QR Code to reach the App download page, then download from App Store, Google Play or download the APK directly.

After download, click to run the app and make the registration.



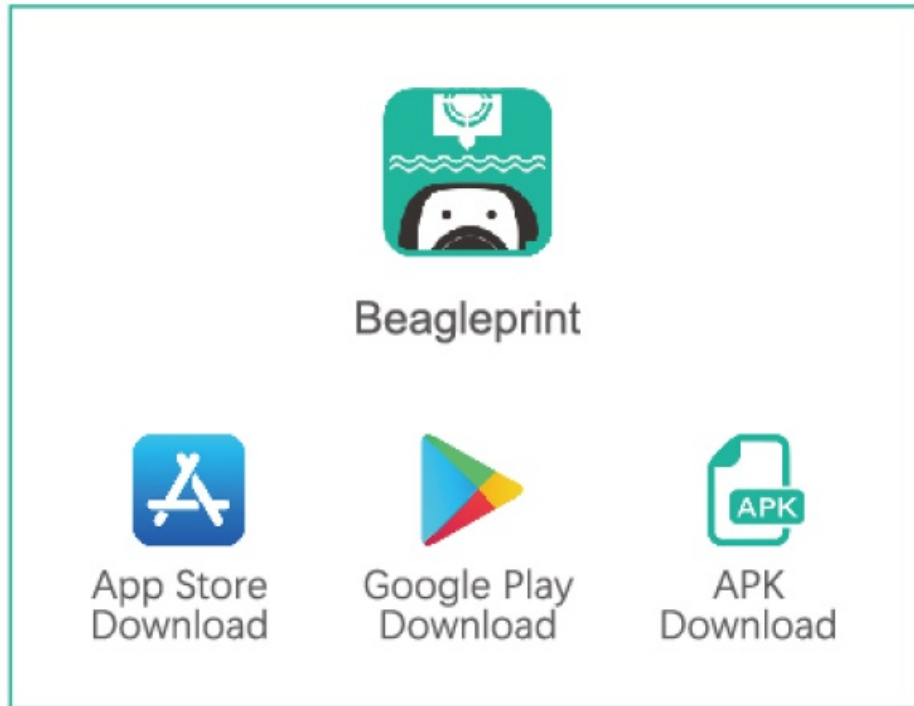

## USE THE APP

Use your phone to connect to the camera hotspot.

Please DO NOT cut off the power of the Beagle camera when it's working; DO NOT disconnect the camera from the printer when it is connected to the printer and transmit printable files through the camera for 3d printing.

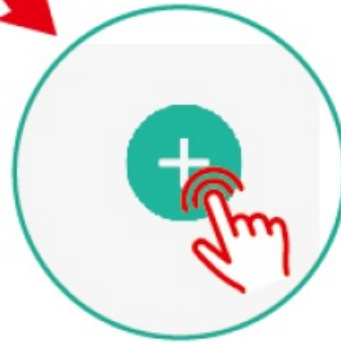
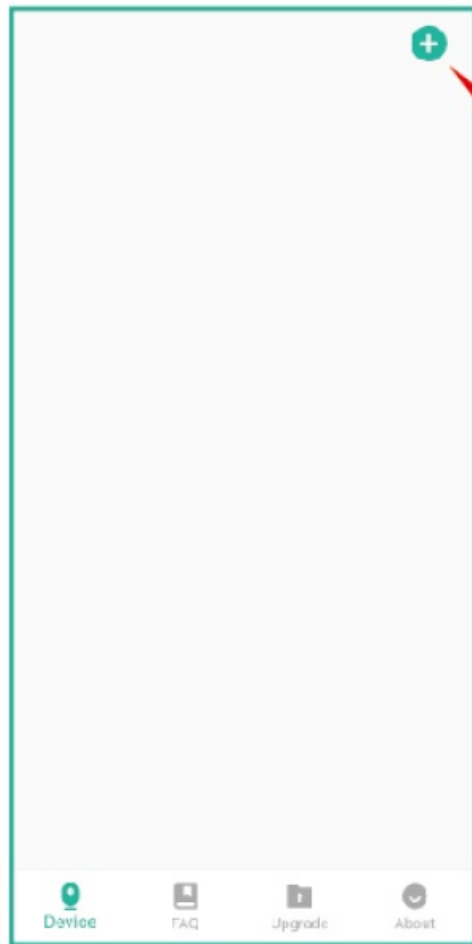

Connect the Camera to WiFi Network

After power up the camera, click to run the “**Beagleprint**” app, then click “+” icon to add the camera.

## QR Scan Configuration

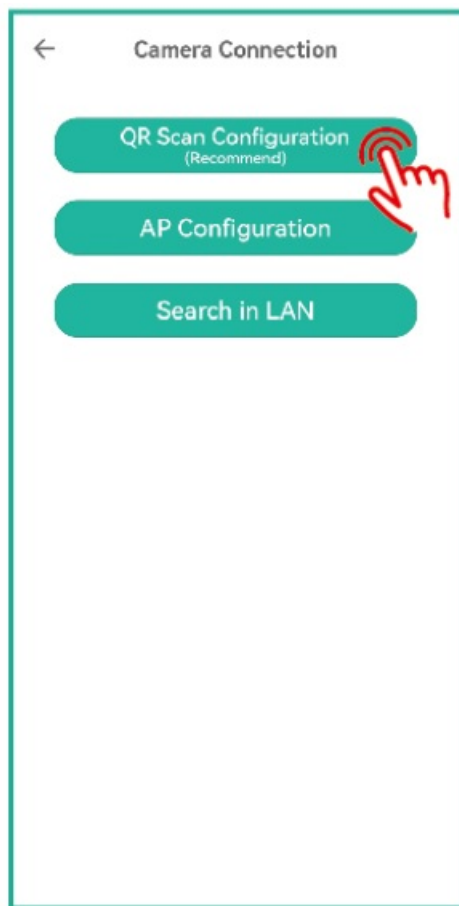

Select the  
**"QR Scan Configuration"**  
to add the camera.

Make sure the power is not  
being cut off during the  
configuration.

Power up the camera and  
ensure you have heard the  
remind voice. If not, please  
select you didn't hear and  
reset the camera.

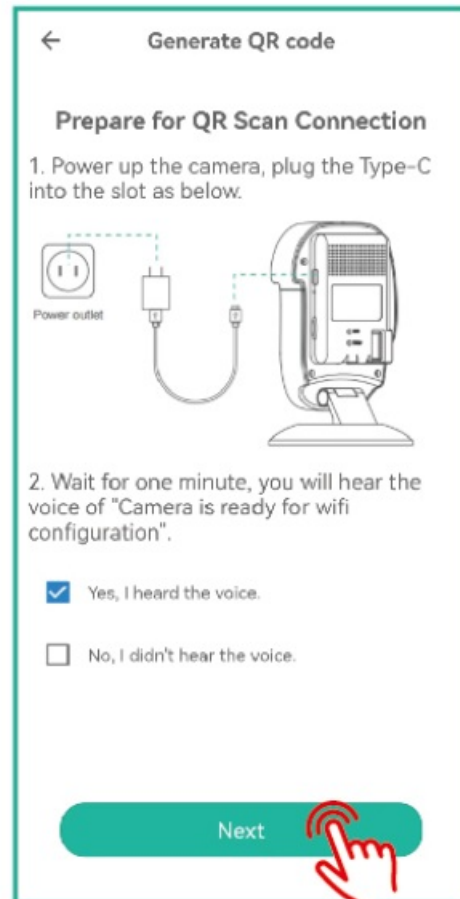

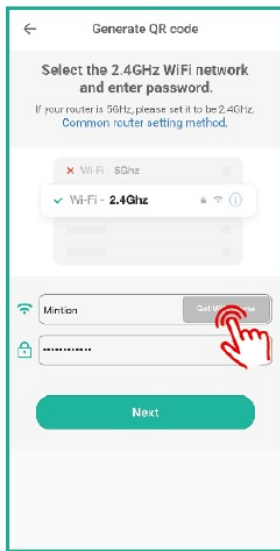

With the permission, the app will automatically get the WiFi name of your phone connected. Please enter the exact password of WiFi.

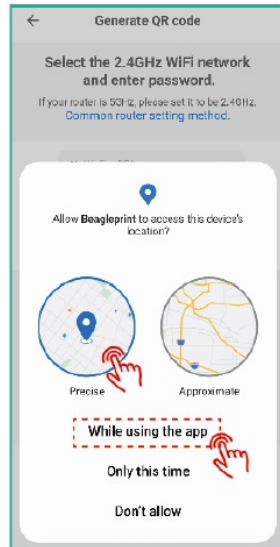

Please give the permissions to the app, especially for the Precise Location.

⚠ Main reason fails to WiFi connection is the wrong password.



Hold the phone straightly in the front of Beagle camera about 20cm distance, then you will hear a prompt sound of scanning, then Click to next.

The camera will automatically connect to the WiFi network. Please wait for 1-2 minutes. After connection, the camera will switch automatically.



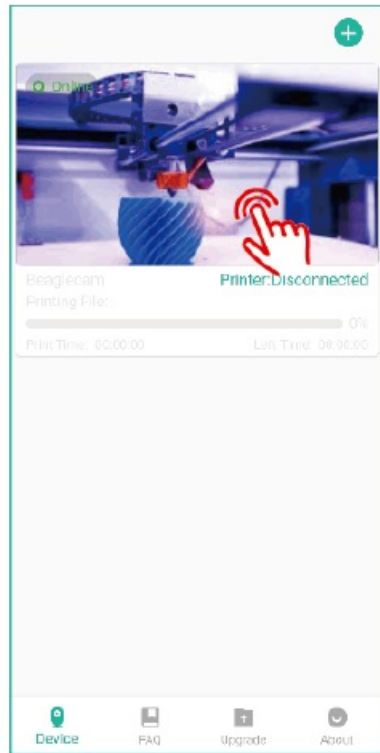

◀ The camera is Online and click to log in to check the video.

You can find the video stream and printer status. ▶

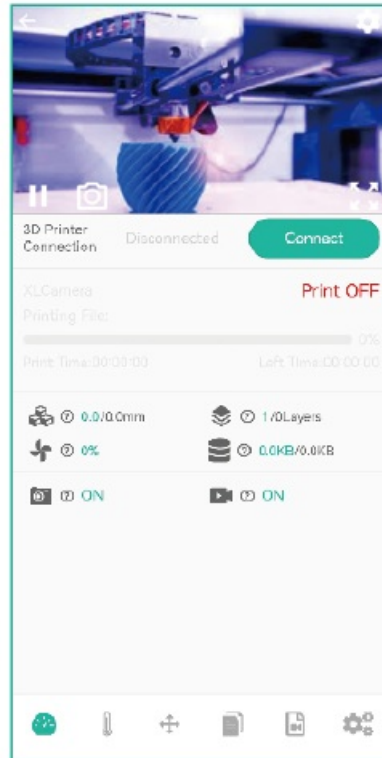

## ATTENTION

Please DO NOT cut off the power of the Beagle camera when it's connecting to the 3d printer on printing; DO NOT disconnect the camera from the printer when it is connected to the printer and transmit geode files through the camera for printing. Otherwise, it will cause printing failure and damage the camera's firmware. In this case, the camera cannot work typically; this problem is the user problem, not a quality problem. Hence, please ensure that you cannot disconnect the camera from the power supply and the USB cable connected to the printer when the camera is working, and the 3d printer is printing.

The Beagle camera only supports one printer connection for control, allowing four users to simultaneously log in and access the camera (including mobile phone and computer users). Therefore, please make sure it's securely accessing the device to prevent bad guys from accessing the camera or printer and the environment to cause damage.

At the same time, we recommend that you do not let the 3d printer perform the 3d printing work completely unattended. Please come to the printer and watch the real printing progress of the printer regularly to prevent further deterioration of the situation when an abnormal condition occurs.

This camera shortens the distance between the user and the printer.

The user is obliged to ensure the reasonableness and legality of the use of the product and avoid infringement of third-party rights, including but not limited to publicity rights, intellectual property rights, data rights, or privacy rights. At the same time, since the customers' use and storage of this camera are beyond our control, we are not

responsible for possible personal injury or property loss.

This manual is for reference only. In any case, we have the right to modify and improve it without notifying users. If you want to know the latest instruction manual, you can go to the official website for more information.

## **FCC WARNING STATEMENT**

Changes or modifications not expressly approved by the party responsible for compliance could void the user's authority to operate the equipment. This equipment has been tested and found to comply with the limits for a Class B digital device, pursuant to Part 15 of the FCC Rules. These limits are designed to provide reasonable protection against harmful interference in a residential installation.

This equipment generates uses and can radiate radio frequency energy and, if not installed and used in accordance with the instructions, may cause harmful interference to radio communications.

However, there is no guarantee that interference will not occur in a particular installation. If this equipment does cause harmful interference to radio or television reception, which can be determined by turning the equipment off and on, the user is encouraged to try to correct the interference by one or more of the following measures: dealer or an experienced radio/TV technician for help.

- Reorient or relocate the receiving antenna.
- Increase the separation between the equipment and receiver.
- Connect the equipment into an outlet on a circuit different from that to which the receiver is connected.
- Consult the dealer or an experienced radio/TV technician for help.

## **FCC RADIATION EXPOSURE STATEMENT**

The antennas used for this transmitter must be installed to provide a separation distance of at least 20 cm from all persons and must not be co – located for operating in conjunction with any other antenna or transmitter.

## **FAQ**

1. What's the maximum storage of the TF card I can use for this camera?

The maximum storage is 128GB.

2. Whats the camera lens? And what's the distance?

The beagle camera is using the fixed lens, and the focus distance is 20cm.

3. How can I connect the Beagle camera to the printer?

We provide the default micro USB to USB cable in box to connect to the printer. if your printer is using a Hi-speeding 2.0 socket, you have to purchase one Hi-speeding 2.0 to USB cable.

Plug the USB side cable into the USB socket on the back panel of the camera. and the micro USB is plugged into the printer. After the camera is connected to the WiFi, then click to run the app Bealgeprint and click the "Connect" button under the camera review window. Before connecting to the printer. you need to select the brand and model of printer to confirm the printed size

4. Why I can't connect the camera to my 3d printer?

There're few reasons to check on this problem, but make sure your 3d printer is power up:

1. Ensure the USB cable from the Beagle camera to your 3d printer is supported to transmit the data, not just for charging.
2. Please check if your 3d printer is on the compatible 3d printers list, while the Beagle camera is an

ongoing project, we will upgrade the firmware to more 3d printers on compatibility regularly.

5. Why my Beagle camera is not generate the time-lapse video?

Please ensure that the time-lapse video function is in “ON” status, in the default setting, it’s on. And please check what slicer you are using, now the Beagle camera is compatible with Ultimate Cura, Creativ Slicer, Simplify3D, Prusaslicer and Superslicer. If you are using a different slicer, and the system of the camera is not able to identify the layer description. then it won’t send the commands to the printer to move the hotend to capture an image, then it won’t generate the time-lapse video automatically.

## **GUIDELINES OF BEAGLE CAMERA**



### QR Scan Configuration for wifi Network



### Mounting brackets of Beagle camera



### Firmware Upgrade



### Setup for Time-lapse Video



### IP Address on PC



### 3D Printers of Compatibility



### WiFi Connection by SD Card



### Adjust the lens of Camera



### Unboxing and Setup



## Documents / Resources

	<p><a href="#">Mintion Beagle 3D Printer Camera</a> [pdf] User Manual Beagle, 3D Printer Camera, Beagle 3D Printer Camera, Printer Camera, Camera</p>
---	---