



Minoston MT10N Countdown Timer Switch User Manual

[Home](#) » [Minoston](#) » Minoston MT10N Countdown Timer Switch User Manual

Minoston®

Countdown Timer Switch • MT10N



- Switch x1
- Wiring x1
 - Screws x2
 - Faceplate x1

Contents [[hide](#)

- 1 Specifications:
- 2 FCC
- 3 OPERATIONS
- 4 Documents / Resources
 - 4.1 References
- 5 Related Posts

Specifications:

Indoor use in dry location

Model: MT10N

Power: 120VAC, 60Hz

Tungsten: 1200W

Resistive: 1800W

Motor: 1/2 HP

Time Delay: 5, 10, 30, 60 mins, 2 or 4 hours

Humidity: 95% RH, non-condensing

Operating Temperature: 32° to 131° F (0° to 55° C

Indoor use in dry location

FCC

This device complies with part 15 of the FCC and Industry Canada license-exempt RSS standard(s). Operation is subjected to the following two conditions:

(1) this device may not cause harmful interference, and (2) this device must accept any interference received, including interference that may cause undesired operation.

FCC NOTE: The manufacturer is not responsible for any radio or TV interference caused by unauthorized modifications to this equipment. Such modifications could void the user's authority to operate the equipment.

— Reorient or relocate the receiving antenna.

— Increase the separation between the equipment and receiver.

— Connect the equipment into an outlet on a circuit different from that to which the receiver is connected.

— Consult the dealer or an experienced radio/TV technician for help.

NOTE: This equipment has been tested and found to comply with the limits for a Class B digital device, pursuant to Part 15 of the FCC Rules. These limits are designed to provide reasonable protection against harmful interference in a residential installation. This equipment generates, uses, and can radiate radio frequency energy and, if not installed and used in accordance with the instructions may cause harmful interference to radio communications. However, there is no guarantee that interference will not occur in a particular installation. If this equipment does cause harmful interference to radio or television reception, which can be determined by turning the equipment off and on, the user is encouraged to try to correct the interference by one or more of the following measures:

Important note: To comply with the FCC RF exposure compliance requirements, no change to the antenna or the device is permitted. Any change to the antenna or the device could result in the device exceeding the RF exposure requirements and void the user's authority to operate the device



CAUTION – PLEASE READ!

This device (MT10N) is intended for installation in accordance with the National Electric Code and local regulations in the United States, or the Canadian Electrical Code and local regulations in Canada. If you are unsure or uncomfortable about performing this installation consult a qualified electrician.



WARNING – SHOCK HAZARD

TURN OFF THE POWER to the circuit for the switch and lighting fixture at the service panel (circuit breaker) prior to installation.

ALL WIRING CONNECTIONS MUST BE MADE WITH THE POWER OFF to avoid personal injury and/or damage to the switch.



OTHER WARNINGS

Risk of Fire

Risk of Electrical Shock

Risk of Burns



WARRANTY

Our Products warrants this product to be free from manufacturing defects for a period of one year from the original

date of consumer purchase. This warranty is limited to the repair or replacement of this product only and does not extend to consequential or incidental damage to other products that may be used with this product. This warranty is in lieu of all other warranties, expressed or implied. Some states do not allow limitations on how long an implied warranty lasts or permit the exclusion or limitation of incidental or consequential damage, so the above limitations may not apply to you. This warranty gives you specific rights, and you may also have other rights which vary from state to state.

Part 1. Installation



CHANGING THE COLOR OF THE PADDLE(OPTIONAL)

This step is optional. Before you start you may want to change the color of the paddle to match your wallplate or decor.

1. Push side tabs in on one side and then the other to release the paddle. Lift the cover-up and off.
2. Simply put the new paddle onto the switch by side tabs and snap securely into place. Once this step has been completed please proceed to part 2 wiring.

DESCRIPTION

The MT10N is a timer switch with 6 preset time buttons and 1 Manual ON button. All Loads connected to this timer will automatically turn OFF when the selected time expires. The 6 selectable times is 5 Min, 10 Min, 30 Min, 60 Min, 2 Hours, and 4 Hours

FEATURES

Easily replaces a standard single-pole Light or Fan switch.

Compatible with most types of lights.

Attractive blue LED indicators are conveniently located next to each button for Indoor use only.



Scan to view installation guide

WARNING

Read and understand these instructions before installing. It is recommended that a qualified electrician performs this installation. Make sure to turn off the circuit breaker or fuse(s) and make sure power is off before wiring the device. This device is intended for installation in accordance with the National Electric Code and local regulations. Use Copper wires ONLY

OPERATIONS

- Preset Buttons: The LED indicator will blink twice to confirm each button press.
- There are 6 buttons with preset times of 5 Min, 10 Min, 30 Min, 60 Min, 2 Hours, and 4 hours.
- While the Load is OFF, press and release the button with the desired time once to turn the Load on for that selected amount of time.
- When the time expires, the Load will automatically turn off.
- While the Load is ON, press and release the button with the desired time once to restart the countdown with the newly selected time.
- Manual ON Button: The LED indicator will blink 3 times to confirm each button press.
- The Manual ON button is the large button located above the preset buttons.
- While the Load is OFF, press and release the Manual ON button to turn the Load ON with the last selected timer preset.
- While the Load is ON, press and release the Manual ON button to override the timer and turn the Load OFF.
- To hold the Load ON: Press and hold the Manual ON button for 3 seconds.
- The load will turn ON and stay ON. The timer WILL NOT turn the Load OFF.
- Press and release the Manual ON button to turn the Load OFF.
- Press and release the button with the desired time once to keep the Load on for that selected amount of time.
- LED Light: Default, the LED indicator light next to each selected button blinks twice each time it is pressed to mark the time selected

HOW TO INSTALL THE WIRES

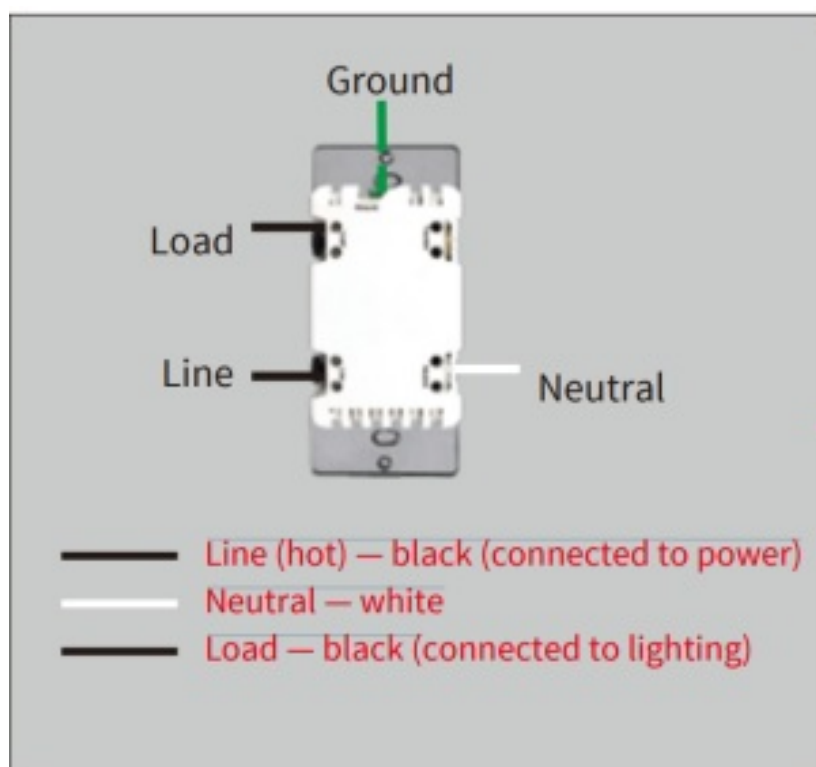

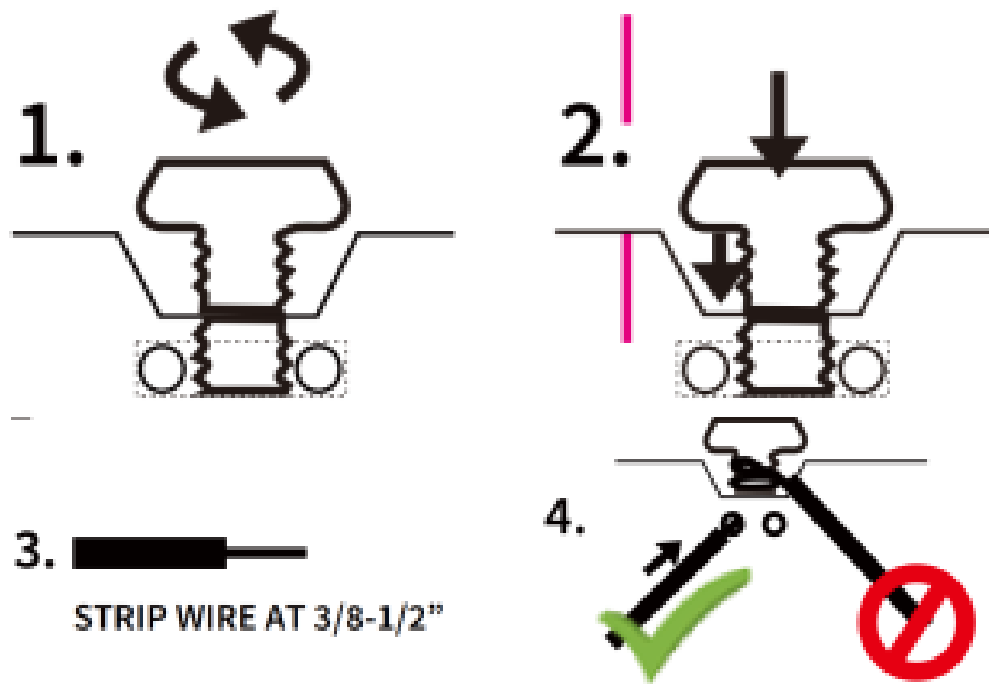

1. Unscrew: carefully turn the screw counterclockwise to leave enough space for the wire to be inserted. Do not unscrew the screws completely.
2. Press down: Once loosened, use your finger so it catches the thread.
3. Insert the wire: make sure the wire is completely straight, then insert it into the terminal while holding down the screw. Do not wrap the wire around the screw!
4. Tighten: Turn the screw clockwise to tighten the wire. Make sure the wires are locked!

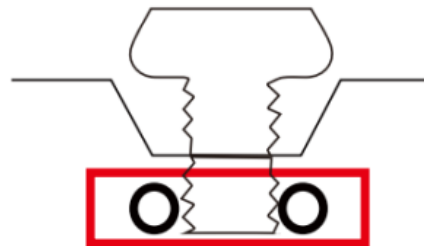

Note: There are 2 holes for each terminal that can be used in the connection. You can use a jumper wire or the second hole at the terminal to connect.

Single-pole wiring

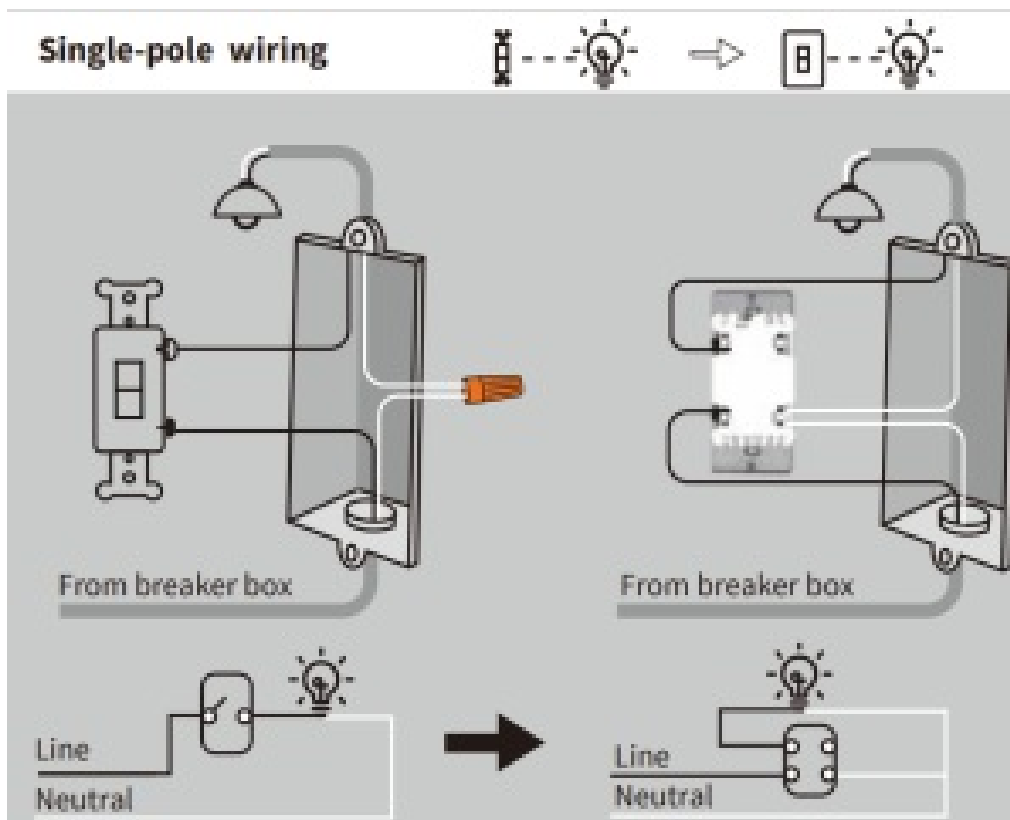

1. Tool: Please prepare a flat head screwdriver. Single-pole wiring
2. Turn power OFF at circuit breaker or fuse box.

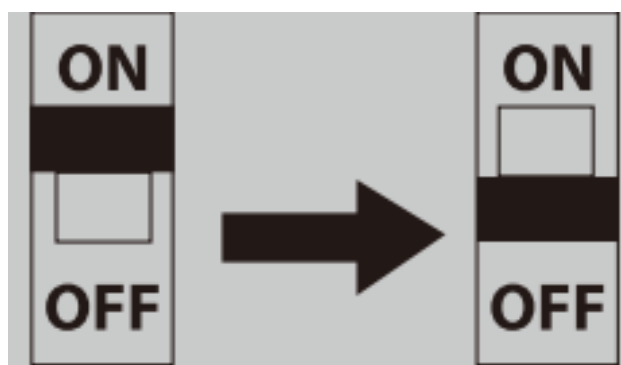

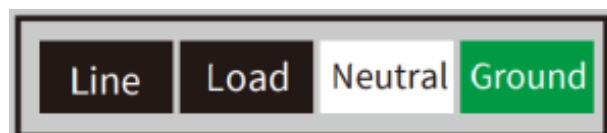

3. Remove wallplate.
4. Remove the switch mounting screws.
5. Disconnect the wires and label them after removing the old switch.(Please use our sticker)



6. Carefully remove the switch from the switch box. (DO NOT disconnect the wires.)
7. There are up to five screw terminals on the smart switch, these are marked (Please check <HOW TO INSTALL THE WIRES>)
8. Fix the wallplate with screws after wiring succeed. (Please use our screws.)
9. The Ground was excluded from the diagram to simplify the illustration. Please Make sure all ground wires are connected to all switches respectively.

• Please contact us at ask@minoston.com if you have any questions during installation

	<p>Minoston MT10N Countdown Timer Switch [pdf] User Manual MT10N, Countdown Timer Switch</p>
	<p>Minoston MT10N Countdown Timer Switch [pdf] Instruction Manual MT10N Countdown Timer Switch, MT10N, Countdown Timer Switch, Timer Switch, Switch</p>
	<p>MINOSTON MT10N Countdown Timer Switch [pdf] User Manual MT10N Countdown Timer Switch, MT10N, Countdown Timer Switch, Timer Switch, Switch</p>

References

- [M Minoston |](#)