

MINISO A132 Sanrio Characters Bluetooth Speaker



MINISO A132 Sanrio Characters Bluetooth Speaker User Manual

[Home](#) » [MINISO](#) » MINISO A132 Sanrio Characters Bluetooth Speaker User Manual 

Contents

- [1 MINISO A132 Sanrio Characters Bluetooth Speaker](#)
- [2 PRODUCT PARAMETERS](#)
- [3 PRODUCT OVERVIEW](#)
- [4 FUNCTIONS](#)
- [5 CONNECT PAIR OF DEVICES](#)
- [6 ACCESSORIES](#)
- [7 TROUBLESHOOTING](#)
- [8 Documents / Resources](#)
 - [8.1 References](#)
- [9 Related Posts](#)

MINISO

MINISO A132 Sanrio Characters Bluetooth Speaker



PRODUCT PARAMETERS

Bluetooth	V5.0
Pairing Name	MINISO-A132
Charging Input	5V = 500mA
Battery	3.7V, 700mAh
Charging Port	Type-C
Transmission Distance	Around 10m
Music Playback Time	Around 4H (70% Volume)
Charging Time	Around 2H

PRODUCT OVERVIEW

1. Power Button
2. Volume+
3. Volume-
4. Illumination Light
5. Type-C Charging Port
6. Indicator Light
7. TF Card Slot

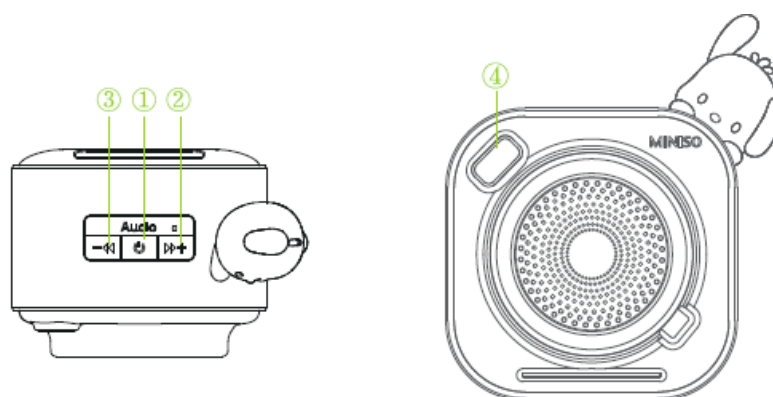

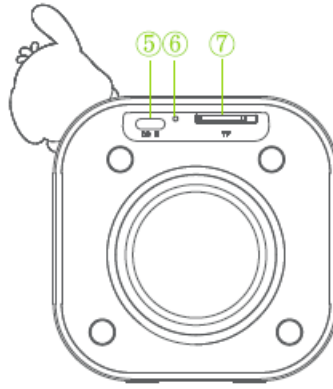

FUNCTIONS

Function	Instructions
Power Button	Long press to turn on/off, short press to play/pause
Volume+ Button	Short press to turn volume up, long press to move to previous track
Volume- Button	Short press to turn volume down, long press to move to next track
Illumination Light	Double press on power button
Charging Indicator Light	When charging red light turns on, when fully charged the light turns off
PreviousTrack	Insert TF card to play audio file inside

CONNECT PAIR OF DEVICES

You need to prepare a pair of the same model (you need to buy the second one separately). There are two methods to mutual connection.

1. Method 1: Fi rat connects to a device, then connects the two speakers to each other.
2. Method 2: First connect tile two speakers to each other, then connect to a device.
 1. Step of Mell'iod 1 :1. Turn on any of the two speakers.

Speaker 1

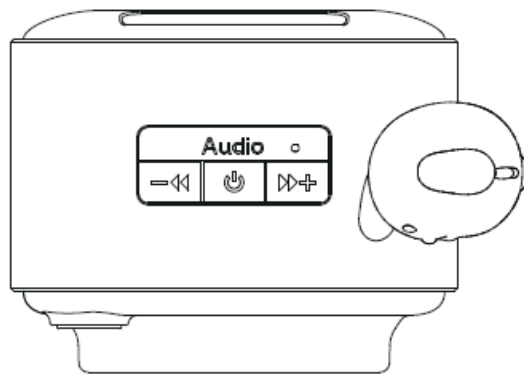

Long press for 3 seconds
to turn on

2. Turn on the device's Bluetooth, search for "MINISO-A132" and connect, the beeping around means the connection is done

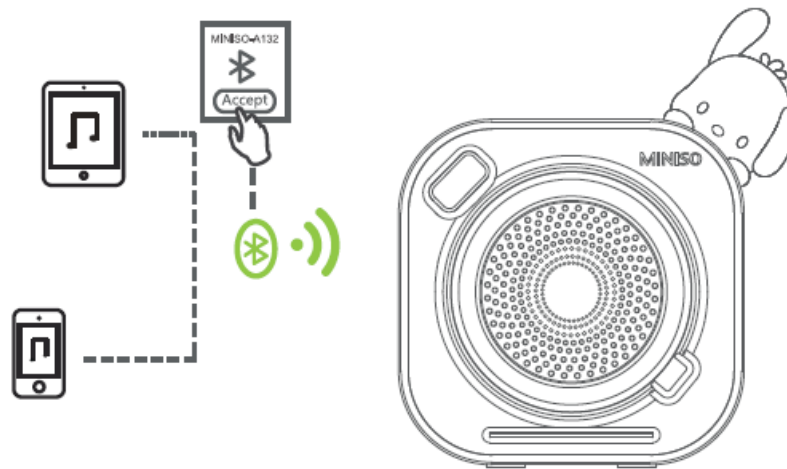

3. Turn on the other speaker.

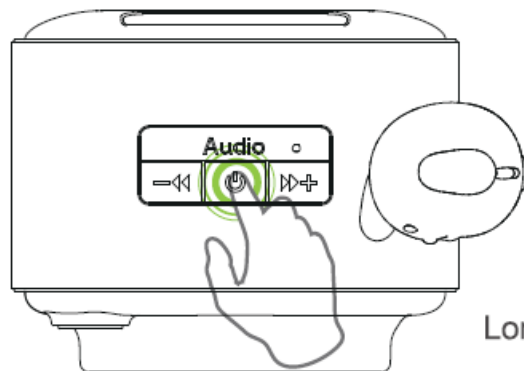

Long press for 3 seconds
to turn on

4. Double press Volume+ button of any of the two speakers, the first beep means the speakers start a mutual connection, the second beep, means the connection is a clone, and the blue light is constantly on. (If the connection doesn't succeed within 30 seconds, repeat the steps)

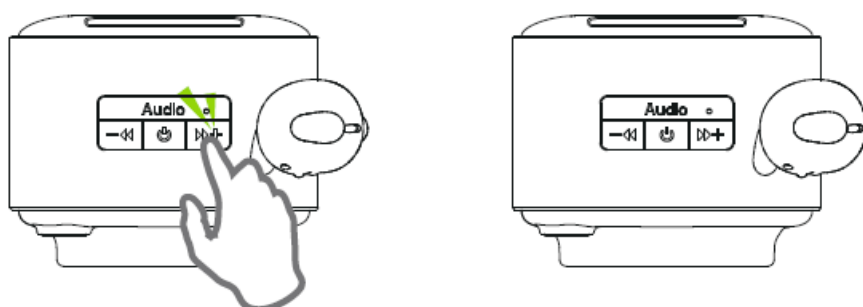

1. Steps of Method 2:1. Turn on both of speakers

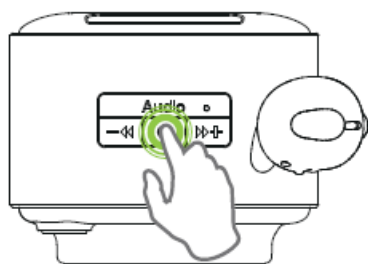

Long press for 3 seconds
to turn on

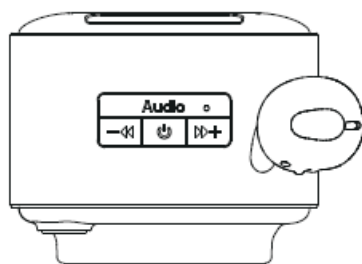

Long press for 3 seconds
to turn on

2. Double press the Volume+ button of any one of the two speakers, the first beep “3 means the speakers !!!art mutual connection:, the second beep,g means the comedian is done, and the blue light blinks slowly, {If the connection doesn't succeed within 30 seconds, repeat this step)

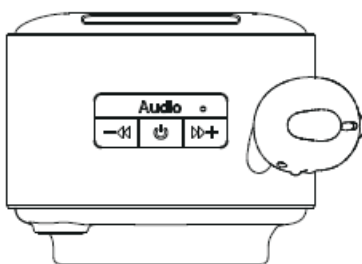
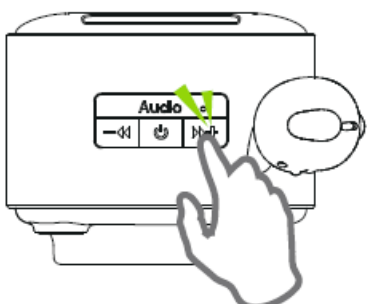

3. Turn on the device's Bluetooth, search for “MINISO-A132” and connect, the beeping sound means the connection is done, and blue light is constantly on.

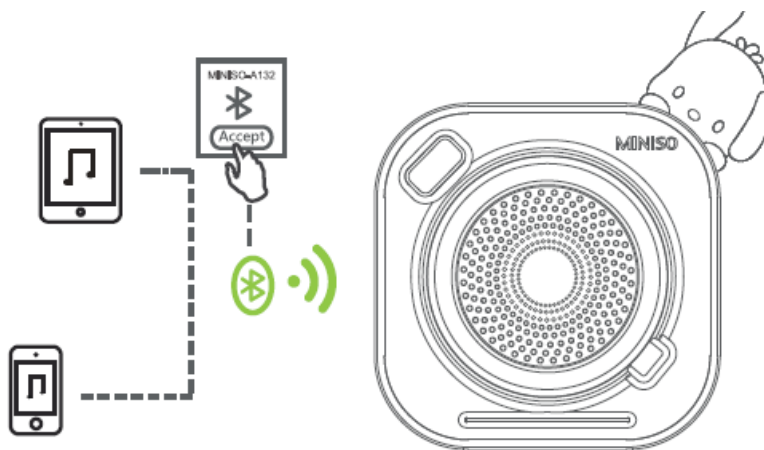

ACCESSORIES

1 Bluetooth Speaker 1 Charging Cable 1 User Manual

TROUBLESHOOTING

1. The wireless speaker is unable to be paired with the cell phone, Solution: Confirm If the wireless speaker is in pairing mode and if the Bluetooth on your phone is turned on. Then delete the product in the list, and pair it with your phone again according to the User Manual.
2. The wireless speaker is unable to be turned on. Solution: Confirm the battery level. Charge the speaker if it is needed.

3. Cari, will the battery of the wireless speaker be replaceable? **Solution:** No, it is a lithium polymer battery, which is irreplaceable.
4. Can I use the wireless speaker at a high volume for a long time?
Solution: To extend the lifespan of the wireless speaker, it is not recommended to play it at a high volume for a long time.
5. The link between the wireless speaker and my cell phone has been disconnected within 10 meters, **Solution:** Bluetooth is wireless so it is very sensitive to objects between the speaker and the connected device. Check if there are any metal or other objects that may affect connection within the effective distance.
6. I cannot hear audio playing when the speaker is connected to the computer or phone. **Solution:** Check whether the computer's audio output is already connected to a wireless device and whether the Bluetooth in the computer supports the A2DP protocol. Make sure the volume is up on your phone or computer.
7. Can I operate the Apps of my phone through the speaker after pairing the wireless speaker with the phone?
Answer: Some apps may not support being operated through the speaker due to their settings.

FCC Warning:

This device complies with Part 15 of the FCC Rules, Operation is subject to the following two conditions:

1. This device may not cause harmful interference.
2. The device must accept any interference received, including interference that may cause undesired operation.

Caution: Changes or modifications not expressly approved by the party responsible for compliance could void the user's authority to operate the equipment.

NOTE: This equipment has been tested and found to comply with the limits for a Class B digital device, pursuant to Part 15 of the FCC Rules. These limits are designed to provide reasonable protection against harmful interference in a residential installation. This equipment generates, uses, and can radiate radio frequency energy and, if not installed and used in accordance with the Instructions, may cause harmful interference to radio communications. However, there is no guarantee that interference will not occur in a particular installation. If this equipment does cause harmful interference to radio or television reception, which can be determined by turning the equipment off and on, the user is encouraged to try to correct the interference by one or more of the following measures:

- Reorient or relocate the receiving antenna,
- Increase the separation between the equipment and the receiver.
- Connect the equipment to an outlet on a circuit different from that to which the receiver is connected,
- Consult the dealer or an experienced radio/TV technician for help.

FCC Radiation Exposure Statement

This equipment complies with FCC radiation exposure limits for an uncontrolled environment. This transmitter must not be co-located or operated in close proximity with any other antenna or transmitter.



[MINISO A132 Sanrio Characters Bluetooth Speaker](#) [pdf] User Manual

A132, A132 Sanrio Characters Bluetooth Speaker, Sanrio Characters Bluetooth Speaker, Characters Bluetooth Speaker, Bluetooth Speaker, Speaker

References

- [User Manual](#)

[Manuals+](#), [Privacy Policy](#)

This website is an independent publication and is neither affiliated with nor endorsed by any of the trademark owners. The "Bluetooth®" word mark and logos are registered trademarks owned by Bluetooth SIG, Inc. The "Wi-Fi®" word mark and logos are registered trademarks owned by the Wi-Fi Alliance. Any use of these marks on this website does not imply any affiliation with or endorsement.