



Contents [[hide](#)]

- [1 Minifinder Pico A Lightweight and Minimalistic GPS Device](#)
- [2 Package Contents](#)
- [3 Product Management](#)
- [4 Explanation of LED Lights](#)
- [5 Explanation of Voice Notifications](#)
- [6 App Overview](#)
- [7 Device List](#)
- [8 Explanation of Voice Notifications](#)
- [9 Creating a Geofence](#)
- [10 Add a Contact](#)
- [11 Reminder](#)
- [12 Need More Help?](#)
- [13 Specifications](#)
- [14 Important Safety Instructions](#)
- [15 Documents / Resources](#)
 - [15.1 References](#)

MiniFinder®

Minifinder Pico A Lightweight and Minimalistic GPS Device



Package Contents

1. MiniFinder Pico
2. Magnetic Charging Cable
3. Power Adapter



Product Management

1. Charge Before First Use

Please charge the device for at least 4 hours before using it for the first time

2. While Charging

The blue LED light will remain solid during charging.

Once the device is fully charged, the blue LED will turn off

3. Charging the Device

Attach the magnetic charging cable to the charging pins on the device

4. Power On

Press and hold the On/Off button for 3 seconds to turn on the device

5. Power Off

Press and hold both SOS button and On/Off button for 2 seconds



Explanation of LED Lights

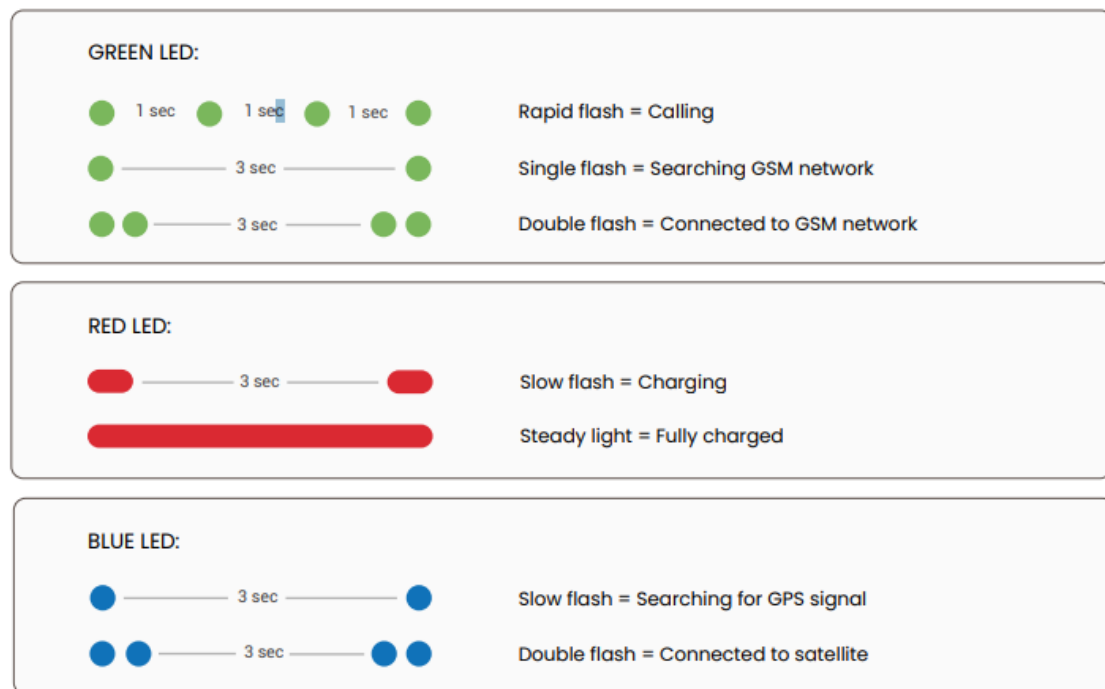

Explanation of Voice Notifications

- **Your mobile alarm is charging**

Your MiniFinder Pico has been plugged into a power source and is now charging

- **B Battery is low, please recharge your battery**

Your MiniFinder Pico is running out of battery , and you should charge it soon. This will be repeated 3 times

- **C Your alarm has been activated. Press the SOS button to stop**

The SOS alarm has been activated. Press the MiniFinder button to cancel the alarm before it starts calling

- **D Fall alarm has been activated. Press the SOS button to stop**

Your MiniFinder Pico has activated the fall alarm. Press the MiniFinder button to

cancel the alarm

- **E Calling contact number X**

The device is now calling the authorized phone numbers you set up in the app. It will proceed with the next phone number if the current one doesn't respond.

Getting Started – Download the MiniFinder

To begin using your MiniFinder Pico, you first need to download the MiniFinder Live App. If you're viewing this guide on your mobile device, simply click the Google Play or App Store icons to go directly to the download page. Alternatively, open the App Store or Google Play, and search for "MiniFinder Live" to install the app manually.



MiniFinder Live Introduction

Welcome to MiniFinder Live – a system designed to provide real-time positioning, smart alerts, and valuable insights to enhance personal safety and independence. Paired with the MiniFinder Pico, this platform gives you access to intelligent alarm functions, notifications and useful tools to support your safety.

This manual provides step-by-step guidance on how to use MiniFinder Live effectively. Follow the instructions to get started and make the most of your experience.

App Overview

Once the app is installed, the first step is to create an account. Tap Sign Up, then enter your email address and set a password to get started.

Once logged in, you'll be presented with an app overview, which is displayed on the right-hand side of your screen.

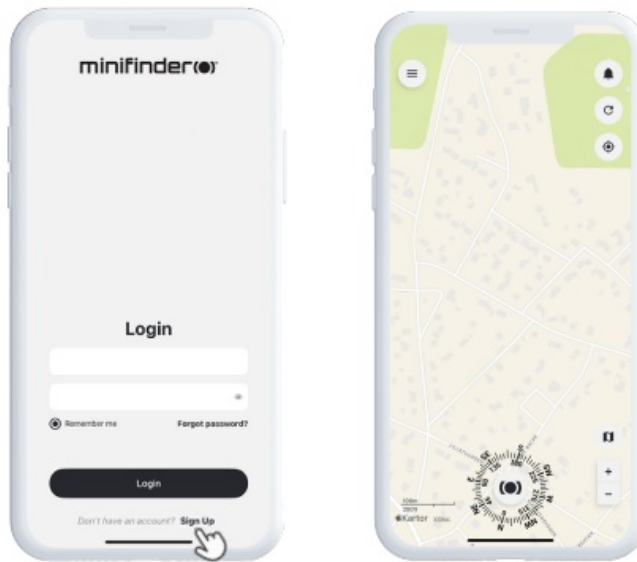

Menu

To open the quick menu, tap the MiniFinder button. This gives you fast access to key features like Tags, Geofence, and the Scanner tool.

For additional options, use the main menu located in the top left corner of the screen. By tapping this menu, you can access your profile, devices, contacts, reminders, and more.

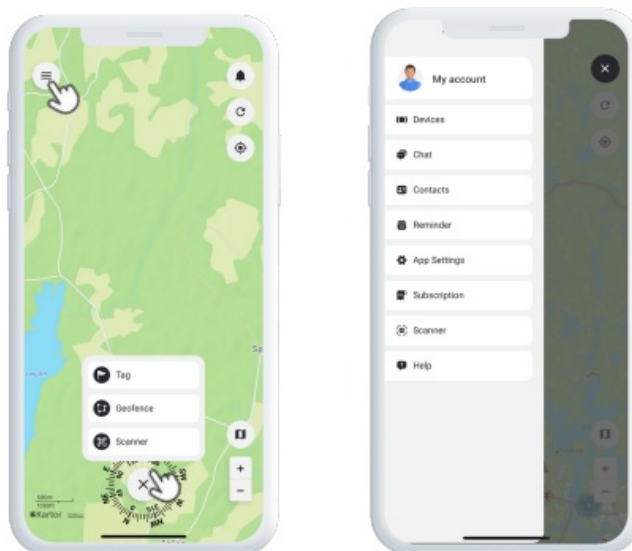

Add a New Device

To add a new device to your account, navigate to the menu located in the top left corner of the screen and select Devices. From there, tap the plus sign. You will now have the option to scan the barcode on your MiniFinder package to automatically populate the IMEI number. Alternatively, if the package is not available, you can manually input the

IMEI number.

Next, you can choose a name for your device, update the profile picture, and select a color. Once you have completed these steps, simply tap Add device.

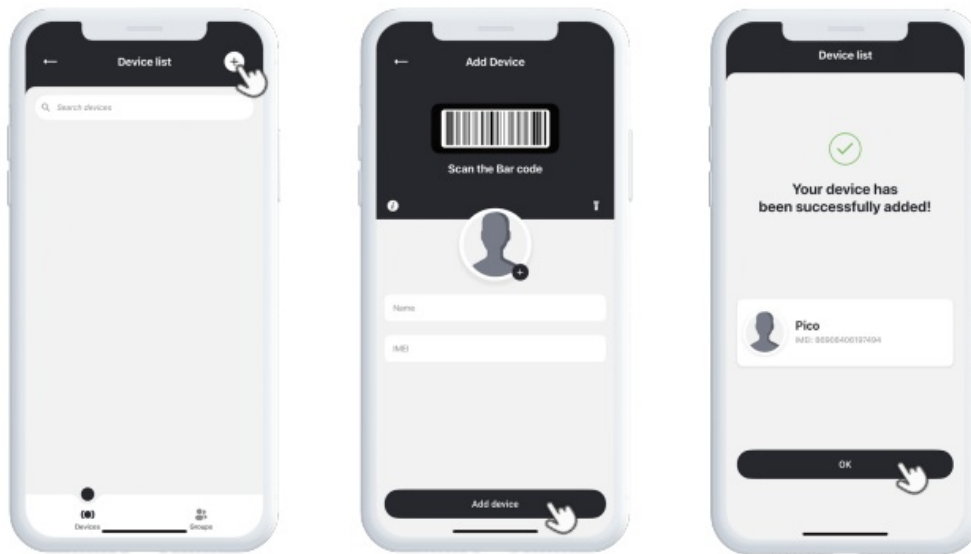

Choose a subscription

You'll now automatically be redirected to the subscription selection page.

Choose the subscription plan that best suits your needs and follow the steps to complete the purchase.

Device List

You can now find your device in the Device List, located under Devices in the main menu.

By expanding the drop-down menu on your device (tap the arrow on the right), you'll access several options, including:

- A Show on Map – View your device's current location
- B Device Settings – Adjust positioning and alert preferences
- C Profile – Edit device information
- D Log – View event history
- E Comments – Add notes related to the device

These tools help you manage and monitor your device with ease.

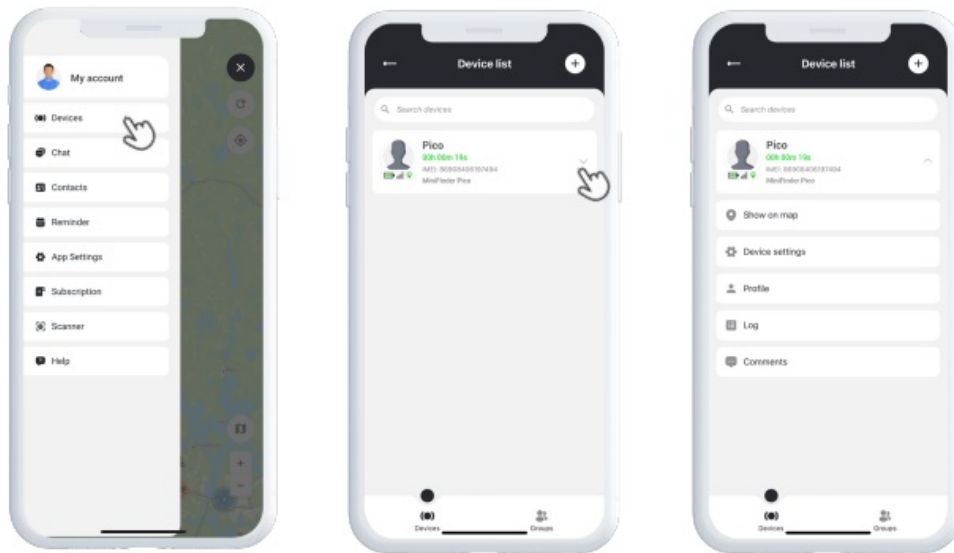

Device Panel

The Device Panel provides valuable insights into your device's location history and movement patterns, giving you a clearer picture of your activity over time.

To access the Device Panel, simply tap your device's icon directly on the map. This opens a detailed view with tracking data such as recent routes, timestamps, and other key metrics.

From the panel, you can also:

- A Share live location
- B View historical data
- C Add numbers to call
- D Set up alerts, such as the panic alarm, the fall alarm and the low battery alarm

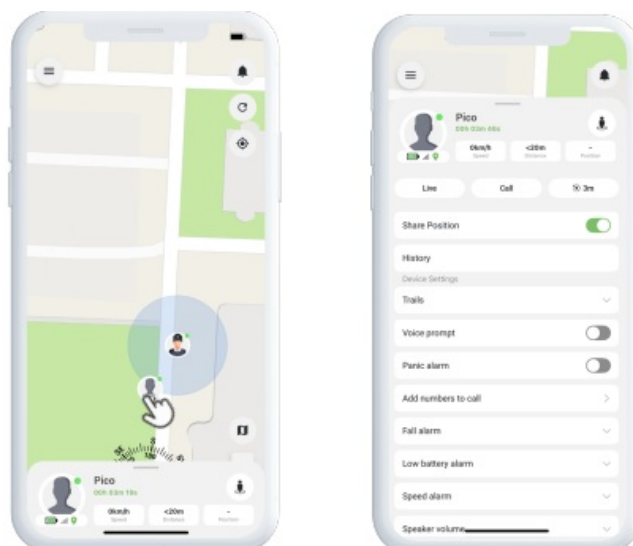

Minifinder Pico: A Lightweight and Minimalistic GPS Device

Package Contents

1. MiniFinder Pico
2. Magnetic Charging Cable
3. Power Adapter



Product Management

1. Charge Before First Use

Please charge the device for at least 4 hours before using it for the first time

2. While Charging

The blue LED light will remain solid during charging.

Once the device is fully charged, the blue LED will turn off

3. Charging the Device

Attach the magnetic charging cable to the charging pins on the device

4. Power On

Press and hold the On/Off button for 3 seconds to turn on the device

5. Power Off

Press and hold both SOS button and On/Off button for 2 seconds



Explanation of LED Lights

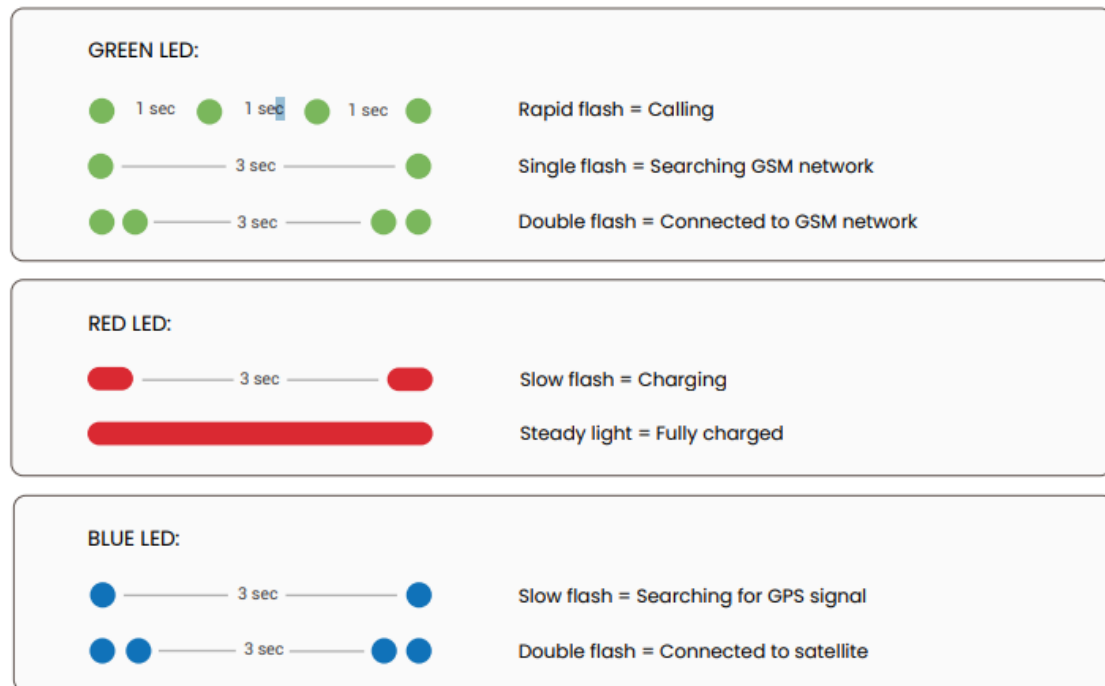

Explanation of Voice Notifications

- **Your mobile alarm is charging**

Your MiniFinder Pico has been plugged into a power source and is now charging

- **B Battery is low, please recharge your battery**

Your MiniFinder Pico is running out of battery and you should charge it soon. This will be repeated 3 times

- **C Your alarm has been activated. Press the SOS button to stop**

The SOS alarm has been activated. Press the MiniFinder button to cancel the alarm before it starts calling

- **D Fall alarm has been activated. Press the SOS button to stop**

Your MiniFinder Pico has activated the fall alarm. Press the MiniFinder button to cancel the alarm

- **E Calling contact number X**

The device is now calling the authorized phone numbers you set up in the app. It will proceed with the next phone number if the current one doesn't respond.

Getting Started – Download the MiniFinder

To begin using your MiniFinder Pico, you first need to download the MiniFinder Live App. If you're viewing this guide on your mobile device, simply click the Google Play or App Store icons to go directly to the download page. Alternatively, open the App Store or

Google Play, and search for “MiniFinder Live” to install the app manually.



MiniFinder Live Introduction

Welcome to MiniFinder Live – a system designed to provide real-time positioning, smart alerts, and valuable insights to enhance personal safety and independence. Paired with the MiniFinder Pico, this platform gives you access to intelligent alarm functions, notifications and useful tools to support your safety.

This manual provides step-by-step guidance on how to use MiniFinder Live effectively. Follow the instructions to get started and make the most of your experience.

App Overview

Once the app is installed, the first step is to create an account. Tap Sign Up, then enter your email address and set a password to get started.

Once logged in, you'll be presented with an app overview, which is displayed on the right-hand side of your screen.



Menu

To open the quick menu, tap the MiniFinder button. This gives you fast access to key features like Tags, Geofence, and the Scanner tool.

For additional options, use the main menu located in the top left corner of the screen.

By tapping this menu, you can access your profile, devices, contacts, reminders, and more.

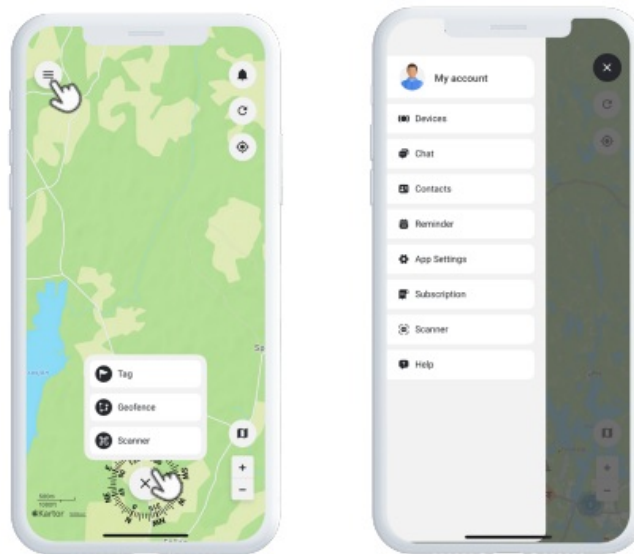

Add a New Device

To add a new device to your account, navigate to the menu located in the top left corner of the screen and select Devices. From there, tap the plus sign. You will now have the option to scan the barcode on your MiniFinder package to automatically populate the IMEI number. Alternatively, if the package is not available, you can manually input the IMEI number.

Next, you can choose a name for your device, update the profile picture, and select a color. Once you have completed these steps, simply tap Add device.

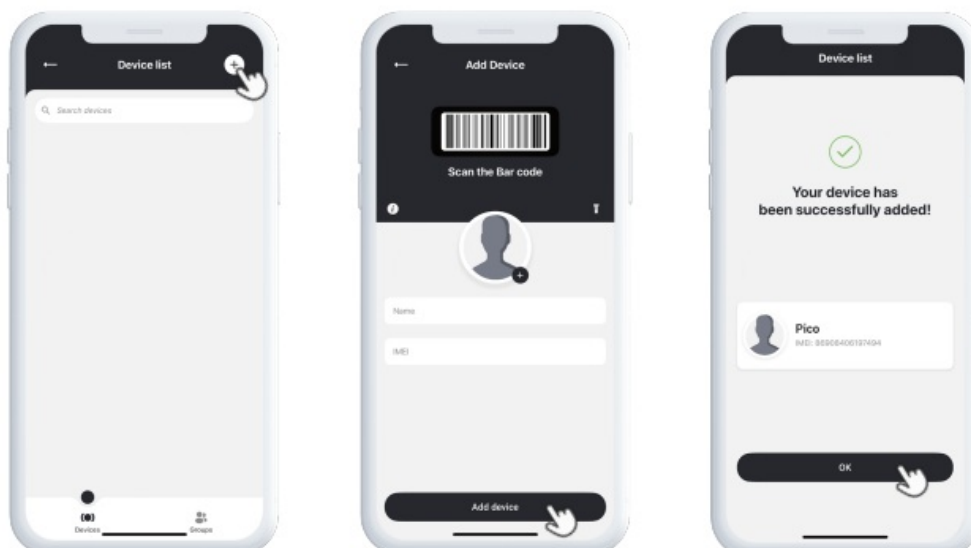

Choose a subscription

You'll now automatically be redirected to the subscription selection page.

Choose the subscription plan that best suits your needs and follow the steps to complete the purchase.

Device List

You can now find your device in the Device List, located under Devices in the main menu.

By expanding the drop-down menu on your device (tap the arrow on the right), you'll access several options, including:

- A Show on Map – View your device's current location
- B Device Settings – Adjust positioning and alert preferences
- C Profile – Edit device information
- D Log – View event history
- E Comments – Add notes related to the device

These tools help you manage and monitor your device with ease.

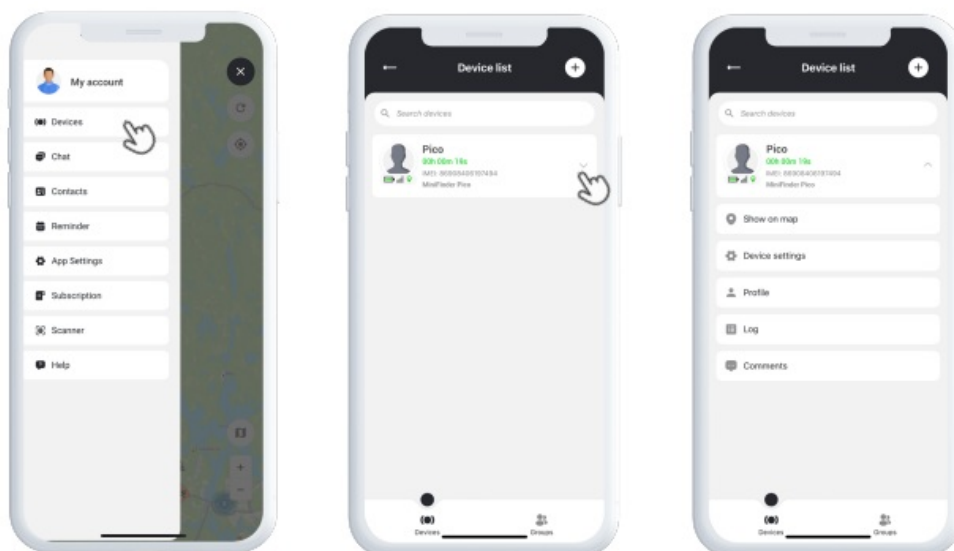

Device Panel

The Device Panel provides valuable insights into your device's location history and movement patterns, giving you a clearer picture of your activity over time.

To access the Device Panel, simply tap your device's icon directly on the map. This opens a detailed view with tracking data such as recent routes, timestamps, and other key metrics.

From the panel, you can also:

- A Share live location
- B View historical data
- C Add numbers to call
- D Set up alerts, such as the panic alarm, the fall alarm and the low battery alarm

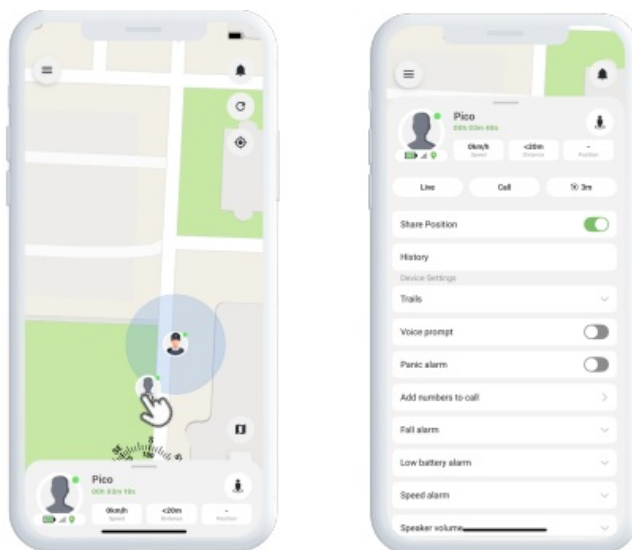

Device Settings

By tapping Settings within the Device Panel, you'll be taken to a dedicated page where you can fine-tune various features and preferences. From adjusting update intervals to configuring alerts and notifications, this section allows you to optimize your device's performance to suit your specific needs.

Alarm Notifications

To access your alarm notifications, tap the flashing bell icon located in the top right corner of the screen. This section is divided into three categories:

1. Alarms – Displays critical alerts that require immediate attention
2. Notifications – Shows general system messages and updates
3. History – Allows you to view all past alarms and notifications for reference

Within each section, you can choose to dismiss the alarm, view more details, or tap the pin icon to see the exact location of the event on the map.

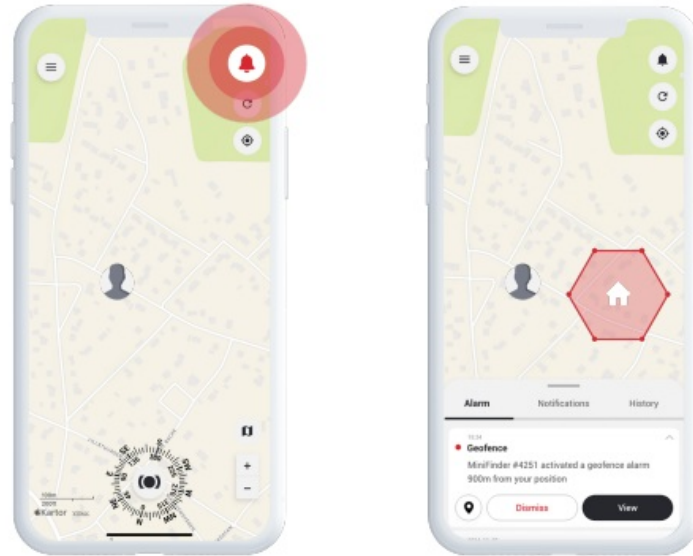

Creating a Geofence

To create a geofence, tap Geofence in the quick menu. Choose whether to draw your own geofence using a polygon or a circle.

If you select polygon, mark the desired area by placing and connecting points on the map. Then, select the device you want to link to the geofence and define whether alerts should trigger when the device enters, exits, or both.

Finally, give your geofence a name, choose a color, and tap Save.

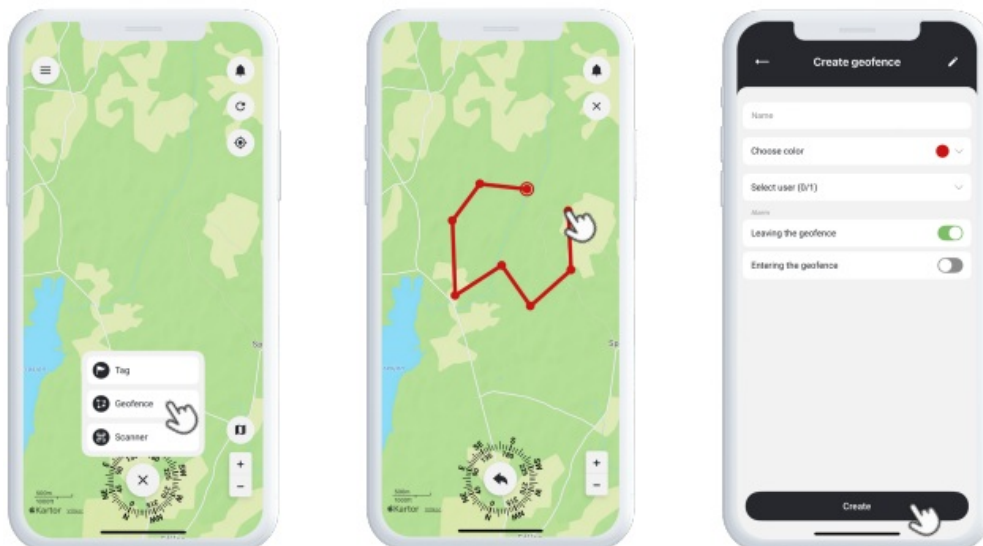

Tags

Tags allow you to highlight specific locations on the map that are important for your location setup.

To create a tag, select Tags in the quick menu and move the pointer to the desired location on the map. Choose the type of tag, add a label, and include any additional information if needed. Tap Save, and the tag will instantly appear on the map.

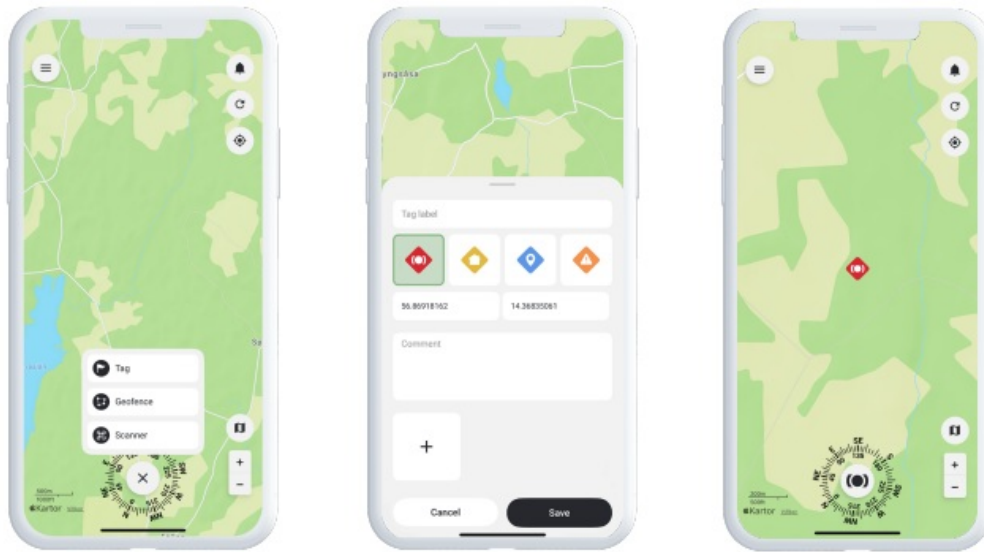

Add a Contact

To view a contact on the map or share location information, you first need to add the person as a contact. Follow the steps below to add a new contact:

1. Tap the menu in the upper left corner and select Contacts.
2. Click on the Add Contact icon to the right of the search bar. You'll then be asked whether you want to sync contacts from your mobile phone – if you prefer not to, select No, thanks.
3. Enter the email address or phone number of the person you want to add into the search field and click the magnifying glass icon to search.
4. Once the correct contact appears, confirm that you want to add the person. Your contact request will then be sent immediately.
5. In order to start sharing location or device information, the person must first accept your request.



Share Location with a Contact

Sharing your location with a family member, colleague, or friend can enhance safety and improve communication. To share your location with a contact in the app, start by tapping the menu in the upper left corner. Then go to Contacts and select the person you want to share your location with.

When the contact is open, choose whether to share your own location or the location of a specific device. You can also choose to grant full access, which means the contact will have access to all available information linked to the device. Once you've confirmed the settings, the location will be shared and visible to the recipient.

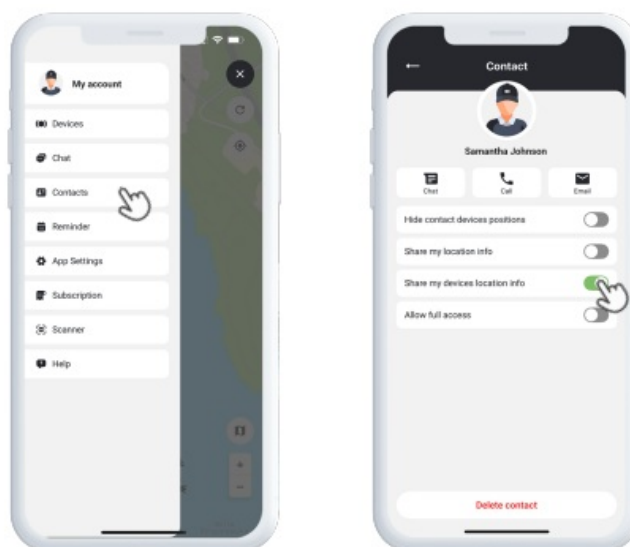

Reminder

MiniFinder Live includes a built-in calendar feature to help you stay organized.

To create a reminder, tap the main menu and select Reminder. From here, you can schedule important events such as medication reminders, daily routines, or any other tasks.

Choose the date, set how often the reminder should repeat, and tap Save.

Your reminder will now appear in the calendar, helping you keep track of key activities with ease.

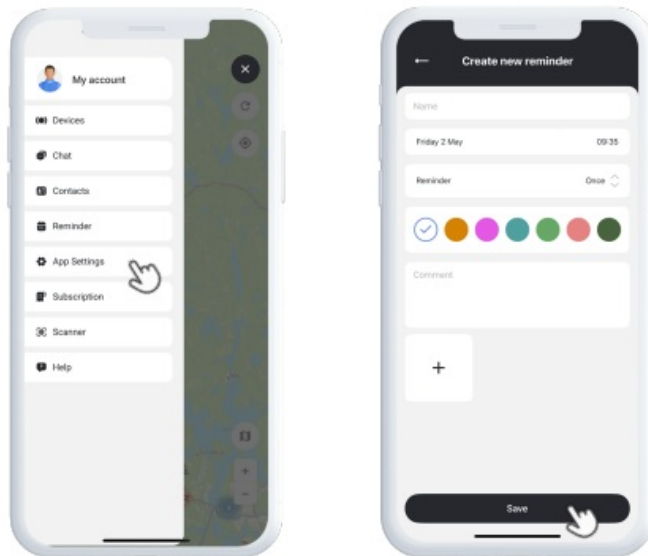

Need More Help?

For support and feature documentation, go to the Help section in the main menu. There you'll find step-by-step guides covering key MiniFinder Live functions, designed to help you maximize the platform's capabilities.

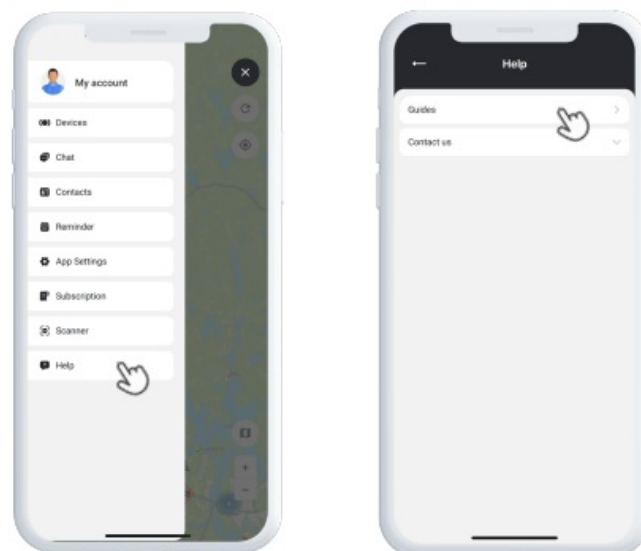

Specifications

- Dimensions 60 mm x 41 mm x 16 mm
- Weight 40g
- Battery Life 36-40h with 5 5-minute interval
- Connectivity LTE: B1, B3, B7, B8, B20 GSM:900/1800 MHz
- Power Source 5V DC 1.0A
- SIM Preinstalled
- Voice call Yes
- Fall sensor Yes
- Sensor Accelerometer, 3-axis

Memory

The device is equipped with a built-in 16 MB flash memory. This memory stores GPS data when GSM network coverage is unavailable (e.g., in rural areas, indoors, underground locations, etc.). The stored location data is automatically transmitted as soon as GSM coverage is restored.

Safety Declaration

This equipment has been tested and found to comply with safety certification requirements according to the specifications of EN Standard: EN60950-1: 2006 + A12: 2011.

Important Safety Instructions

- Read these instructions carefully.
- Keep these instructions for future reference.
- Heed all warnings.
- Follow all instructions.
- Do not tamper with your MiniFinder®.
- Do not use abrasive cleaners to clean your MiniFinder®.
- Do not place your MiniFinder® in a dishwasher, washing machine, or dryer.
- Do not expose your MiniFinder® to extremely high or low temperatures.
- Do not use your MiniFinder® in a sauna or steam room.
- Do not leave your MiniFinder® in direct sunlight for extended periods.

- Do not place your MiniFinder® near an open flame.
- Do not attempt to disassemble your MiniFinder®; it contains no user-serviceable parts.



— Recycling Information

The symbol on the product or its packaging indicates that this product must be disposed of separately from household waste at the end of its service life. Please be aware that it is your responsibility to dispose of electronic equipment properly at designated recycling centers, in order to help conserve natural resources.

minifinder.com

Documents / Resources

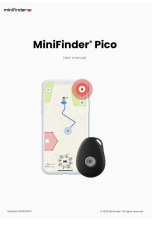
	<p>minifinder Pico A Lightweight and Minimalistic GPS Device [pdf] User Manual</p> <p>Pico A Lightweight and Minimalistic GPS Device, Lightweight and Minimalistic GPS Device, Minimalistic GPS Device, GPS Device</p>
--	--

References

- [User Manual](#)

 minifinder

 GPS Device, Lightweight and Minimalistic GPS Device, minifinder, Minimalistic GPS Device, Pico A Lightweight and Minimalistic GPS Device

Leave a comment

Your email address will not be published. Required fields are marked *

Comment *

Name

Email

Website

☐ Save my name, email, and website in this browser for the next time I comment.

Post Comment

Search:

e.g. whirlpool wrf535swhz

Search

[Manuals+](#) | [Upload](#) | [Deep Search](#) | [Privacy Policy](#) | [@manuals.plus](#) | [YouTube](#)

This website is an independent publication and is neither affiliated with nor endorsed by any of the trademark owners. The "Bluetooth®" word mark and logos are registered trademarks owned by Bluetooth SIG, Inc. The "Wi-Fi®" word mark and logos are registered trademarks owned by the Wi-Fi Alliance. Any use of these marks on this website does not imply any affiliation with or endorsement.