



## MINIDV M3 Mini Dash Camera User Guide

[Home](#) » [MINIDV](#) » MINIDV M3 Mini Dash Camera User Guide 

# Mini DV

QUICK START GUIDE



## Contents

- 1 Download the APP for instructions and tutorials
- 2 Getting to know the parts
- 3 Charging the camera
- 4 Insert TF card
- 5 Power on / Power off.
- 6 Wi-Fi ON/OFF
- 7 Shutter Button
- 8 Touchscreen operation
- 9 Connecting the APP
- 10 Connect to a computer
- 11 Documents / Resources
  - 11.1 References

## Download the APP for instructions and tutorials

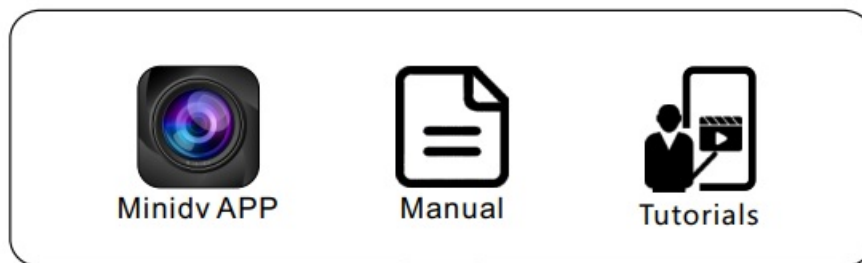

<https://minidv.com/m3/guide>

Scan the QR code to view tutorials and download the app

## Getting to know the parts

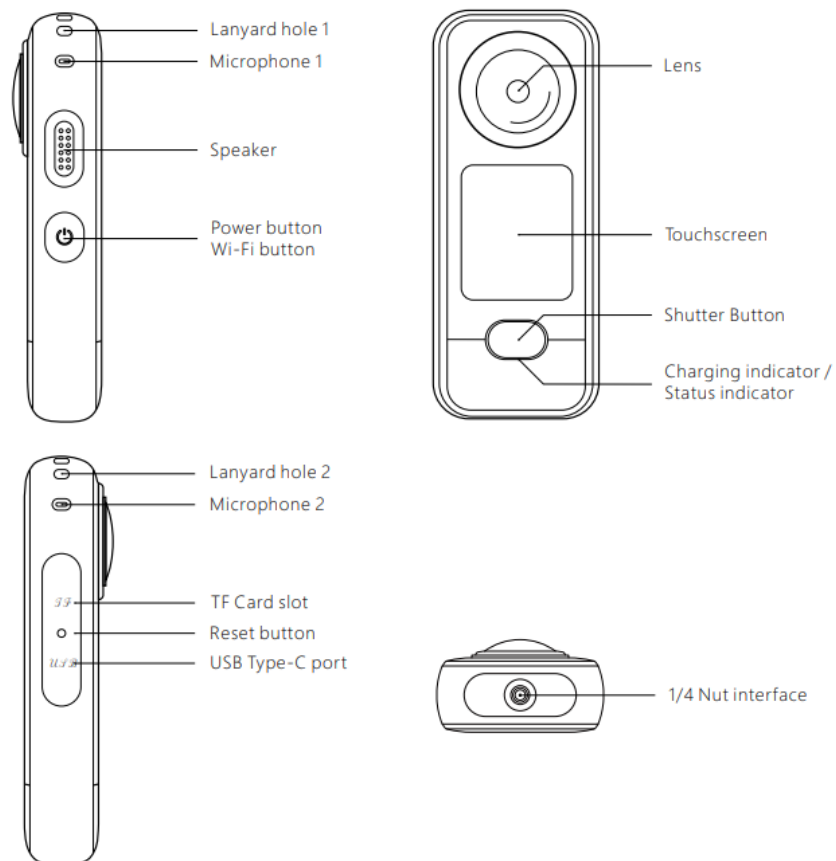

## Charging the camera

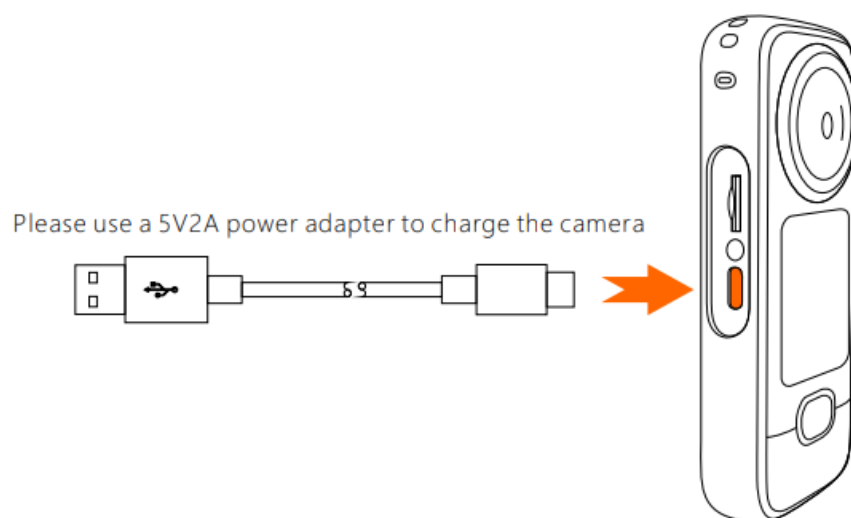

## Insert TF card

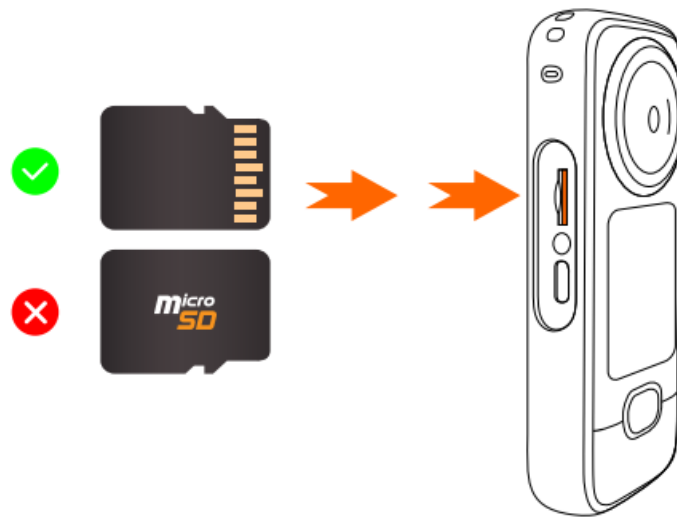

Please insert the TF card with the gold finger toward the lens side.

### **Power on / Power off.**

Tap to turn on

Press and hold for 3 seconds to turn off

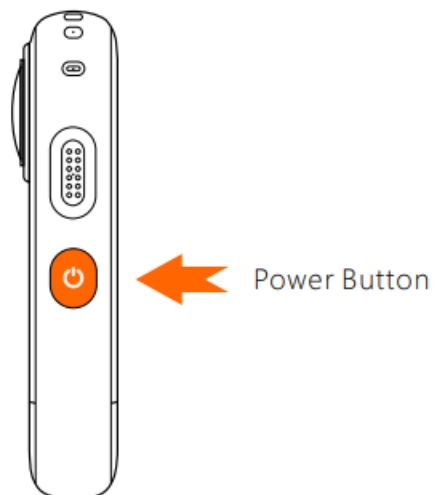

### **Wi-Fi ON/OFF**

In standby, tap the Wi-Fi button to turn on Wi-Fi, Tap the Wi-Fi button again to turn off Wi-Fi.



Wi-Fi can also be turned on and off in the settings menu  
Once the Wi-Fi is on, scan the QR code with the minidv App to connect to the camera.



You can also manually find the camera Wi-Fi hotspot with SSID minidv\_\*\*\*\*, The password is 12345678 to connect to the camera manually.

## Shutter Button

This button is a multi-function button and also has the following button functions

Playback

Pause

OK

Back

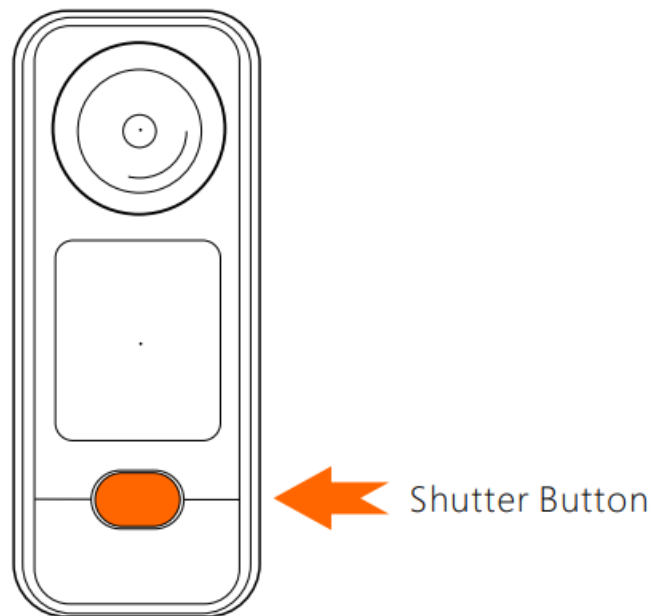

## Touchscreen operation

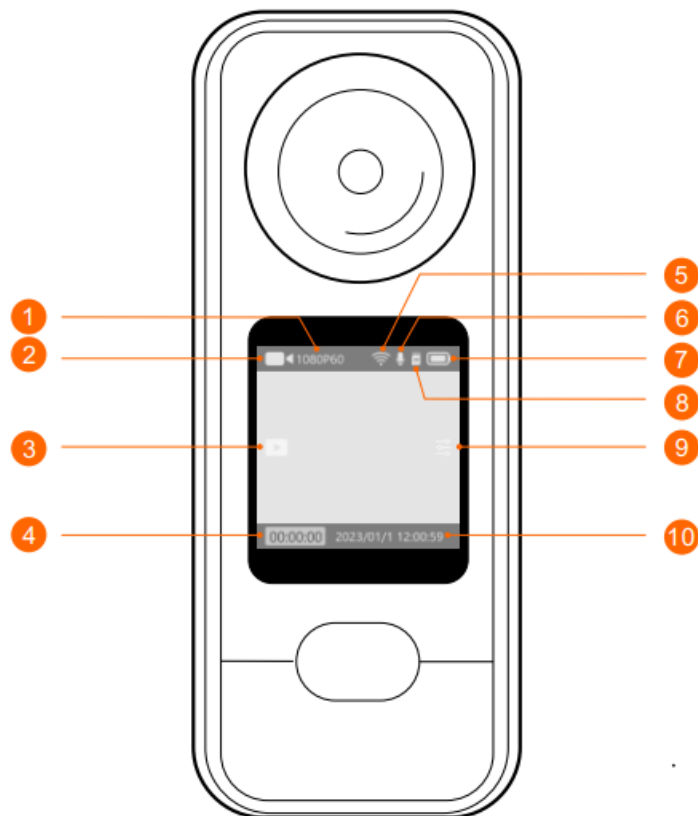

1. Resolution/frame rate
2. WiFi status
3. Mode
4. Playback
5. Remaining shootable time
6. Microphone state
7. State of charge
8. Memory card status
9. Parameter settings

## 10. Date Time

- In standby, swipe down from the top of the screen to access mode switching for VIDEO, TIME-LAPSE, SLOW-MO, and PHOTO.



- Swipe left or right to select the appropriate shooting mode, then tap to enter and slide down to back to standby.

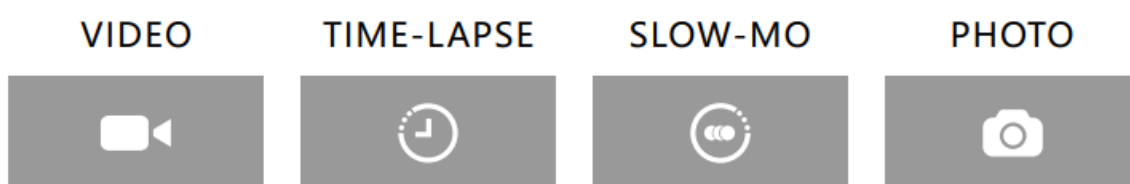
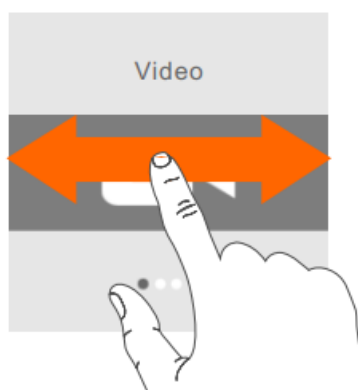

### 1. VIDEO

In video standby, swipe from the right to the left of the screen to enter the video parameter settings.



### 2. TIME-LAPSE

In TIME-LAPSE standby, swipe from the right to the left of the screen to enter the TIME-LAPSE parameter settings.



Swipe left or right to select a parameter, slide down from top to bottom to exit the parameter setting

### 3. SLO-MO

In SLO-MO standby, swipe from the right to the left of the screen to enter the SLO-MO parameter settings.



### 4. PHOTO

In PHOTO standby, swipe from the right to the left of the screen to enter the PHOTO parameter settings.



Swipe left or right to select a parameter, slide down from top to bottom to exit the parameter setting

### 5. Playback

In camera standby, swipe from the left to the right of the screen to enter the playback screen.



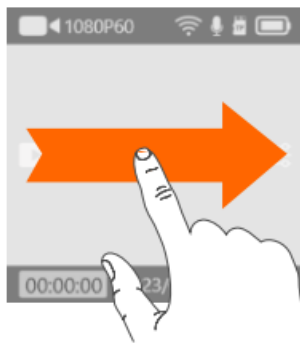

Enter playback

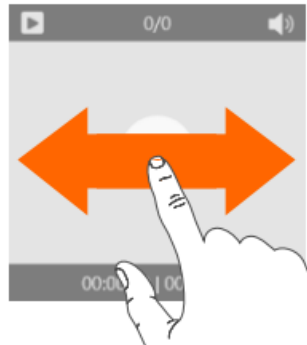

Selecting Playback Files

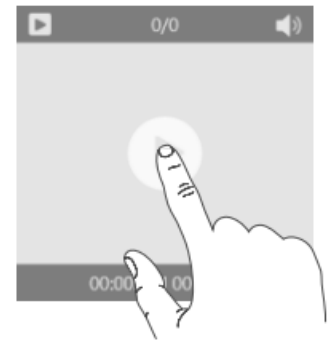

Click to play/pause

## 6. File Delete/Lock

In playback mode, select the Ple you want to delete or lock, press and hold the screen for 3 seconds, the “Delete and Lock” window will pop up, if you want to exit. If you want to exit, just swipe down or press the button at the bottom of the screen.

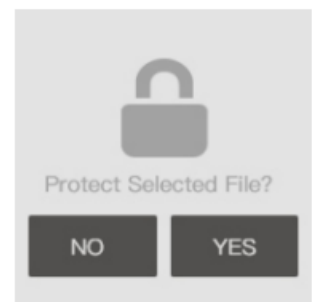
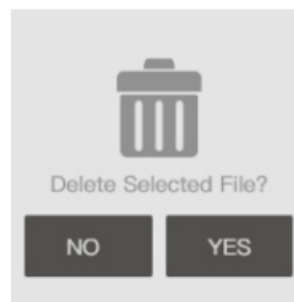
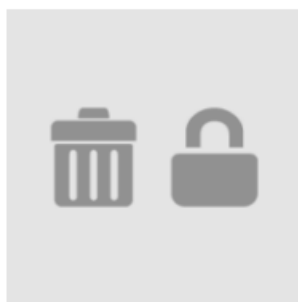

## 7. Setup

In camera standby, swipe up from the bottom of the screen to enter the camera settings screen.



Enter setup











Switch to next page



Switch to previous page



Exit setup

	Click to Format
	Click to turn the microphone off or on
	Click to turn WiFi on or off
	Click to go to more settings
	Click to go to volume control
	Click to go to presets
	Click to go to Image Reversal
	Click to enter parameter settings

## Connecting the APP

1. Turn on the M3 camera.
2. Turn on the M3 camera's Wi-Fi
3. Turn on your phone's Wi-Fi.
4. Open minidv App and click "Device", scan the QR code or manually Pnd the SSID of the camera to connect the camera.



Click "Device"



Click "Scan"

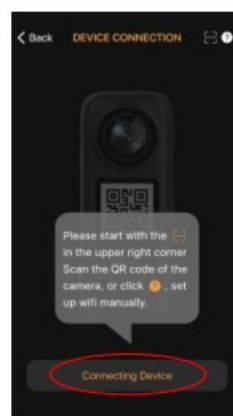

Click "Connecting Device"

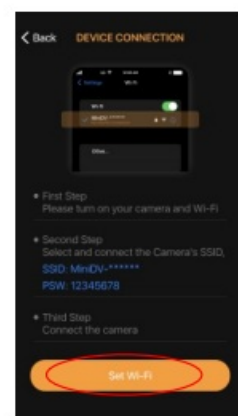

Click "Set Wi-Fi"

## Connect to a computer

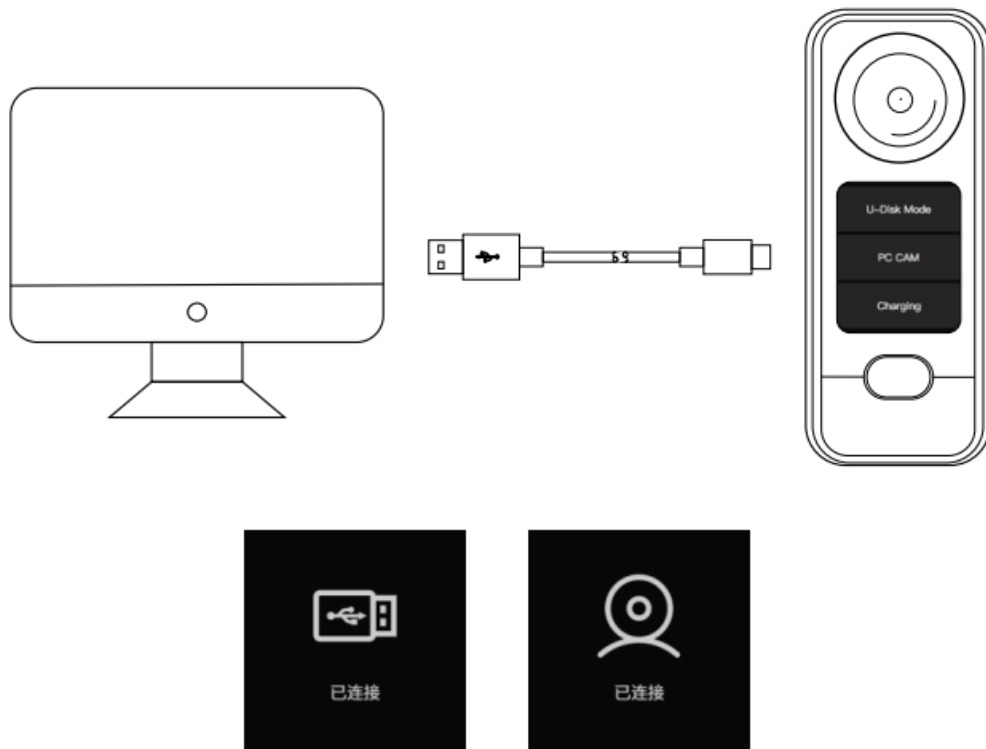

1. U-Disk Mode.
2. PC CAM.
3. Charging.

FCC Warning Statement: Changes or modifications to this unit not expressly approved by the party responsible for compliance could void the user's authority to operate the equipment. This equipment has been tested and found to comply with the limits for a Class B digital device, pursuant to Part 15 of the FCC Rules. These limits are designed to provide reasonable protection against harmful interference in a residential installation. This equipment generates, uses and can radiate radio frequency energy and, if not installed and used in accordance with the instructions, may cause harmful interference to radio communications.

However, there is no guarantee that interference will not occur in a particular installation. If this equipment does cause harmful interference to radio or television reception, which can be determined by turning the equipment off and on, the user is encouraged to try to correct the interference by one or more of the following measures:

- Reorient or relocate the receiving antenna.
- Increase the separation between the equipment and receiver.
- Connect the equipment into an outlet on a circuit different from that to which the receiver is connected.
- Consult the dealer or an experienced radio/TV technician for help.

This device complies with Part 15 of the FCC Rules. Operation is subject to the following two conditions: (1) this device may not cause harmful interference, and (2) this device must accept any interference received, including interference that may cause undesired operation.

#### FCC Radiation Exposure Statement

The device has been evaluated to meet general RF exposure requirement. The device can be used in portable exposure condition without restriction.

## Documents / Resources

QUICK START GUIDE



## [MINIDV M3 Mini Dash Camera](#) [pdf] User Guide

2AIGT-GM3, 2AIGTGM3, gm3, M3 Mini Dash Camera, M3 Dash Camera, Mini Dash Camera, M3, Dash Camera

## References

- [M M3 Guide – minidv.com | mini camera](#)
- [User Manual](#)

[Manuals+](#), [Privacy Policy](#)

This website is an independent publication and is neither affiliated with nor endorsed by any of the trademark owners. The "Bluetooth®" word mark and logos are registered trademarks owned by Bluetooth SIG, Inc. The "Wi-Fi®" word mark and logos are registered trademarks owned by the Wi-Fi Alliance. Any use of these marks on this website does not imply any affiliation with or endorsement.