



Minetom S14 Solar String Light User Manual

[Home](#) » [Minetom](#) » Minetom S14 Solar String Light User Manual 

Contents

- [1 Minetom S14 Solar String Light](#)
- [2 User Manual](#)
- [3 Package Lists](#)
- [4 SPECIFICATIONS](#)
- [5 HOW TO USE](#)
- [6 INSTALLATION](#)
- [7 Smart APP Connection](#)
- [8 Unable to Connect](#)
- [Troubleshooting](#)
- [9 Remote Controller Operation](#)
- [10 Remote function description](#)
- [11 Cautions & Warnings](#)
- [12 FCC Caution:](#)
- [13 Documents / Resources](#)
- [14 Related Posts](#)



Minetom S14 Solar String Light



User Manual

Thank you for purchasing Solar String Light (Bluetooth control), please read this user manual carefully first, we will introduce some of the important features and operations procedures of this product, please keep this manual in a safe place for future reference.

Package Lists

- 1* LED String Light
- 1* Solar panel
- 1* Post & Spike
- 1* RF remote control
- 1* User manual

SPECIFICATIONS

Item No.	S14-4815-SS-3R
Solar Panel Size	L226 x W126 mm
Solar Panel	3W/DC5V Polysilicon solar panel
Working Current	600mA
Working Voltage	DC3V
Charging Time	4-6hrs(40000Lux)
Working Time	3-5hrs(After full charge)
Total Length	48FT/14.6M
LED Bulb	S14(15pcs),0.2W/pcs
Bulb Spacing	3FT/0.9M
CCT	RGB&W(2700K)
Waterproof Rated	IP65
Working mode	Warm lighting/Colorful change
Charging mode	Solar charging or USB charging
Control mode	Smart APP + RF remote control + Button control

HOW TO USE

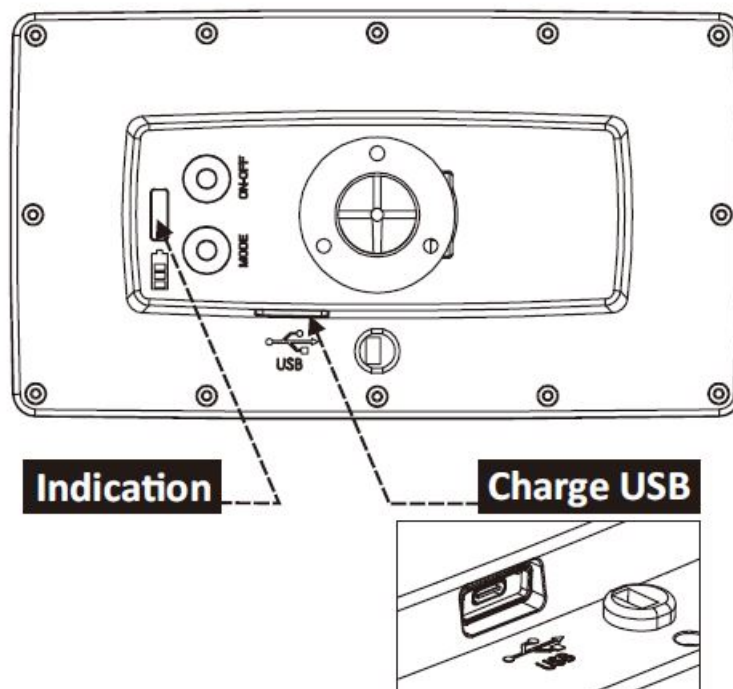

1. This solar string light can use solar or USB for charging.
2. Shortly press the button, the string light will be ON or OFF.
3. After turn on the string light, shortly press the “mode” button again, can change the light bulb color, and achieve different lighting modes.
4. The solar string light will be turned on automacally at night.
5. The solar string light will be turned off automacally for charging at day me.

6. When turn on the string light, the indicaons will be always ON.
7. Three control modes: Smart APP +RF remote control+ Button control

INSTALLATION

1. Fix the solar panel first (Two installation methods):

1. Insert the solar panel into the lawn with a post and a spike
2. With three wall screws, attach the solar panel to the wall or the top of the wall or a tree stump

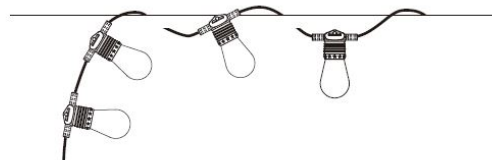
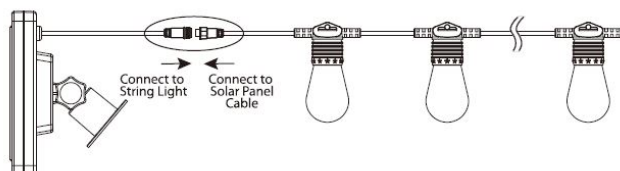

2. Connecting String Lights
3. Install cable with the empty sockets in desired location

Smart APP Connection



HappyLighting app

1. Search and Download the “HappyLigh ng” APP from APP store (for IOS) and Google play store(for Android).
2. Shortly press the ON/OFF buon to turn on the string light, turn on the “Bluetooth” function on your phone , then open the “HappyLigh ng” APP, your APP will pair with the smart string light automatically.
3. App more functions can be freely controlled by you.

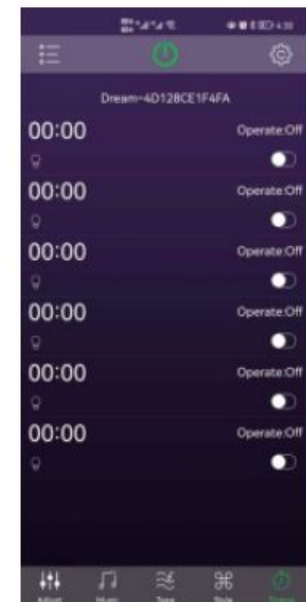
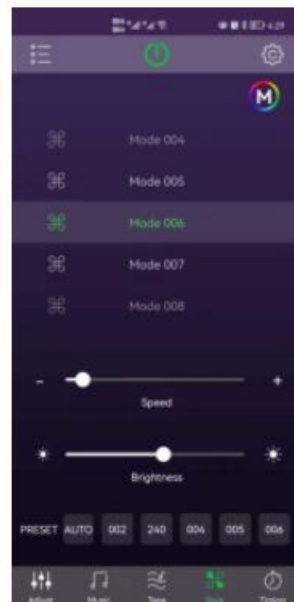
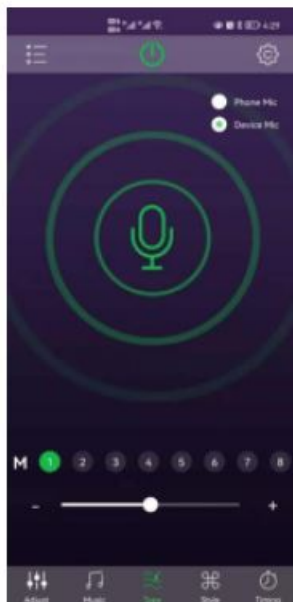
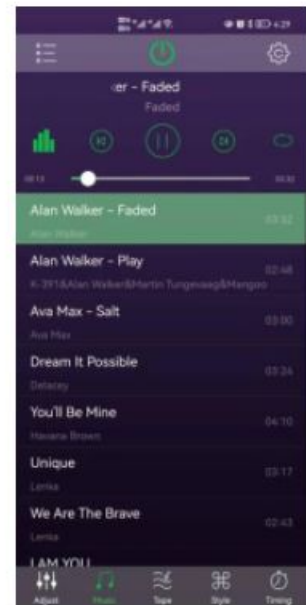

1. Warm white mode: Warm white light brings you soft and comfortable lighting.
2. RGB mode: RGB LED can change different light color.
3. Music mode: Lights can change colors with the beautiful rhythm of music.
4. Tape mode: Lights can be moved followed by the outside voice/music.
5. 256 scene modes can be selected.
6. Timing function, you can set the corresponding scene to change the color of the light.
7. You can shake the phone to change the color of the light.
8. Also you can take color from the photos on the mobile phone for light transformation.

Unable to Connect Troubleshooting

1. Check if the power supply of the string light is normal.
2. Check if the Bluetooth is turned on.
3. Check if there are other mobile phones connected, Bluetooth 4.0 only supports connections one to many, does not support many to many.
4. Check APP Bluetooth setting if the phone is connected to the device, if connected, exit the APP and reopen it,

the APP will go to connect automatically.

5. Normal operations and can not connect, please exit the APP and reopen.

6. Exit APP, restart mobile phone, power on the string light, reopen the APP, then they will connect automatically.

Remote Controller Operation

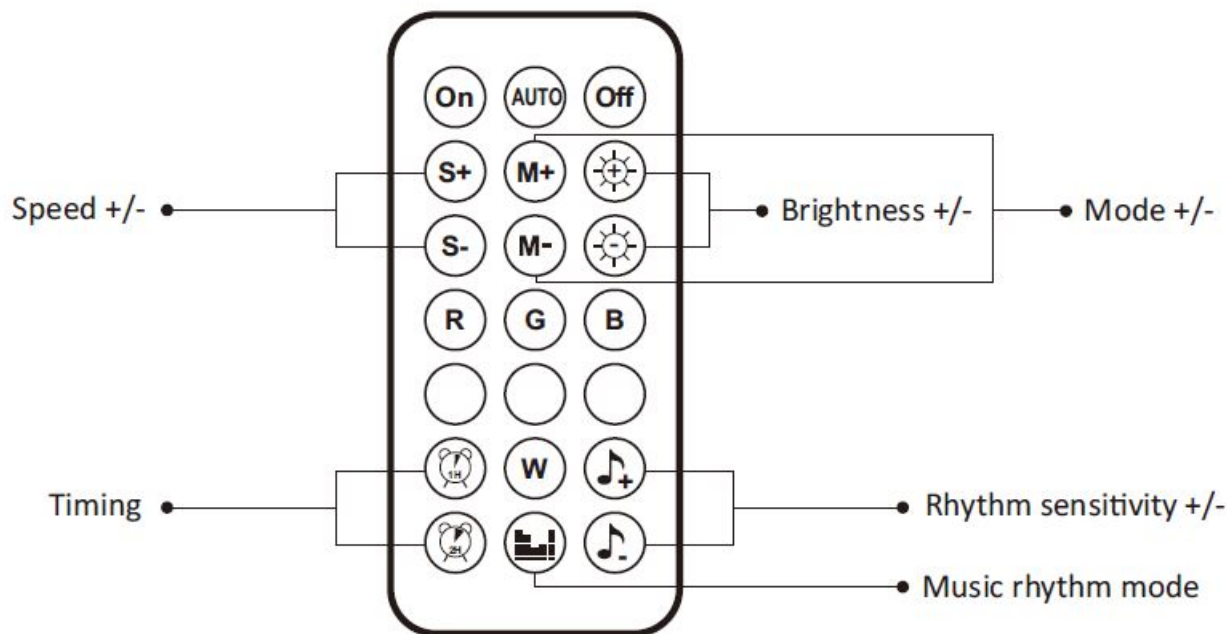

Remote function description

- ON/OFF
- AUTO: 256 scene modes can be changed automatically
- Speed +/-: Dynamic status speed +/-
- Mode +/-: 256 scene modes +/-
- Brightness +/-: Adjust the RGB&W brightness +/-
- Timing: 1H/2H timing function
- Music rhythm mode: 8 music rhythm modes
- In the white light mode, 11 preset colors can be changed cyclically.
- RGBW: Click to change to relevant colors.

Note: RF Remote controller can work when the led string light not in quick blink status.

Cautions & Warnings



1. The bulb is 3V only, please do not put the bulb into other fixtures.
2. Do not repair, disassemble, or modify the product without approval.
3. Do not place the light near any heat sources.

4. Please keep it away from children.
5. Please keep the light dry and clean.
6. Please do not hang anything from the string lights as the extra weight may break the light wire and cause potential fire hazard.
7. Although our lights are built with safety measures, we do not recommend leaving the light unattended or turning on permanently.
8. Please unplug the switch when it is not in use.
9. Please cut off the power before installing the bulb.

FCC Caution:

This device complies with part 15 of the FCC Rules. Operation is subject to the following two conditions: (1) this device may not cause harmful interference, and (2) this device must accept any interference received, including interference that may cause undesired operation.

Any changes or modifications not expressly approved by the party responsible for compliance could void the user's authority to operate the equipment.

NOTE: This equipment has been tested and found to comply with the limits for a Class B digital device, pursuant to Part 15 of the FCC Rules. These limits are designed to provide reasonable protection against harmful interference in a residential installation. This equipment generates, uses and can radiate radio frequency energy and, if not installed and used in accordance with the instructions, may cause harmful interference to radio communications. However, there is no guarantee that interference will not occur in a particular installation. If this equipment does cause harmful interference to radio or television reception, which can be determined by turning the equipment off and on, the user is encouraged to try to correct the interference by one or more of the following measures:

- Reorient or relocate the receiving antenna.
- Increase the separation between the equipment and receiver.
- Connect the equipment into an outlet on a circuit different from that to which the receiver is connected.
- Consult the dealer or an experienced radio/TV technician for help.

To maintain compliance with FCC's RF Exposure guidelines, This equipment should be installed and operated with minimum distance between 20cm the radiator your body: Use only the supplied antenna. FCC ID: 2A4IE-S14

Documents / Resources

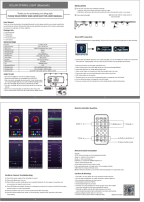
	<p>Minetom S14 Solar String Light [pdf] User Manual S14, 2A4IE-S14, 2A4IES14, S14 Solar String Light, Solar String Light</p>
---	--