



MINELAB ML 105 Manticore High Power Metal Detector User Manual

[Home](#) » [MINELAB](#) » MINELAB ML 105 Manticore High Power Metal Detector User Manual 



Contents

- 1 [BUTTONS AND INDICATIONS](#)
- 2 [MINELAB ML 105 HEADPHONES](#)
- 3 [PACKAGE CONTENTS](#)
- 4 [CHARGING THE HEADPHONES](#)
- 5 [TURNING ON THE HEADPHONES](#)
- 6 [TURNING OFF THE HEADPHONES](#)
- 7 [PAIRING TO A DETECTOR](#)
- 8 [CONNECT WITH THE LAST PAIRED DEVICE](#)
- 9 [ADJUST THE VOLUME](#)
- 10 [CONNECTING THE AUXILIARY CABLE](#)
- 11 [FACTORY RESET](#)
- 12 [SAFETY INFORMATION](#)
- 13 [TROUBLESHOOTING](#)
- 14 [CARE AND MAINTENANCE](#)
- 15 [SOFTWARE UPGRADABLE](#)
- 16 [WIRELESS COMPATIBILITY](#)
- 17 [PRODUCT SPECIFICATION](#)
- 18 [Documents / Resources](#)
 - 18.1 [References](#)
- 19 [Related Posts](#)

BUTTONS AND INDICATIONS

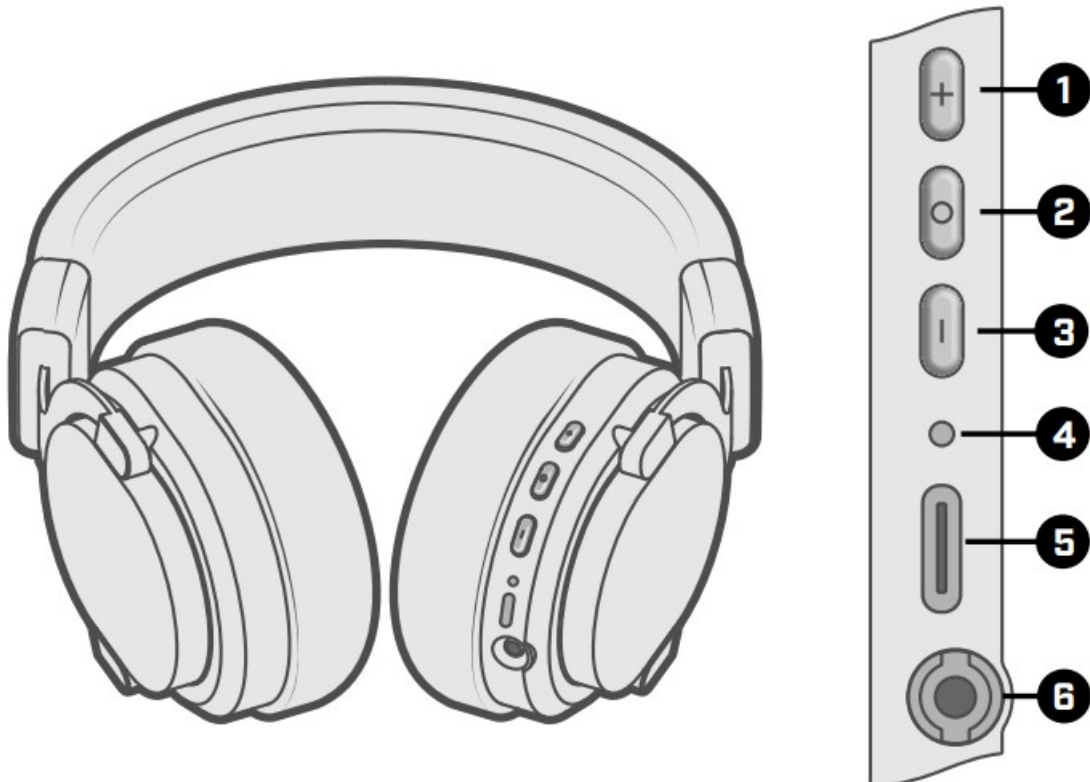

1. VOLUME PLUS BUTTON (+)

Increases the Volume by one level.

2. MULTI-FUNCTION BUTTON (MFB)

Turns the headphones On or Off, activates Pairing Mode, reset the headphones to factory defaults.

3. VOLUME MINUS BUTTON (-)

Decreases the Volume by one level.

4. STATUS LED

Alternating blue / red	Pairing mode
Flash blue once every 3 seconds	Connected
Flash blue 3 times every second	Not connected
Solid red	Charging

5. USB-C CHARGING SOCKET

6. HEADPHONE SOCKET 3.5 mm (1/8 inch)

MINELAB ML 105 HEADPHONES

Minelab ML 105 headphones use wireless technology which delivers faster, higher quality audio than standard Bluetooth. They will give more precise and faster detection responses when used for metal detecting.

ML 105 headphones contain the latest nRF5340 chipset to provide a high quality low-latency audio experience.

PACKAGE CONTENTS

- ML 105 Headphones
- 3.5 mm (1/8 inch) Detachable Auxiliary Cable
- USB-C Charging / Data Cable
- Instruction Manual

CHARGING THE HEADPHONES

Connect the USB-C cable to the USB-C socket 5 of the headphones.

The Status LED 4 will remain solid red during charging.

NOTE: USB charger is not supplied. Any generic high quality USB charger can be used.

TURNING ON THE HEADPHONES

Press and hold the MFB 2 until the Status LED 4 flashes solid blue for 1 second and then flashes red and blue. The headphones enter pairing mode automatically when no device is paired.

TURNING OFF THE HEADPHONES

Press and hold the MFB 2 for 2 seconds until the headphones turn Off.

PAIRING TO A DETECTOR

1. Position the headphones and the detector no more than 1 metre (3 feet) apart.
2. Ensure the headphones are turned Off.
3. Press and hold the MFB 2 until the Status LED 4 flashes red and blue.
4. Press and hold the wireless button on the detector for 2 seconds. The wireless icon on the detector display will flash rapidly.

- When pairing is complete, the Status LED 4 will flash blue once every 3 seconds, indicating that they are connected to the detector.

NOTE: If the pairing cannot be completed, the headphones will continually attempt to pair until a connection is made.

CONNECT WITH THE LAST PAIRED DEVICE

The headphones will automatically connect with the last-paired device. If connection is successful, the Status LED 4 will flash blue once every 3 seconds.

ADJUST THE VOLUME

- Increase Volume: Press + 1 button
- Decrease Volume: Press – 3 button

CONNECTING THE AUXILIARY CABLE

The ML 105 headphones are supplied with a detachable 3.5 mm ($\frac{1}{8}$ inch) auxiliary cable for wired operation. To use the cable, plug the connector into the headphone socket 6 and turn 90° anti-clockwise to lock the connector.

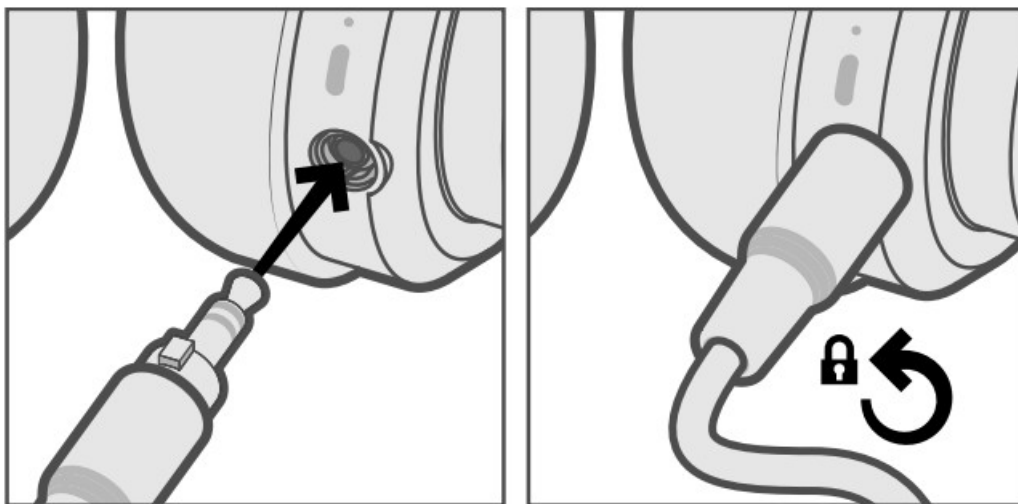

FACTORY RESET

Make sure the headphones are turned Off.

Press the MFB 2 for approximately 10 seconds until there are 2 beeps and the Status LED 4 flashes pink 2 times. Release the button.

The Status LED 4 will now be flashing red and blue, indicating that the headphones are in pairing mode. All previously paired devices will be unpaired.

SAFETY INFORMATION

- Never allow children to play with the headphones — small parts are a choking hazard.
- Observe all signs that require an electrical device or RF radio product to be switched off in designated areas. These could include hospitals, blasting areas, and potentially explosive environments.
- Turn Off your headphones prior to boarding an aircraft.

- Never mount or store your headphones over any air bag deployment area as serious injury may result if the air bag deploys.
- Do not open or mutilate the built-in battery.
- Dispose of batteries according to local regulations. Do not dispose as household waste.
- Only charge the headphones built-in battery in accordance with the instructions contained in the user guide.
- Avoid charging the headphones in extreme temperature conditions.

TROUBLESHOOTING

If you are unable to connect your headphones to your device, try the following:

- Ensure your headphones are turned On and are fully charged.
- Ensure the headphones are paired with your device.
- Ensure your device's wireless feature is activated. Refer to your device's user guide for specific instructions.
- Ensure the headphones are within 10 metres (32 feet) of your device and there are no obstructions such as walls or other electronic devices in between.

CARE AND MAINTENANCE

- Turn the headphones Off before placing in a pocket or bag.
- Do not expose the headphones to liquid, moisture or humidity, as the headphones are not waterproof.
- Do not use abrasive cleaning solvents to clean the headphones.
- Do not expose the headphones to extreme temperature conditions. The storage temperature range is from 0°C to +60°C.
- Do not dispose the headphones in a fire as this may result in an explosion.
- Do not bring the headphones into contact with sharp objects as this will cause scratches and damage.
- Do not attempt to disassemble the headphones, as they do not contain serviceable components.
- If the headphones are not used for long periods, store in a dry place free from extreme temperature conditions and dust.

SOFTWARE UPGRADABLE

The ML 105 headphones are upgradable via the supplied USB-C data/charging cable. Visit www.minelab.com/support for further information.

WIRELESS COMPATIBILITY

The wireless technology used in the ML 105 headphones is only compatible with certain Minelab metal detectors. Visit www.minelab.com/support for further information.

PRODUCT SPECIFICATION

Chipset	Nordic nRF5340
Operating range	Up to 10 m (32 ft)
Charging time	3.5 hours (approximately)
Operating time	35 to 40 hours
Dimensions	210 × 185 × 90 mm (8.3 × 7.3 × 3.5 inches)
Weight	274 g (9.7 oz)
Wireless operating frequency	2.4 to 2.485 GHz
Audio output power	17 mW ×2
Power of supply	0.1 W
Storage temperature range	0°C to +60°C (32°F to +140°F)

Minelab reserves the right to introduce changes in design, equipment and technical features at any time without notice.

MINELAB® is a trademark of Minelab Electronics Pty. Limited.



Documents / Resources

	<p>MINELAB ML 105 Manticore High Power Metal Detector [pdf] User Manual ML 105 Manticore High Power Metal Detector, ML 105, Manticore High Power Metal Detector, High Power Metal Detector, Metal Detector</p>
---	---

References

-  [Metal Detectors | Minelab Metal Detectors](#)
-  [Support | Minelab Metal Detectors](#)