



milwaukee P36-WLAB Wireless Laser Alignment Base with Remote User Manual

[Home](#) » [Milwaukee](#) » milwaukee P36-WLAB Wireless Laser Alignment Base with Remote User Manual 

milwaukee P36-WLAB Wireless Laser Alignment Base with Remote



Contents

1	IMPORTANT SAFETY INSTRUCTIONS
2	FUNCTIONAL DESCRIPTION
3	SPECIFICATIONS
4	SYMBOLLOGY
5	ASSEMBLY
6	OPERATION
7	MAINTENANCE
8	SERVICE – UNITED STATES
9	SERVICE – CANADA
10	LIMITED WARRANTY USA & CANADA
11	Documents / Resources
11.1	References

IMPORTANT SAFETY INSTRUCTIONS



WARNING

Read and understand all instructions. Failure to follow all instructions may result in electric shock, fire and/or serious personal injury. Save these instructions.

- This tool is designed to be powered by AA batteries properly inserted into the tool. Do not attempt to use with any other voltage or power supply.
Do not use zinc-carbon batteries.
- Chemical Burn Hazard. A new or used battery can cause severe internal burns and lead to death in as little as 2 hours if swallowed or enters the body. Keep away from children. If you think batteries may have been swallowed or entered the body, seek immediate medical attention.
- Do not mix new and used batteries. Do not mix brands (or types within brands) of batteries.
- Do not mix rechargeable and non-rechargeable batteries.
- Install batteries according to polarity (+ / –) diagrams. Do not install batteries backwards. Batteries can explode or leak.
- Do not crush, drop, damage, or expose batteries to high temperature.
Under abusive conditions, liquid may be ejected from the battery, avoid contact. If contact accidentally occurs, flush with water. If liquid contacts eyes, additionally seek medical help.
- Do not incinerate or dismantle batteries. Properly dispose of used batteries immediately.
- For indoor use.



Federal Communications Commission



WARNING

Changes or modifications to this unit not expressly approved by the party responsible for compliance could void the user's authority to operate the equipment.

This equipment has been tested and found to comply with the limits for a Class B digital device, pursuant to Part 15 of the FCC Rules. These limits are designed to provide reasonable protection against harmful interference in a residential installation. This equipment generates, uses and can radiate radio frequency energy and, if not installed

and used in accordance with the instructions, may cause harmful interference to radio communications. However, there is no guarantee that interference will not occur in a particular installation. If this equipment does cause harmful interference to radio or television reception, which can be determined by turning the equipment off and on, the user is encouraged to try to correct the interference by one or more of the following measures:

- Reorient or relocate the receiving antenna.
- Increase the separation between the equipment and receiver.
- Consult the dealer or an experienced radio/TV technician for help

This device complies with part 15 of the FCC Rules and ISED-Canada's license exempt RSS standards. Operation is subject to the following two conditions: 1) This device may not cause harmful interference, and 2) This device must accept any interference received, including interference that may cause undesired operation.

FUNCTIONAL DESCRIPTION

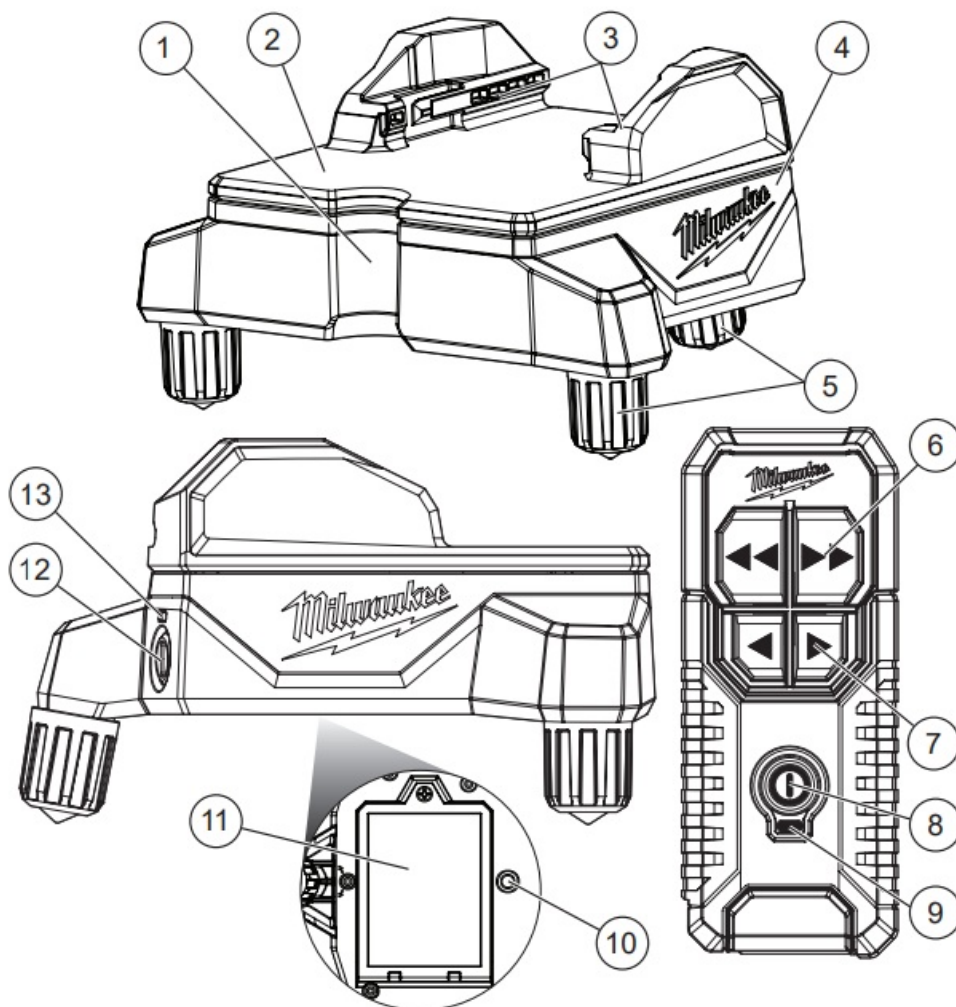

1. Plumb point indent
2. Rotating top plate
3. Laser level adapter
4. Motorized fixed base
5. Height adjustable legs
6. Fast sweep
7. Single step/slow sweep
8. Remote power button
9. Power/movement LED
10. Threaded 1/4"-20 tripod insert
11. Power cell door
12. Power button
13. Power/movement LED



SPECIFICATIONS

Alignment Base Cat. No.	48-35-1314
Volts	4.5V DC
Battery Type	3x(AA) LR6
Module/FCC ID	RF4463PRO/P36-WLAB
Ingress Protection	IP54
Drop Rating	0.9 m
Working Range (Remote W/Base)	125'
Adjustment Horizontal Range	40' @ 125'
Micro-Step Accuracy	3/32" @ 100'
Mounting Thread	1/4"-20
Remote Control Cat. No.	22-80-1314
Volts	3V DC
Battery Type	2x(AA) LR6
Module/FCC ID	RF4463PRO/P36-WLAR
Drop Rating	3 m
Altitude	<6560'
Pollution Degree	2
Maximum Relative Humidity (RH)	80%
for up to 88°F	
Decreasing Linearly Relative Humidity (RH)	50% at 104°F
Recommended Ambient	
Storage Temperature	-13°F to 140°F
Operating Temperature	0°F to 122°F

SYMBOLOLOGY

- V Volts
-  Direct Current
-  Read Operator's Manual

ASSEMBLY

Attaching Laser to Alignment Base

The alignment base can be used with MILWAUKEE® M12™, MILWAUKEE® REDLITHIUM™ USB, and alkaline lasers.

- To **attach**, align the grooves on the pivot bracket with the laser adapter features on the rotating top plate. Slide the laser back until latched in place.
- To **remove**, carefully slide the pivot bracket on the laser out of the base of the mount.

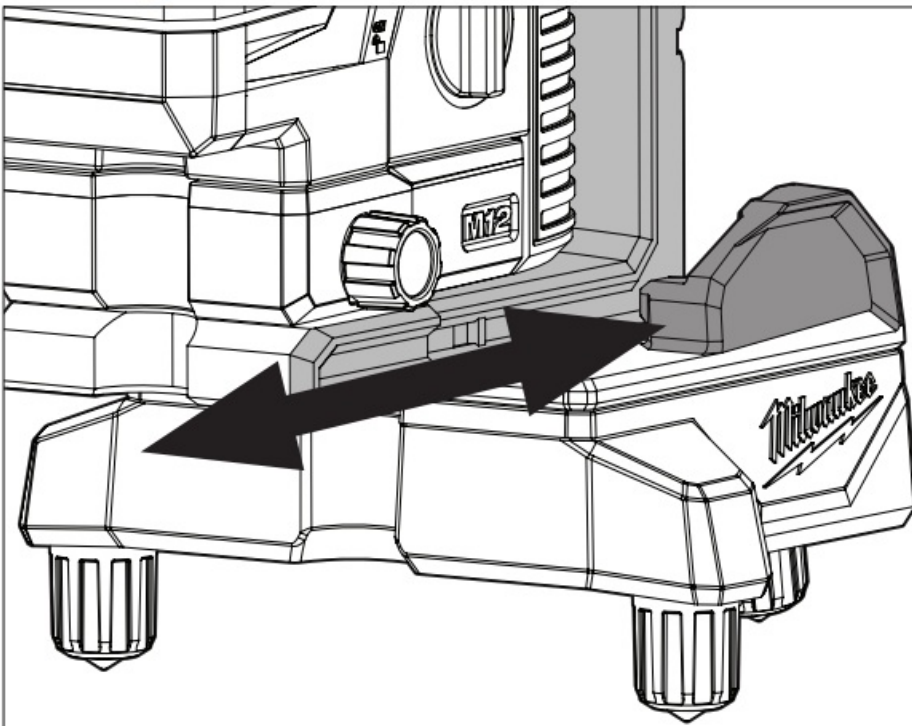

Changing Batteries

Only use recommended batteries. If the tool will not be used for a long time, remove the batteries as a protection against corrosion. Change batteries when the base and/or remote light is red.

To change the batteries:

1. Remove the laser from the wireless laser alignment base.
2. Unscrew and lift latch to open battery door.
3. Insert 3-AA batteries according to the +/- polarity marked in the compartment.
4. Install the battery door and fasten securely.

OPERATION

Pairing Remote to Alignment Base

The remote control is not intended to be unpaired from the alignment base.

- If the remote becomes unpaired, hold the power button on remote control for 3 seconds, then hold power button on base for 3 seconds to repair.

Turning ON/OFF the Alignment Base

The alignment base can be used with MILWAUKEE® M12™, MILWAUKEE® REDLITHIUM™ USB, and alkaline lasers. Ensure the alignment base is powered on, and the LED is solid green.

- To turn **ON**, press the power button, the LED will turn green. •To turn OFF, press the power button until the LED turns **off** completely.

Using the Remote Control

The remote control can only be used with one alignment base at a given time. To avoid interference with other alignments bases on the same jobsite, space out the tools from one another. The alignment base and remote control have three modes; macro-sweep, micro-sweep, and micro-step.

- To turn **ON**, press the power button on the remote control.
- To **adjust** the alignment base, use the arrow buttons on the remote control: •To macro adjust, use the buttons with two triangles on it. This can be used in either left or right directions.
- **To micro** adjust, use the buttons with one triangle on it. This can be used in either left or right directions.
- **To sweep**, long hold the button, this can be done be with macro and micro buttons on the remote control.
- To turn **OFF**, press the power button until the LED turns off completely on the alignment base.

Low Battery for Alignment Base and Remote Control

The alignment base uses alkaline batteries, please see below instructions for each LED status colors.

- For normal operation, the LED will be green, unless the remote control is unpaired, then the LED will be red.
- For low battery status, the LED will be solid red.
- If the batteries are depleted and the power button is pressed, the LED will pulse red for 1 second, then the alignment base will turn off.

MAINTENANCE

Cleaning

Clean dust and debris from vents. Keep tool clean, dry and free of oil or grease. Use only mild soap and a damp cloth to clean, since certain cleaning agents and solvents are harmful to plastics and other insulated parts. Some of these include gasoline, turpentine, lacquer thinner, paint thinner, chlorinated cleaning solvents, ammonia and household detergents containing ammonia. Never use flammable or combustible solvents around tools.

SERVICE – UNITED STATES

1-800-SAWDUST (1.800.729.3878)

Monday-Friday, 7:00 AM – 6:30 PM CST or visit www.milwaukeeetool.com

Contact Corporate After Sales Service Technical Support with technical, service/repair, or warranty questions.

Email: metproductsupport@milwaukeeetool.com

Become a Heavy Duty Club Member at www.milwaukeeetool.com to receive important notifications regarding your tool purchases.

SERVICE – CANADA

Milwaukee Tool (Canada) Ltd 1.877.948.2360

Monday-Friday, 7:00 AM – 4:30 PM CST or visit www.milwaukeetool.ca

LIMITED WARRANTY USA & CANADA

This MILWAUKEE power tool* is warranted to the original purchaser from an authorized MILWAUKEE distributor only to be free from defects in material and workmanship. Subject to certain exceptions, MILWAUKEE will repair or replace any part on this power tool which, after examination, is determined by MILWAUKEE to be defective in material or workmanship for a period of two (2) years after the date of purchase unless otherwise noted. Return of the power tool to a MILWAUKEE factory Service Center location or MILWAUKEE Authorized Service Station, freight prepaid and insured, is required.

A copy of the proof of purchase should be included with the return product. This warranty does not apply to damage that MILWAUKEE determines to be from repairs made or attempted by anyone other than MILWAUKEE authorized personnel, misuse, alterations, abuse, normal wear and tear, lack of maintenance, or accidents.

Normal Wear: Many power tools need periodic parts replacement and service to achieve best performance. This warranty does not cover repair when normal use has exhausted the life of a part including, but not limited to, chucks, brushes, cords, saw shoes, blade clamps, o-rings, seals, bumpers, driver blades, pistons, strikers, lifters, and bumper cover washers

- This warranty does not cover battery packs or all power tools. Refer to the separate and distinct warranties available for those products.

The warranty period for the LED in the LED Work Light (49-24-0171) and the LED Upgrade Bulb (49-81-0090) is the lifetime of the product subject to the limitations above. If during normal use the LED or LED Upgrade Bulb fails, the part will be replaced free of charge.

Warranty Registration is not necessary to obtain the applicable warranty on a MILWAUKEE power tool product. The manufacturing date of the product will be used to determine the warranty period if no proof of purchase is provided at the time warranty service is requested.

ACCEPTANCE OF THE EXCLUSIVE REPAIR AND REPLACEMENT REMEDIES DESCRIBED HEREIN IS A CONDITION OF THE CONTRACT FOR THE PURCHASE OF EVERY MILWAUKEE PRODUCT. IF YOU DO NOT AGREE TO THIS CONDITION, YOU SHOULD NOT PURCHASE THE PRODUCT. IN NO EVENT SHALL MILWAUKEE BE LIABLE FOR ANY INCIDENTAL, SPECIAL, CONSEQUENTIAL, OR PUNITIVE DAMAGES, OR FOR ANY COSTS, ATTORNEY FEES, EXPENSES, LOSSES OR DELAYS ALLEGED TO BE AS A CONSEQUENCE OF ANY DAMAGE TO, FAILURE OF, OR DEFECT IN ANY PRODUCT INCLUDING, BUT NOT LIMITED TO, ANY CLAIMS FOR LOSS OF PROFITS. SOME STATES DO NOT ALLOW THE EXCLUSION OR LIMITATION OF INCIDENTAL OR CONSEQUENTIAL DAMAGES, SO THE ABOVE LIMITATION OR EXCLUSION MAY NOT APPLY TO YOU. THIS WARRANTY IS EXCLUSIVE AND IN LIEU OF ALL OTHER EXPRESS WARRANTIES, WRITTEN OR ORAL. TO THE EXTENT PERMITTED BY LAW, MILWAUKEE DISCLAIMS ANY IMPLIED WARRANTIES, INCLUDING WITHOUT LIMITATION ANY IMPLIED WARRANTY OF MERCHANTABILITY OR FITNESS FOR A PARTICULAR USE OR PURPOSE; TO THE EXTENT SUCH DISCLAIMER IS NOT PERMITTED BY LAW, SUCH IMPLIED WARRANTIES ARE LIMITED TO THE DURATION OF THE APPLICABLE EXPRESS WARRANTY AS DESCRIBED ABOVE. SOME STATES DO NOT ALLOW LIMITATIONS ON HOW LONG AN IMPLIED WARRANTY LASTS, SO THE ABOVE LIMITATION MAY NOT APPLY TO YOU, THIS WARRANTY GIVES YOU SPECIFIC LEGAL RIGHTS, AND YOU MAY ALSO HAVE OTHER RIGHTS WHICH VARY FROM STATE TO STATE.

This warranty applies to product sold in the U.S.A. and Canada only.

Please consult the 'Service Center Search' in the Parts & Service section of MILWAUKEE's website www.milwaukeetool.com or call 1.800.SAWDUST (1.800.729.3878) to locate your nearest service facility for warranty and non-warranty service on a MILWAUKEE power tool.



Documents / Resources



[milwaukee P36-WLAB Wireless Laser Alignment Base with Remote](#) [pdf] User Manual
P36-WLAB Wireless Laser Alignment Base with Remote, P36-WLAB, Wireless Laser Alignment Base with Remote, Laser Alignment Base with Remote, Alignment Base with Remote, Base with Remote

References

- [Milwaukee® Tool Official Site | Nothing but HEAVY DUTY®](#)
- [Milwaukee® Tool Official Site | Nothing but HEAVY DUTY®](#)
- [User Manual](#)

[Manuals+](#), [Privacy Policy](#)

This website is an independent publication and is neither affiliated with nor endorsed by any of the trademark owners. The "Bluetooth®" word mark and logos are registered trademarks owned by Bluetooth SIG, Inc. The "Wi-Fi®" word mark and logos are registered trademarks owned by the Wi-Fi Alliance. Any use of these marks on this website does not imply any affiliation with or endorsement.