



milwaukee M18 Force Logic press Tool with One-Key User Manual

[Home](#) » [Milwaukee](#) » milwaukee M18 Force Logic press Tool with One-Key User Manual 

Contents

- [1 milwaukee M18 Force Logic press Tool with One-Key](#)
- [2 GENERAL POWER TOOL SAFETY WARNINGS](#)
- [3 SYMBOLOGY](#)
- [4 SPECIFICATIONS](#)
- [5 FUNCTIONAL DESCRIPTION](#)
- [6 ASSEMBLY](#)
- [7 OPERATION](#)
- [8 Troubleshooting](#)
- [9 MAINTENANCE](#)
- [10 ACCESSORIES](#)
- [11 Documents / Resources](#)
- [12 Related Posts](#)



milwaukee M18 Force Logic press Tool with One-Key



WARNING

To reduce the risk of injury, user must read and understand operator's manual.

GENERAL POWER TOOL SAFETY WARNINGS

WARNING

Read all safety warnings, instructions provided with this power tool. Failure to follow all instructions listed below may result in

Save all warnings and instructions for future reference. The term "power tool" in the warnings refers to your mains-operated (corded) power tool or battery-operated (cordless) power tool.

WORK AREA SAFETY

- Keep work area clean and well lit. Cluttered or dark areas invite accidents.
- Do not operate power tools in explosive atmo liquids, gases or dust. Power tools create sparks which may ignite the dust or fumes.
- Keep children and bystanders away while operating a power tool. Distractions can cause you to lose control.

ELECTRICAL SAFETY

- Power tool plugs must match the outlet. Never modify the plug in any way. Do not use any adapter plugs with earthed (grounded) power tools.
reduce risk of electric shock.
- Avoid body contact with earthed or grounded surfaces, such as pipes, radiators, ranges and refrigerators.
There is an increased risk of electric shock if your body is earthed or grounded.
- Do not expose power tools to rain or wet conditions. Water entering a power tool will increase the risk of electric shock.
- Do not abuse the cord. Never use the cord for carrying, pulling or unplugging the power tool. Keep cord away from heat, oil, sharp edges or moving parts.
- Damaged or entangled cords increase the risk of electric shock.
- When operating a power tool outdoors, use an extension cord suitable for outdoor use. Use of a cord suitable for outdoor use reduces the risk of electric shock.
- If operating a power tool in a damp location is unavoidable, use a residual current device (RCD) protected supply. Use of a RCD reduces the risk of electric shock.

PERSONAL SAFETY

- Stay alert, watch what you are doing and use common sense when operating a power tool. Do not use a

power tool while you are tired or under

A moment of inattention while operating power tools may result in serious personal injury.

- Use personal protective equipment. Always wear eye protection. Protective equipment such as a dust mask, non-skid safety shoes, hard hat or hearing protection used for appropriate conditions will reduce personal injuries.
- Prevent unintentional starting. Ensure the switch source and/or battery pack, picking up or carrying the tool. the switch or energizing power tools that have the switch on invites accidents.
- Remove any adjusting key or wrench before turning the power tool on. A wrench or a key left attached to a rotating part of the power tool may result in personal injury.
- Do not overreach. Keep proper footing and balance at all times. This enables better control of the power tool in unexpected situations.
- Dress properly. Do not wear loose clothing or jewelry. Keep your hair and clothing away from moving parts. Loose clothes, jewelry or long hair can be caught in moving parts.
- If devices are provided for the connection of dust extraction and collection facilities, ensure these are connected and properly used. Use of dust collection can reduce dust-related hazards.
- Do not let familiarity gained from frequent use of tools allow you to become complacent and ignore tool safety principles. A careless action can cause severe injury within a fraction of a second.

POWER TOOL USE AND CARE

- Do not force the power tool. Use the correct power tool for your application. The correct power tool will do the job better and safer at the rate for which it was designed.
- Do not use the power tool if the switch does not Any power tool that cannot be controlled with the switch is dangerous and must be repaired.
- Disconnect the plug from the power source and/or remove the battery pack, if detachable, from the power tool before making any adjustments, changing accessories, or storing power tools. Such preventive safety measures reduce the risk of starting the power tool accidentally.
- Store idle power tools out of the reach of children and do not allow persons unfamiliar with the power tool or these instructions to operate the power tool. Power tools are dangerous in the hands of untrained users.
- Maintain power tools and accessories. Check for misalignment or binding of moving parts, breakage of parts and any other condition that have the power tool repaired before use. Many accidents are caused by poorly maintained power tools
- Keep cutting tools sharp and clean. Properly maintained cutting tools with sharp cutting edges are less likely to bind and are easier to control.
- Use the power tool, accessories and tool bits etc. in accordance with these instructions, taking into account the working conditions and the work to be performed. Use of the power tool result in a hazardous situation
- Keep handles and grasping surfaces dry, clean and free from oil and grease. Slippery handles and grasping surfaces do not allow for safe handling and control of the tool in unexpected situations.

BATTERY TOOL USE AND CARE

- A charger that is suitable for one type with another battery pack. battery packs. Use of any other battery packs may
- When battery pack is not in use, keep it away from other metal objects, like paper clips, coins, keys, nails,

screws or other small metal objects, that can make a connection from one terminal to another. Shorting the battery terminals together

- Under abusive conditions, liquid may be ejected from the battery; avoid contact. If contact accidentally occurs, flush with water. If liquid contacts eyes, additionally seek medical help. Liquid ejected from the battery may cause irritation or burns.
- Do not use a battery pack or tool that is damaged - explosion or risk of injury.
- Do not expose a battery pack or tool to fire or excessive temperature. Exposure to fire or temperature above 130°C (265°F) may cause explosion.
- Follow all charging instructions and do not charge the battery pack or tool outside the temperature

SERVICE

Never service damaged battery packs. Service of battery packs should only be performed by the manufacturer or authorized service providers.

SPECIFIC SAFETY RULES FOR PRESS TOOL

- Use tool only as directed. Only trained personnel should operate tool
- Do not use tool without press jaw installed. Fingers could be crushed.
- Keep hands away from press jaw while tool is in use. Fingers could be crushed
- Chemical Burn Hazard. Keep coin cell battery away from children
- To reduce the risk of injury, wear safety goggles or glasses with side shields. Inspect and discard workpieces with cracks or wear before use. Materials may crack or shatter
- Use tool only with MILWAUKEE® or MILWAUKEE® approved press jaws, press fittings, and pipe for which they are designed. Other uses may cause injury or damage to the tool, accessories, and pipes. Leaking may result. Only use press jaw with a compression range rated for this tool
- Always use common sense and be cautious when using tools. It is not possible to anticipate every situation that could result in a dangerous outcome. Do not use this tool if you do not understand these operating instructions or you feel the work is beyond your capability; contact MILWAUKEE® Tool or a trained professional for additional information or training
- Maintain labels and nameplates. These carry important information. If unreadable or missing, contact a MILWAUKEE® service facility for a replacement.

WARNING sawing, grinding, Some dust created by power sanding, drilling, and other construction activities contains chemicals known to cause cancer, birth defects or other reproductive harm. Some examples of these chemicals are:

- lead from lead-based paint
- crystalline silica from bricks and cement and other masonry products, and
- arsenic and chromium from chemically-treated lumber.

Your risk from these exposures varies, depending on how often you do this type of work. To reduce your exposure to these chemicals: work in a well ventilated area, and work with approved safety equipment, such as those dust masks that are specially designed to filter out microscopic particles.

ADDITIONAL BATTERY SAFETY RULES

WARNING To injury, reduce the risk of fire, personal and product damage due to a short circuit, never immerse your tool, battery pack or charger in fluid or allow a fluid to flow inside them. Corrosive or conductive fluids, such as seawater, certain industrial chemicals, and bleach or bleach-containing products, etc., can cause a short circuit.

WARNING

Do not charge non-rechargeable batteries.

SYMBOLLOGY



Volts



Direct Current



Watts



Read operator's manual



Wear safety glasses.



Risk of Injury



Do not dispose of electric tools together with household waste material. Electric tools and electronic equipment that have reached the end of their life must be collected separately and returned to an environmentally compatible recycling facility.

Regulatory Compliance Mark (RCM). This product meets applicable regulatory requirements.



SPECIFICATIONS

- Cat. No. .M18 ONEBLHPT
- Volts 18V DC
- Watts 450

Compression Range

- Nominal Force 32kN
- Using Ring < Ø 4" (100 mm)
- Using Jaws < Ø 2" (50 mm)
- Battery Type M18™

Recommended Ambient

- Charger Type M18™
- Operating Temperature -10°C to 50°C

FUNCTIONAL DESCRIPTION

1. Start button

2. Green LED
3. Red LED
4. Press jaw
5. Retaining pin
6. Release button
7. Handle
8. Coin battery door
9. ONE-KEY™
Indicator (Not shown)

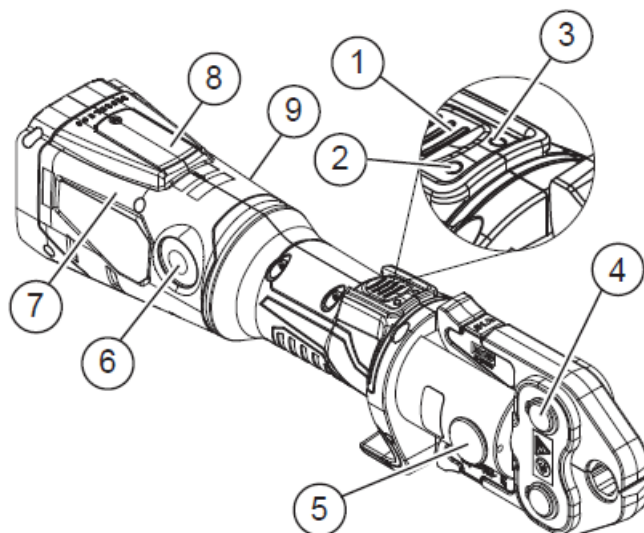

ASSEMBLY

WARNING

Removing/Inserting the Battery

To remove the battery, push in the release buttons and pull the battery pack away from the tool.

WARNING Always remove battery pack before To insert the battery, slide the pack into the body of the tool. Make sure it latches securely into place.

Use tool only with MILWAUKEE® or MILWAUKEE® approved press jaws, press fittings, and pipe for which they are designed. Other uses may cause injury or damage to the tool, accessories, and pipes. Leaking may result.

Inserting/Removing the Press jaw

1. Pull out the retaining pin (1).
2. Insert the press jaw (2).
3. Push in the retaining pin (3).

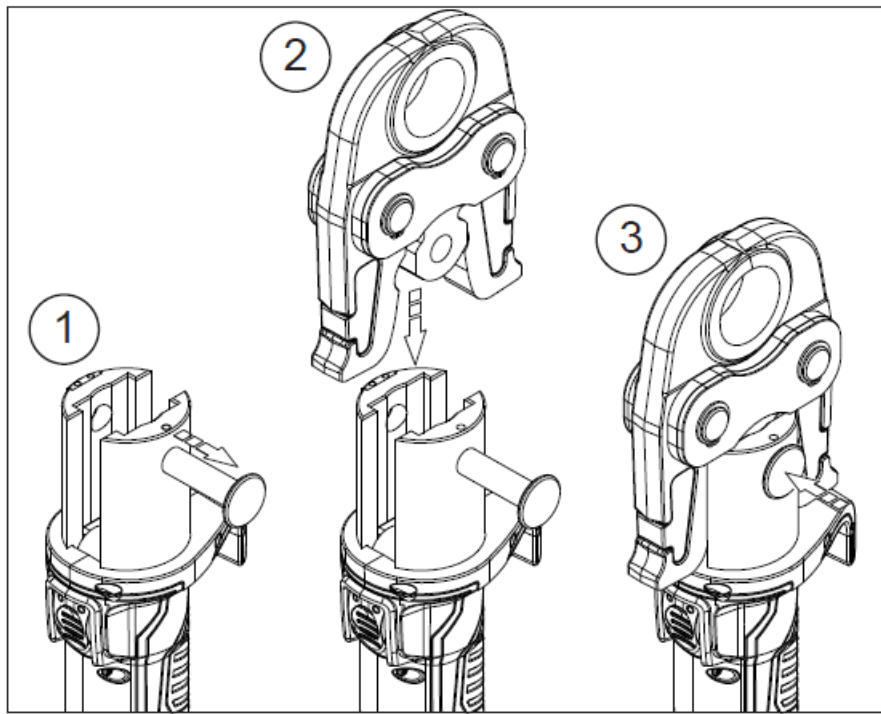

ONE-KEY™

To learn more about the ONE-KEY™ functionality for this tool, please refer to the quick reference included with this product or go to www.milwaukeetool.com.au/www.milwaukeetool.co.nz. To download the ONE-KEY™ app, visit the App Store or Google Play from your smart device.

ONE-KEY™ Indicator	
Solid Blue	Wireless mode is active and ready app.
Blinking Blue	Tool is actively communicating with the ONE-KEY™ app.
Blinking Red	Tool is in security lockout and can be unlocked by the owner via the ONE-KEY™ app.

OPERATION

WARNING

To reduce the risk of injury, always wear safety goggles or glasses with side shields.

Pressing

Before beginning a press, inspect the jaw assembly for cracks or other damage. Do not use a damaged jaw assembly. Return damaged jaw assembly to a MILWAUKEE® service facility.

The tool will turn off automatically after 30 minutes of no use.

Inspect and discard workpieces with cracks or wear before use. Materials may crack or shatter.

1. Turn the tool ON by quickly pressing and releasing the start button.
2. Open the jaws and place around the fitting
3. Hold tool securely. Press and hold the start button. The green LED will go out.
4. The automatic press cycle begins. Release the start button and continue to hold the tool securely.
5. When the press cycle is complete the tool will switch LED will light.

6. To cancel the automatic press cycle, press and hold the release button. Hold tool securely until jaws open
7. If the tool is in use for 30 minutes continuously cool down for at least 15 minutes before continuing. Under normal use (e.g., plumbing/mechanical) press freely and pay attention to the LED indicators (see “Troubleshooting”).
8. If the red LED lights, press the start button. If the tool does not run, return the tool to a MILWAUKEE® service facility for repairs.
9. If the red and green LEDs blink alternately, the tool must be serviced by a MILWAUKEE® service facility.

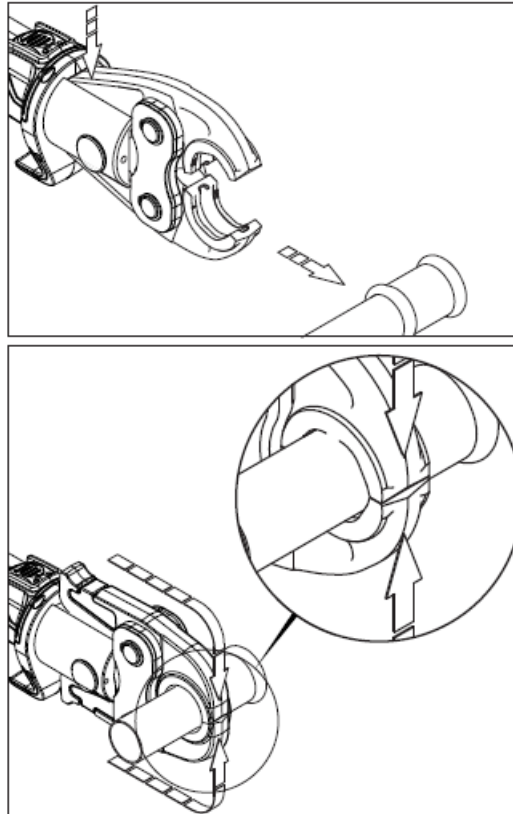

Troubleshooting

LED	Cause	Solution
Green	The battery	Charge the battery.
LED	is not	
blinking	charged to	
	complete	
	a pressing	
	operation.	
	The retaining	Insert the retaining pin, or
	pin is not	check the retaining
	correctly shut	pin and cylinder.
	or has come	NOTE: The pressing
	loose.	operation may not have
		been completed. Check and
		repeat if necessary.
Red	Device	Bring device into operating
LED blinking	not within operating	temperature range -10°C to 50°C.
	temperature	
	range.	
Red LED on	Device fault	Retry operation. If Red LED remains lit, return the tool, charger and battery pack, to a MILWAUKEE® service facility for repairs.
Green and Red LED blinking alternately	Service needed	The tool has reached its service interval (50,000 cycles). Return the tool, charger and battery pack, to a MILWAUKEE® service facility for service.

MAINTENANCE

WARNING To reduce the risk of injury, always unplug the charger and remove the battery pack from the charger or tool before performing any maintenance. Never disassemble the tool, battery pack or charger. Contact a MILWAUKEE® service facility for ALL repairs.

Maintaining Tool

Keep your tool, battery pack and charger in good repair by adopting a regular maintenance program. Inspect your tool for issues such as undue noise, misalignment or binding of moving parts, breakage of parts, or any other condition that may affect the tool operation. Return the tool, battery pack, and charger to a MILWAUKEE® service facility for repair. After six months to one year, depending on use, return the tool, battery pack and charger to a MILWAUKEE® service facility for inspection.

If the tool does not start or operate at full power with a fully charged battery pack, clean the contacts on the battery pack. If the tool still does not work properly, return the tool, charger and battery pack, to a MILWAUKEE® service facility for repairs.

ONE-KEY™

WARNING Chemical Burn Hazard.

This device contains a lithium button/coin cell battery. A new or used battery can cause severe internal burns and lead to death in as little as 2 hours if swallowed or enters the body. Always secure the battery cover. If it does not close securely, stop using the device, remove the batteries, and keep it away from children. If you think batteries may have been swallowed or entered the body, seek immediate medical attention.

Internal Battery

An internal battery is used to facilitate full ONE-KEY™ functionality.

If the Mode Indicator LED turns off and the tool cannot adjust speed, or if the Bluetooth communication stops working, remove and reinsert the coin cell battery to reset. Replace the battery if the problem continues.

To replace the battery:

1. Remove the battery pack.
2. Remove the screw(s) and open the battery door.
3. Remove the old battery, keep it away from children, and dispose of it properly.
4. Insert the new battery (3V CR2032), with the positive side facing up.
5. Close the battery door and tighten the screw(s) securely.

WARNING To reduce the risk of personal injury or damage, never immerse your tool, battery pack or charger in liquid or
Cleaning

Clean dust and debris from vents. Keep handles clean, dry and free of oil or grease. Use only mild soap and a damp cloth to clean, since certain cleaning agents and solvents are harmful to plastics and other insulated parts. Some of these include gasoline, turpentine, lacquer thinner, paint thinner, chlorinated cleaning solvents, ammonia and household detergent combustible solvents around tools.

Repairs

For repairs, return the tool, battery pack and charger to the nearest authorized service center.

ACCESSORIES

WARNING Use only recommended accessories. Others may be hazardous.

For a complete listing of accessories, go online to www.milwaukeetool.com.au/
www.milwaukeetool.co.nz or contact a distributor.

WARRANTY – AUSTRALIA and NEW ZEALAND

Please refer to Australian and New Zealand warranty supplied with tool. This warranty applies only to product sold by authorized dealers in Australia and New Zealand.

SERVICE – AUSTRALIA and NEW ZEALAND

MILWAUKEE® prides itself in producing a premium quality product that is Nothing But Heavy Duty™. Your satisfaction with our products is very important to us! If you encounter any problems with the operation of this tool, please contact your authorized MILWAUKEE® dealer.

For a list of MILWAUKEE® dealers, guarantee or service agents please contact MILWAUKEE® Customer Service or visit our website.

(Australia Toll Free Telephone Number 1300 645 928)

(New Zealand Toll Free Telephone Number 0800 645 928)

or visit milwaukeetool.com.au/milwaukeetool.co.nz.

Milwaukee Electric Tool Corporation

13135 West Lisbon Road, Brookfield, Wisconsin U.S.A. 53005

Milwaukee Tool (Australia)
26 – 40 Nina Link, Dandenong South,
Victoria, 3175, Australia

Milwaukee Tool (New Zealand)
274 Church Street, Penrose,
Auckland, 1061, New Zealand

DESIGNED BY MILWAUKEE ELECTRIC TOOL CORP. PROFESSIONALLY
MADE IN CHINA
PRINTED IN CHINA

Documents / Resources

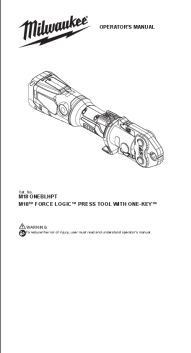
	<p>milwaukee M18 Force Logic press Tool with One-Key [pdf] User Manual M18 ONEBLHPT, M18 Force Logic press Tool with One-Key, M18, Force Logic press Tool with One-Key</p>
---	--