

*Milwaukee*

## **M18 FMT Oscillating Multi Tool Kit**



# **Milwaukee M18 FMT Oscillating Multi Tool Kit Instruction Manual**

[Home](#) » [Milwaukee](#) » Milwaukee M18 FMT Oscillating Multi Tool Kit Instruction Manual 

### **Contents**

- [1 Milwaukee M18 FMT Oscillating Multi Tool Kit](#)
- [2 Specifications](#)
- [3 FAQs](#)
- [4 WHAT IN THE BOX](#)
- [5 INSTALLATION INSTRUCTIONS](#)
- [6 CHARGING](#)
- [7 PRODUCT USING INSTRUCTIONS](#)
- [8 TECHNICAL DATA](#)
- [9 Device description](#)
- [10 MAINTENANCE](#)
- [11 BATTERIES](#)
- [12 SYMBOLS](#)
- [13 CONTACT INFORMATION](#)
- [14 Documents / Resources](#)
  - [14.1 References](#)



**Milwaukee M18 FMT Oscillating Multi Tool Kit**



## Specifications

- **Model:** M18 FMT
- **Contents:** Technical Data, Safety Instructions, Specified Conditions of Use, Declaration of Conformity, Batteries, Maintenance, Symbols

## FAQs

- **Q: How do I change the batteries?**
  - **A:** To change the batteries, follow the instructions provided in the manual. Typically, you need to locate the battery compartment, remove the old batteries, and insert new ones following the correct polarity.
- **Q: What should I do in case of a malfunction?**
  - **A:** If you encounter any issues or malfunctions with the product, refer to the troubleshooting section in the manual. If problems persist, contact customer support for assistance.
- **Q: Can I use the product for outdoor applications?**
  - **A:** The recommended usage conditions specify whether the product is suitable for outdoor applications. Check the manual for guidance on using the product outdoors.

## WHAT IN THE BOX



5x

## INSTALLATION INSTRUCTIONS

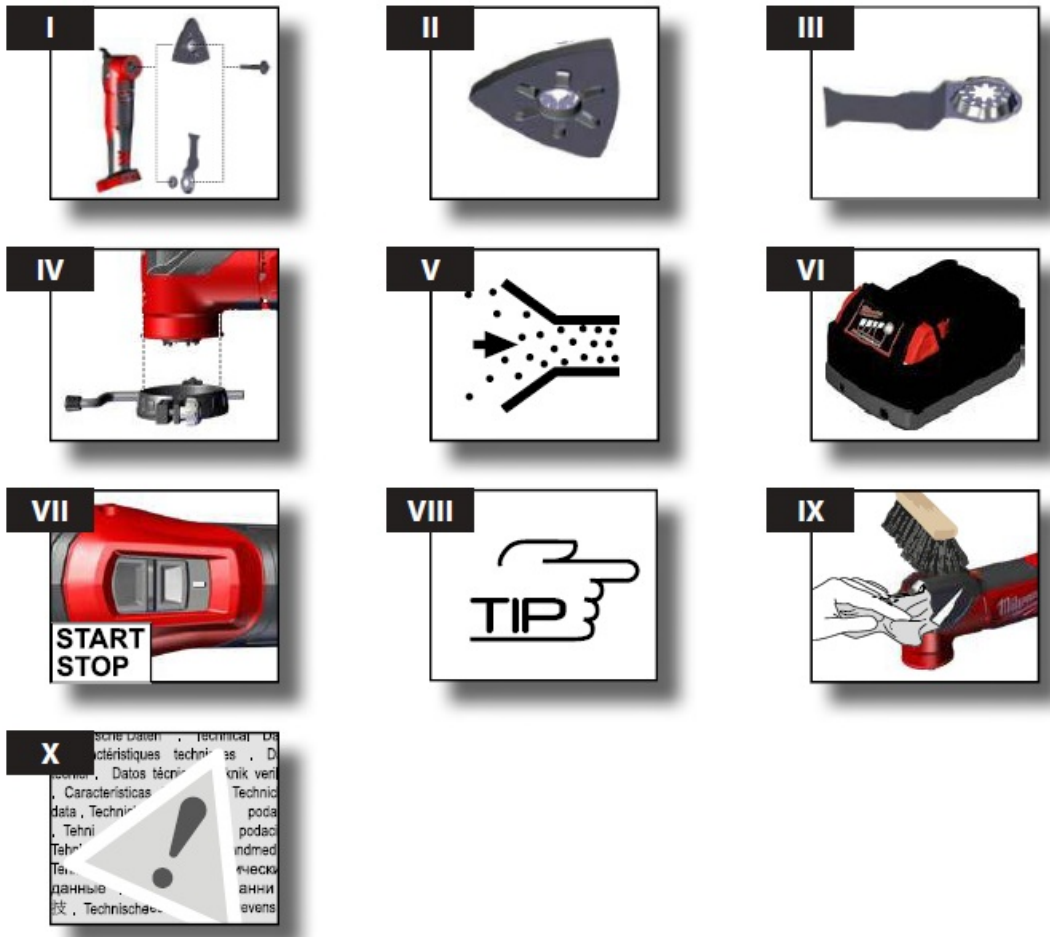







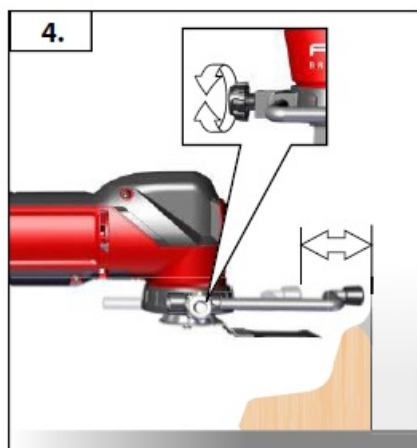
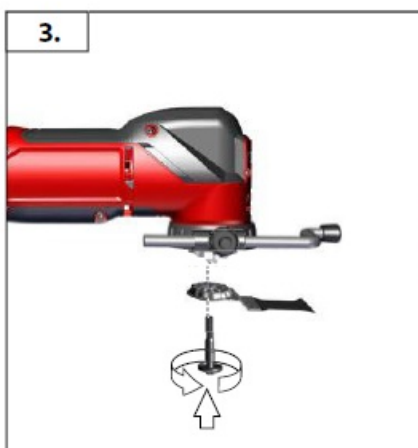



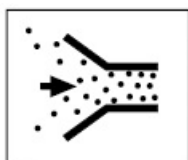

## CHARGING

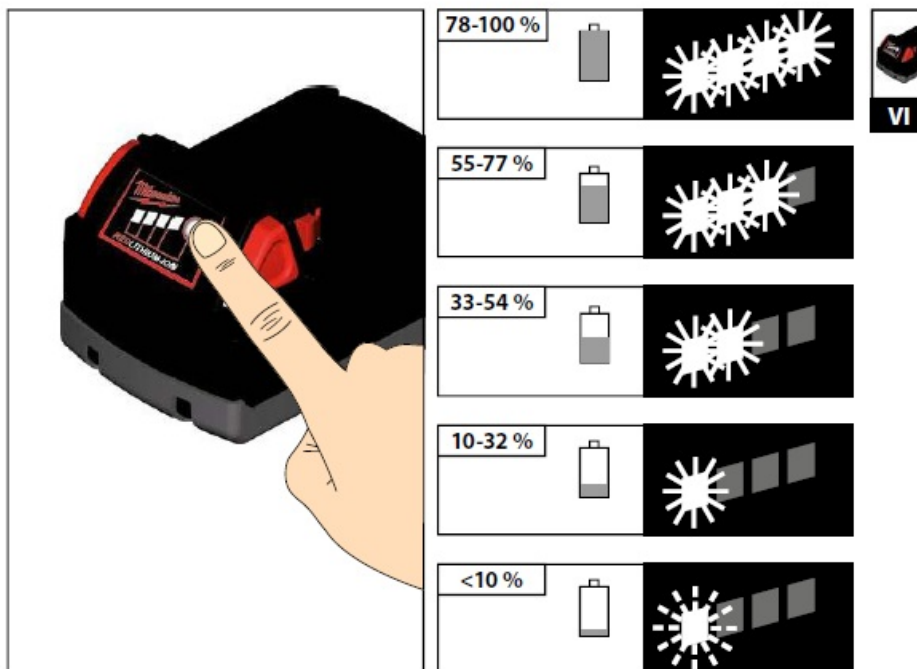

## PRODUCT USING INSTRUCTIONS



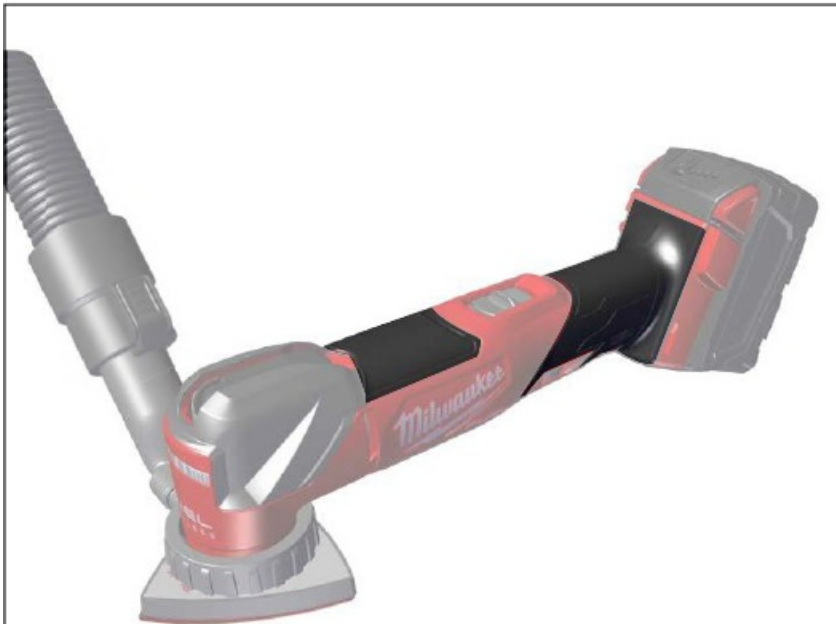

START  
STOP  
VII

#### Insulated gripping surface

Isolierte Grifffläche  
Surface de prise isolée  
Superficie di presa isolata  
Superficie de agarre con aislamiento  
Superficie de pega isolada  
Geïsoleerde handgrepen  
Isolerede gribeflader  
Isolert gripeflate  
Isolerad greppyta

Eristetty tarttumapinta  
Μονωμένη επιφάνεια λαβής  
İzolasyonlu tutma yüzeyi  
Izolovaná uchopovací plocha  
Izolovaná úchopná plocha  
Izolowana powierzchnia uchwytu  
Szigetelt fogófelület  
Izolirana prijemalna površina  
Izolirana površina za držanje  
Izolēta satveršanas virsma

Izoliuotas rankenos paviršius  
Isoleeritud pideme piirkond  
Изолированная поверхность ручки  
Изолирана повърхност за хващане  
Suprafață de prindere izolată  
Изолирана површина на дршката  
Изольована поверхня ручки  
مساحة المقبض معزولة



START  
STOP  
VII



Allow the tool to come to full speed before beginning the work.



## WARNING

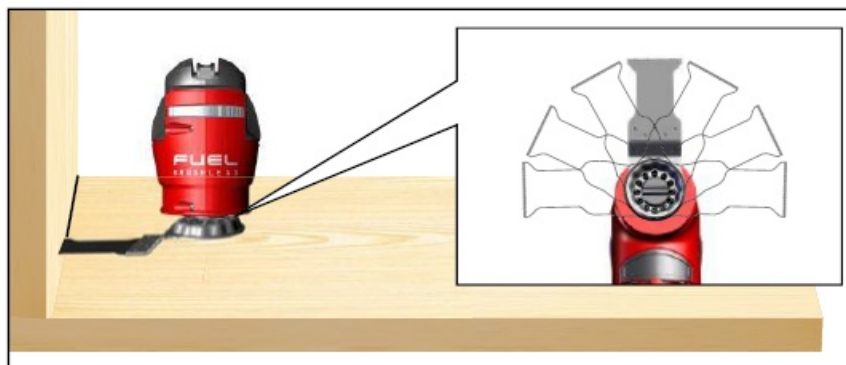
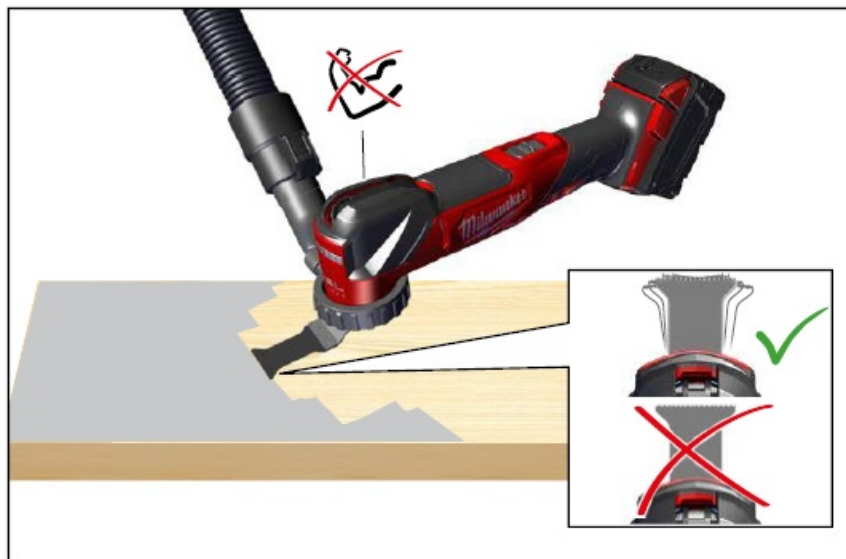



**TECHNICAL DATA**

<b>TECHNICAL DATA Multitool</b>	<b>M18 FMT</b>
Production code	4833 38 01 ... ... 000001-999999
Battery voltage	18 V
Weight according EPTA-Procedure 01/2014 (2,0 Ah... 12,0 Ah)	1,6 kg ... 2,7 kg
Oscillating angle left/right	2,1°/ 2,1°
Deltasander no load oscillation frequency	10000-20000 min-1
Recommended Ambient Operating Temperature	-18°C ... +50 °C
Recommended battery types	M18B... M18HB..
Recommended charger	M12-18..., M1418C6
<b>Noise information</b>  Measured values determined according to BS EN 62841. Typically, the A-weighted noise levels of the tool are:	
Sound pressure level (Uncertainty K=3dB(A)) Sound power level (Uncertainty K=3dB (A)) <b>Wear ear protectors!</b>	79,41 dB(A) 90,41 dB(A)
<b>Vibration information</b>  Vibration total values (triaxial vector sum) determined according to BS EN 62841 Vibration emission value ah*  Sanding Uncertainty K=  cutting wood Uncertainty K=	3,37 m/s2  1,50 m/s2  5,21 m/s2  1,50 m/s2

\* with saw blade bimetal, dimension 81 x 34 x 1,25 mm

## WARNING!

- The vibration and noise emission level given in this information sheet has been measured in accordance with a standardized test given in
- BS EN 62841 and may be used to compare one tool with another. It may be used for a preliminary assessment of exposure.
- The declared vibration and noise emission level represents the main applications of the tool. However if the tool is used for different applications, with different accessories or poorly maintained, the vibration and noise emission may differ. This may significantly increase the exposure level over the total working period.
- An estimation of the level of exposure to vibration and noise should also take into account the times when the tool is switched off or when it is running but not actually doing the job. This may significantly reduce the



exposure level over the total working period.

- Identify additional safety measures to protect the operator from the effects of vibration and/or noise such as: maintain the tool and the accessories, keep the hands warm, organization of work patterns.
- Wear ear protectors. Exposure to noise can cause hearing loss.

## Device description

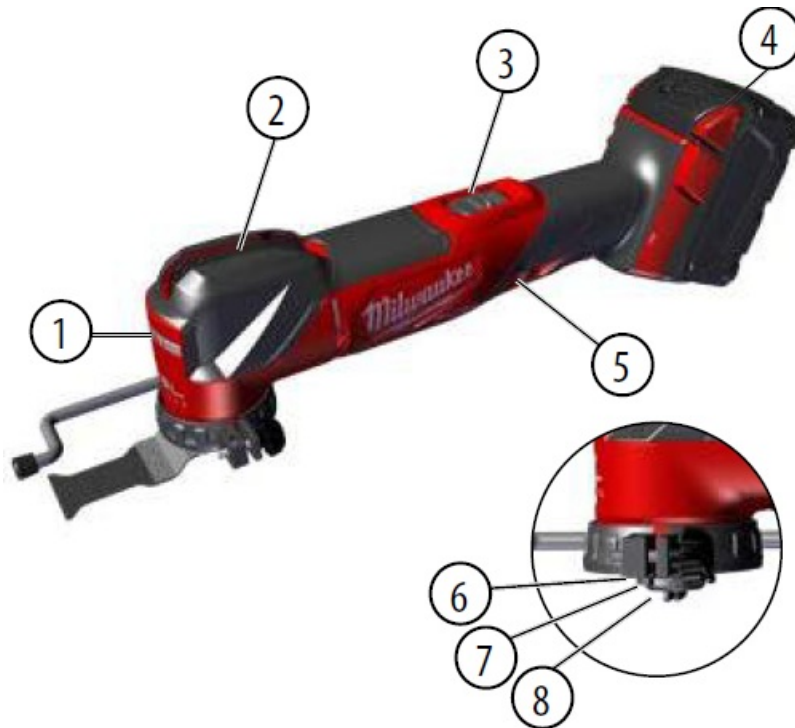

1. LED
2. Quick release lever
3. On/Off switch
4. Battery
5. Speed dial
6. Inner flange
7. Adapter
8. Accessory bolt

## WARNING

- Read all safety warnings, instructions, illustrations and specifications provided with this power tool. Failure to follow all instructions listed below may result in electric shock, fire and/ or serious injury.
- Save all warnings and instructions for future reference.

## A MULTITOOL SAFETY WARNINGS

- Hold the power tool by insulated gripping surfaces, when performing an operation where the cutting accessory may contact hidden wiring. Cutting accessory contacting a „live” wire may make exposed metal parts of the power tool „live” and could give the operator an electric shock.
- Use clamps or another practical way to secure and support the workpiece to a stable platform. Holding the

workpiece by hand or against your body leaves it unstable and may lead to loss of control.

### **Additional Safety and Working Instructions**

- Use protective equipment. Always wear safety glasses when working with the machine. The use of protective clothing is recommended, such as dust mask, protective gloves, sturdy non-slip footwear, helmet and ear defenders.
- The dust produced when using this tool may be harmful to health.
- Do not inhale the dust. Wear a suitable dust protection mask.
- Do not machine any materials that present a danger to health (e.g. asbestos).
- Switch the device off immediately if the insertion tool stalls! Do not switch the device on again while the insertion tool is stalled, as doing so could trigger a sudden recoil with a high reactive force. Determine why the insertion tool stalled and rectify this, paying heed to the safety instructions.

### **Possible causes may be:**

- it is tilted in the workpiece to be machined
- it has pierced through the material to be machined
- the power tool is overloaded
  - Do not reach into the machine while it is running.
  - The insertion tool may become hot during use.

### **WARNING**

- **The danger of burns!**
  - when changing tools
  - when setting the device down
- Chips and splinters must not be removed while the machine is running.
- When working in walls ceilings, or floors, take care to avoid electric cables and gas or waterpipes.
- Clamp your workpiece with a clamping device. Unclamped workpieces can cause severe injury and damage.
- Do not use cracked or distorted saw blades.
- Plunge cuts without pre-drilling a hole are possible with soft materials (wood, light building materials for walls). Harder materials (metals) must first be drilled with a hole corresponding to the size of the saw blade.
- Remove the battery pack before starting any work on the machine.
- Do not dispose of used battery packs in the household refuse or by burning them. Milwaukee Distributors offers to retrieve old batteries to protect our environment.
- Do not store the battery pack together with metal objects (short circuit risk).
- No metal parts must be allowed to enter the battery section of the charger (short circuit risk).
- Use only System M18 chargers for charging System M18 battery packs. Do not use battery packs from other systems.
- Never break open battery packs and chargers and store only in dry rooms. Keep dry at all times.
- Battery acid may leak from damaged batteries under extreme load or extreme temperatures. In case of contact with battery acid wash it off immediately with soap and water. In case of eye contact rinse thoroughly for at least 10 minutes and immediately seek medical attention.

## WARNING

- To reduce the risk of fire, personal injury, and product damage due to a short circuit, never immerse your device, battery pack, or charger in fluid or allow fluid to flow inside them.
- Corrosive or conductive fluids, such as seawater, certain industrial chemicals, and bleach or bleach-containing products, etc., Can cause a short circuit.

## SPECIFIED CONDITIONS OF USE

- The Maschine can be combined with different tools and is designed for the following use:
  - **Sander Head:** sanding wood, metal and plastics
  - **Segment saw blade head:** for cutting flush to a surface in wood and plastics.
  - **Universal blade head:** for working in wood.
- Do not use this product in any other way as stated for normal use.

## MAINTENANCE

- Use only Milwaukee accessories and Milwaukee spare parts. Should components need to be replaced which have not been described, please contact one of our Milwaukee service agents (see our list of guarantee/service addresses).
- If needed, an exploded view of the tool can be ordered. Please state Article No. as well as the machine type printed on the label and order the drawing at your local service agents or directly at:
- Techtronic Industries GmbH, Max-Eyth-Straße 10, 71364 Winnenden, Germany.

## BATTERIES

- Battery packs which have not been used for some time should be recharged before use.
- Temperatures in excess of 50°C (122°F) reduce the performance of the battery pack. Avoid extended exposure to heat or sunshine (risk of overheating).
- The contacts of chargers and battery packs must be kept clean.
- For an optimum lifetime, the battery packs have to be fully charged, after use.
- To obtain the longest possible battery life remove the battery pack from the charger once it is fully charged.
- For battery pack storage longer than 30 days:
- Store the battery pack where the temperature is below 27°C and away from moisture.
- Store the battery packs in a 30% – 50% charged condition.

## BATTERY PACK PROTECTION

- The battery pack has overload protection that protects it from being overloaded and helps to ensure long life. Under extreme stress, the battery electronics switch of the machine automatically.
- To restart, switch the machine of and then on again. If the machine does not start up again, the battery pack may have discharged completely. In this case it must be recharged in the battery charger.

## TRANSPORTING LITHIUM BATTERIES

- Lithium-ion batteries are subject to the Dangerous Goods Legislation requirements.
  - Transportation of those batteries has to be done in accordance with local, national and international provisions and regulations.
  - The user can transport the batteries by road without further requirements.
  - Commercial transport of Lithium-Ion batteries by third parties is subject to Dangerous Goods regulations.
- Transport preparation and transport are exclusively to be carried out by appropriately trained persons and the process has to be accompanied by corresponding experts.

#### **When transporting batteries:**

- Ensure that battery contact terminals are protected and insulated to prevent short circuits.
- Ensure that the battery pack is secured against movement within the packaging.
- Do not transport batteries that are cracked or leak. Check with the forwarding company for further advice.

#### **EC-DECLARATION OF CONFORMIT Y**

- We declare under our sole responsibility that the product described under "Technical Data" fulfills all the relevant provisions of the directives
- 2011/65/EU (RoHS)
- 2014/30/EU
- 2006/42/EC
- and the following harmonized standards have been used
- EN 62841-1:2015
- EN 55014-1:2017+A11:2020
- EN 55014-2:2015
- EN IEC 63000:2018



- Winnenden, 2020-10-10

- Alexander Krug / Managing Director
- Authorized to compile the technical file
- Techtronic Industries GmbH
- Max-Eyth-Straße 10, 71364 Winnenden, Germany

#### **GB-DECLARATION OF CONFORMIT Y**

- We declare as the manufacturer under our sole responsibility that the product described under „Technical Data“ fulfills the relevant provisions of the following Regulations
- S.I. 2012/3032 (as amended), S.I. 2008/1597 (as amended),
- S.I. 2016/1091 (as amended) and that the following designated
- standards have been used:

- BS EN 62841-1:2015
- BS EN 55014-1:2017+A11:2020
- BS EN 55014-2:2015
- BS EN IEC 63000:2018
- Winnenden, 2020-10-10



- Alexander Krug / Managing Director
- Authorized to compile the technical file
- Techtronic Industries GmbH
- Max-Eyth-Straße 10, 71364 Winnenden, Germany

## SYMBOLS



CAUTION! WARNING! DANGER!



Remove the battery pack before starting any work on the appliance.



Please read the instructions carefully before starting the machine.



Always wear goggles when using the machine.



Wear gloves!

**n<sub>0</sub>**

Stroke rate under no-load

**V**

Voltage



Direct Current



Do not dispose electric tools, batteries/rechargeable batteries together with household waste material. Electric tools and batteries that have reached the end of their life must be collected separately and returned to an environmentally compatible recycling facility. Check with your local authority or retailer for recycling advice and collection point.



European Conformity Mark



Ukraine Conformity Mark



EurAsian Conformity Mark



British Conformity Mark

## CONTACT INFORMATION

- Copyright 2020
- Techtronic Industries GmbH
- Max-Eyth-Straße 10

- 71364 Winnenden
- Germany
- +49 (0) 7195-12-0
- [www.milwaukeeeetool.eu](http://www.milwaukeeeetool.eu)
- Techtronic Industries (UK) Ltd
- Fieldhouse Lane
- Marlow Bucks SL7 1HZ
- UK
- (12.20) 4931 4258 91

## Documents / Resources

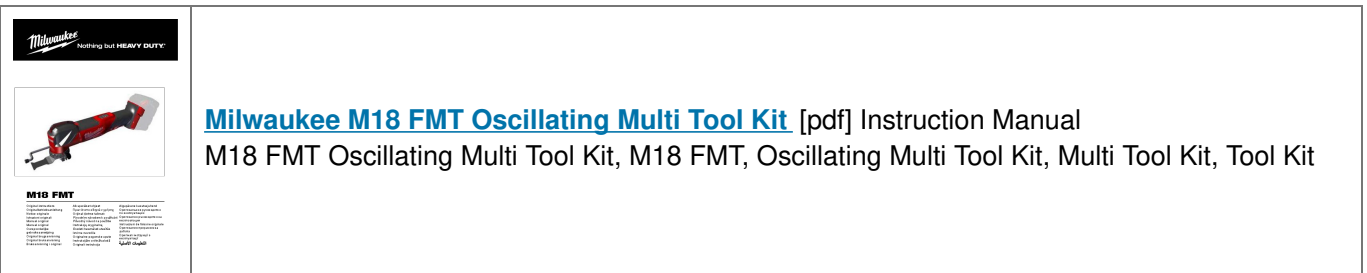

## References

- [!\[\]\(065aacad479feea1b3f501fa02b79a7a\_img.jpg\) Milwaukee Tool Europe | Cordless Power Tools, Outdoor Tools, Hand Tools, PPE, Work wear. Storage and Accessories. | Milwaukee Tools Europe](#)
- [User Manual](#)

**Manuals+, Privacy Policy**

This website is an independent publication and is neither affiliated with nor endorsed by any of the trademark owners. The "Bluetooth®" word mark and logos are registered trademarks owned by Bluetooth SIG, Inc. The "Wi-Fi®" word mark and logos are registered trademarks owned by the Wi-Fi Alliance. Any use of these marks on this website does not imply any affiliation with or endorsement.