

**Milesight**  
**WS203 Motion**  
**and TH Sensor**



## Milesight WS203 Motion and TH Sensor User Guide

[Home](#) » [Milesight](#) » Milesight WS203 Motion and TH Sensor User Guide 

### Contents

- [1 Milesight WS203 Motion and TH Sensor](#)
- [2 Product Usage Instructions](#)
- [3 Safety Precautions](#)
- [4 Product Introduction](#)
- [5 Hardware Introduction](#)
- [6 Operation Guide](#)
- [7 Installation](#)
- [8 Device Payload](#)
- [9 Documents / Resources](#)
  - [9.1 References](#)



**Milesight WS203 Motion and TH Sensor**



## Specifications

- **Product Name:** Motion & TH Sensor WS203
- **Compliance:** CE, FCC, RoHS
- **Features:** Passive Infrared and Fresnel Lens, High-accurate TH sensor, PIR sensor, Adjustable PIR covers

## Product Usage Instructions

### Installation

1. Ensure all items from the packing list are present and undamaged.
2. Mount the sensor in the desired location using appropriate mounting hardware.

### Power Button and LED Indicator

- **Function:** Power On/Off
- **Action:** Press and hold the power button for more than 3 seconds
- **Check On/Off Status:** Quickly press the power button once.
- **Reset to Factory Default PIR Status:** Press and hold the power button for more than 10 seconds

### LED Indicator:

- **Power On:** Off / On
- **Power Off:** On / Off
- **Light On:** Device is on / Light Off: Device is off
- **Blink quickly:** Blinks twice

## NFC Configuration

**Note:**

1. Ensure the location of the NFC area of the smartphone and remove the phone case.
2. If the NFC configuration fails, remove the phone and try again.
3. Use a dedicated NFC reader provided by Milesight IoT for configuration.

**FAQ****• Q: How can I reset the WS203 sensor to factory default PIR status?**

**A:** Press and hold the power button for more than 10 seconds to reset to factory default PIR status.

**• Q: What should I do if the NFC configuration fails?**

**A:** Remove the phone, ensure proper positioning, and try again. If it still fails, use a dedicated NFC reader provided by Milesight IoT for configuration.

**Safety Precautions**

Milesight will not shoulder responsibility for any loss or damage resulting from not following the instructions of this operating guide.

- The device must not be disassembled or remodeled in any way.
- Do not expose the PIR lens to direct sunlight.
- Do not paint or clean the PIR lens, or it will affect the detection of the device.
- Ensure that you install the battery properly. Choose the right model and make it connect to the positive and negative terminals correctly.
- Do not place the device where the temperature is below/above the operating range.
- Do not place the device close to objects with naked flames, heat sources (such as an oven), or exposure to sunlight, cold sources, liquid, and extreme temperature changes.
- Remove the battery from the device if it is not to be used for an extended period. Otherwise, the battery might leak and damage the device.
- The device must never be subjected to shocks or impacts.

**Declaration of Conformity**

WS203 conforms with the essential requirements and other relevant provisions of the CE, FCC, and RoHS.

**Copyright © 2011-2023 Milesight. All rights reserved.**

All information in this guide is protected by copyright law. Whereby, no organization or individual shall copy or reproduce the whole or part of this user guide by any means without written authorization from Xiamen Milesight IoT Co., Ltd.

**For assistance, please contact**

**Milesight technical support:**

- **Email:** [iot.support@milesight.com](mailto:iot.support@milesight.com)
- **Support Portal:** support.milesight-iot.com
- **Tel:** 86-592-5085280
- **Fax:** 86-592-5023065
- **Address:** Building C09, Software Park Phase III, Xiamen 361024, China.

## Revision History

Date	Doc Version	Description
Aug. 3, 2023	V 1.0	Initial version

## Product Introduction

### Overview

- WS203 is an environmental monitoring device that combines motion and temperature/humidity (TH) sensors. By detecting motion within a 6-meter range based on passive infrared (PIR) technology, the WS203 can trigger TH detection and periodically report environmental status over the LoRaWAN® network.
- With easy configuration and wireless detection, the WS203 offers a reliable and convenient solution for space and TH optimization. Compatible with the Milesight LoRaWAN® gateway and Milesight IoT Cloud platform, it enables real-time monitoring of occupant status for effective remote management. The WS203 can find applications in various settings including smart offices, buildings, hospitals, and more.

### Key Features

- Equipped with passive infrared and Fresnel Lens for motion or occupancy detection
- Built-in high-accurate TH sensor along with PIR sensor enabling communicative triggers
- Provide different types of PIR covers for adjustable and flexible field angles and different detecting ranges.
- Store locally 1000 historical records and support retransmission to prevent data loss.
- Equipped with NFC for one-touch configuration and support card emulation mode
- Function well with standard LoRaWAN® gateways and network servers
- Compatible with Milesight IoT Cloud
- Support Milesight D2D protocol to enable ultra-low latency and direct control without a gateway.

## Hardware Introduction

### Packing List



1 × WS203 Sensor



4 × PIR Covers



1 × 3M Tape



2 × Mounting Kits



1 × Quick Start Guide



1 ×

Warranty Card

If any of the above items are missing or damaged, please contact your sales representative.

## Hardware Overview

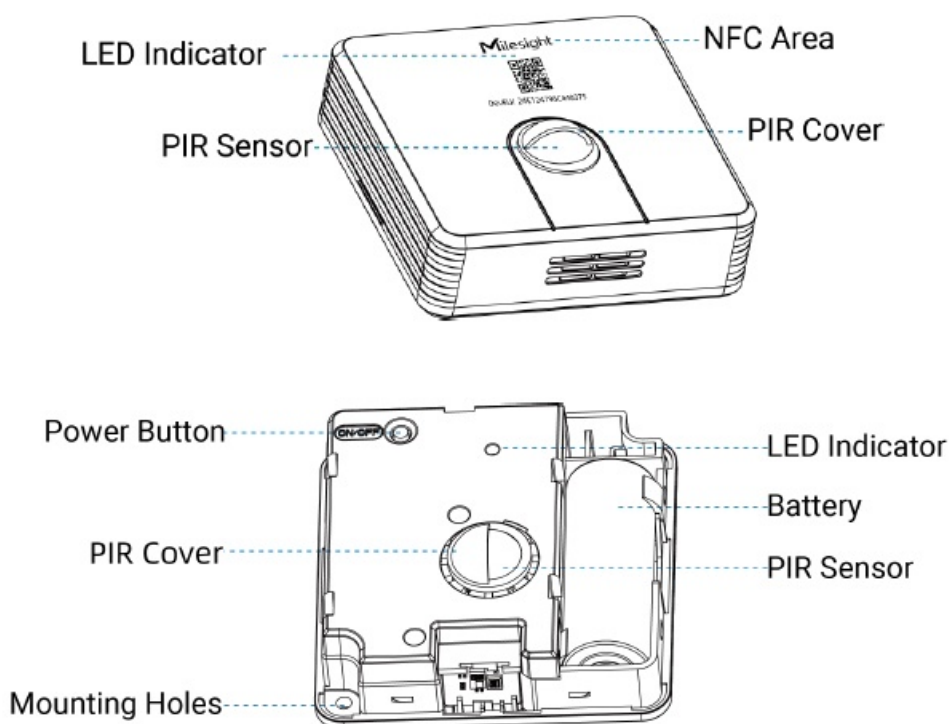

## Power Button and LED Indicator

Function	Action	LED Indicator
Power On/Off	Press and hold the power button for more than 3 seconds	Power On: Off → On
		Power Off: On → Off
Check On/Off Status	Quickly press the power button once.	Light On: Device is on
		Light Off: The device is off.
Reset to Factory Default	Press and hold the power button for more than 10 seconds	Blink quickly
PIR Status	Vacant → Occupied	Blinks twice
	Occupied → Vacant	Blinks twice

### Dimensions (mm)

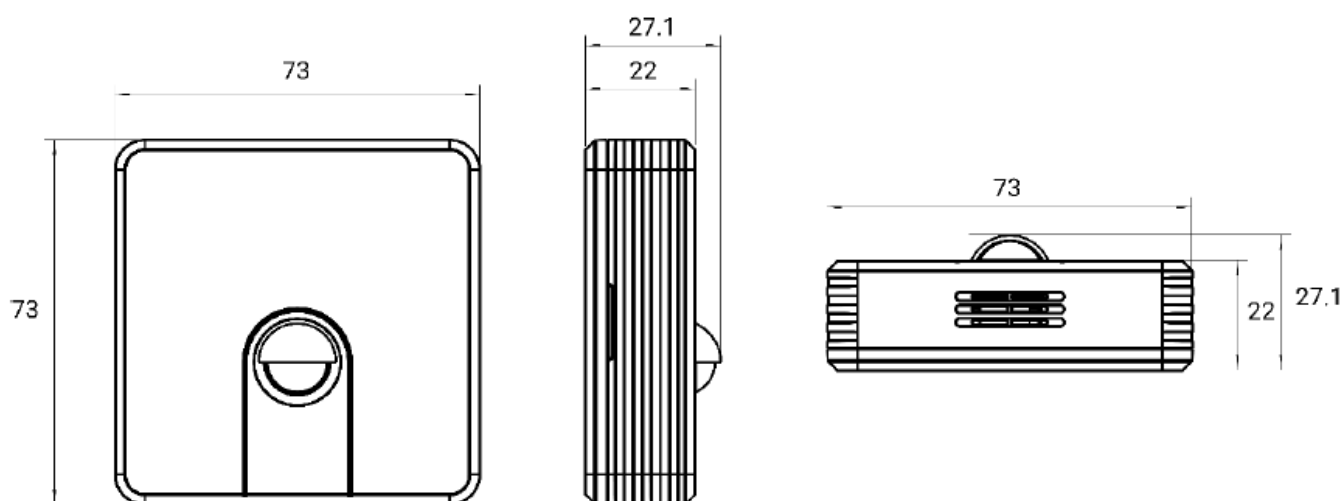

## Operation Guide

### NFC Configuration

WS203 sensor can be monitored and configured via NFC. Please refer to the following configuration steps.

1. Download and install the Milesight ToolBox App from Google Play or Apple App Store.
2. Enable NFC on the smartphone and launch Milesight ToolBox.
3. Attach the NFC area of a smartphone to the device, and click NFC Read to read device information. The basic information and settings of the device will be shown on the ToolBox App if it's recognized successfully. You can read and configure the device by tapping the Read/Write device on the App. To protect the security of the device, please change the password when first configuring. The default password is 123456.

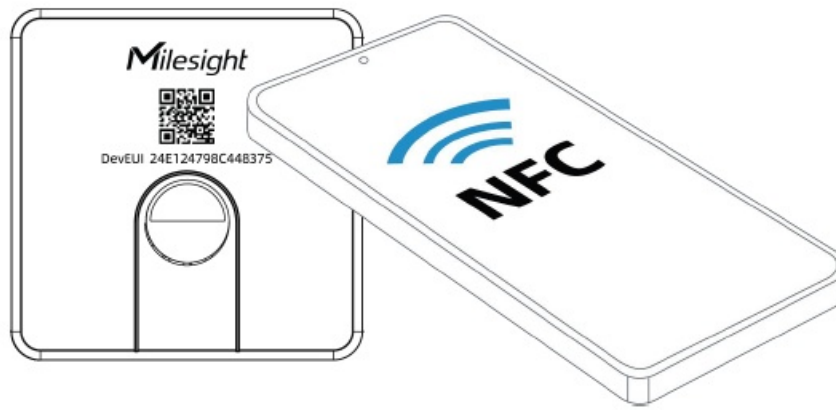

**Note:**

1. Ensure the location of the NFC area of the smartphone and it's recommended to take off the phone case.
2. If the smartphone fails to read/write configurations via NFC, remove the phone and try again.
3. WS203 sensor can also be configured by a dedicated NFC reader provided by Milesight IoT.

**LoRaWAN® Settings**

Go to Device > Settings > LoRaWAN® Settings of ToolBox App to configure AppEUI, Join Type, Application Key, and other information. You can also keep all settings by default.

Device EUI

24E124791D196040

\* APP EUI

24e124c0002a0001

\* Application Port



85



Join Type

ABP

\* Network Session Key

\*\*\*\*\*

\* Application Session Key

\*\*\*\*\*

Parameters	Description
Device EUI	Unique ID of the device which can also be found on the label.
App EUI	The default App EUI is 24E124C0002A0001.
Application Port	The port is used for sending and receiving data, the default port is 85.
Join Type	OTAA and ABP modes are available.
Application Key	App key for OTAA mode, the default is 5572404C696E6B4C6F52613230313823.
Network Session Key	Nwkskey for ABP mode, the default is 5572404C696E6B4C6F52613230313823.
Application Session Key	Appskey for ABP mode, the default is 5572404C696E6B4C6F52613230313823.
Device Address	DevAddr for ABP mode, the default is the 5th to 12th digits of the SN.
LoRaWAN® Version	V1.0.2 and V1.0.3 are available.
Work Mode	It's fixed as Class A.
RX2 Data Rate	RX2 data rate to receive downlinks.
RX2 Frequency	RX2 frequency to receive downlinks. Unit: Hz

Channel Mode	Select Standard-Channel mode or Single-Channel mode. When Single-Channel mode is enabled, only one channel can be selected to send uplinks. Please enable Single-Channel mode if connecting to the DS7610.
--------------	--



Channel	<p>Enable or disable the frequency to send uplinks.</p> <p>Examples:</p> <p>1, 40: Enabling Channel 1 and Channel 40</p> <p>1-40: Enabling Channel 1 to Channel 40</p> <p>1-40, 60: Enabling Channel 1 to Channel 40 and Channel 60 All: Enabling all channels</p> <p>Null: Indicate that all channels are disabled</p> <div><p>Channel Mode</p><div>Standard-Channel ▼</div><p>Enable Channel Index ⓘ</p><div>0-71</div></div> <table><thead><tr><th>Index</th><th>Frequency/MHz ⓘ</th></tr></thead><tbody><tr><td>0 - 15</td><td>902.3 - 905.3</td></tr><tr><td>16 - 31</td><td>905.5 - 908.5</td></tr><tr><td>32 - 47</td><td>908.7 - 911.7</td></tr><tr><td>48 - 63</td><td>911.9 - 914.9</td></tr><tr><td>64 - 71</td><td>903 - 914.2</td></tr></tbody></table>	Index	Frequency/MHz ⓘ	0 - 15	902.3 - 905.3	16 - 31	905.5 - 908.5	32 - 47	908.7 - 911.7	48 - 63	911.9 - 914.9	64 - 71	903 - 914.2
Index	Frequency/MHz ⓘ												
0 - 15	902.3 - 905.3												
16 - 31	905.5 - 908.5												
32 - 47	908.7 - 911.7												
48 - 63	911.9 - 914.9												
64 - 71	903 - 914.2												
Confirmed Mode	If the device does not receive an ACK packet from the network server, it will resend data once.												
Rejoin Mode	<p>Reporting interval <math>\leq</math> 35 mins: the device will send a specific number of LinkCheckReq MAC packets to the network server every reporting interval or every double reporting interval to validate connectivity; If there is no response, the device will re-join the network.</p> <p>Reporting interval <math>&gt;</math> 35 mins: the device will send a specific number of LinkCheckReq MAC packets to the network server every reporting interval to validate connectivity; If there is no response, the device will re-join the network.</p>												
Set the number of packets sent.	When the rejoin mode is enabled, set the number of LinkCheckReq packets to send. Note: the actual sending number is Set the number of packet sent + 1.												

ADR Mode	Allow the network server to adjust the data rate of the device.
Spread Factor	If ADR is disabled, the device will send data via this spread factor.
Tx Power	Transmit power of the device.

**Note:**

1. Please contact sales for the device EUI list if there are many units.
2. Please contact sales if you need random App keys before purchase.
3. Select OTAA mode if you use the Milesight IoT cloud to manage devices.
4. Only OTAA mode supports rejoin mode.

**General Settings**

Go to Device > Setting > General Settings of ToolBox App to set the reporting interval, etc.

Temperature Unit ⓘ

°C
▼

Reporting Interval

-
30
+

min

Time to Report Vacancy / min ⓘ

5

LED Indicator ⓘ

☐

Data Storage ⓘ

☒

Data Retransmission ⓘ

☐

Change Password

☐



## Temperature



Over / °C

Below / °C

Collecting Interval



1



min

## Data Storage

WS203 supports storing 1000 data records locally and exports data via the ToolBox App. The device will record the data according to the reporting interval even not joining the network.

1. Go to Device > Status of ToolBox App to sync the device time.

Device Time

2023-08-08 19:22

Sync

2. Go to Device > Setting > General Settings to enable the data storage feature.

Data Storage



Data Retransmission



3. Go to Device > Maintenance of ToolBox App, click Export, then select the data time range and click Confirm to export data. The maximum export data period on the ToolBox App is 14 days.

Cancel

Export Data Period

Confirm

2023-08-01 19:44

To

2023-08-08 19:44

2023	6	17	42
2022	7	18	43
2023	8	1	19
		2	20
		3	21
		4	22
		5	23
		6	24
		7	25
		8	26
		9	27
		10	28
		11	29
		12	30
		13	31
		14	32
		15	33
		16	34
		17	35
		18	36
		19	37
		20	38
		21	39
		22	40
		23	41
		24	42
		25	43
		26	44
		27	45
		28	46
		29	47
		30	48
		31	49
		32	50
		33	51
		34	52
		35	53
		36	54
		37	55
		38	56
		39	57
		40	58
		41	59
		42	60
		43	61
		44	62
		45	63
		46	64
		47	65
		48	66
		49	67
		50	68
		51	69
		52	70
		53	71
		54	72
		55	73
		56	74
		57	75
		58	76
		59	77
		60	78
		61	79
		62	80
		63	81
		64	82
		65	83
		66	84
		67	85
		68	86
		69	87
		70	88
		71	89
		72	90
		73	91
		74	92
		75	93
		76	94
		77	95
		78	96
		79	97
		80	98
		81	99
		82	100
		83	101
		84	102
		85	103
		86	104
		87	105
		88	106
		89	107
		90	108
		91	109
		92	110
		93	111
		94	112
		95	113
		96	114
		97	115
		98	116
		99	117
		100	118
		101	119
		102	120
		103	121
		104	122
		105	123
		106	124
		107	125
		108	126
		109	127
		110	128
		111	129
		112	130
		113	131
		114	132
		115	133
		116	134
		117	135
		118	136
		119	137
		120	138
		121	139
		122	140
		123	141
		124	142
		125	143
		126	144
		127	145
		128	146
		129	147
		130	148
		131	149
		132	150
		133	151
		134	152
		135	153
		136	154
		137	155
		138	156
		139	157
		140	158
		141	159
		142	160
		143	161
		144	162
		145	163
		146	164
		147	165
		148	166
		149	167
		150	168
		151	169
		152	170
		153	171
		154	172
		155	173
		156	174
		157	175
		158	176
		159	177
		160	178
		161	179
		162	180
		163	181
		164	182
		165	183
		166	184
		167	185
		168	186
		169	187
		170	188
		171	189
		172	190
		173	191
		174	192
		175	193
		176	194
		177	195
		178	196
		179	197
		180	198
		181	199
		182	200
		183	201
		184	202
		185	203
		186	204
		187	205
		188	206
		189	207
		190	208
		191	209
		192	210
		193	211
		194	212
		195	213
		196	214
		197	215
		198	216
		199	217
		200	218
		201	219
		202	220
		203	221
		204	222
		205	223
		206	224
		207	225
		208	226
		209	227
		210	228
		211	229
		212	230
		213	231
		214	232
		215	233
		216	234
		217	235
		218	236
		219	237
		220	238
		221	239
		222	240
		223	241
		224	242
		225	243
		226	244
		227	245
		228	246
		229	247
		230	248
		231	249
		232	250
		233	251
		234	252
		235	253
		236	254
		237	255
		238	256
		239	257
		240	258
		241	259
		242	260
		243	261
		244	262
		245	263
		246	264
		247	265
		248	266
		249	267
		250	268
		251	269
		252	270
		253	271
		254	272
		255	273
		256	274
		257	275
		258	276
		259	277
		260	278
		261	279
		262	280
		263	281
		264	282
		265	283
		266	284
		267	285
		268	286
		269	287
		270	288
		271	289
		272	290
		273	291
		274	292
		275	293
		276	294
		277	295
		278	296
		279	297
		280	298
		281	299
		282	300
		283	301
		284	302
		285	303
		286	304
		287	305
		288	306
		289	307
		290	308
		291	309
		292	310
		293	311
		294	312
		295	313
		296	314
		297	315
		298	316
		299	317
		300	318
		301	319
		302	320
		303	321
		304	322
		305	323
		306	324
		307	325
		308	326
		309	327
		310	328
		311	329
		312	330
		313	331
		314	332
		315	333
		316	334
		317	335
		318	336
		319	337
		320	338
		321	339
		322	340
		323	341
		324	342
		325	343
		326	344
		327	345
		328	346
		329	347
		330	348
		331	349
		332	350
		333	351
		334	352
		335	353
		336	354
		337	355
		338	356
		339	357
		340	358
		341	359
		342	360
		343	361
		344	362
		345	363
		346	364
		347	365
		348	366
		349	367
		350	368
		351	369
		352	370
		353	371
		354	372
		355	373
		356	374
		357	375
		358	376
		359	377
		360	378
		361	379
		362	380
		363	381
		364	382
		365	383
		366	384
		367	385
		368	386
		369	387
		370	388
		371	389
		372	390
		373	391
		374	392
		375	393
		376	394
		377	395
		378	396
		379	397
		380	398
		381	399
		382	400
		383	401
		384	402
		385	403
		386	404
		387	405
		388	406
		389	407
		390	408
		391	409
		392	410
		393	411
		394	412
		395	413
		396	414
		397	415
		398	416
		399	417
		400	418
		401	419
		402	420
		403	421
		404	422
		405	423
		406	424

4. Click Export Record to find the export file records.



**Note:** Slide the file record to the left to delete the record.

5. Click Data Cleaning to clear all stored data inside the device if necessary.



### Data Retransmission

WS203 supports data retransmission to ensure the network server can get all data even if the network is down for some time. There are two ways to get the lost data:

- The network server sends downlink commands to enquire about the historical data for specifying the time range.
- When the network is down and no response from LinkCheckReq MAC packets for a period of time, the device will record the time of disconnection from the network and retransmit the lost data after the device is reconnected to the network.

**Here are the steps of data retransmission:**

1. Go to Device > Setting > General Settings to enable the data storage feature and data retransmission feature.



2. Go to Device > Setting > LoRaWAN Settings to enable the rejoin mode feature and set the number of packets sent. Take below as an example, the device will send LinkCheckReq MAC packets to the network server regularly to check if the network is disconnected; if there is no response 8+1 times, the join status will change to de-active and the device will record a data loss time point (the time to join the network).

Rejoin Mode



Set the number of detection signals sent 

8

3. After the network is connected back, the device will send the lost data from the point in time when the data was lost according to the data re-transmission reporting interval.

**Note:**

1. If the device is rebooted or re-powered when data retransmission is not completed, the device will re-send interrupted retransmission data again after the device is reconnected back to the network.
2. If the network is disconnected again during data retransmission, the device will only send the latest disconnection data.
3. The retransmission data format is started with "20ce", please refer to section 5.4.
4. Data retransmission will increase the uplinks and shorten the battery life.

**Milesight D2D Settings**

Milesight D2D protocol is developed by Milesight and used for setting up transmission among Milesight devices without a gateway. When the Milesight D2D setting is enabled, WS203 can work as a Milesight D2D controller to send control commands to trigger Milesight D2D agent devices.

1. Configure RX2 data rate and RX2 frequency in LoRaWAN® settings, it is suggested to change the default value if there are many LoRaWAN® devices around.
2. Go to Device > Settings > D2D Settings to enable the D2D function and configure the D2D settings.

Enable ☒

D2D Key

\*\*\*\*\*

Occupied&Temperature threshold triggered ☒

Control command

0

LoRa Uplink ⓘ ☐

Control Time /min ⓘ ☒

5

Occupied ☐

Parameters	Description
Enable	Enable or disable the Milesight D2D feature.
D2D Key	Define a unique D2D key which is the same as the setting in D2D agent devices. Default value: 5572404C696E6B4C6F52613230313823
Status Condition	<p>When WS203 detects one or more of the below statuses, it will send the control command to the corresponding Milesight D2D agent devices:</p> <p>Occupied &amp; Temperature threshold triggered</p> <p>Occupied (PIR)</p> <p>Vacant (PIR)</p> <p>Temperature threshold triggered</p> <p>The temperature threshold is lifted</p> <p><b>Note:</b> for temperature threshold conditions, please enable and configure the temperature threshold feature under Threshold Settings.</p>

Control command	Define a 2-byte hexadecimal control command (0x0000 to 0xffff).
LoRa Uplink	If enabled, a LoRaWAN® uplink packet that contains the PIR status or temperature alarm will be sent to the gateway after the Milesight D2D control the command is sent.
Control Time/min1	After receiving commands from WS203, Milesight D2D agent devices will take corresponding actions for this duration.  Default: 5 mins, Range: 1 – 1440 mins

## Maintenance

### Backup

WS203 supports backup templates for easy and quick configuring devices in bulk. The backup feature is only for devices with the same model and LoRaWAN® frequency band.

1. Go to the Template page on the App and save the current settings as a template. The saved templates are also editable.





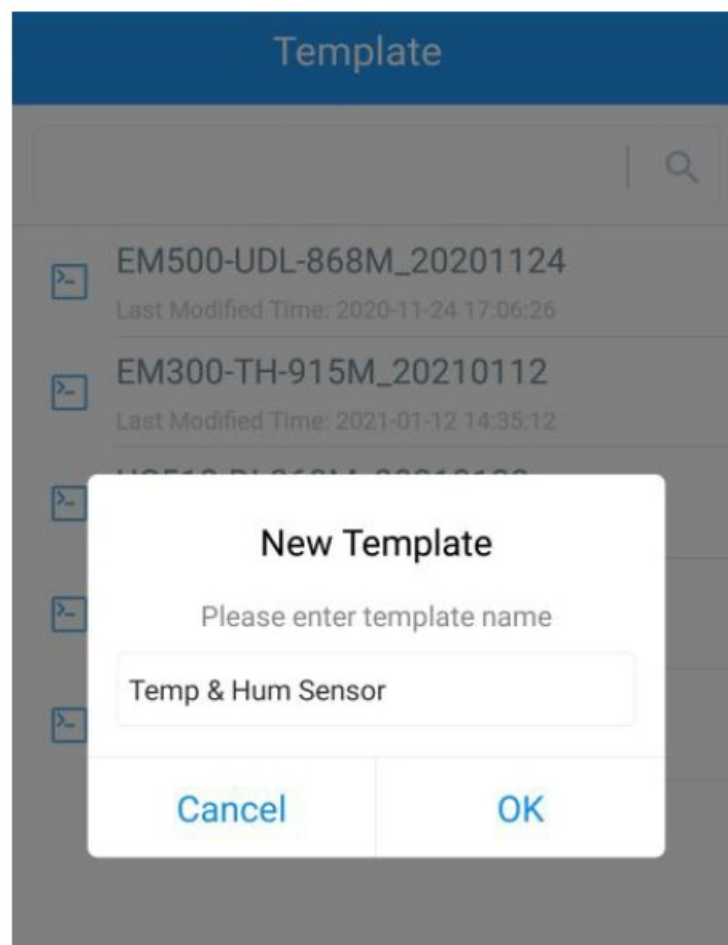

2. Select one saved template and click Write, then attach the smartphone to another device via NFC to reuse the template.



**Note:** Slide the template item to the left to edit or delete the template. Click the template to edit the configurations.

1. This feature is under development on Milesight D2D agent devices.



Template		
<input type="text"/>		
	EM500-UDL-868M_20201124	Last Modified Time: 2020-11-24 17:06:26
	EM300-TH-915M_20210112	Last Modified Time: 2021-01-12 14:35:12
	UC512-DI-868M_20210128	Last Modified Time: 2021-01-28 16:57:20
	UC501-470M_20210201	Last Modified Time: 2021-02-01 11:29:43
	M_20210208	Last Modified Time: 2021-02-08 16:44:37
		<div>Edit</div> <div>Delete</div>

## Upgrade

1. Download firmware from the Milesight website to your smartphone.
2. Go to Device > Maintenance of ToolBox App, tap Browse to import firmware, and upgrade the device.

## Note:

1. Operation on ToolBox is not supported during the upgrade.
2. Only the Android version of ToolBox supports the upgrade feature.

Status	Setting	Maintenance
SN	6791D19604050005	
Model	WS203-915M	
Firmware Version	V1.1	
Hardware Version	V1.0	
Manual Upgrade		
Browse		

### Reset to Factory Default

WS203 supports two methods to reset the device which are as follows:

- **Via Hardware:** Press and hold the power button for more than 10 until the LED indicator blinks quickly.
- **Via ToolBox App:** Go to Device > Maintenance to tap Reset, then attach the smartphone to the device via NFC to complete the reset.

Status	Setting	Maintenance
SN	6791D19604050005	
Model	WS203-915M	
Firmware Version	V1.1	
Hardware Version	V1.0	
Manual Upgrade		
<div>Browse</div>		
Restore Factory Default		
<div>Reset</div>		

## Installation

### Installation Note:



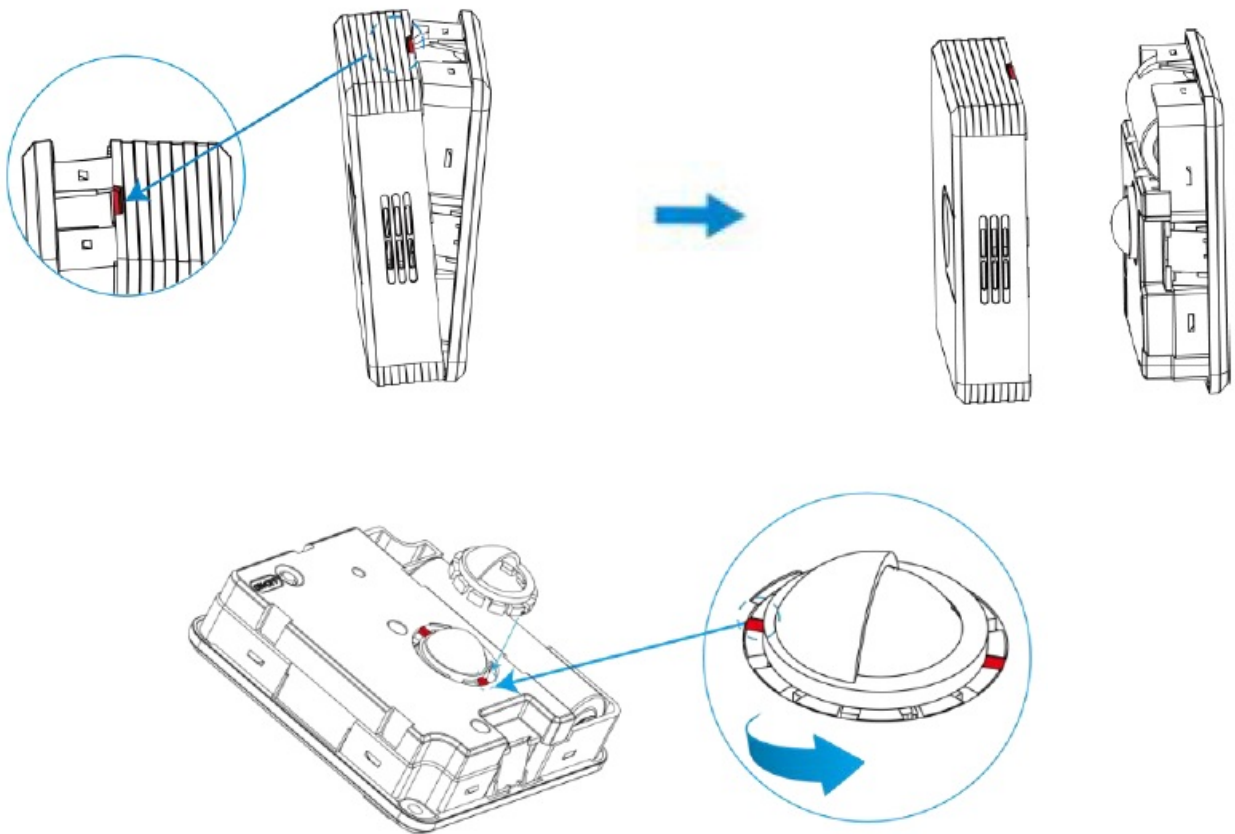

1. Adjust the installation direction according to the detection area requirement.
2. Ensure the detection area does not have moving objects like waving trees and fans.
3. Ensure the detection area is not blocked by curtains or barriers.
4. Do not expose the device to direct infrared (including sunlight, light, etc.), or the PIR detection will be affected.
5. The recommended installation location is 2 m in height on the wall with the half PIR cover to avoid room light inference.
6. Avoid the device facing a transparent plate (like glass) within 5m since the PIR will detect through it.

### PIR Cover Installation:

Take off the front cover of the device, then select the PIR cover as required and put it on the PIR sensor with groove alignment. The adjustable angle of every groove is 30°.

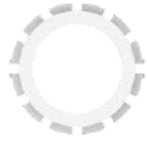

**PIR cover reference guidance(wall mount and installation height=2m):**

PIR Cover	Detection Area
	Maximum: 120 ° Horizontal, 50 ° Vertical, 6 m Recommend: 98 ° Horizontal, 44.4° Vertical, 5 m
	Maximum: 38 ° Horizontal, 50 ° Vertical, 6 m Recommend: 38 ° Horizontal, 44.4° Vertical, 5 m
	Maximum: 38 ° Horizontal, 100 ° Vertical, 6 m Recommend: 38 ° Horizontal, 88.8° Vertical, 5 m
	Maximum: 120 ° Horizontal, 100 ° Vertical, 6 m Recommend: 98 ° Horizontal, 88.8° Vertical, 5 m
	Support to be tailored as required

#### Fixed by 3M Tape:

Attach 3M tape to the back of the sensor, then tear the other side and place it on a flat surface. Please adjust the installation direction according to the detection area.

#### Note:

1. Since the default 3M tape has a high viscosity, please tear the device down via a screwdriver.
2. If it is necessary to tear the device down easily, please divide the 3M tape into several parts and only tear one part to the device.

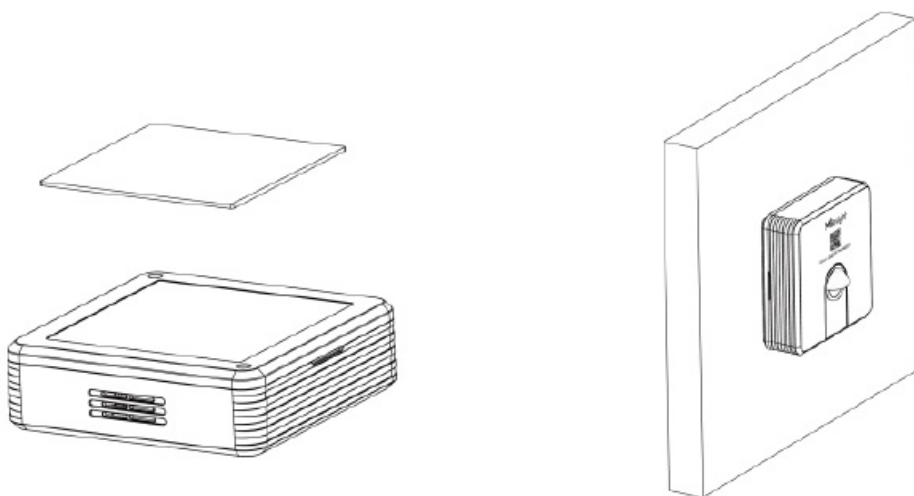

#### Fixed by Mounting Kits:

1. Take off the front cover of the device, then fix the wall plugs to a flat surface according to the device mounting

holes. Finally, secure the device to the wall plugs using screws. Please adjust the installation direction according to the detection area.

2. Restore the front cover of the device.

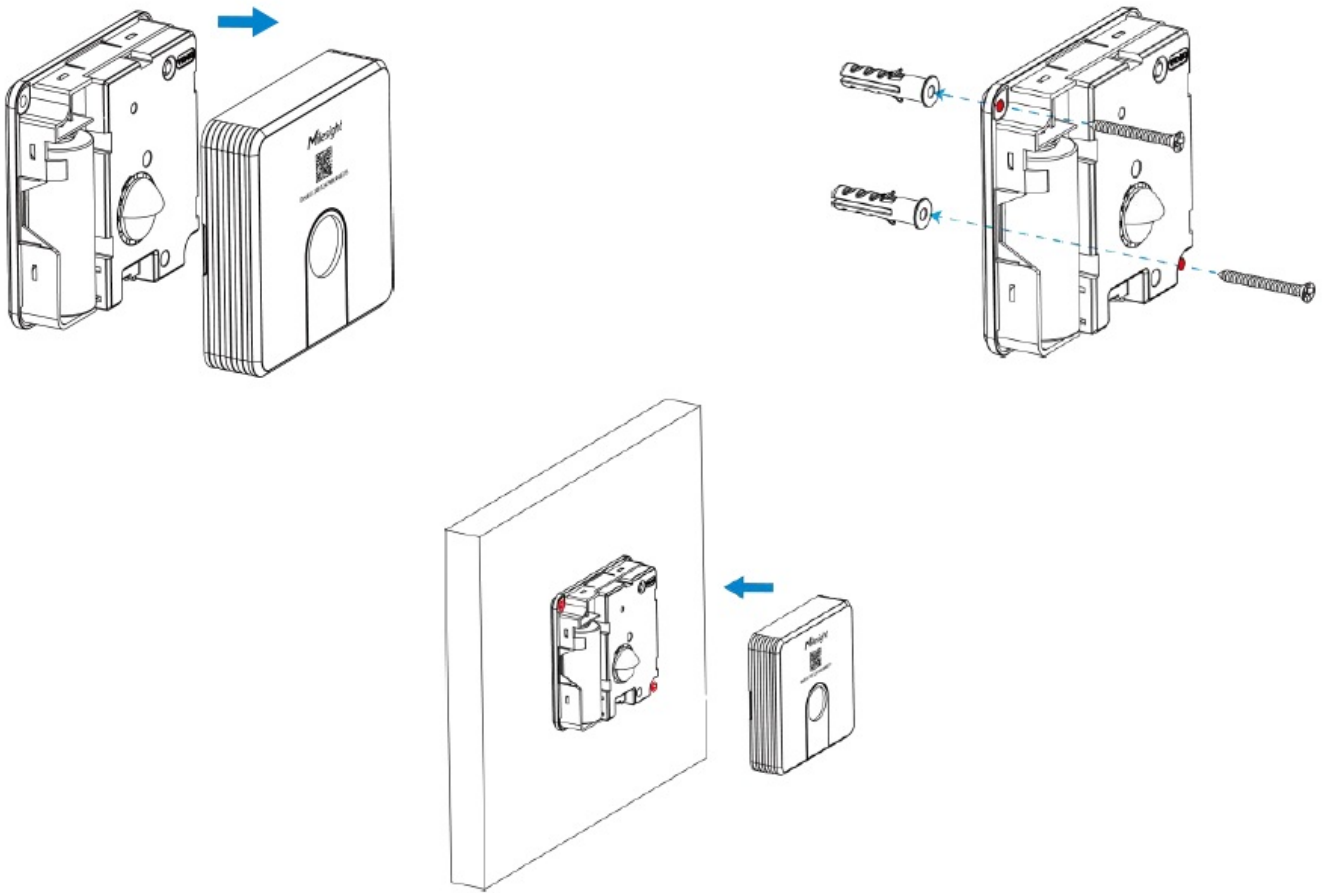

## Device Payload

All the data is based on the following format (HEX), the Data field should follow the little-endian:

Channel1	Type1	Data1	Channel2	Type2	Data2	Channel 3	...
1 Byte	1 Byte	N Bytes	1 Byte	1 Byte	M Bytes	1 Byte	...

For decoder examples please find the files on <https://github.com/Milesight-IoT/SensorDecoders>.

## Basic Information

WS203 sensor reports basic information whenever joining the network.

Channel	Type	Description
ff	0b (Power On)	Device is on
	01 (Protocol Version)	01=>V1
	16 (Device SN)	16 digits
	09 (Hardware Version)	01 40 => V1.4
	0a (Software Version)	01 14 => V1.14
	0f (Device Type)	00: Class A, 01: Class B, 02: Class C

### Example:

ff0bff ff0101 ff166791d19604050005 ff090100 ff0a0101 ff0f00					
Channel	Type	Value	Channel	Type	Value
ff	0b (Power On)	ff (Reserved)	ff	01 (Protocol Version)	01 (V1)
Channel	Type	Value	Channel	Type	Value
ff	16 (Device SN)	6791d19604050 005	ff	09 (Hardware Version)	0100 (V1.0)
Channel	Type	Value	Channel	Type	Value
ff	0a (Software Version)	0101 (V1.1)	ff	0f (Device Type)	00 (Class A)

### Sensor Data

Item	Channel	Type	Description
Battery Level	01	75	UINT8, Unit: %
Temperature	03	67	INT16, Unit: °C, Resolution: 0.1 °C
Humidity	04	68	UINT8, Unit: %, Resolution: 0.5 %RH
PIR Status	05	00	00: Vacant; 01: Occupied
			Temperature (2 Bytes) + Alarm Status(1
			Byte)
Temperature			Temperature: unit — °C
Alarm	83	67	Alarm Status:
			00 -Alarm release
			01 -Alarm

### Examples:

1. **Periodic packet:** report as reporting interval (30 minutes by default).

017562 0367d500 04687f 050001					
Channel	Type	Value	Channel	Type	Value
01	75 (Battery Level)	62=>98%	03	67 (Temperature)	d5 00=>00 d5=213 Temp=213*0.1 =21.3°C
Channel	Type	Value	Channel	Type	Value
04	68 (Humidity)	7f=>127 Hum=127*	05	00 (PIR Status)	01=>Occupied
		0.5=63.5%			

2. **PIR trigger packet:** report when PIR status changes.

0367d500 04687f 050001					
Channel	Type	Value	Channel	Type	Value
03	67 (Temperature)	d5 00=>00 d5=213 Temp=213*0.1= 21.3°C	04	68 (Humidity)	7f=>127 Hum=127*0.5= 63. 5%
Channel	Type	Value			
05	00 (PIR Status)	01=>Occupied			

3. Temperature alarm packet: report when the temperature reaches the threshold or returns to normal value.

83670e0101 04687a					
Channel	Type	Value	Channel	Type	Value
83	67 (Temperature)	Temperature: 0e 01 = >01 0e = 270 * 0.1 = 27 °C 01= Alarm	04	68 (Humidity)	7a=>122 Hum=122 *0.5= 61%

### Downlink Commands

WS203 supports downlink commands to configure the device. The application port is 85 by default.



Channel	Type	Description
ff	10 (Reboot)	ff
	2f (LED Indicator)	00: disable; 01: enable
	8e (Reporting Interval)	3 Bytes, Byte 1: 00 Byte 2-3: interval time, unit: min
	95 (Time to report vacancy)	2 Bytes, unit: s
	68 (Data Storage)	00: disable, 01: enable
	69 (Data Retransmission)	00: disable, 01: enable
	6a (Data Retransmission Interval)	3 Bytes Byte 1: 00 Byte 2-3: interval time, unit: s

		range: 30~1200s (600s by default)
	84 (D2D Feature)	1 Byte, 00: disable; 01: enable
	96 (D2D Settings)	<p>8 Bytes,</p> <p>Byte 1:</p> <p>00- All threshold conditions;</p> <p>01- Occupancy&amp;Temperature threshold triggered;</p> <p>02- Occupied; 03-Vacant;</p> <p>04-Temperature threshold triggered; 05-Temperature threshold is lifted</p> <p>Byte 2: 00-disable, 01-enable</p> <p>Byte 3: 00-disable LoRa Uplink, 01-enable LoRa Uplink</p> <p>Byte 4-5: D2D control command Byte 6-7: control time, unit: min</p> <p>Byte 8: 00-disable control time, 01-enable control time</p>
	06 (Threshold Alarm)	<p>9 Bytes, CTRL(1B)+Min(2B)+Max(2B)+00000000(4B) CTRL:</p> <p>Bit0~Bit2:</p> <p>00- disable</p> <p>01- below (minimum threshold) 010-above (maximum threshold) 011-within</p> <p>100-below or above</p> <p>Bit3~Bit7: 11001</p>

### Example:

1. Reboot the device.

ff10ff		
Channel	Type	Value
ff	10 (Reboot)	ff (Reserved)

2. Set the reporting interval as 2 minutes.

ff8e 00 0200		
Channel	Type	Value
ff	8e (Reporting Interval)	02 00=>00 02=>2 mins

3. Set the time to report vacancy as 2 minutes.

ff957800		
Channel	Type	Value
ff	95 (Time to report vacancy)	78 00=>00 78=>120 s=2 mins

4. Set LED indicator.

ff2f01		
Channel	Type	Value
ff	2f (LED Indicator)	01=>Enable

5. Enable the D2D feature.

ff8401		
Channel	Type	Value
ff	84 (D2D Feature)	01=Enable

6. Set D2D settings.

ff96 01 01 01 04e0 0500 01		
Channel	Type	Value
ff	96 (D2D Settings)	01=>Occupied&Temperature threshold triggered; 01=>Enable; 01=>Enable LoRa Uplink; 04 e0=>e0 04, Control Command is e0 04; 05 00=>00 05, Control time is 5 mins; 01=>Enable Control Time

7. Set threshold alarm.

ff06 cc 9600 2c01 00000000		
Channel	Type	Value
ff	06 (Threshold Alarm)	Ctrl: cc=>11001100 100=below or above Min_value: 96 00=>00 96=15° C Max_value: 2c 01=>01 2c=30°C

## Historical Data Enquiry

WS203 supports sending downlink commands to enquire about historical data for specified time points or time ranges. Before that, ensure the device time is correct and the data storage feature is enabled to store the data.

**Command format:**

Channel	Type	Description
fd	6b (Enquire data in time point)	4 Bytes, Unix timestamp
fd	6c (Enquire data in time range)	Start time (4 bytes) + End time (4 bytes), Unix timestamp
fd	6d (Stop query data report)	ff
ff	6a (Report Interval)	3 Bytes, Byte 1: 01 Byte 2: interval time, unit: s, range: 30~1200s (60s by default)

**Reply format:**

Channel	Type	Description
FC	6b/6c	1 Byte, 00: data inquiry success 01: time point or time range invalid 02: no data in this time or time range
20	ce (Historical Data)	9 Bytes, Data time stamp (4 Bytes) + Trigger Status (1 Byte) + PIR Status (1 Byte) + Temperature (2 Bytes) + Humidity (1 Byte) Trigger_status: 00 – temperature threshold alarm is released 01 – temperature threshold alarm triggered 02 – PIR vacant trigger 03 – PIR occupied trigger 04 – periodic report

**Note:**

1. The device only uploads no more than 300 data records per range inquiry.
2. When inquiring about the data in time point, it will upload the data that is the closest to the search point within the reporting interval range. For example, if the device's reporting interval is 10 minutes and users send a

command to search for 17:00's data if the device finds there is data stored in 17:00, it will upload these data. If not, it will search for data between 16:50 to 17:10 and upload the data which is the closest to 17:00.

#### Example:

1. Enquire historical data between 2023/8/4 17:00:00 to 2023/8/4 17:15:00.

fd6c10becc6494c1cc64		
Channel	Type	Value
fd	6c (Enquire data in time range)	Start time: 10becc64=> 64ccbe10 = 1691139600s = 2023-08-04 17:00:00 End time: 94c1cc64 => 64ccc194 = 1691140500s = 2023-08-04 17:15:00

#### Reply:



fc6c00		
Channel	Type	Value
FC	6c (Enquire data in time range)	00: data inquiry success

20ce 7ac1cc64 04 01 0e01 7b			
Channel	Type	Time Stamp	Value
20	ce (Historical Data)	7ac1cc64 => 64ccc17a => 1691140474s = 2023-08-04 17:14:34	04=>Periodic report PIR: 01=>Occupied; Temperature: 0e01=>010e = 27°C Humidity: 7b => 123 = 61.5%

#### Contact Information

- 14 rue Edouard Petit 42000 St-Etienne
- **Tel:** +33 477 92 03 56
- **Email:** [contact@rg2i.com](mailto:contact@rg2i.com)
- [www.rg2i.com](http://www.rg2i.com).

#### Documents / Resources

 	<p><a href="#">Milesight WS203 Motion and TH Sensor</a> [pdf] User Guide</p> <p>WS203 Motion and TH Sensor, WS203, Motion and TH Sensor, and TH Sensor, TH Sensor, Sensor</p>
---	---

References

-  [Support : IoT Support](#)
-  [GitHub - Milesight-IoT/SensorDecoders](#)
- [User Manual](#)

Manuals, Privacy Policy

This website is an independent publication and is neither affiliated with nor endorsed by any of the trademark owners. The "Bluetooth®" word mark and logos are registered trademarks owned by Bluetooth SIG, Inc. The "Wi-Fi®" word mark and logos are registered trademarks owned by the Wi-Fi Alliance. Any use of these marks on this website does not imply any affiliation with or endorsement.