



Milesight UG65 i-Box Smart Building Kit User Guide

[Home](#) » [Milesight](#) » Milesight UG65 i-Box Smart Building Kit User Guide 

Contents





- [1 Milesight UG65 i-Box Smart Building Kit](#)
- [2 Device List](#)
- [3 Packing List](#)
- [4 Registration and Activation](#)
- [5 Setting-up the Gateway](#)
- [6 Setting-up the Sensors](#)
- [7 Setting-up UC300 IoT Controller](#)
- [8 Documents / Resources](#)
 - [8.1 References](#)
- [9 Related Posts](#)





Milesight UG65 i-Box Smart Building Kit



Device List

Quantity	Item	Description	Applications
1	WS101 Smart Button 	WS101 smart button supports sending different alerts depending on various press actions and can be used in emergency alarm system, remote control or other remote push button applications.	<ul style="list-style-type: none"> • Easy to be carried out by the seniors and the disabled or to be installed anywhere • Remote control lights or curtains in office
1	WS301 Magnetic Contact Switch 	WS301 sensor uses a magnet to detect the open/closed status of door/window or something has been moved. It's wire-free and can be easily mounted on the doors, panes, cabinets, etc.	<ul style="list-style-type: none"> • Entry/fire door monitoring • Asset protection in the cabinets or boxes • Suitable for offices, homes or factories applications
1	AM103 IAQ Sensor 	AM103 is a 3-in-1 ambience monitoring sensor including the measurement of temperature, humidity and CO ₂ concentration and can display indoor status visually on the E-ink screen in real-time and transmit to network server using LoRaWAN® technology.	<ul style="list-style-type: none"> • Monitor temperature, humidity and CO₂ levels • Indicate CO₂ levels via traffic light or emoticon on the E-ink screen • Suitable for office or school indoor air quality monitoring
1	EM300-SLD Leak Detection Sensor 	EM300-SLD sensor can detect the presence of liquids by a small probe based on the conductive principle. Besides, EM300-SLD equips temperature and humidity sensors to monitor the indoor and outdoor environment.	<ul style="list-style-type: none"> • Pipe leak monitoring • Basement flooding detection • Machine room monitoring
1	UC300 IoT Controller 	UC300 IoT controller equips with multiple data interfaces including digital inputs, relay outputs, RS232, RS485, analog inputs and PT100 RTD input, which can convert legacy sensors to work with LoRaWAN® network and control devices.	<ul style="list-style-type: none"> • Acquire data from legacy sensors and send via LoRaWAN® networks • Control the on/off status via relay outputs or RS485 Modbus commands

Quantity	Item	Description	Applications
1	UG65 Semi-Industrial LoRaWAN® Gateway 	UG65 semi-industrial indoor LoRaWAN® gateway provides stable connectivity between sensors and mainstream network servers or Milesight IoT cloud.	<ul style="list-style-type: none"> • Collect data from LoRaWAN® sensors • Forward data to Milesight IoT Cloud or mainstream network servers via Ethernet or Wi-Fi
	1 Year (Pro1) Milesight IoT Cloud 	Milesight IoT Cloud provides unparalleled levels of vertical integration with Milesight LoRaWAN® gateways and sensors. It visualizes field data and enables user to monitor and control remote assets on an intuitive dashboard.	<ul style="list-style-type: none"> • Drag & Drop dashboard to display data • Real-time alarm notifications • Exportable historical data and generate reports • Custom trigger conditions & actions to enable collaborative interaction among end-devices • Android & iOS versions available

Packing List

Item	AM103	WS101	WS301	EM300-SLD	UC300	UG65
Device	●	●	●	●	●	●
Ethernet Cable						●
LoRa Antenna					●	●
ER14505 Li-SoCl ₂ Batteries	●					
3M Double-Sided Tape	●	●		●		
Wall Mounting Kits	●	●		●	●	●
Fixing Screws	●		●	●	●	●
Screw Caps				●		
DIN Rail Clip					●	
Mounting Bracket						●
Terminal Blocks					●	
Power Adapter					●	●
Warranty Card	●					

Registration and Activation



1. Open web browser, navigate to cloud.milesight-iot.com to register a Milesight IoT Cloud account. You can also install Milesight IoT Cloud App from Google Play or App store.



2. Activate the account to pro 1 plan by entering the activation code on the web GUI. You can contact your sales representative to get the activation code.

Setting-up the Gateway

1. Power on the UG65 via power adapter or PoE.
2. Access the web GUI and configure the network setting to get an Internet connectivity.
 - Username: admin
 - Password: password

Method 1:

1. Search and connect the Wi-Fi SSID of gateway (Gateway_*****), then open the browser and type 192.168.1.1 to log in the web GUI.
2. Select the Connection Type of Ethernet port and fill in the IP information, then connect UG65 gateway Ethernet port to network devices like a router or a modem to get Internet access.

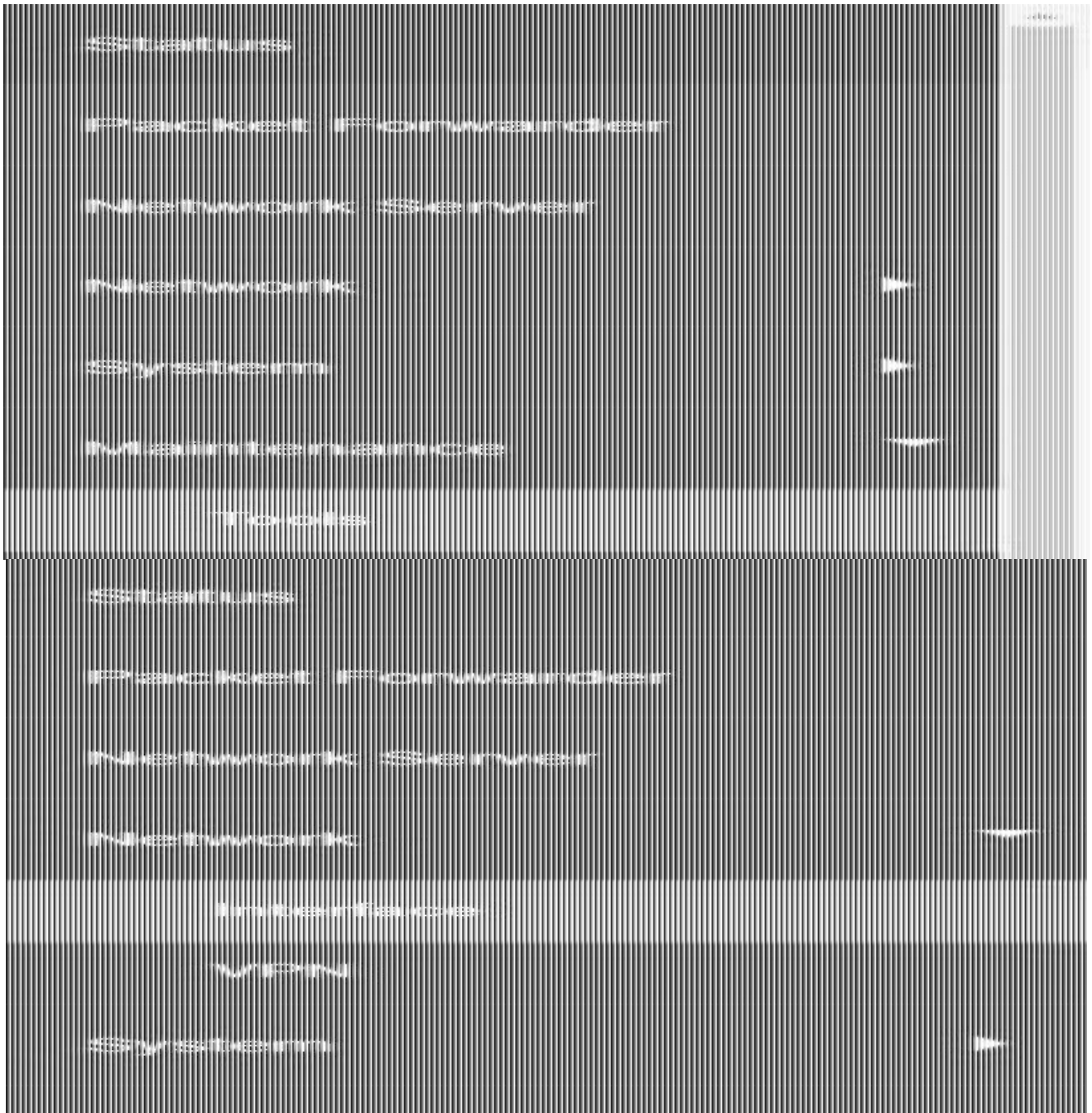

Method 2:

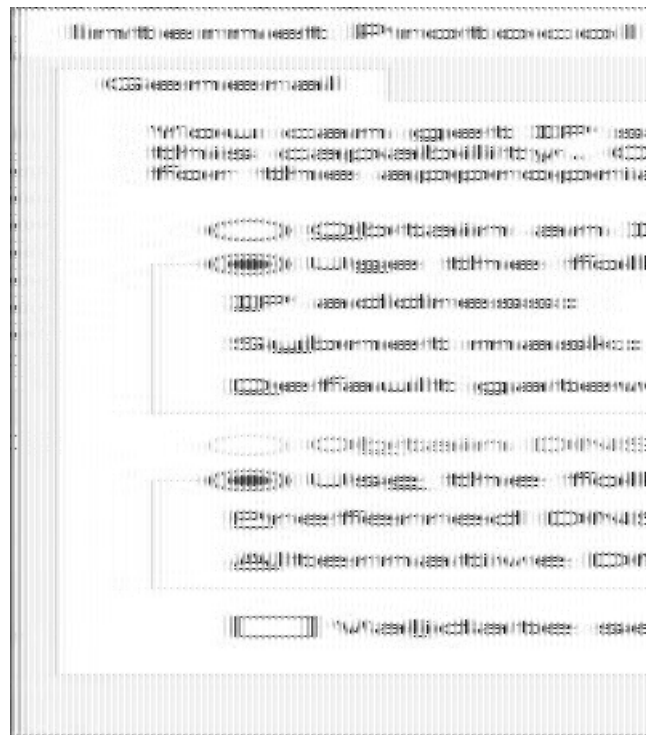

1. Connect the UG65 to PC via Ethernet port and configure the IP address of computer to the same subnet with the UG65 manually (e.g. 192.168.23.200).
2. Type 192.168.23.150 into the browser on PC to log in the web GUI of UG65 gateway.
3. Connect UG65 to another Wi-Fi access point to get network connection and set wlan0 as main interface.





4. Enable the network server and Milesight IoT Cloud mode.

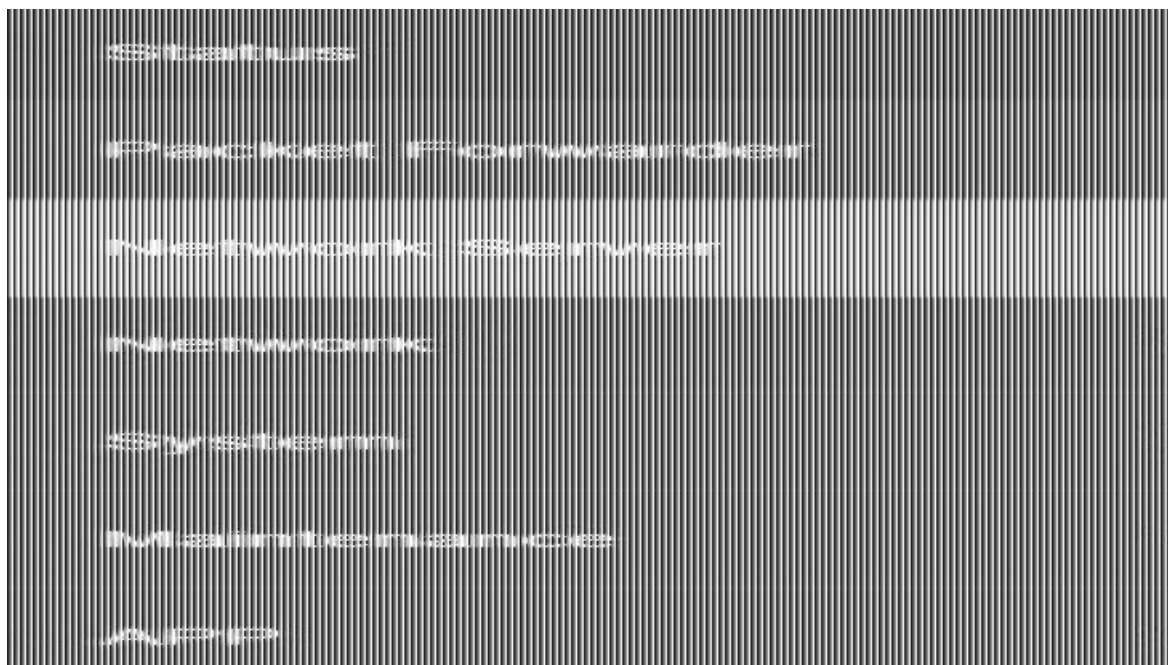

5. Fill in the device SN to add gateway and ensure the gateway is online. You can also enter the SN manually on the Cloud App to add the gateway.



Setting-up the Sensors

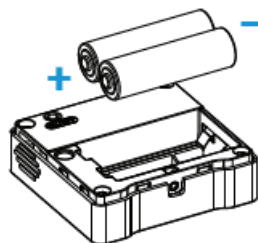

1. Pull out the battery insulating sheet to power on WS series sensors and install the batteries onto AM103 device.

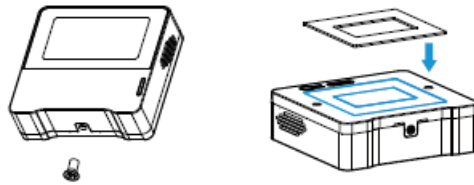

AM103

Fixed by Screw:

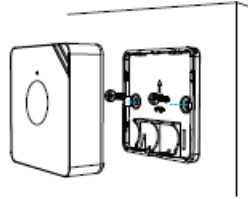

WS101

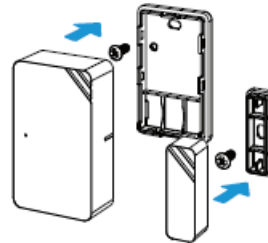

WS301

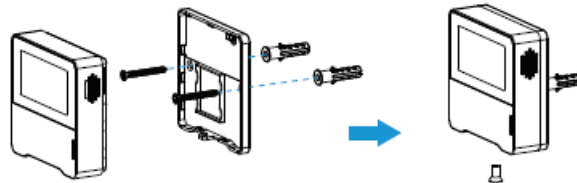

AM103

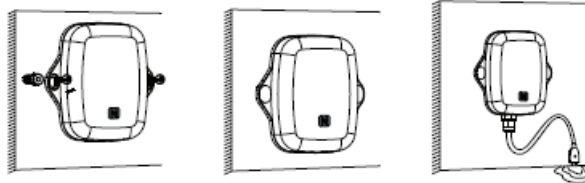

EM300-SLD

2. Use an NFC-enabled smart phone to install Milesight ToolBox App from Google Play or App store, place the NFC area of phone close to the device and use Milesight ToolBox App to read and configure the device. **Milesight ToolBox App:**



Android



iOS

3. Fill in the device SN to add sensors on Milesight IoT Cloud page. You can also use Cloud App to scan the QR code on the label of device to add, or fill in the device SN manually to add sensors. After devices are getting online, you can view the data on the cloud.

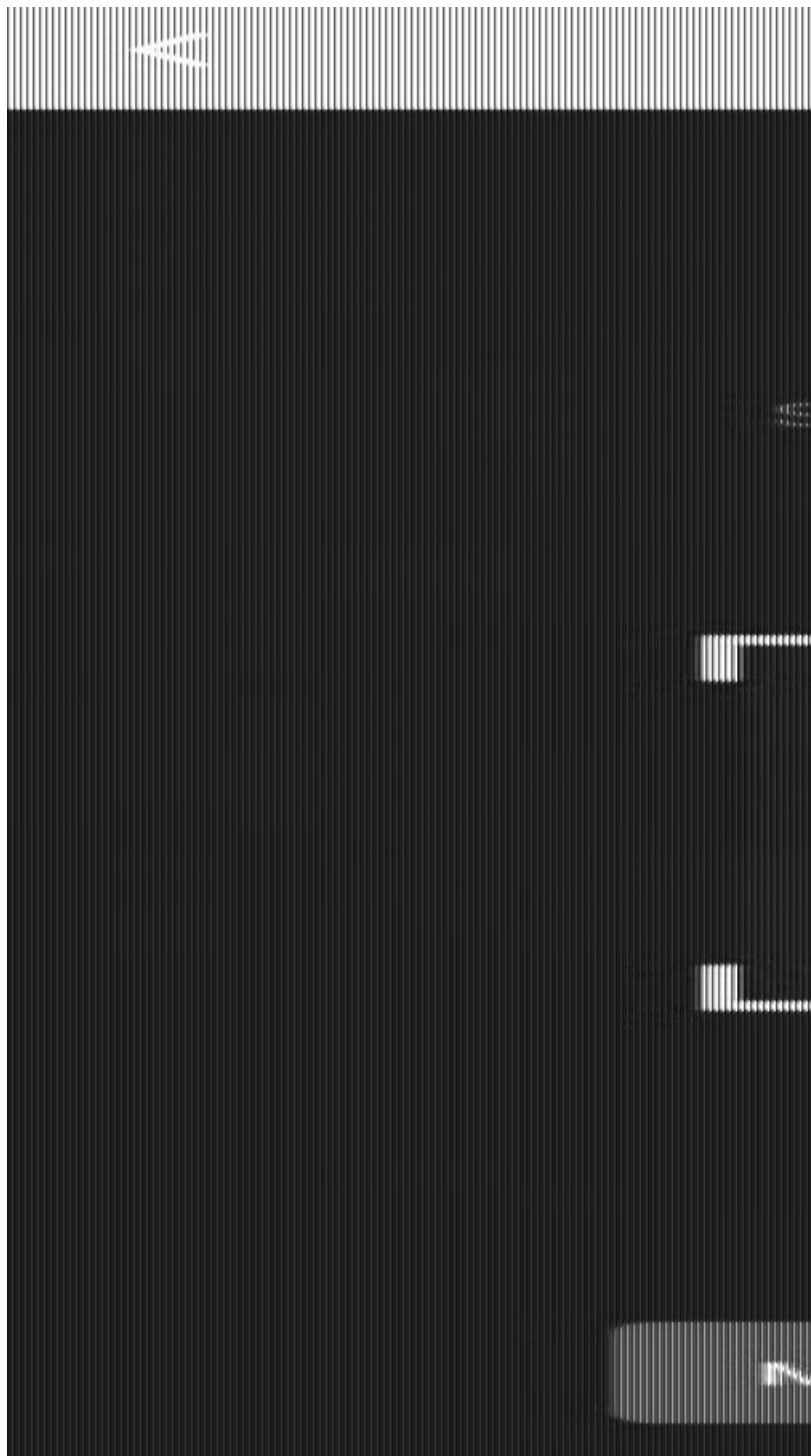

4. Fix sensors to the wall via 3M tapes or wall mounting kits. For EM300-SLD, the leak probe can be fixed to the wall via double-sided tape.

Fixed by 3M Tapes:

5.

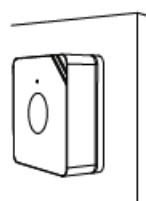
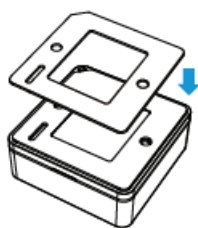

WS101

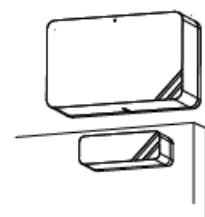

WS301

6.

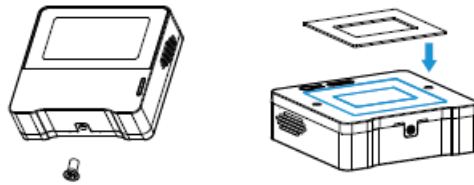

AM103

Fixed by Screw:

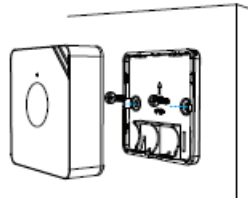

WS101

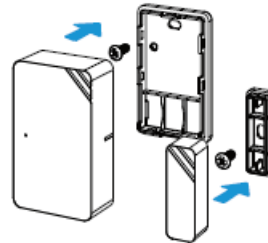

WS301

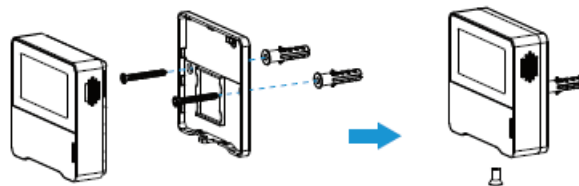

AM103

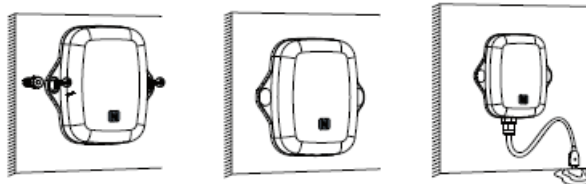

EM300-SLD

Setting-up UC300 IoT Controller

1. Connect the sensors to corresponding data interfaces of UC300 and install LoRa antenna.
2. Power on UC300 via power adapter and connect the type-C port to PC, use ToolBox software downloaded from Milesight website to configure the device and test if it can read sensor data.
3. Fill in the device SN to add sensors on Milesight IoT Cloud page. You can also use Cloud App to scan the QR code on the label of device to add, or fill in the device SN manually to add the controller.
4. After device is getting online, enable the corresponding data interfaces displayed on the cloud page.
5. Install the controller to the wall via wall mounting kits or hang it to the DIN rail.

Wall Mounting:

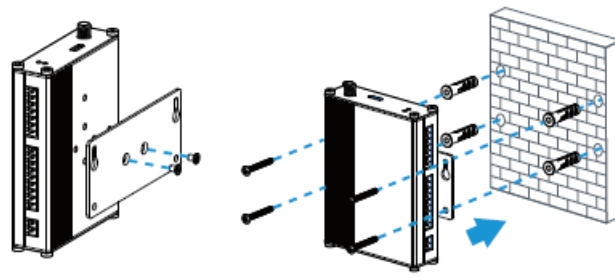

DIN Rail Mounting:

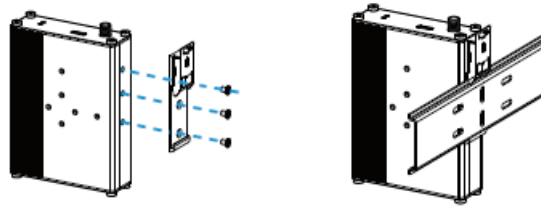

Documents / Resources



[Mulesight UG65 i-Box Smart Building Kit](#) [pdf] User Guide
UG65, i-Box Smart Building Kit, UG65 i-Box Smart Building Kit

References

- cloud.milesight-iot.com
- [Milesight IoT - LoRaWAN, 5G & AIoT](#)
- [Download Center | Milesight - AIoT Solution Provider](#)