



# Milesight UC300 Smart IoT Controller User Guide

[Home](#) » [Milesight](#) » Milesight UC300 Smart IoT Controller User Guide 

## Milesight UC300 Smart IoT Controller User Guide



### Contents

- [1 Packing List](#)
- [2 Hardware Introduction](#)
- [3 LED Patterns](#)
- [4 SIM Installation \(Cellular Version\)](#)
- [5 Configuration Guide](#)
- [6 Installation](#)
- [7 Documents / Resources](#)
  - [7.1 References](#)
- [8 Related Posts](#)

## Packing List

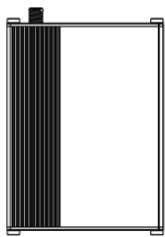

1 x UC300 Device

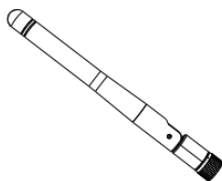

1 x LoRa/Cellular  
Antenna

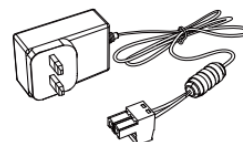

1 x Power Adapter

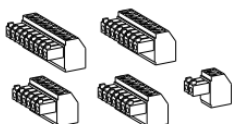

5 x Terminal Blocks

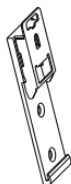

1 x DIN Rail  
Mounting Clip

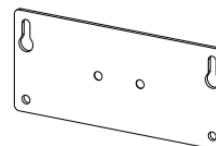

1 x Wall Mounting  
Bracket



4 x Wall Mounting  
Kits



4 x Fixing Screws



1 x Quick Start Guide



1 x Warranty Card

## Hardware Introduction

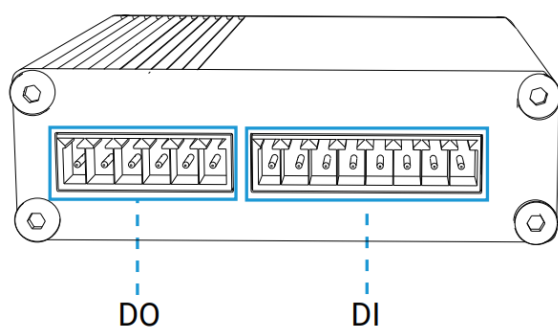

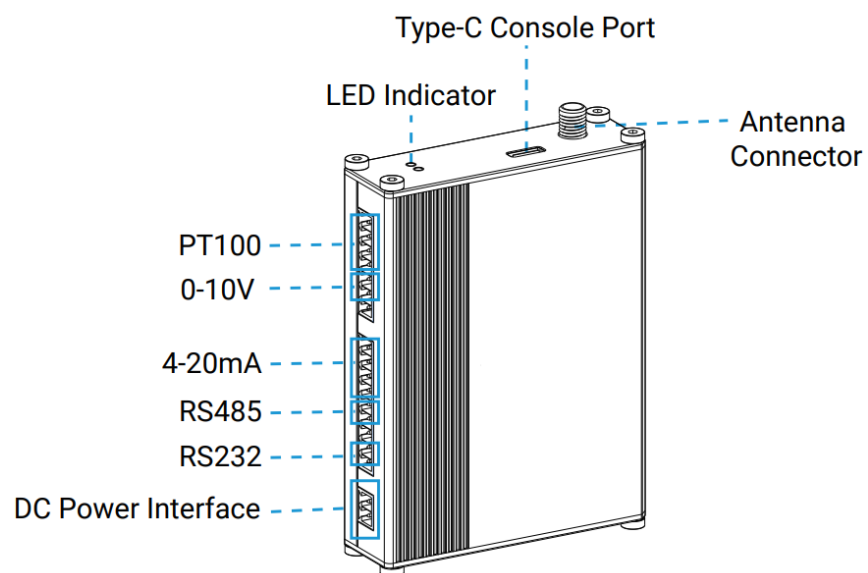

## LED Patterns

LED	Device Status	Description
SYS	System works	Static On
	Reset to factory default: hold the reset button inside the device for more than 10 seconds	Static On → Quickly Blinks
	Fail to acquire data from data interfaces	Slowly Blinks
	System error	Static On
ACT	Send join network requests	Blinks as Requests
	Succeed to join/register to network	Blinks Twice → Static On Blinks Twice → Static On
	Succeed to send uplinks	Blinks Once
	Succeed to send uplink	Blinks Twice
	Receive downlinks	Blinks Twice

### **SIM Installation (Cellular Version)**

Release the screws and cover on the antenna connector, insert the SIM card into the slot. If you want to take out the SIM card, press it to make it pop out.

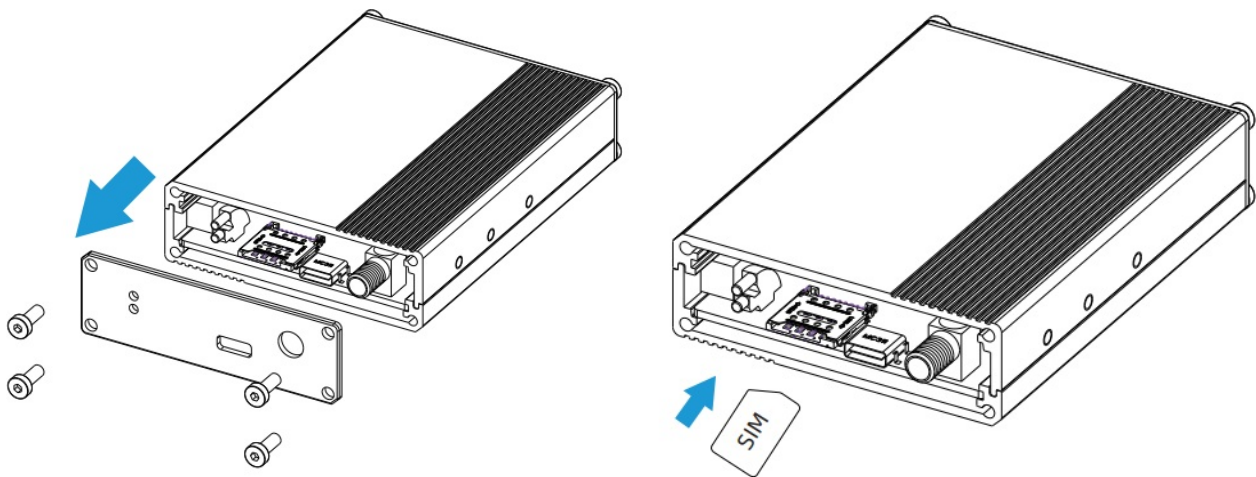

## Configuration Guide

Preparation:

- Type-C USB cable
- PC (Windows 10 is recommended)
- ToolBox Software: it can be downloaded from Milesight IoT website.

### Steps:

Connect the device to computer via type-C port and open the ToolBox, select serial port as USB port and type as “General”, then type the password to log in ToolBox and configure the device. (Default login password: 123456)

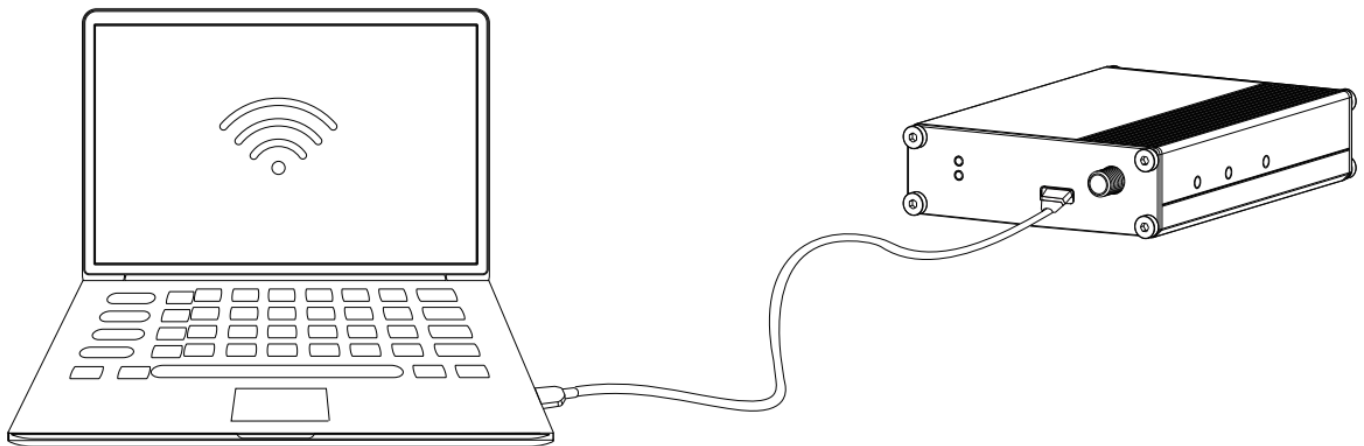

## Installation

### Wall Mounting

1. Fix the wall mounting bracket to the device with 2 screws.

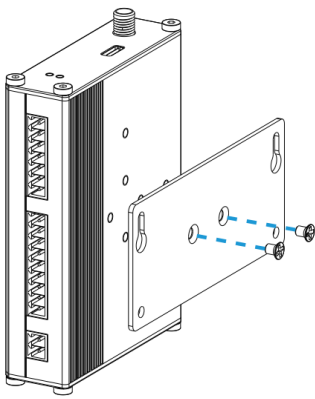

2. Drill 4 holes on the wall according to the wall mounting bracket, then fix the wall plugs into the wall.

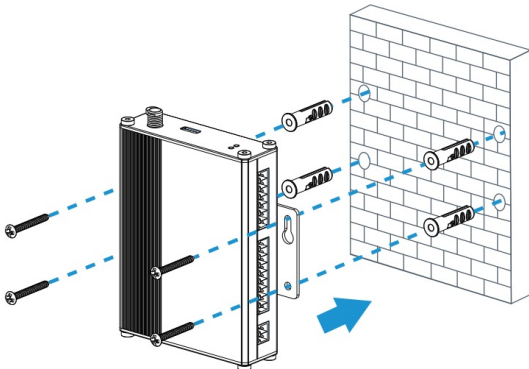

3. Fix the device to the wall plugs with screws. When installation, it's suggested to fix the upper two screws first.

### DIN Rail Mounting

1. Fix the mounting clip to the device with 3 screws.

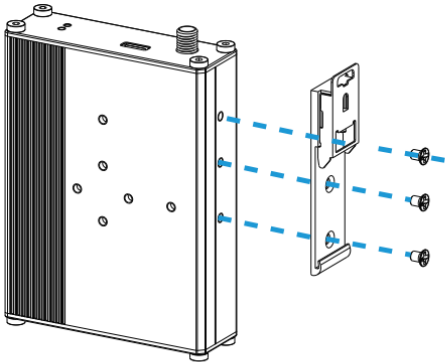

1

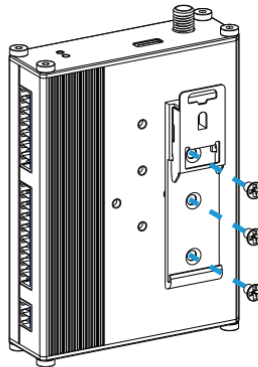

2

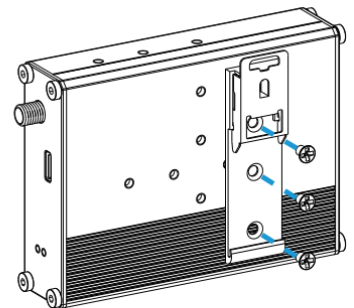

3

2. Hang the device to the DIN rail. The width of DIN rail should be 35 mm.

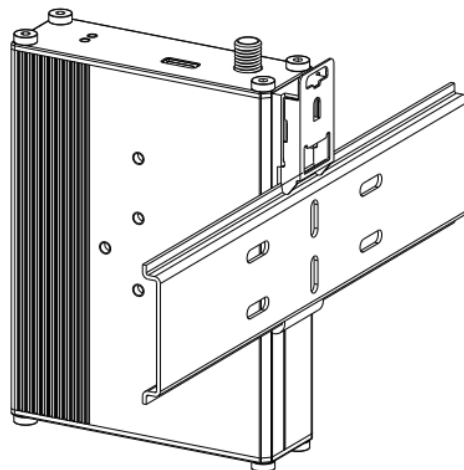
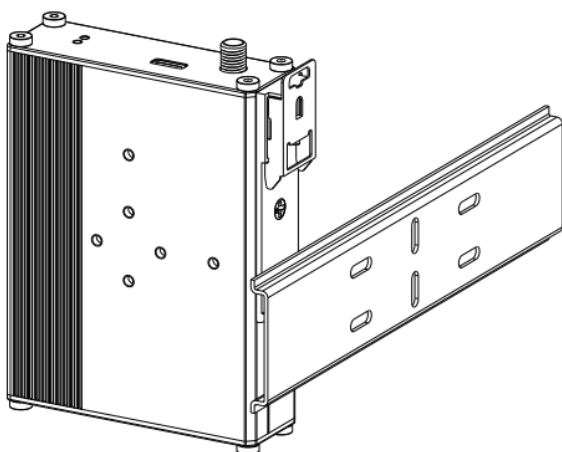

### Cloud App



### Quick Start Guide



All Software & files can be downloaded from  
<https://www.milesight-iot.com/documents-download/>

### Better Inside, More in Sight

Milesight IoT Co., Ltd. [www.milesight-iot.com](http://www.milesight-iot.com)



### Documents / Resources

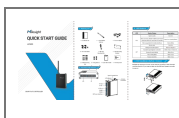

[Milesight UC300 Smart IoT Controller](#) [pdf] User Guide  
UC300, Smart IoT Controller, UC300 Smart IoT Controller, IoT Controller, Controller

### References

- [!\[\]\(eae20f1adff742df783f6f7e3bbe72d1\_img.jpg\) Milesight IoT - LoRaWAN, 5G & AIoT](#)
- [!\[\]\(43c6e08c5a1618d745b54da5c843274e\_img.jpg\) Download Center | Milesight - AIoT Solution Provider](#)

Manuals+.