



**MIKAVI
ENERJUMP 1
Jump Starter
With Air
Compressor**



MIKAVI ENERJUMP 1 Jump Starter With Air Compressor Instruction Manual

[Home](#) » [MIKAVI](#) » MIKAVI ENERJUMP 1 Jump Starter With Air Compressor Instruction Manual 

Contents

- [1 MIKAVI ENERJUMP 1 Jump Starter With Air Compressor](#)
- [2 Specifications](#)
- [3 Introduction](#)
- [4 Usage Instructions](#)
- [5 Vehicle Jump-Starting](#)
- [6 Jump starter with air compressor](#)
- [7 SAFETY WARNINGS](#)
- [8 DEVICE CONSTRUCTION](#)
- [9 THE PACKAGE INCLUDES](#)
- [10 TECHNICAL SPECIFICATION](#)
- [11 FUNCTIONS/OPERATION](#)
- [12 TROUBLESHOOTING](#)
- [13 WARRANTY SERVICE TERMS](#)
- [14 FAQs](#)
- [15 Documents / Resources](#)
 - [15.1 References](#)



MIKAVI ENERJUMP 1 Jump Starter With Air Compressor



Specifications

- **Dimensions:** 200*130*52mm
- **Max. Air Pressure:** 150 psi
- **Input Power Connector:** USB Type-C
- **Output Power Connector:** USB 5V/2A

Introduction

The EnerJump 1 is a multifunctional device featuring:

1. Jump starter function
2. Built-in air compressor
3. Power bank capability
4. Flashlight

Usage Instructions

Emergency LED Light Operation

To activate the flashlight, press and hold the multifunction button for 3 seconds. Press and hold again for 3 seconds to turn off the flashlight.

Vehicle Jump-Starting

Before jump-starting a vehicle, ensure the device is charged at least 70% and all vehicle electronics are turned off.

1. Connect the red cable to the positive battery terminal.
2. Connect the black cable to the negative battery terminal.

Charging External Devices

Plug the USB cable into the device's USB port and the other end into the device to be charged. Press the multifunction button to start charging. Use an AC adapter with an output of at least 5V/1A or preferably 5V/3A for optimal charging.

Air Compressor Function

1. Connect one end to the device's power connector.
2. Connect the other end to the tire valve.

Jump starter with air compressor

Thank you for purchasing the multi-functional jump starter EnerJump 1.

To ensure correct operation, please read this user manual carefully before using this device. This manual includes detailed information on the product's specifications, functions, operation, safety warnings, and other accessories.

INTRODUCTION

Use utmost care when operating the device! Failure to observe safety precautions can cause damage to your health or life!



JUMP STARTER



1. Jump starter



2. Built-in compressor



3. Powerbank function



4. Flashlight function

SAFETY WARNINGS

ATTENTION – DANGER

No charging the product indoors or in unattended places!

WARNING

To keep away from fire, electric shock, or any damage to your car, please follow the warnings below:

- Do not throw or hit hard. Do not disassemble or reinvent. Keep the product away from moisture, water or fire. Avoid prolonged exposure of the device to sunlight. If the product is damaged, please stop using it.
- Do not allow children to touch the product, this is not a toy. Keep the device out of reach of children.
- Do not clamp both battery terminals together or clamp on the same piece of metal. Otherwise, it may cause safety accidents.

DEVICE CONSTRUCTION

1. air pump switch
2. air pump interface
3. USB 5V/2A
4. USB Type-C
5. multifunction button
6. smart clips interface
7. size adjustment
8. mode transformation
8. smart clamps “protect”
9. USB charging cable
10. nozzle adapters

11. air hose

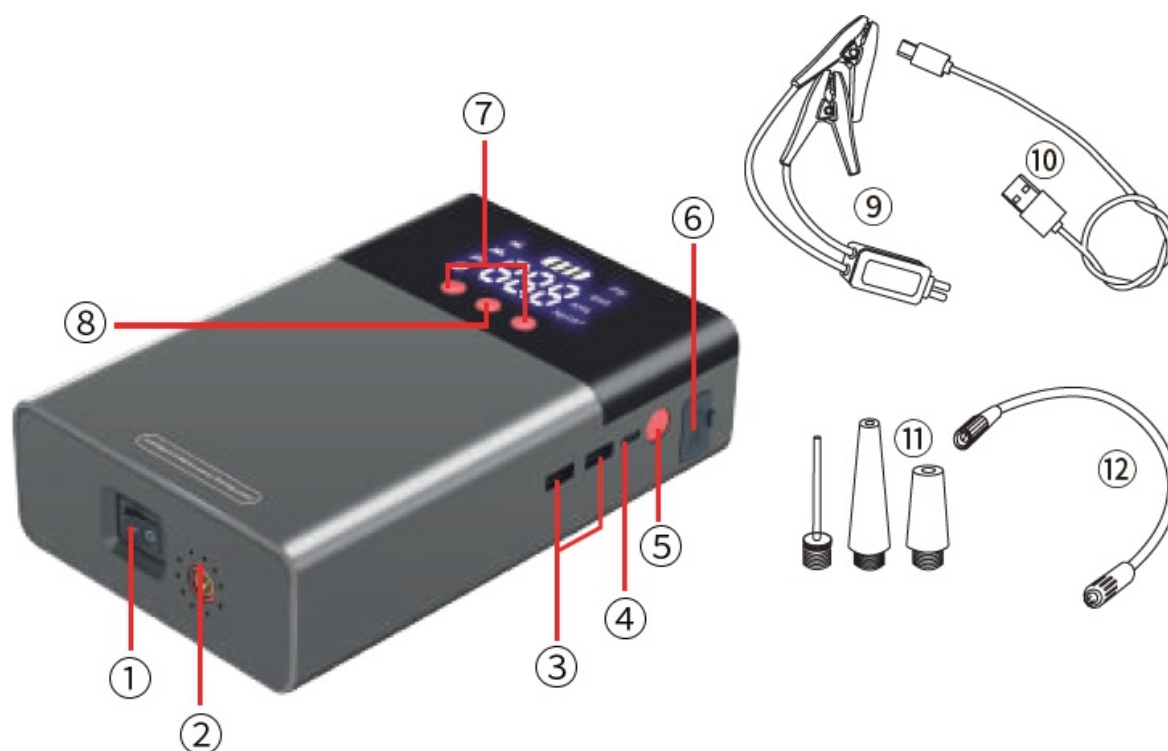

THE PACKAGE INCLUDES

- jump starter
- packaging
- user manual
- accessories
- storage bag for accessories

IMPORTANT

Due to continuous development, upgrades, or updates, the specifications and appearance of the device may change without prior notice. The images in the instruction manual may differ in parameters from the original product.

TECHNICAL SPECIFICATION

Automotive Emergency Jump Starter Specifications

Dimensions:	200*130*52mm	Remarks: The tire pressure will have a certain tolerance according to the temperature changes.
Max. pneumatic pressure	150 psi	
Input:	5V/2A	
Output:	5V/2A	
The pressure accuracy:	±0.1BAR	
Charging time:	4~5 hours	
Working temperature	-20°C~60°C	

FUNCTIONS/OPERATION

HOW TO USE LED EMERGENCY LIGHTING

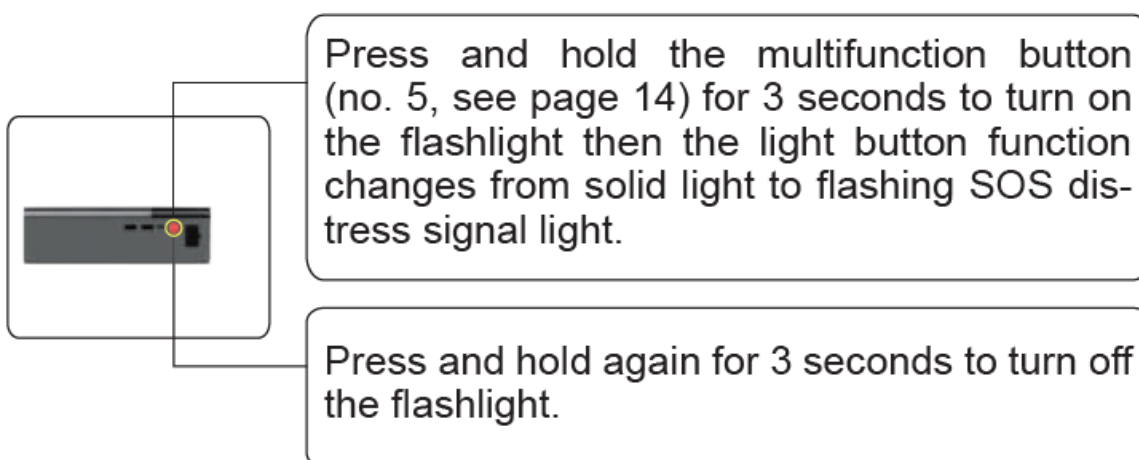

WARNING

The device is suitable only with 12V batteries!

HOW TO START A CAR WITH A FLAT BATTERY

Before starting the car, make sure that the device is charged to at least 70%, and all electrical devices such as the radio, lights, etc. in the car are turned off.

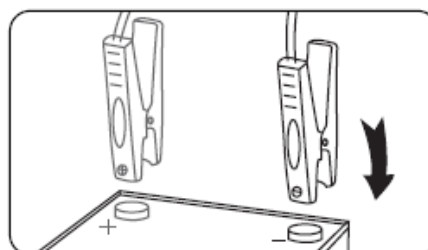
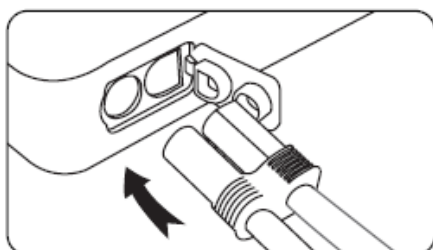

STEP

Remove the silicone plug and insert the cable plug into the appropriate port (no. 6, see page 14).

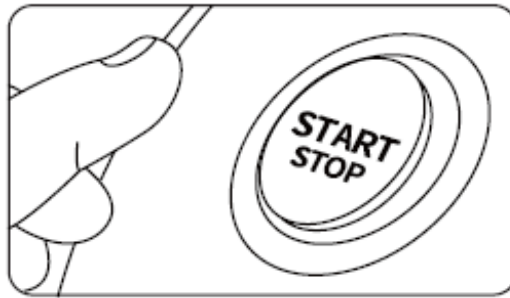

Start the engine

Do not cycle the jump starter for more than 3 seconds, pause for 1 minute between jump start attempts. This is necessary to let the jump starter battery cool down. STEP 2: Connect red clamp to the positive terminal of the car battery. Then, attach the black cable to the negative terminal of the car battery. Make sure the clamps are securely attached.

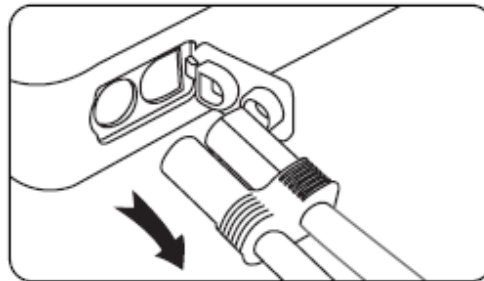

The plug is withdrawn from the jump starter first, and then the battery clips are removed from the terminals.

- If the connection is successful, the indicator lights up green.
- If the indicator lights up in red, it may indicate that the supply voltage is too low, or the clamps have been incorrectly connected.
- The device is protected against overheating. If the device gets overheated, the red indicator light will be on continuously, and the buzzer will emit 2 beeps per second. Once the fault has been rectified, the buzzer will return to normal status. Over-temperature protection is triggered at 80 °C.
- The device features protection against overcurrent. If the protection is triggered, the device will automatically shut down, the protection indicator will light up, and the buzzer will emit 4 beeps per second. After the fault has been rectified, the indicator will immediately return to normal status.

DEVICE CHARGING FUNCTION

Plug the USB cable into the product's USB port. Plug the other end of the cable into the corresponding interface of the dedicated device. After connecting the cable, press the multifunction button (no. 5, see page 14) to start the power supply.

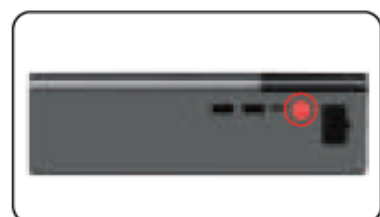
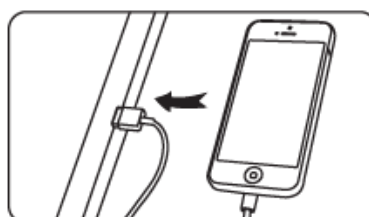
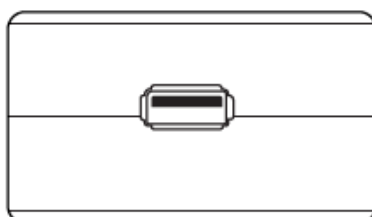

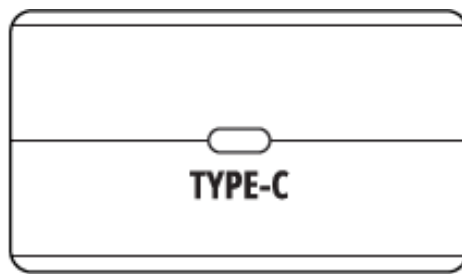

It is recommended that you use an AC adapter with an output of at least 5V/1A or preferably 5V/3A for charging. it can be a smartphone or tablet charger.

Insert the matching adapter and charger plug into the USB Type-C input port of the product.

AIR COMPRESSOR FUNCTION

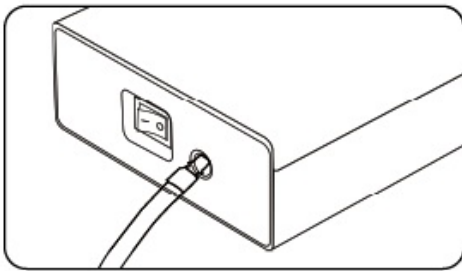

STEP 1

Connect one end of the inflation line to the air hole.

STEP 2

Connect the other end of the cable to the tire.

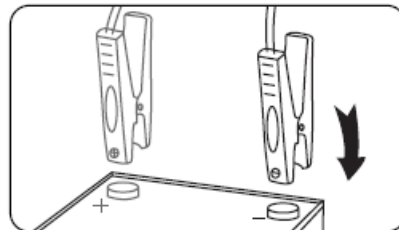
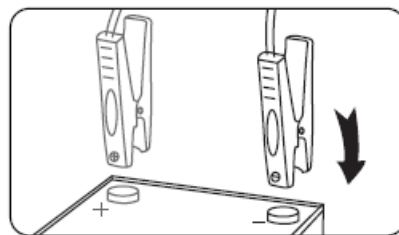
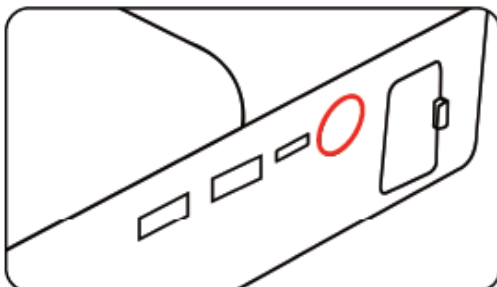
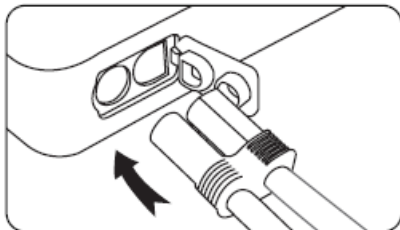
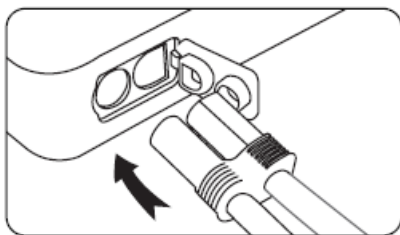

STEP 3

After connecting the wires, press the multifunction button (no. 5, see page 14) to start the device.

STEP 4

Select the mode according to “R”.

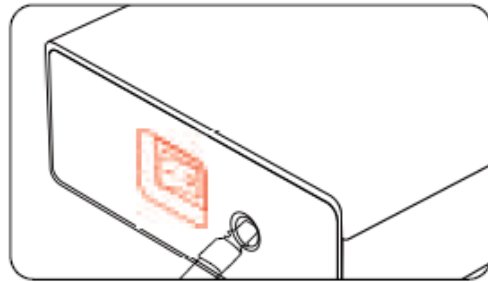

STEP 5

“-,+” are pressure adjustment buttons (no. 7, see page 14) (the default value is initially set and should be adjusted according to the user's individual needs).

STEP 6

Turn on the inflation switch to inflate the air. The process will stop automatically when full inflation is reached

TROUBLESHOOTING

• HOW TO USE THE INTELLIGENT BATTERY CLAMPS?

When the intelligent battery clamps are connected to the jump starter and car battery, the light indicator stays on green and the buzzer does not sound, which is the on state and can start the car normally.

• AUTOMATIC SHUTDOWN

The product has an intelligent detection function. Once there is no load, or the electronic devices are fully charged, it will be automatically powered off to save power.

• HOW LONG WILL IT TAKE TO CHARGE THE PRODUCT?

4 – 5 hours. To extend the device's service life, we recommend keeping the device charged to at least 50% and checking the charge level every month.

WARNINGS

- Read the operating instructions carefully before using the device.
- The device must never be used as a substitute for a car battery.
- Keep children and animals away from the working area of the device.
- Only use the jump starter for 12 V batteries.5. Keep the clips and their connection points clean and tidy. Never connect the clips together.
- Avoid using the device near explosive substances, flammable gases, or dusty environments.
- Avoid overheating the device, smoking near the device, and exposing the device to extreme moisture, keep the device away from open flames, and never immerse it in water.
- The device must not be stored at temperatures exceeding 60 °C.
- After successfully jump-starting the vehicle, disconnect the jump starter from the battery within 30 seconds to prevent equipment damage.
- Do not use the jump starter cable to charge other devices.
- Keep it supervised while charging.

- Using the device at current and voltage ranges other than those specified on the device nameplate may cause charging and discharging problems and deterioration of battery capacity and performance. This is also dangerous and may cause the device to malfunction.
- When the battery is stored for more than three months, the product needs to be charged to ensure the normal performance of the product.
- Never do anything that may cause mechanical damage to the device.
- Do not disassemble or transform the product without authorization.
- If the device casing is bulged, leaking, or giving off an unpleasant odor, stop using the device immediately.
- If you notice battery acid leaking from the battery, do not touch it with bare hands. If battery acid contacts the skin or eyes, rinse immediately with plenty of running cold water and soap. Flush eyes for at least 10 minutes. Seek medical advice if necessary.
- The device features a lithium rechargeable battery that must be disposed of under the applicable laws in your country.
- Please connect the starting cable correctly according to 20. Never attempt to jump-start the vehicle in continuous mode! With standard power, the start cycle should take no more than 3 seconds, and the interval between cycles should be at least 1 minute. Do not exceed 3 consecutive start attempts.
- After starting the car with the starting power, the temperature of the starting power supply itself will rise, please do not charge the starting power at this time, at least 8-10 minutes before charging.
- Only use the jump starter cable supplied with the jump starter.
- Do not charge the device immediately after jump-starting the vehicle's battery.
- Never use the device to start the vehicle's battery and charge the device's internal battery simultaneously.

WARRANTY SERVICE TERMS

WARRANTY COVERAGE

- Within the warranty period, if there is a quality problem during normal use, we will exchange and repair the product.
- Within the replacement period, we will only provide repair service for the appearance problem.
- Random accessories and gifts are not covered by the warranty.

THE WARRANTY WILL BE AUTOMATICALLY INVALID UNDER THE FOLLOWING SITUATIONS

- Damage caused by incorrect operation, used with negligence or force majeure (e.g., flood and fire, earthquake, lightning, war, etc.).
- The product has been repaired or adapted by technicians from non-manufacturers or non-manufacturers authorized organizations.
- The security code or warranty sticker on the product has been replaced, altered, or broken.
- The appearance is badly damaged and destroyed.

If the product is not covered by the warranty, we will provide repair service and it shall be at the customer's cost. The customer fills in the table below

Order No.			
Purchase Date			
Customer's info			
Address			
Phone		E-mail	

Mikavi's contact details

Return address	Trzebunia 513, 32-438 Trzebunia		
Helpline	22 487 58 75	E-mail	info@mikavi.pl

FAQs

Can I charge the device in unsuitable environments?

No, it is not recommended to charge the device in inappropriate environments.

What should I do if the device overheats during use?

If the device overheats, a red LED will blink continuously, and a beeping sound will occur. Stop use immediately and address the issue before using it again.

What type of adapter should I use for charging external devices?

It is recommended to use an AC adapter with an output of at least 5V/1A, preferably 5V/3A for efficient charging.

Documents / Resources

 <p>ENERJUMP 1 JUMP STARTER SAMOCHODOWY Z KOMPRESOREM POWIETRZA WCIŚNIĘCIEM KŁÓW JUMP STARTER WITH AIR COMPRESSOR THE BEST CHOICE FOR YOUR CAR</p>	<p>MIKAVI ENERJUMP 1 Jump Starter With Air Compressor [pdf] Instruction Manual ENERJUMP 1 Jump Starter With Air Compressor, ENERJUMP 1, Jump Starter With Air Compressor, Starter With Air Compressor, Air Compressor, Compressor</p>
---	---

References

- [Mikavi](#)
- [User Manual](#)

[Manuals+](#), [Privacy Policy](#)

This website is an independent publication and is neither affiliated with nor endorsed by any of the trademark owners. The "Bluetooth®" word mark and logos are registered trademarks owned by Bluetooth SIG, Inc. The "Wi-Fi®" word mark and logos are registered trademarks owned by the Wi-Fi Alliance. Any use of these marks on this website does not imply any affiliation with or endorsement.