



CS 7632 FL SmartLine element  
with induction Tepan Yaki



# Miele CS 7632 FL SmartLine element with induction Tepan Yaki Owner's Manual

[Home](#) » [Miele](#) » Miele CS 7632 FL SmartLine element with induction Tepan Yaki Owner's Manual 

## Contents

- [1 Miele CS 7632 FL SmartLine element with induction Tepan Yaki](#)
- [2 Product Specifications](#)
- [3 Product Usage Instructions](#)
- [4 Technical data](#)
- [5 SmartLine element](#)
- [6 FAQ](#)
- [7 Documents / Resources](#)
  - [7.1 References](#)

A large Miele logo, consisting of the word "Miele" in white serif font on a red rectangular background.

Miele CS 7632 FL SmartLine element with induction Tepan Yaki



## Product Specifications

- **Model:** CS 7632 FL SmartLine element with induction Tepan Yaki
- **EAN:** 4002515836293
- **Material Number:** 10684420
- **Old Material Number:** 27763250GB
- **Induction Centred Tepan area with dimensions:** 60 x 378 x 520 mm
- **Power Levels:** 8
- **Power Consumption:** 2.80 kW
- **Voltage:** 220-240 V
- **Frequency:** 50-60 Hz

## Product Usage Instructions

### Installation

1. Refer to the provided installation drawing for flush installation.
2. Ensure the mains connection box is properly connected with the mains cable.
3. Follow the stepped cut-out dimensions for installation.
4. A wooden frame of 12 mm should be used (supplied loose).

## Operation

1. Ensure the appliance is connected to a suitable power source.
2. Place the cookware on the centered Tepan area with induction.
3. Adjust the desired power level using the control panel.
4. Carefully monitor the cooking process to achieve desired results.

## Cleaning and Maintenance

1. Allow the appliance to cool down before cleaning.
2. Use a mild detergent and a soft cloth to clean the surface.
3. Avoid using abrasive cleaners or materials that may scratch the surface.
4. Regularly check and clean the ventilation openings to ensure proper airflow.

Intuitive quick selection via number sequences – Smart Select

- **Elegant design** – for flush or raised installation
- Seamlessly integrates with any SmartLine element
- **Particularly versatile** – 2 separately controlled teppan areas
- **Short heating-up times** – thanks to induction cooking

**EAN:** 4002515836293 / Material number: 10684420 / Old Material Number: 27763250GB

Heating type	
Heating type	Induction
Construction type	
SmartLine	•
Design	
Elegant glass ceramic surface	•
Flush	•
Ceramic surface colour	Black
Surface-mounted installation	•
1st cooking zone/cooking area	
Position	Centred
Type	Tepan area with induction
User convenience	
Operation via sensor controls	Smart Select
Display colour	Yellow
Keeping warm	•
Stop & Go function	•
Recall function	•
Safety switch-off	•
Individual setting options (e.g. buzzers)	•
Wipe protection	•
Minute minder	•
Cleaning and care	
Easy to clean ceramic glass	•
Safety	
Safety switch-off	•
Lock function	•
System lock	•
Overheating protection	•
Residual heat indicator	•

## Technical data

- **Dimensions (H x W x D) in mm** 60 x 378 x 520
- **Dimensions in mm** (width) 378

- **Dimensions in mm (height)** 60
- **Dimensions in mm (depth)** 520
- **Cut-out dimensions (W x D) with flush-fit installation in mm** 358/382 x 500/524
- **Casing height incl. connection box in mm** 60
- **Internal cutout dimensions in mm (width) with flush installation** 358
- **Internal cutout dimensions in mm (depth) with flush installation** 500
- **Weight in kg** 8
- **External cutout dimensions in mm (width) with flush installation** 382
- **External cutout dimensions in mm (depth) with flush installation** 524
- **Total rated load in kW** 2.80
- **Length of supply lead in m** 1.5
- **Voltage in V** 220-240
- **Frequency in Hz** 50-60

#### **Accessories included**

- **Mains cable** Yes

#### **SmartLine element**

**SmartLine element with induction Tepan Yaki**

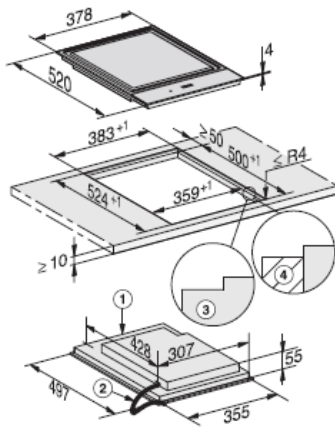

CS7632FL, flush (installation drawing)

1) Front, 2) Mains connection box with mains connection cable, L = 2000 mm, 3) Stepped cut-out, 4) Wooden frame 12 mm (supplied loose)

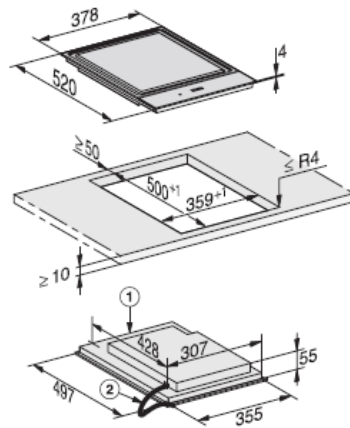

CS7632FL, flush (installation drawing)

1) Front, 2) Mains connection box with mains connection cable, L = 2000 mm

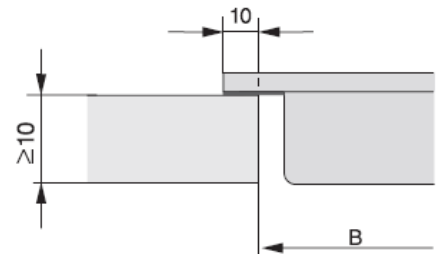

CS 7000 FL (Installation drawing)

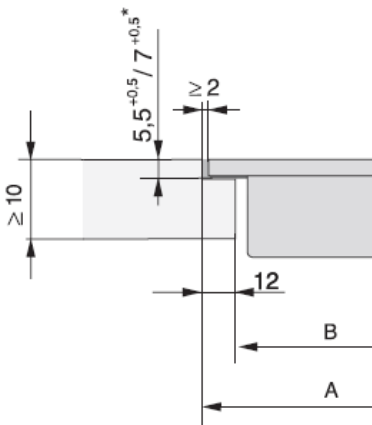

CS 7000 FL, flush (Installation drawing)

\*7+0,5 = CS7611 (Wok)

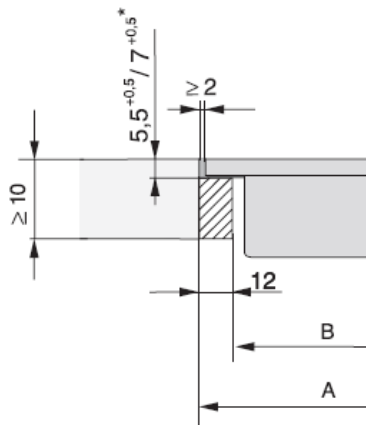

CS 7000 FL, flush (Installation drawing)

\*7+0,5 = CS7611 (Wok)

## FAQ

- **Q: Where can I find more information about the product?**
  - A: Additional information can be found at <http://www.miele.ie>
- **Q: What accessories are included with the product?**
  - A: The mains cable is included with the CS 7632 FL SmartLine element.

## Documents / Resources

	<p><a href="#">Miele CS 7632 FL SmartLine element with induction Tepan Yaki</a> [pdf] Owner's Manual CS7632 FL, 10684420, 27763250GB, CS 7632 FL SmartLine element with induction Tepan Yaki, CS 7632 FL, SmartLine element with induction Tepan Yaki, element with induction Tepan Yaki, with induction Tepan Yaki, induction Tepan Yaki, Tepan Yaki, Yaki</p>
--	---

## References

- [User Manual](#)

This website is an independent publication and is neither affiliated with nor endorsed by any of the trademark owners. The "Bluetooth®" word mark and logos are registered trademarks owned by Bluetooth SIG, Inc. The "Wi-Fi®" word mark and logos are registered trademarks owned by the Wi-Fi Alliance. Any use of these marks on this website does not imply any affiliation with or endorsement.