

Miele APWM 020 Communication Module and Installation Kit Instruction Manual



Contents

[1 Conversion and assembly instructions](#)

[1.1 M.-No 11819250](#)

[1.1.1 Installation instructions for XCI US box 2 PWM12-20 kg](#)

[1.1.2 Included parts](#)

[1.1.3 Installing the wiring harness](#)

[1.1.4 Attaching the XCI box 2 with holding plate to the washing machine](#)

[2 Documents / Resources](#)

[2.1 References](#)

[3 Related Posts](#)

Conversion and assembly instructions

M.-No 11819250

Installation instructions for XCI US box 2 PWM12-20 kg

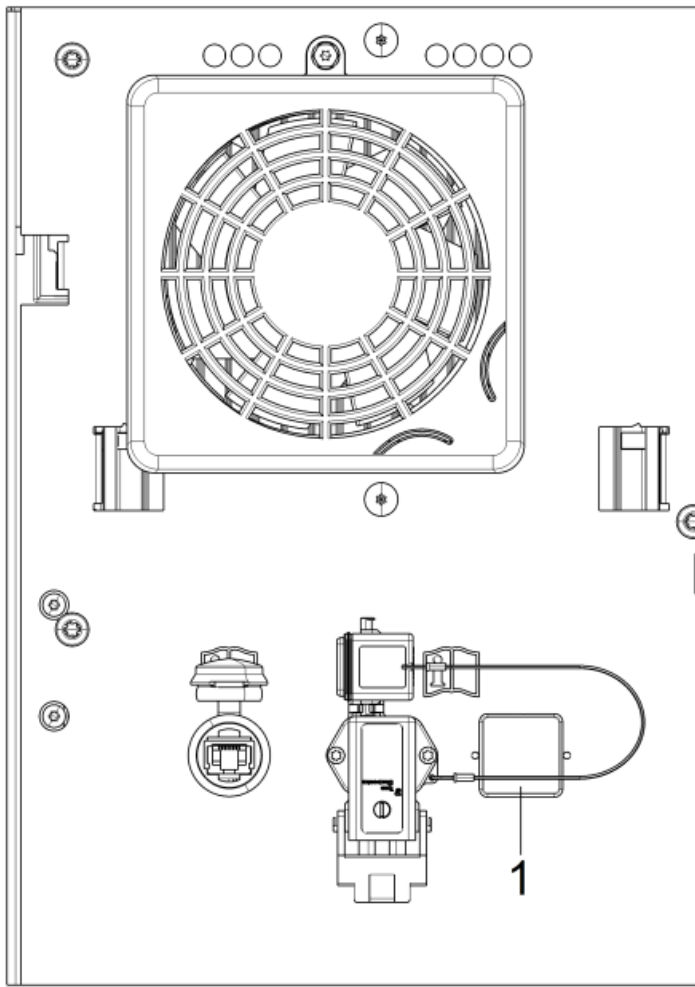

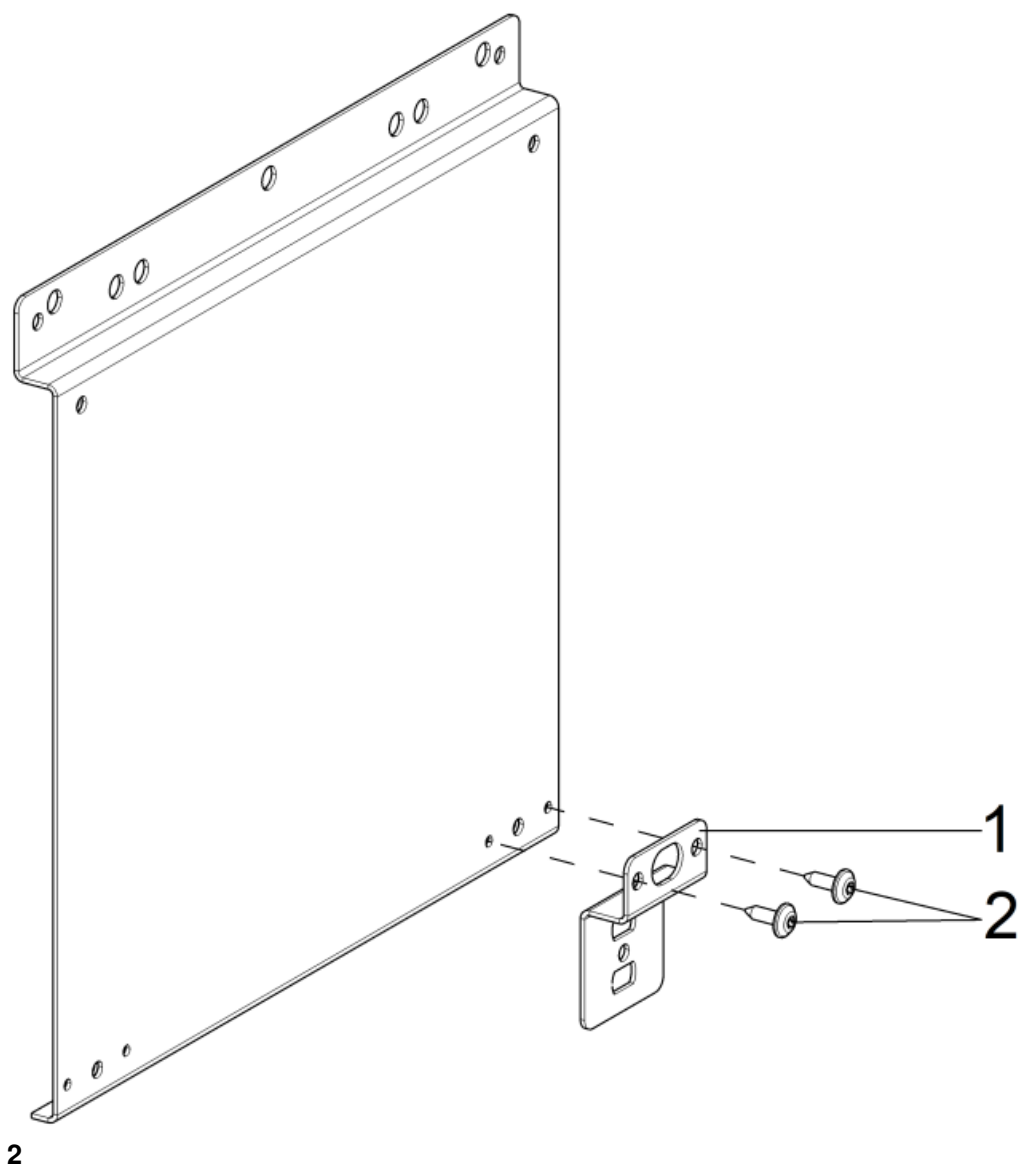

2

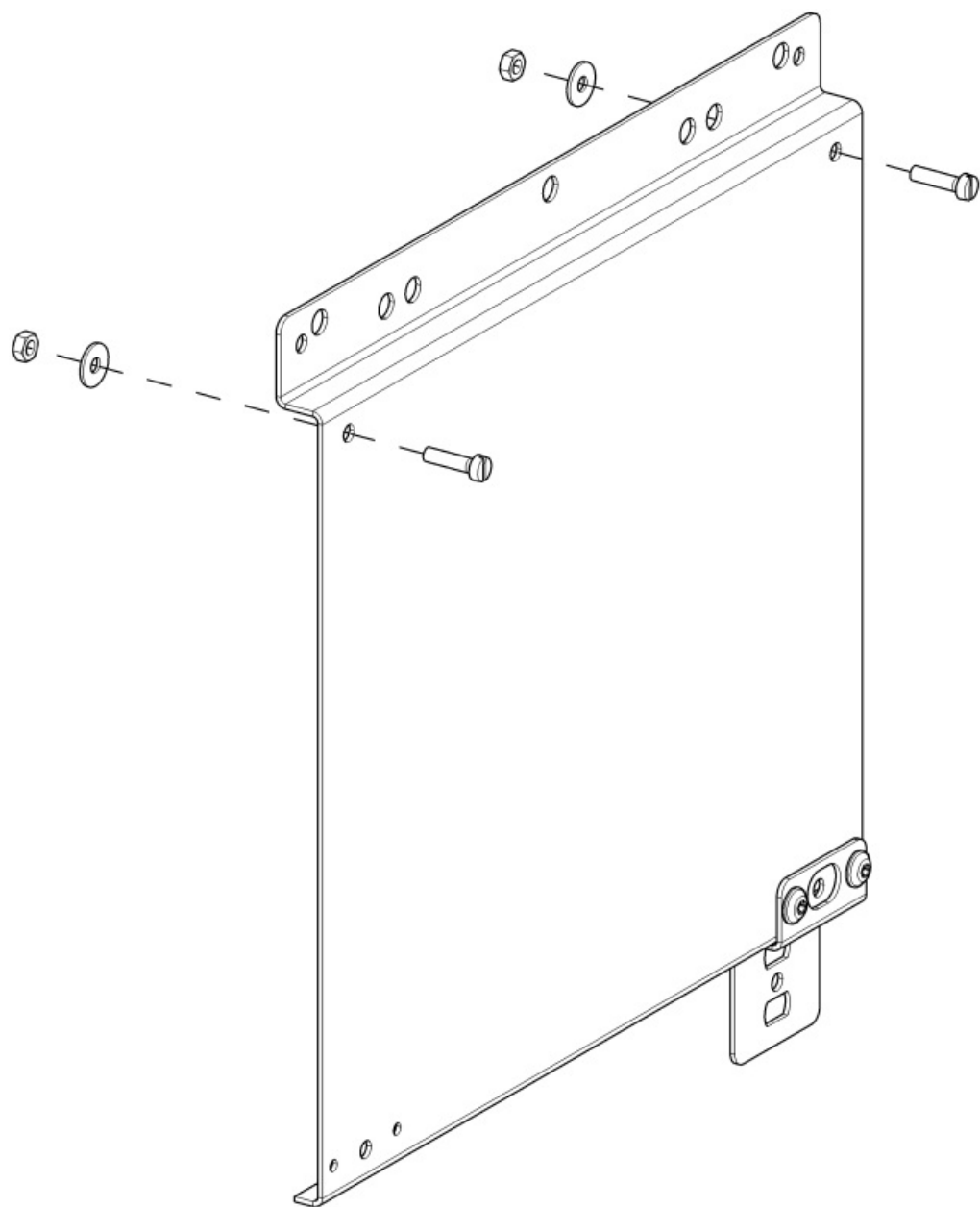

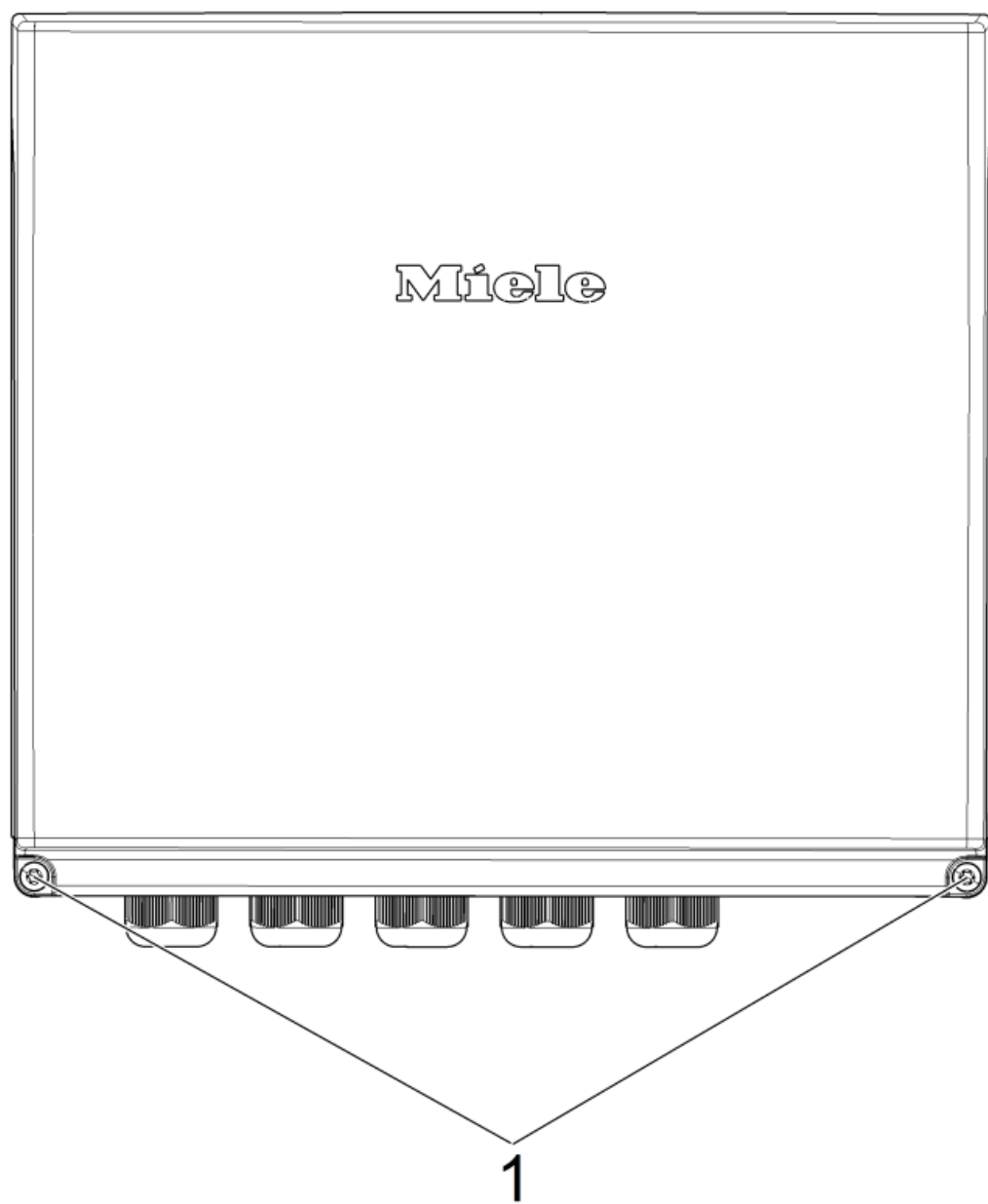

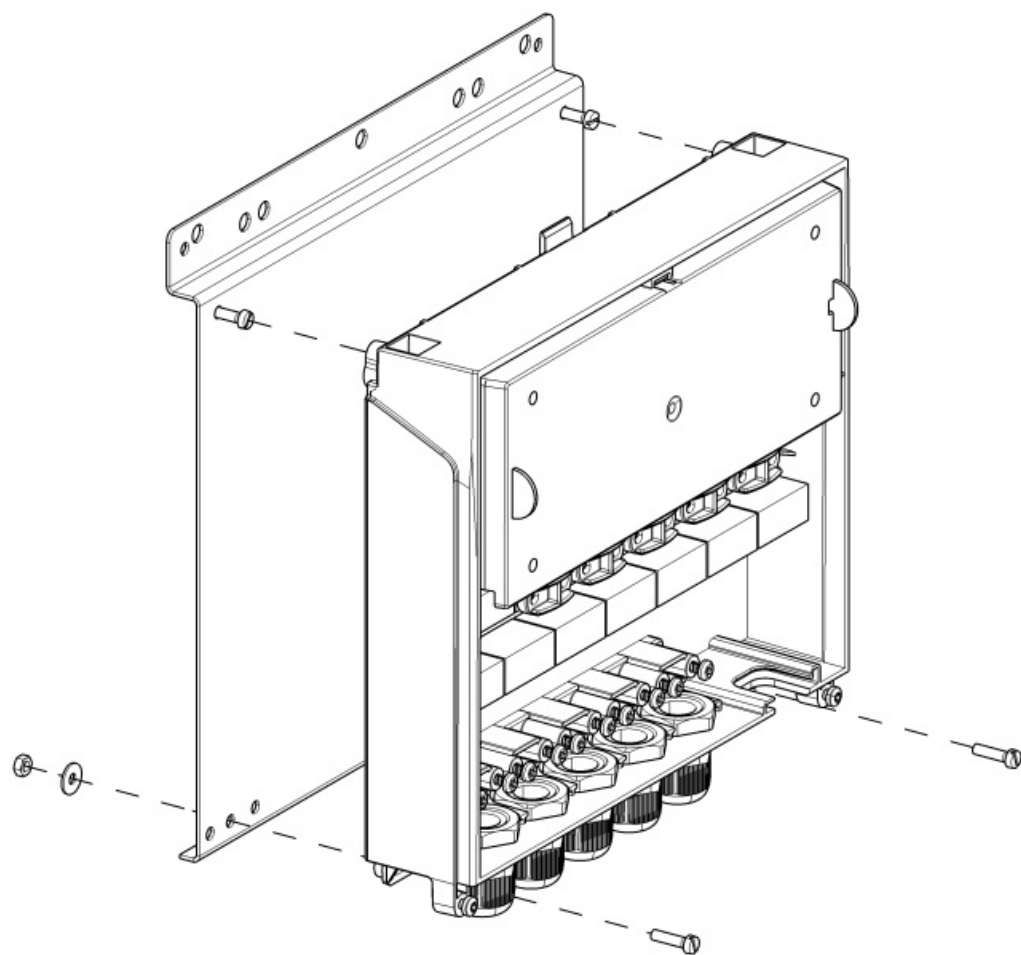

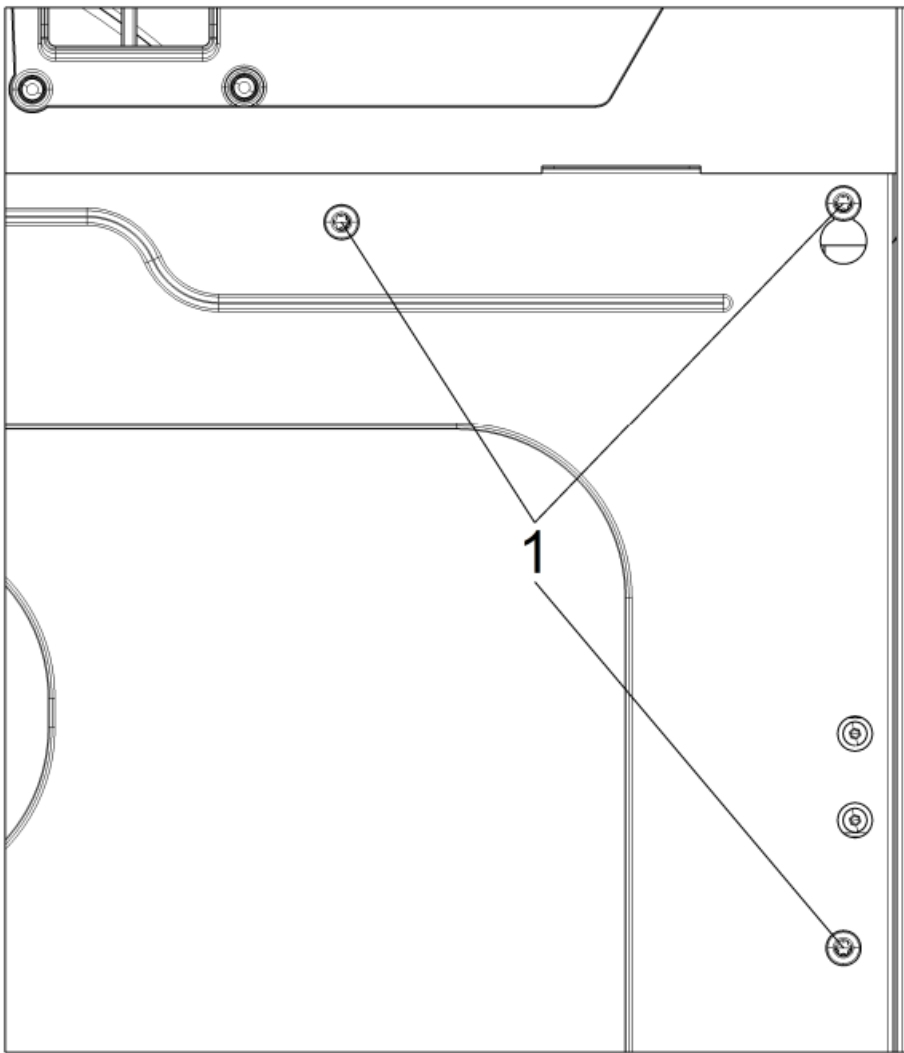

6

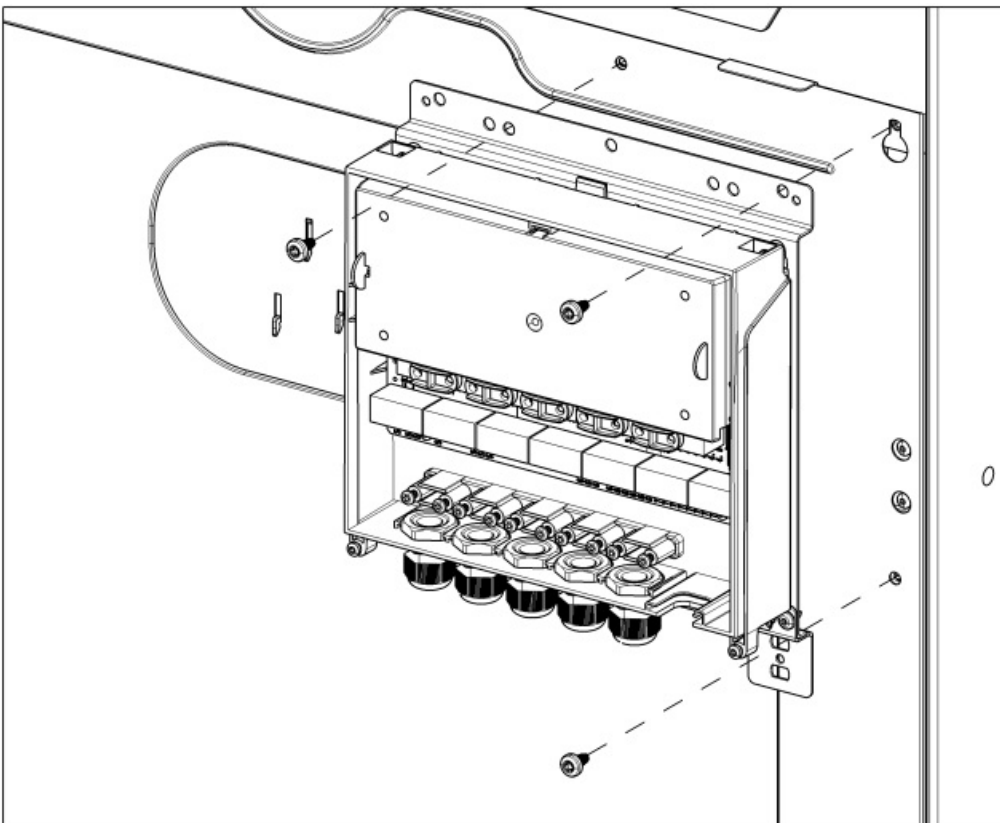

7

Included parts

No.	Mat. no.	Designation
1		XCI box
1		Wiring harness for XCI box 2
2		Raised-head self-tapping screw 2.9 x 16
4		Cheese-head screw M4 x 16
4		Hexagon nut DIN 934 M4 GAL/ZN
4		Washer M4 A2
5		Raised-head screw M4 x 12.5 (only 2 are required)

Danger due to incorrect service and repair work

WARNING



Danger due to incorrect service and repair work

There is a risk of serious damage, injury and even death if service and repair work is carried out incorrectly.

- ✚ Service and repair work should only be carried out by a suitably qualified electrician with specialist training, knowledge and experience.
- ✚ All appropriate safety requirements must be taken into account.
- ✚ Wear personal protective equipment.
- ✚ First read the Miele service documentation, then commence work.

The “Miele Service Documentation (MSD)” service application is required when carrying out maintenance work on the appliance

The safety instructions and warnings in the Miele Service Documentation (MSD) for the corresponding model must be observed.

Work on the appliance must be carried out in accordance with the work instructions.

Installing the wiring harness

- ✚ Remove the cap (1) from the rear of the machine, see Fig. 1.
- ✚ Feed the wiring harness through the opening and into the machine.
- ✚ Use 2 raised-head self-tapping screws 2.9 x 16 to secure the Wepol coupling of the wiring harness to the rear panel.
- ✚ Lay the new wiring harness parallel to the wiring harness for the existing Wepol coupling.
- ✚ Plug in the earthing connection for the wiring harness next to the earth terminal on the wiring harness for the existing Wepol coupling.
- ✚ Connect the wiring harness on the electronic unit EL as shown in the wiring diagram.

Attaching the XCI box 2 with holding plate to the washing machine

- ✚ Screw the fixing plate bracket (1) to the holding plate (3) with 2 M4 raised-head screws (2), see Fig. 2.

- 🔧 Screw the 2 cheese-head screws loosely to the holding plate with 1 washer and 1 nut attached to each of them, see Fig. 3.
- 🔧 Remove the screws (1) from the lid of the XCI box, see Fig. 4.
- 🔧 Fold the lid of the XCI box up and back. A Position the top of the XCI box on the screws on the holding plate, see Fig. 5.
- 🔧 Screw the bottom of the XCI box to the holding plate using the 2 cheese-head screws with 1 washer and 1 nut attached to each of them, see Fig. 5.
- 🔧 Screw the nuts tight at the top.
- 🔧 Remove the 3 screws from the rear of the washing machine, see Fig. 6.
- A Use the 3 screws you removed above to screw the XCI box to the rear of the washing machine, see Fig. 7.
- 🔧 Connect the XCI box as described in the operating instructions.
- 🔧 Fit the lid to the XCI box.

02.06.2023

Documents / Resources

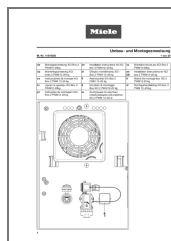

[Miele APWM 020 Communication Module and Installation Kit](#) [pdf] Instruction Manual
APWM 020 Communication Module and Installation Kit, APWM 020, Communication Module and Installation Kit, Module and Installation Kit, Installation Kit, Kit

References

- [User Manual](#)

[Manuals+](#). [Privacy Policy](#)

This website is an independent publication and is neither affiliated with nor endorsed by any of the trademark owners. The "Bluetooth®" word mark and logos are registered trademarks owned by Bluetooth SIG, Inc. The "Wi-Fi®" word mark and logos are registered trademarks owned by the Wi-Fi Alliance. Any use of these marks on this website does not imply any affiliation with or endorsement.